

## Outdoor Ceiling Fixture Installation Instructions

### ⚠ WARNING:

1. To avoid fire, shock, or death, disconnect power at circuit breaker or fuse before the installation.
2. If you are unsure about the installation or maintenance of the Outdoor Ceiling Fixture, please consult a qualified electrician.

### ⚠ SAFETY:

1. Please read all warnings and instructions before installation.
2. The fixture must be wired in accordance with the National Electric Code and applicable local codes or ordinances.
3. To insure personal safety, proper grounding is required.

### INSTALLATION NOTES:

1. This fixture should not be used in areas with limited ventilation or high ambient temperature exceeding 45°C.
2. Fixture cannot be used with a dimmer switch, motion sensor and other electronic switching devices.

### INSTALLATION LOCATION:

This fixture must only be wall-mounted. Be certain that the receiving junction box is well secured and can support the weight of the lamp.

### PRODUCT DIMENSIONS:

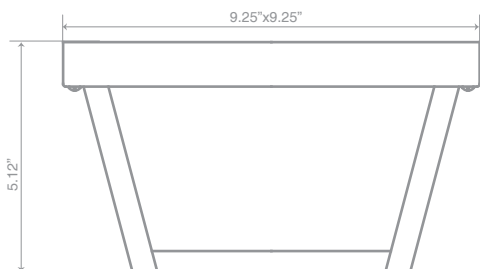

### PRODUCT SPECIFICATION:

**Part Number:** MEL-9175W

**Input Voltage:** 120 VAC

**Amp Draw:** 0.11 A

**Frequency:** 60 Hz

**Rated Power:** 12.5W

**Beam Angle:** 120°

**Suitable for:** Damp Location

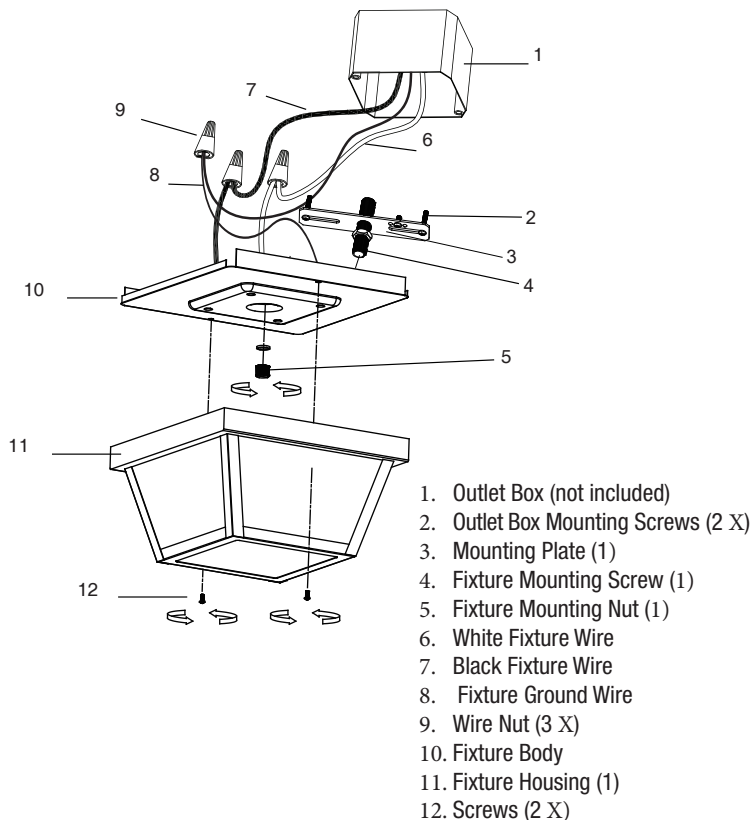

### INSTALLATION INSTRUCTION:

**CAUTION:** Read **WARNING** and **SAFETY** Notes before beginning installation.

<b>1.TURN POWER OFF</b>	Turn power off at circuit breaker or remove fuse.
<b>2.PREPARE CROSS BAR</b>	Screw in the Fixture Mounting Screws (4) into the Mounting Plate (3)
<b>3.MOUNT CROSS BAR</b>	Mount Mounting Plate (3) to Outlet Box (1) by inserting the two Mounting Screws (2) through slots in Mounting Plate.
<b>4.CONNECT FIXTURE</b>	Hold the fixture body (10) close to the outlet box(1). Using wire nuts provided connect Yellow/Green wire from fixture to green or bare copper ground (house) wire. If outlet box is grounded you may fasten fixture ground wire directly to outlet box. Connect white fixture wire(s) to neutral supply wire. Connect black fixture wire(s) to power supply wire.
<b>5.MOUNT FIXTURE BODY</b>	Insert Fixture Mounting Screw (4) through holes on the fixture body and secure to Mounting Plate by tightening Fixture Mounting Nut (5). NOTE: Hand tighten Mounting Nuts. Do not use any tools as over tightening may occur causing damage to back plate.
<b>6.MOUNT FIXTURE HOUSING</b>	Insert fixture body(10) screw bolt through fixture housing (11)holes and secure the screws (12) to the ends of the fixture body(10).
<b>7.TURN POWER ON</b>	Turn power on at circuit breaker or replace the fuse.

## 3 YEAR WARRANTY

Maxxima extends a 3 year limited warranty to the original purchase that the products listed are free from defects in material and/or workmanship only. Maxxima will replace any warrantied product to the original consumer/purchaser if the product fails because of defects due to workmanship and/or materials within the limited warranty period. Limited warranty is not transferable and applies to the original installation of the Maxxima product. This offer does not constitute in any way a product guarantee and Maxxima does not hereby assume any obligation whatsoever beyond sending a free replacement product.