



**Winnow™**  
28" x 24" wall cabinet  
**K-33583-ASB**

### Features

- Open shelf offers easy access to storage, while interior shelf provides ample space for extra toilet paper.
- Three-way adjustable soft-close door hinges with 100° opening capability for easy cabinet access.
- Finish-matched 10"-deep cabinet interior.
- Customize your storage with optional accessories such as floor liners, drawer organizers, and perfectly sized containers (sold separately).
- Coordinates with K-33584 upgraded hardware finishes (sold separately).

### Material

- Solid wood and moisture-resistant MDF.
- Painted exterior.

### Installation

- Easy installation – no special tools required.

### Recommended Products/Accessories

K-33584 5" cabinet pull  
K-33582-ASB 70" x 24" linen tower  
K-33577-ASB 24" bathroom vanity set  
K-33578-ASB 30" bathroom vanity set  
K-33579-ASB 36" bathroom vanity set  
K-33580-ASB 48" bathroom vanity set  
K-33581-ASB 60" bathroom vanity set  
K-33585  
K-33586

### Included Components

Additional Components:

Wall-mounting hardware

### Codes/Standards

EPA TSCA Title VI  
CARB P2

### KOHLER® One-Year Limited Warranty

See website for detailed warranty information.



**Winnow™**  
28" x 24" wall cabinet  
**K-33583-ASB**

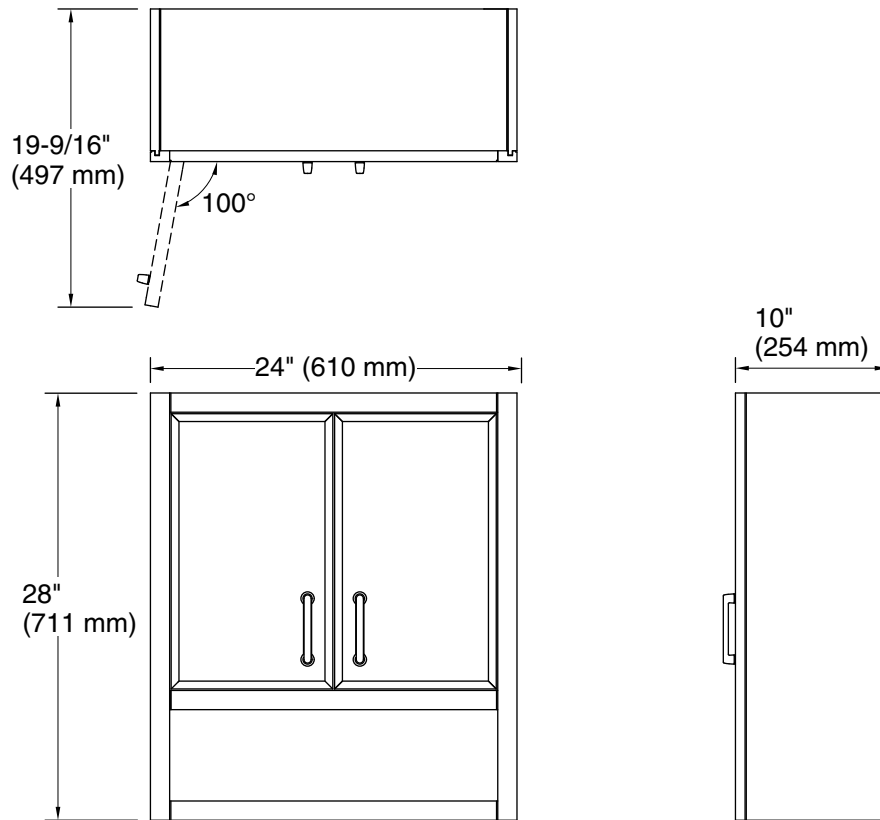

**Technical Information**

All product dimensions are nominal.

**Notes**

Install this product according to the installation instructions.