



Shower Wall Kit

INSTALLATION INSTRUCTIONS



Read all instructions prior to installing product.

Refer to manufacturers safety instructions when operating any tools.

To register your product, please visit:

freedomproduct.com

⚠ WARNING:

- Improper installation of this product can result in personal injury. Always wear safety goggles when cutting, drilling and assembling the product.
- Incorrect installation may cause harm to the product or individual.

NOTICE:

- DO NOT attempt to assemble the kit if parts are missing or damaged.
- DO NOT return the product to the store. For assistance or replacement parts call: 1-800-336-2383.

BEFORE YOU BEGIN:

Check your local zoning laws.

- Local zoning laws and Home Owners Associations may regulate the location, style and height of your product or even require a permit signoff beforehand.
- Check local codes for frost line depth and regulations.
- You must have the utility companies clearly mark your property for electrical, gas or water lines to avoid puncturing any unseen underground utilities.

TOOLS/MATERIALS NEEDED:

Line Level
Post Level
Tape Measure
Ratchet Set
Drill Gun #2, #3 Phillips
Driver Bit Extender (Recommended)
Safety Glasses
Black Sharpie or Carpenter's Pencil
Rags
Spray Cleaner

Component list:

Item #	Description	Qty.
1	1.75" x 5.47" x 42.125" Privacy Panel Rail	2
2	1.02" x 1.379" x 46.5" U-Channel	2
3	0.875" x 6" x 50" – 0.35W Tongue and Groove Board	7
4	1.75" x 5.5" Bracket Kit	4
5	Pan Head Screw	16
6	Screw Head Cap	16

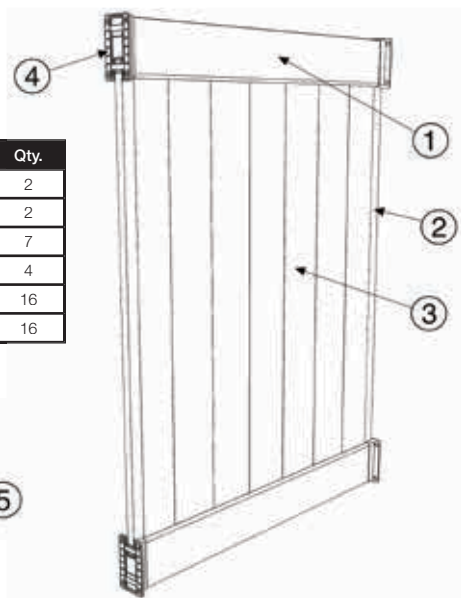

1

Bottom Rail

- Slide brackets onto bottom rail and lift rail into place between posts.
- Offset bottom brackets 10" above finish grade and center bottom rail on posts (Fig. 1).
- Mount brackets to posts using included 4 screws per bracket. Insert white screw head caps to hide screws (Fig. 1).

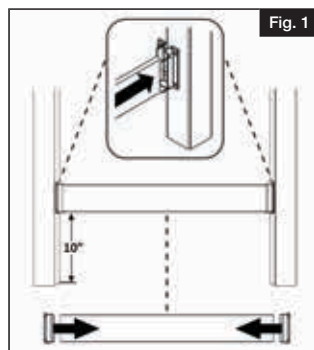

Fig. 1

2

Vertical Tongue and Groove Boards

- Insert vertical tongue and groove boards into bottom rail from left to right.
- Place U-Channel centered vertically on edge of tongue and groove boards #1 and #7 (Fig. 2)

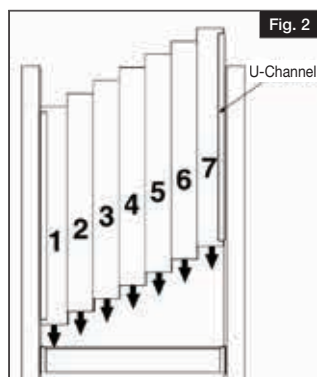

Fig. 2

3

Top Rail

- Slide brackets onto top rail and place rail on top of vertical tongue and groove boards (Fig. 3).
- Mount brackets to posts using included 4 screws per bracket. Insert white screw head caps to hide screws (Fig. 3).

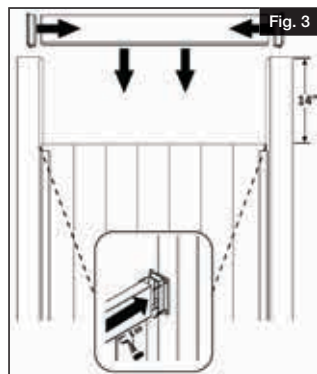

Fig. 3

BARRETTE OUTDOOR LIVING

7830 FREEWAY CIRCLE
MIDDLEBURG HEIGHTS, OHIO 44130

TEL: (888) 418-4400
WWW.FREEDOMPRODUCT.COM

