

ASSEMBLY INSTRUCTIONS



CAUTION

◆ Inspect the wire insulation for any cuts, abrasions, or exposed copper that may have resulted during shipping. If there is a defect in the wire, do not attempt installation.

◆ Before starting installation of this fixture or removal of a previous fixture, disconnect the power by turning off the circuit breaker or by removing the fuse at the fuse box.

✉ If you need further assistance, please contact us by Email: customersupport@superiordecorinc.com

TOOLS REQUIRED



Ladder



Safety glasses



Electrical tape



Phillips screwdriver



Flat blade screwdriver



Pliers

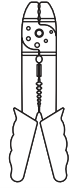

Wire strippers

HARDWARE INCLUDED

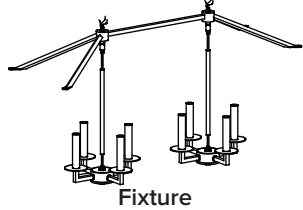

Fixture

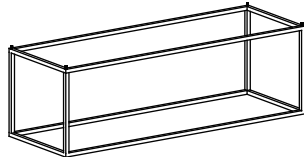

Iron Rack



Ball Nuts (A&B)

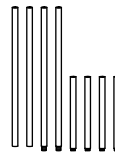

Stems



Swivels

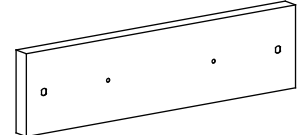

Ceiling Plate

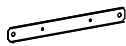

Baseplate



Lanyards



Washers

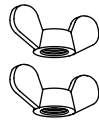

Decorative Nuts



Ground Wire

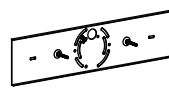

Mounting Unit



Wood Screws



Wall Anchors



Mounting Screws



Wire Nuts

*PARTS SHOWN MAY DIFFER SLIGHTLY PER LIGHT FIXTURE

EXPLODED PARTS

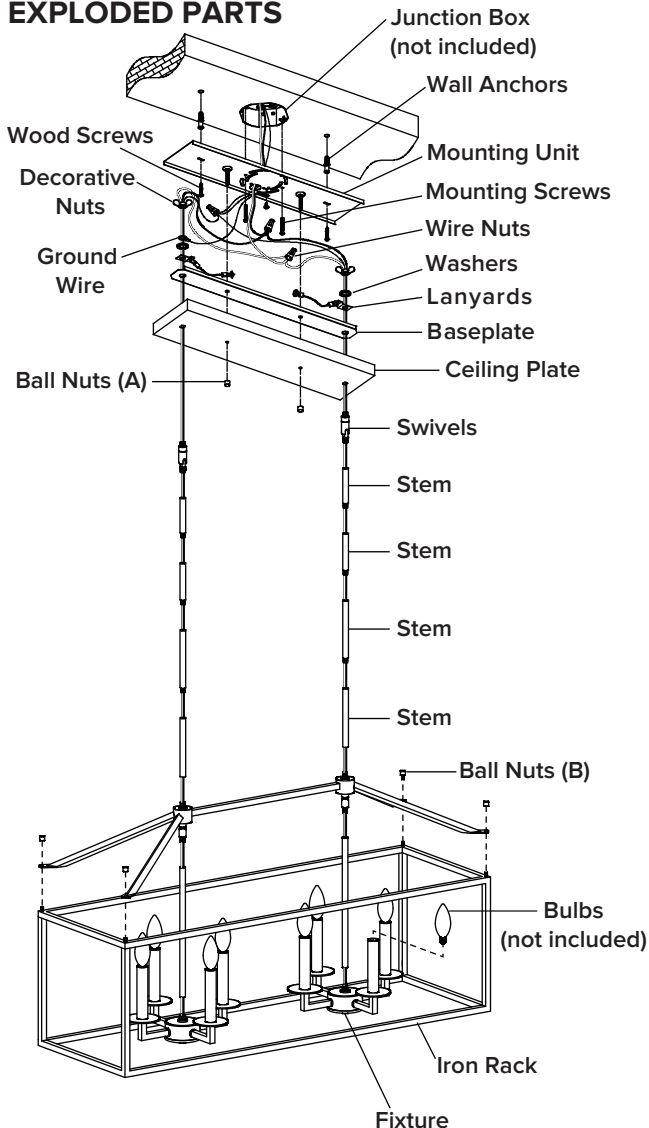

INSTALLATION

STEP 1

1. Installation **fixture**.
2. Attach the **iron rack** onto **fixture** using **ball nuts (B)**.

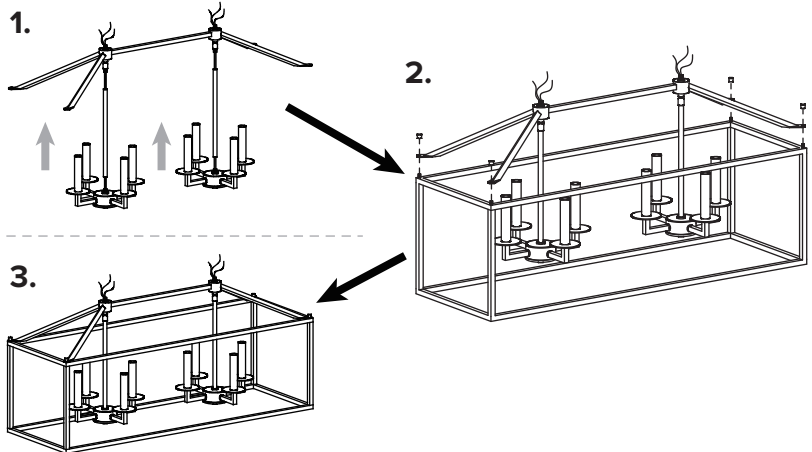

STEP 2

1. Unscrew the **ball nuts (A)** and **green grounding screw** from the **mounting unit**.
2. Disassemble the **swivels** under the **ceiling plate** by unscrewing **decorative nuts**. Keep the **baseplate**, **washers**, **ground wire** and **lanyards** for later use.

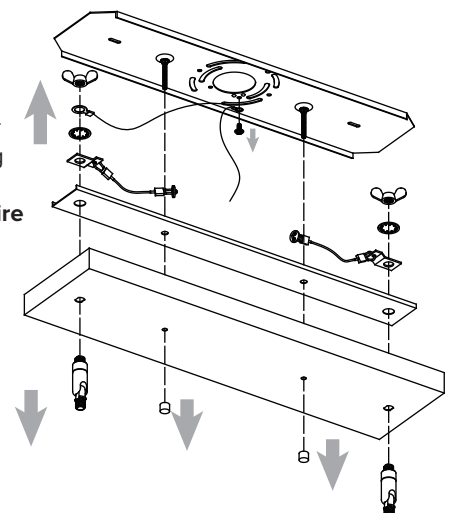

ASSEMBLY INSTRUCTIONS (INSTALLATION)

STEP 3

1. Weave the fixture wire and fixture ground wire through the **stems** and **swivels**.
2. Install **swivels** and **stems** into the **fixture**.
Install **stems** based on the desired length of the item on the **fixture**.

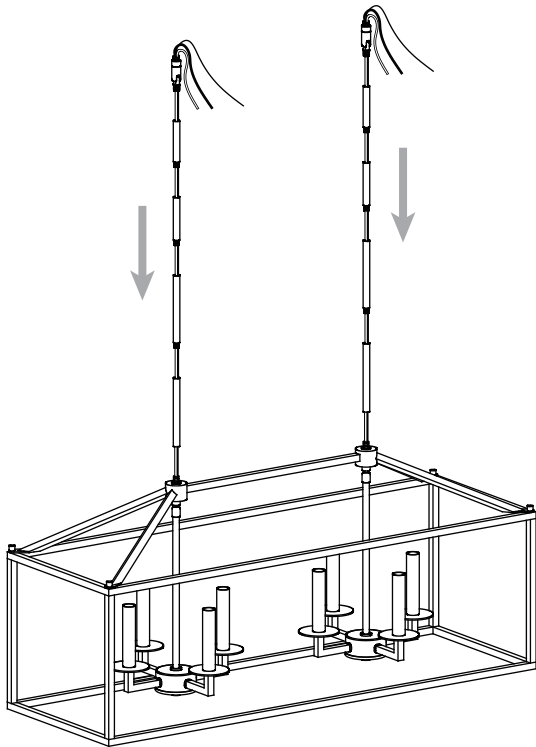

STEP 4

1. Weave the fixture wire and fixture ground wire through the **ceiling plate**, **baseplate**, **ground wire**, **lanyards**, **washers** and **decorative nuts**.
2. Install **baseplate**, **lanyards**, **ground wire** and **swivels** into the **ceiling plate**, and secure with **washer** and **decorative nuts**.

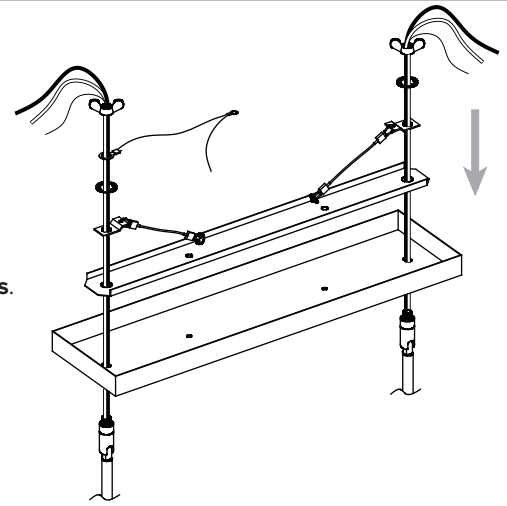

STEP 5

Attach the **mounting unit** to the junction box (not included) using the **mounting screws**. Secure **mounting unit** to ceiling with **wood screws** and **wall anchors**.

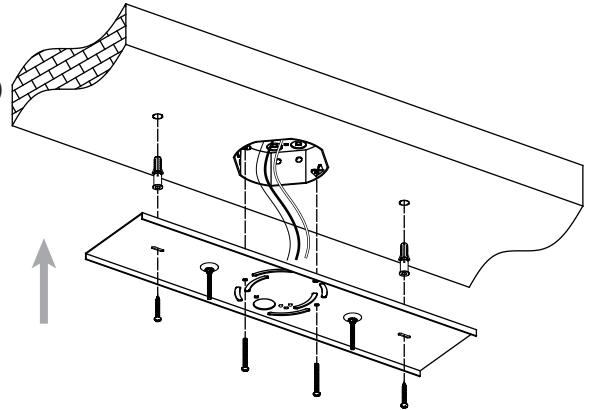

STEP 6

1. Attach the lanyards on to the mounting unit.
2. Make the electrical connection from the junction box (not included) to the **fixture**. Connect the **ground wire** to the **mounting unit** using the preinstalled green ground screw. Then, connect the positive, negative and ground wires with the supplied **wire nuts**. Secure with electrical tape.

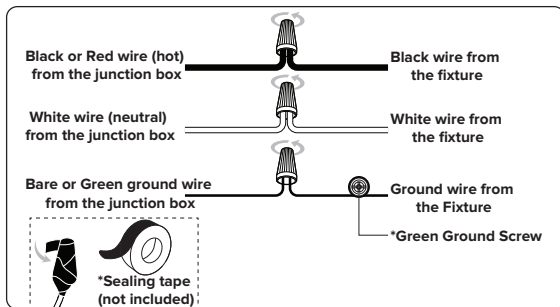

STEP 7

Attach the **ceiling plate** to the **mounting unit** through screw holes as shown, and secure it with **ball nuts (A)**.

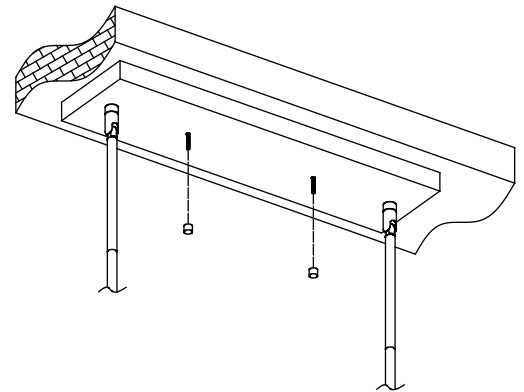

STEP 8

Install bulbs (not included)

