



# HOW TO MEASURE

## FULL-FRAME REPLACEMENT

Use this method to measure for a full-frame replacement project (removing sash and frame) using a Pella® wood window or patio door.

### Option One: If You Can Remove the Interior Trim.

#### Step A: Remove the Trim.

- Using a utility knife, score the paint around the interior wall on all sides of the window or door.
- Next, using a pry bar, separate the bottom trim from the interior wall. Repeat until all trim is removed.

#### Step B: Measure the Opening Width.

- Measure the distance from the right stud to the left stud in three places (the center, top and bottom) on your old window or door. (See Diagram A.)
- Write down the smallest of these three measurements to the right — this is your opening width.



#### Step C: Measure the Opening Height.

- Measure the distance from the header to the bottom stud in three places (the center, right and left) on your old window or door. (See Diagram B.)
- Write down the shortest of the three measurements above — this is your opening height.

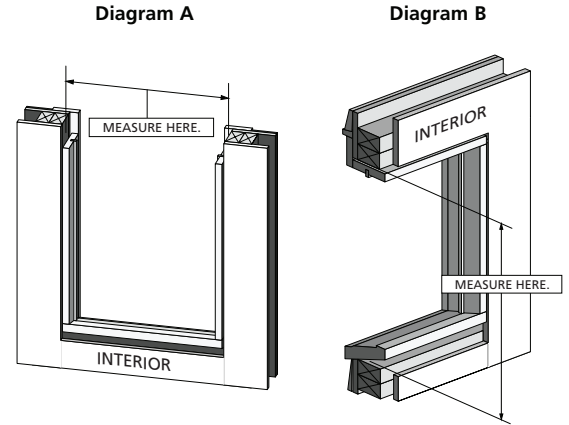

### Option Two: If You Can't Remove the Interior Trim.

#### Step A: Measure the Opening Width.

- Drill a hole in the center of the left side of your old window or door. (See Diagram C.) Drill until you are through the frame, approximately 3/4 in. **Stop drilling when you hit the air pocket and no longer feel resistance.**
- Insert a wire into the hole to measure the depth. (See Diagram F.) Write the wire measurement down.
- Repeat this process, drilling a hole in the center of the right side of your old window or door. Measure the depth of the hole with a piece of wire, and write the measurement down.
- Using a tape measure, measure the opening width of your old window or door. Write the measurement down. (See Diagram C.)
- Add this measurement to the two wire measurements. The total is your opening width.
- Repeat the entire process at the top and bottom sides of the window or door so you have three total width measurements. (See Diagram D.) Use the smallest of the three totals to order your new window or door opening width.

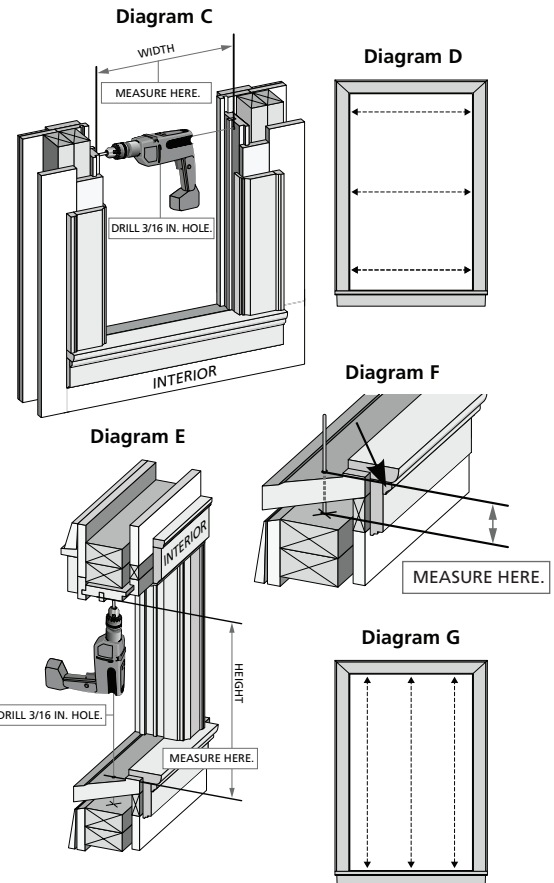

#### Step B: Measure the Opening Height.

- Drill a hole in the center of the top of your old window or door. (See Diagram E.) Drill until you are through the frame, approximately 3/4 in. **Stop drilling when you hit the air pocket and no longer feel resistance.**
- Insert a wire into the hole to measure the depth. (See Diagram F.) Write the wire measurement down.
- Repeat this process, drilling a hole in the center of the bottom of your old window or door. Measure the depth of the hole with a piece of wire, and write the measurement down.
- Using a tape measure, measure the opening height of your old window or door. Write the measurement down. (See Diagram E.)
- Add this measurement to the two wire measurements. The total is your opening height.
- Repeat the entire process for the right and left edges of the window or door so you have three total opening height measurements. (See Diagram G.) Use the shortest of the three totals to order your new window or door opening height.

Left Wire Measurement	Right Wire Measurement	Width Measurement	Opening Width
_____	+	_____	_____
_____	+	_____	_____
_____	+	_____	_____
_____	+	_____	_____
_____	+	_____	_____
_____	+	_____	_____
_____	+	_____	_____
_____	+	_____	_____
_____	+	_____	_____
_____	+	_____	_____

Top Wire Measurement	Bottom Wire Measurement	Height Measurement	Opening Height
_____	+	_____	_____
_____	+	_____	_____
_____	+	_____	_____
_____	+	_____	_____
_____	+	_____	_____
_____	+	_____	_____
_____	+	_____	_____
_____	+	_____	_____
_____	+	_____	_____
_____	+	_____	_____

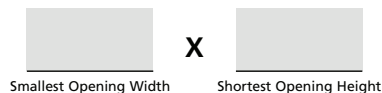



# HOW TO MEASURE

## POCKET REPLACEMENT

With Pella® replacement windows, you save time and money on your window replacement project. Since we make the window to your specific size, you probably won't need to touch your existing siding, wallboard or trim. Plus, when you choose Pella replacement windows, you get the benefits of Pella's quality and performance.

Pella pocket replacement windows are designed to slide easily into the pocket left behind when old window sash come out. There is little mess with this option – existing trim, paint and your home's exterior are usually not disturbed. To use this type of window replacement, the existing frame and sill must be structurally sound.

Use this method to measure for a pocket replacement project (removing sash only) using any Pella® Impervia® or Encompass by Pella™ replacement window, or Precision Fit® double-hung replacement window. For any other aluminum-clad wood window, see your local Pella sales representative for measuring information.

### Step 1: Check the Window for Squareness.

Check the window for squareness by measuring the diagonal dimensions of the opening. (See Diagram A.) *If there is more than a 1/4 in. difference in the diagonal dimensions, the window opening is not square.* If the opening is square, proceed. If it is not square, a full-frame tear-out window replacement may be necessary.

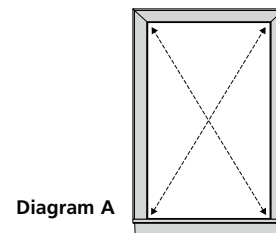

Diagram A

### Step 2: Measure the Height.

Measure the height from the bottom of the sill to the head jamb, between the interior stop and the parting stop. (See Diagram B.) Measure three places: the left, right and middle. (See Diagram C.) Use the shortest dimension to fill in the chart.

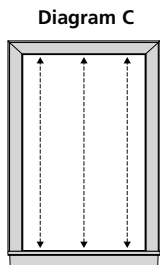
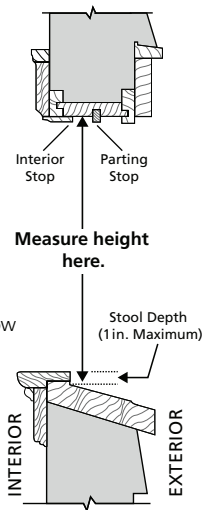

Diagram C

Diagram B:  
Side view of  
existing window  
opening.



### Step 3: Measure the Width.

Measure the width of the opening from the left to the right side, between the interior stop and the parting stop. (See Diagram D.) Measure three places: at the top, bottom and middle. (See Diagram E.) Use the smallest dimension to fill in the chart.

Diagram D: Top view of existing window opening.

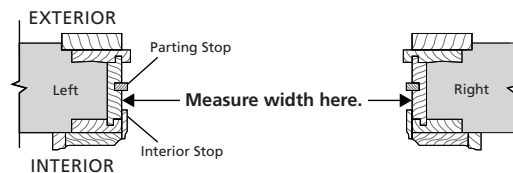
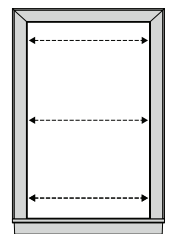

Diagram E



### Measurement Chart

Use the measurements from steps 2 and 3.

Room or Location	Smallest Opening Width	Shortest Opening Height
Window #1 _____	_____ x _____	_____
Window #2 _____	_____ x _____	_____
Window #3 _____	_____ x _____	_____
Window #4 _____	_____ x _____	_____
Window #5 _____	_____ x _____	_____