

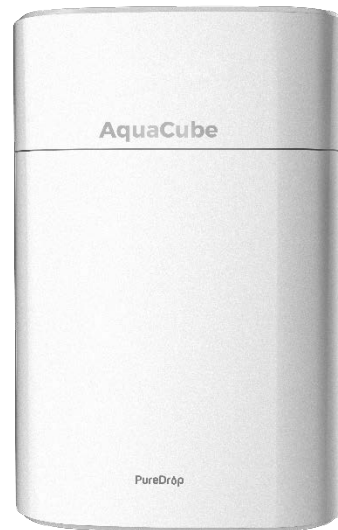

AquaCube Ultra-filtration Water System

Installation and Maintenance Manual

MODEL CUW4



Please read the User's Manual carefully and keep it available.

Product Overview	3
Filter Specifications and Replacement Instructions	4
Filter Indicators	5
Quick Tips	6
CUW4 Installation.....	8
Usage Recommendations	11
Usage Precautions.....	12
Device Specifications	12
Regular Maintenance and Care	13
Troubleshooting.....	14
Warranty	16

Product Overview

This ultra filtration water purifier device is best used for filtering and purifying municipal tap water. The purified water produced by this device is ideal for household use, including cooking and cleaning.

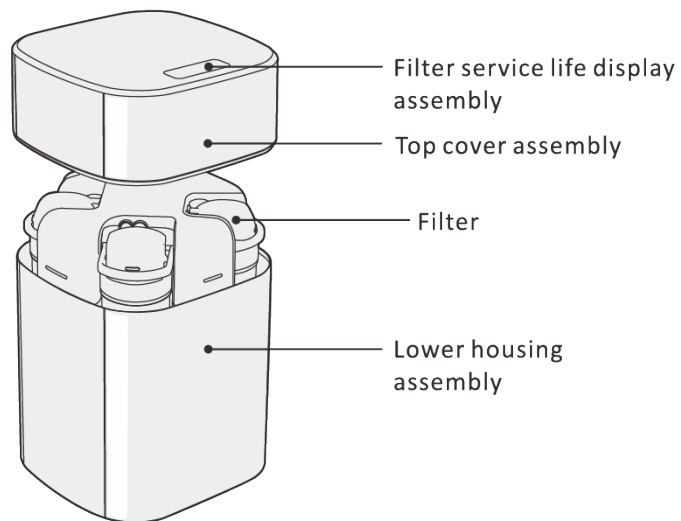

Components:

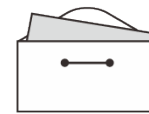

Instructions

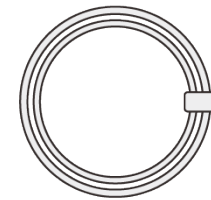

1/4" PE pipe

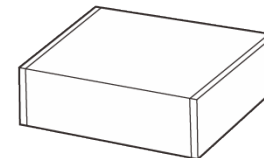

*Faucet accessories box

Remarks:

The faucet accessories box contains one gooseneck faucet, one water inlet ball valve, and eight 2" joint clamps.

Filter Specifications and Replacement Instructions

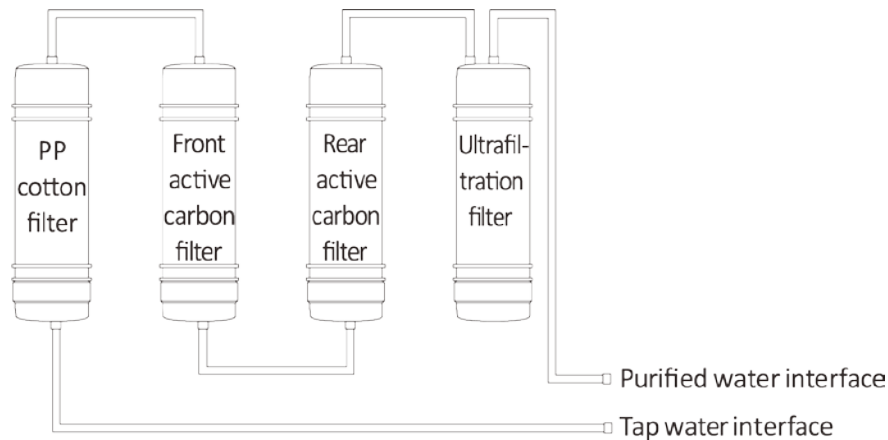

Filter Name	Functions	Service Life	# Pieces
PP cotton filter	Provides rough filtration for raw water and blocks substances visible to the naked eye	4-6 months	1
Front active carbon filter	Absorbs abnormal colors and smells, residual chlorine, and some organics (methenyl trichlorlde, carbon tetrachloride)	6-12 months	1
Ultrafiltration filter	Blocks bacteria (total chloroforms) and substances visible to the naked eye	18-24 months	1
Rear active carbon filter	Absorbs abnormal colors and smells, residual chlorine, and some organics (methenyl trichlorlde, carbon tetrachloride) with better effect	6-12 months	1

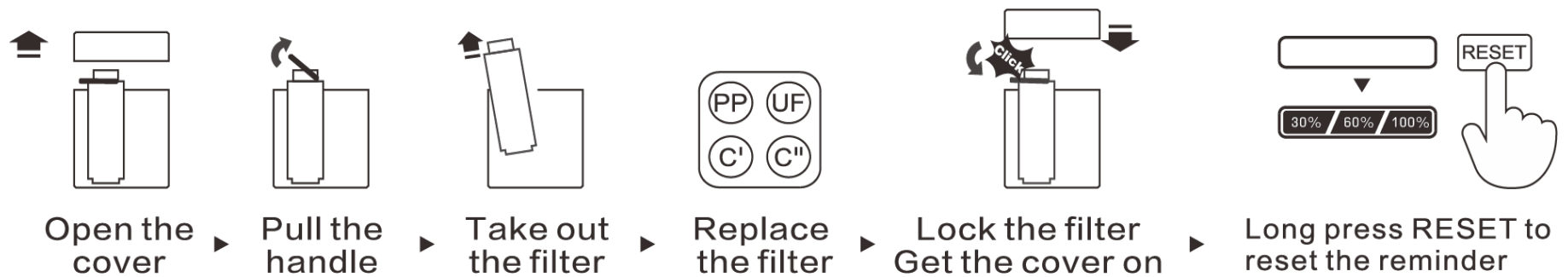

Filter Indicators

The device includes a display that indicates remaining service life on the filter. The service life is only an estimate. The actual maintenance cycle will vary according to geographic location, local water quality, amount of use, and season of the year.

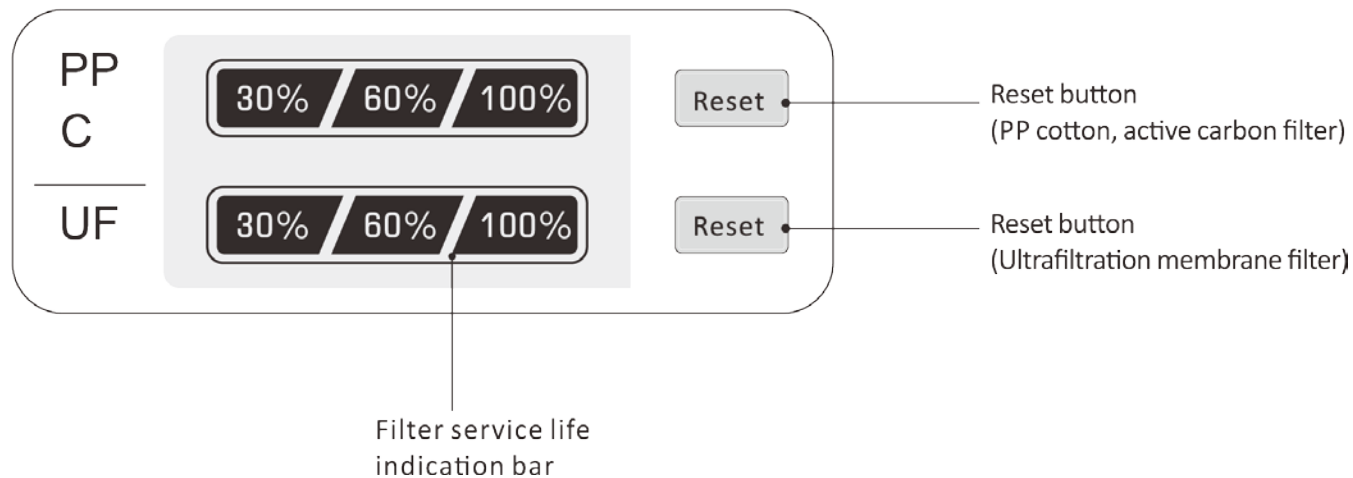

Periodically cleaning and replacing the filter will help maintain water cleanliness and quality. To replace the filter, open the cover, pull the handle, take out the filter, replace the filter, lock the filter, and put the cover back on. Press RESET for a few seconds to reset the reminder.

Quick Tips

Inlet Water Valves of different sizes

Some homes may have a 1/2-inch inlet water valve that is not compatible with the 3/8-inch Feed Water Adapter (AFW). Please get an adapter from your local plumbing store or contact us. If drilling is necessary, make sure that no power or water lines are in the way.

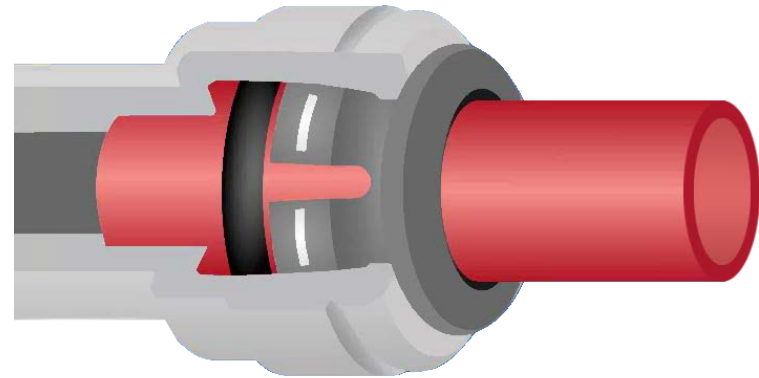

Use of Quick-Fitting

1. Viewing from the open end, a quick-fitting starts with the Collet, Lock Clip (usually blue in color), and Fitting Body.
2. To connect, cut tubing evenly, remove the Lock Clip, push the tubing 1/2 inch into the quick-fitting, and reinstall the Lock Clip. Pull on the tubing gently to make sure it is locked in.
3. To disconnect, remove the Lock Clip and compress and hold down the Collet into the Fitting Body to eliminate the gap where the locking clip was occupying while simultaneously pulling the tubing out.

Note: Watch "RO Quick-Fitting" YouTube videos for your reference.





Drilling a Hole in Sink or Countertop

1. Search "How to Drill a Hole in Granite Countertop" on YouTube for your reference.
2. Choose a 1/2-inch Diamond hole saw for granite and a titanium drill bit for steel.
3. Use a coolant to disperse heat. Choose water for granite or oil for steel.
4. Use a 1-1/2" Suction Base Drilling Ring to hold coolant and prevent drill bit from slipping on the counter.
5. Start slowly. Be cautious, as the power drill might slip and damage the counter surface.
6. Set variable speed power drill at 100-200 RPM.
7. Do NOT use hammer drill on natural stone, glass, and ceramic materials.
8. Hold drill bit vertically and swirl a little to apply pressure evenly in a circular motion.

Be patient and deliberate. It can take 20-40 minutes to drill through one inch.

CUW4 Installation

CAUTION: Improperly installed systems could result in water damage due to leaks or flooding. If you are not familiar with standard sink plumbing systems and the proper use of common hand and power tools or have any difficulty with the installation of this system, please consult a licensed professional, such as a contractor or plumber.

Preparation

Location:

This water filter can be installed anywhere that has a proper cold-water supply, such as under the kitchen sink, behind the refrigerator, next to your aquarium, inside your RV, etc.

Tools needed:

1. 3/8 inch and 1/4 inch wrenches or adjustable wrench
2. Phillips and flathead screwdrivers
3. A pair of scissors or a utility knife
4. Bucket and towel to catch water drips
5. Variable speed power drill with 1/2 inch steel or marble hole saw bit if a hole needs to be drilled in the counter

Installing the Feed Water Adapter

1. Turn off your Inlet Water Valve (COLD), and open the kitchen faucet to release water pressure.
2. With a towel or bucket underneath, disconnect the faucet's water hose from the Inlet Water Valve using the 3/8-inch wrench, and install the Feed Water Adapter (AFW) between them. Make sure the rubber washers are still in place. It is usually not necessary to use Teflon tape here. Tighten the hex nut by hand and use the wrench for the final 1/4 - 1/2 turn. Do not over tighten.



3. Install the ¼-inch tubing on the Feed Water Adapter using the ¼-inch wrench. Tighten by hand, then use the wrench to tighten another half- to one turn. If you received the Feed Water Adapter with quick-fitting, simply insert the tubing ½ inch deep into the fitting. It will lock automatically.



Installing the drinking faucet

1. If your kitchen sink does not have a spare ½" hole, you will need to drill one. (Refer to Quick Tips for Drilling a Hole in Sink or Countertop). Wipe clean and dry the area.

2. If there is a blue protection film on the Front Plate, remove it. Slip the Front Plate with black rubber washer onto the faucet stem. Insert the faucet stem into the hole on the counter. Optionally, plumber's glue or sealer could be used.
3. Under the sink, slip on the Back Washer, and tighten the Wing Nut.



Installing the tubing (check Quick Tips for Use of Quick-Fitting)

1. Connect tubing with AFW to the “Water In” port of the system.
2. Install quick-fitting to the faucet.
3. Connect tubing with faucet to the “Water Out” port of the system.

**Make sure you remove the Lock Clip when inserting the tubing.
Reinstall the Lock Clip after the tubing is inserted.



System startup

1. With a towel or bucket underneath, slowly turn on the Cold Water Valve, and feel the vibration and noise of the water flow. If your water pressure is high, DO NOT turn the Inlet Water Valve all the way up, but sparingly to a level position.
2. If it leaks, check if the tubing is fully inserted into the quick-fitting and that the cartridges are properly in position.
3. Turn on the Drinking Faucet. Water should start flowing. Let it run for 5-15 minutes or until all of the carbon particles are flushed out and the water turns clear. The water filter is now ready for use. Write down the current date on the cartridge for future reference. The cartridge set has a capacity of **1,100** gallons or a life span of about **6-9** months depending on water quality and usage.

Usage Recommendations

- This device will work best at a pressure range of 15-60 psi. It's normal for the device to vibrate and make a light noise when producing water.

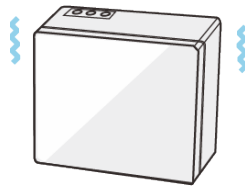

- If the device won't be used for an extended period, shut off the power supply and close the three-way valve. Allow the water to run for 3-5 minutes before using again.



- A pretreatment device may be installed in front of the main device if the incoming water doesn't meet municipal standards (i.e., high quantities of mud and sand, residual chlorine, etc.)

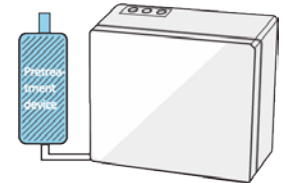

- An additional device to increase or lower pressure may need to be installed if the water pressure is higher or lower than the recommended level. Note: When the environment temperature is low, the flow rate will naturally drop.

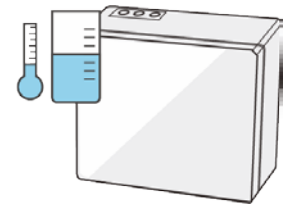

- If the device appears to be faulty, cut off the water supply immediately and call iSpring at 678-261-7611.

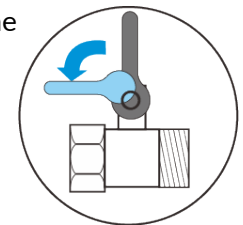

Usage Precautions

In order to ensure safe use and prevent accidents, physical injury, and possible property loss for you and others, please follow these precautions.

- When there isn't water supply or the pipe is under repair, turn off the three-way valve. After reconnecting the power supply, turn on other faucets to drain out sand and mud before turning the three-way valve back on; otherwise, the filter may become jammed.

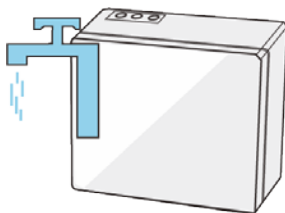

- Do not expose the device to direct sunlight, temperatures lower than 32°F, strong magnetic objects, a damp or dusty environment, combustible or volatile substances, heat sources, or open flames.

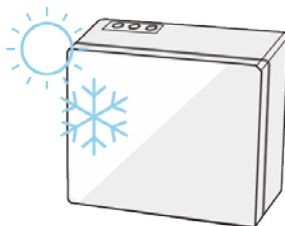

- Do not place heavy objects on the device.

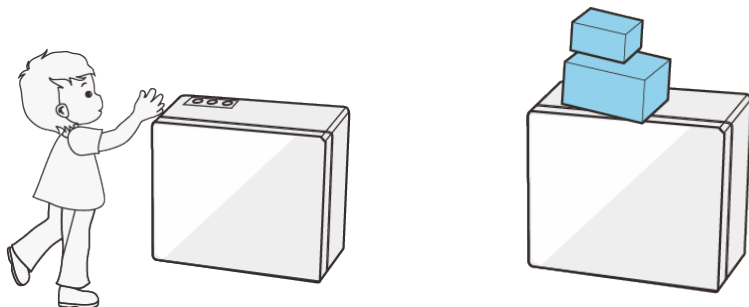

- Supervise use of the device by children and others as needed.
- Only use authorized accessories provided by iSpring.

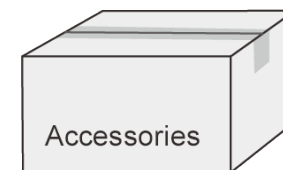

Device Specifications

The purified water flow rate is tested when the environment temperature is 77±2°F, water temperature is 77± 1°C, and water inlet pressure is 35± 3psi.

The rated total water capacity is tested according to QB/T 4143 and QB/T 4144.

Rated general purified water flow rate	800 gal
Purified water flow rate	0.32 gpm
Working pressure	15-60psi
Applicable water quality	Municipal tap water
Working temperature	40-100°F

Regular Maintenance and Care

Regular maintenance of the device and filter replacement can help ensure the quality of water output.

When cleaning the product, do not use soap, detergent, or a strong volatile solvent such as thinner, gasoline or alcohol. Use of these substances may crack, scratch, or change the color of the device.

Do not directly spray water on the device.

Regularly check for water leakage surrounding the device or the water outlet faucet.

Check to make sure the water pipes are fixed tightly.

Do not put the product in a declining, horizontal, or upturned position.

Do not use the product in an environment lower than 32°F.



Troubleshooting

The following are common issues that you should be able to resolve on your own. If these measures don't work, please call iSpring at 678-261-7611.

Issue	Possible reasons	Solution
Water purifier generates mild noise when in use	This is normal during the purifying and filtering process.	None needed
Water volume drops significantly	Filter is jammed	Flush or replace the filter.
	Filter has not been replaced in a timely manner and/or has exceeded its service life	Replace the filter.
	The ball valve or faucet is not completely turned on	Check water inlet ball valve and make sure that the faucet is completely turned on.
	Purified water in the water storage tank is used up	Wait for the device to produce water and use it about 1/2 hour later.
Water quality is poor	Faulty filter	Contact iSpring at 678-261-7611 for replacement filter.

	Device hasn't been used for more than three days	Turn on the purified water faucet and flush it for 3-5 minutes.
	Poor quality of water source	Confirm that water source is municipal tap water.
Water leakage	Component is damaged	Cut off water and power supply, and call iSpring at 678-261-7611.
No water output after replacing filter or, after recovering tap water, water purifier doesn't output water	The pipe or water filter is jammed	Remove any obstacles from the pipe. Replace jammed filters and try again.

Warranty

This Limited Warranty extends to the original purchaser of the system only. This warranty covers all Manufacturer-supplied items only that prove to be defective in material, workmanship, or factory preparation. This warranty covers parts only; all labor is excluded from this warranty, including, but not limited to, services related to the removal, replacement, installation, adjustment, maintenance, and/or repair of the unit or its components items. excludes all non-Manufacturer labor required for any servicing of the unit, including, but not limited to, servicing related to installation, adjustment, maintenance, and repair of the unit. This warranty applies only for the first full calendar year from date of purchase. The following items are excluded from this warranty: membranes, filters, O-rings, and all other parts or components that require regular replacement as a result of ordinary usage.

Disclaimers: This Limited Warranty applies only if the system is installed, used, and maintained in compliance with all instructions and requirements enclosed with the system. This warranty will be void for failure to observe the following conditions:

1. The system is to be used with potable water supply only.
2. Feed water pressure to the unit is no less than 40 PSI (30 PSI for systems with built-in booster pump) and no greater than 80 PSI.
3. The system is to be used on water supplies with chlorine concentrations of 1.0 mg/L (ppm) or less.
4. Feed water temperature to the unit must be no less than 40°F and no more than 100°F.
5. Total dissolved solids (TDS) in feed water must be less than 750 mg/L (ppm).
6. Feed water must have a pH between 4 and 8.
7. Turbidity must be less than 1.0 NTU.
8. SDI must be less than 5.
9. Feed water must be completely free of iron, manganese or hydrogen sulfide.

While the testing was performed under standard laboratory conditions, actual performance may vary. The Manufacturer does not know the characteristics

of your water supply. The quality of water supplies may vary seasonably or over a period of time. Your water usage may vary as well. Water characteristics can also change if the drinking water appliance is moved to a new location. The Manufacturer assumes no liability for the determination of the proper equipment necessary to meet your requirements, and we do not authorize others to assume such obligation on our behalf.

This Limited Warranty does not cover any Manufacturer-supplied items that are defective as a result of the use of improper parts, equipment or materials. This warranty does not cover alterations or modifications of the unit or failure of a unit caused by such alterations and modifications.

This Limited Warranty does not cover malfunctions of the unit due to tampering, misuse, alteration, lack of regular maintenance, misapplication, fouling due to hydrogen sulfide, manganese or iron, scaling from excessive hardness, turbidity greater than 1.0 NTU, Silt Density Index (SDI) greater than 5.0 SDI, or excessive membrane hydrolysis due to chlorine levels in excess of 1.0 mg/L (ppm). In addition, damage to the unit due to fire, accident, negligence, act of God, or events beyond the control of the Manufacturer are not covered by this warranty.

Incidental and Consequential Damages Limitation: The Manufacturer will not be responsible for any incidental or consequential damages as a result of the failure of this unit to comply with express or implied warranties or any defect in the unit, including but not limited to, lost time, inconvenience, damage to personal property, loss of revenue, commercial losses, postage, travel, telephone expenditures, or other losses of this nature. In case some states do not allow the exclusion or limitation of incidental or consequential damages, you may choose to return the system. If you choose to keep it, you insist this exclusion STILL apply to you.

Owner's Warranty Responsibilities: As a condition of this Limited Warranty, the owner must ensure that periodic maintenance of the system is performed as described in the literature enclosed with the system. Neglect, improper maintenance, abuse, modification, or alteration of the unit will invalidate this Warranty. Should your unit develop a defect or otherwise fail to perform in accordance with this warranty, you should contact the retailer from whom the product was originally purchased.

Implied Warranties: The implied at-law warranties of merchantability and fitness for a particular purpose shall terminate on the date one year after the date of purchase.

NOTE: IN CASE SOME STATES DO NOT ALLOW LIMITATIONS ON HOW LONG AN IMPLIED WARRANTY LASTS, YOU MAY CHOOSE TO RETURN THE SYSTEM. IF YOU CHOOSE TO KEEP IT, YOU AGREE THAT THE ABOVE LIMITATIONS STILL APPLY TO YOU.

Warranty Registration

We provide a 30-day money back guarantee, one-year Manufacturer Warranty and lifetime tech support for all of our products.

However, we do not have your order information from the vendors other than our website.

The easiest way to activate the warranty is to go to www.123filter.com, and submit your warranty registration under “Warranty Registration”.

You can also email the following information via email to support@123filter.com, along with your comment.

PureDrop Warranty Registration	
Your Name:	
Your E-Mail:	
Your Phone:	
Order#:	
Model#:	
Order Date:	
Reviewer ID:	
Notes:	

Please remember, we love to help our customers. If you have any questions or concerns about our products, please don't

*hesitate to **call** or **email** us. We will do everything we can to make your purchase a 5-star experience.*

678-261-7611 support@123filter.com

*If you are happy with our product and service, please show your support by writing a product **review** on the website you*

purchased from, even if it's just a single line. It takes you just a minute, but means a lot to us. Thank you!



Local / International: 678-261-7611

Office Hours: Monday-Friday 9:00 a.m. – 5:00 p.m. EST

Technical Support Hours: Monday-Friday 9:00 a.m. - 5:00 p.m. EST

ISPRING WATER SYSTEMS, LLC

Atlanta, GA USA