

PRODUCT INSTRUCTIONS

Thank you for choosing our products.

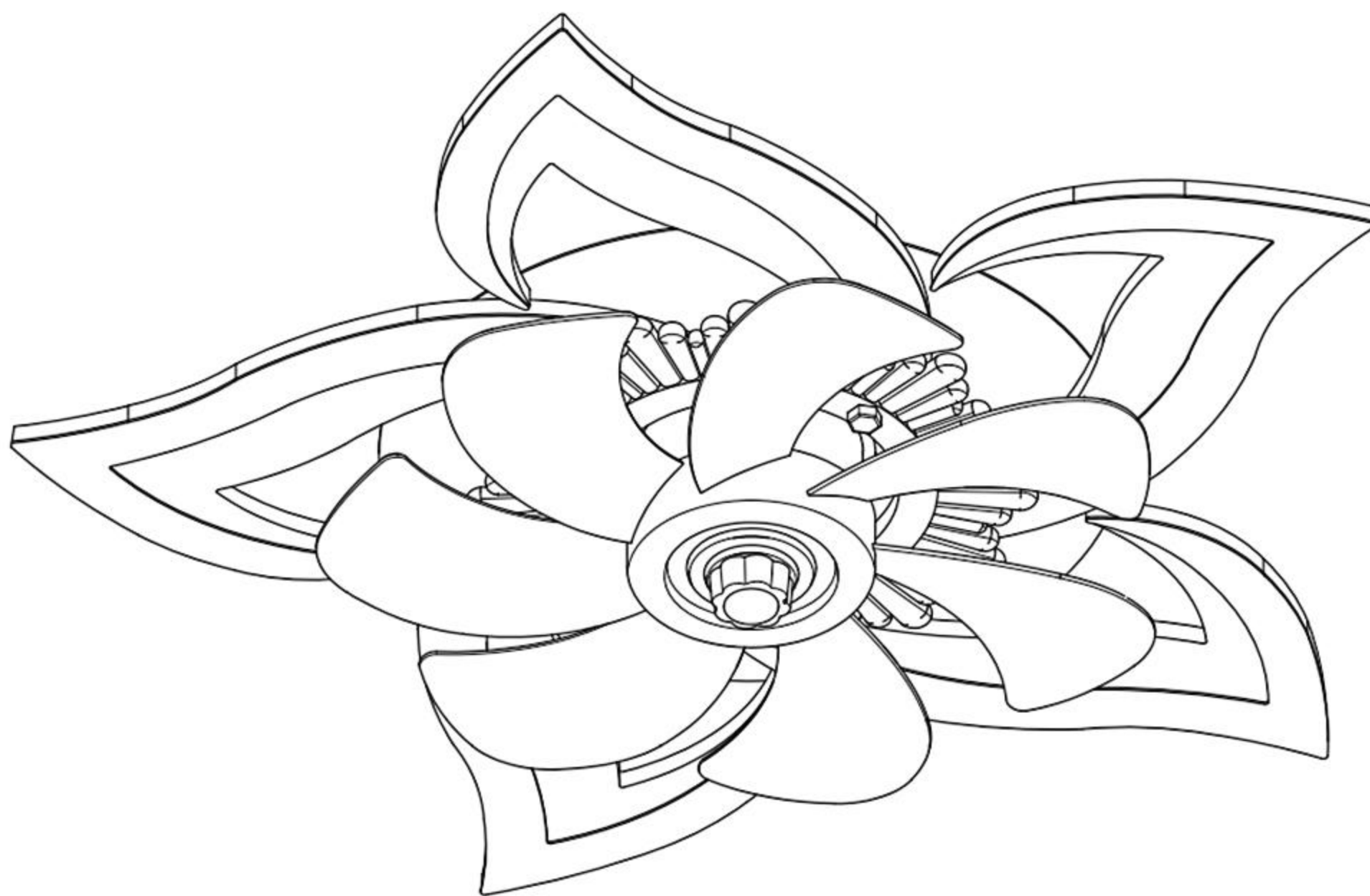

RW-6828

(Please read carefully before installation)

TABLE OF CONTENTS

01	Thank you letter... ..	01
02	Product display and description... ..	02
03	Text annotation... ..	03
04	Remote Control Instructions... ..	04
05	Installation video tutorial... ..	05
06	Authorized certification... ..	06
07	Thanks again... ..	07
08	Statement... ..	08

THANK YOU FOR YOUR CHOICE

First of all, thank you for choosing our products. I hope you and your family can spend every holiday happily and comfortably in a busy summer. We still need you to provide us with suggestions for our growth. Thank you for your support so that we can play better.

Your understanding and trust is our strong driving force for progress, your concern and support is our inexhaustible source of growth. Every time you participate in, every suggestion, let us excited, we constantly forge ahead. The journey with you, our progress is endless confidence and strength; With you, our cause can be immortal, prosperity and development. In the next years, hope to be able to continue to receive you and all consumers trust, care and support, welcome you and all the consumer advice and criticism to us, we will with the sincerity, honesty, sincerity and passion to serve every customer.

Customer satisfaction is our eternal pursuit! We will continue to provide you with the most sincere service, and constantly strive to "no best, only better" !

Once again thank you for your trust and support!

I wish you good health! A happy family! Prosperity! All the best! advance Salute !



2.Product display and description

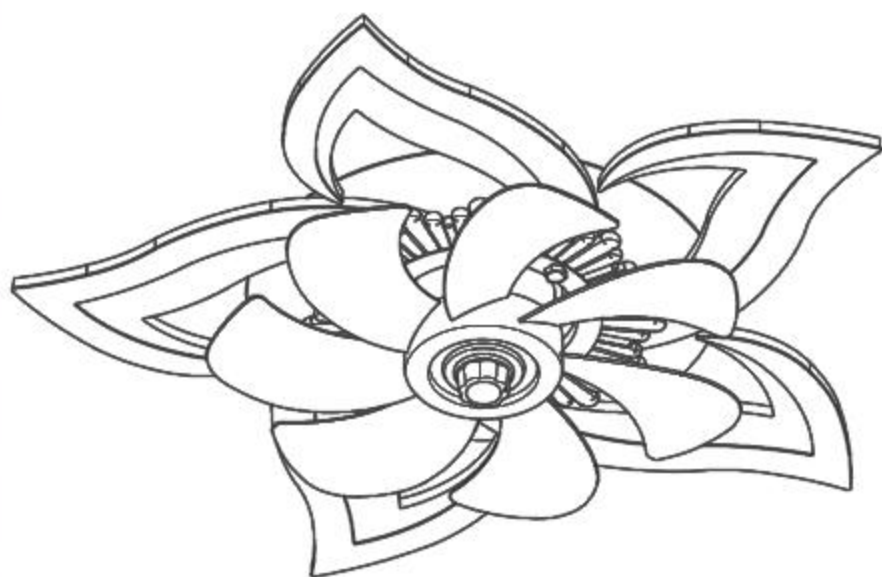
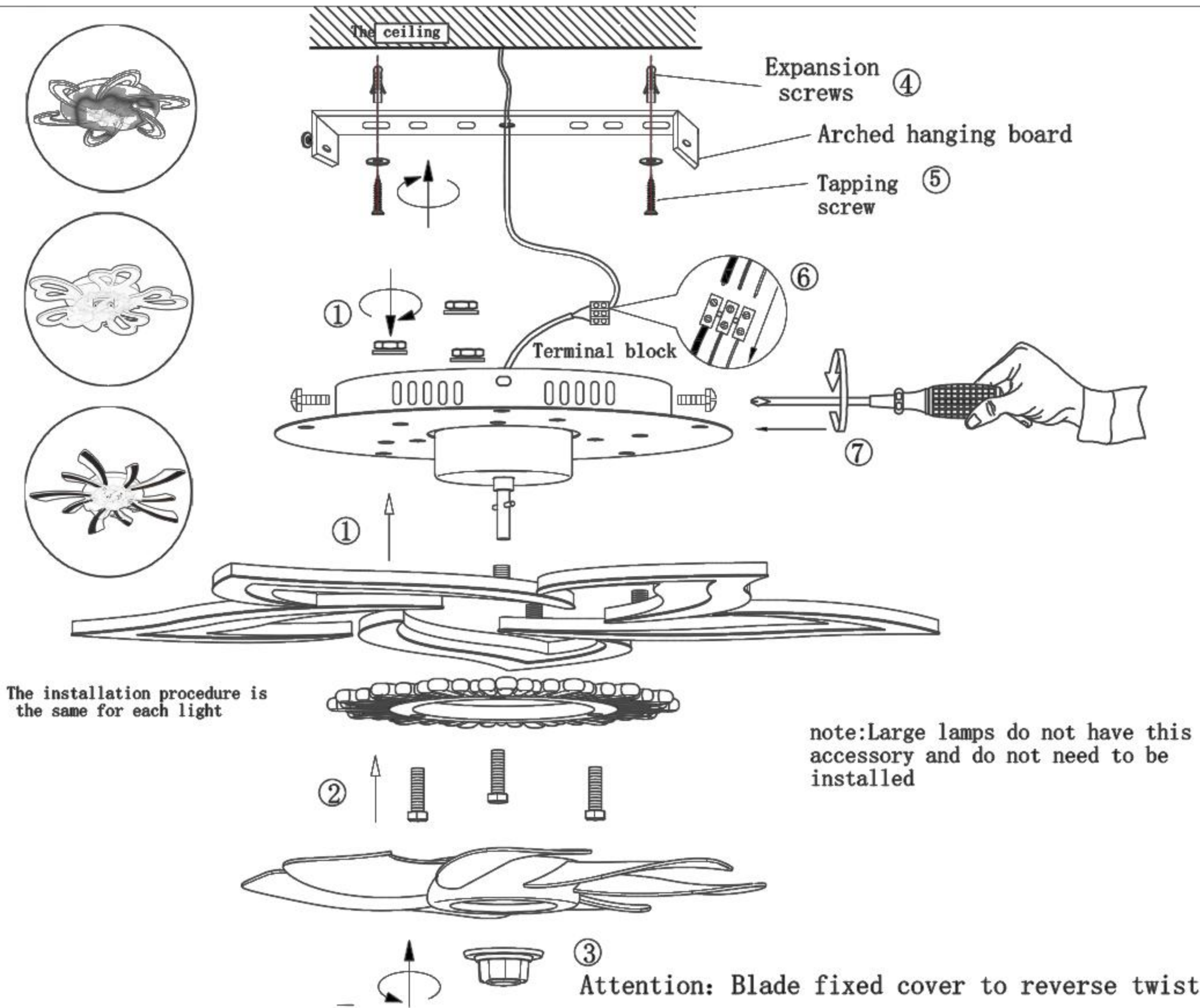

Effect picture after installation

This is the central point of the lamp

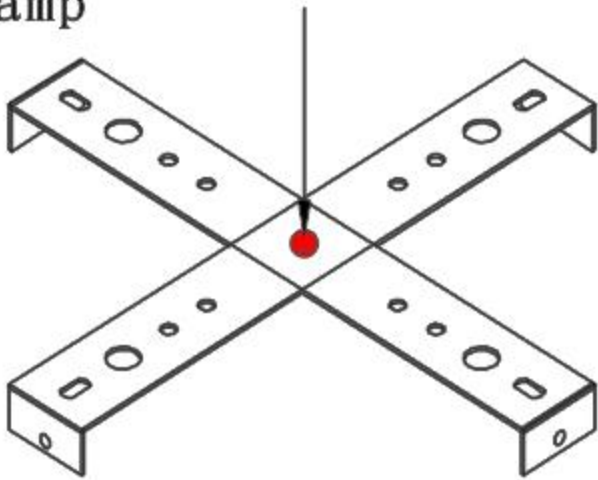

Schematic diagram of cross hanging plate

3.Text annotation

Thank you for purchasing our products.
Attention: for your safety, please entrust
a professional person to install



- (1) : all power supply shall not exceed the specified range (rated voltage AC220V/AC110v, 50Hz, Support global voltage standard, can convert your country's standard voltage)
- (2) : do not install lamps in the unstable ceiling or open air;
- (3) : do not install lamps above high temperature objects or wet places;
- (4) : in order to ensure safety, if there is any problem with lamps, please entrust professional personnel to carry out maintenance;

Installation steps:

- (1) : before installation, the whole lamp shall be tested for lighting, and the appearance of the lamp shall be checked for damage (2) : fix the arched hanging board on the ceiling with expansion screws;
- (3) : when installing, please wear gloves to avoid damaging the surface of lamp body;
- (4) : take down the test wire outside the terminal block of the lamp body and connect it to the main line;

(L-live; N-null; \perp -earth)

- (5):Lock the lamp body with screws and bow hanging plate (with a magnetic cross screwdriver)
- (6):Please use the remote control according to another manual.

Please try to light up before installing



Before installing the lamp, please check whether the circuit is falling off or in poor contact. Please connect the wire first, and then power on for testing. After power on for testing, check if it is in good condition and then install it.

4.Remote Control Instructions

Turn off lights and fans/Always close

ALL OFF

The light is on/off

LIGHT ON/OFF

Fan is turned

F

Fan reversal

R

The wind class

3

2

4

1

5

6

Close the wind fan

FAN/OFF

Regulating fan wind speed

1H

2H

4H

Timing off fan

1H

2H

4H



APP download

Turn off lights and fans/Always close

ALL OFF

The light is on/off

LIGHT ON/OFF

Close the wind fan

2

3

4

5

6

Regulating fan wind speed

1

2

3

4

5

6

Fan is turned

F

Fan reversal

R

The wind class

1H

2H

4H

Timing off fan

1H

2H

4H



APP download

Turn on the controller, then you will hear a sound "Di". Press "FAN" within 2 minutes till you hear the sound "Di Di". Check code is done. If not, turn off the controller, and repeat it after 1 minute.

IF THE REMOTE CONTROL CANNOT BE EFFECTIVELY CONTROLLED, PLEASE CHECK THE BATTERY, AND REMOVE THE BATTERY IF NOT IN USE FOR A LONG TIME.

Matters needing attention:

- 1.Receiver can not be mounted on the plane to avoid affecting the unevenness of the cover and ceiling.

2.Receiver sub-inputs and outputs are strictly prohibited from adjusting input and output pairs.

3.The working voltage of this product: **AC 180-265V**

4.If there is a wall switch on the fan,it must be on to control effectively.

5.Wiring should be done according to the color of the wire and the instructions on the sleeve.

6.When using the remote control,please check whether the battery is installed or not.Pay attention to the positive and negative poles of the battery.The control key of the handle flashes every key that is pressed

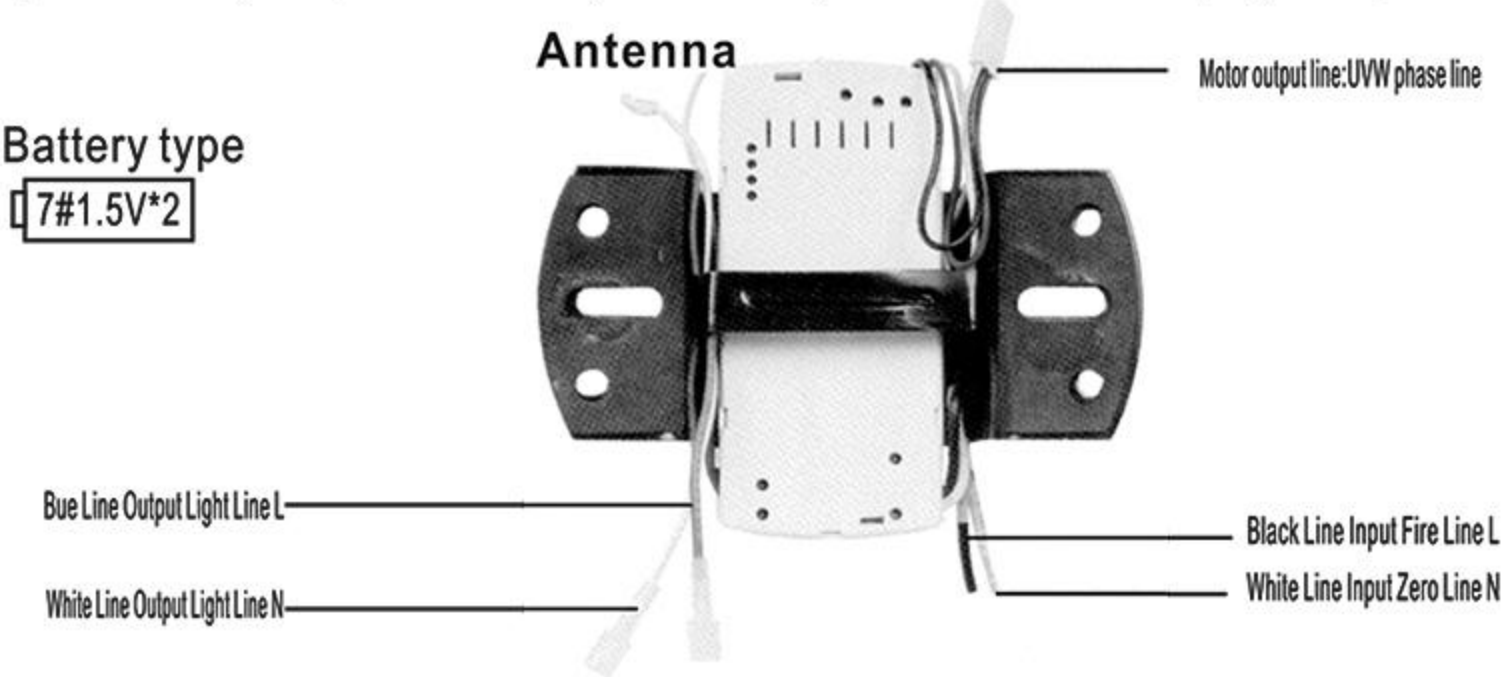

5.Installation video tutorial



Scan the QR code to watch on YouTube



6. Authorized certification



7.Thanks again



My friend, the weather can be very hot sometimes.
When you go out, you should pay attention to
heatstroke prevention. I wish you and your
family a happy day.If you have any questions,
you can consult us. We are very happy to
hear your voice.



STATEMENT

- ❶ This manual is as comprehensive and detailed as possible on the basis of the existing information, but the company reserves the right to modify the information in the manual without prior notice.
- ❷ If there is any discrepancy between the picture and the actual product, the actual product shall prevail.
- ❸ Since the information in this manual may still be changed after printing, please ask your dealer for the latest information.