

Contemporary Barn Door Pull Instructions

Read this guide thoroughly before installation and follow the instructions. This product is designed for lightweight interior doors. Do not use it on exterior or heavy metal doors.

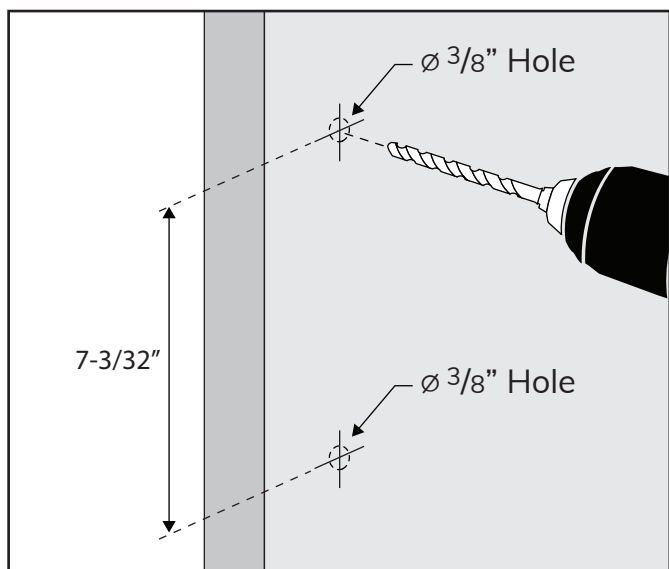

Mark the mounting holes $7"$ apart center on center and drill (2) $\frac{3}{8}"$ diameter holes as shown in the illustration below.

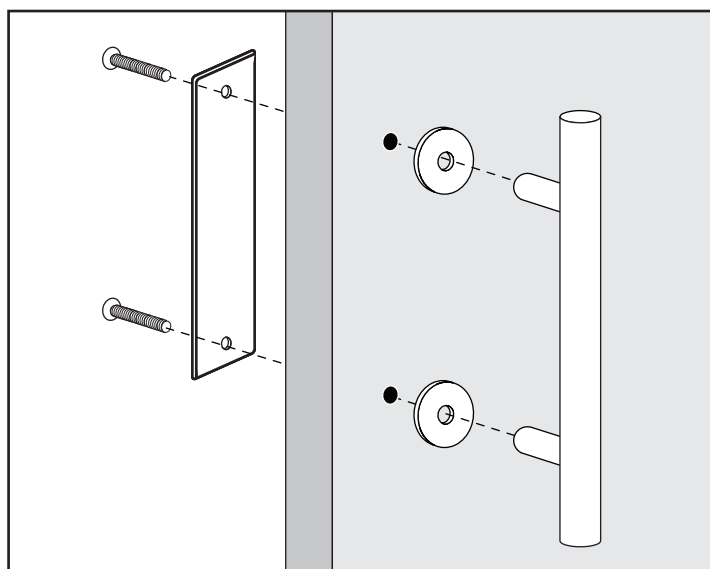

Insert the (2) M8x60mm screws through the square flush plate and install through the door and secure the handle on the exterior.

