

# Laurel Mountain

4-Piece Shower (Handed by Seat)

6030SH 1 S4PSL

6030SH 1 S4PSR



## **ALMEDIA** INSTALLATION GUIDE

## Tools and Materials for Proper Installation

- Drill
- Screw Driver Bit
- Drill Bit
- Screw Driver
- Mildew Resistant Silicone Caulking
- Pencil
- Framing Square
- Level

Please consult all local and state building codes and read the entire installation instructions prior to beginning the installation of this unit to ensure that the final installation is performed correctly.

▲ **IMPORTANT** - Upon receipt, inspect the shower for fit, finish and any damage or defect.

Do not remove the Medallion Identification Number. Doing so may affect the warranty.

This number may be found above the drain, left or right corner of unit.

Laurel Mountain's 4-piece showers are to be stored in a dry area prior to installation to prevent moisture from attacking the reinforcement material which could cause warping of the unit.

This unit ships assembled to reduce the potential of shipping damage.

To disassemble the unit: Remove shipping packaging, then remove the wing nuts that secure the walls to the base.

## Framing The Pocket

Frame a square and plumb pocket to dimensions of the unit. It is suggested that the floor be clear and level.

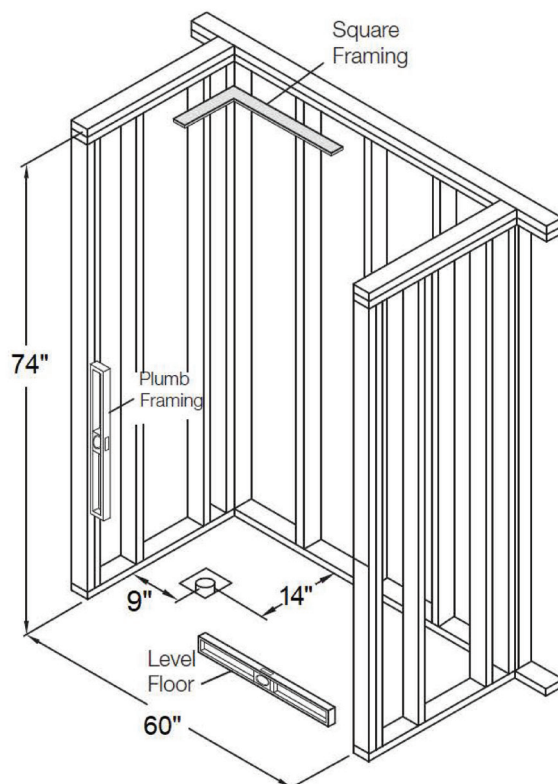

Figure 1

▲ **NOTE:** Accommodations should be made in the pocket dimensions for any accessories attached to the unit.

## Installing The Base

Set the base of the unit into the framed pocket and plumb and level it. Shims may be placed under the leveling legs to make the unit plumb and level. Install all plumbing fixtures for the unit, making sure not to over-tighten them. Check the drain and make sure that it is sealed properly and not leaking. Use appropriate size shims to fill any gaps between the flange at the top of the base and the framing (See note on Figure 2). When the unit is plumb and level and any gaps are shimmed, secure the unit to the framing with galvanized nails or screws (pre-drilling holes is recommended). Secure the vertical flanges every 6" or as necessary to keep the flanges flush to the studding. Secure the horizontal flanges wherever they come into contact with the studding.

**In an application where the unit is installed over wall board, trim/molding will be required to conceal the flanges, for best results your fasteners will need to be flush with the nailing flange. Laurel Mountain recommends centering and counter sinking a corrosion resistant fastener on the nailing flange. Raised fasteners will result in a problematic finishing process of the trim kit.**

Laurel Mountain's Products are designed to be self-supporting. The floors of our products are lab certified to withstand a point load of 300 pounds to ensure a quality product. In cases where any occupant of the home meets or exceeds 300 pounds in weight, we recommend that the unit be installed on a bedding material of cement or casting plaster. Use of a bedding material is required if the unit is being installed in a high use facility. (ie: dormitory, locker room, nursing home, motel, hotel etc.) For standard installations, the use of a bedding material is optional and done at the discretion of the customer. If a bedding material is used, be sure to place a moisture barrier such as plastic, between the bedding compound and the unit. Laurel Mountain recommends using Gypsolite® or Structo-lite® plasters for a bedding material.

### ▲ FOAM SHOULD NEVER BE USED AS A BEDDING MATERIAL

## Unit Flange Attachment

- ▲ Vertical Flange - Attached 6" On Center
- ▲ Horizontal Flange - Attached Every Stud

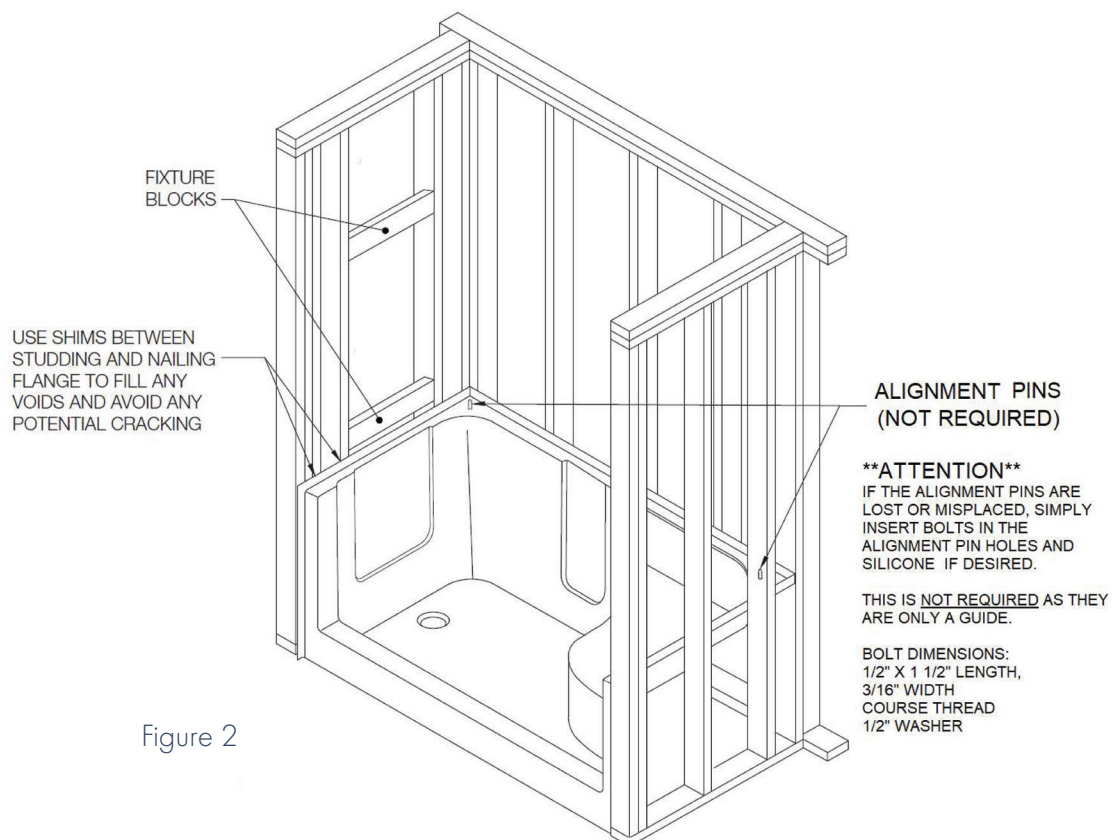

Figure 2

## Back Wall Installation

Locate the back wall section. You can perform a dry-fit of the wall section to the base to check fit and ensure things line up and then remove panel for preparation.

Before installing the back wall, clean seam, then apply a bead of silicone caulking (not latex caulking) on the seam that will be between the base and back wall. If alignment pins are used, Be sure that the bead goes in front of the Pins on the base.

(Figure 3) Guide the back wall section onto the installed base section. **Make sure that the back wall section is plumb. Use shims to get it plumb if needed. The side wall sections will not install correctly if the back wall is not plumb.** Once the back wall section is plumb and seated properly on top of the base section, secure the back wall section to the studding. Secure the vertical flanges every 6" or as necessary to keep the flanges flush to the studding. Secure the horizontal flanges wherever they come into contact with the studding. Verify again that the wall section is plumb.

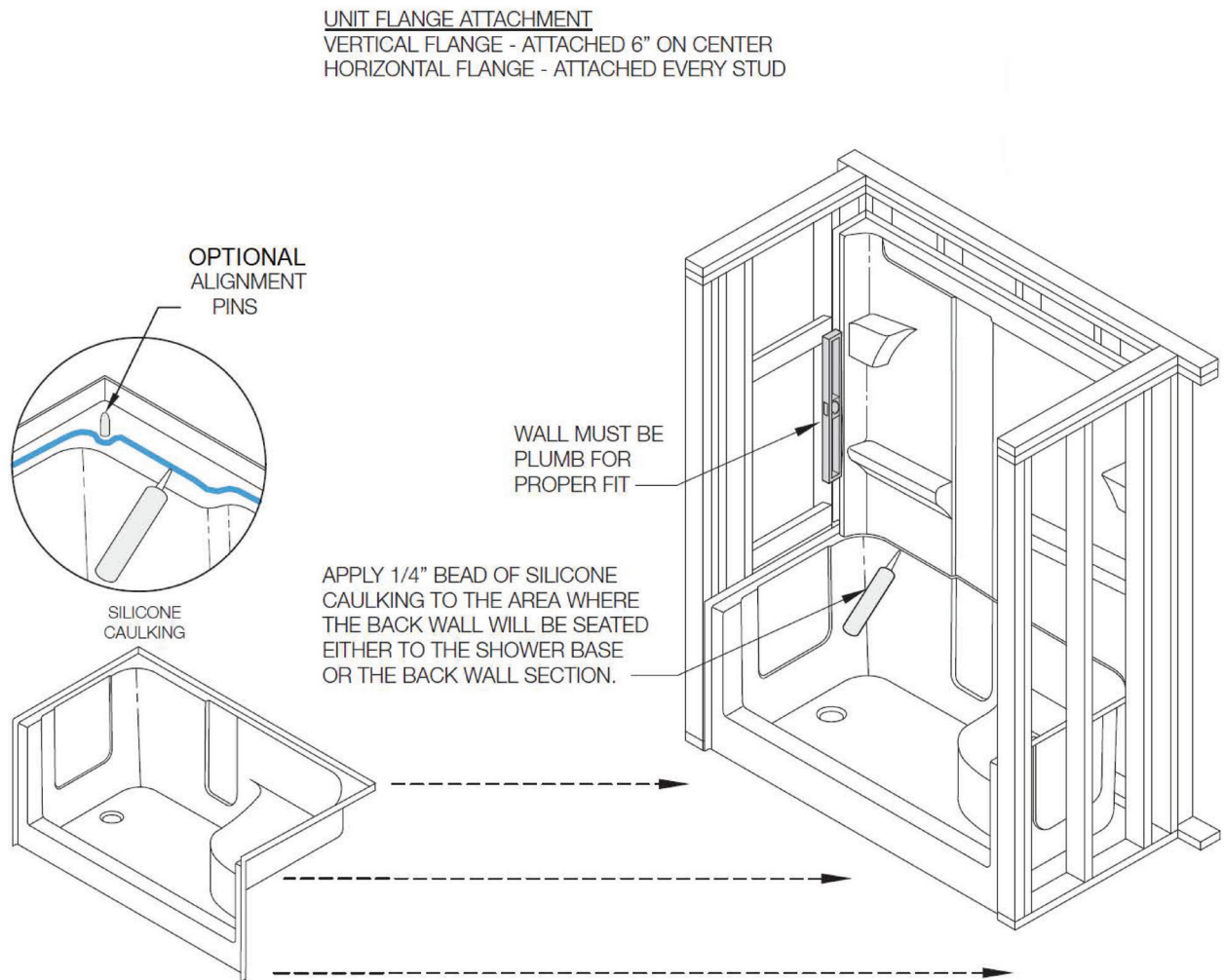

Figure 3

## Left Hand Wall Installation

Locate the left hand wall section of the unit. The side walls are designed to be easy to install from the front of the unit. You can perform a dry-fit of the wall section to the base to check fit and ensure things line up and then remove panel for preparation. Clean seams then apply a bead of silicone caulking (not latex caulking) on the seam that will be between the base and the side wall & the side wall and the back wall Figures 4.1 & 4.2. Once the left side wall section is seated properly on top of the base section, secure the side wall section to the studding. Secure the vertical flanges every 6" or as necessary to keep the flanges flush to the studding. Secure the horizontal flanges wherever they come into contact with the studding.

Repeat this process for the right hand wall section.

▲ **Note:** If installing the unit under drywall, see Fig 4.3. Installation over drywall, see Fig 4.4.

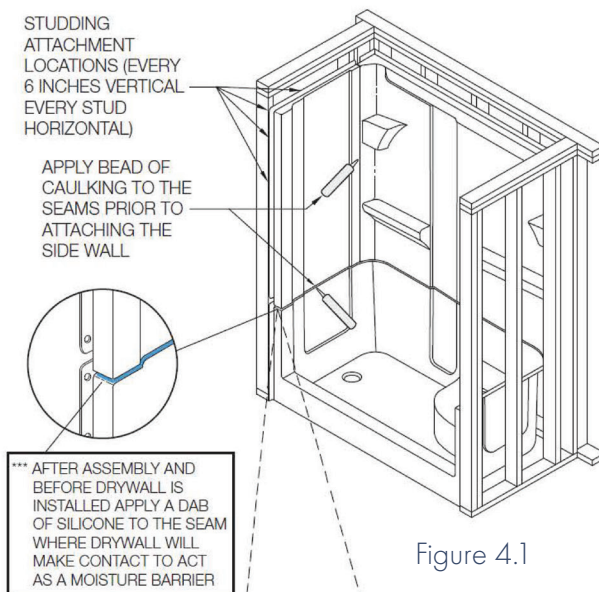

Figure 4.1

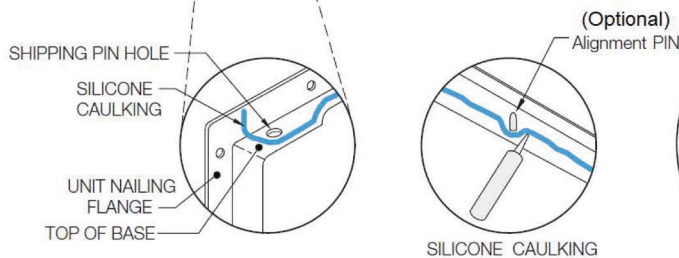

Figure 4.2

APPLY ABOUT A 1/4" BEAD OF SILICONE CAULKING AT THE FRONT EDGE OF THE BASE AND PARTIALLY UP THE NAILING FLANGE.

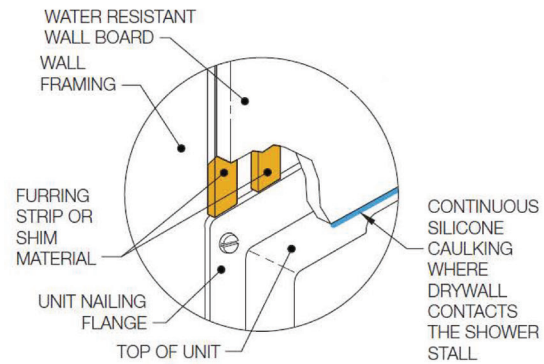

Figure 4.3

Detail at Top of Unit  
(Installed under drywall)

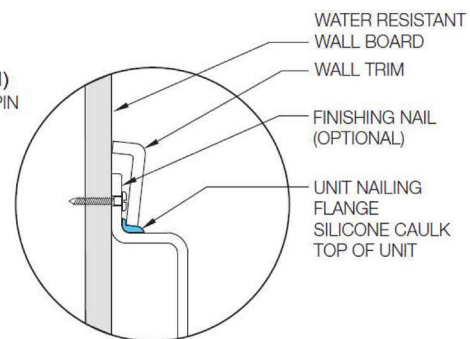

Figure 4.4

Section at Top of Unit  
(Installed over drywall)



Customer Service: 800-930-0050 • [laurelmountain.com](http://laurelmountain.com)