



**Decree®**  
33" top-/undermount single-bowl kitchen sink  
**K-R28204-2**

### Features

- 36" (914 mm) minimum base cabinet width
- Single bowl
- Two faucet holes
- 9" (229 mm) depth provides generous workspace
- Tightly angled fabricated corners maximize bowl space
- SilentShield® sound-absorption technology offers quieter performance
- Rear drain placement increases cabinet storage space underneath sink
- Box includes: Sink, sink rack, strainer, installation hardware



### Material

- Premium 18-gauge stainless steel
- KOHLER stainless steel sinks resist corrosion and tarnishing

### Codes/Standards

ASME A112.19.3/CSA B45.4

### Installation

- Top-mount or undermount

### Recommended Products/Accessories

K-23729 Stainless steel cleaner  
K-23726 Drain treatment

### KOHLER® Stainless Steel Sinks Lifetime Limited Warranty

See website for detailed warranty information.

### Optional Products/Accessories

K-11352 Disposal Flange with Stopper  
K-6667 Wood Cutting Board  
K-28929 Roll-up multipurpose rack  
K-5473 kitchen sink utility rack  
K-6379 Kitchen Squeegee

### Included Components

K-6644 Sink rack for Vault™ and Strive® kitchen sinks  
7400 Stainless Steel Sink Drain and Strainer  
91915 Hardware Kit

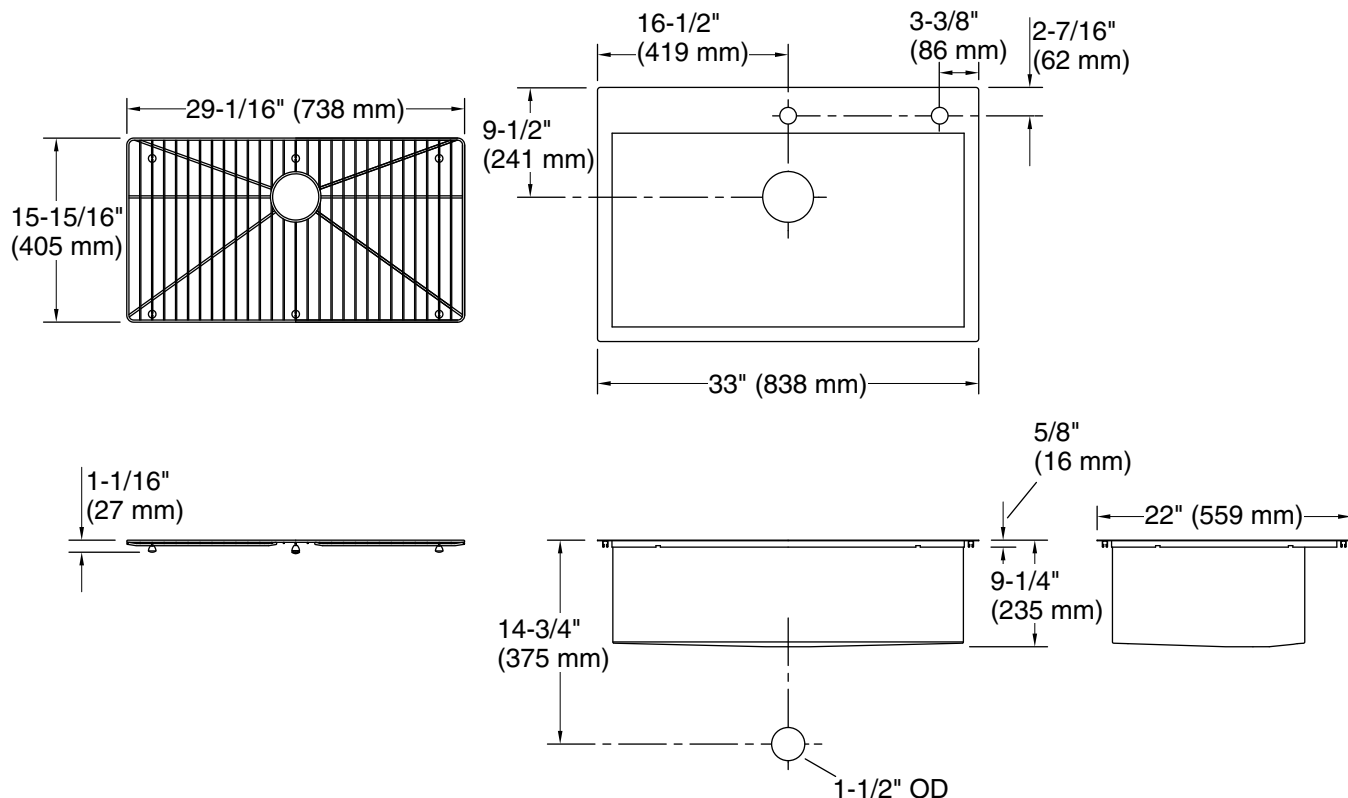

## Technical Information

All product dimensions are nominal.

Basin configuration: Single Bowl

Min. base cabinet width: 36" (914 mm)

Bowl area (Only):  
 Length: 30-1/4" (768 mm)  
 Width: 16-9/16" (421 mm)  
 Bowl depth: 9-1/2" (241 mm)  
 Water depth: 9" (229 mm)

Number of deck holes: 1

Faucet hole(s): 1-7/16" (37 mm)

Drain hole: 3-7/8" (98 mm)

Template: Top-mount/Undermount, 1130821-7, required, included

## Notes

Install this product according to the installation instructions.