

model no. TC301A

Excel®

29" STEEL TOOL CART

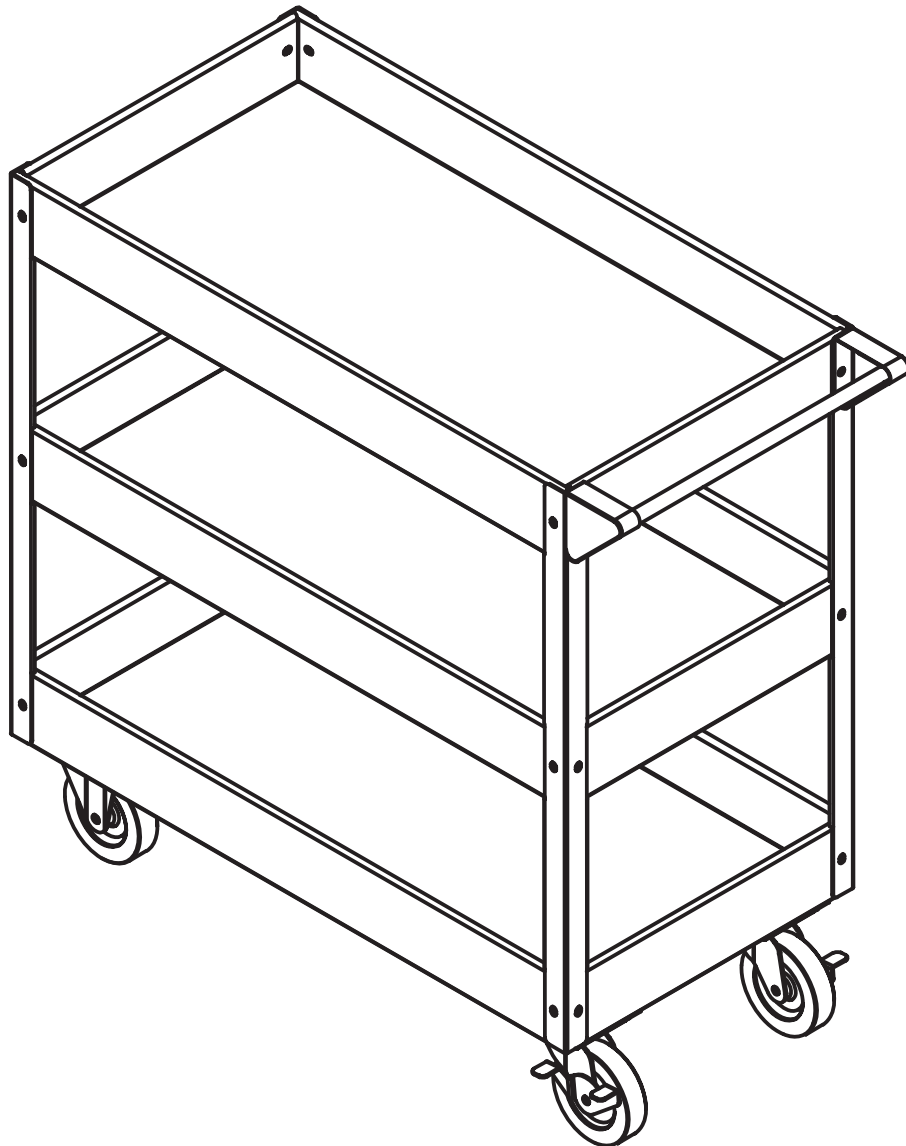

IMPORTANT:

Please read this manual carefully before installing this product and save it for reference.

**INSTRUCTION
MANUAL**

No.	Description	Qty.	No.	Description	Qty.
1	Fixed Caster	2	7	Column	4
2	Swivel Caster (with brake)	2	8	Screw M6 x 14	24
3	Side Handle	1	9	Washer M6	24
4	Handle Bracket	2	10	Washer With Spring M6	24
5	Top / Middle Tray	2	11	Nut M6	24
6	Bottom Tray	1	12	Bolt M6 x 16	16

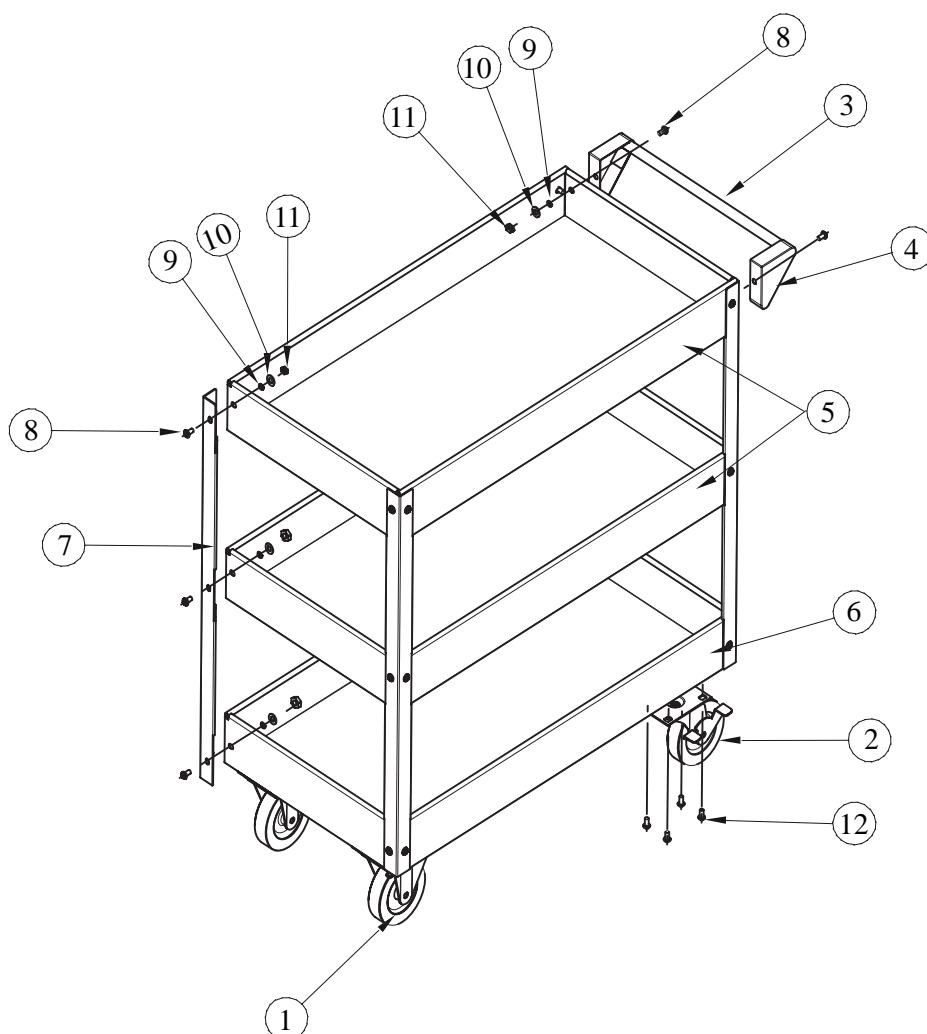

Tools needed for Assembly



Screwdriver



Wrench



SAVE THESE INSTRUCTIONS

This manual contains important safety and operating instructions.
Read all instructions and follow them with use of this product.

Step 1

Attach the four casters to the bottom tray (#6) with 16pcs M6 x 16 bolts (#8). Mount both swivel casters (with brake) (#2) on the same side, and mount both fixed casters (#1) on the opposite side. Wrench tighten.

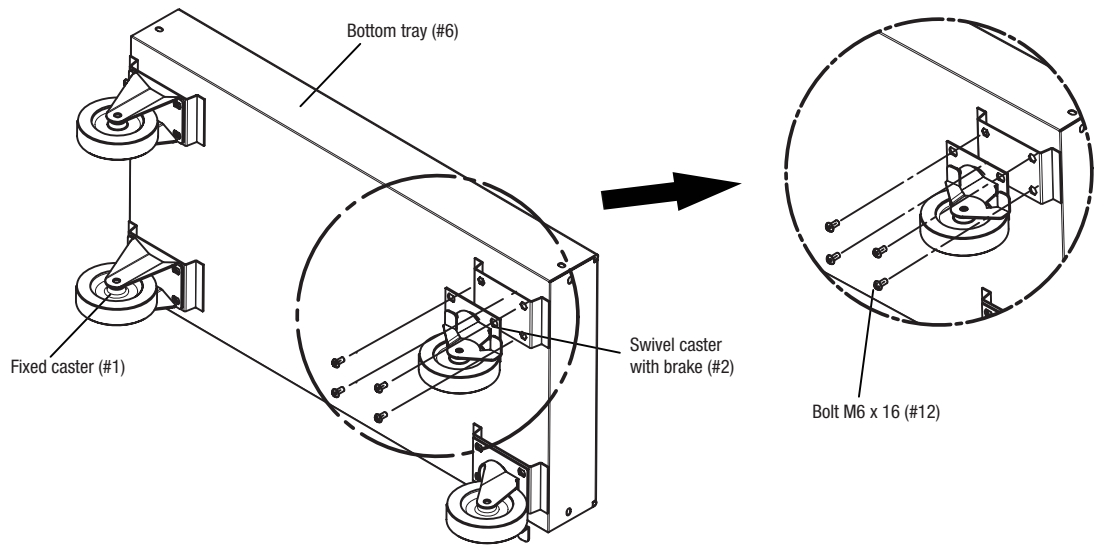

Step 2

Attach the columns (#7) in either direction to the bottom tray (#6) with 8pcs M6 x 14 screws (#8), 8pcs M6 washers with spring (#10), 8pcs M6 washers (#9) and 8pcs M6 nuts (#11).

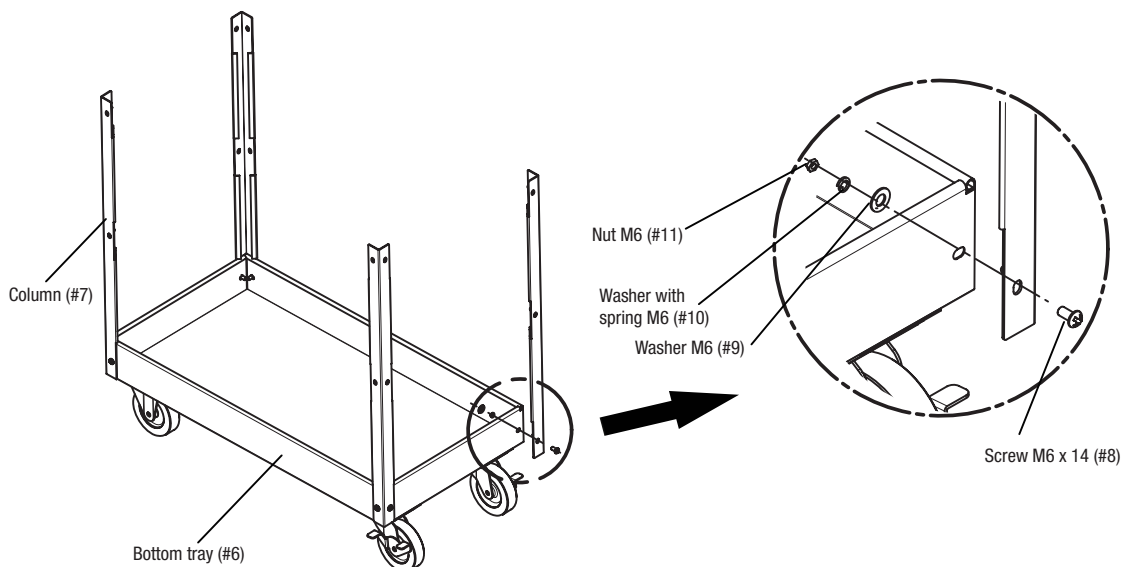

Step 3

Attach the middle tray (#5) to the four columns (#7) with 8pcs M6 x 14 screws (#8), 8pcs M6 washers with spring (#10), 8pcs M6 washers (#9), and 8pcs M6 nuts (#11). Repeat the above step to attach the top tray. Please do not attach screws in the two holes noted in the diagram below, these two holes will be used to attach the handle in a later step.

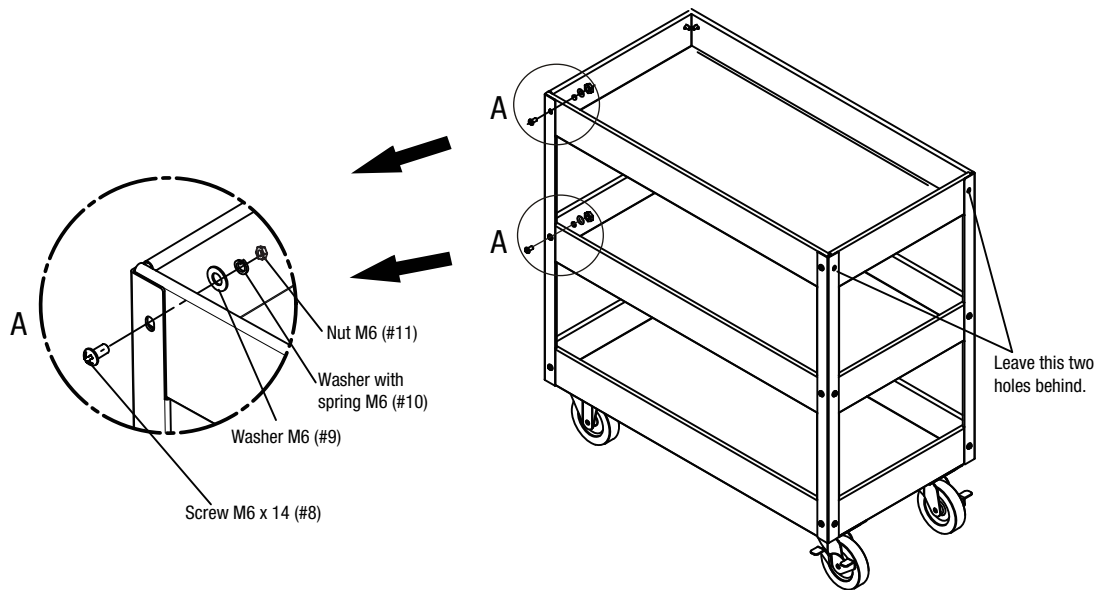

Step 4

Attach the handle (#3) and two handle brackets (#4) to the top tray with 2pcs M6 x 14 screws (#8), 2pcs M6 washers with spring (#10), 2pcs M6 washers (#9) and 2pcs M6 nuts (#11). Please install the handle on the same side as the swivel casters (with brake) (#2).

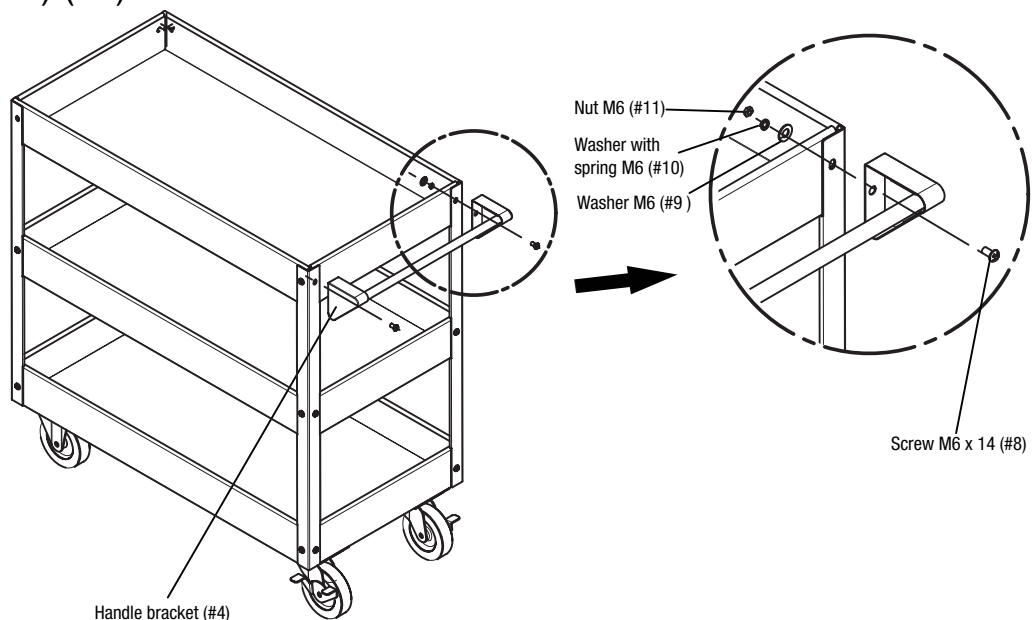

Read and follow all instructions before using this product

INSPECT this product before assembly. Do not assemble the product if parts are missing or damaged.

LOAD the cart from the bottom up. Failure to load the cart from the bottom up may cause the product to tip, which could cause personal injury or product damage.

WEAR approved safety glasses and heavy-duty work gloves during assembly.

DISPERSE the weight of items evenly that are placed in or on the product. Failure to disperse the weight of items evenly may cause personal injury or property damage.

USE the brakes when the product is not being moved. Failure to apply the brakes when the cart is not being moved may cause the cart to roll and cause personal injury or product damage.

DO NOT stand on the product. Standing on the product may cause you to fall and cause personal injury.

DO NOT alter this product in any manner. For example, do not weld extra parts, or attach electrical equipment to the product. Altering this product may cause personal injury or product damage.

DO NOT tow this product with power equipment. The product could tip, which may cause personal injury or product damage.

DO NOT allow children to play on or around the product. Failure to keep children from playing on or around the product may cause personal injury or product damage.

THE MAXIMUM LOAD CAPACITY FOR EACH TRAY SHOULD BE NO MORE THAN 80 lb
THE MAXIMUM LOAD CAPACITY FOR THE PRODUCT SHOULD BE NO MORE THAN 240 lb

Excel®