

# AIR PURIFIER

## USER MANUAL



Filter Reset Button



Timer Button



Fan Speed /  
Child Lock Button

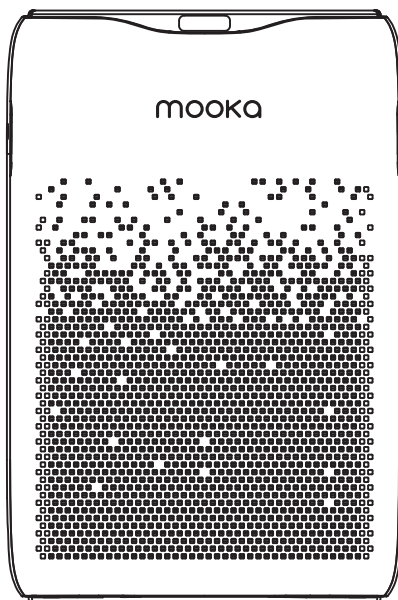

## **CUSTOMER SERVICE**

Our customer service team is standing by to assist you if you have any questions or concerns.



[www.mookashops.com](http://www.mookashops.com)



[support@mookashops.com](mailto:support@mookashops.com)



1-855-666-9955



[m.me/MookaUS](https://m.me/MookaUS)

# CONTENT

INSTRUCTIONS FOR SAFE OPERATION .....	01
LIST OF MAJOR COMPONENTS .....	04
PRODUCT SPECIFICATIONS .....	05
SAFETY WARNING .....	06
GETTING STARTED .....	07
PANEL ICONS .....	08
TROUBLE CLEARING .....	09

# INSTRUCTIONS FOR SAFE OPERATION

---

When using this product, please follow the basic warnings as follows:

Read all warnings before use

Warnings - To reduce the risk of fire, electric shock, damage, observe the following requirements:

1. Disconnect the air purifier with the power source when you do not use it or before maintenance.
2. To reduce the risk of electric shock, do not use outdoors or on wet surfaces.
3. Please use the product in accordance with this manual and use only the functions recommended in this manual.
4. It is recommended to use a separate power outlet instead of a multi-outlet socket to avoid the danger due to overheating.
5. Please place the product on a stable table or floor, and do not use it on the edge of the table or an inclined surface to avoid accidental damage to the product.
- 6 Before using the product, please remove the packages of the main body of air purifier and all its filters, and ensure that the filters are installed correctly according to this manual.
7. To open the front panel and replace the filter, be sure to turn off the power.
8. Do not block the air inlet and outlet when using the appliance, so as to avoid damage caused by overheating of the appliance. Do not use it near a soft object, such as curtains. And please ensure that there is 30cm clearance around the appliance.

# INSTRUCTIONS FOR SAFE OPERATION

---

9. Do not use non-original accessories or parts to avoid damage to the product. If non-original parts or accessories are used, the applicable after-sales terms will be invalid.
10. If the power cord is damaged and it is necessary to replace the power cord, it must be done by a professional or in a designated maintenance station.
11. This product cannot replace the ventilation fan, vacuum cleaner or range hood in the kitchen.
12. Do not insert your fingers or other objects into the air outlet of the appliance to avoid damage to the appliance or personal injury.
13. If the dominant air quality of the room is bad (such as oil fumes and unusual smell in newly decorated apartment), it is highly recommended that you open the windows at the same time when you use this product for better effect.
14. When the product has an unusual smell or noise, disconnect the power supply and contact the after-sales service station.
15. Do not use flammable cleaning agents such as gasoline; otherwise there is a risk of fire.
16. Do not use the product in an environment where explosive materials, flammable liquids, or flammable gases are in close proximity, and do not use it near heating or high-temperature objects. This may result in an explosion.
17. Unplug the power cord before cleaning, maintenance and repair.

# INSTRUCTIONS FOR SAFE OPERATION

---

- 18. Do not pull the power cord while unplugging it. The correct way is to hold the plug and pull it out.
  - 19. When unplugging the power cord and moving the appliance, please keep your hands dry.
  - 20. When lifting or moving the appliance, use the handle on the product.
  - 21. When the product is not in use, please put it back in the box and store it in a safe and cool place. Keep it away from direct sunlight.
  - 22. This product is for home use only. If you need to give the product to someone else, please send the manual together.
  - 23. Please keep this manual properly.
- This product is not suitable for some special groups of people, such as children, people with disabilities and mental illness, or people who lack relevant use experience and knowledge unless they are using the product under supervision to ensure safety. Please ensure that children do not use this product as a toy.

# LIST OF MAJOR COMPONENTS

---

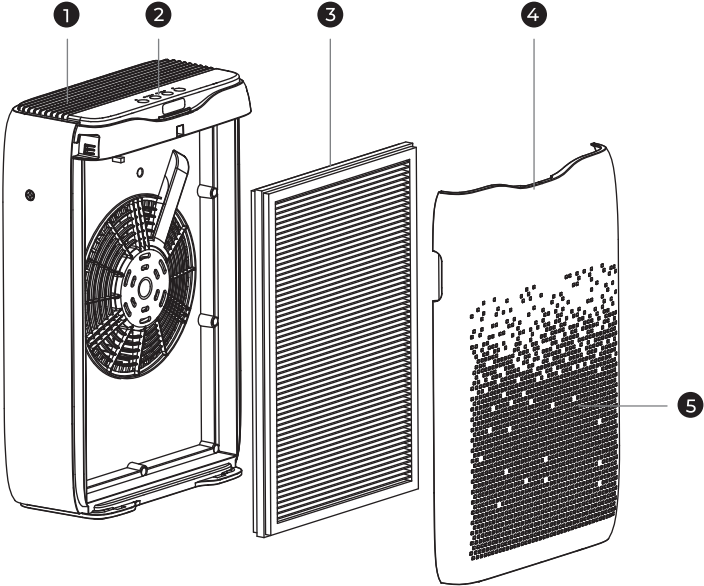

- 1. Air outlet
- 2. Control Panel
- 3. Filter
- 4. Front panel
- 5. Air inlet

# PRODUCT SPECIFICATIONS

---

Description	Air Purifier
Model	EPI188
Voltage	120V/60Hz
Rated power	50W
N.W/G.W	3.5/4.6kg
Dimension	310*153*466mm



## SAFETY WARNING

---

1

Do not cover the air outlet with a towel or other object to avoid damage to the appliance and personal injury.



2

When plugging in the power cord, please make sure your hands are dry. Only use dry hands to insert the plug into the socket. Do not handle air cleaners or plugs with wet hands.

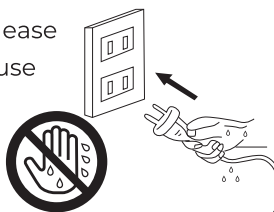

3

Do not pull the power cord while unplugging it. The correct way is to hold the plug and pull it out to avoid damage to the cord.

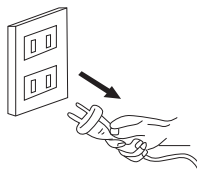

# GETTING STARTED

---

1. Pull the front cover from the top to remove front cover (Fig 1).

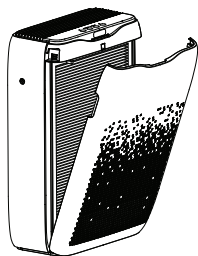

Fig 1

2. Remove plastic wrapping of filters (Fig 2) .

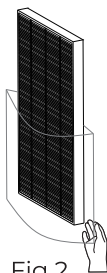

Fig 2

3. After the filter plastic bag is removed, put the filter back into the product and install the front cover of the product to the buckle.

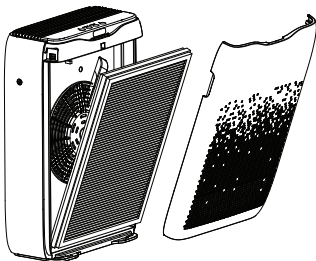
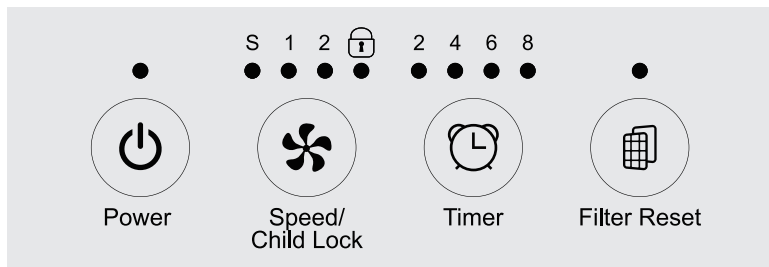





Fig 3

# PANEL ICONS



## DESCRIPTION

Icon	Name	Description
	Power	Touch the power switch button to turn the power on and off.
	Fan Speed / Child Lock Button	<ol style="list-style-type: none"><li>1. Touch (Short Press) the button each time to select sleep mode/ speed 1 / speed 2.</li><li>2. Long press this button for 3s to enter/exit the child lock mode.</li></ol>
	Timer Button	Press the button to set the automatic shutdown time of 2/4/6/8H.
	Filter Reset Button	When the filter has been used for over 2000 hours, this button light will flash indicating you need to replace a new filter. After changing filter, press and hold the button for 3 seconds, to reset the indicator light, timer restarts.

# TROUBLE CLEARING

---

In the face of the following general problems, the users may inspect by themselves. (Note: If you find a problem, please immediately turn off the appliance to prevent damage to the appliance and other hazards.)

Problem phenomenon	Possible causes	Solution
Startup fails.	Plug is not inserted in place.	Plug in the power cord again and make sure it is plugged into the correct place.
	There is no electricity in the socket.	Change to another socket and try to plug in again.
The product is overheating.	The appliance may operate under overload for excessively long time or air.	Please turn the appliance off and restart it 15 minutes later.
Rurification capacity is reduced.	Filter is dirty or its service life comes to an end.	Remove and replace the filter by referring to the previous detailed instructions.

Attention: If you still couldn't clear the trouble after checking as the above steps, please contact our after-sale center or technology fixing center for help. Don't take apart to fix it up by yourself, in case of danger or damage to the appliance.

# mooka

*Beyond Elegance*

- 🌐 [www.mookashops.com](http://www.mookashops.com)
- ✉ [support@mookashops.com](mailto:support@mookashops.com)
- ☎ 1-855-666-9955
- 📱 [m.me/MookaUS](https://m.me/MookaUS)



Made in China