

CLEANING AND STORAGE

Make sure to regularly wipe down the solar panel with a damp cloth for best charging results. Clean solar panel will be able to absorb more sun energy.

IMPORTANT

- DO NOT open the compartment on the back of the unit and expose the internal batteries.
- DO NOT replace Li-Ion batteries that are inside the unit.

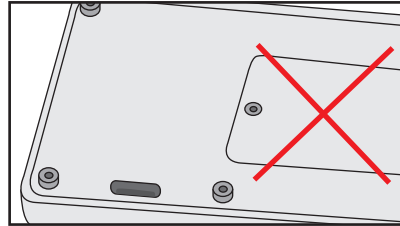

SPECIFICATIONS

Battery: Rechargeable Li-Ion battery 2x18650, 3.7V, 1500mAh

Battery capacity: 3000mAh

Solar panel: 5.5V, 230mA

Charging time: approx. 13 hrs

Detection range: 16-26 feet (5-8m)

Product size: W"11.8x D2.24"x H4.33"

W30 x D5.7 x H11cm

Net weight: 1.08lb/492g

Waterproof rate: IP65

THE LEDs ARE NON REPLACEABLE.



This product uses a Li-Ion battery. When it can no longer be used, it should be removed from the unit and recycled. The battery must not be incinerated or composted. The battery can be taken for disposal to any local retailer participating in the national recycling program sponsored by the RBRC (SEE RBRC seal). Call your local details, or the RBRC hotline at 1-800-820-8837 for the closest recycling center to you.

BELL+HOWELL BIONIC™ WALL LIGHT XL

1000 LUMENS

**SOLAR
POWERED**

No Batteries, No Wires, Weather Resistant

2

**LIGHT MODES
LOW • HIGH
3500 KELVIN**



- **HIGH INTENSITY LEDs**
- **WEATHER RESISTANT**
- **ADDED SECURITY**
- **PORTABLE & MOUNTS EASILY**

INSTRUCTIONS

BELL+HOWELL® BIONIC™ WALL LIGHT XL ITEM NO.8575ENL
Distributed by EMSON® New York, NY 10001, USA
©2024 EMSON® All Rights Reserved. Made in China.

! IMPORTANT

- This product includes a lithium-ion battery that cannot be replaced. Once the battery reaches the end of its life, the entire product must be discarded and replaced.
- **WARNING:** Do not dispose of lithium-ion batteries in the trash or by fire as batteries may leak or explode. Do not open, short circuit, or damage lithium-ion batteries as injury may occur. Recycle lithium-ion batteries in accordance with local, state, and federal regulations.

PARTS IDENTIFICATION

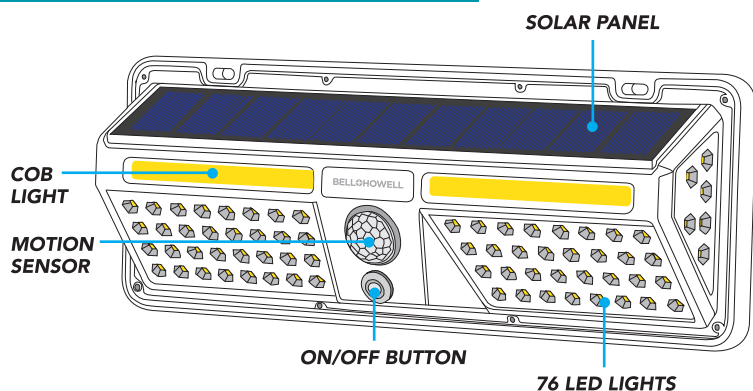

ALSO INCLUDES:
2 - 3M tape strips
2 - Screws with Anchors

INSTALLATION

- When picking a place to install your Bionic Wall Light XL, choose a location with maximum sun exposure during the day.
- Avoid areas under trees or bushes as this will prevent a proper charge of the Bionic Wall Light XL.
- When using the Bionic Wall Light XL in the fall and winter, please note that due to fewer daylight hours, the batteries might not charge fully. This may limit the amount of time the Bionic Wall Light XL will be on.

USING 3M TAPE Clean the area before installing. Let it fully dry.

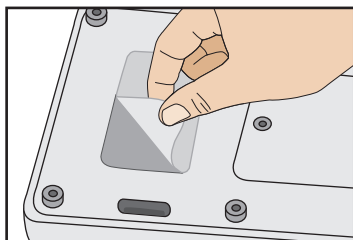

Peel off backing and place it with the adhesive side down on the back of the unit. Next, peel off the other side of the tape.

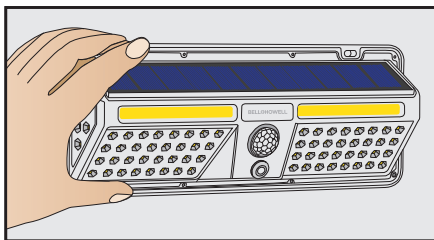

Press the unit firmly onto the surface for a few seconds.

USING SCREWS AND ANCHORS (included)

You will also need: drill, hammer or rubber mallet, screwdriver.

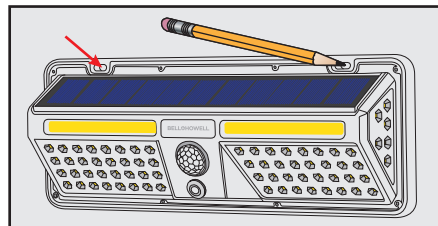

Place the unit against the surface and mark both points with a pencil.

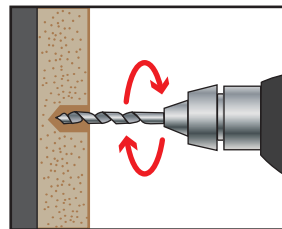

Create an anchor hole in the surface by using the drill or tapping a nail in with the hammer. Do not make the hole wider than the anchor. If nail was used, remove it from surface.

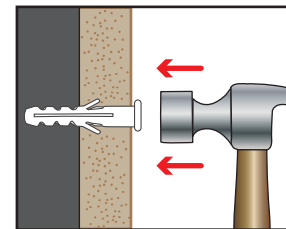

Place each anchor over the hole and firmly tap it in until it is flush with the surface.

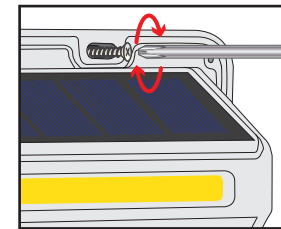

Place the unit by lining up its holes with the already installed anchors. Slowly tighten the screw into the plastic anchor with the screwdriver. Repeat for the other side.

USAGE

Leave the unit under direct sunlight for solar charging at least 8 hours. If there isn't ample sunlight, it may take longer for the batteries to charge.

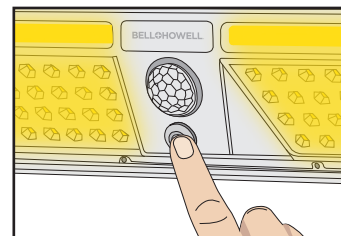

BRIGHT MODE

Press the ON/OFF button once, bright light will turn on. After 20 seconds of no movement, the light will turn off. When the movement is detected, the light will turn on BRIGHT Mode.

TURN OFF

Press the ON/OFF button again to turn the unit off.

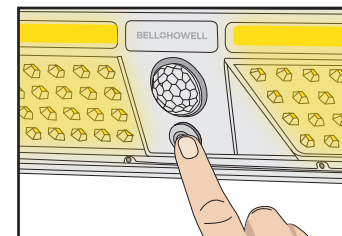

ECO NIGHT MODE

Press the ON/OFF button twice, eco light will turn on and stay on. When the movement is detected, the light will turn on BRIGHT Mode. After 20 seconds of no movement, the light will go back to continuous ECO NIGHT Mode.