

TV Stand

Instruction Manual

DZJ-G01-BK

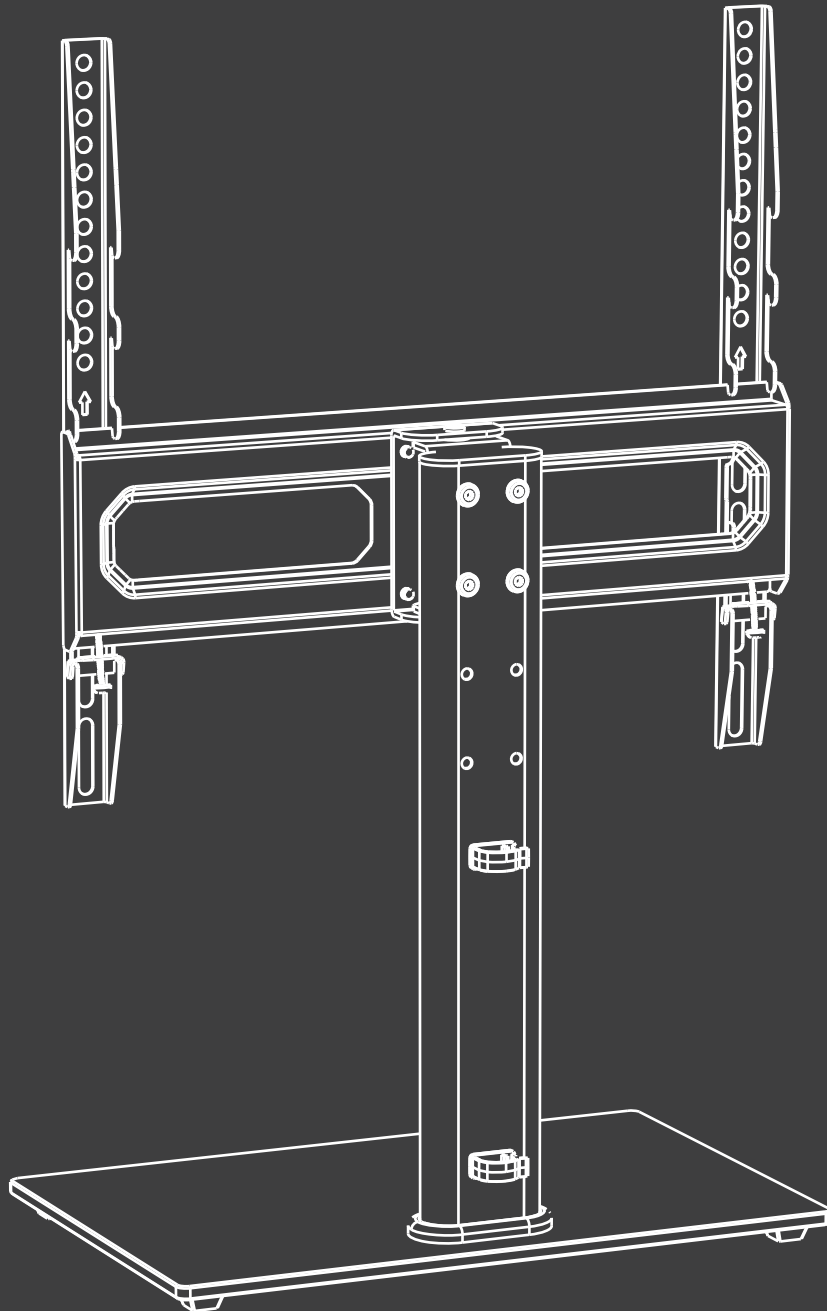

Before getting started, let's make sure this stand is compatible.

1 Is the VESA pattern of your TV 100 x 100mm (3.9 x 3.9") to 400 x 400mm (15.7 x 15.7") ?

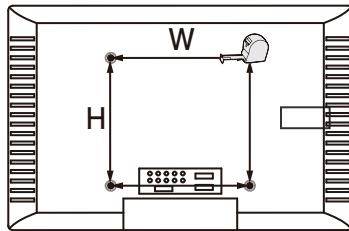

☐ Yes – Perfect!

☐ No – This stand is NOT compatible.

2 Does your TV (including accessories) weigh less than 99 lbs (45 kg) ?



☐ Yes – Perfect!

☐ No – This stand is NOT compatible.

3 Tools Needed
(NOT Included)

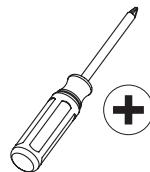

Screwdriver

1 Package List

a

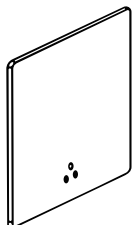

x1
Motherboard

b



x1
Column

c

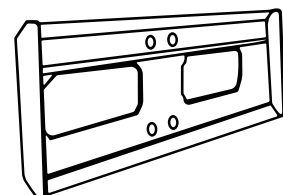

x1
Panel

d

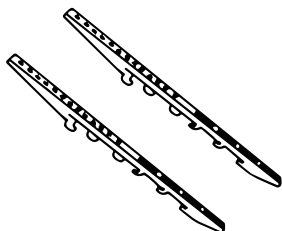

x2
Monitor Brackets

e



x1
Shaft

f



x1
Shaft

A

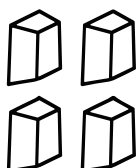

x4
Rubber Feet

B

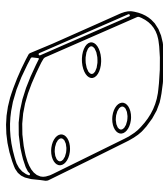

x1
Gasket

C



x3
Screw
M6*25mm

D

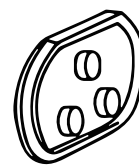

x1
Base

E



x2
Cable Buckle

F



x4
Screw
M6*35mm

G



x2
Nut
M6

H



x2
Screw
M6*16mm

I

x2
Washer
M6*18*1.5mm

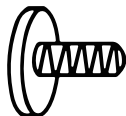
J

x4
Screw
M6*8mm

K

x2
Screw
M5*30mm

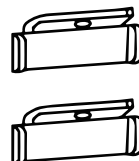
L

x2
Safety Lock

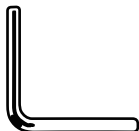
M

x1
Wrench
4mm

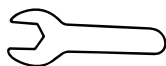
N

x1
Wrench
10mm

2 TV Screw Kit



1 **x4 Screw**
M4*16mm



2 **x4 Screw**
M4*30mm



3 **x4 Screw**
M6*16mm



4 **x4 Screw**
M6*30mm



5 **x4 Screw**
M8*16mm



6 **x4 Screw**
M8*45mm



7 **x8 Washer**
17.5*8.5*5mm



8 **x8 Washer**
17.5*8.5*10mm

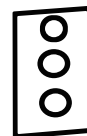

9 **x4 Gasket**

Step 1

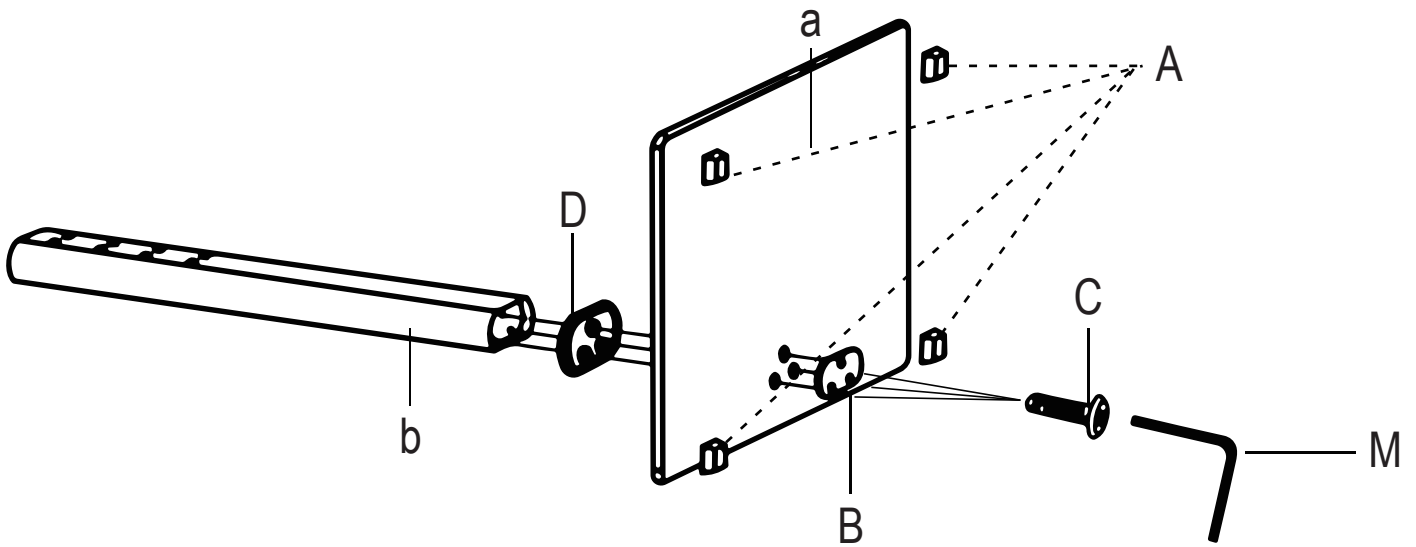

Attach the Rubber Feet A*4 to the four corners of the Motherboard a, then pass the Screws C*3 through the Gasket B, the Motherboard a, the Base D and the Column b in turn, and tighten them with the Wrench M.

Step 2

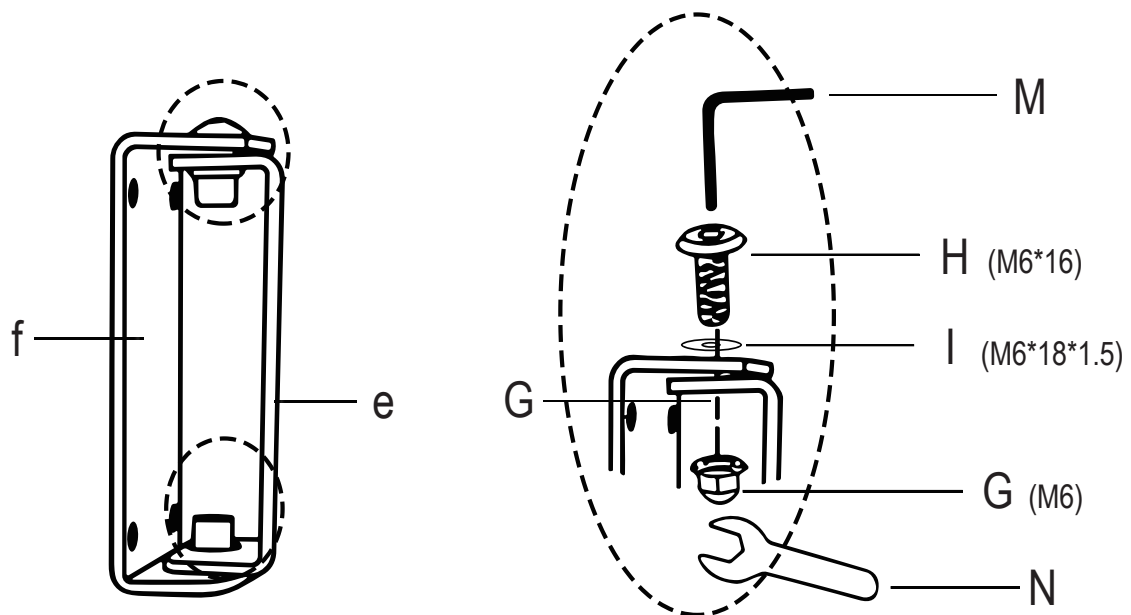

Stack the Shaft e and Shaft f. The Screws H*2 passes through the Shaft and connects with the Washers I*2 and Nuts G*2 to be tightened with Wrenches M and N.

Step 3

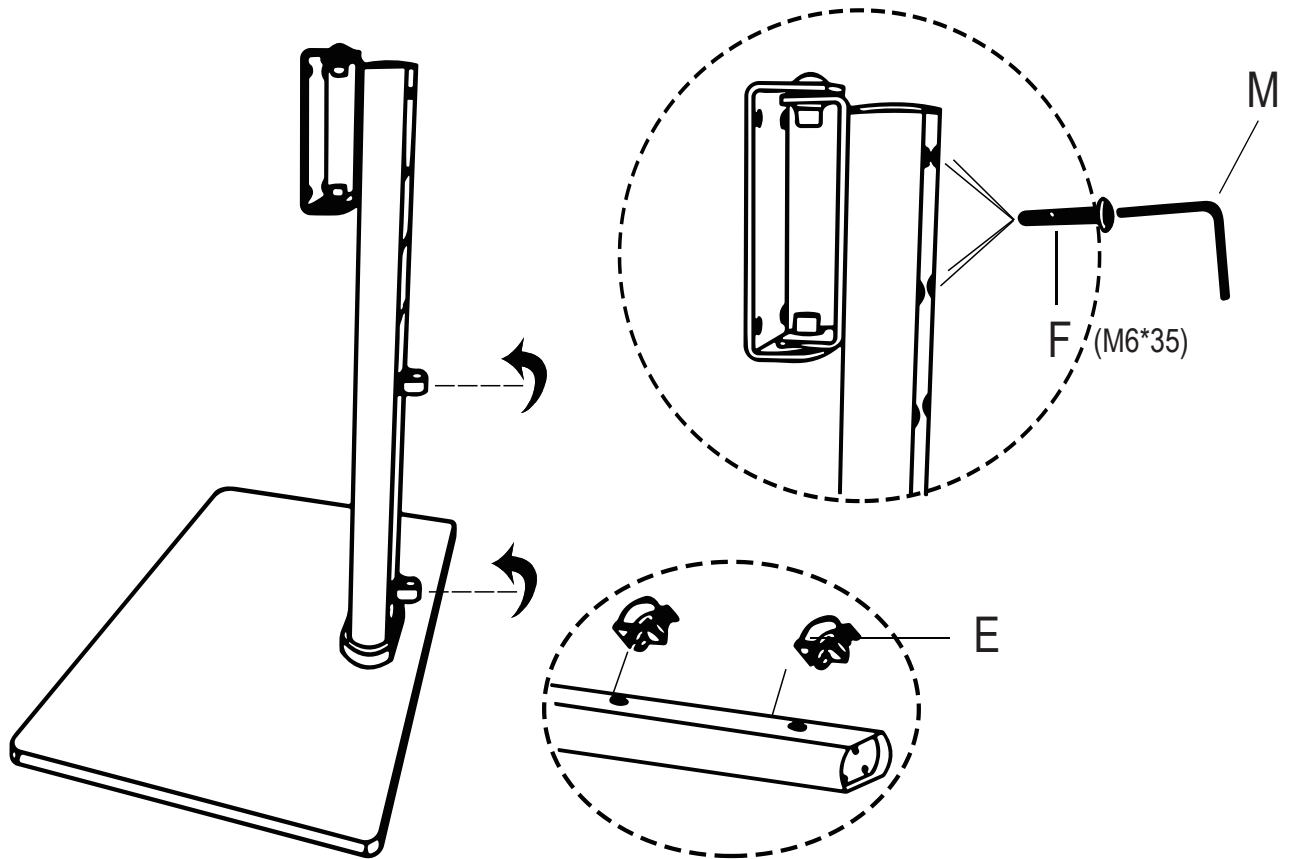

Attach the mounted rotating Shaft to Column b with Screws F*4 and Wrench M. Then attach the Cable Buckle E*2 to Column b.

Step 4

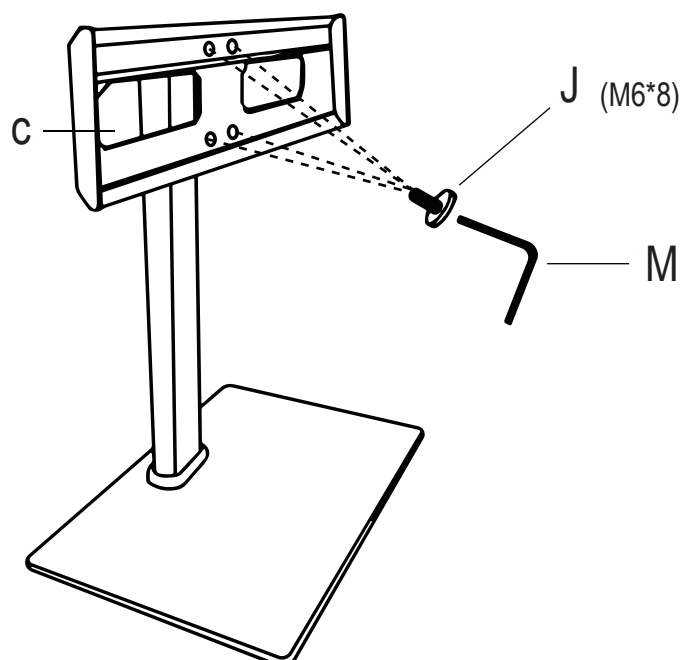

Attach Panel c to the mounted rotating Shaft with Screws J*4 and tighten it with a Wrench M.

Step 5-1 Select the screws

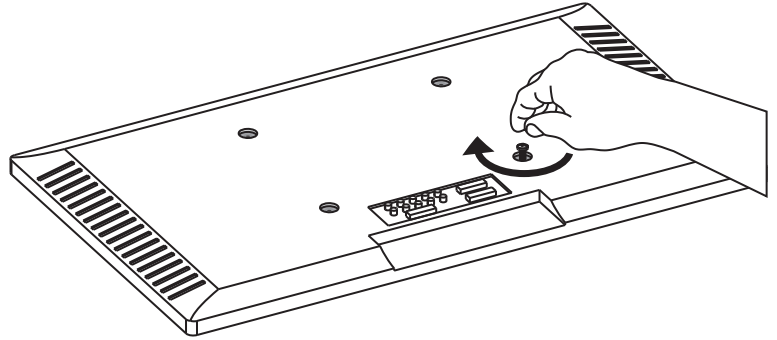
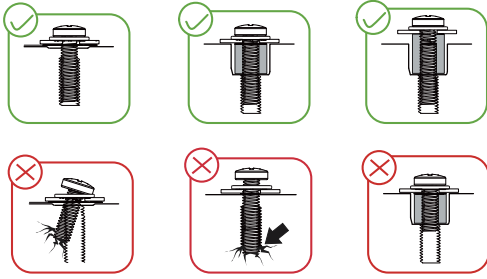

Place the screws into the screw holes on the back of the TV to determine which screw will work. It takes at least 4-5 turns in the borehole. Do not rotate past the bottom of the hole.

Step 5-2 Flat-Panel TV

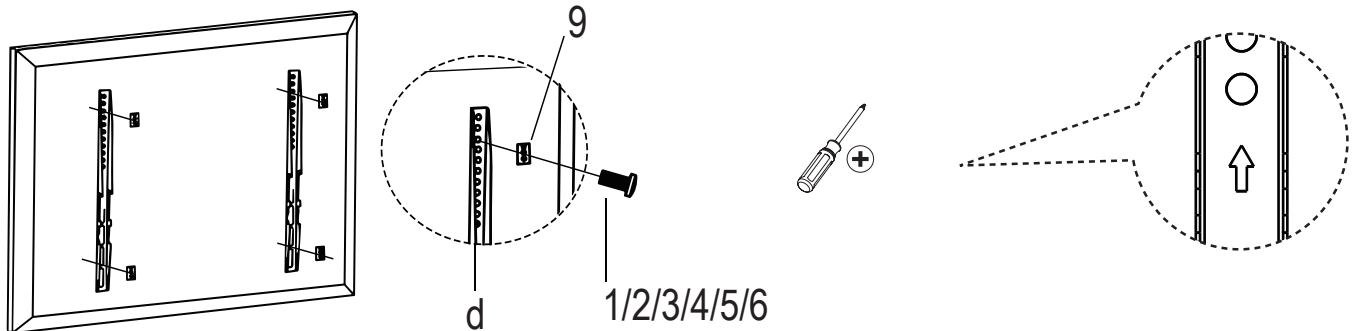

Select the appropriate screws (1/2/3/4/5/6) according to the size of the TV back panel holes, and then tighten the screws through the Gasket 9*4 and the Monitor Brackets d*2 with a screwdriver.

Note: Washers can be added to accommodate the length of the screws and the back of the TV if needed.

Step 5-3 Curved TV

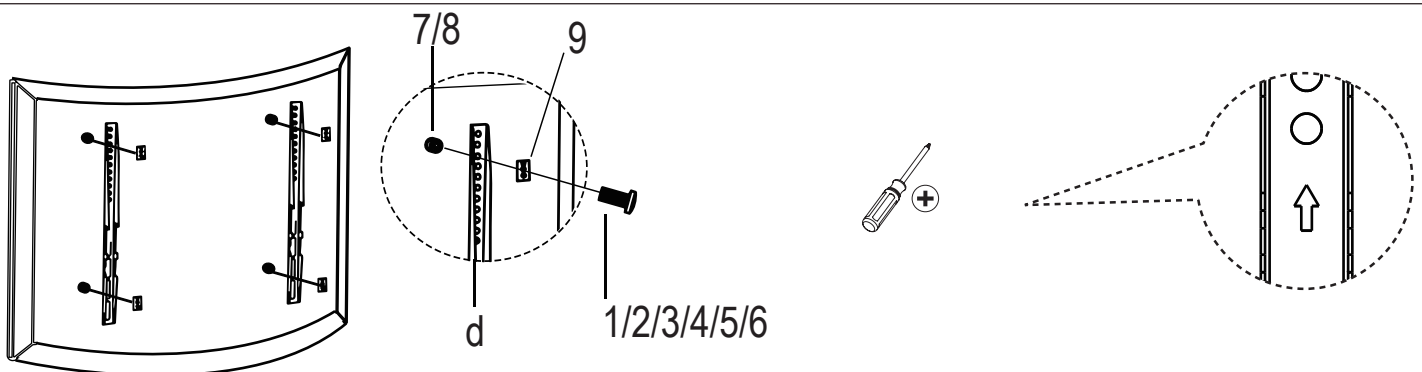

Select the appropriate screws (1/2/3/4/5/6) according to the size of the TV back panel holes, and then tighten the screws through the Gasket 9*4, Monitor Brackets d*2 and the Washer(7/8) with a screwdriver.

Note: The washer must be high enough that the curved back of the TV does not interfere with the mounting plate.

Step 6

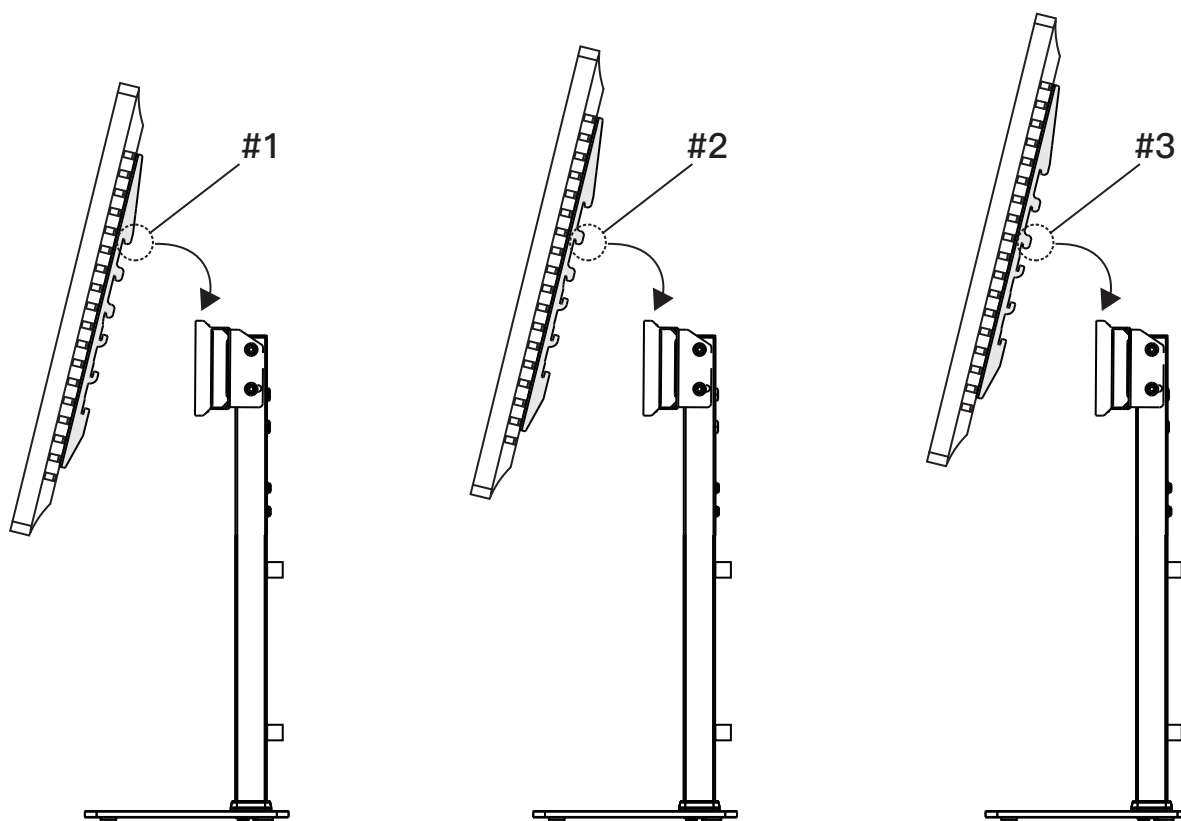
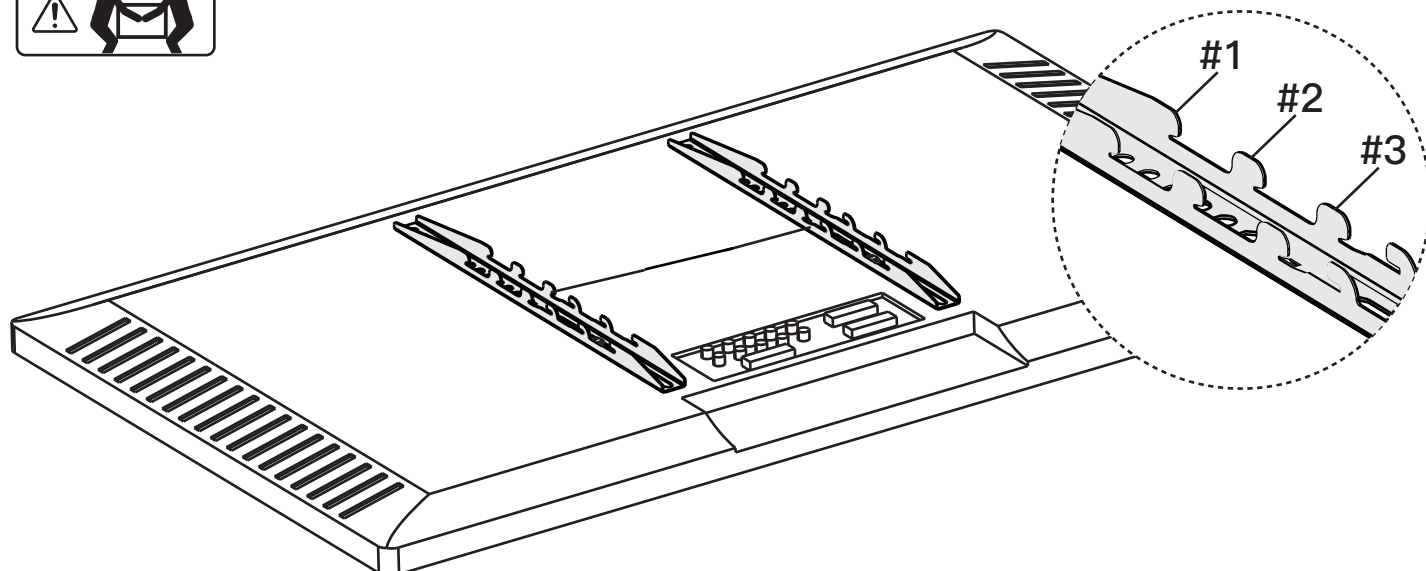

The Monitor Brackets has three sets of hooks. Before installing the TV, choose the right hook.

Step 7

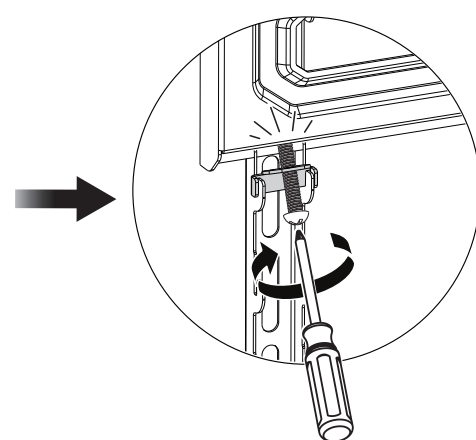
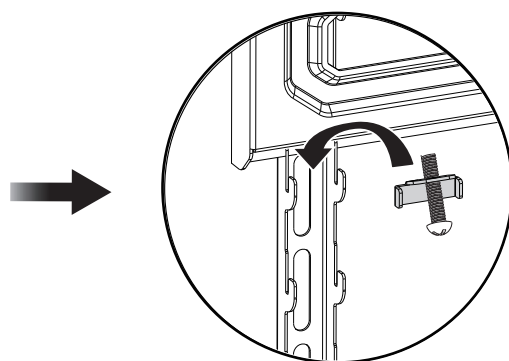
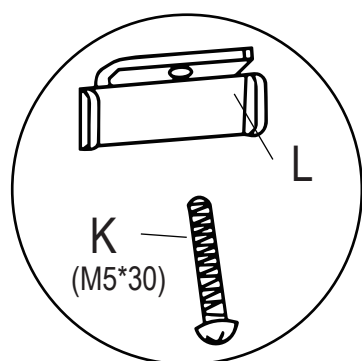
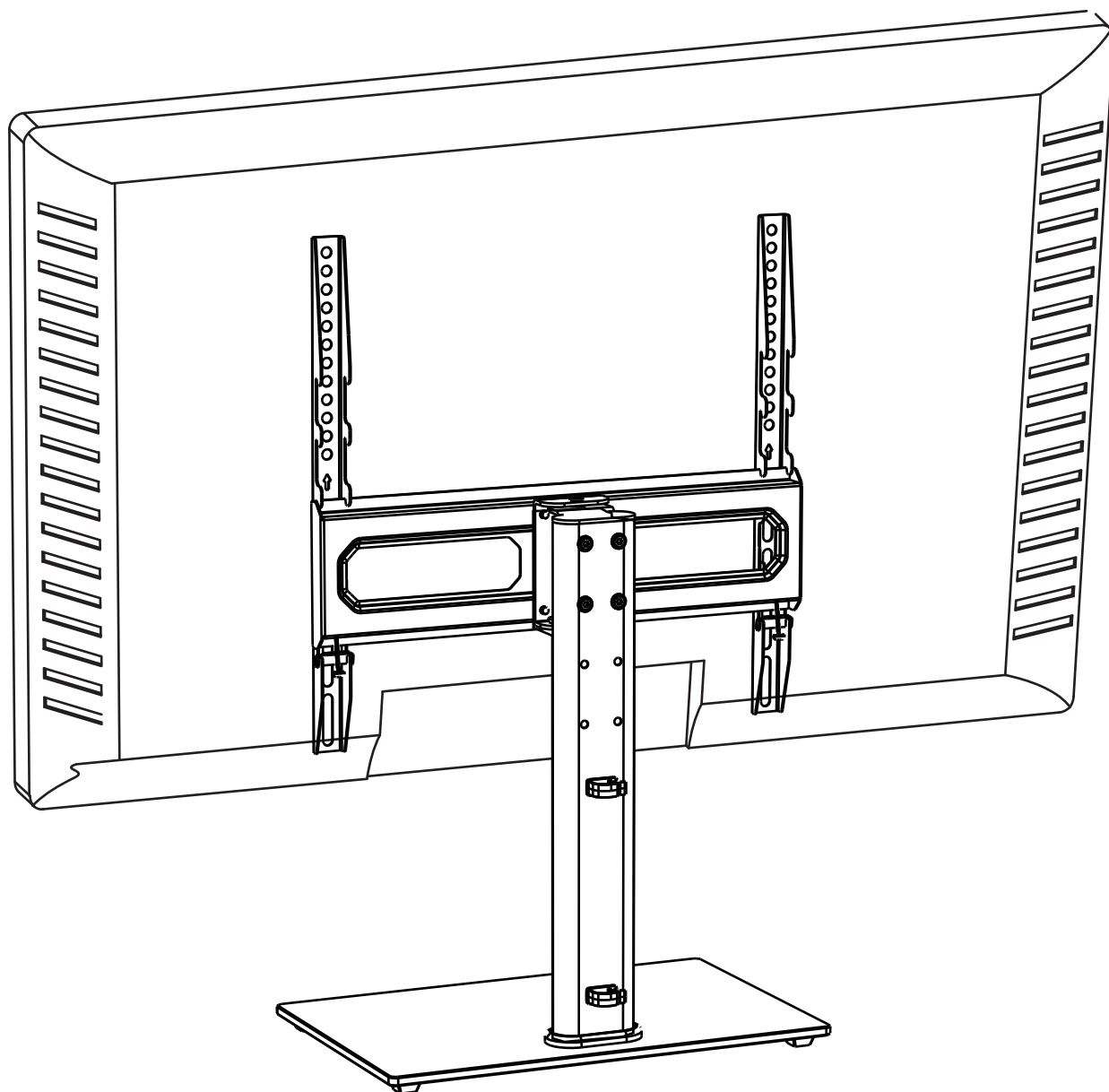

Insert the Screw K*2 through the Safety Lock L*2 into the upward hook located directly below the horizontal TV panel. Tighten the screws until they touch the TV back panel.

Step 8

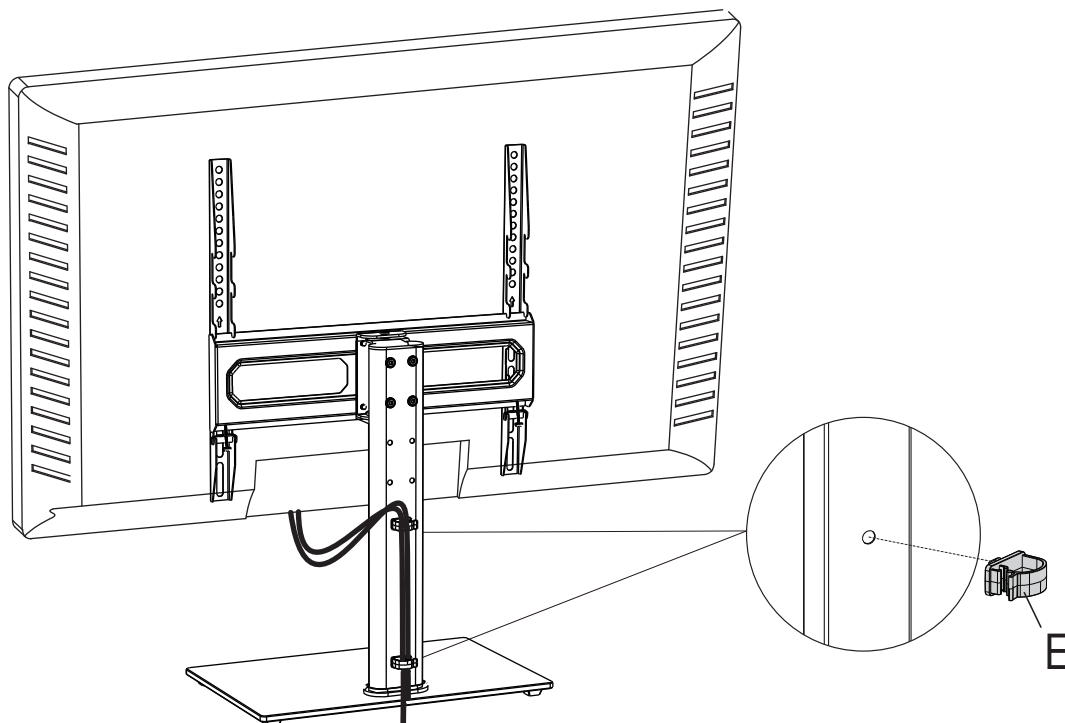

Conceal the cable of the TV into the Cable Buckle E*2.

Step 9

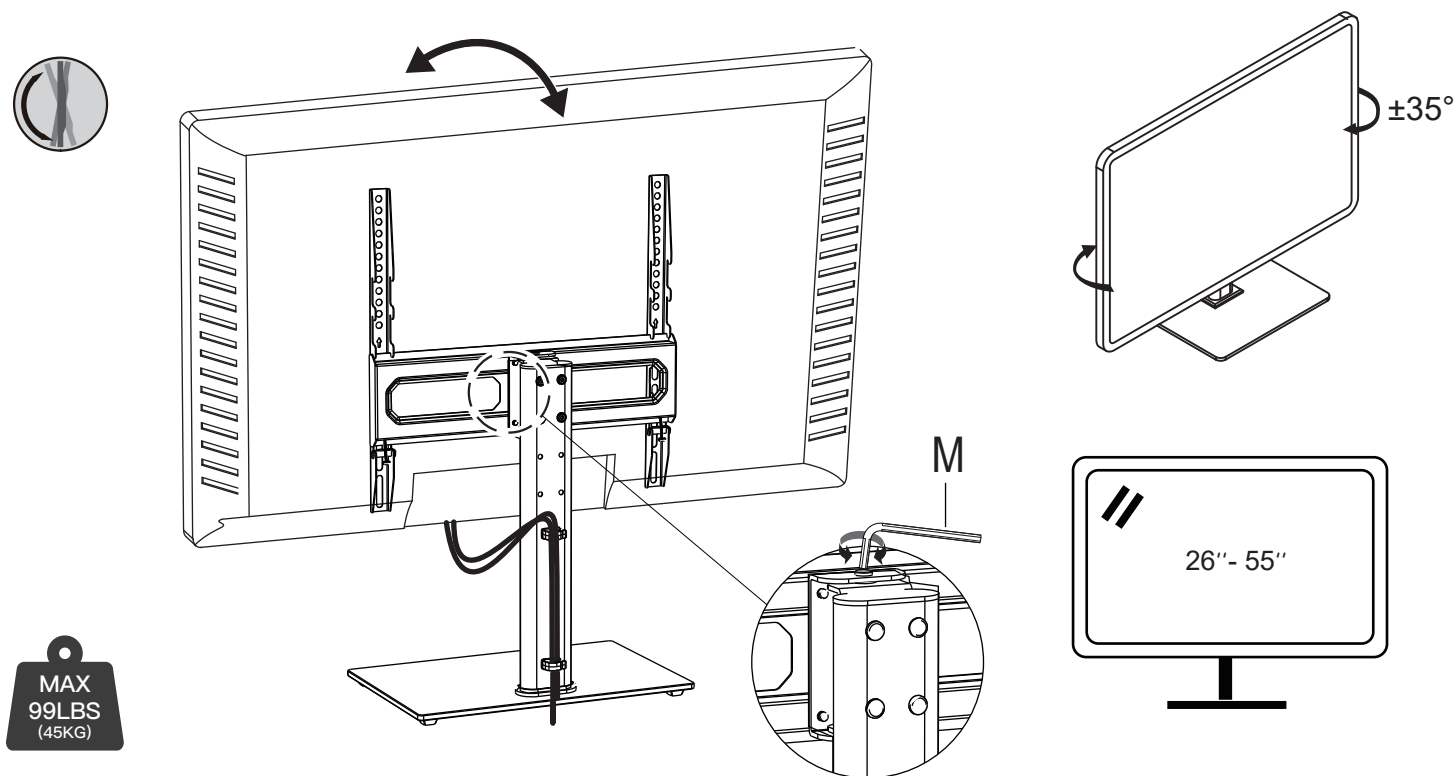

Tilt the TV to the desired angle. If it is difficult to tilt the TV, you can adjust the TV tilt angle by loosening or tightening the Wrench M adjustment screws H.

