

Sideboard

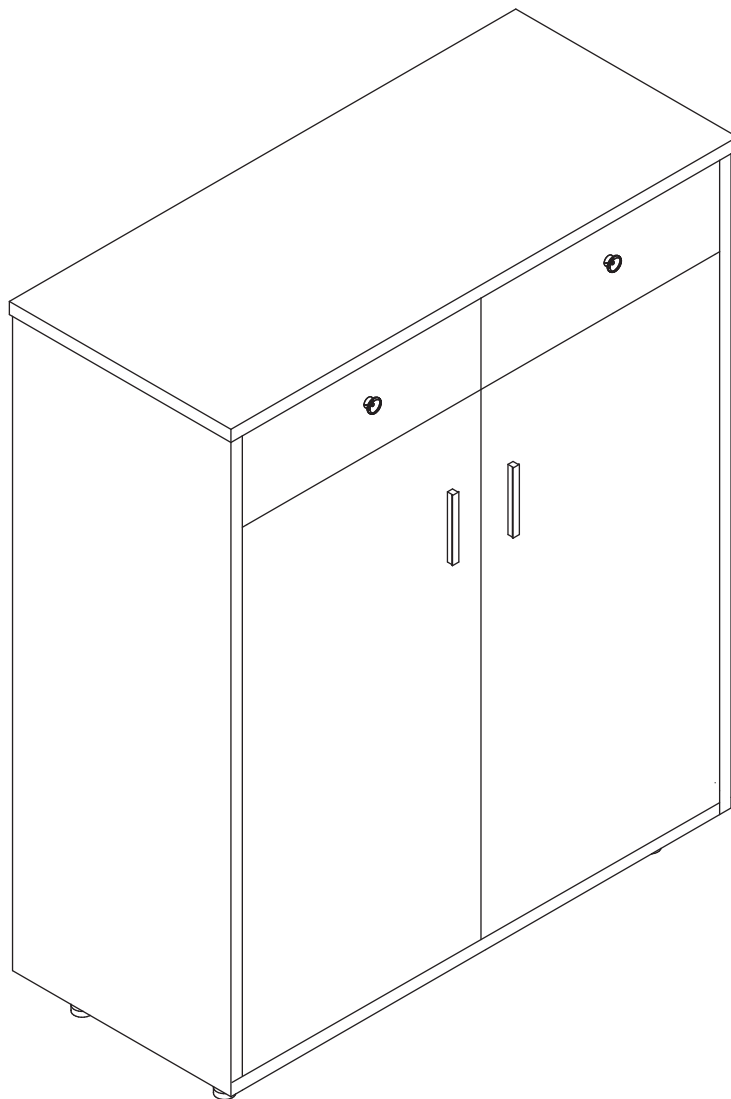

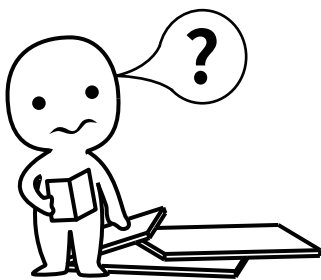

IMPORTANT INFORMATION!

please read the entire manual before starting to assemble and/or using this product. follow the manual thoroughly and keep it for further reference.

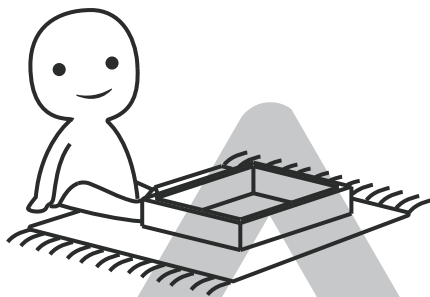
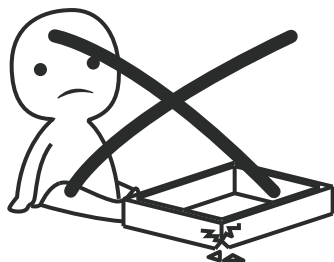

AVOID SCRATCHES!

In order to avoid scratching this furniture should be assembled on a soft layer-could be a rug.

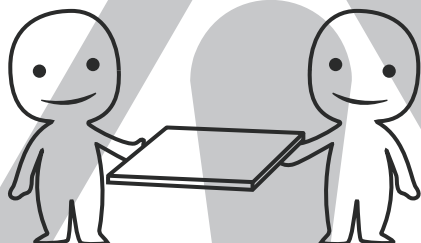

IMPROVE EFFICIENCY !

Try to find a partner to install with you, which can speed up the installation efficiency and shorten the time.

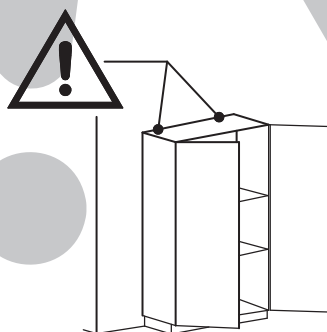
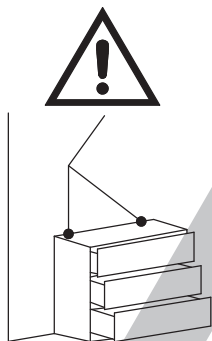

ANTI-TOPPLE WARNING !

Overturned furniture can cause serious or fatal crush injuries. To prevent tipping over, be sure to use the wall attachment, if not included with this product. Please purchase the wall attachment that fit your wall. If unsure, seek professional advice. Please read and follow each step of the instructions carefully.

IMPORTANT !

It is important that any product which is assembled using any kind of screw is re-tightened 2 weeks after assembly, and once every 3 months - in order to assure stability through-out the lifespan of the product.

For regular maintenance and cleaning of the product, for the frame, please use a rag dipped in neutral detergent to fully wipe it, and then dry it with a clean rag. For glass materials, wipe with a rag dampened with water glass cleaner, and then dry with a dry rag.

Do not use an electric screwdriver, and do not use too much force when installing, because the board is easy to break.

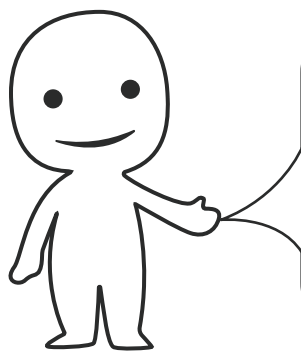

Please prepare the following tools

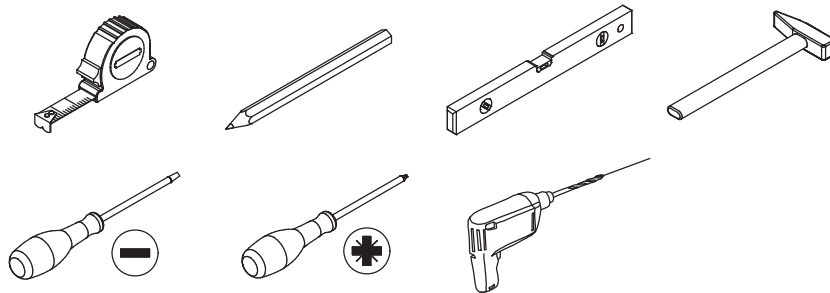

When installing, please carefully confirm whether each screw corresponds to the manual, accessories with similar shapes can be distinguished by size

A x 17

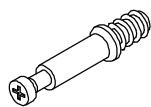

Ø 6 x 35 mm

B x 17



Ø 15 x 9 mm

C x 240



Ø 3 x 12 mm

D x 17

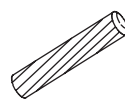

Ø 6 x 30 mm

E x 29

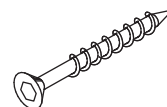

Ø 5 x 40 mm

F x 4

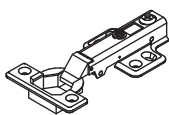

G x 12



H x 16



Ø 4 x 12 mm

J x 4



K x 2

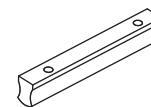

L x 1

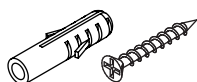

M x 1



N x 9

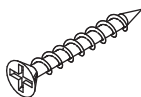

Ø 4 x 35 mm

T x 10



O x 2



DL x 1

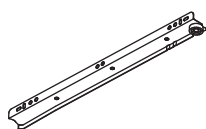

300 mm

DR x 1

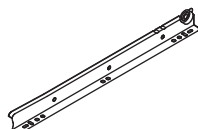

300 mm

CR x 1

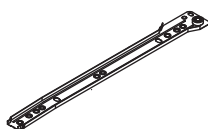

300 mm

CL x 1

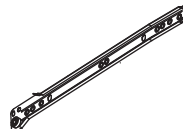

300 mm

P x 1



300 mm

Q x 6



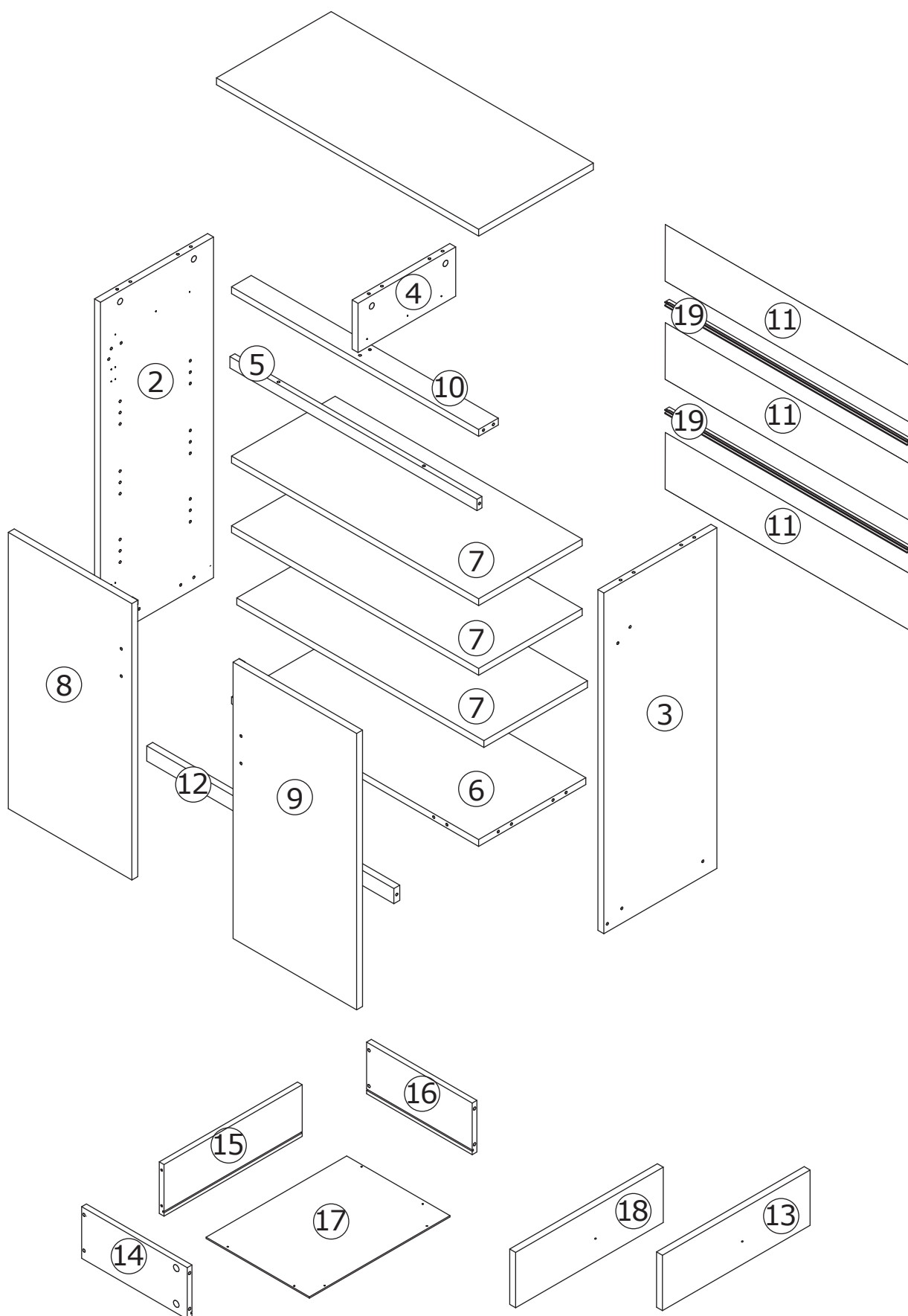

1

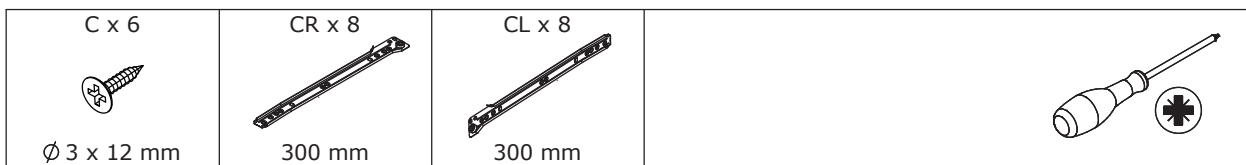

Fix slide rail(CR) and (CL) to both sides of No.4 board as shown. Please note the 2 sides have different holes.

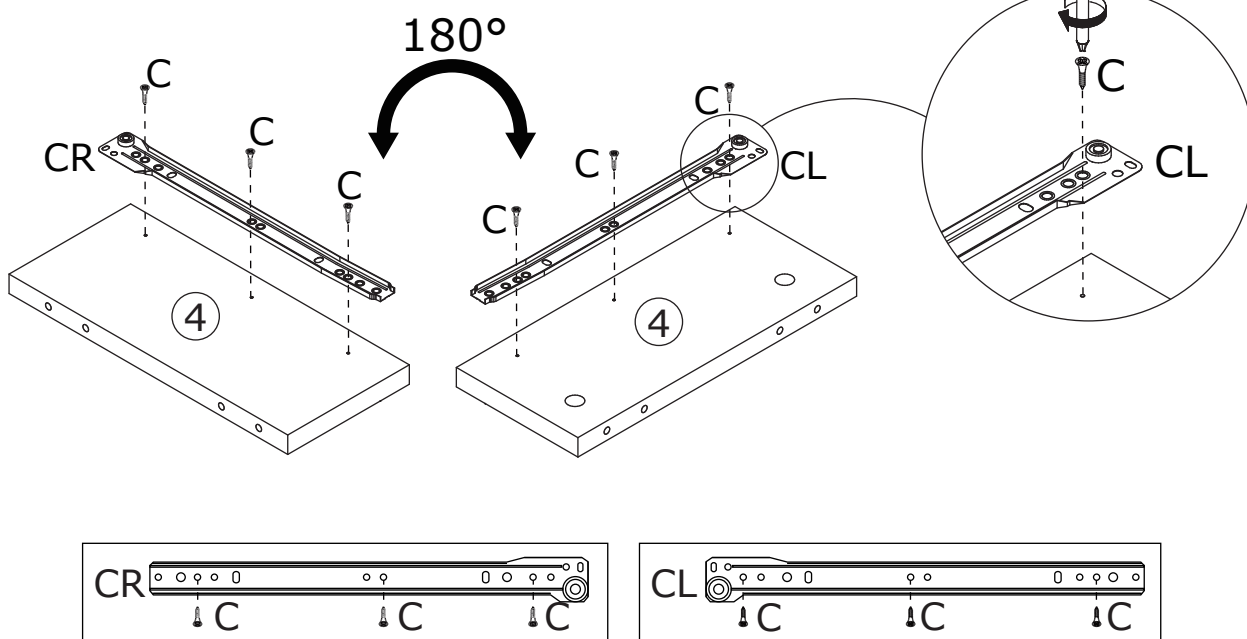

2



Attach No.10 board to No.4 board with wooden dowel(D) as shown.
Attach No.5 board to No.10 board with wooden dowel(D) and screw(E) as shown.

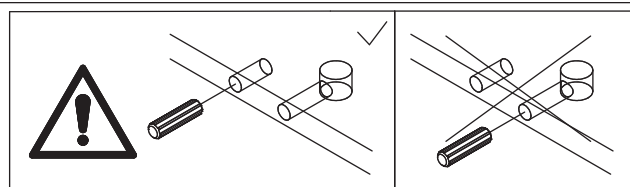
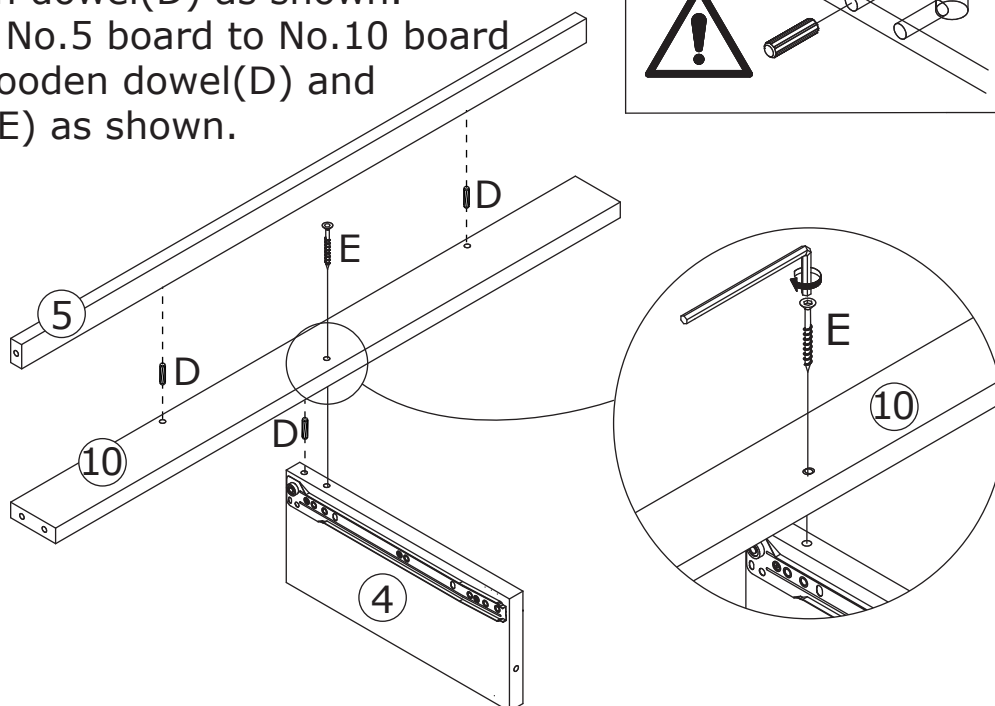

3

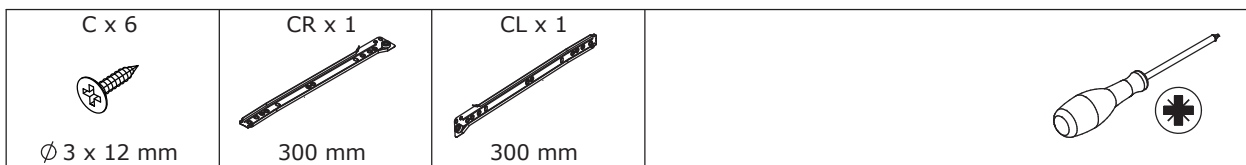

Fix slide rail(CR) and (CL) to No.3 board and No.2 board respectively as shown.
Please pay attention to the holes where the accessories are inserted.

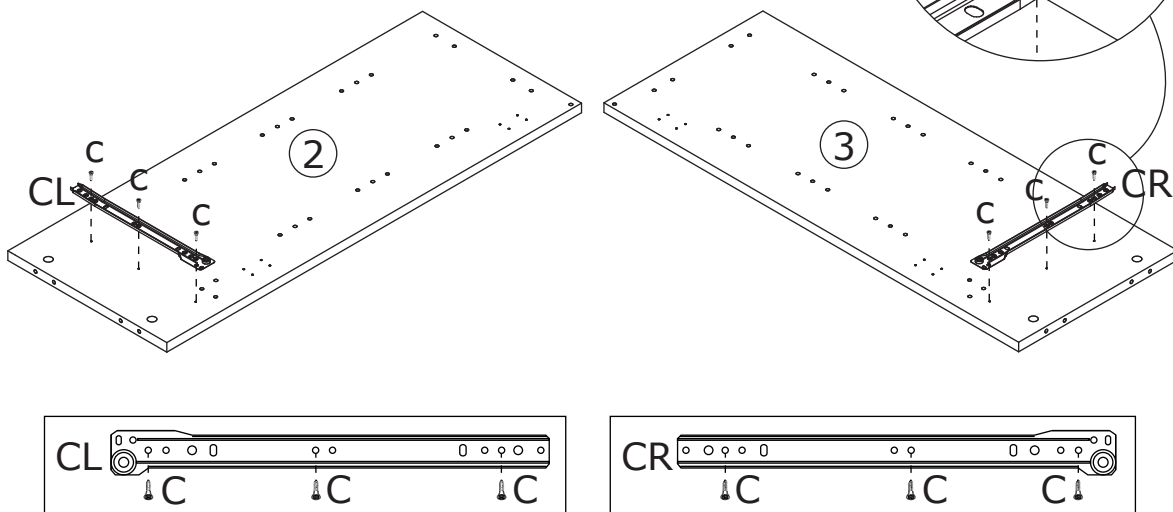

4

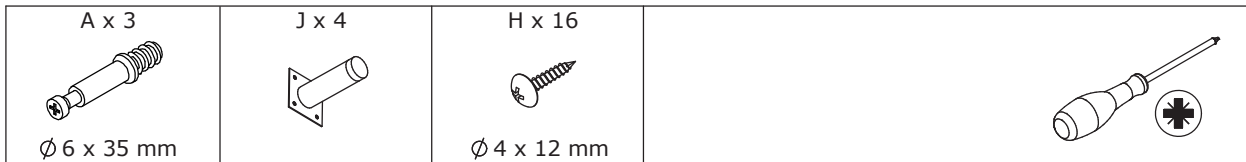

Insert screw(A) into No.12 board with screwdriver as shown.
Fix leg(J) to No.6 board with screw(H) as shown.

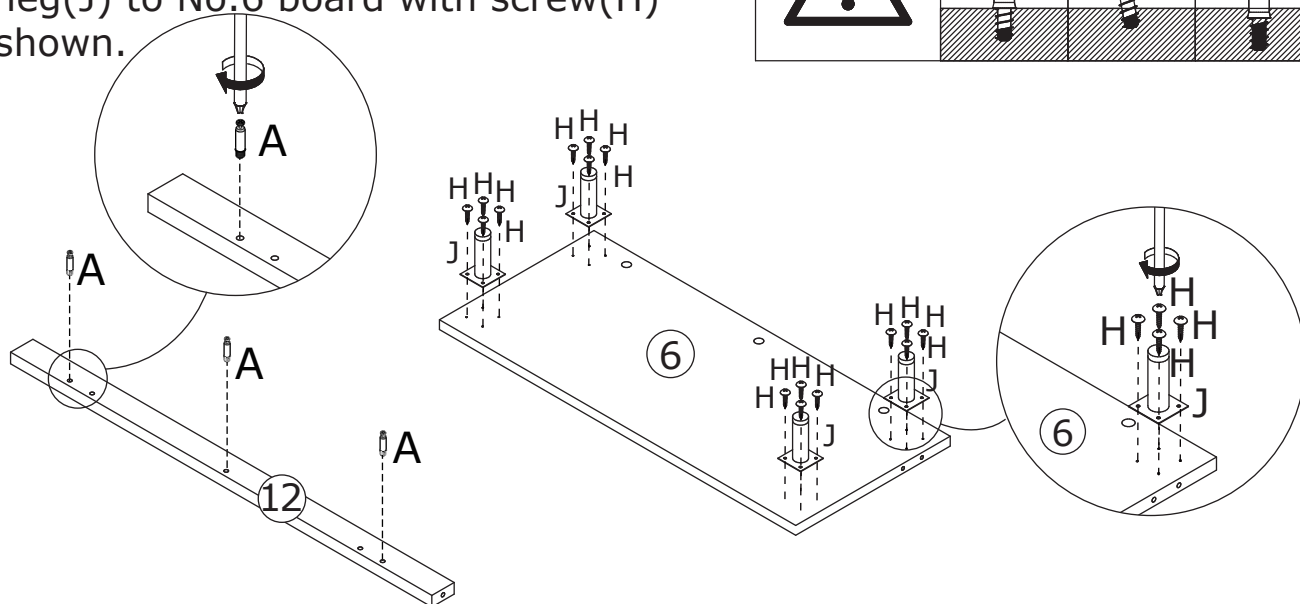
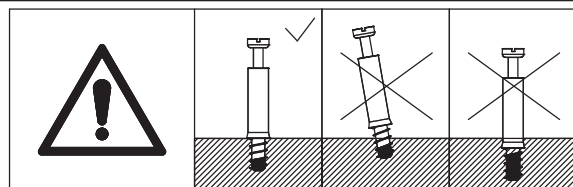

5

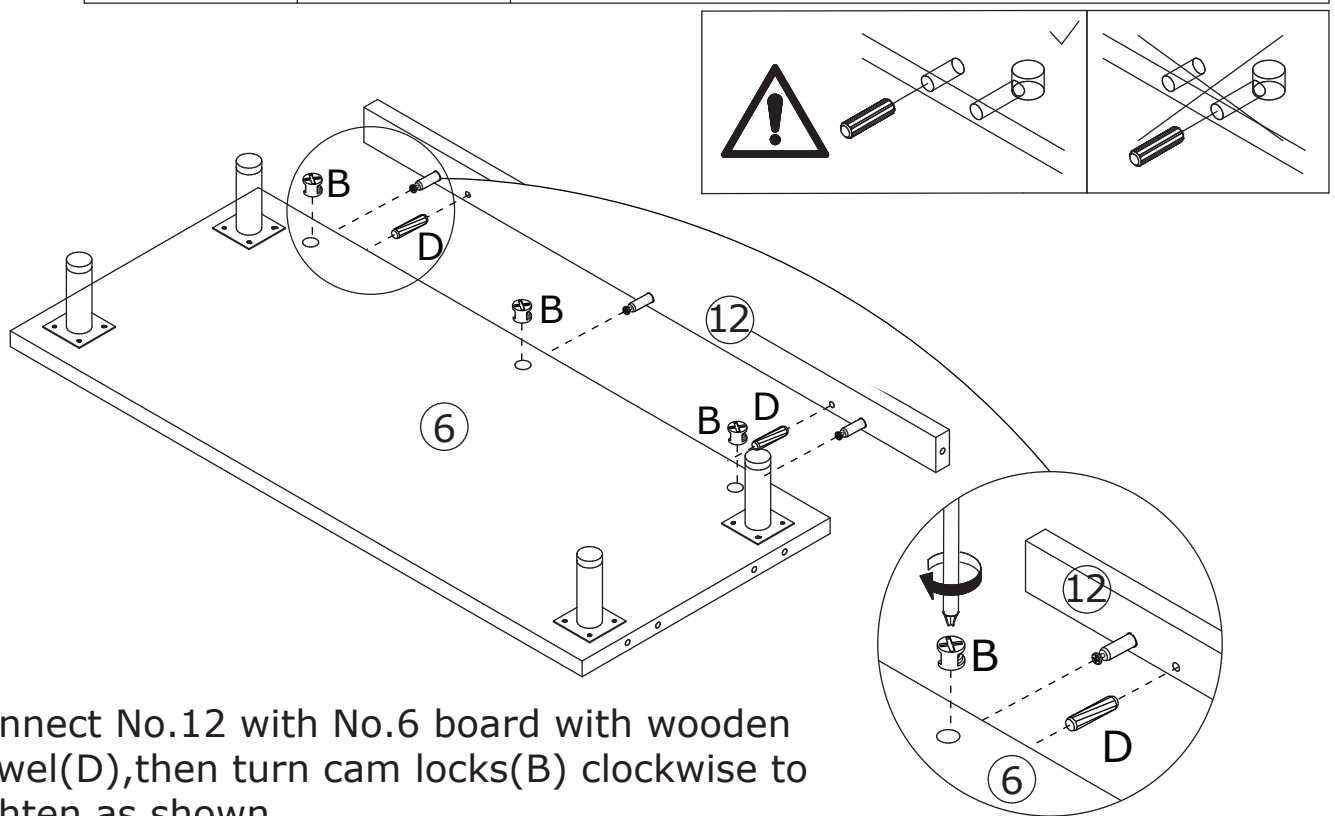

Connect No.12 with No.6 board with wooden dowel(D),then turn cam locks(B) clockwise to tighten as shown.

6

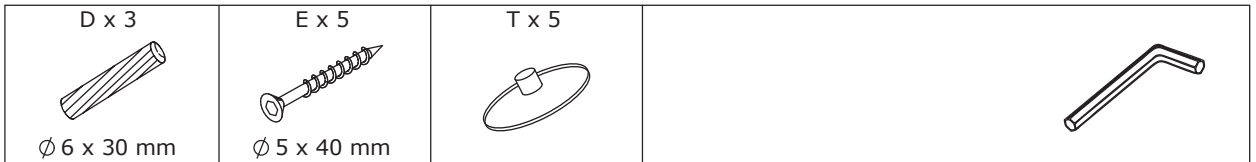

Connect No.2 board with two assembled components using wooden dowel(D) at first.

Fix No.2 board with screw(E), and cover part(T) to screws as shown.

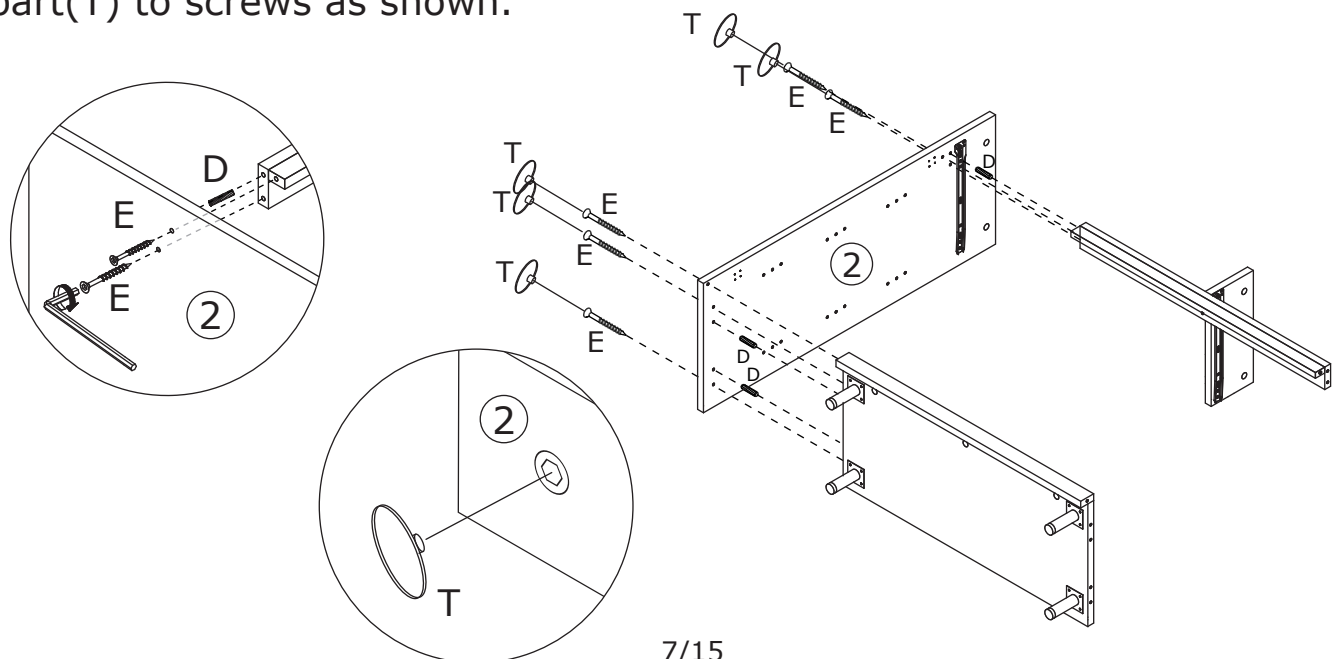
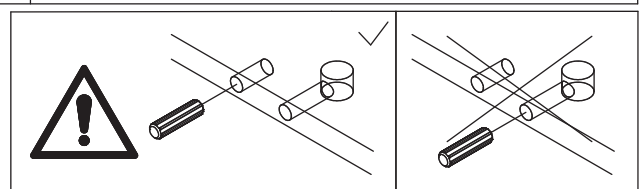

7

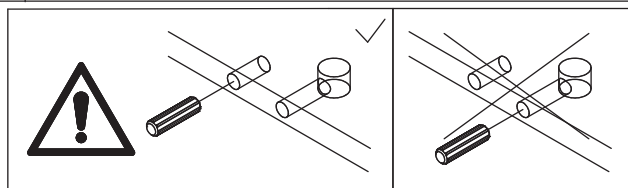
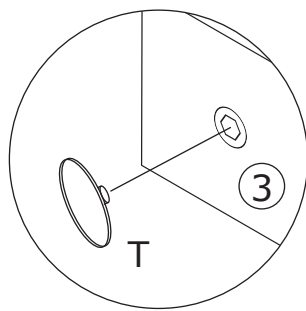
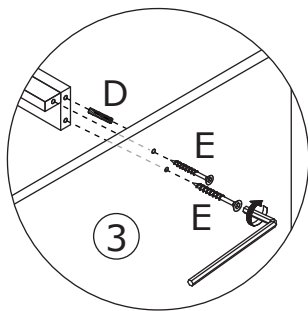
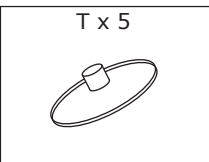
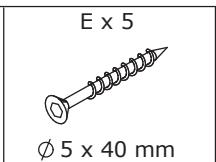
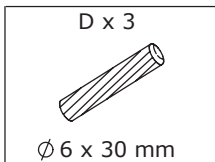

Connect No.3 board with the assembled component using wooden dowel(D) at first. Fix No.3 board with screw(E), and cover part(T) to screws as shown.

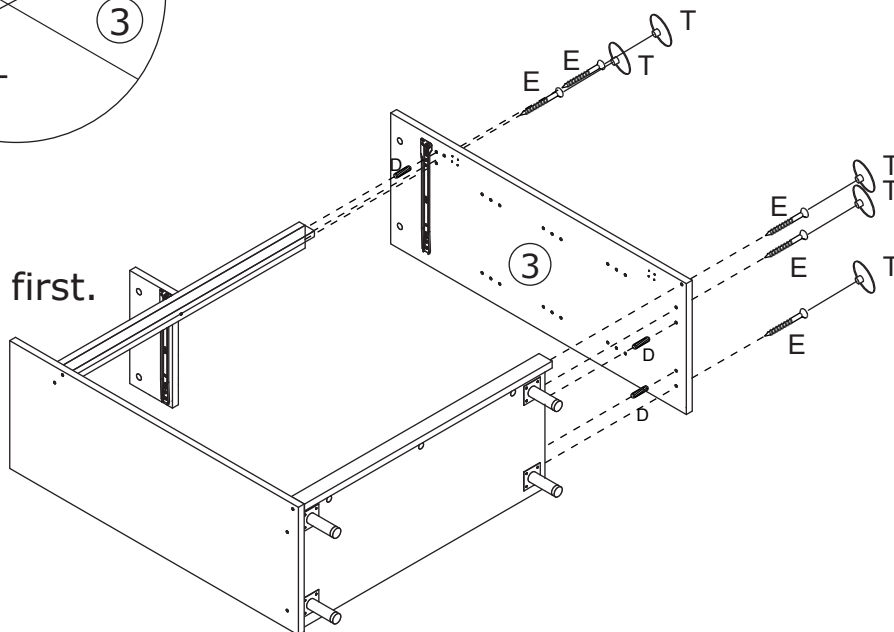

8

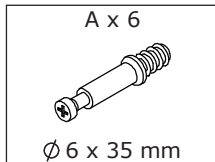

Insert screw(A) into No.1 board with screwdriver as shown. Please pay attention to the holes where the accessories are inserted.

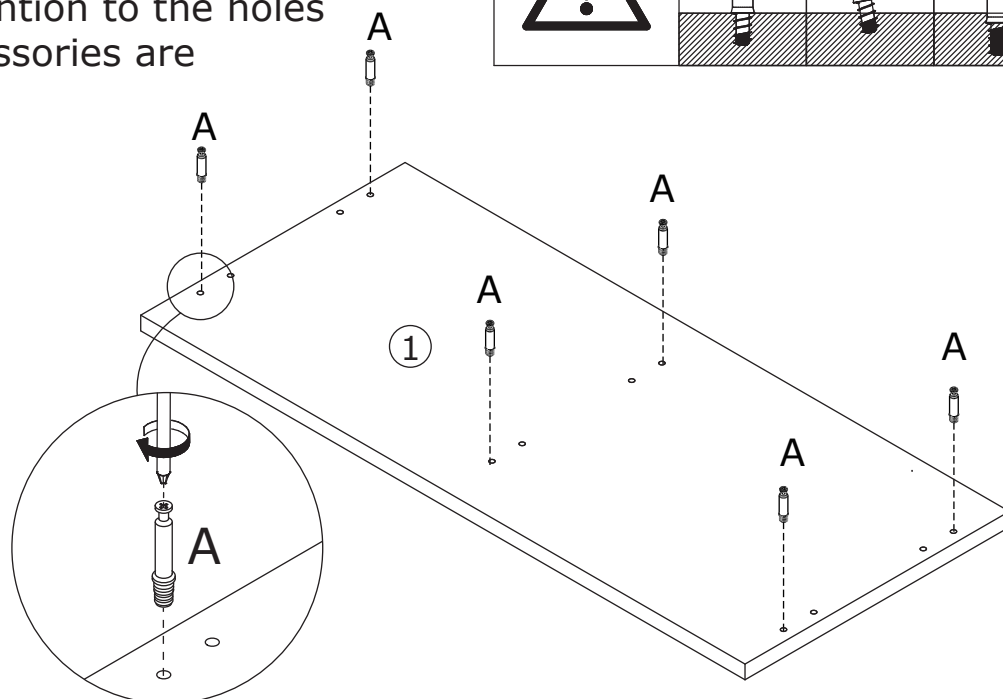
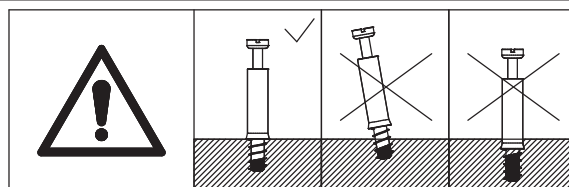

9

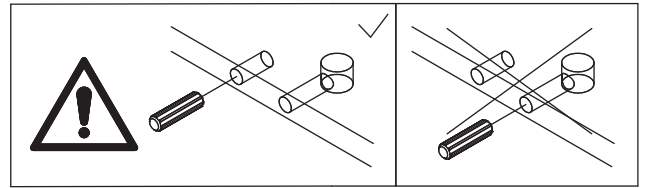
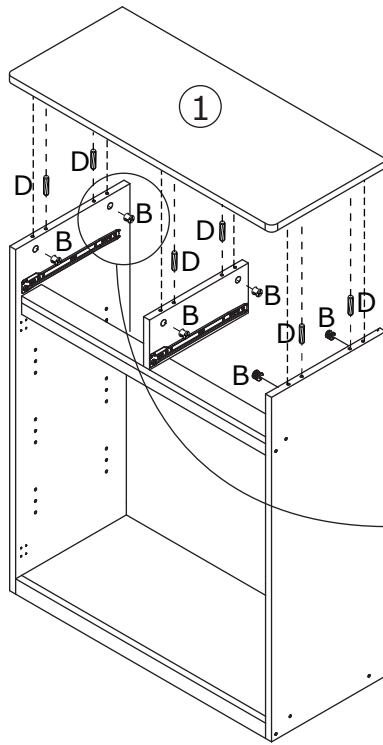
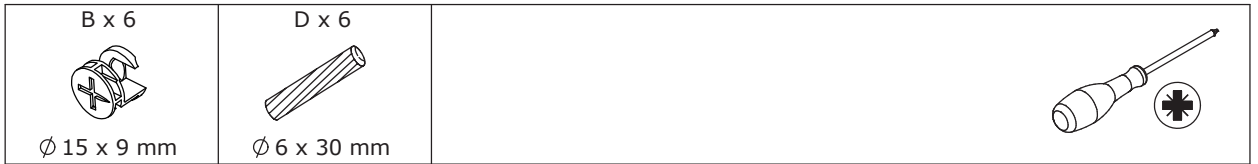

Cover No.1 board to the assembled unit with wooden dowel(D), then turn cam locks(B) clockwise to tighten as shown.

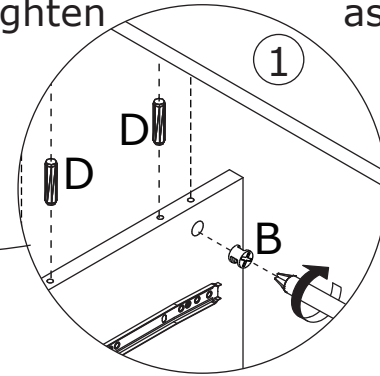

10

Connect each No.11 board with No.19 as shown.

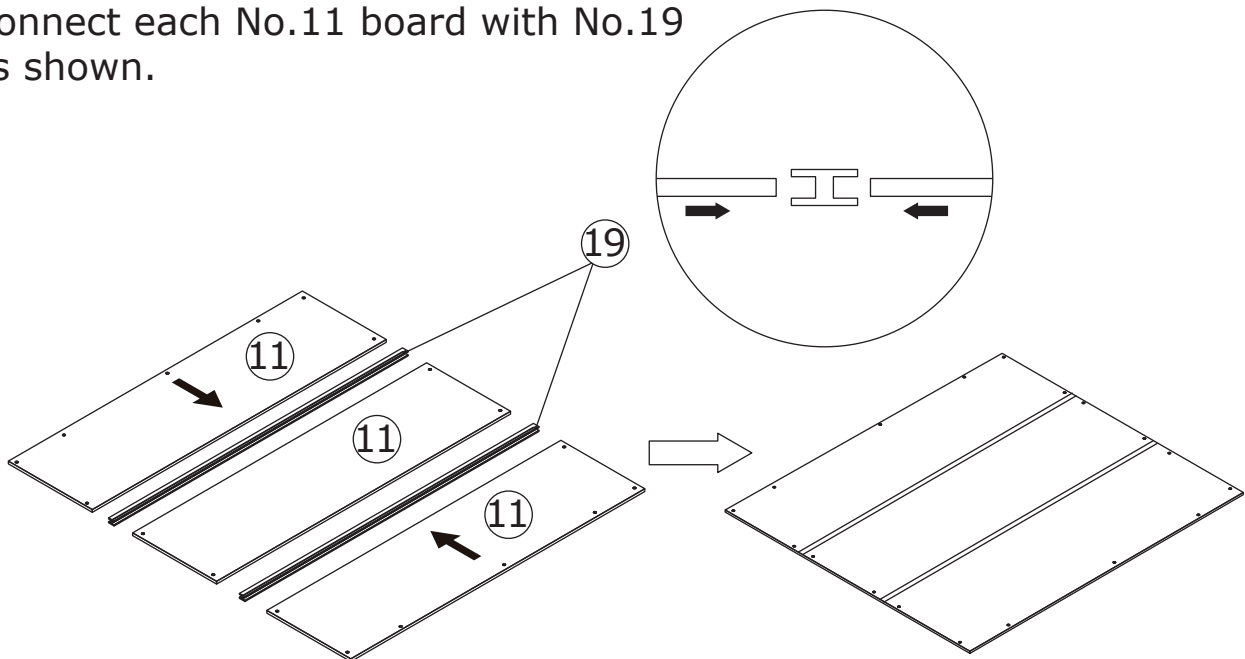

11

E x 18

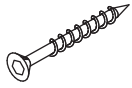

Ø 5 x 40 mm



Fix back boards with screw(E) as shown.
Please note don't use an electric
screwdriver or use force to rotate,
may cause board crack.

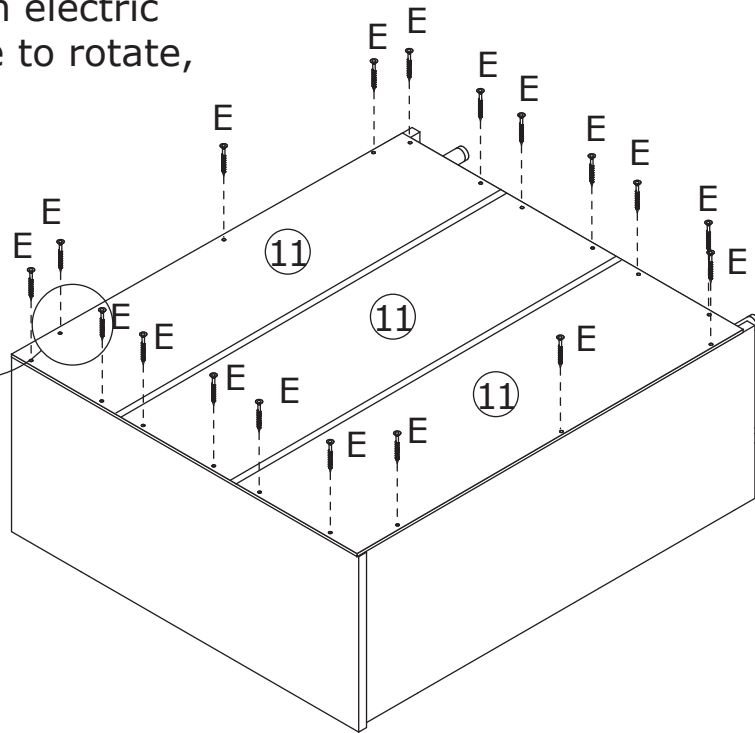
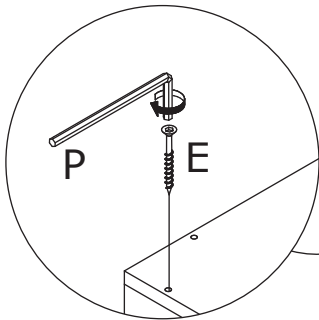

12

Insert part(G) into the side
boards, and put into No.7
board as shown.

OR

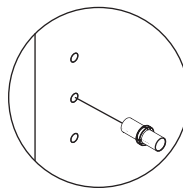

OR

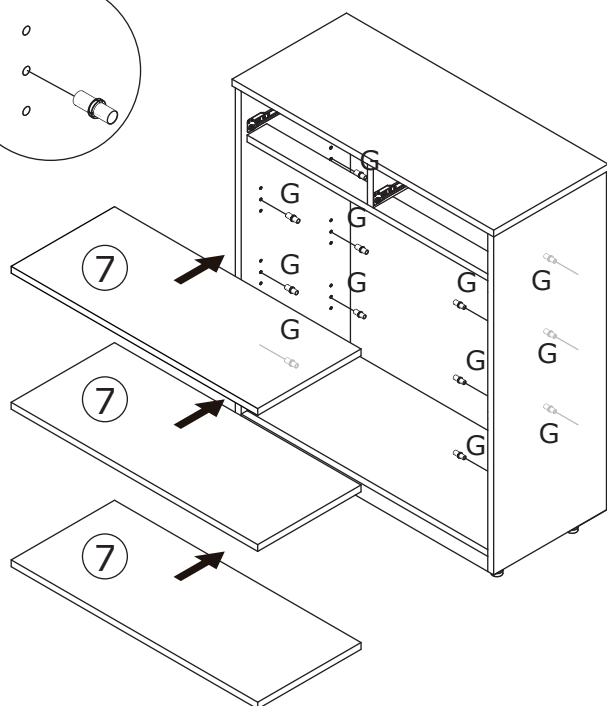
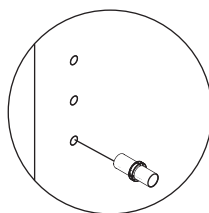

13

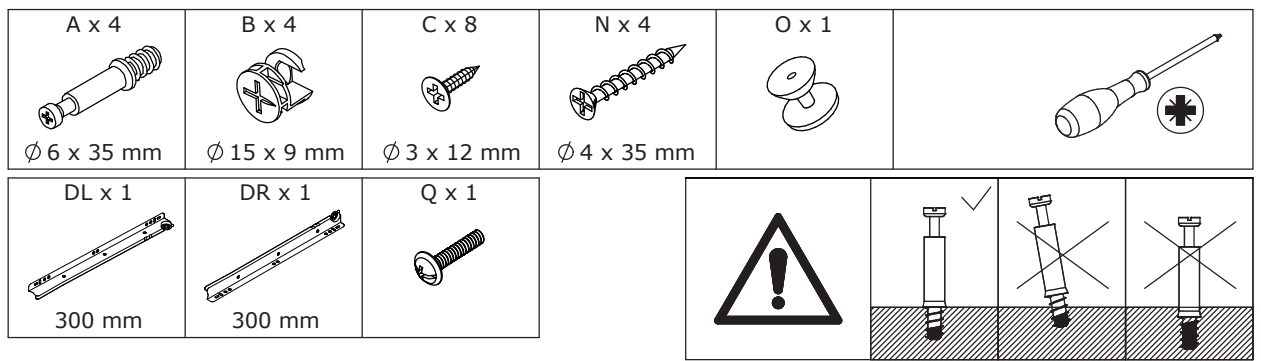

Connect No.14 and No.16 board with No.15 using screw(N).

Insert screw(A) into No.18 board at first, fix handle(O) to the board with screw(Q).

Attach No.18 board to the component, then turn

cam locks(B) clockwise to tighten as shown.

Insert No.17 board into available slots as shown.

Fix slide rail(DL) and (DR) to No.14 and No.16 board respectively as shown.

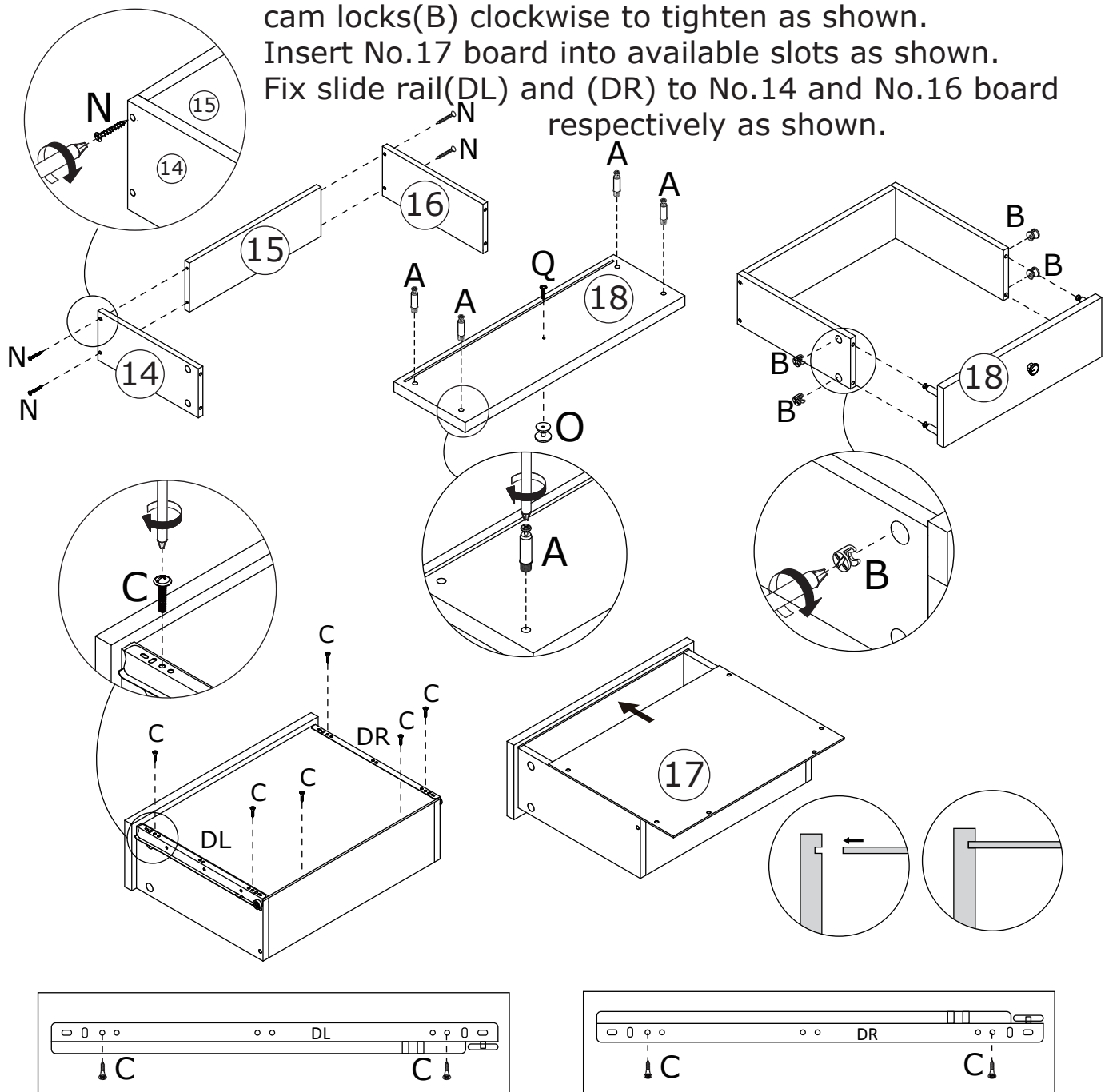
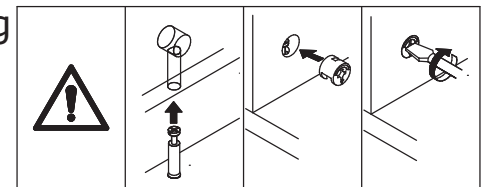

14

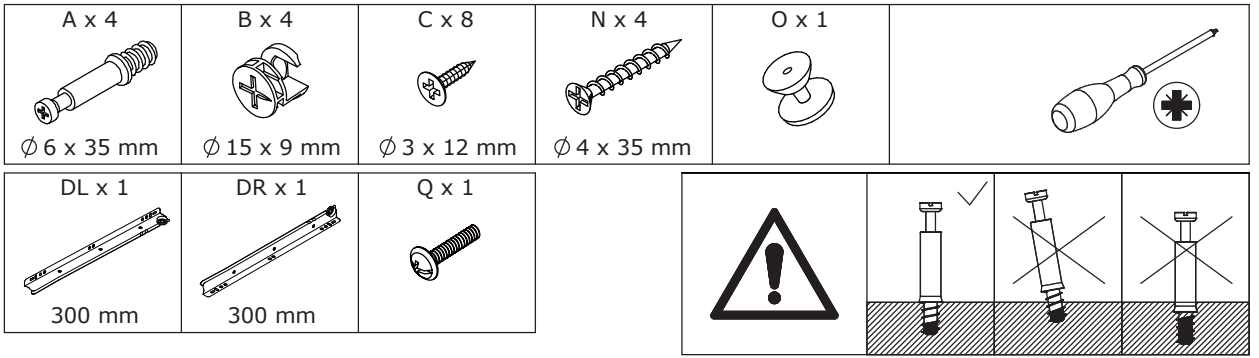

Connect No.14 and No,16 board with No.15 using screw(N).

Insert screw(A) into No.13 board at first, fix handle(O) to the board with screw(Q).

Attach No.13 board to the component,then turn cam locks(B) clockwise to tighten as shown.

Insert No.17 board into available slots as shown.

Fix slide rail(DL) and (DR) to No.14 and No.16 board respectively as shown.

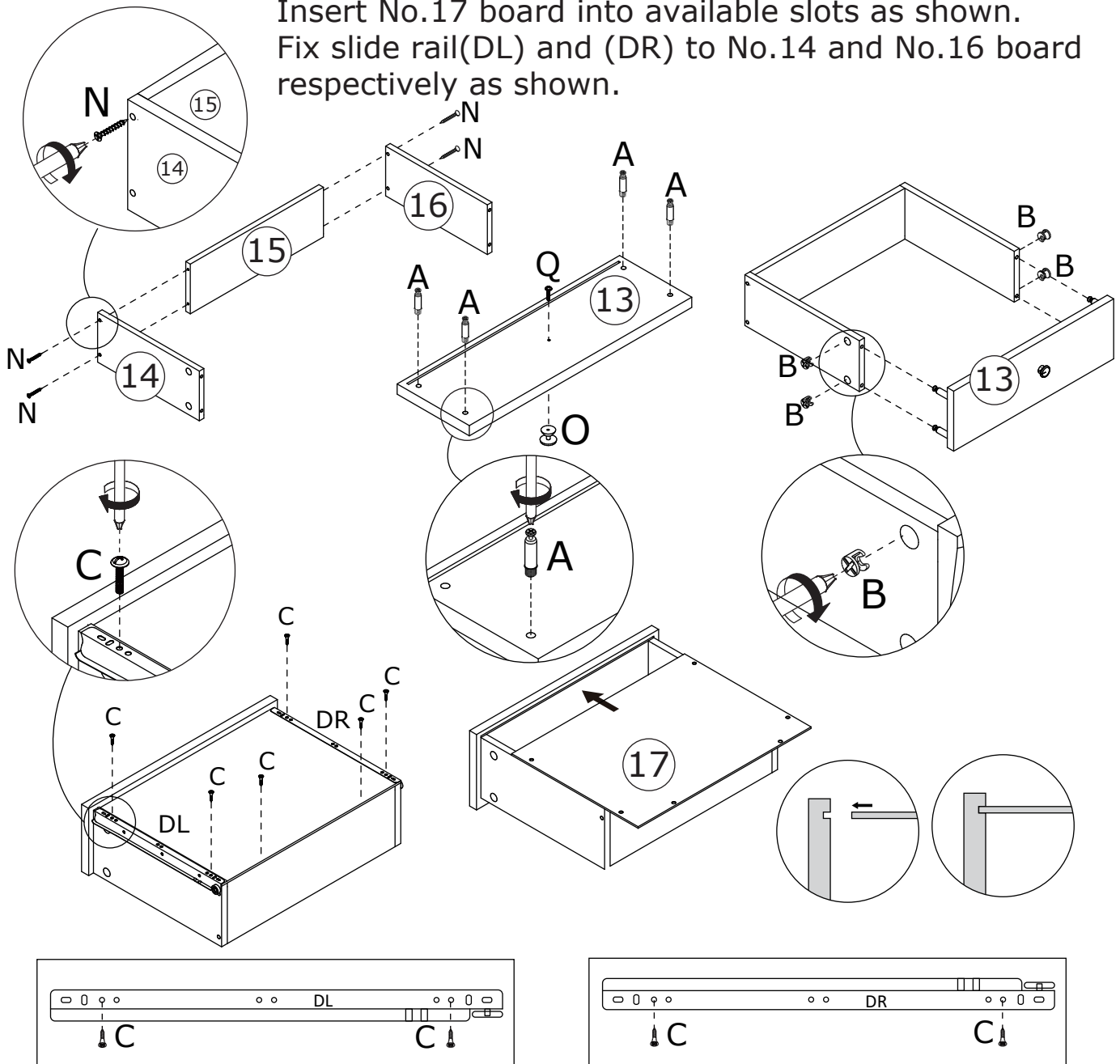

15

C x 8



Ø 3 x 12 mm

F x 4

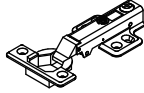

K x 2

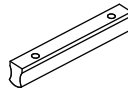

Q x 4



Fix hinge(F) to No.8 and No.9 board with screw(C) as shown.
Fix handle(K) to both board with screw(Q) as shown.

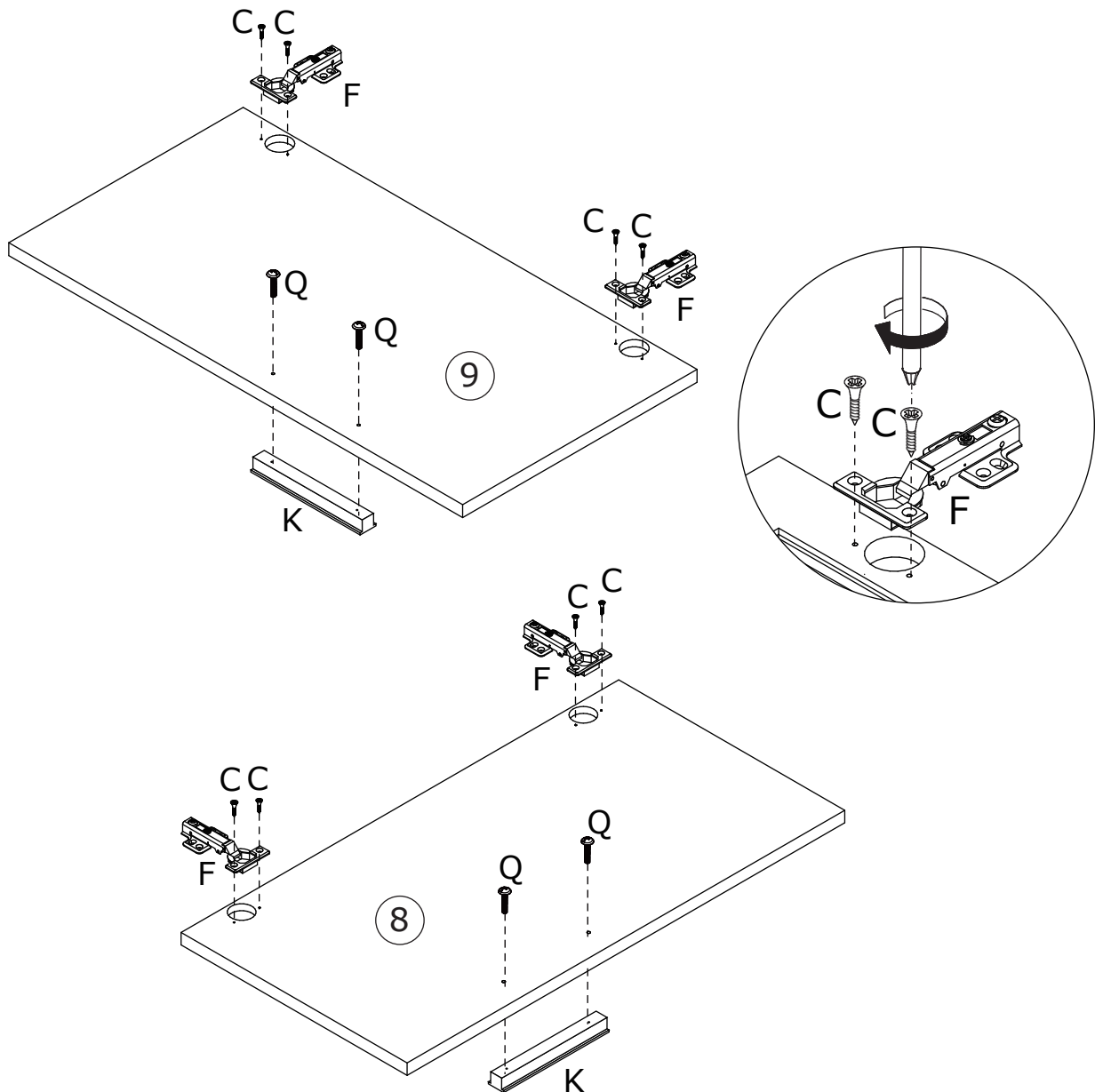

16

C x 18



Ø 3 x 12 mm

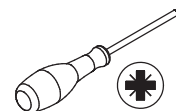

Attach No.8 board to left, No.9 to right side by fixing hinge using screw(C) as shown.

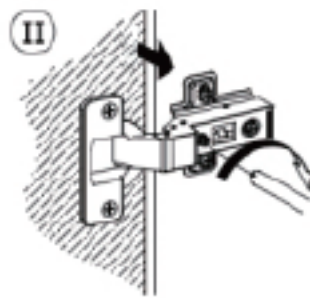
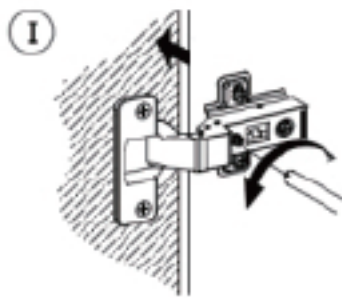
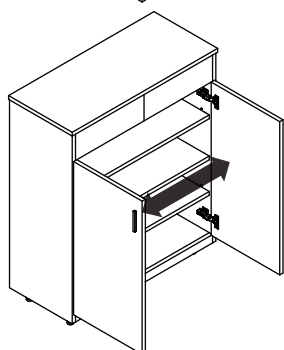
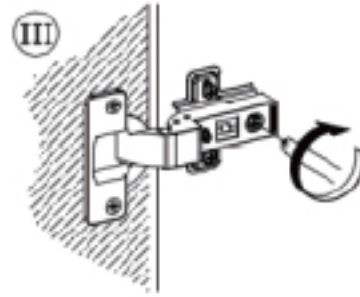
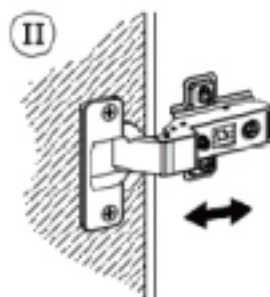
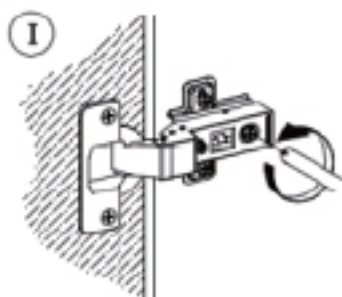
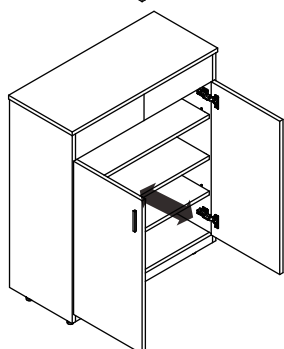
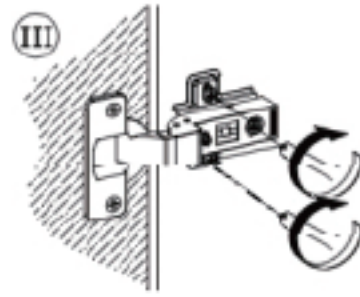
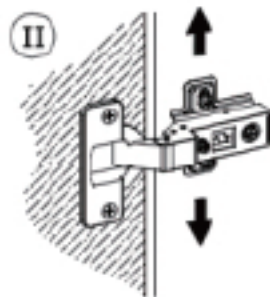
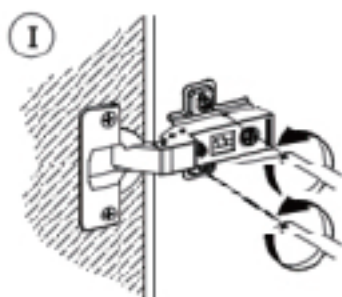
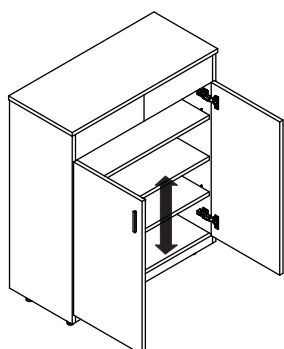
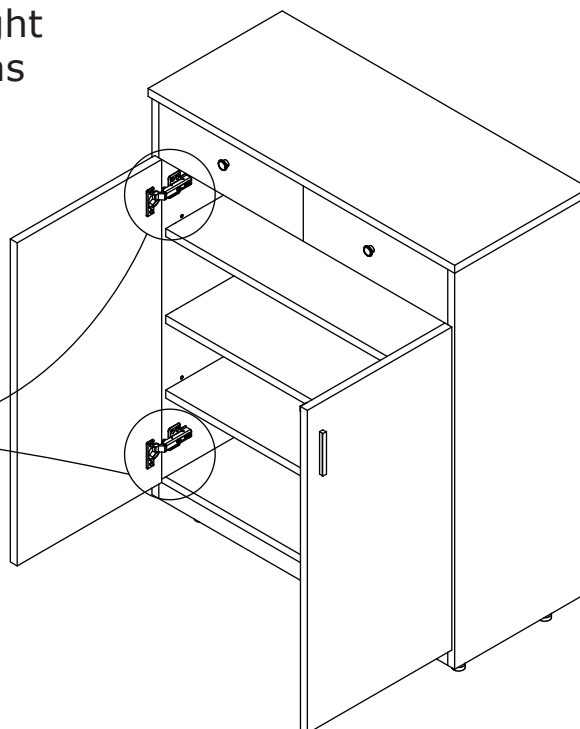
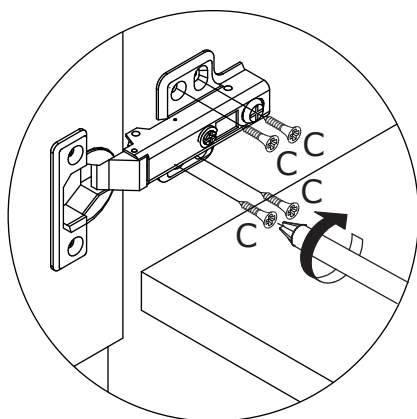

17

L x 1

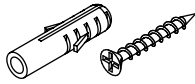

M x 1

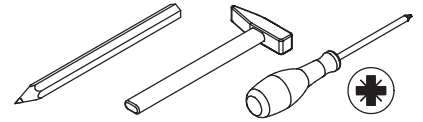

For the safety of use, it is recommended to install the anti-tipping device(L)and (M) as shown.

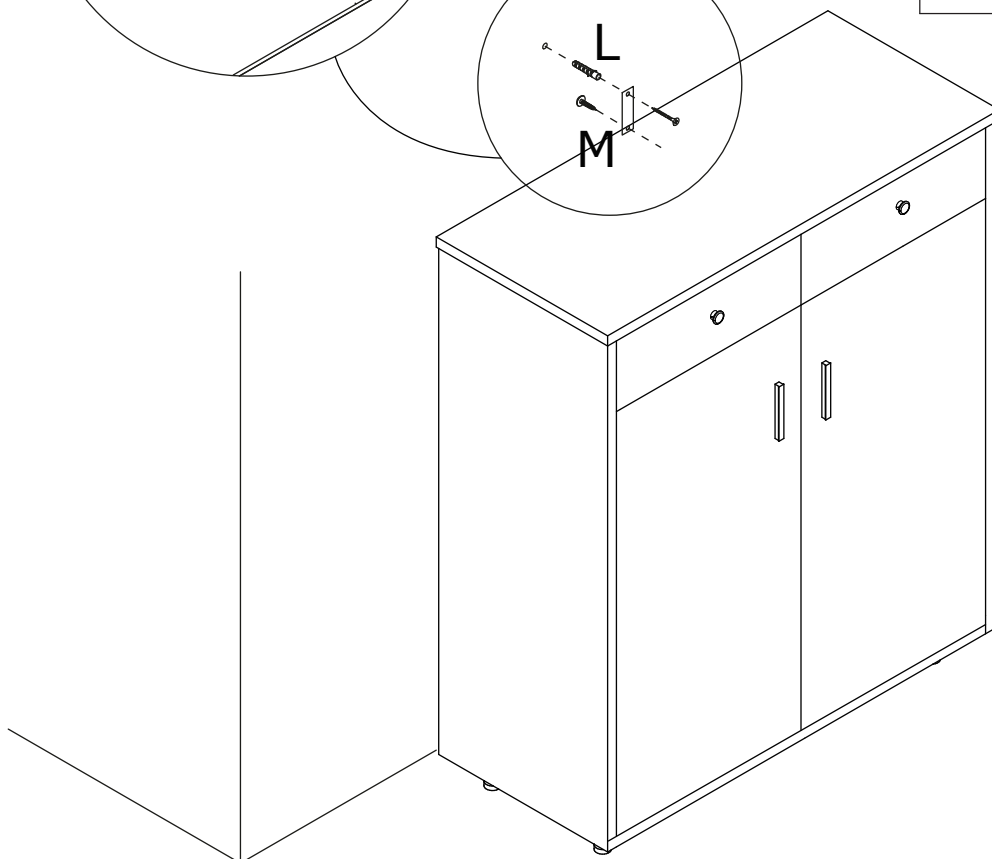
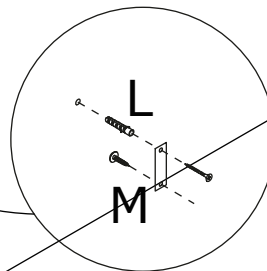
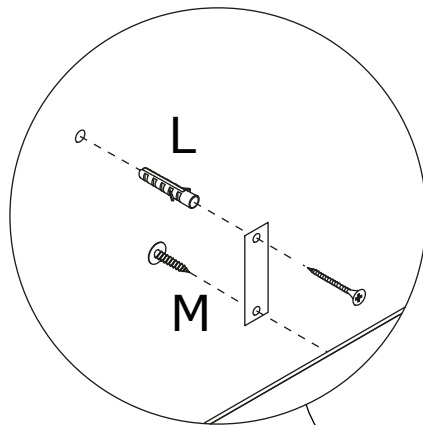
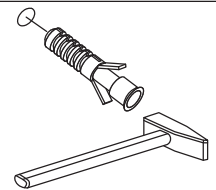
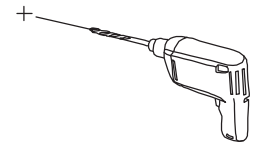
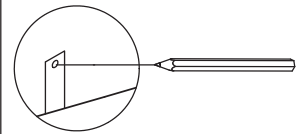

WARRANTY

WARRANTY CLAIMS

- There is a 30-day warranty for broken furniture or any other problems that do not work properly. The warranty will start from the date of purchase which must be verified by proof of purchase.
- Before making a claim, we may be able to answer your query, simply visit for further information. Our dedicated After-sale Team will endeavour to answer all messages within 48 hours. Please leave your purchase order number, along with some details of the problem, if you want a replacement part. We will arrange within 48 hours. If there is out of stock, we will reply with a shipping date.
- The product must be used in accordance with the instructions provided. For health reasons.
- For other reasons, if the furniture needs to be returned, it must be cleaned and dried and operated within 30 days of receipt.

Type of Warranty Claim

- Failure to follow the furniture instructions will invalidate the warranty. Attention please.
- Does not include damage during installation, but includes damage during transportation.

Scope of responsibility

- Shall not bear any responsibility for misuse or user damage and / or loss of parts during the installation of furniture.
- After using, the damage and scratches of the furniture are not covered by the warranty.

The Warranty Relates to All Bought in The Us and Covers The Following Areas

- Sheet parts: 1 months from the date of purchase.
- Electrical parts: 1 months from the date of purchase.

RETURNS

CHANGED YOUR MIND AND NEED TO RETURN YOUR ITEM?

PLEASE FOLLOW THE BELOW INSTRUCTIONS:

- If you have purchased and have simply changed your mind, follow the retailer's instructions for returns.

DEFECTIVE ITEMS

- If your item is defective in any way, i.e. it doesn't work but you can't identify why, in the first instance, please consult our FAQ section at feedbackstation@163.com as there may be a simple solution to the issue.

DAMAGED ITEMS

- If you receive an order with obvious shipping damage from the retailer, then we suggest the delivery is refused. If the delivery has been accepted and then shipping damage is found, please follow the specific instructions advised by the retailer.
In all circumstances please save all packaging material and paperwork for the order. Please be aware that if you dispose of packaging material or attempt to return the merchandise without contacting the fulfiller, you jeopardise your chances of making a claim, and you may not receive a credit for the return.