

General Installation Instructions

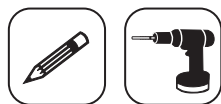

Tools Required for Assembly: (Not Included)

- Pencil • Hammer • Phillips head screwdriver and bit • Power drill
- 5/16 in. drill bit (drywall anchor) or 9/32 in. (molly bolt)



Helpful Tools: (Not Included)

- Level
- Safety glasses

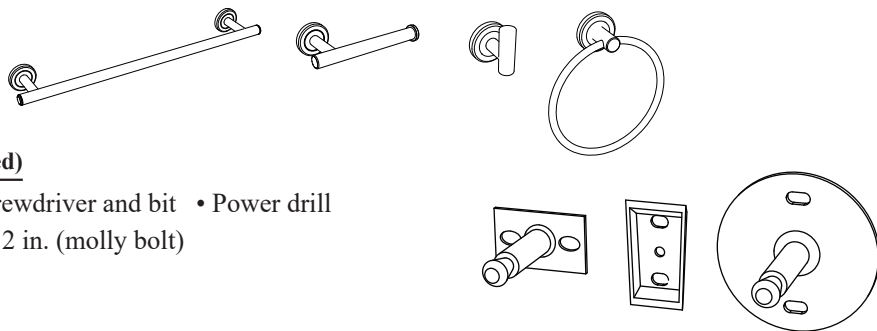

Note: bracket designs may vary.



CAUTION: Drywall anchors are for drywall only. Use tile anchors for tile surfaces.

Refer to the included hardware to determine which installation to follow



Toggle Anchor Installation

- Outline the back plate. Then center bracket and mark position of the screw holes.

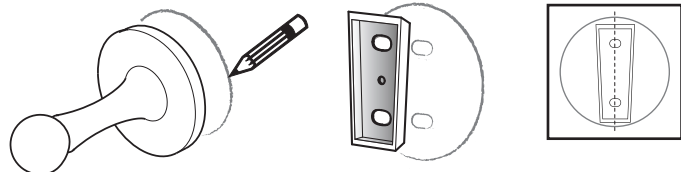

- Drill 5/16 in pilot holes. Using a hammer tap drywall anchors flush into the wall.

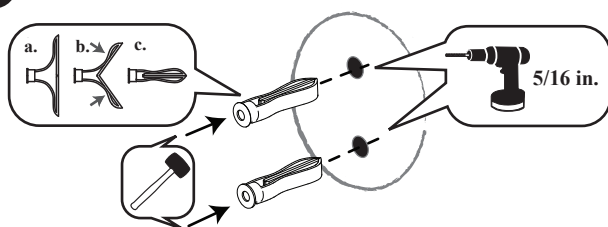

Insert the red push pin into the drywall anchors until the wings pop open. Then remove the pin.

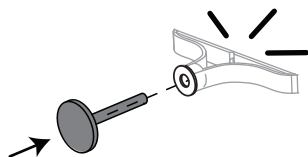

- Place bracket over anchors and tighten screws firmly with Phillips head screwdriver.

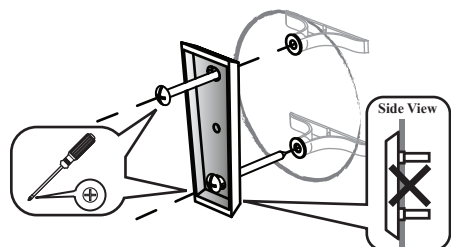

Secure the end piece with Allen wrench and set screw.

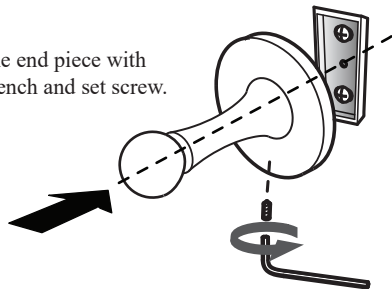

Molly Bolt Anchor Installation

- Outline the back plate. Then center bracket and mark position of the screw holes.

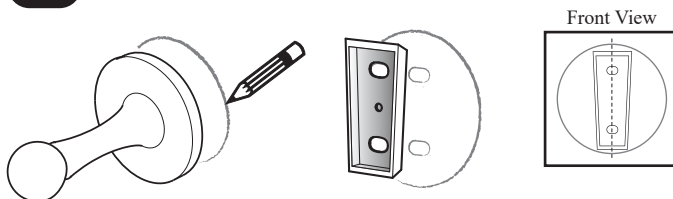

- Drill 9/32 in. pilot holes. Using a hammer tap molly bolt anchors flush into the wall.

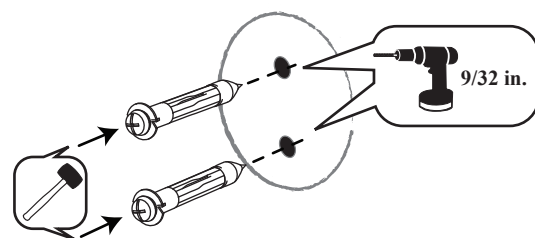

Use a power drill to tighten the screws to collapse molly bolts tightly to the wall. ①

Unscrew the screws from the molly bolts. ②

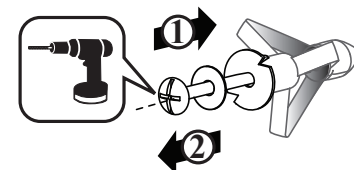

- Place bracket over anchors and tighten screws firmly with Phillips head screwdriver.

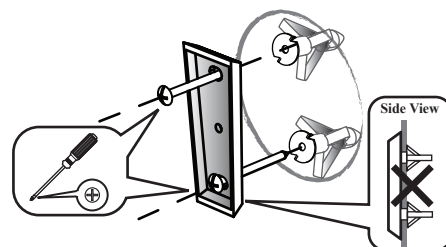

Secure the end piece with Allen wrench and set screw.

