

2 Ft. LED Linkable Grow Strip Light

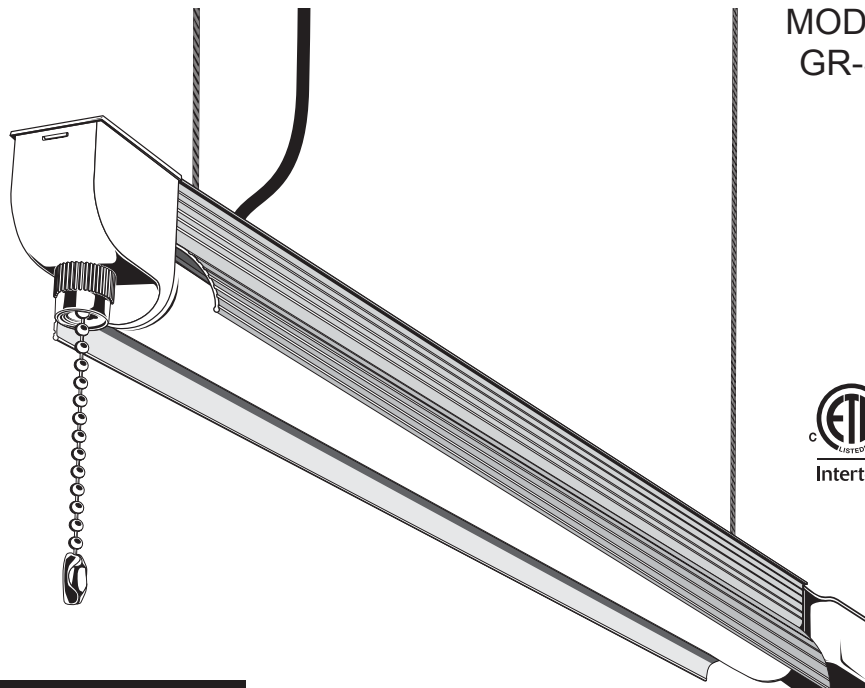

PACKAGE CONTENTS

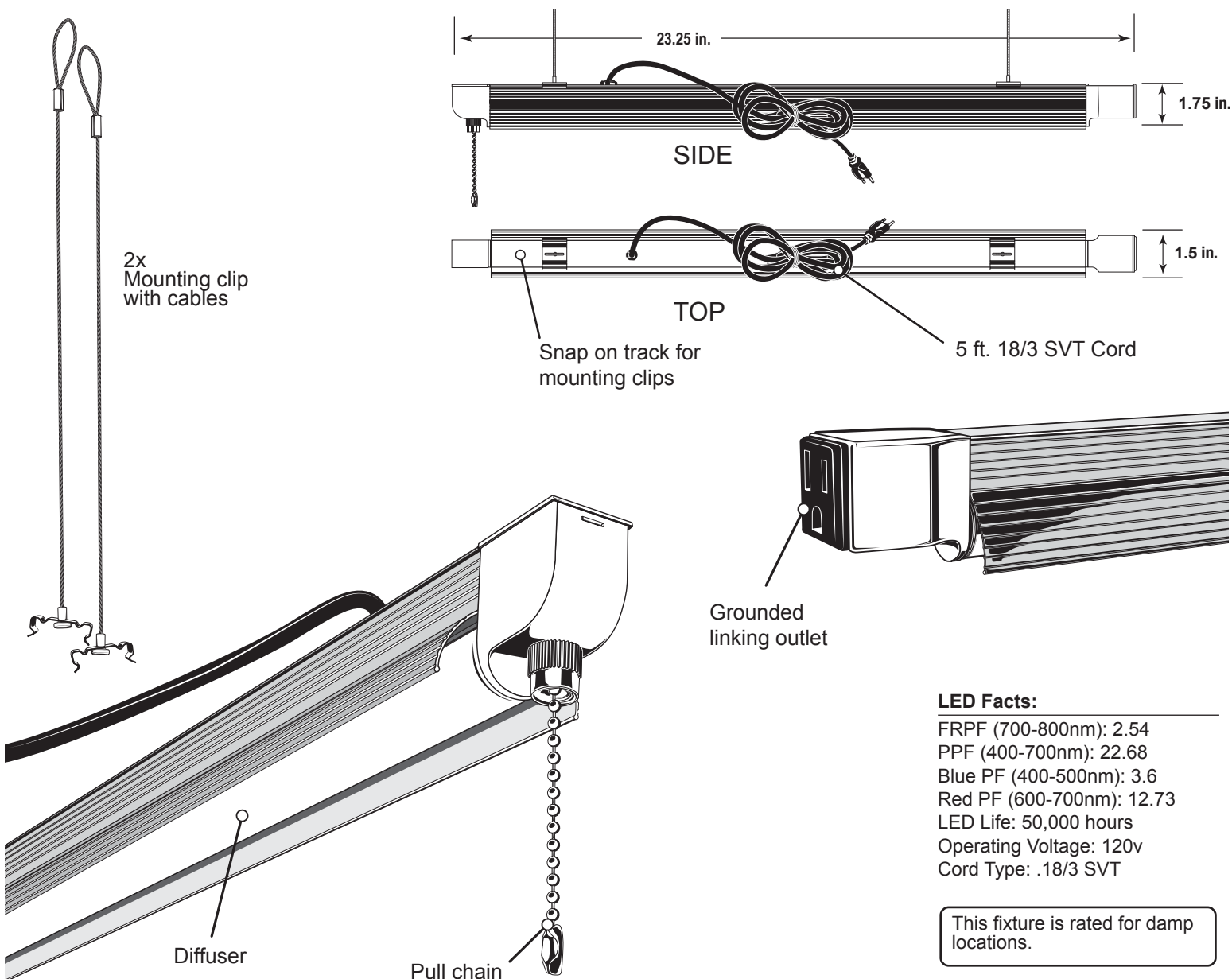

LED Facts:

FRPF (700-800nm): 2.54
PPF (400-700nm): 22.68
Blue PF (400-500nm): 3.6
Red PF (600-700nm): 12.73
LED Life: 50,000 hours
Operating Voltage: 120v
Cord Type: .18/3 SVT

This fixture is rated for damp locations.

⚠️ WARNINGS

⚡ WARNING: TO AVOID ELECTRIC SHOCK, DISCONNECT POWER BEFORE INSTALLING

⚠️ WARNING: This product may represent a possible shock or fire hazard if improperly installed or mounted. Products should be installed following these instructions, local electrical codes and/or the current National Electric Code (NEC).

⚠️ WARNING: DO NOT alter or disassemble the fixture it is completely enclosed and does not contain replaceable or serviceable parts.

⚠️ WARNING: Before installation, plug in fixture to a 120v, 60Hz electrical outlet to check for proper operation. Then, unplug and begin the installation.

⚠️ WARNING: BURN HAZARD! Light fixture is hot, allow cooling time before touching.

⚠️ CAUTION: Personal injury can occur, along with damage to the fixture and/or mounting surface may result if the fixture is pulled from the surface. To prevent premature failure from overheating, fixture should only be installed in environments where the operating temperatures are between -4° to 113°F (-20° to 45° C).

⚠️ WARNING: Do **NOT** look directly at LED light sources.

⚠️ WARNING: This product has a grounded plug (two contact blades and a grounding prong) as a feature to reduce the risk of electric shock. The plug is fashioned to only fit in a grounded outlet one way. If it does not fit, contact a qualified electrician. Never use with an extension cord unless plug can be fully inserted. **DO NOT ALTER THE PLUG OR CORD.**

⚠️ WARNING: Use only in 120v, 60Hz circuits.

⚠️ WARNING: This product is not waterproof.

⚠️ SAFETY AND PRECAUTIONS

• Shut off power to electrical outlet before installing or servicing this fixture.

1. Suitable for damp location use.
2. Do **NOT** install over stoves.
3. Do **NOT** look directly at LED light sources.
4. The LED modules used in this fixture are not serviceable.
5. **This product is inspected prior to shipping.** Do not use if product is cracked, broken or missing parts.
6. Suitable for use in operating environments ranging between -4° to 113°F (-20° to 45° C).
7. Electrical requirements can be found on back of the fixture.
8. Do not mount where fixture may come in contact with water.

ADDITIONAL WARNINGS

This device complies with Part 15 of the FCC rules. Operation is subject to the following two conditions: (1) This device may not cause harmful interference, and (2) this device must accept any interference received, including interference that may cause undesired operation. Warning: Changes or modifications to this unit not expressly approved by the party responsible for compliance could void the user's authority to operate the equipment. The user is cautioned that any changes or modifications not expressly approved by the party responsible for compliance could void the user's authority to operate the equipment. Note: This equipment has been tested and found to comply with the limits for a Class B digital device, pursuant to Part 15 of the FCC rules. These limits are designed to provide reasonable protection against harmful interference in a residential installation. This equipment generates, uses and can radiate radio frequency energy and, if not installed and used in accordance with the instructions, may cause harmful interference to radio communications. However, there is no guarantee that the interference will not occur in a particular installation. If this equipment does cause harmful interference to radio or television reception, which can be determined by turning the equipment off and on, the user is encouraged to try to correct the interference by one or more of the following measures: 1) Reorient or relocate the receiving antenna. 2) Increase the separation between the equipment and receiver. 3) Connect the equipment into an outlet on a circuit different from that of the receiver. 4) Consult the dealer or an experienced radio/TV technician for help.

DIMMING

- **DO NOT USE THIS FIXTURE WITH DIMMERS.**
Doing so will void the warranty of this product.

INSTALLATION INSTRUCTIONS

Install the fixture before plugging it into an electrical outlet. Be sure to locate fixture within 5 ft. of the power supply.

Install the fixture between 12 in. to 39 in. above the top of the plants (**Fig. 1**).

Set the height of the grow light so the center of the light shining down does not create a "hot spot", the light will be too focused on a specific area and may decrease the light absorption in the plants at the perimeter of the coverage area.

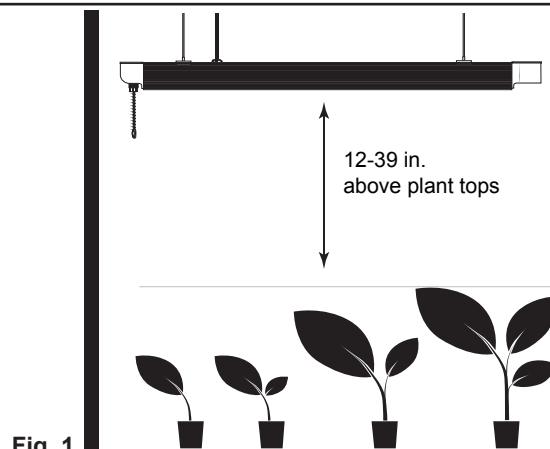

INSTALLATION INSTRUCTIONS

Before installation, cut off power to the electrical outlet.

1. Install the mounting clip with cable to the top side of the fixture along the mounting track that the runs most of the length of the fixture (**Fig. 2**). Lower the clip onto the track. Hook to one side (**Fig. 3**) and press down (**Fig. 4**) until the clip snaps into place (**Fig. 5**). Attach the hanging cables to the ceiling (The actual mounting of the hanging cables to the ceiling or stand is not covered in these instructions). The mounting clips with cables are only designed to hold the weight of the fixture safely.

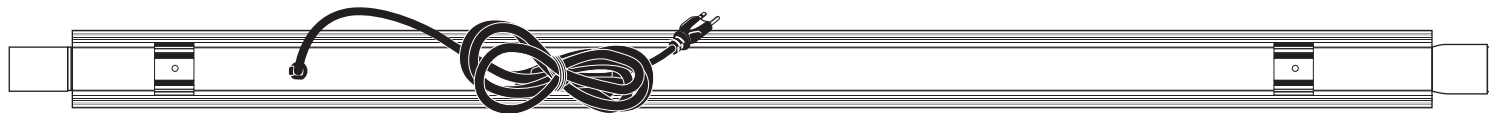

Fig. 2

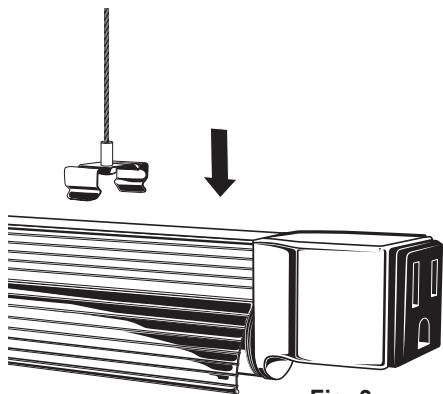

Fig. 3

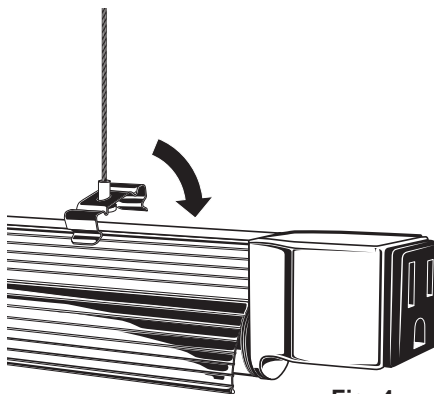

Fig. 4

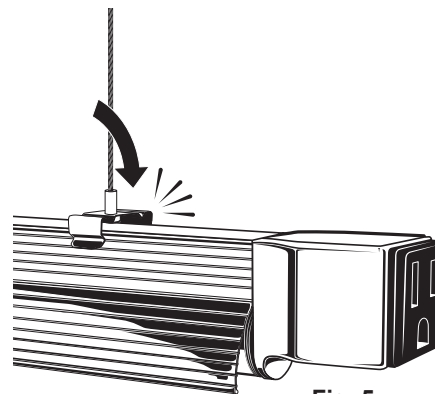

Fig. 5

2. Installation is now complete. Plug the fixture in.

RECOMMENDED

It is recommended the power cord be secured to one of the hanging support chains with cable ties (not included) (**Fig. 6**).

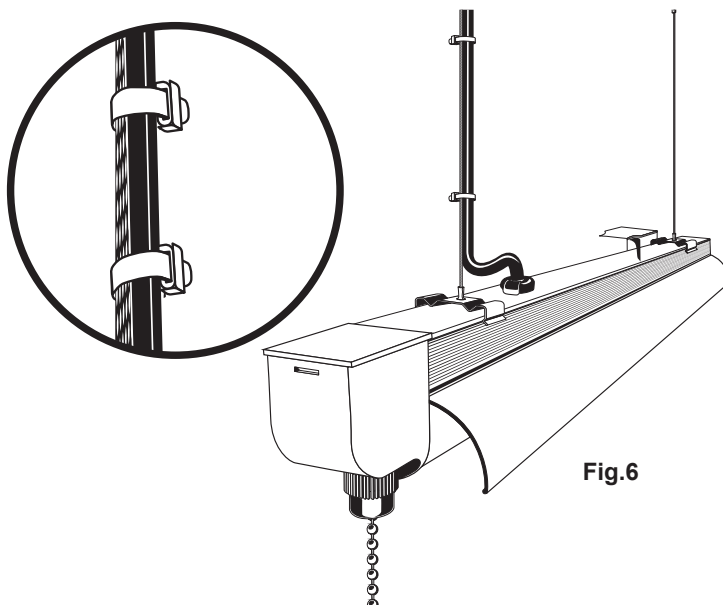

Fig.6

OPERATION

1. Pull the chain switch down to turn the light on and off (**Fig 7**).

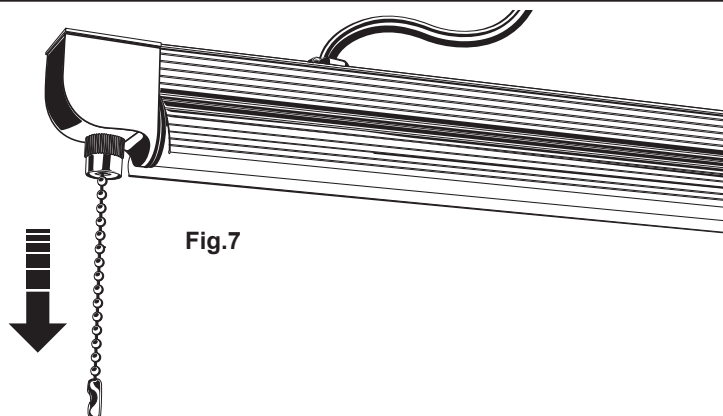
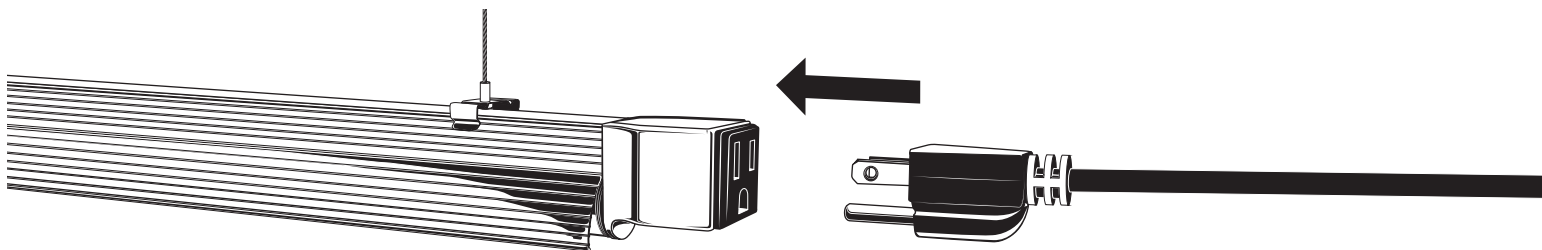

Fig.7

LINKING ADDITIONAL UNITS

This fixture can be linked with #GR-SHP2L and #GR-SHP4L fixtures and up to a maximum of 288 total watts.

1. To link additional lights, unplug the first fixture the additional light will link to. Repeat Step 1 for the additional fixtures. A maximum lights connected on one string of lights **MUST NOT EXCEED A TOTAL OF 2A**. Plug each additional light into the preceding unit (**Fig. 10**). Repeat as necessary. Restore power.



NOTE: For optimal results, the maximum distance between any two linking fixtures should not exceed 12 inches, especially mounted over longer plant beds.

CLEANING INSTRUCTIONS

Disconnect power to fixture before cleaning. Using a soft cloth, clean the fixture using a mild, non-abrasive glass cleaner. DO NOT use solvents. DO NOT use cleaners containing abrasive agents. NEVER spray liquid cleaner directly onto the LEDs, fixture or wiring.

TROUBLESHOOTING GUIDE

Before starting work to connect the fixture, shut off power supply at the circuit breaker panel to avoid electrical shock.

Problem	Probable Cause	Solution
Fixture does not turn on.	1. Faulty switch. 2. Power is off.	1. Test switch or replace it. 2. Verify power supply is on.
Circuit breaker trips or fuse blows when light is turned on.	1. Discontinue use immediately.	1. Call an electrician.

3 YEAR LIMITED WARRANTY

This product is guaranteed against failure due to factory defects in materials or workmanship for three (3) years from the date of purchase. This warranty is non-transferable and applies only to the original owner. Proof of purchase is required for repair or replacement. This warranty does not cover normal wear of parts or damage resulting from any misuse of the product. Misuse of the product includes, but is not limited to: washing the product, using in extreme weather conditions, opening the product, or trying to remodel the product. Important: this warranty is only valid if the product has been purchased through an authorized reseller. Returns and/or warranty replacements must be processed at the original place of purchase.

CUSTOMER SERVICE

For questions regarding this product, please e-mail us at info@stonepointledlighting.com.