

AstroAI



GL-0801A

DIGITAL TIRE PRESSURE GAUGE

USER MANUAL

INTRODUCTION

Thank you for purchasing the 150 PSI Digital Tire Pressure Gauge from AstroAI.

For optimal performance and safety, please read and follow all of the instructions below before operating the device. Please keep this manual for future reference.

We hope you enjoy your new Tire Gauge!

If you need any kind of help or support from our Customer Service team, you are welcome to contact us with your question via support@astroai.com.

WARNING

- Do not use the product for unintended purposes.
- Read and follow all instructions before use.
- Check the device for any damage.
- Do not use this product if it is defective, please contact us for help.
- Keep this product out of children's reach.
- Do not expose this product to rain or water.
- Keep this product away from fire, corrosive liquids, and magnetic substances.
- This product is only compatible with Schrader Valves, it will not work with Presta Valves.
- This product is not suitable for low-temperature environments.
- The maximum measurement range is 150 PSI, any higher pressure measurement will cause damage to this gauge.

DIAGRAM

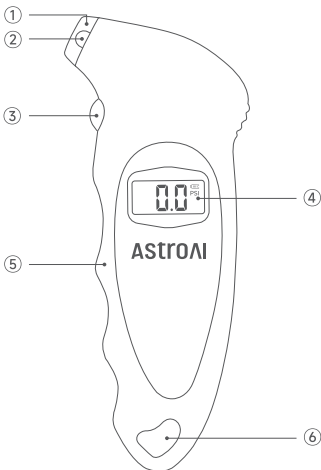

- | | |
|-----------------------------|----------------------|
| ① Nozzle | ④ Backlit LCD Screen |
| ② LED Light | ⑤ Grip |
| ③ Power/Unit Trigger Button | ⑥ Hanging Loop |

SPECIFICATIONS

Range: 0-150 PSI, 0-10 bar, 0-1000 kPa, 0-10 kg/cm²

Display: 0.83×0.39 inches LCD Display

Battery: Coin Cell

Operating Temperature: 23-122 °F / -5-50 °C

OPERATION INSTRUCTIONS

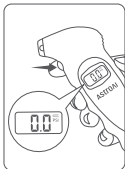

1. Press the trigger button to turn the tire pressure gauge on. The gauge will display "0.0" on the LCD screen.

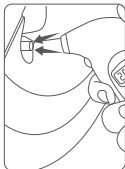

2. Place the nozzle straight on the tire valve you wish to measure. Press firmly to ensure a good seal and prevent air from leaking. Hold the gauge on the valve until the measurement display locks. It should only take a second if you have a good seal.



3. Remove the gauge to easily read the pressure.

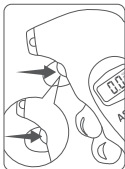

4. Click the button to switch units between PSI, bar, kPa and kg/cm². Press and hold the button for 3 seconds to turn the gauge off. The gauge also automatically turns off shortly after use.

CHANGING THE BATTERY

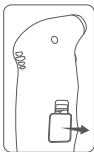

1. Locate the battery compartment on the back of the tire pressure gauge and remove the back cover.

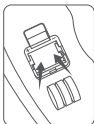

2. Locate the 3 x LR44 Batteries, replace them with new batteries.

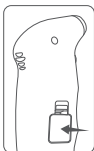

3. Take special care to ensure the new batteries are placed with the correct polarity. Replace the back cover.

TROUBLESHOOTING

Auto Power On/off

This gauge will automatically shut off when not in use after 40 seconds.

Flashing Screen

Replace the batteries or contact us for guidance.

Gauge Will Not Turn On

- Check if the batteries are dead, replace them.
- Check if the gauge is damaged from dropping.

Inaccurate Readings

- Adjust the angle between the nozzle and the tire valve; make sure it is straight on.
- Check and ensure there is a good seal.
- Contact us for maintenance or replacement.

Displays Abnormal Readings

- Check if the product is in a low-temperature environment. (Indoor storage recommended)
- Dropping this product will affect its functions.
- Only works on Schrader Valves, not Presta Valves.

Air Leaking

- A small amount of air will leak when initially affixing the gauge to the valve.
- Ensure there is a good seal between the valve and the nozzle.
- Adjust the angle between the nozzle and the tire valve, make sure it is straight on.
- Contact us for maintenance or replacement.

WARRANTY

1 Year Limited Warranty From AstroAI

Each AstroAI 150 PSI Digital Tire Pressure Gauge is free from defects in material and workmanship.

This warranty does not cover damages caused by negligence, misuse, contamination, alteration, accidents, or abnormal conditions of operation.

This warranty only covers the original purchaser and can not be transferred.

AstroAI always wants to provide our customers with excellent products and customer service. To learn more about us, please visit us at [**astroai.com**](http://astroai.com).

AstroAI

WARNING



- **INGESTION HAZARD:** This product contains a button cell or coin battery.
- **DEATH** or serious injury can occur if ingested.
- A swallowed button cell or coin battery can cause **Internal Chemical Burns** in as little as **2 hours**.
- **KEEP** new and used batteries **OUT OF REACH** of **CHILDREN**
- **Seek immediate medical attention** if a battery is suspected to be swallowed or inserted inside any part of the body.
- Remove and immediately recycle or dispose of used batteries according to local regulations and keep away from children. Do NOT dispose of batteries in household trash or incinerate.
- Even used batteries may cause severe injury or death.
- Call a local poison control center for treatment information.
- The nominal battery voltage 4.5V.
- Non-rechargeable batteries are not to be recharged.
- Do not force discharge, recharge, disassemble, heat above or incinerate. Doing so may result in injury due to venting, leakage or explosion resulting in chemical burns.
- Do not mix old and new batteries, different brands or types of batteries, such as alkaline, carbon-zinc, or rechargeable batteries.
- Remove and immediately recycle or dispose of batteries from equipment not used for an extended period of time according to local regulations.
- Always completely secure the battery compartment. If the battery compartment does not close securely, stop using the product, remove the batteries, and keep them away from children.

Web: www.astroai.com

E-Mail: support@astroai.com

V2.3