

MANHATTAN  
COMFORT

**Loft Buffet Stand - Small**

Model # 491901, 491902

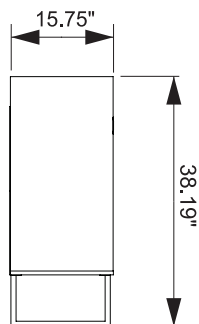

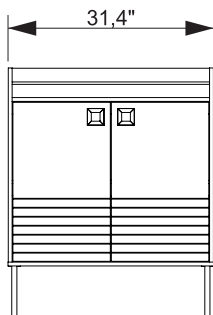
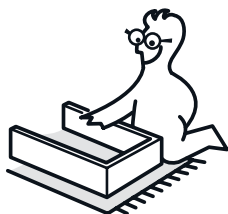
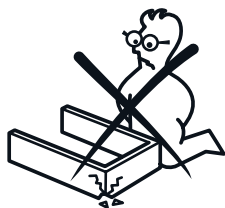

## For Best Results

- Do not throw away packaging materials until assembly is complete.
- Assemble item on a soft surface, such as cardboard or carpet, to protect finish.
- Proper assembly requires two people.

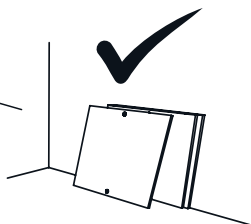
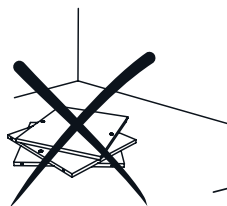

## Tools Required

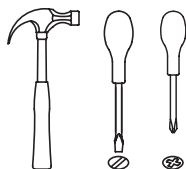

# Included in this Package

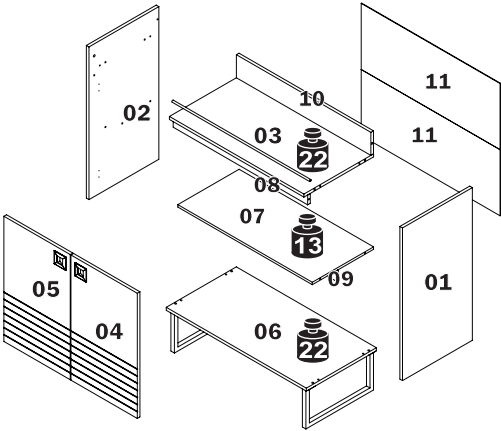

01	RIGHT SIDE	X1
02	LEFT SIDE	X1
03	UPPER TOP	X1
04	RIGHT DOOR	X1
05	LEFT DOOR	X1
06	LOWER TOP	X1
07	SHELF	X1
08	UPPER BATTEN	X1
09	LOWER BATTEN	X1
10	UPPER VIEW	X1
11	BACK	X2
12	FITTINGS	X1



## 12 Fittings

 A - HANDLE x2	 B - SLOW MOTION HINGE x4	 C - 7X50MM SCREW x4	 D - 4X14MM SCREW x16	 E - FOOT x2	 F - 4X14MM SCREW x16	 G - CYLINDRICAL TUBE Ø9,5x786MM x1
 H - 6X30MM WOODEN DOWEL x17	 I - ANGLE BRACKET x4	 J - 5X40MM SCREW x3	 K - MINIFIX SCREW x6	 L - 15MM CONNECTOR x6	 M - WHITE GLUE x1	
 N - 10X10 NAIL x27	 O - FIXER FOR BACK x5	 P - ALLEN WRENCH x1	 Q - HINGE HOLDER x4			

## Where to find the items

Box 01		
01	06	11
02	07	12
03	08	
04	09	
05	10	

Assembly  
time: 100min

Tip of the number of people  
required for product assembly



# Prepare the pieces

## Step 1

Insert the wooden dowels (H) into parts 01,02, 03,07,08 and 09. Remember to use the glue (M).

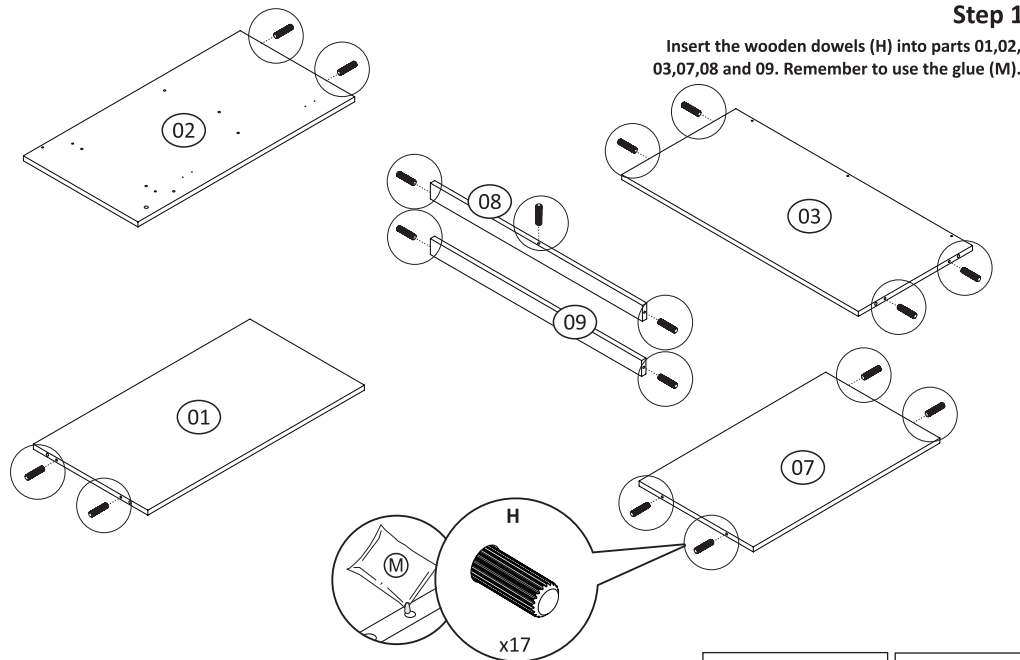

**It's important to glue the wooden dowel.**

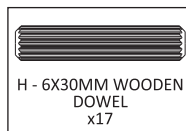

## Step 2

Insert screw (K) into part 01 and 02. Tighten to the limit.

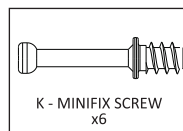
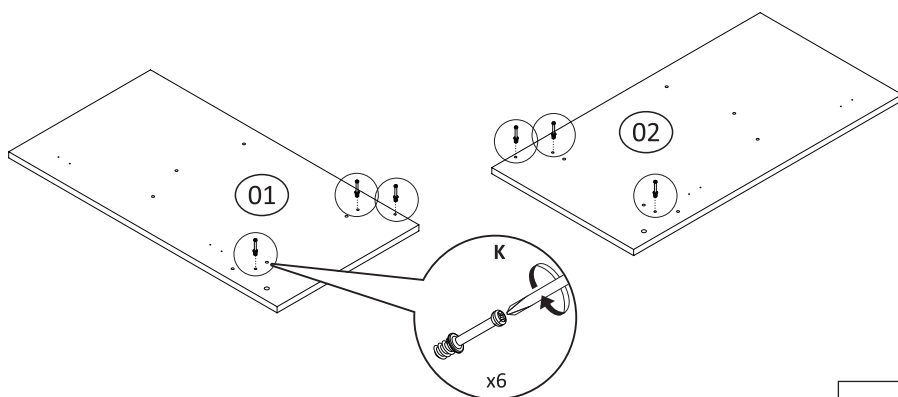

# Assembly

## Step 3

For better assembly,

start with the front of the parts facing down!

Put the glue (M) in hole of the wooden dowel (H), fitting the part 2 on the part 6.

Then install the foot (E) on the parts 6 and 2 with the screws (C).

Use the screws (F) to fix the foot (E) on the part 4.

Tighten to the limit.

As in the drawing below.

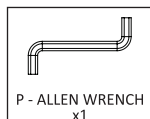
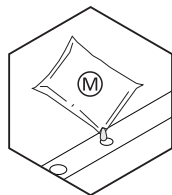

**It's important to glue the wooden dowel.**

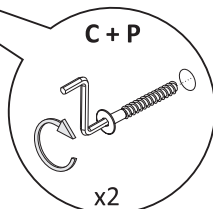
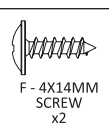
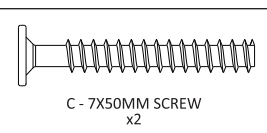
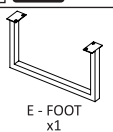

## Step 4

Put the glue (M) in hole of the wooden dowel (H),

fitting the part 3 on the part 8, then use the angle bracket (I) with 2 screws (F) to fix the parts 8 and 3.

After fitting the part 8 and 3 on the part 2.

To fixing the part 3 on the part 2, insert the two minifix connectors (L) in part 3 and rotate clockwise as shown.

Tighten to the limit.

As in the drawing below.

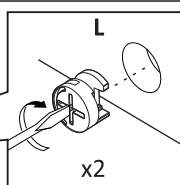
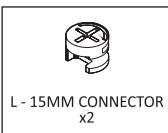
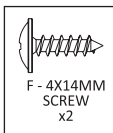
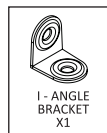
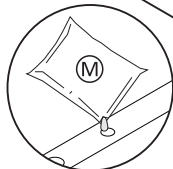
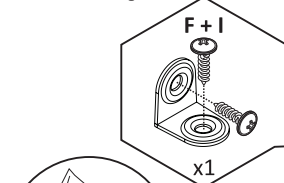

**It's important to glue the wooden dowel.**

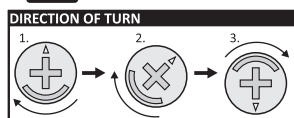

**Tighten the minifix up to the limit to assembly don't be slack.**

# Assembly

## Step 5

Put the glue (M) in hole of the wooden dowel (H), fitting the parts 7 and 9 on the part 2.  
Use the angle bracket (I) with 2 screws (f) to fixing the part 9 on the parts 7 and 2.  
As in the drawing below.

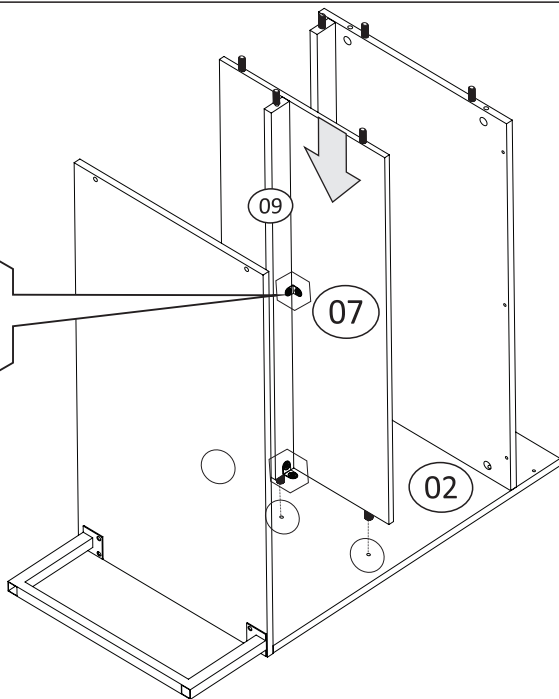
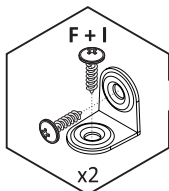
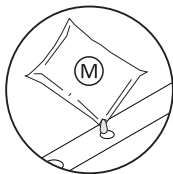

**It's important to glue the wooden dowel.**

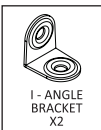
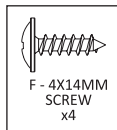

## Step 6

To fixing the parts 10 on 2, insert a minifix connectors (L) on the part 10 and rotate clockwise as shown. Tighten to the limit.  
Use 3 screws (J) to fixing the parts 10 and 3.  
Fit the tube (G) into the hole on the part 2.  
As in the drawing below.

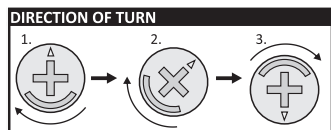
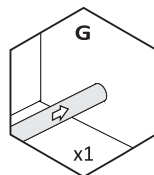
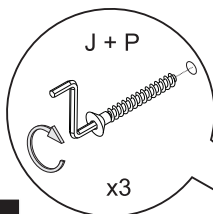

**Tighten the minifix up to the limit to assembly don't be slack.**

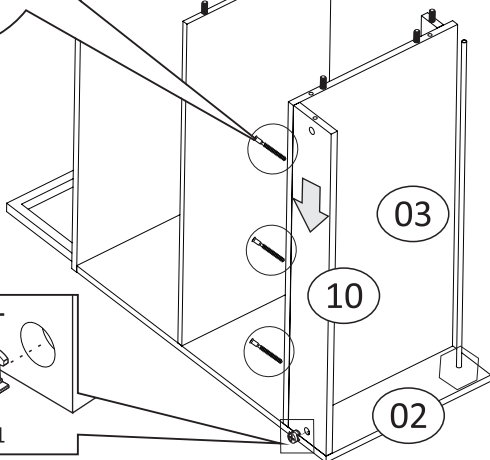
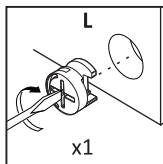
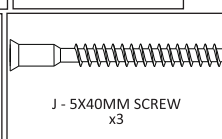
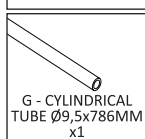
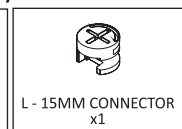
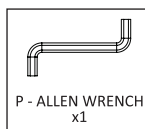

# Assembly

## Step 7

Put the glue (M) in holes of the wooden dowels (H).

Fitting the part 1 on the part 6,

then fitting the part 1 on the parts 3,7,8,9,10, and on the tube (G).

As in the drawing below.

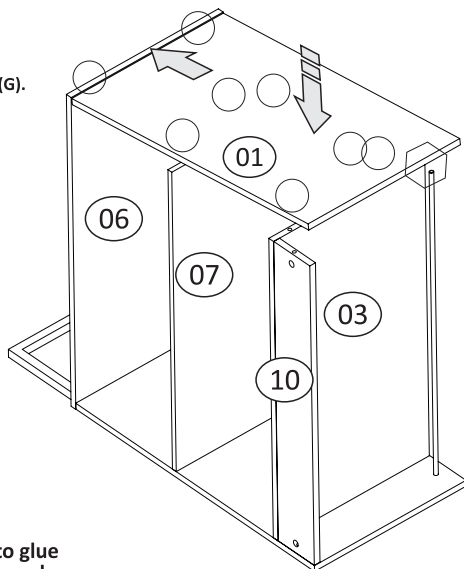
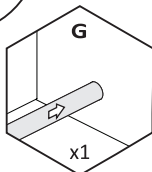
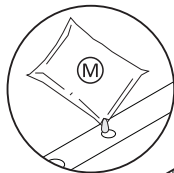

M - WHITE GLUE  
x1

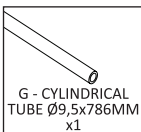

G - CYLINDRICAL  
TUBE Ø9,5x786MM  
x1



**It's important to glue  
the wooden dowel.**

## Step 8

Then install the foot (E) on the parts 6 and 1 with the screws (C).

Use the screws (F) to fix the foot (E) on the part 6.

Use the angle bracket (I) with 2 screws (f) to fixing the parts 9 and 1.

Tighten to the limit.

As in the drawing below.

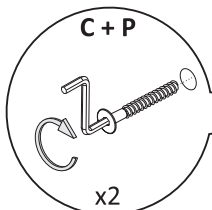

x2

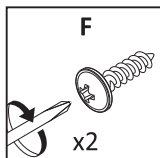

x2

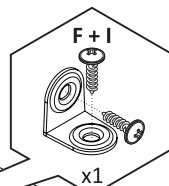

x1

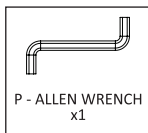
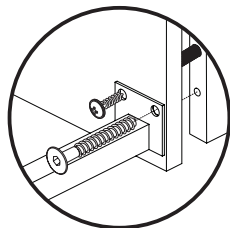

P - ALLEN WRENCH  
x1

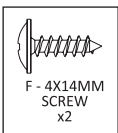

F - 4X14MM  
SCREW  
x2

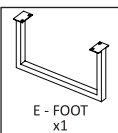

E - FOOT  
x1

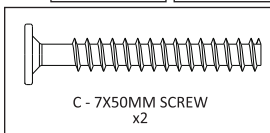

C - 7X50MM SCREW  
x2

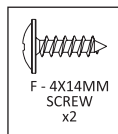

F - 4X14MM  
SCREW  
x2



I - ANGLE  
BRACKET  
x1

# Assembly

## Step 9

To fixing the parts 3 and 10 on the part 1, insert three minifix connectors (L) in parts 3 and 10 and rotate clockwise as shown.  
Tighten to the limit.  
As in the drawing below.

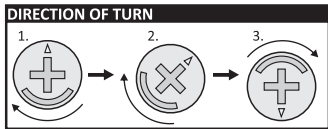
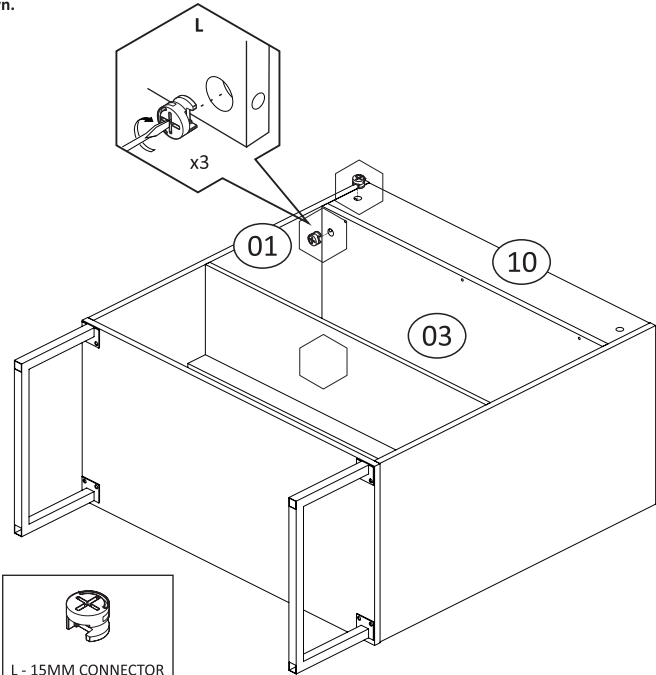

Tighten the minifix up to the limit to assembly don't be slack.

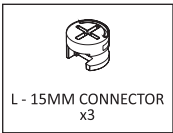

## Step 10

Fix the parts 11 using the nails (N).  
To attach the parts 11, use the fixer for back (O) with the nails (N).  
As in the drawing below.

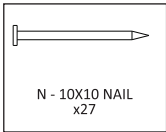
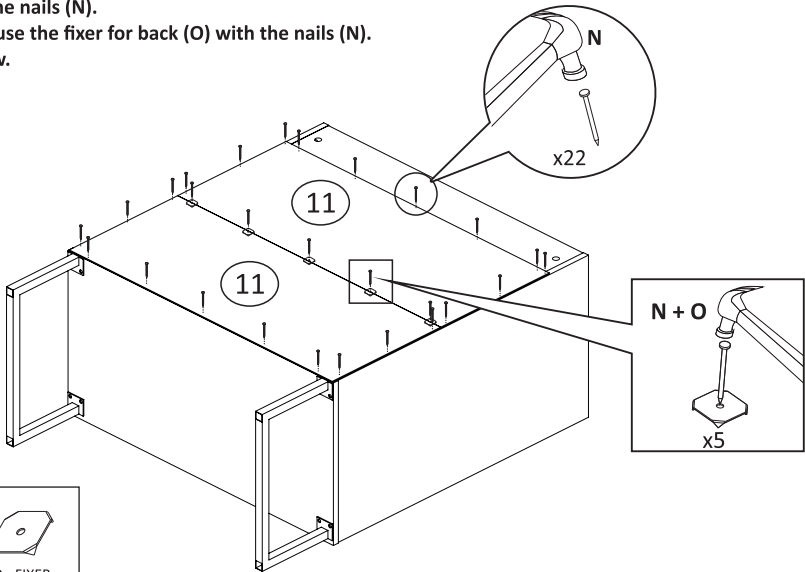



# Assembly

## Step 11

Very carefully and in two people, lift the product off the floor.  
As the drawing below.

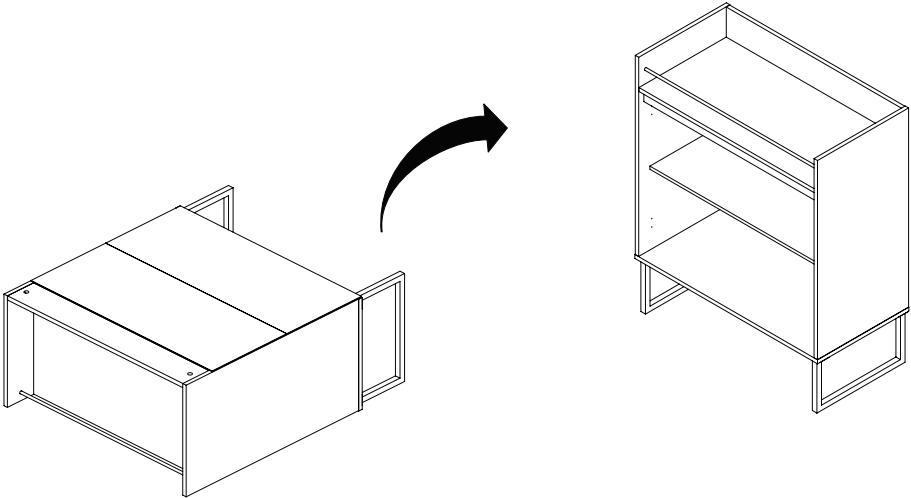

## Step 12

Install the hinge holders (Q) on the parts 1,2 using the screws (D),  
use the markings on the parts to install,  
as in the drawing below.

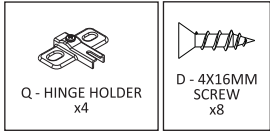
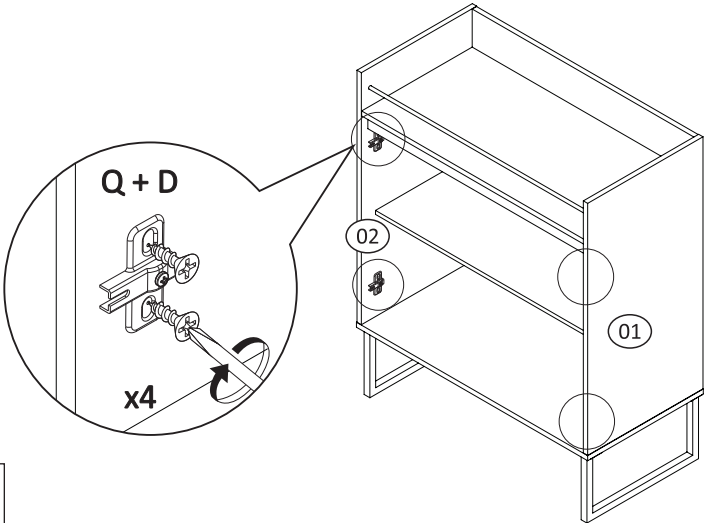

# Assembly

## Step 13

Install the hinges (B) on the parts 4 and 5 using the screws (D), use the holes on the parts to install, as in the drawing below.

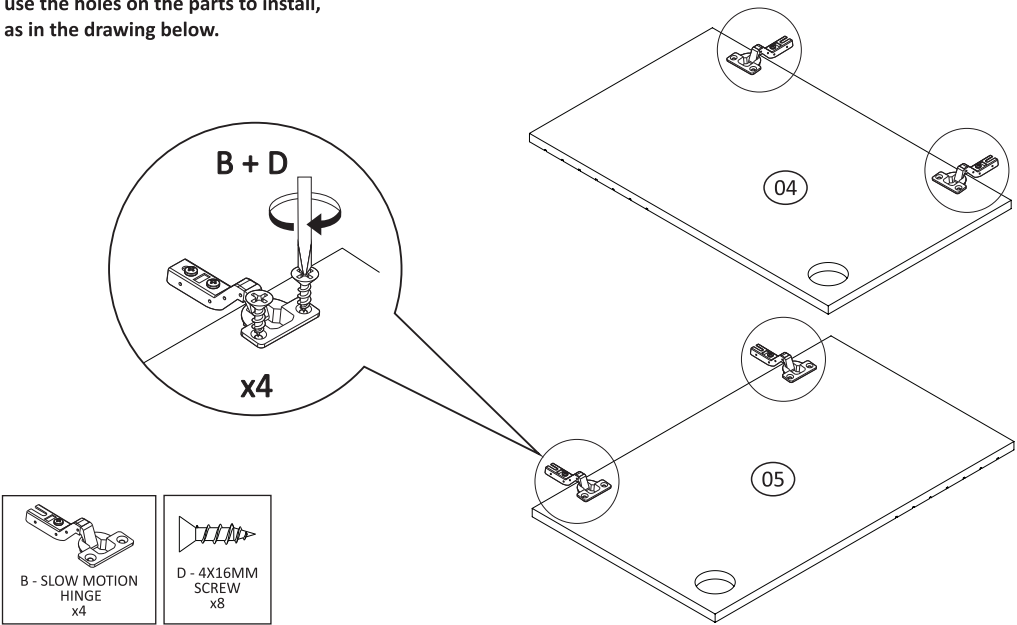

## Step 14

Install the hinges (B) on the hinge holders (Q), then tighten the screw of holder (Q), as in the drawing below.

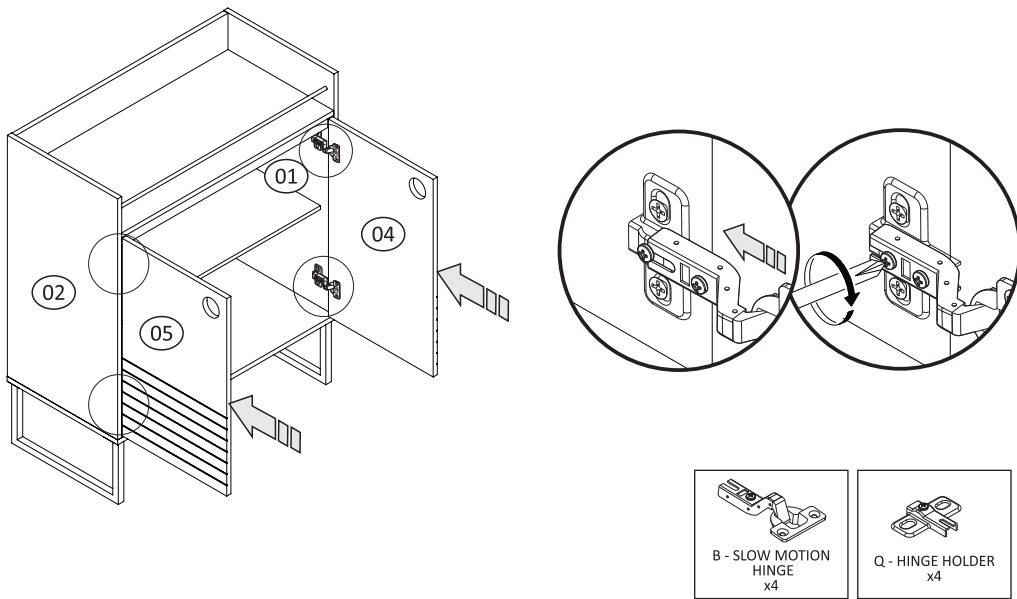

# Assembly

## Step 15

Install the handles (A) on the parts 4 and 5 using the screws (F), as in the drawing below.

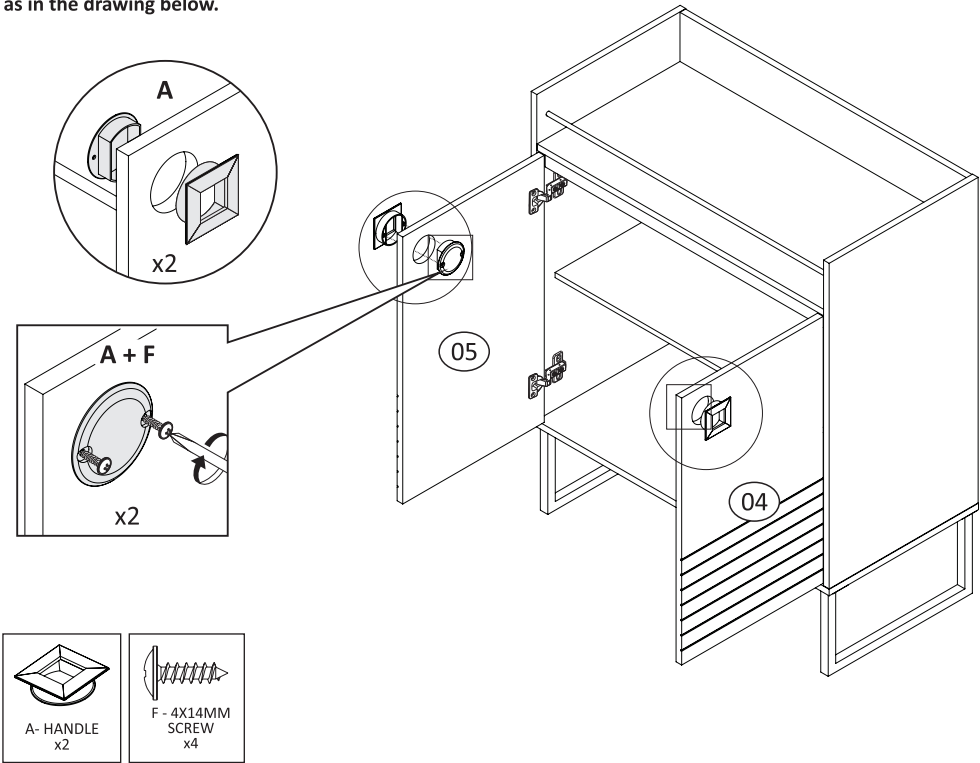

## Step 16 - To adjust the doors, follow the instructions below

If you need to put the door up or down, loosen the screws (D), reposition the holder (Q) and tight again. As in the drawing below.

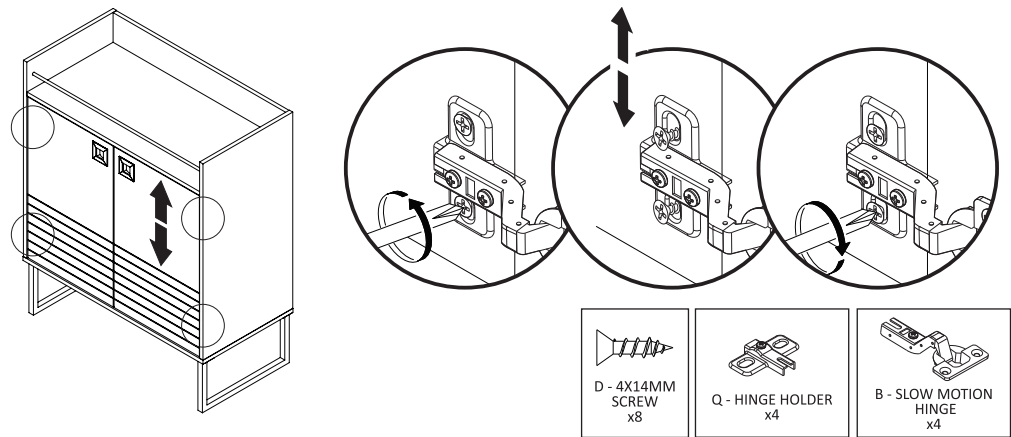

# Assembly

## Step 17 - To adjust the doors, follow the instructions below

If you need to push the door to inside or pull it out, loosen the screw of holder (Q), reposition and tight again. As in the drawing below.

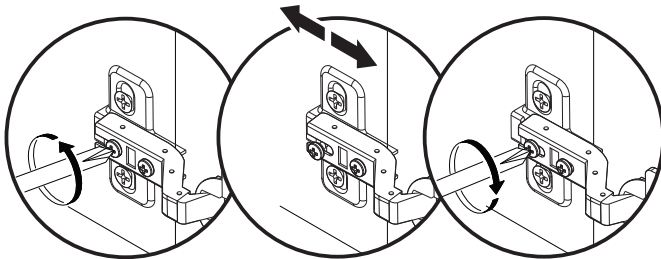
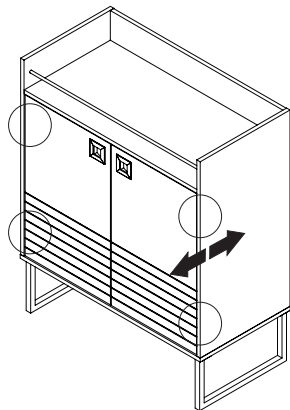

## Step 18 - To adjust the doors, follow the instructions below

If you need to align the doors a bit more to the center, or toward the sides, turn the screw of hinge (B) until the position the door as you need. As in the drawing below.

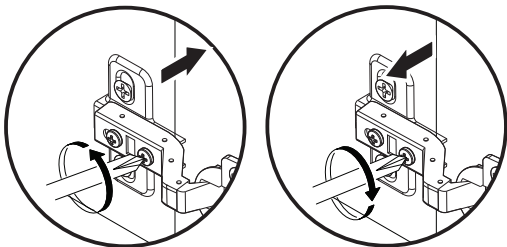
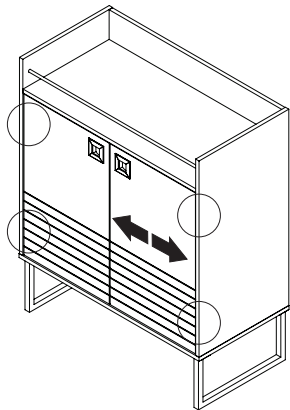

## Safe and Security

### KIT FOR MASONRY MW = MASONRY WALL

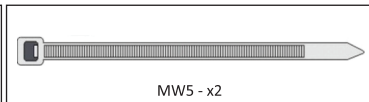
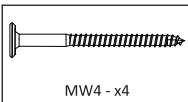
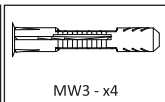
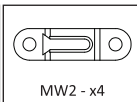
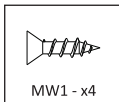

# WARNING



Serious or fatal crushing injuries can occur from furniture tip-over. **ALWAYS** secure this furniture to the wall using tip-over restraints. To further reduce the risk of serious injury and death from tip-overs:

- Place heaviest items in the lower drawer.
- Do not set TVs or other heavy objects on the top of this product.
- Never allow children to climb or hang on drawers doors or shelves.

**DON'T PULL THE FURNITURE TO CHANGE IT.  
INSTEAD OF PULLING, PUSH IT ON THE DIRECTION YOU WANT.**

# Safe and Security

## KIT FOR MASONRY

### Step 19

1. Make holes on the wall following the model below and specifications:
- Ø 8mm (5/16") drill.
  - ▴ Depth of 50mm (1.96").



Use an electric drill.

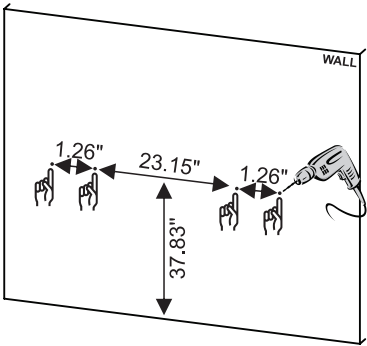

### Step 20

2. Insert the bushing into the hole made on the wall.

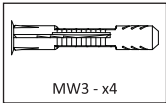

MW3 - x4

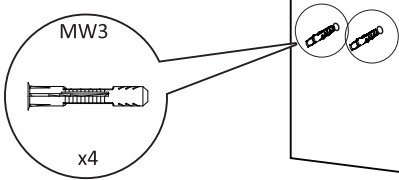

### Step 21

3. Put the screws into the bushings.

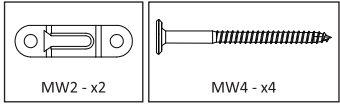
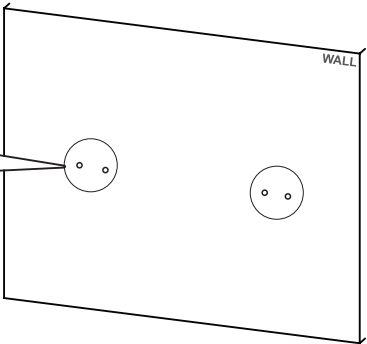
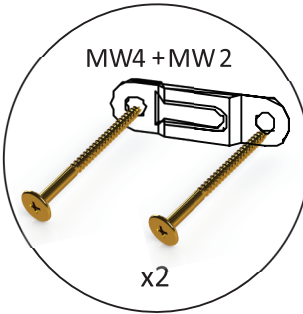

MW2 - x2

MW4 - x4

Safe and Security

KIT FOR MASONRY

4. Put the lock on the horizontal as the pictures below.

Step 22



Check the distance between wall's holes.  
It must be the same distance between centers  
of dresser's device.

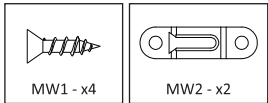
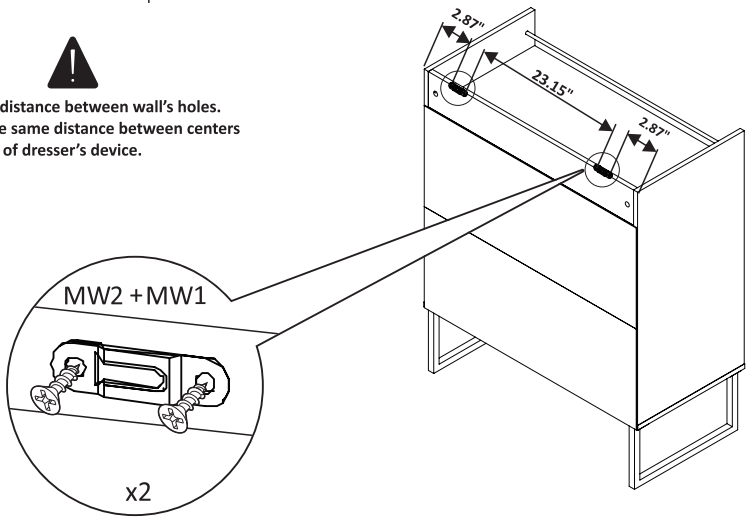

5. Drag the dresser carefully until you meet the screw's head.  
Fit the screw into the lock as the picture below.

Step 23



Put the two pieces together  
and insert the seal.

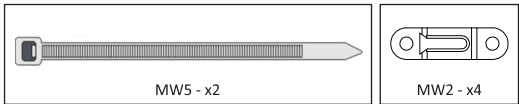
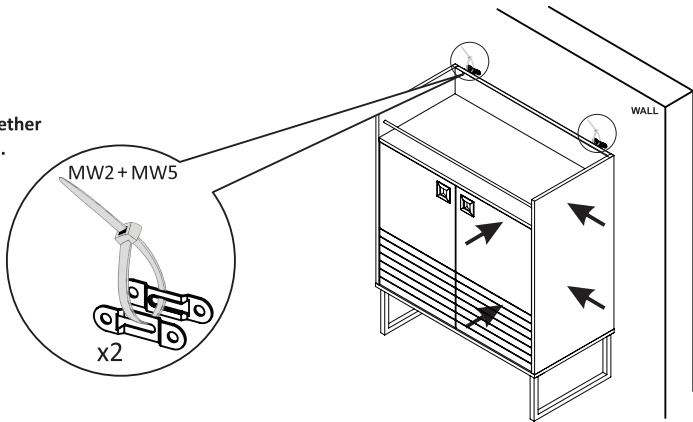

# TAKING GOOD CARE OF YOUR FURNITURE

Cleaning and caring instructions:

- Wipe the wood furniture down with a moist cloth to properly clean the furniture.
- Do not forget to dry your furniture out. Humidity can damage the finish or create mould.
- Chemical products are not recommended;
- Never clean the furniture with scouring powders, steel scrubber pads or any other product which can scratch its.
- Furniture surfaces should not be covered with colored plastic or paper sheets.
- Avoid dragging objects on top of the furniture. They might scratch the finishing.
- Wood furniture are made of mould and termites resistant materials, however, it is recommended to use termiticides in infested places before installing the furniture.
- Avoid furniture exposure to direct Sun light. Drapers suggested.