

INSTALLATION

Product Manual

Version: 460037-01-24A-MH



IMPORTANT INFORMATION!

please read the entire manual before starting to assemble and/or using this product. follow the manual thoroughly and keep it for further reference.



AVOID SCRATCHES!

In order to avoid scratching this furniture should be assembled on a soft layer-could be a rug.



IMPROVE EFFICIENCY !

Try to find a partner to install with you, which can speed up the installation efficiency and shorten the time.

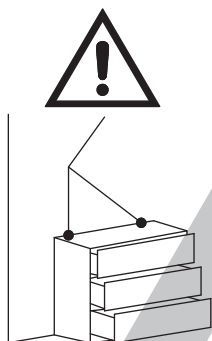

ANTI-TOPPLE WARNING !

Overturned furniture can cause serious or fatal crush injuries. To prevent tipping over, be sure to use the wall attachment, if not included with this product. Please purchase the wall attachment that fit your wall. If unsure, seek professional advice. Please read and follow each step of the instructions carefully.

IMPORTANT !

It is important that any product which is assembled using any kind of screw is re-tightened 2 weeks after assembly, and once every 3 months - in order to assure stability through-out the lifespan of the product.

For regular maintenance and cleaning of the product, for the frame, please use a rag dipped in neutral detergent to fully wipe it, and then dry it with a clean rag. For glass materials, wipe with a rag dampened with water glass cleaner, and then dry with a dry rag.

Do not use an electric screwdriver, and do not use too much force when installing, because the board is easy to break.

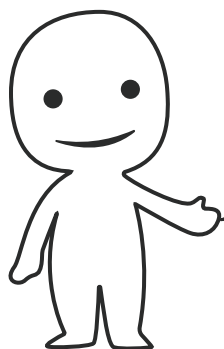

Please prepare the following tools

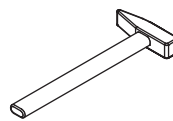
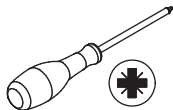

When installing, please carefully confirm whether each screw corresponds to the manual, accessories with similar shapes can be distinguished by size

<p>A x 114</p>  <p>CRA0635A</p>	<p>B x 114</p>  <p>CRB1595A</p>	<p>C x 86</p>  <p>CRF0830A</p>	<p>D x 8</p>  <p>CRD0440A</p>	<p>E x 20</p>  <p>CRD0430A</p>
<p>F x 2</p>  <p>DGA861A</p>	<p>G x 6</p>  <p>Ø 35 mm</p>	<p>H x 2</p> 	<p>J x 62</p>  <p>CRD3514A</p>	<p>K x 2</p>  <p>HG3508-14"</p>
<p>L x 8</p>  <p>CRD0312A</p>	<p>M x 1</p> 	<p>N x 4</p>  <p>Ø 4.9 x 16 mm</p>	<p>P x 41</p>  <p>CRE0312A</p>	<p>Q x 9</p>  <p>15.5 x 10 x 1.2 mm</p>
<p>R x 4</p>  <p>20 x 12 x 1 mm</p>	<p>S x 13</p>  <p>CRD0316A</p>	<p>T x 2</p> 	<p>U x 2</p>  <p>96 x 55 x 27 mm</p>	<p>V x 4</p>  <p>Ø 4 x 8 mm</p>
<p>W x 2</p>  <p>128 mm</p>	<p>X x 4</p>  <p>CRE0418A</p>			

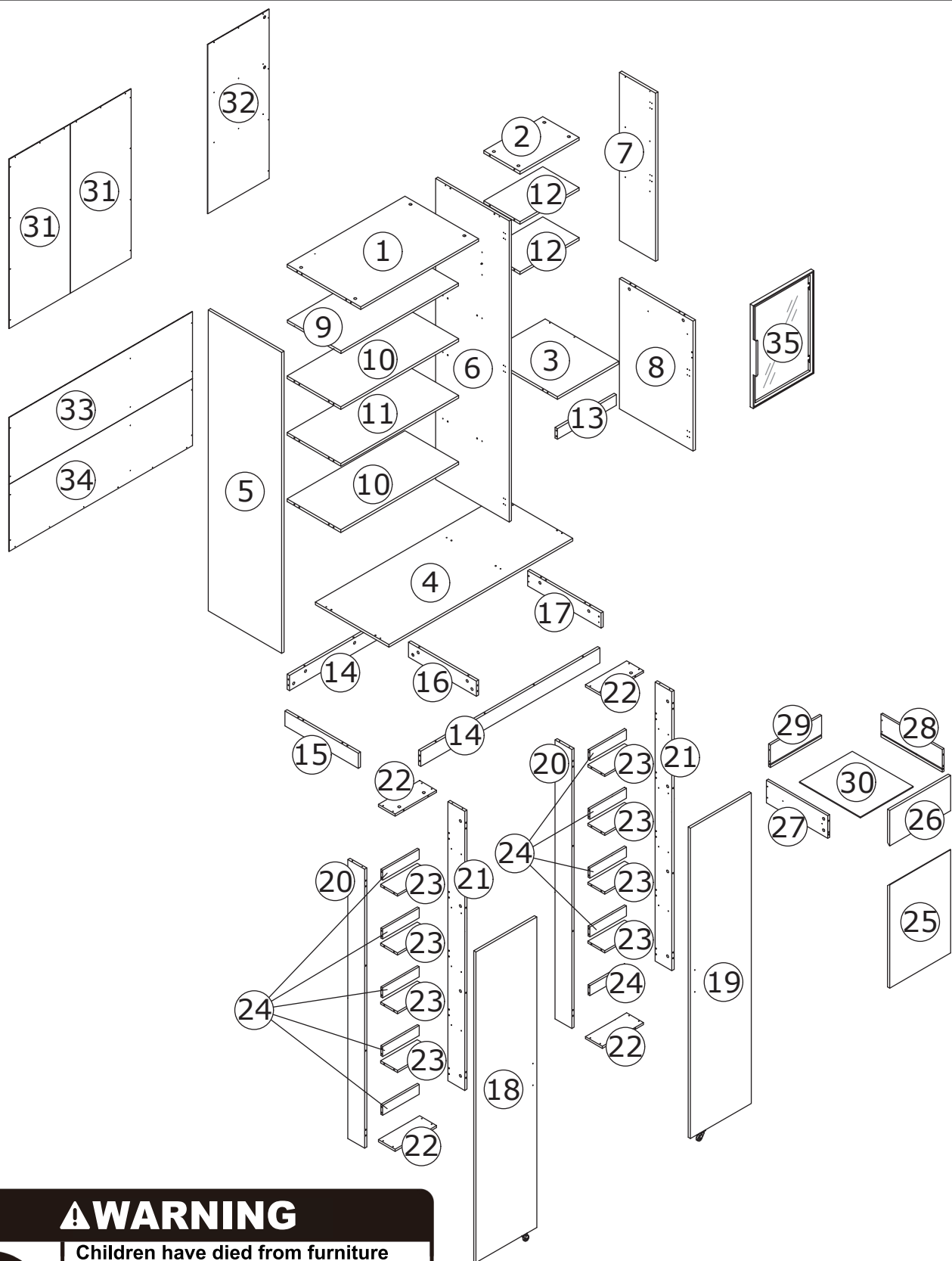

⚠ WARNING



Children have died from furniture tipover. To reduce the risk of furniture tipover:

- ALWAYS install Anti-tip device provided.
- NEVER put a TV on this product.
- NEVER allow children to stand, climb or hang on drawers, doors, or shelves.
- NEVER open more than one drawer at a time.
- Place heaviest items in the lowest drawers.

*This is a permanent label.
Do not remove!*

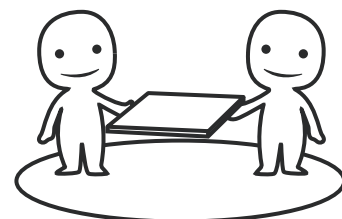

ASSEMBLED BY 2 ADULTS

**Slides Must Be Separated Before Assembly.
After Separated, Set Aside Until Needed for Assembly.**

Las diapositivas deben separarse antes del montaje.
Después de la separación, déjelo a un lado hasta que sea necesario.

Les glissières doivent être séparées avant l'assemblage.
Après la séparation, mettez de côté jusqu'au moment de l'assemblage.

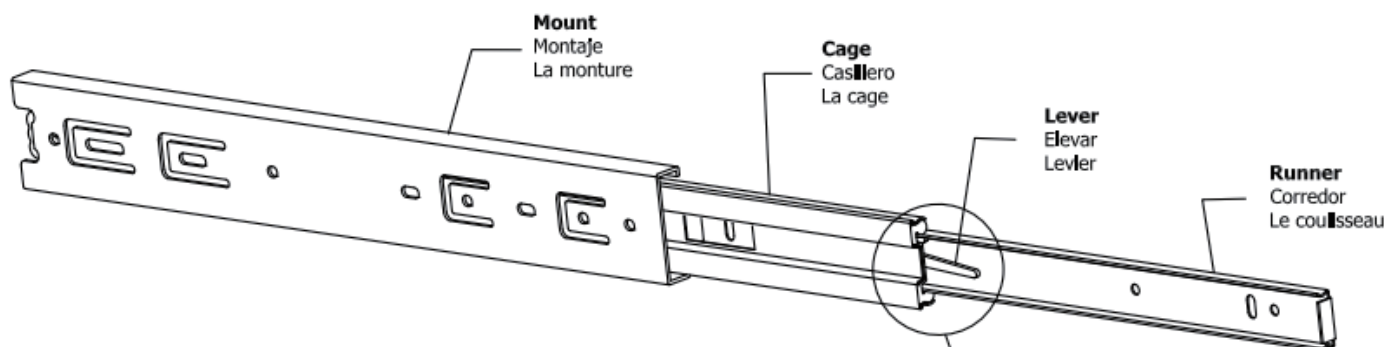

STEP 1: Extend Slide

Extender la diapositiva
Extendre la diapositive

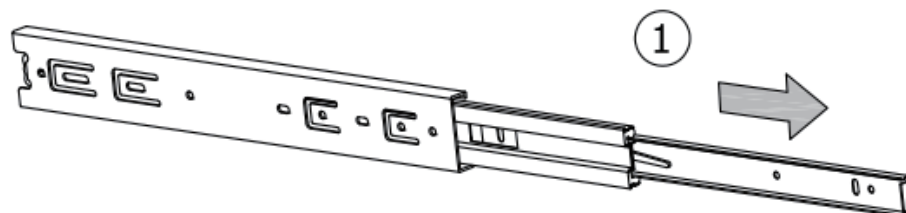

STEP 2: Push Lever UP

Empujar hacia arriba
Lever le levier

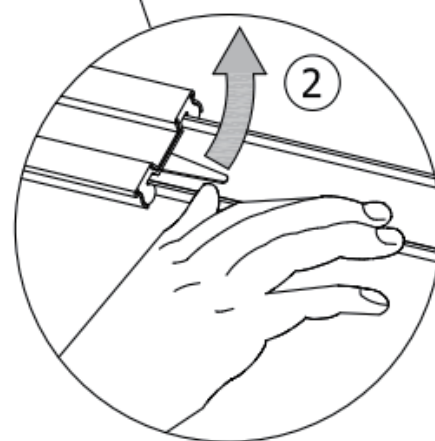

STEP 3: Remove Runner

Quitar el corredor
Enlever le coureur

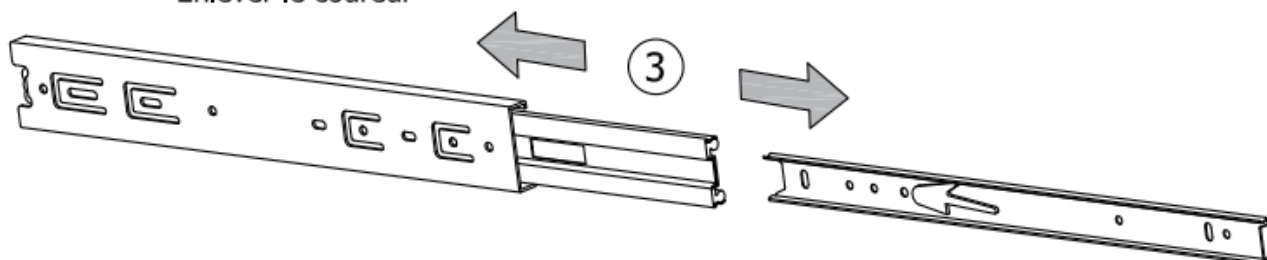

1

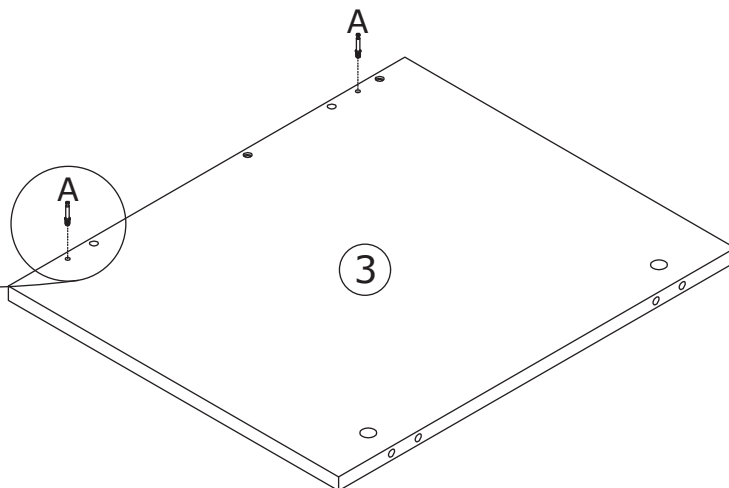
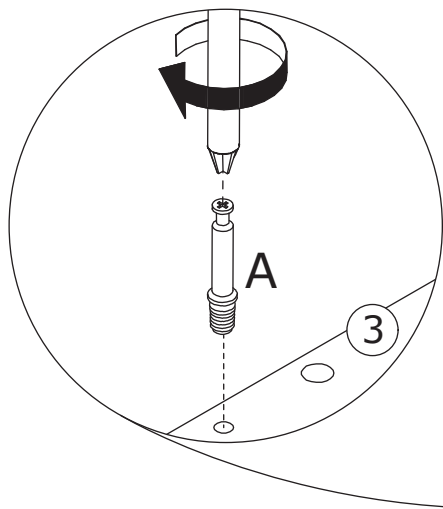
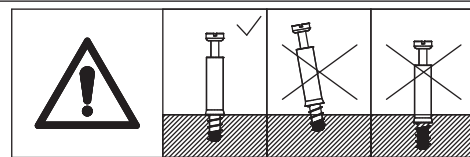
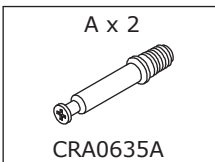

Screw eccentric rod(A)
into panel 3 at first.

2

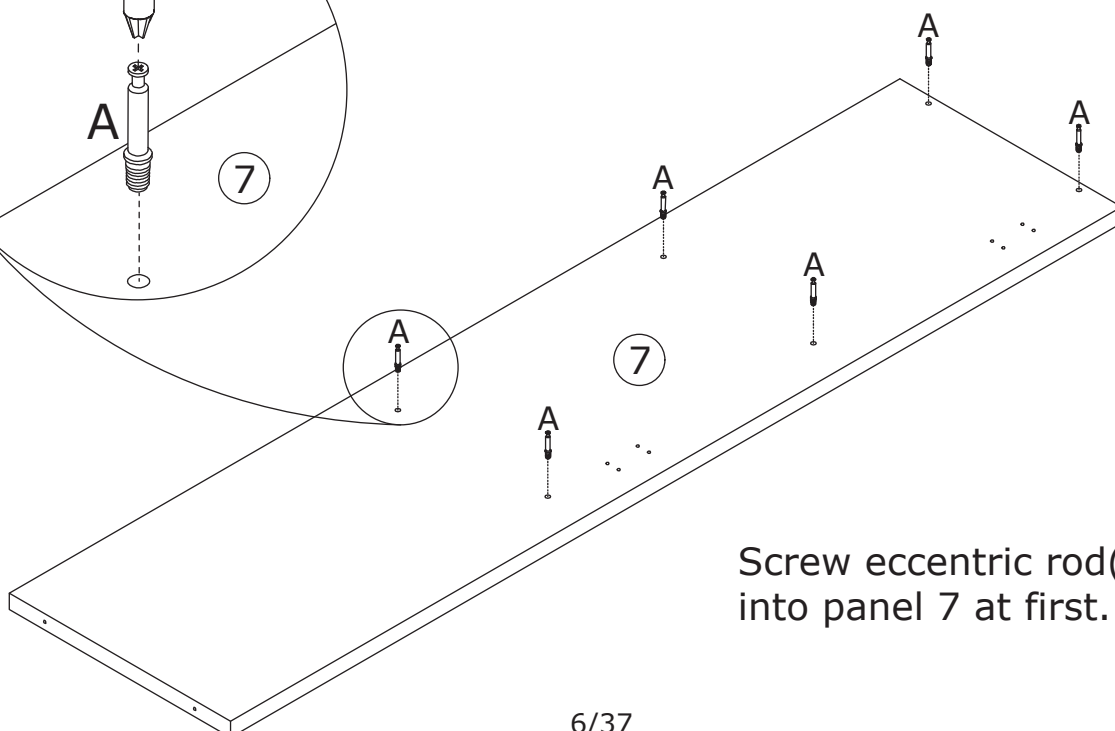
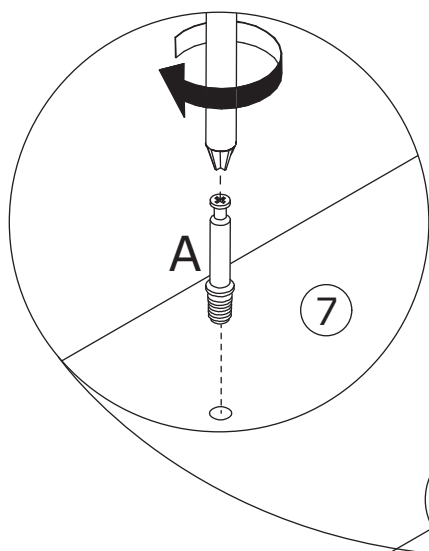
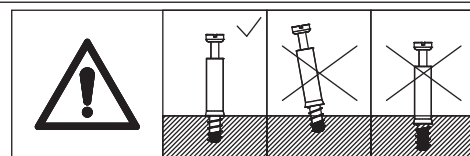
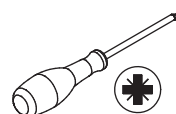
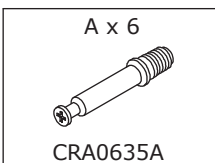

Screw eccentric rod(A)
into panel 7 at first.

3

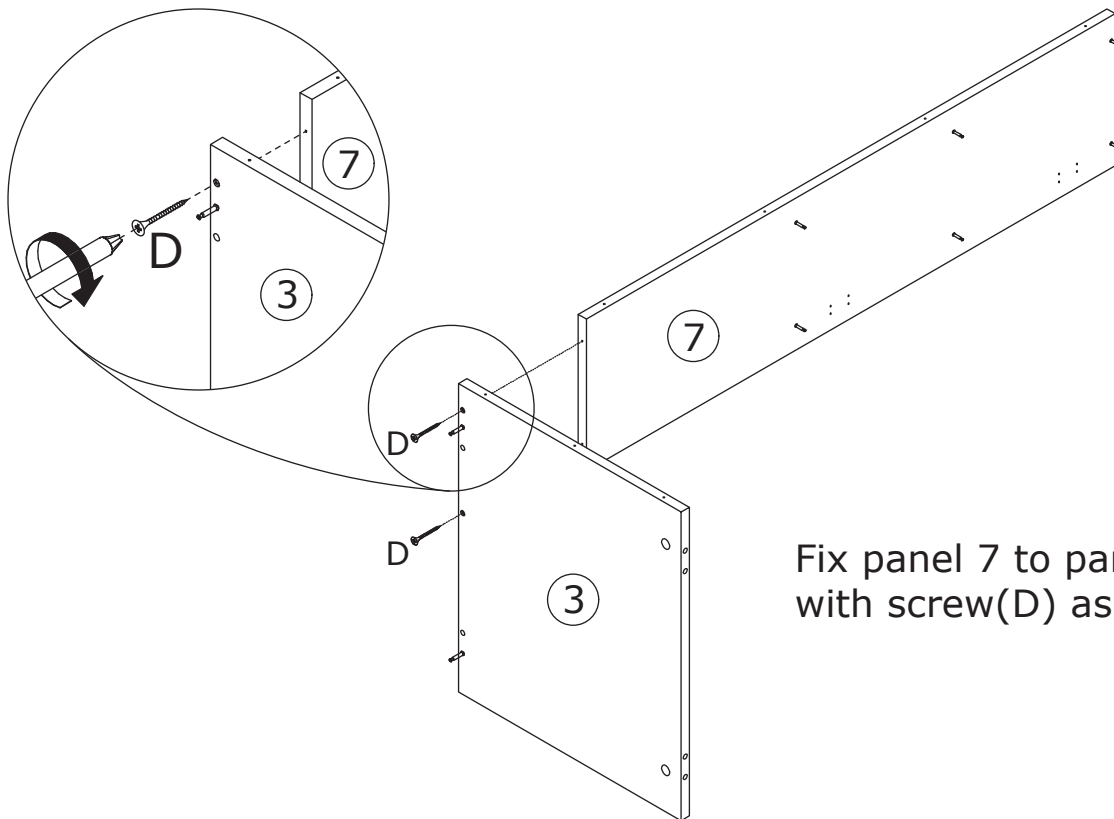
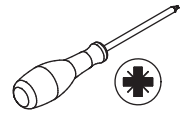
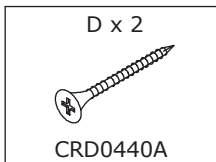

Fix panel 7 to panel 3 with screw(D) as shown.

4

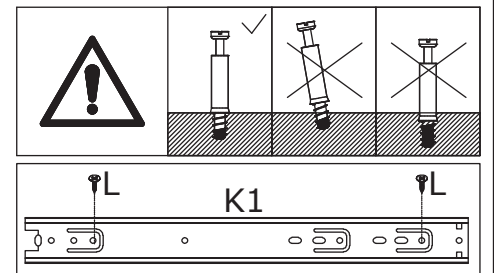
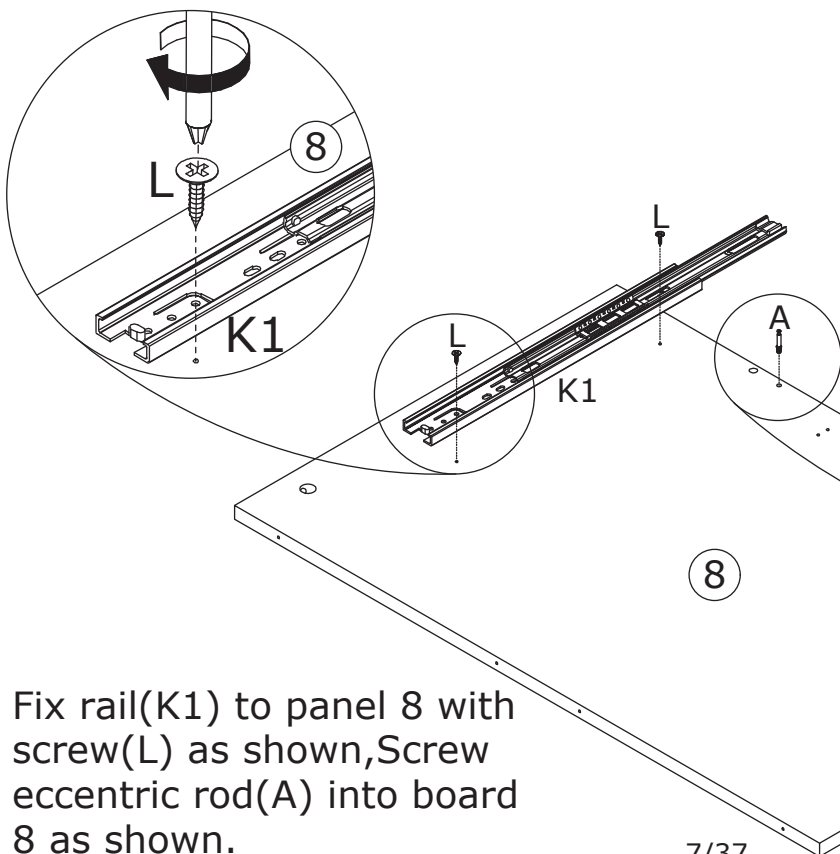
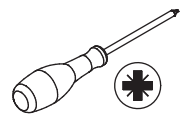
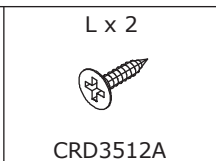
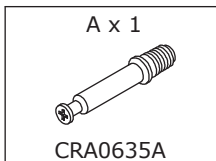

Fix rail(K1) to panel 8 with screw(L) as shown, Screw eccentric rod(A) into board 8 as shown.

5

B x 2	C x 2
 CRB1595A	 CRF0830A

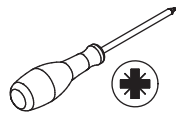

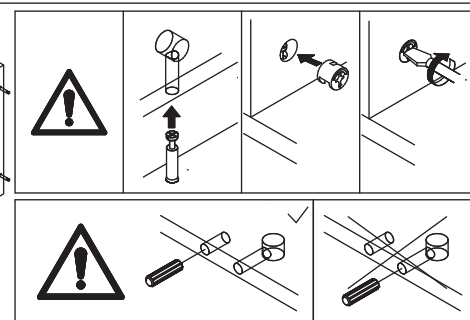
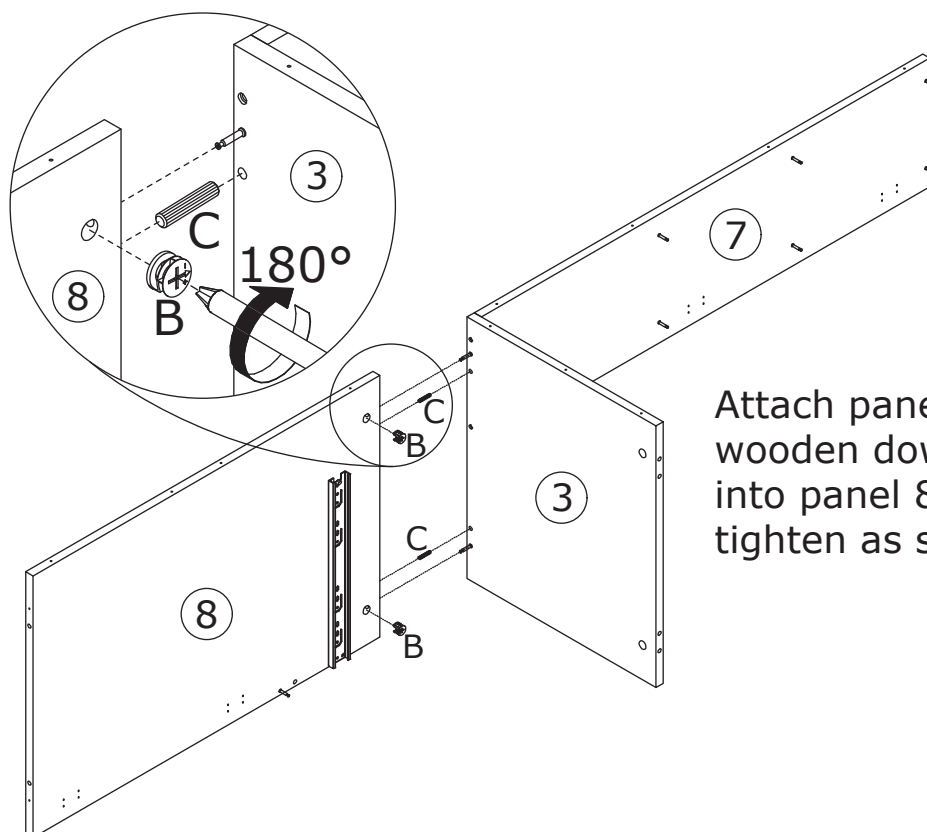



Attach panel 8 to panel 3 using wooden dowel(C), add cam lock(B) into panel 8 and turn clockwise to tighten as shown.

6

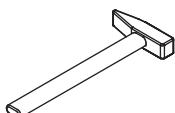
B x 7	C x 1
 CRB1595A	 CRF0830A

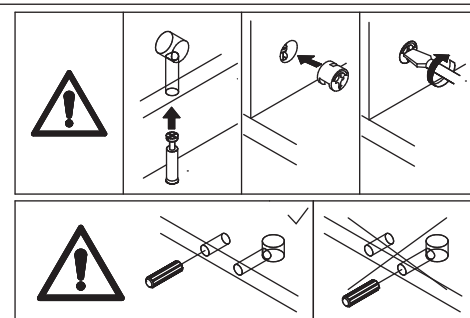
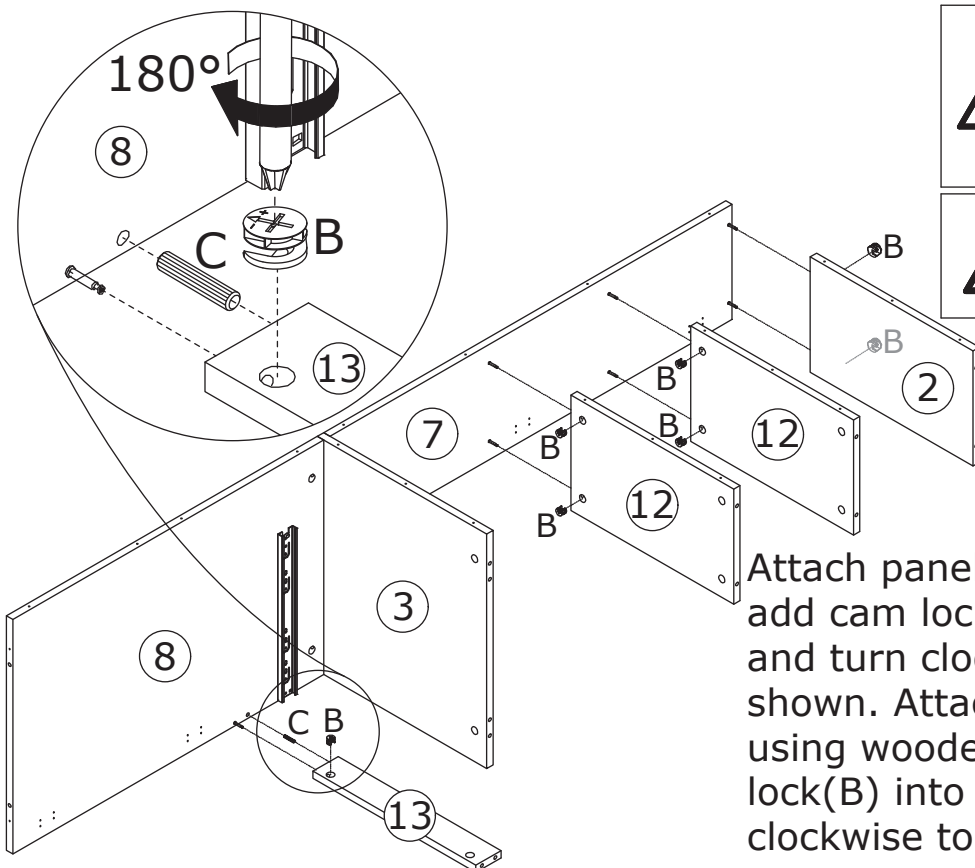

Attach panel 2 and 12 to panel 7 , add cam lock(B) into panel 2,12 and turn clockwise to tighten as shown. Attach panel 13 to panel 8 using wooden dowel(C), add cam lock(B) into panel 13 and turn clockwise to tighten as shown.

7

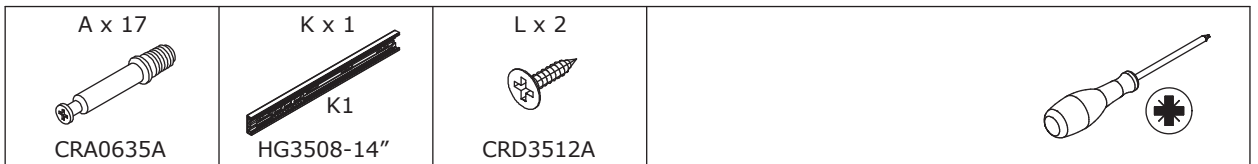

Screw eccentric rod(A) into panel 6 and fix rail(K1) at first.
Then flip to back, screw eccentric rod(A) as shown.

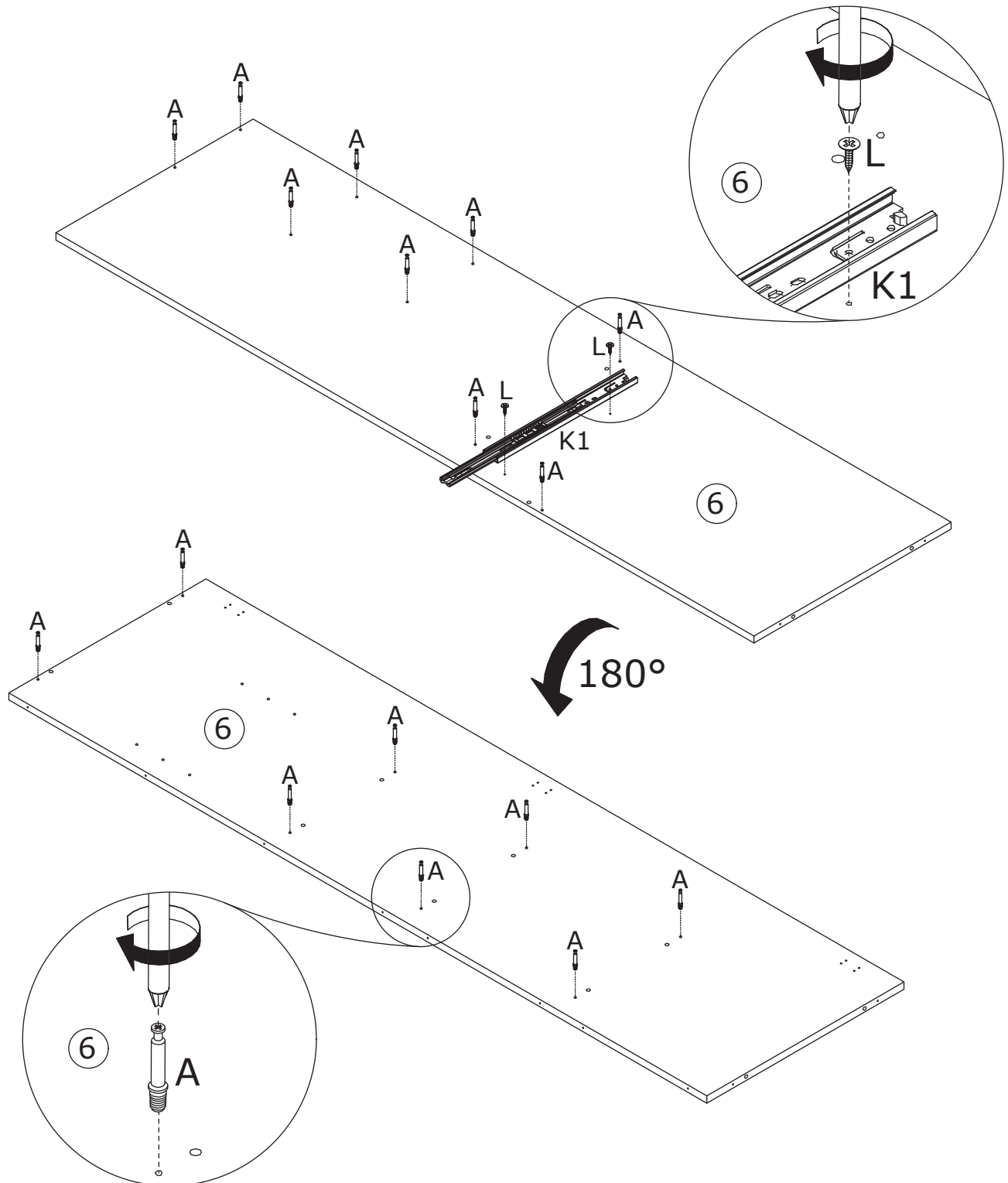
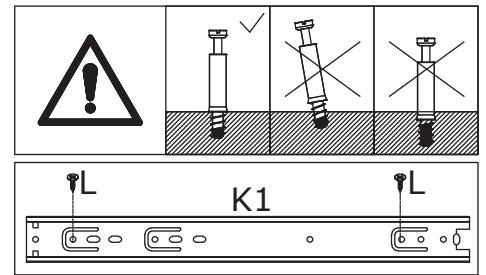

8

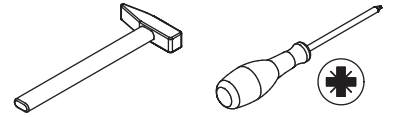
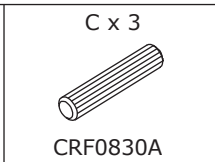
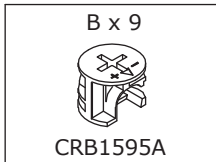

Attach panel 6 to panel 2, 12, 3 and 13 using wooden dowel(C), add cam lock(B) into and turn clockwise to tighten as shown.

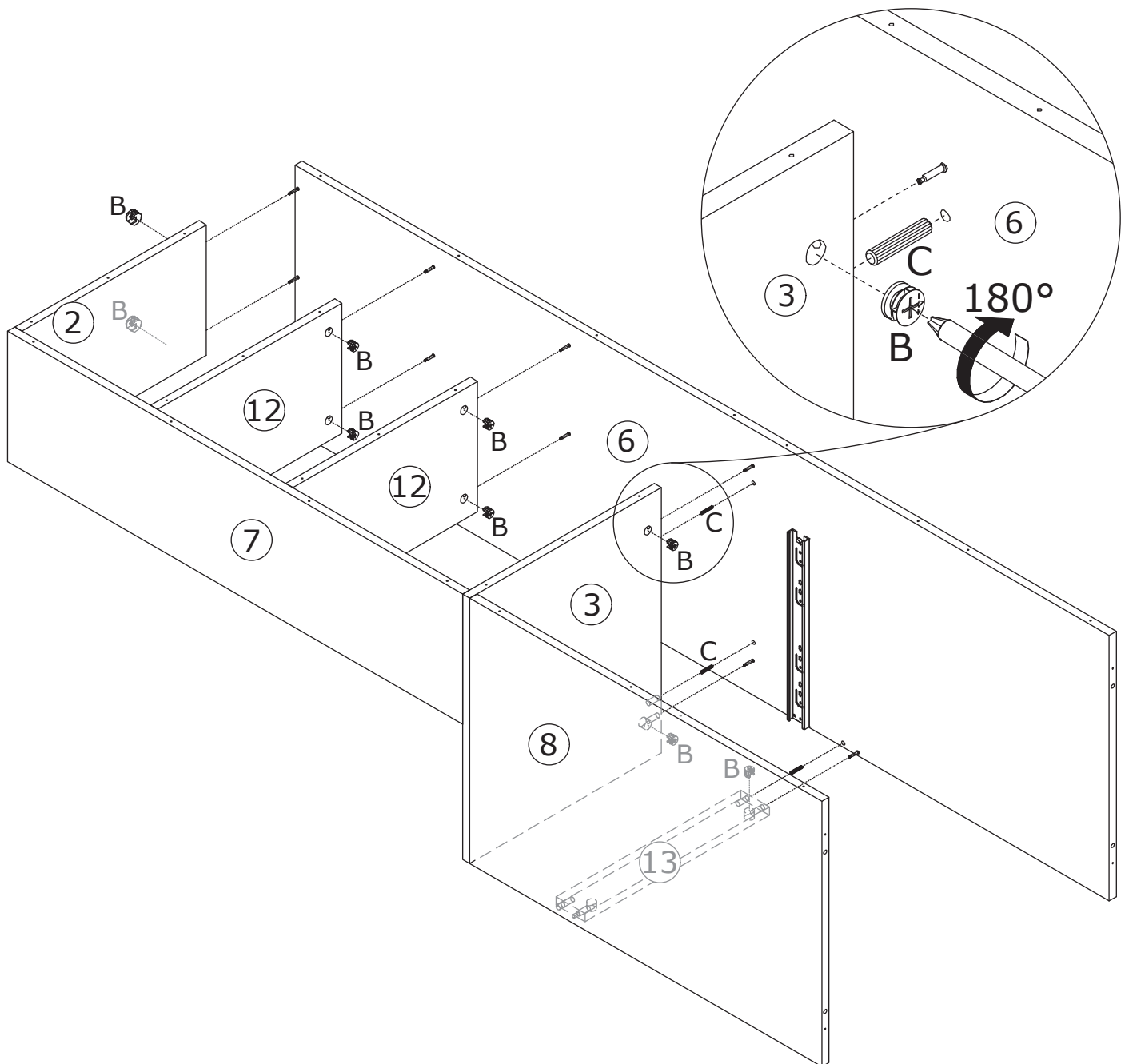
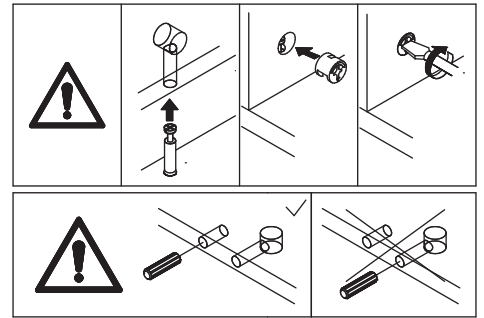

9

B x 8
CRB1595A

C x 8
CRF0830A

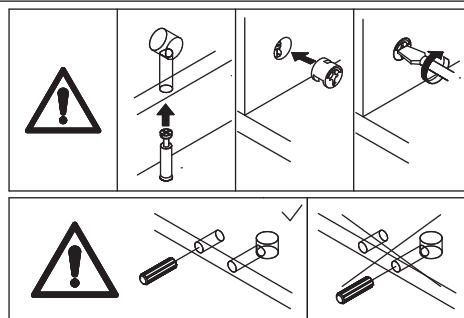
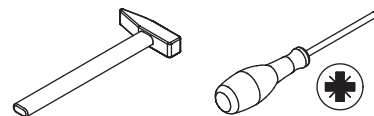

Attach panel 1, 10 and 11 to panel 6 using wooden dowel(C), add cam lock(B) into and turn clockwise to tighten as shown.

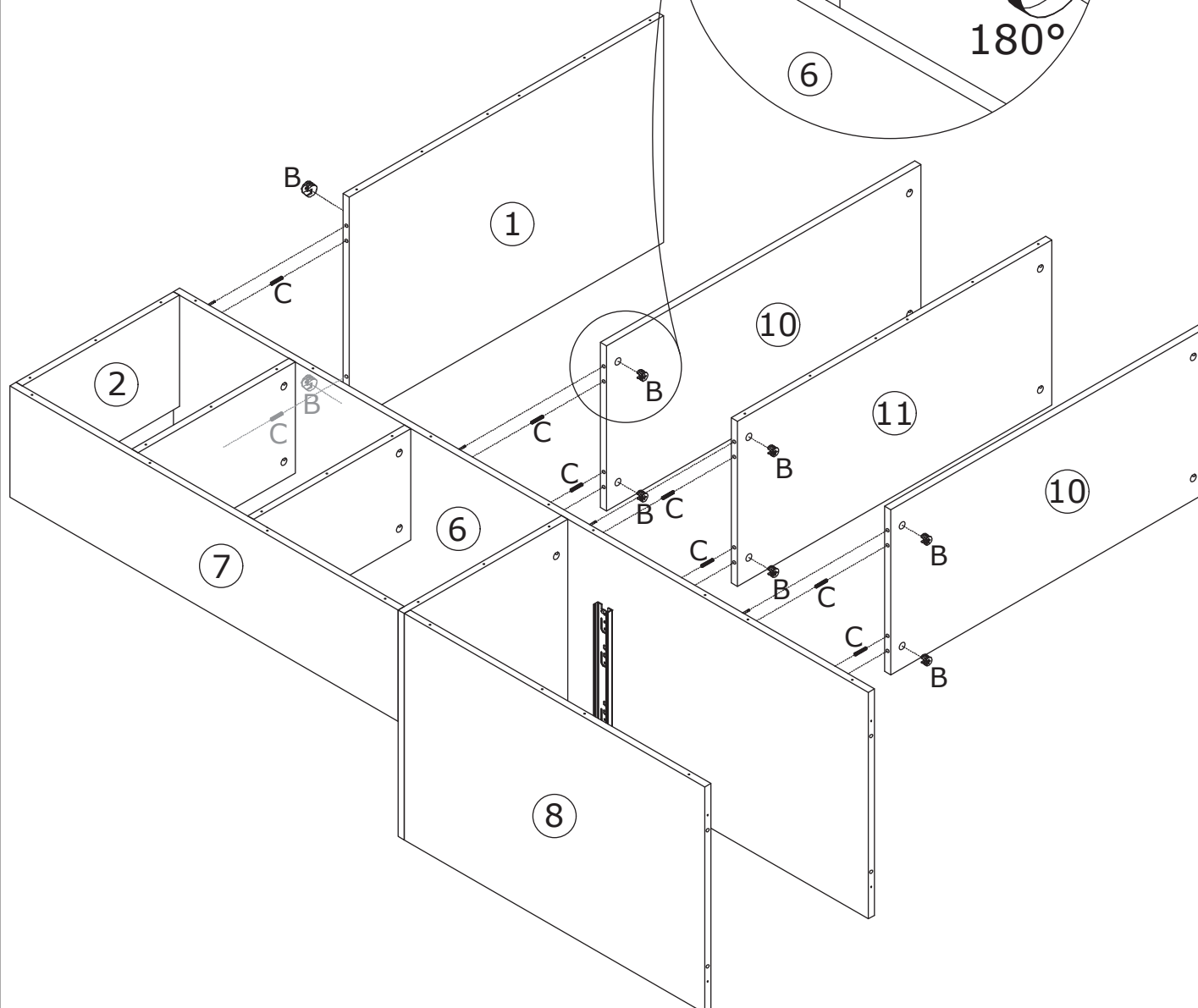
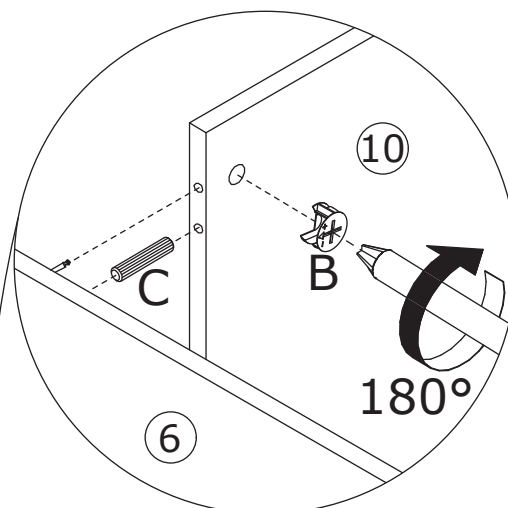

10

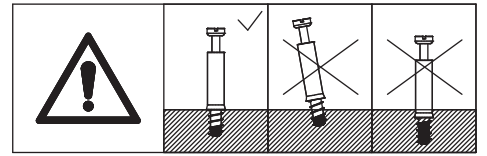
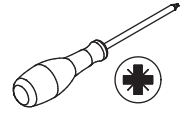
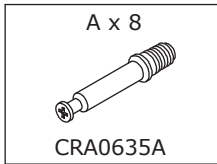

Screw eccentric rod(A) into panel 5 at first.

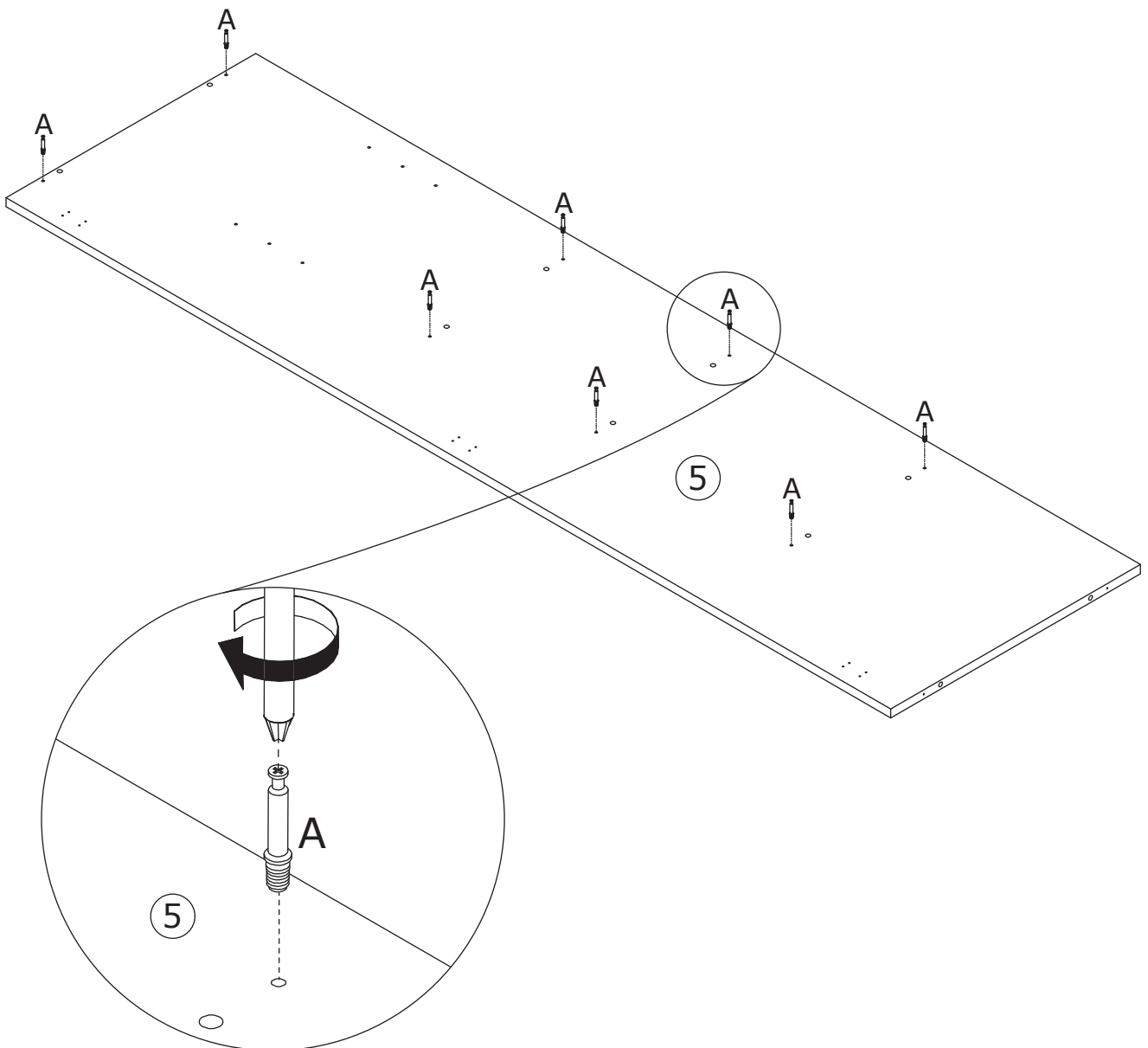

11

B x 8
CRB1595A

C x 8
CRF0830A

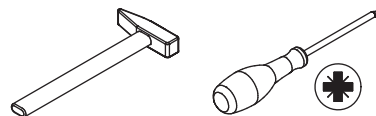

Attach panel 5 to panel 1, 10 and 11 using wooden dowel(C), add cam lock(B) into and turn clockwise to tighten as shown.

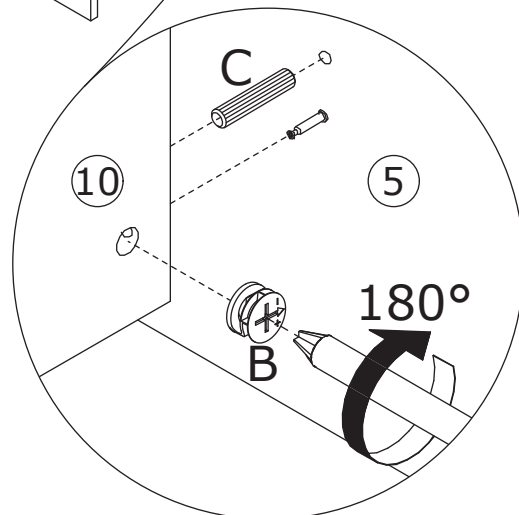
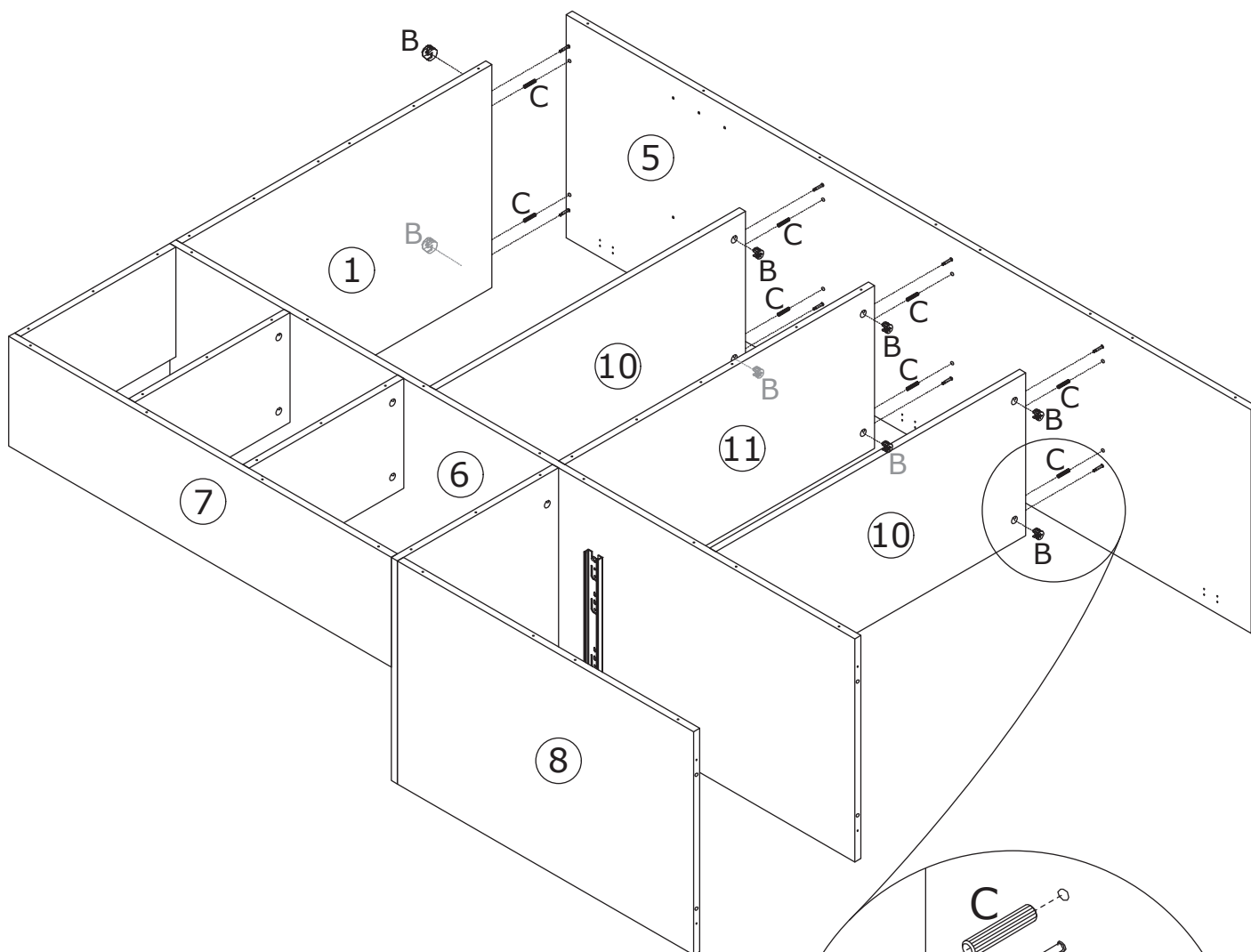
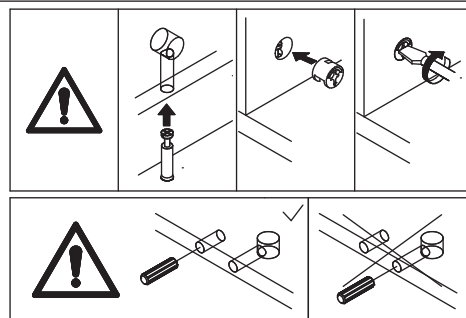

12

A x 14
CRA0635A

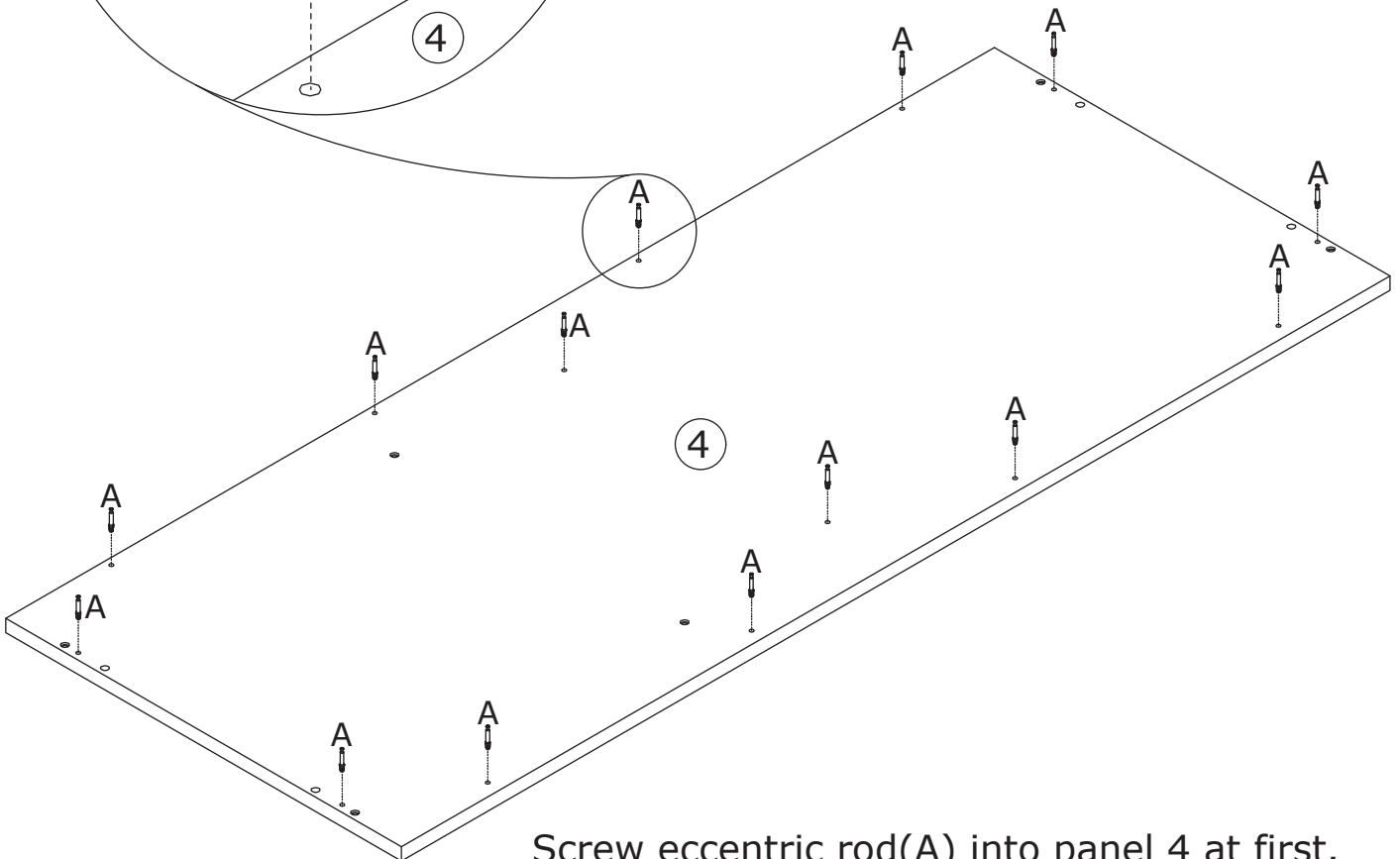
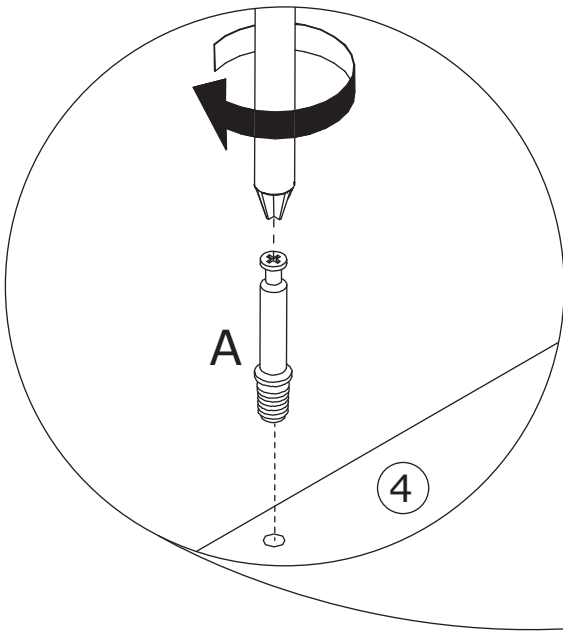
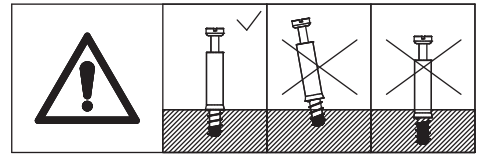
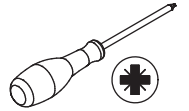

Screw eccentric rod(A) into panel 4 at first.

13

C x 6
CRF0830A

D x 6
CRD0440A

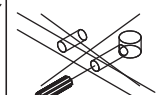
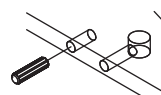
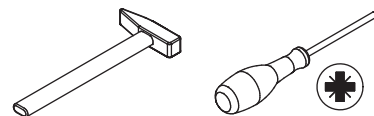

Attach panel 4 to panel 8, 6 and 5 using wooden dowel(C), and fix with screw(D) as shown.

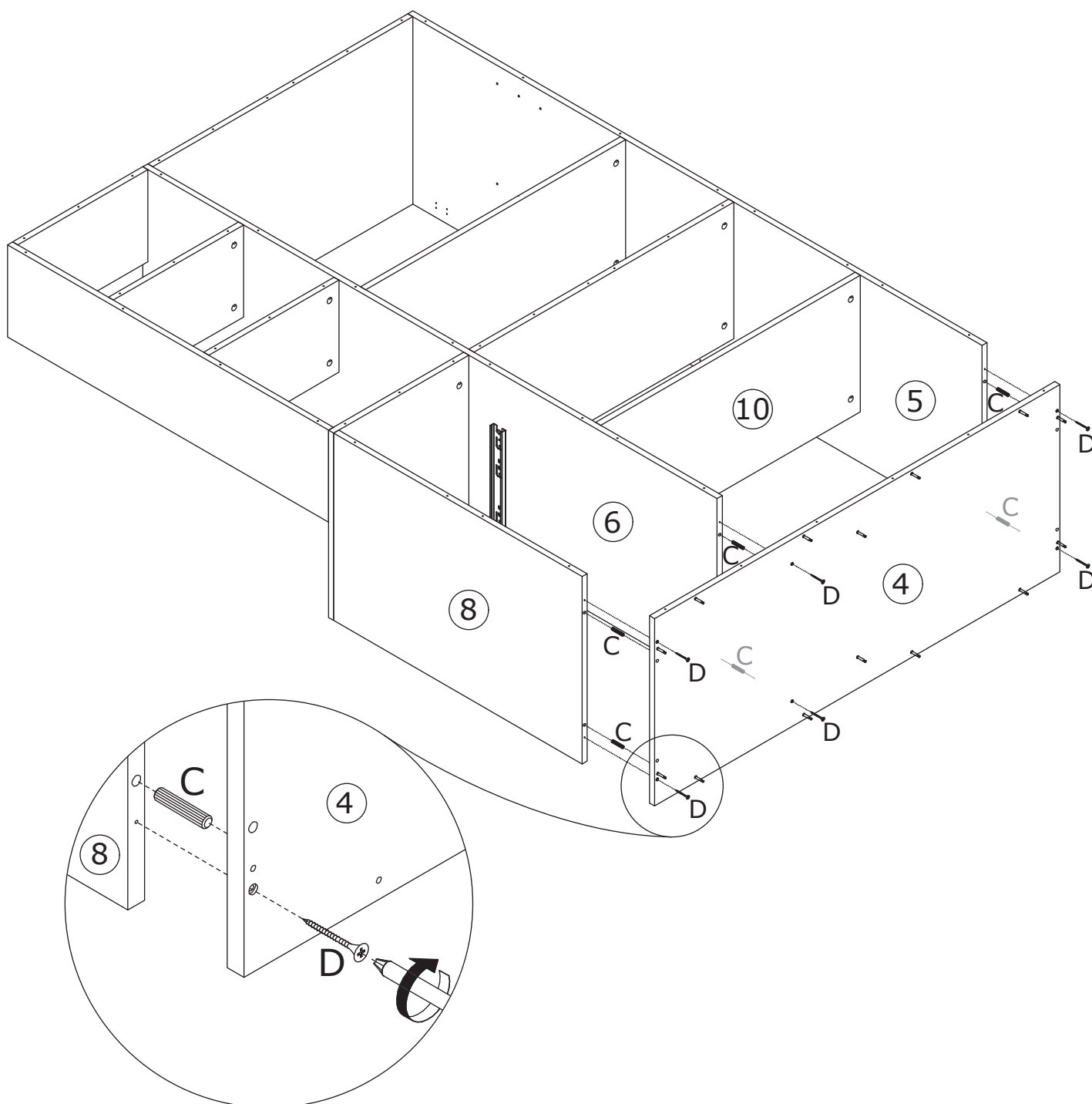

14

A x 2
CRA0635A

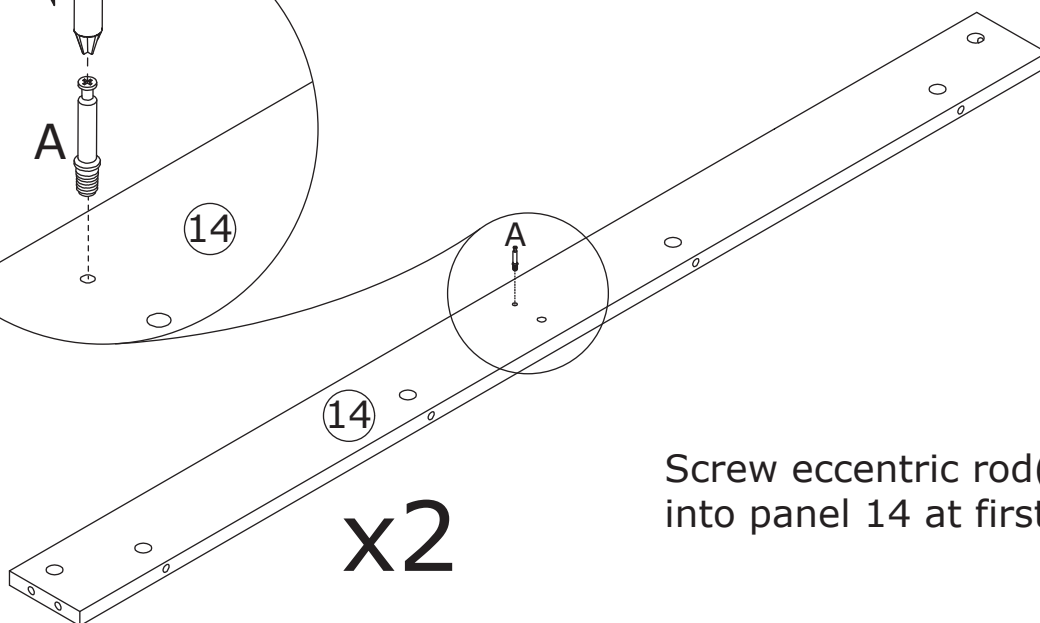
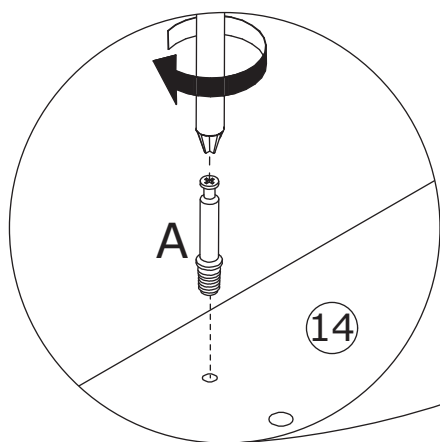
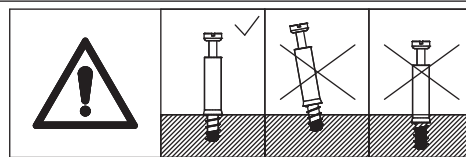
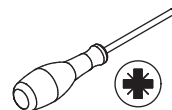

Screw eccentric rod(A)
into panel 14 at first.

15

B x 2
CRB1595A

C x 2
CRF0830A

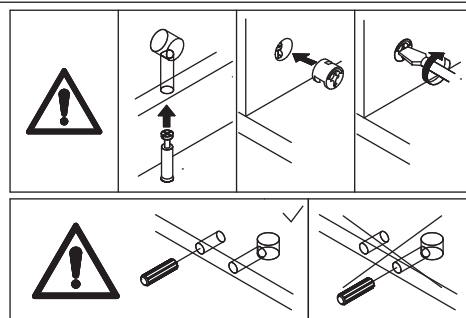
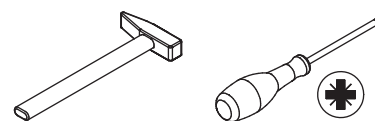

Connect panel 16 to panel 14
using wooden dowel(C), add
cam lock(B) into and turn
clockwise to tighten as shown.

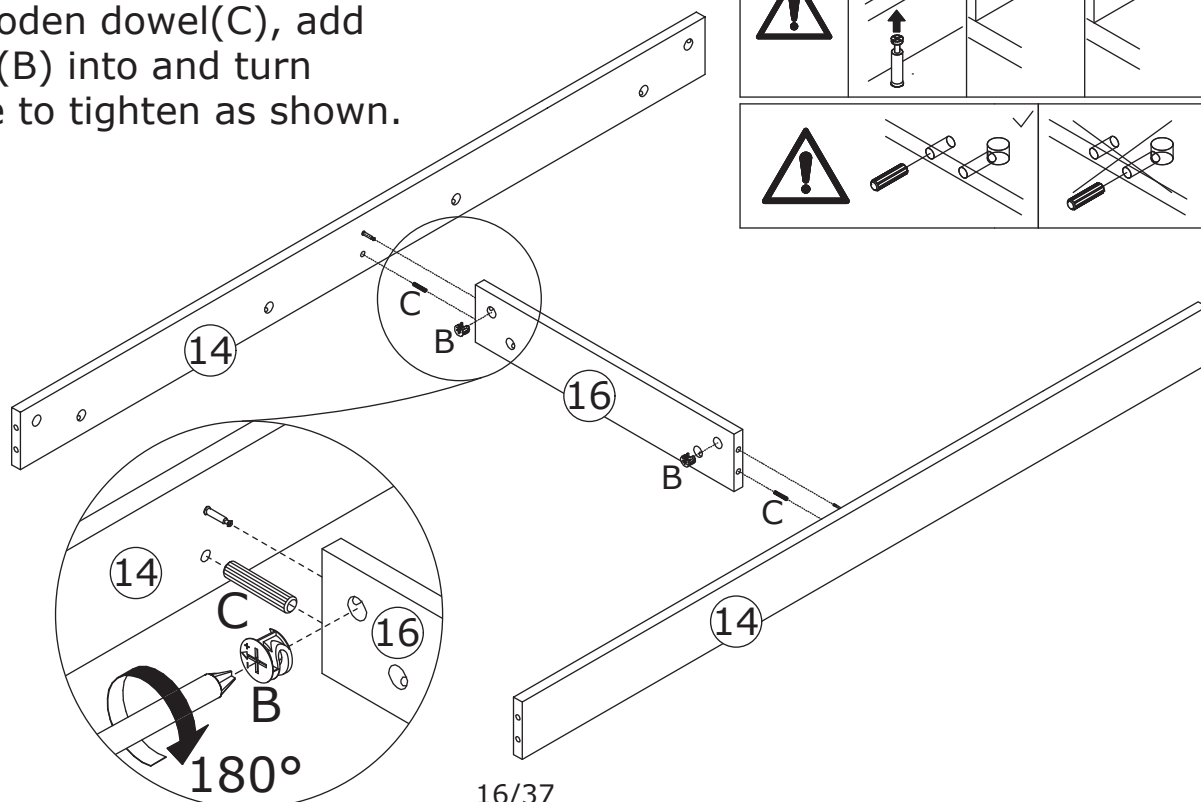

16

A x 4

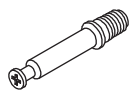

CRA0635A

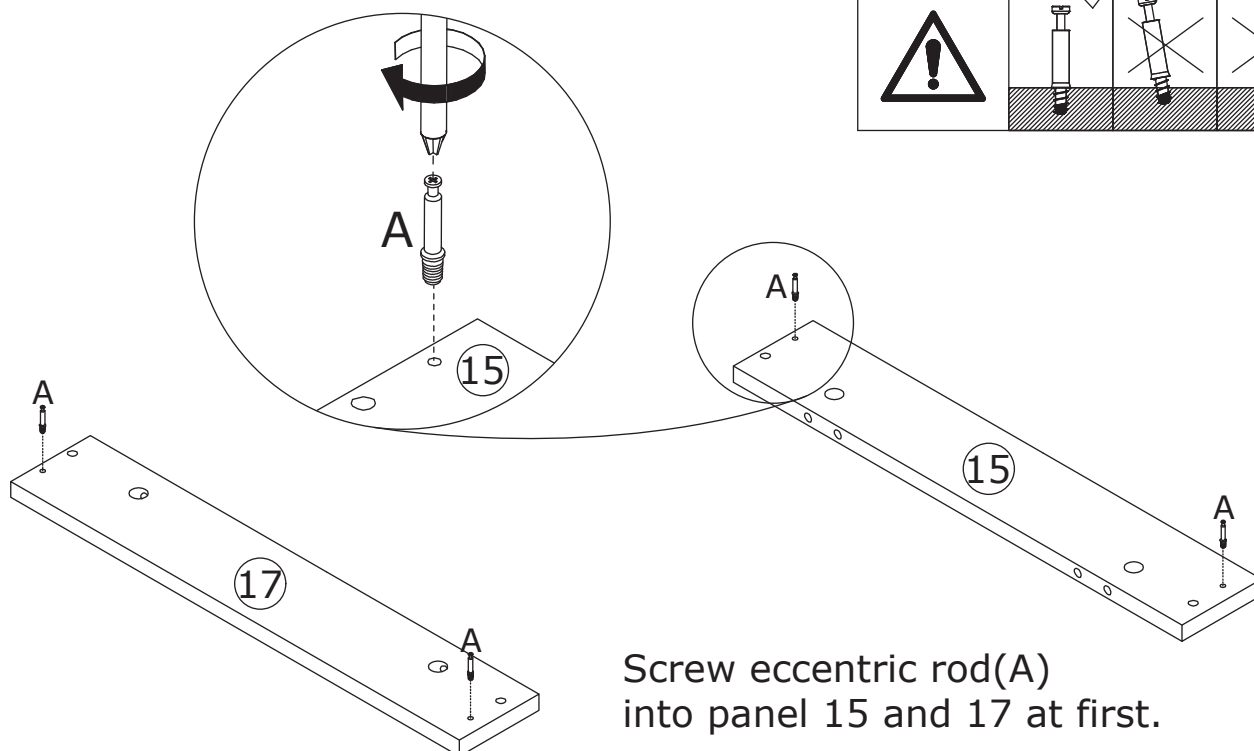
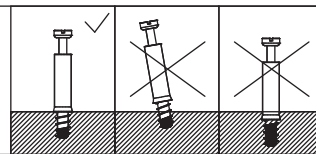
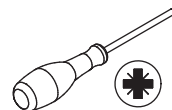

Screw eccentric rod(A)
into panel 15 and 17 at first.

17

B x 4



CRB1595A

C x 4

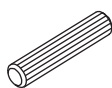

CRF0830A

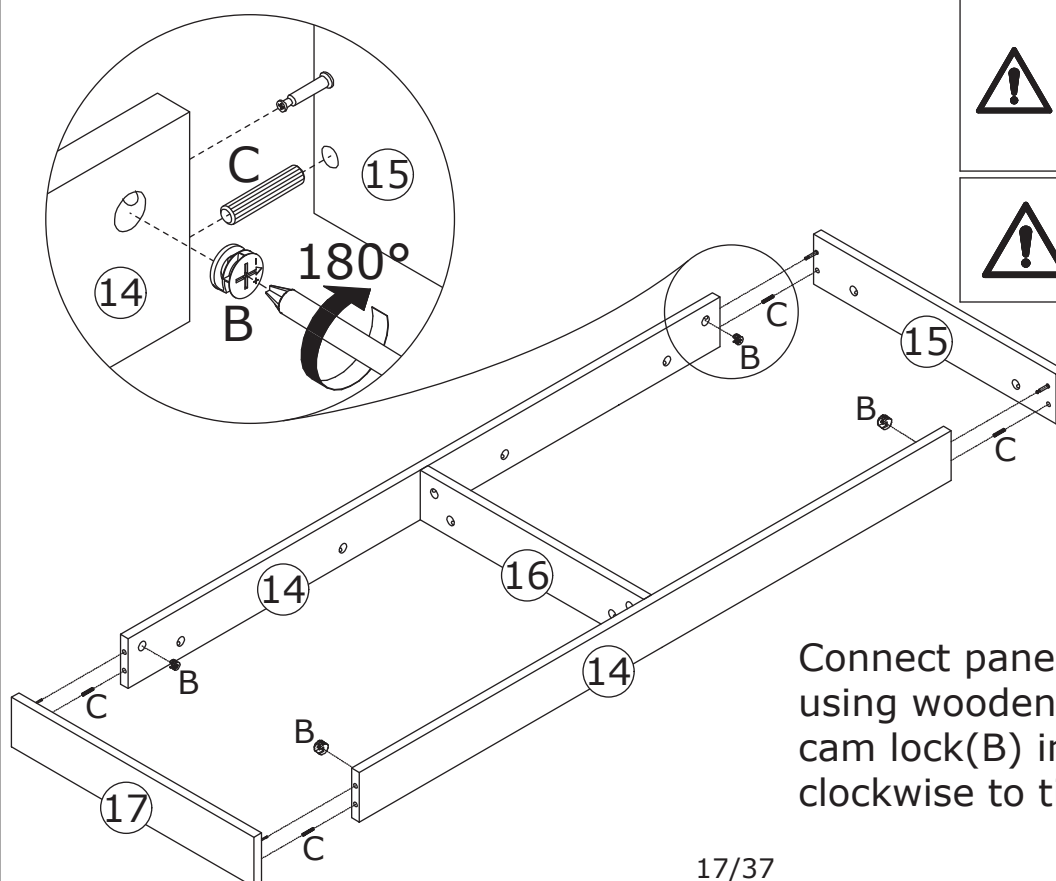
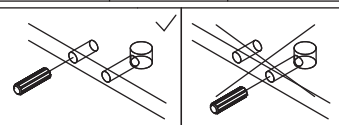
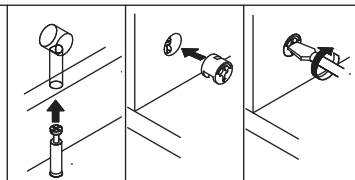
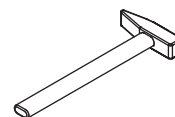

Connect panel 17 to panel 14
using wooden dowel(C), add
cam lock(B) into and turn
clockwise to tighten as shown.



18

<p>B x 14</p>  <p>CRB1595A</p>	<p>C x 4</p>  <p>CRF0830A</p>	
---	--	---

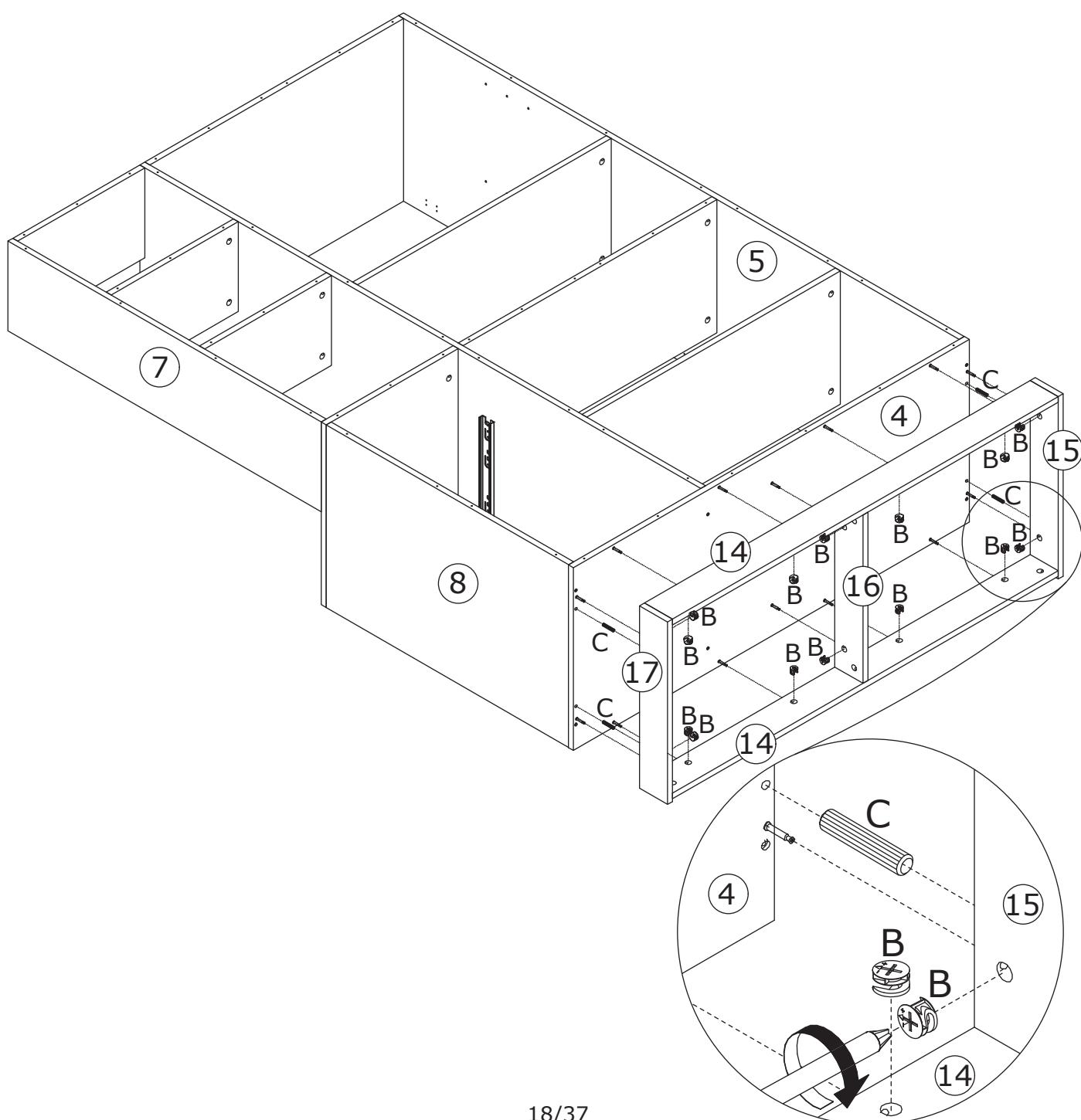
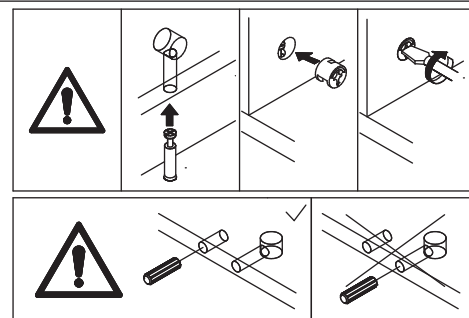
Attach the component to panel 4 using wooden dowel(C), add cam lock(B) into and turn clockwise to tighten as shown.

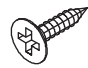
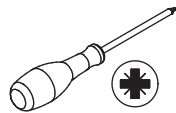

19

<p>P x 41</p>  <p>CRE0312A</p>	<p>Q x 9</p>  <p>15.5 x 10 x 1.2 mm</p>	<p>R x 4</p>  <p>20 x 12 x 1 mm</p>	<p>S x 13</p>  <p>CRD0316A</p>	
---	--	--	--	---

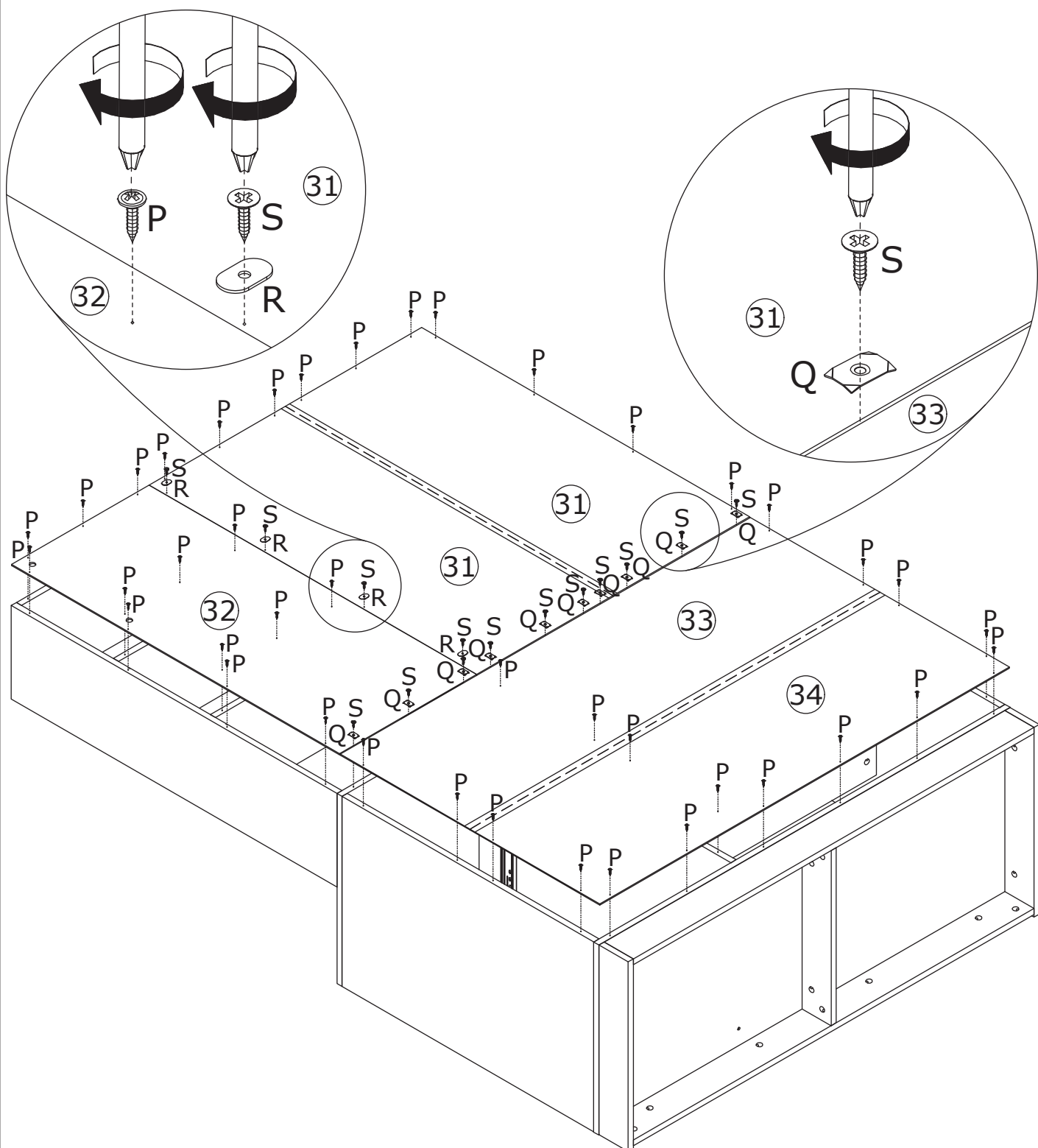

Fix back panel 31, 32, 33 and 34 using screw(P) at first.
Using iron sheet(R,Q) to fix each panel with screw(S).

20

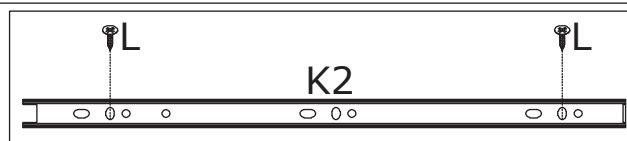
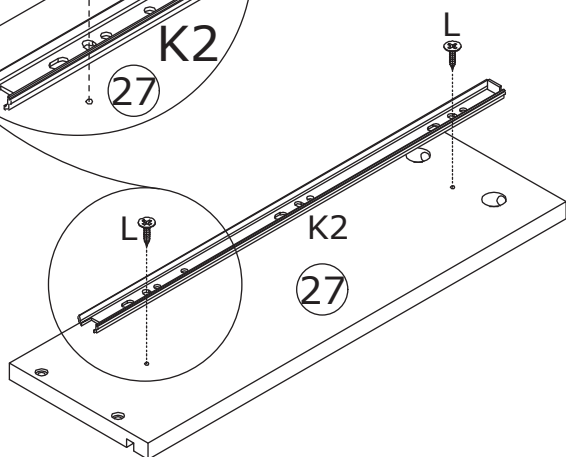
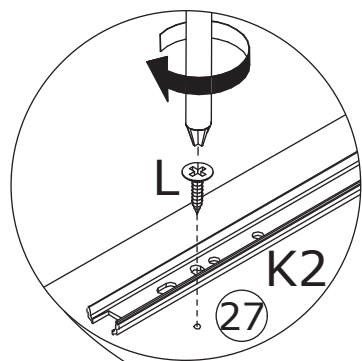
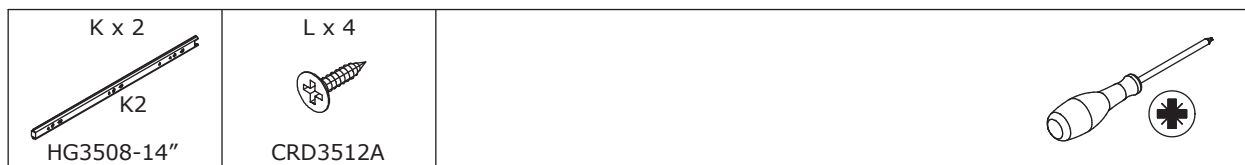

Fix rail(K2) to panel 27 and 28 with screw(L) as shown.

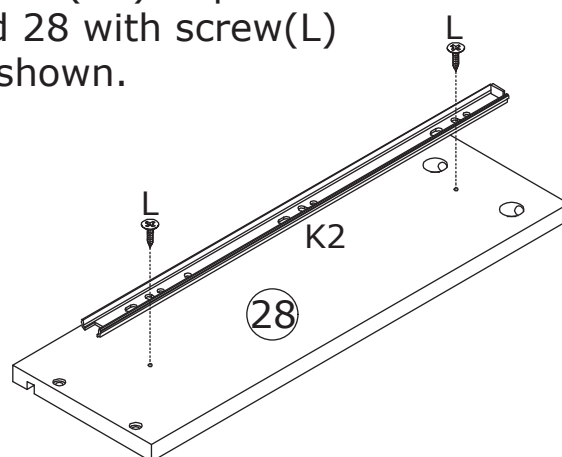

21

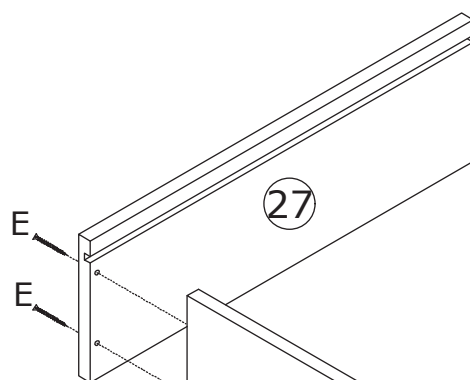
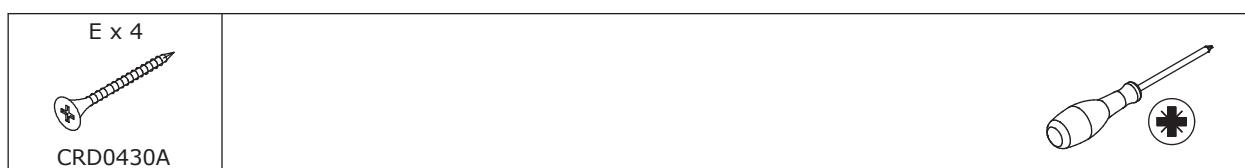

Fix panel 29 to panel 27 and 28 with screw(E) as shown.

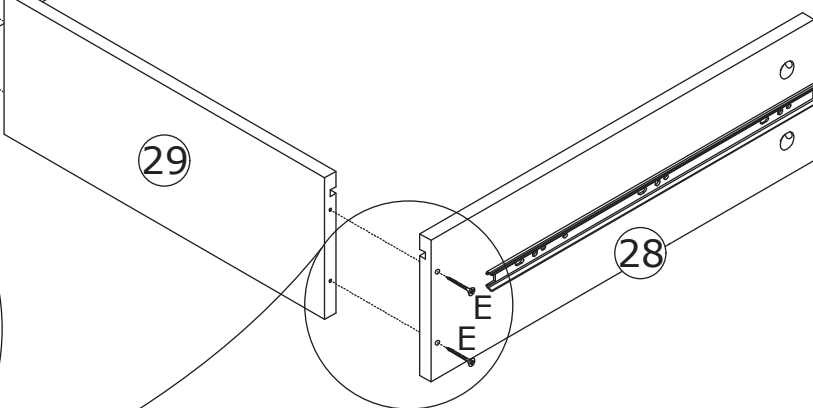
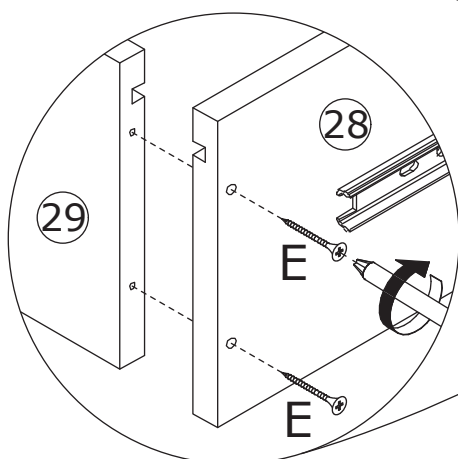

22

Slide panel 30 along available grooves at first.

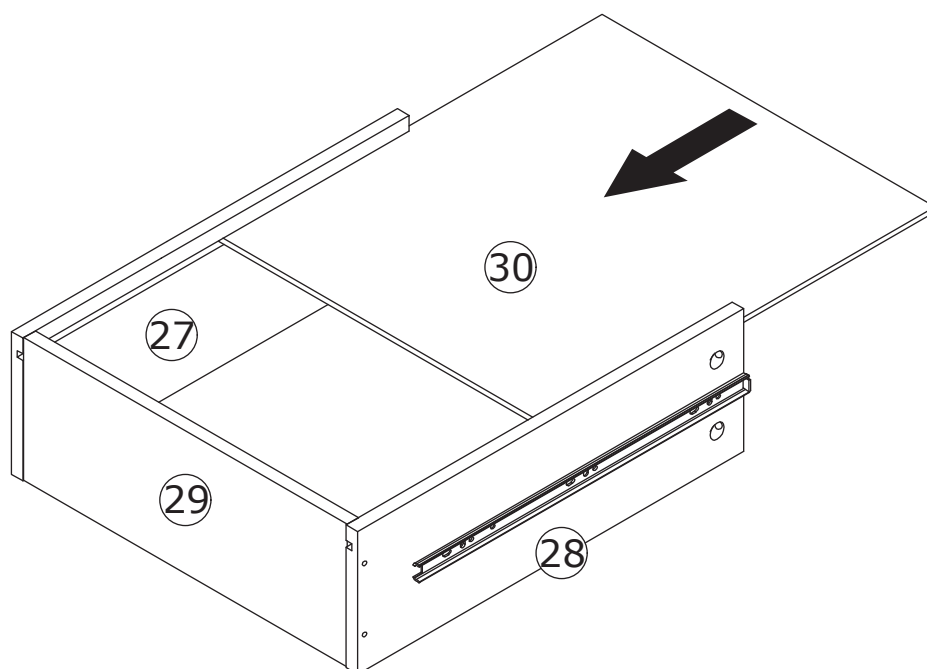

23

A x 4
CRA0635A

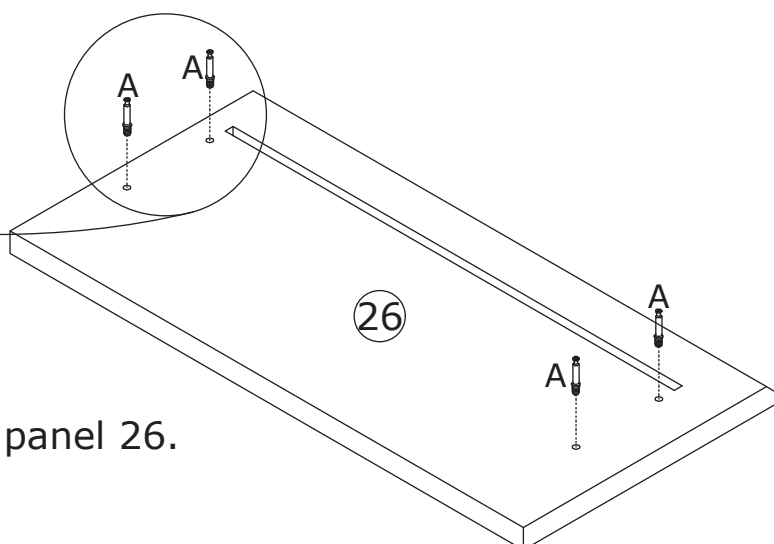
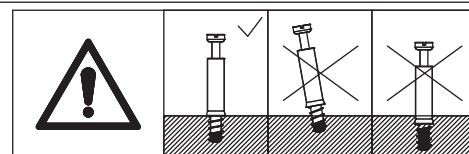
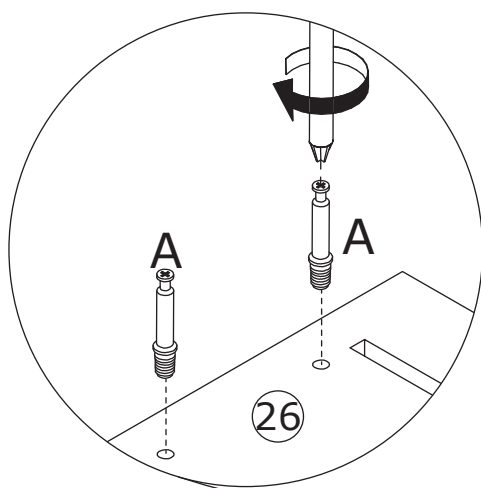
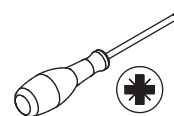

Screw eccentric rod(A) into panel 26.

24

B x 4



CRB1595A

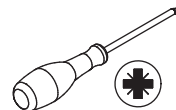

Attach panel 26 to panel 27 and 28, add cam lock(B) into and turn clockwise to tighten as shown.

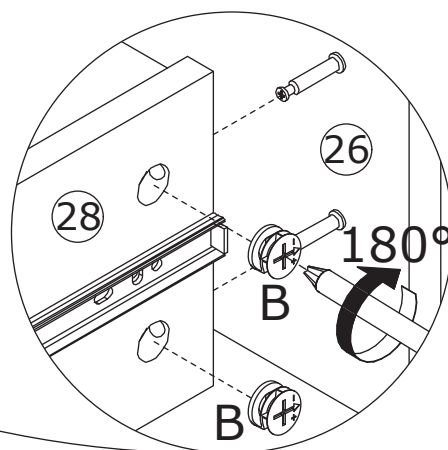
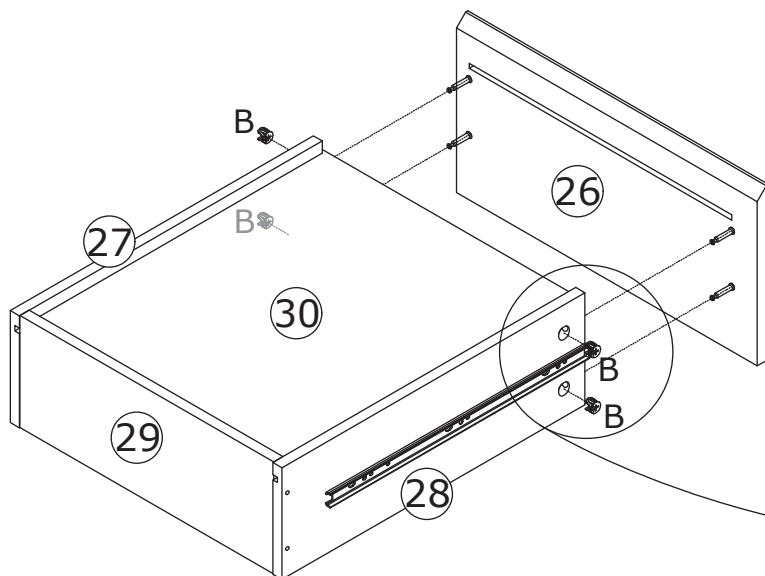
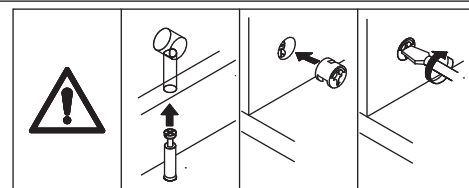

25

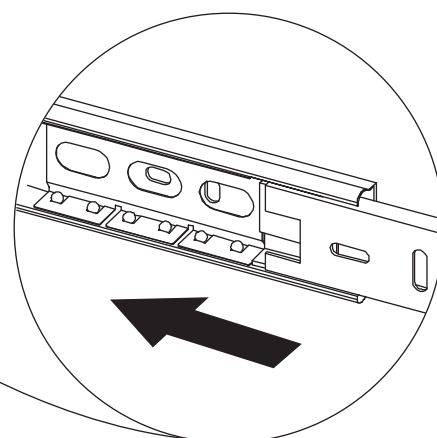
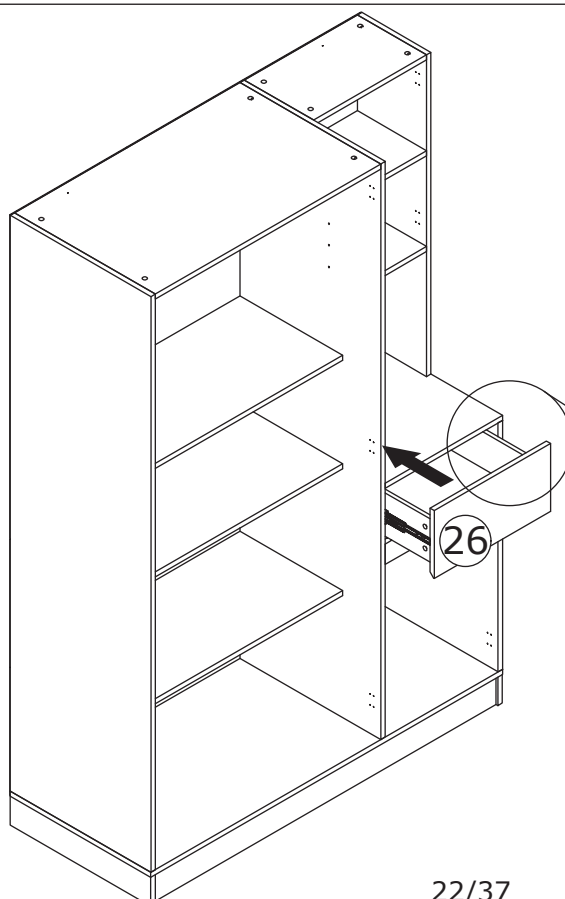

Align rails, slide drawer in.

26

F x 2
DGA861A

J x 4
CRD3514A

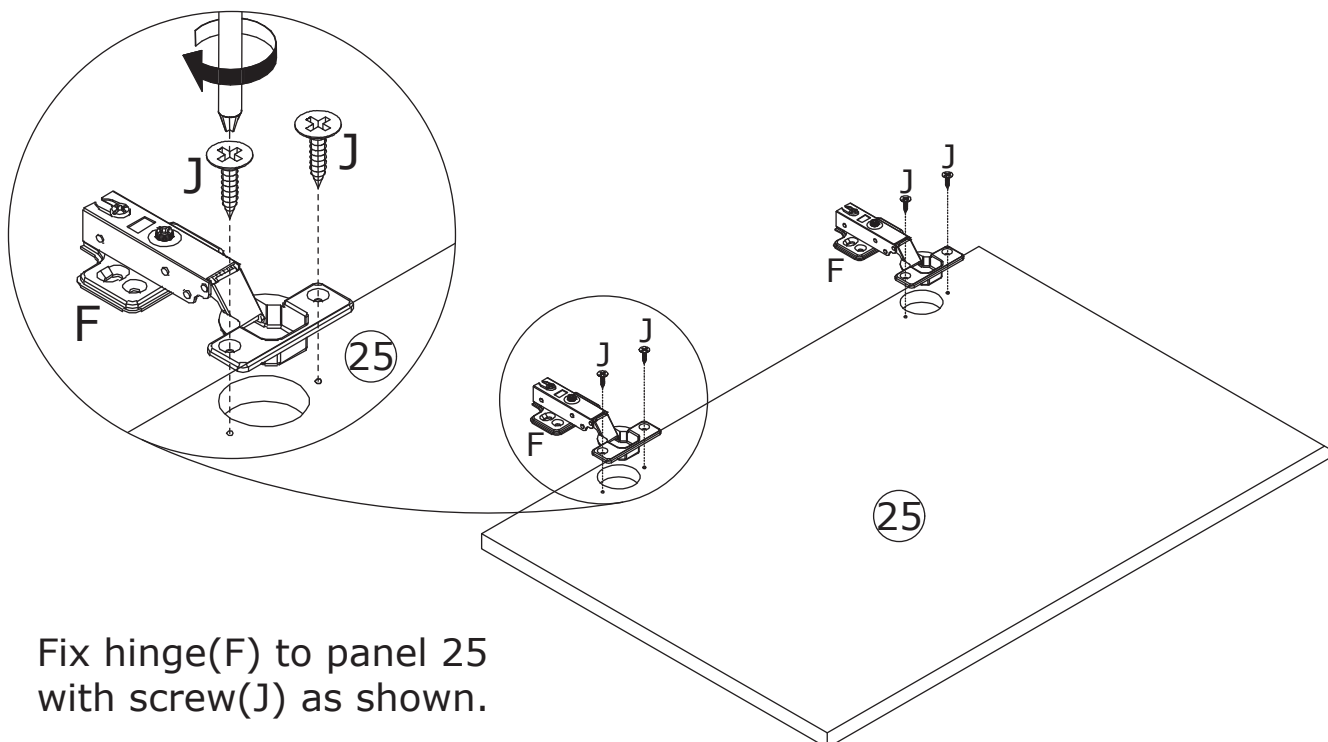
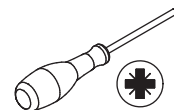

Fix hinge(F) to panel 25
with screw(J) as shown.

27

J x 8
CRD3514A

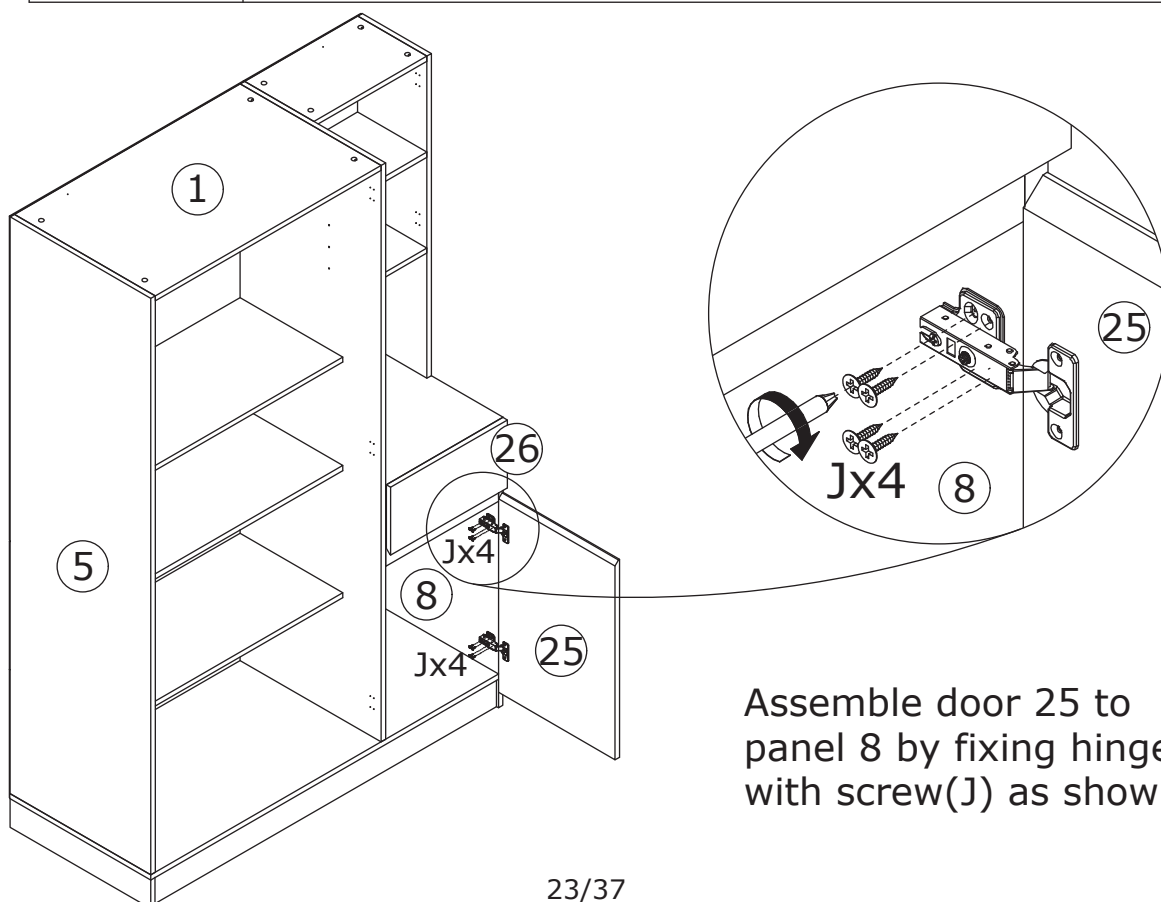

Assemble door 25 to
panel 8 by fixing hinge
with screw(J) as shown.

28

U x 2



96 x 55 x 27 mm

V x 4



Ø4 x 8 mm

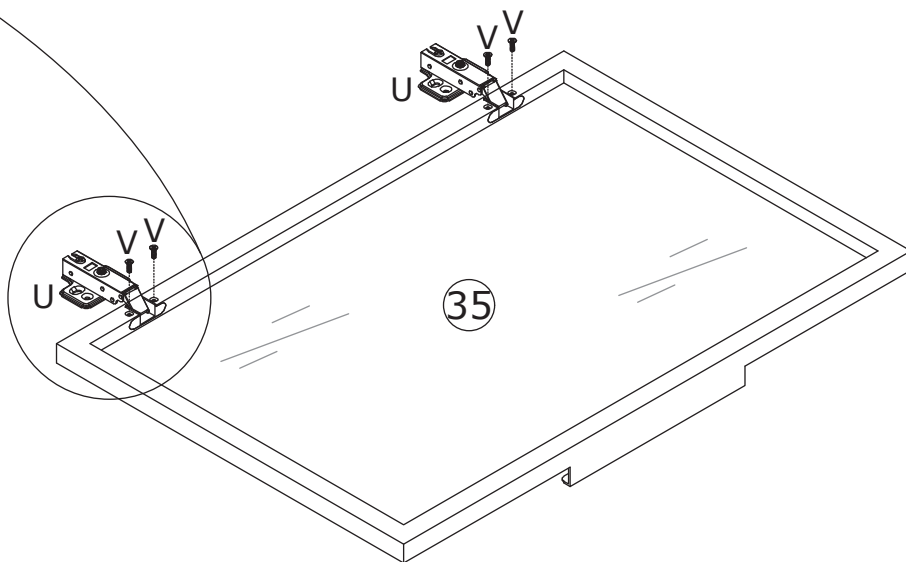
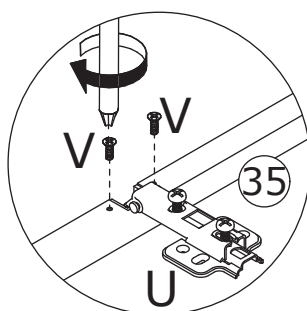
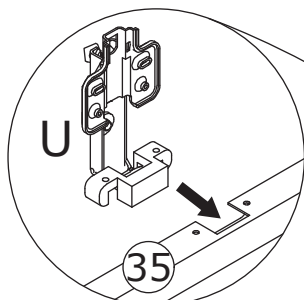
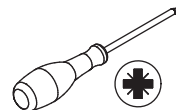

Fix hinge(U) to panel 35 with screw(V) as shown.

29

J x 8



CRD3514A

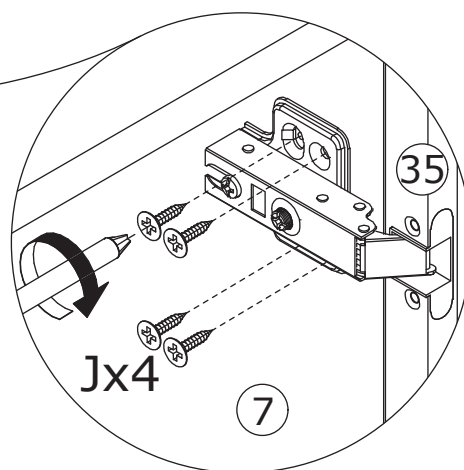
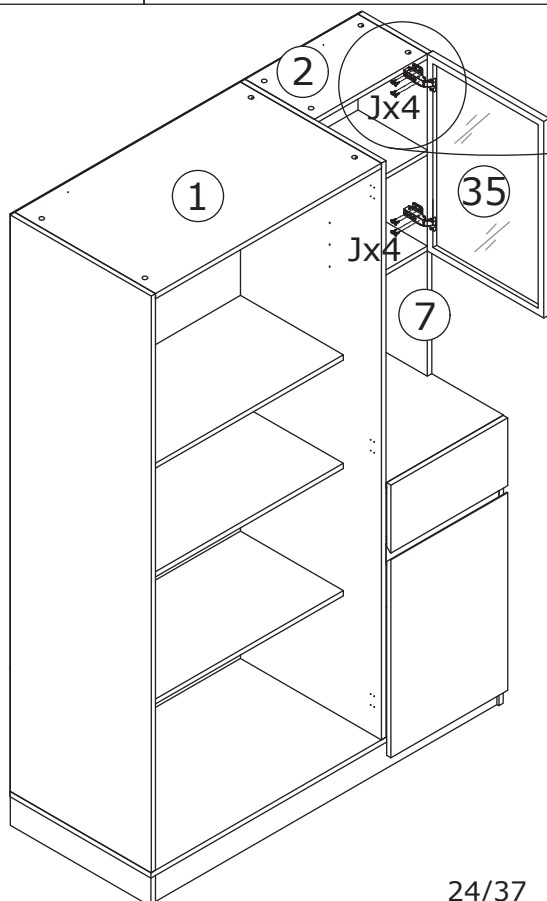
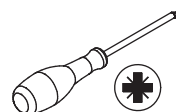

Assemble door 35 to panel 7 by fixing hinge with screw(J) as shown.

30

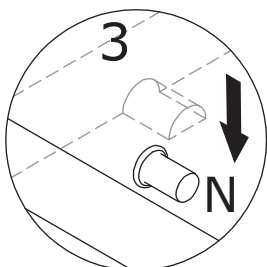
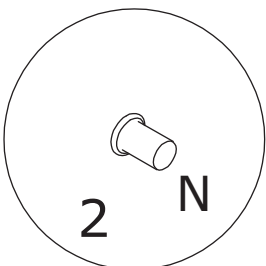
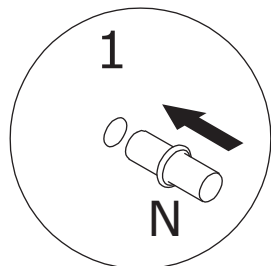
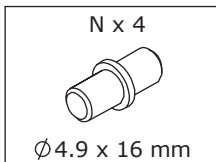

Insert layer pin(N)
into panel 5 and 6,
then place shelf panel 9 on.

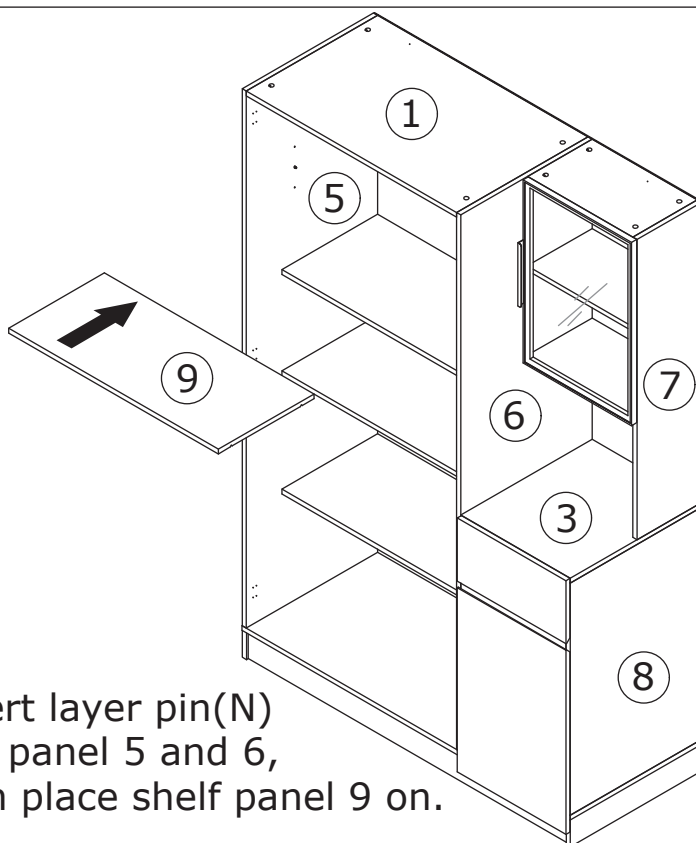

31

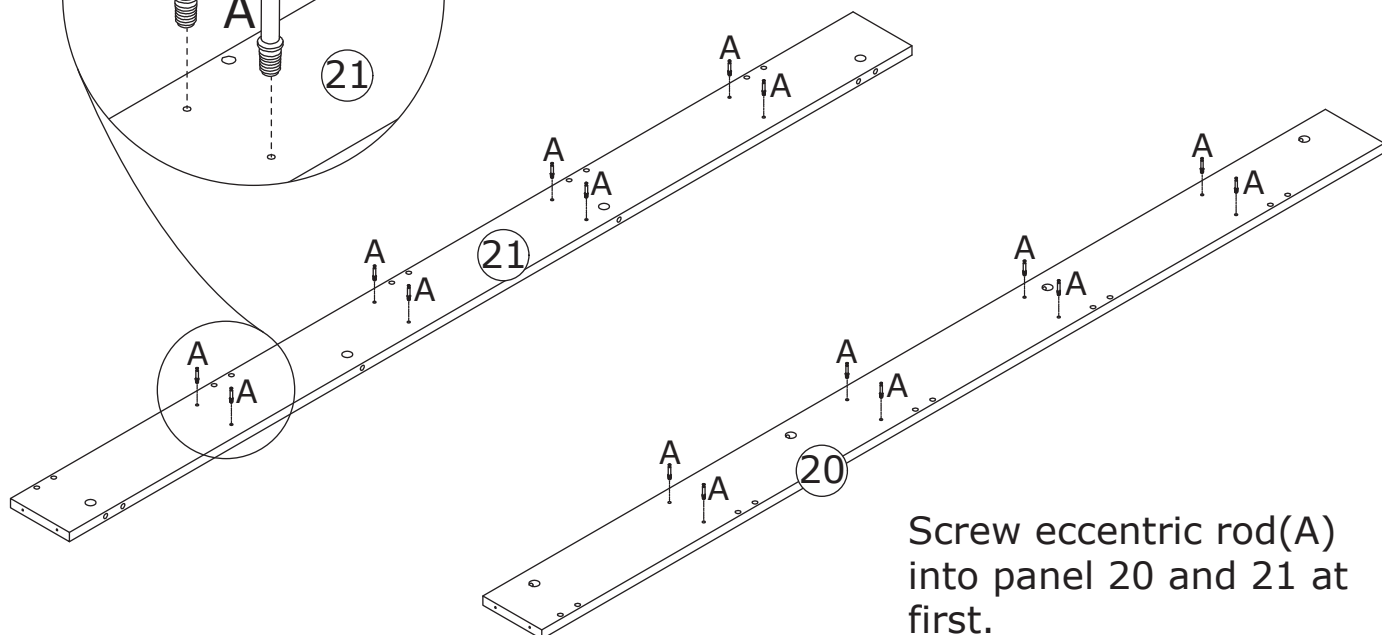
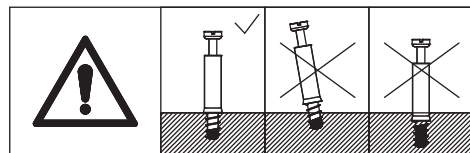
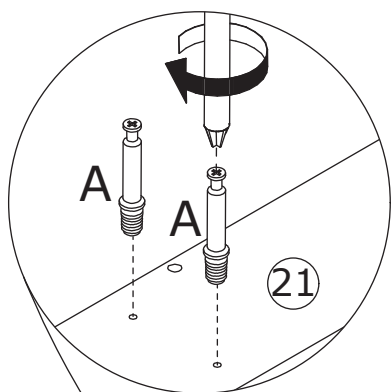
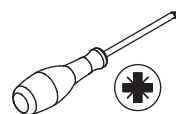
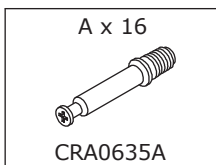

Screw eccentric rod(A)
into panel 20 and 21 at
first.

32

B x 16



CRB1595A

C x 20

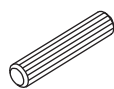

CRF0830A

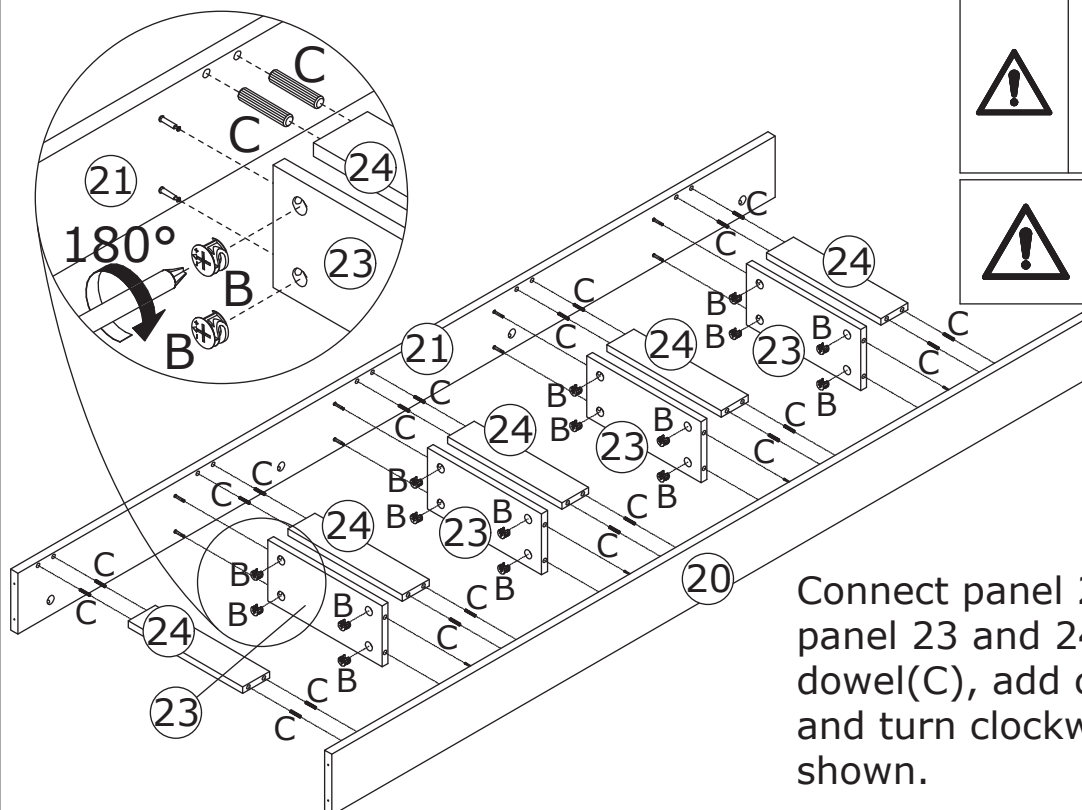
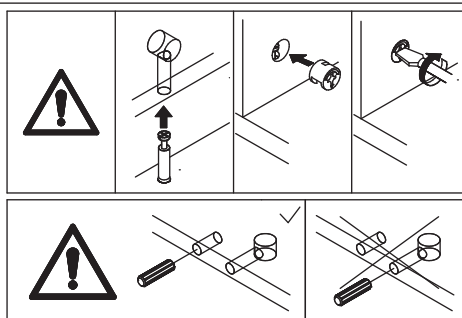
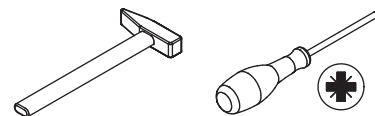

Connect panel 21 and 20 to panel 23 and 24 using wooden dowel(C), add cam lock(B) into and turn clockwise to tighten as shown.

33

E x 8

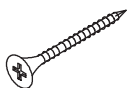

CRD0430A

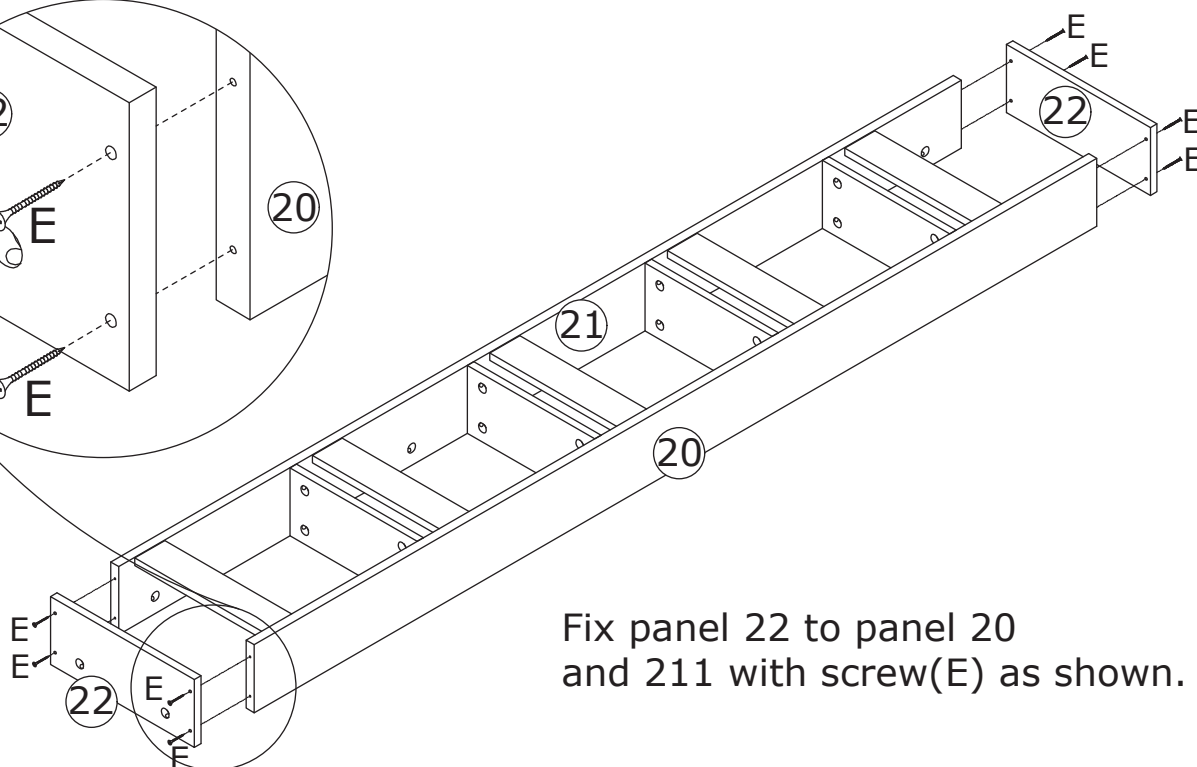
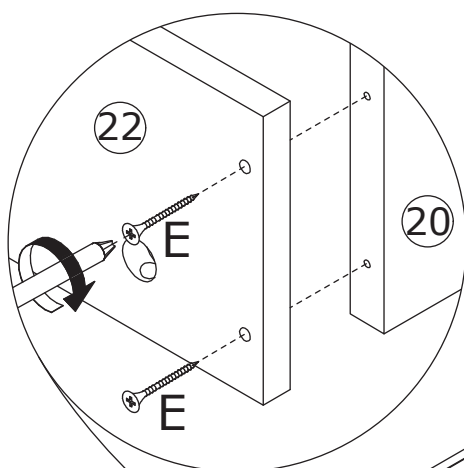
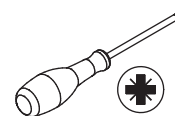

Fix panel 22 to panel 20 and 21 with screw(E) as shown.

34

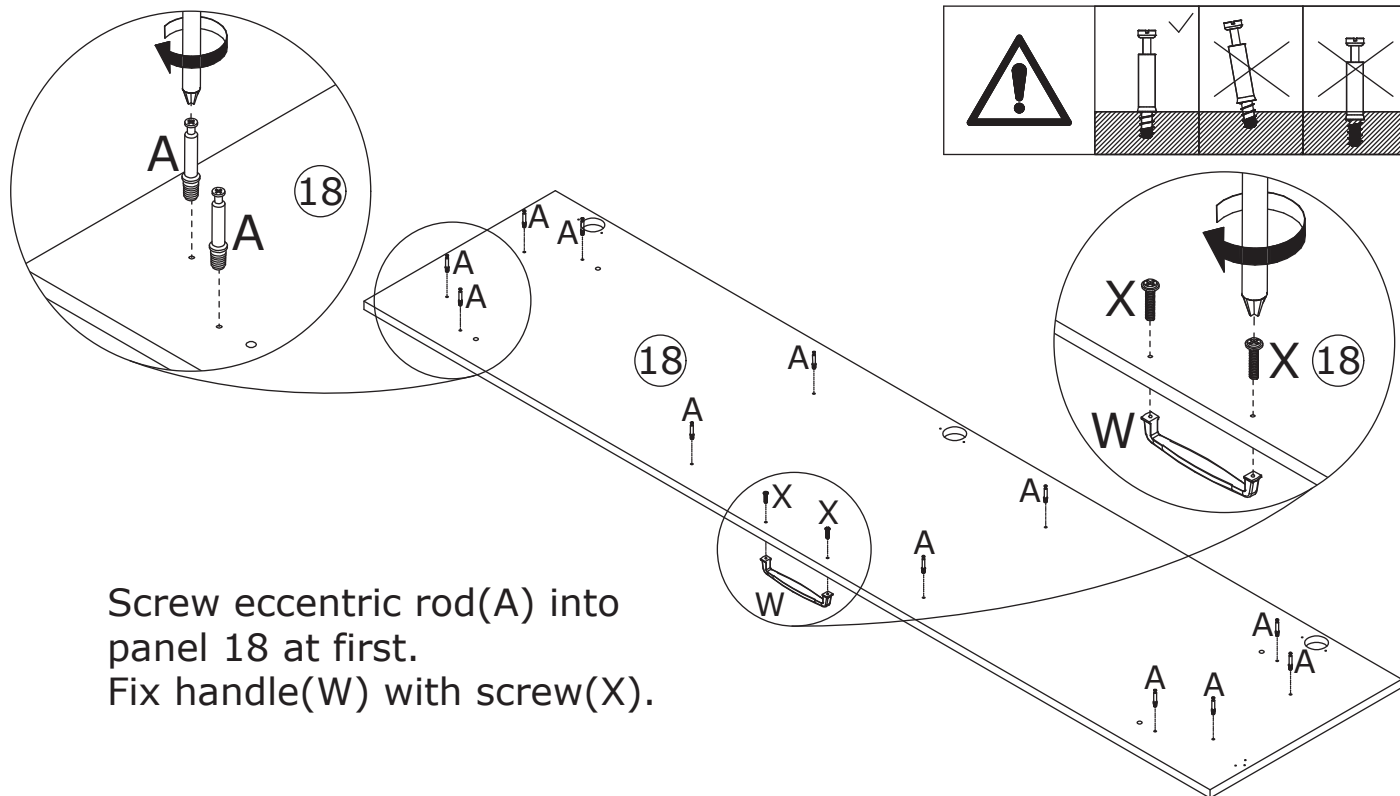
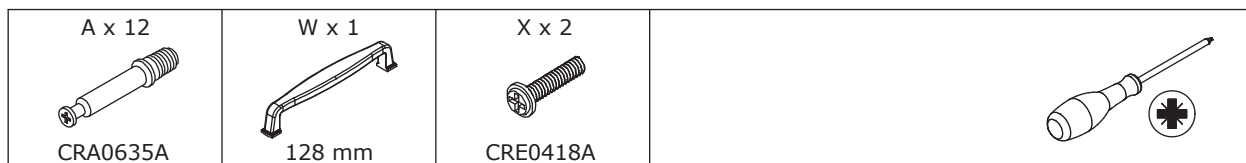

Screw eccentric rod(A) into panel 18 at first.
Fix handle(W) with screw(X).

35

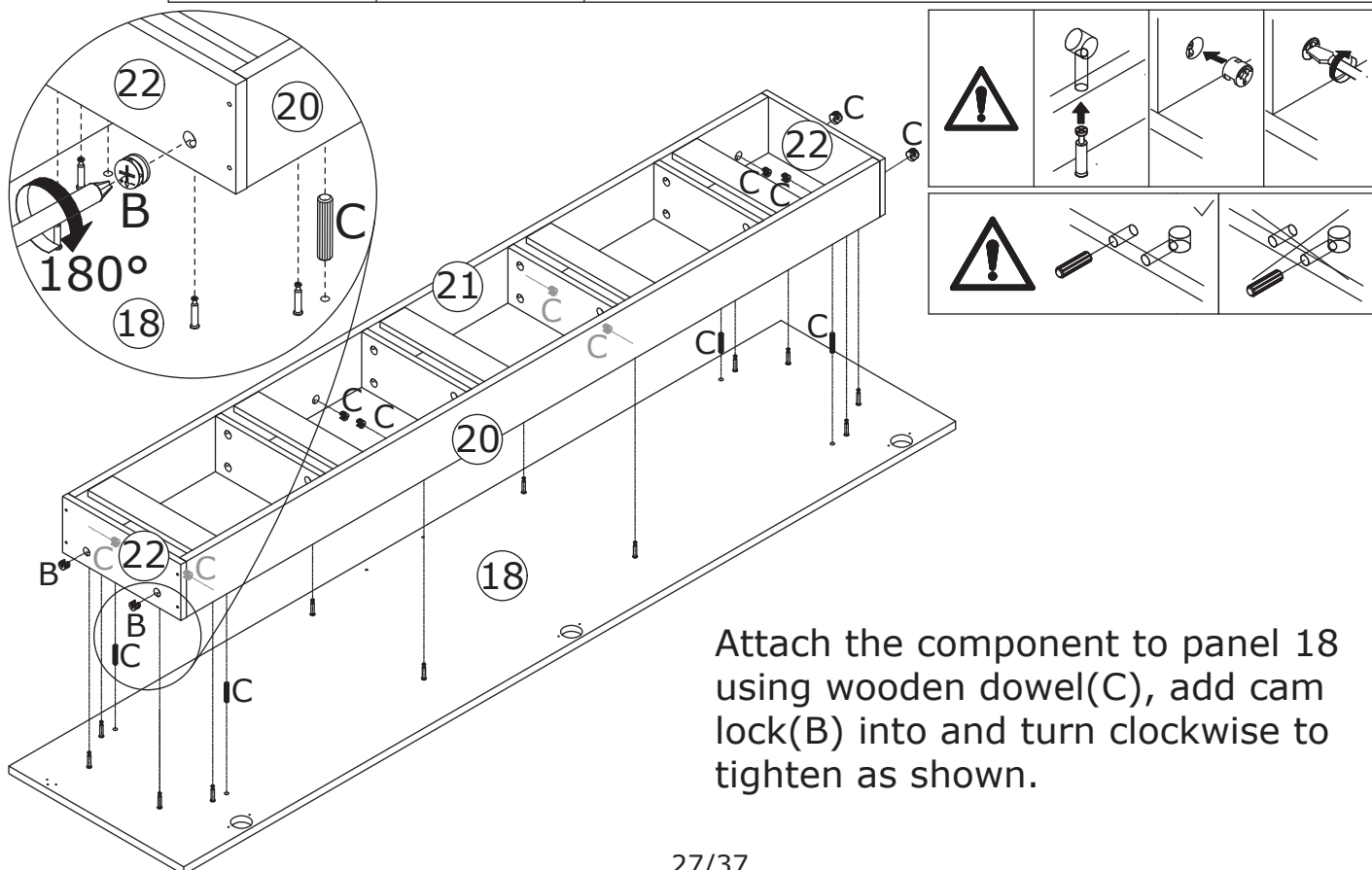

Attach the component to panel 18 using wooden dowel(C), add cam lock(B) into and turn clockwise to tighten as shown.

36

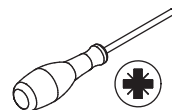
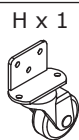

Fix hinge(G) to panel 18 with screw(J) as shown.
Fix wheel(H) with screw(J) as shown.

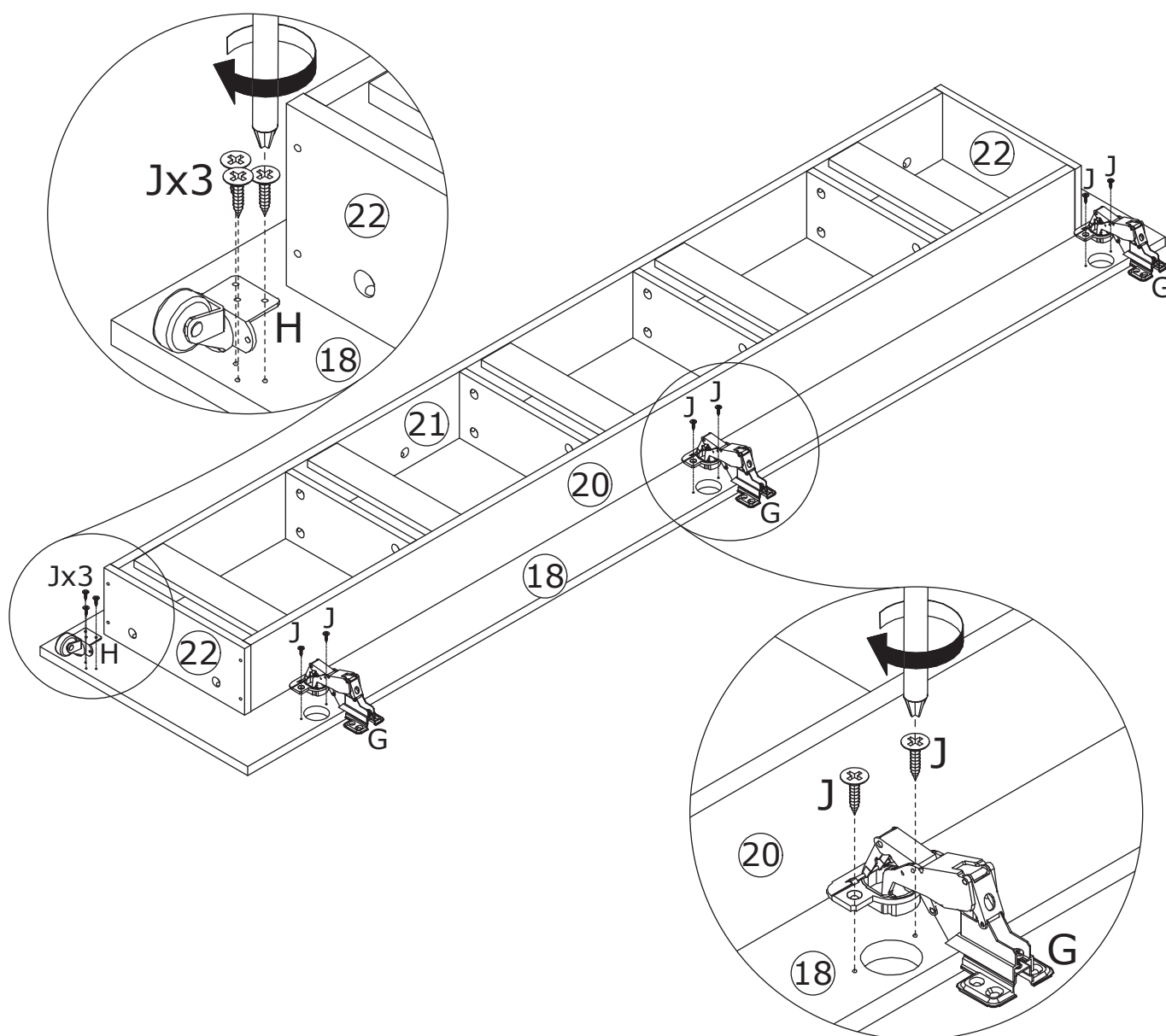

37

J x 12



CRD3514A

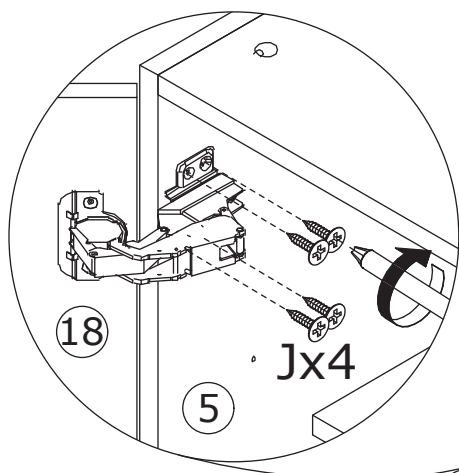
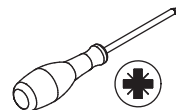

Assemble door 18 to panel 5 by fixing hinge with screw(J) as shown.

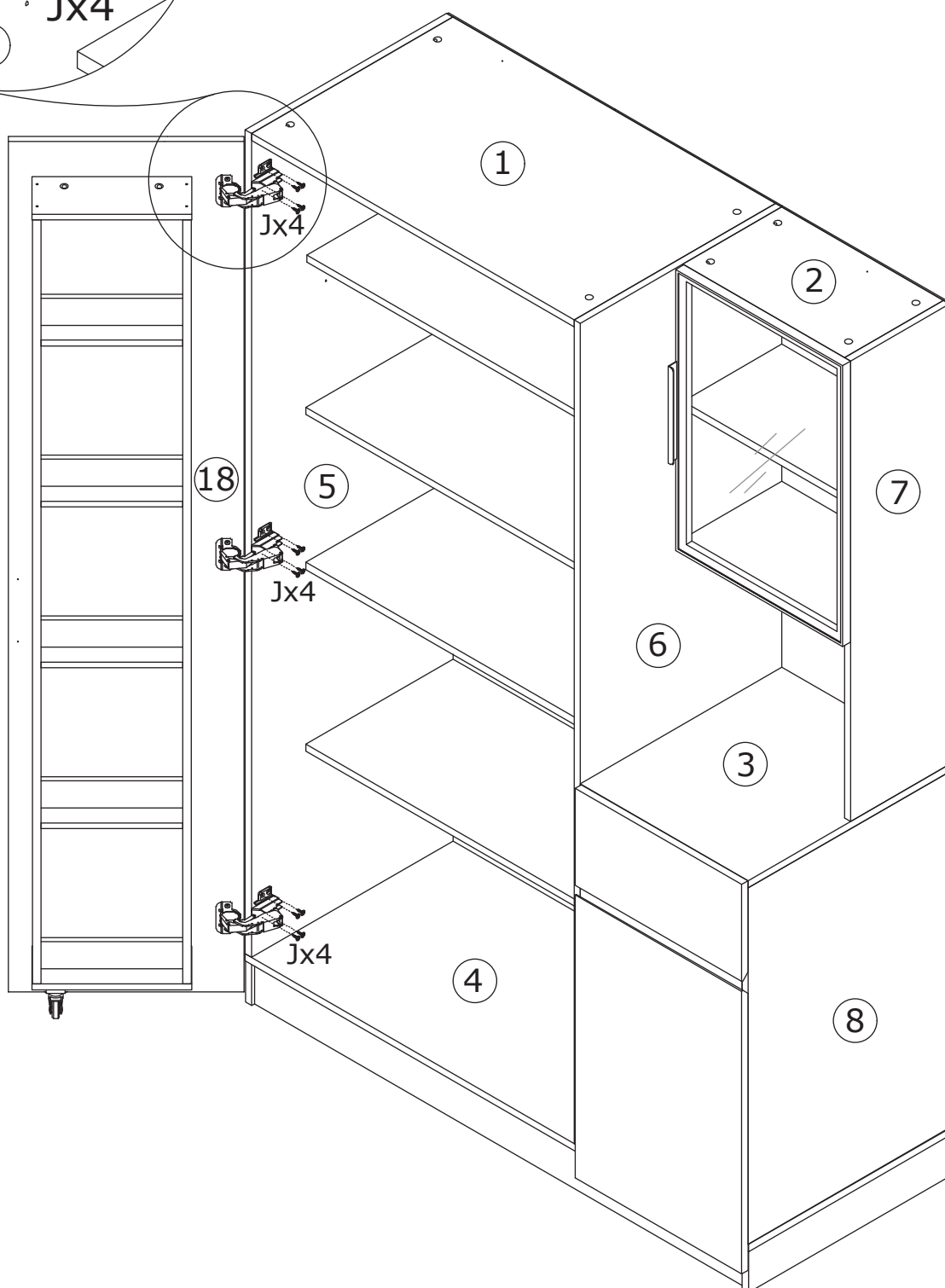

38

A x 16
CRA0635A

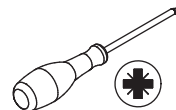

Screw eccentric rod(A) into panel 20 and 21 at first.

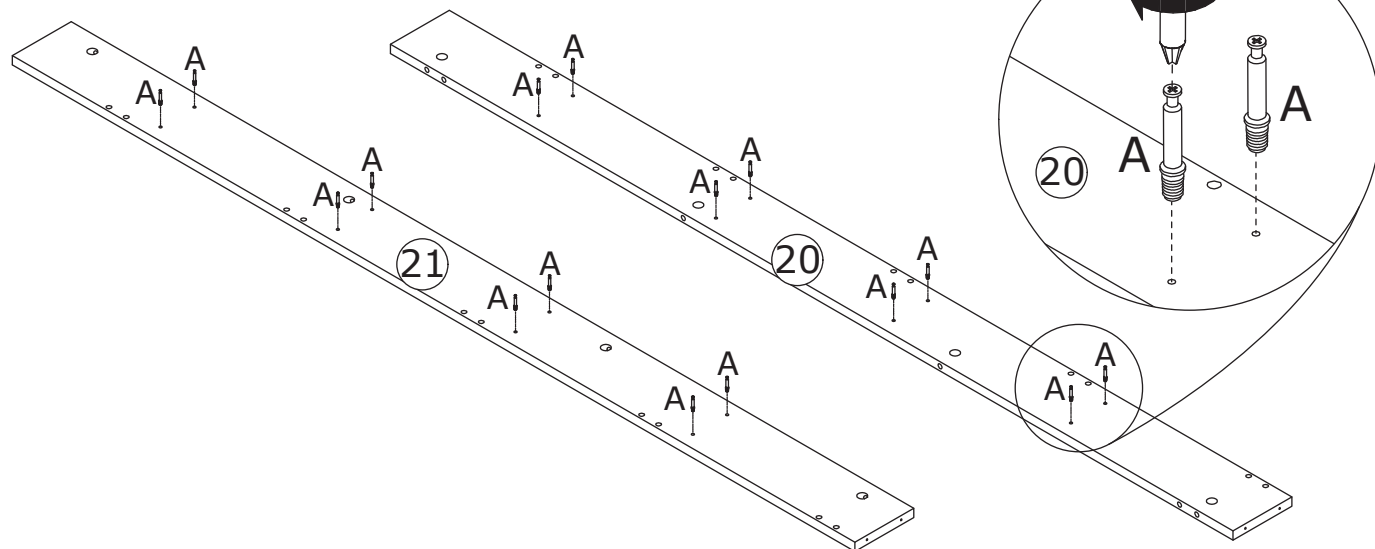
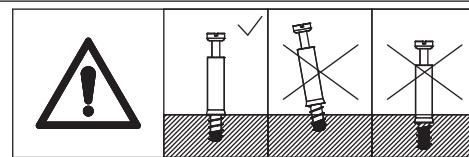

39

B x 16
CRB1595A

C x 20
CRF0830A

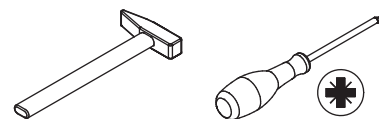

Connect panel 21 and 20 to panel 23 and 24 using wooden dowel(C), add cam lock(B) into and turn clockwise to tighten as shown.

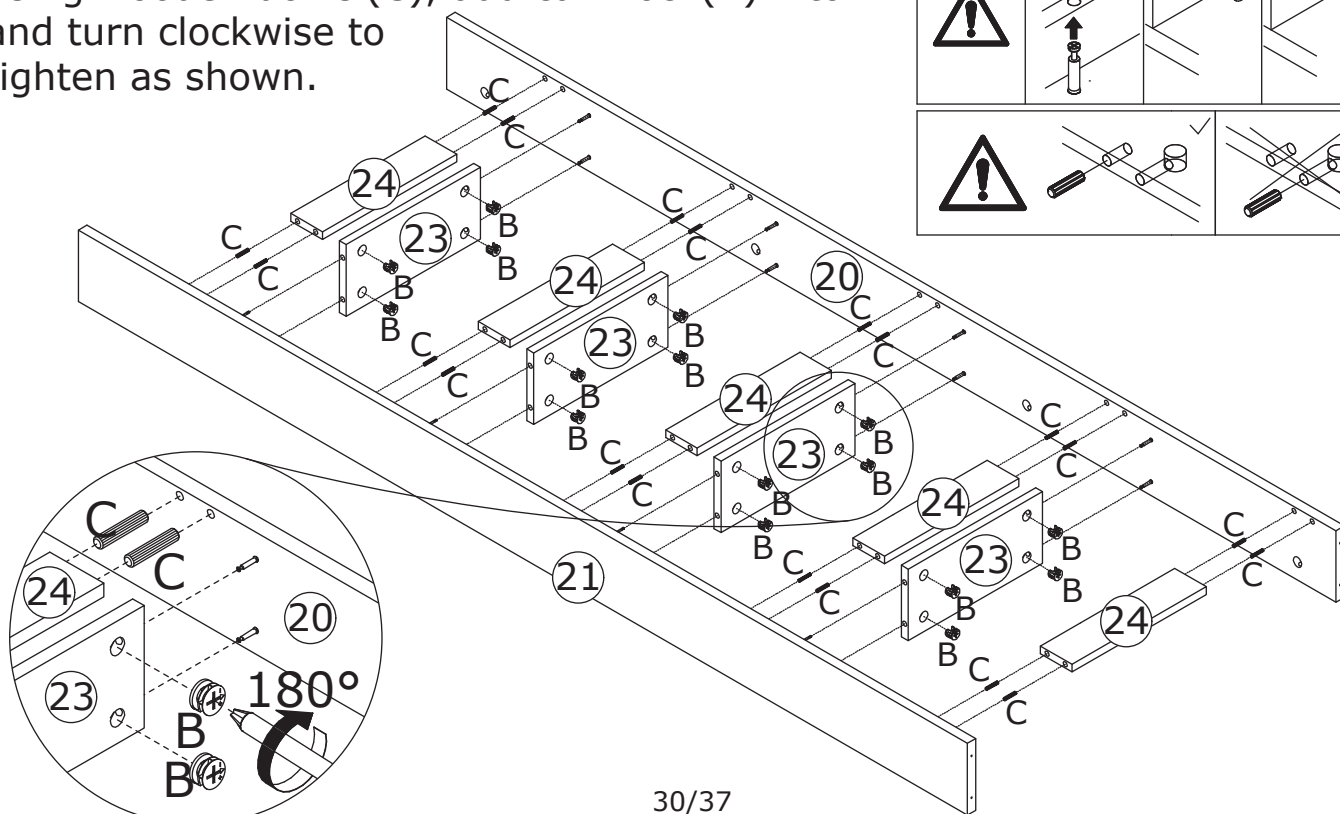
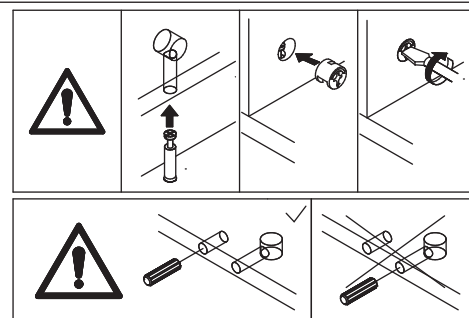

40

E x 8

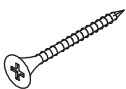

CRD0430A

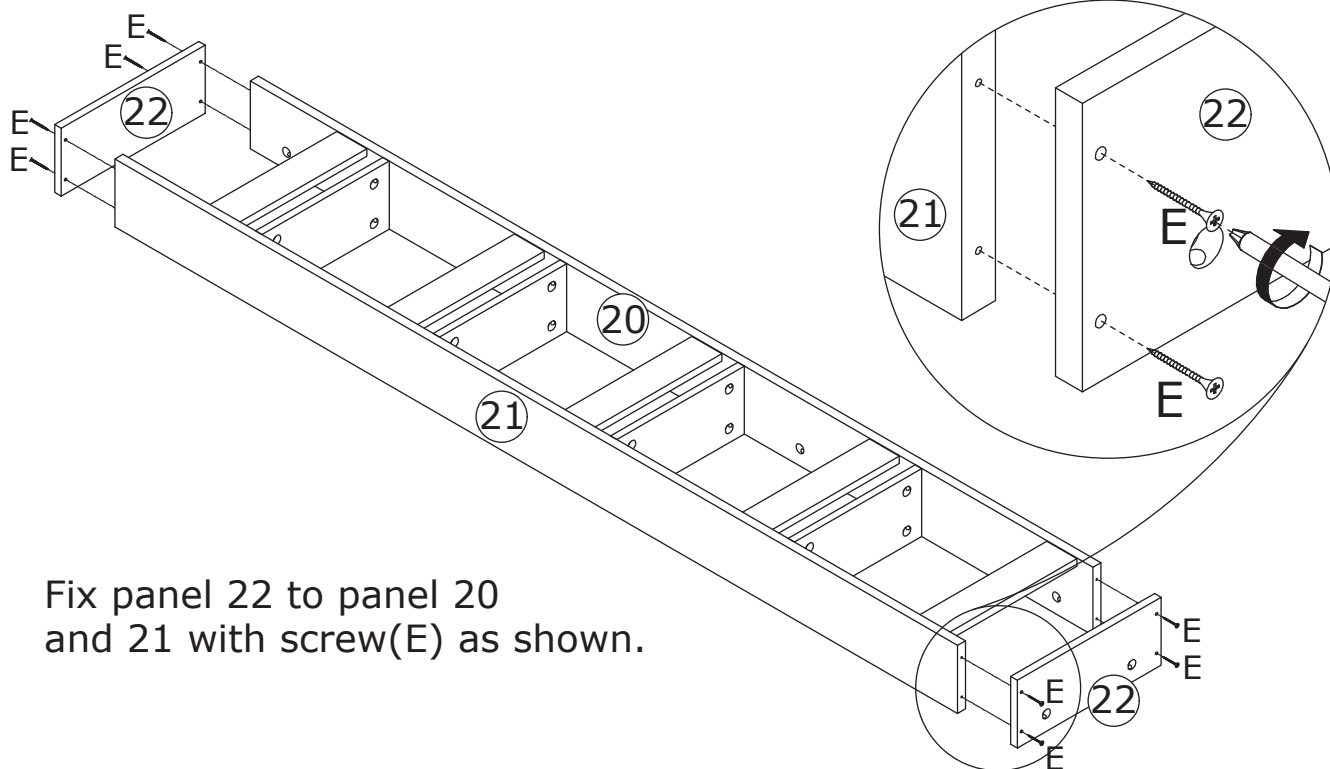
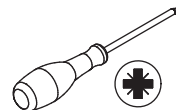

Fix panel 22 to panel 20 and 21 with screw(E) as shown.

41

A x 12

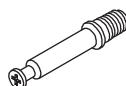

CRA0635A

W x 1

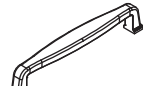

128 mm

X x 2



CRE0418A

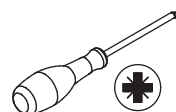

Screw eccentric rod(A)
into panel 19 at first.
Fix handle(W) with screw(X).

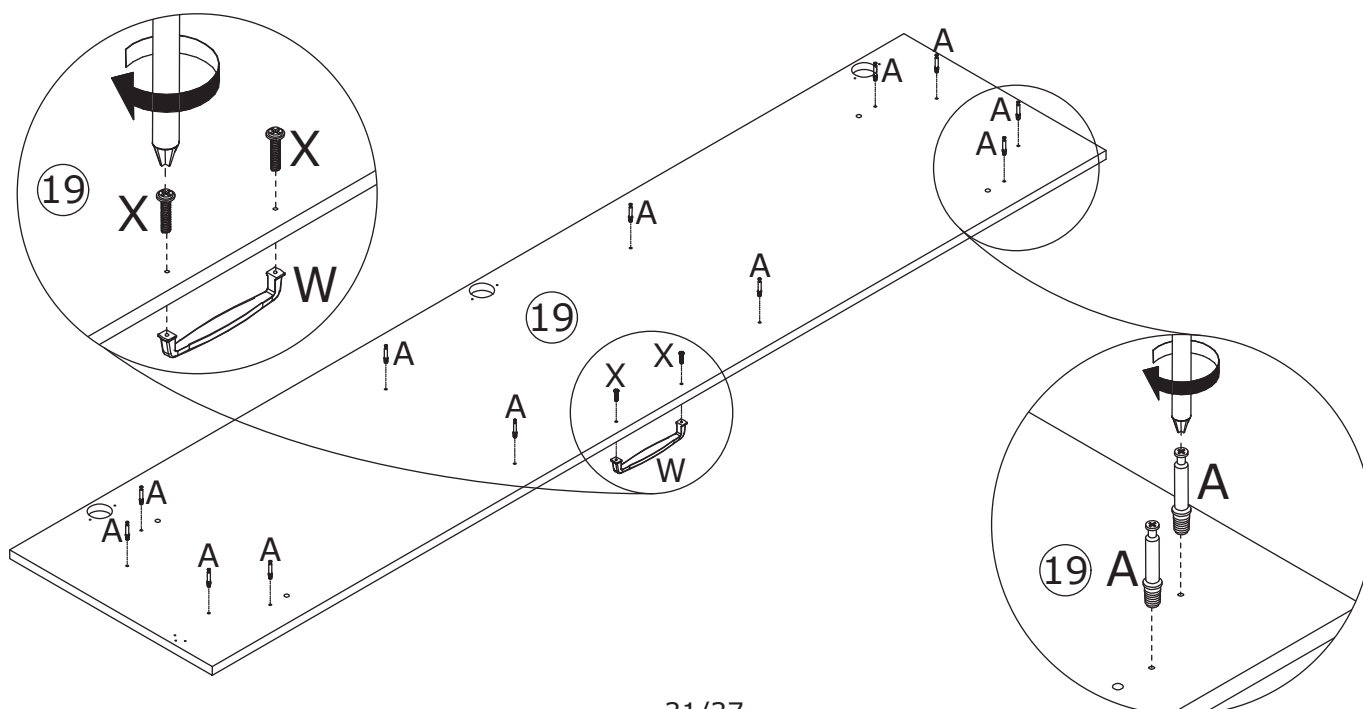
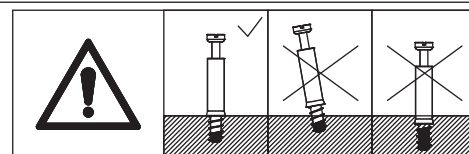

42

B x 12



CRB1595A

C x 4

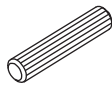

CRF0830A

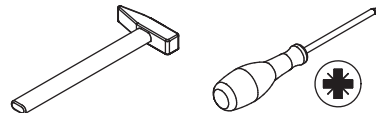

Attach the component to panel 19 using wooden dowel(C), add cam lock(B) into and turn clockwise to tighten as shown.

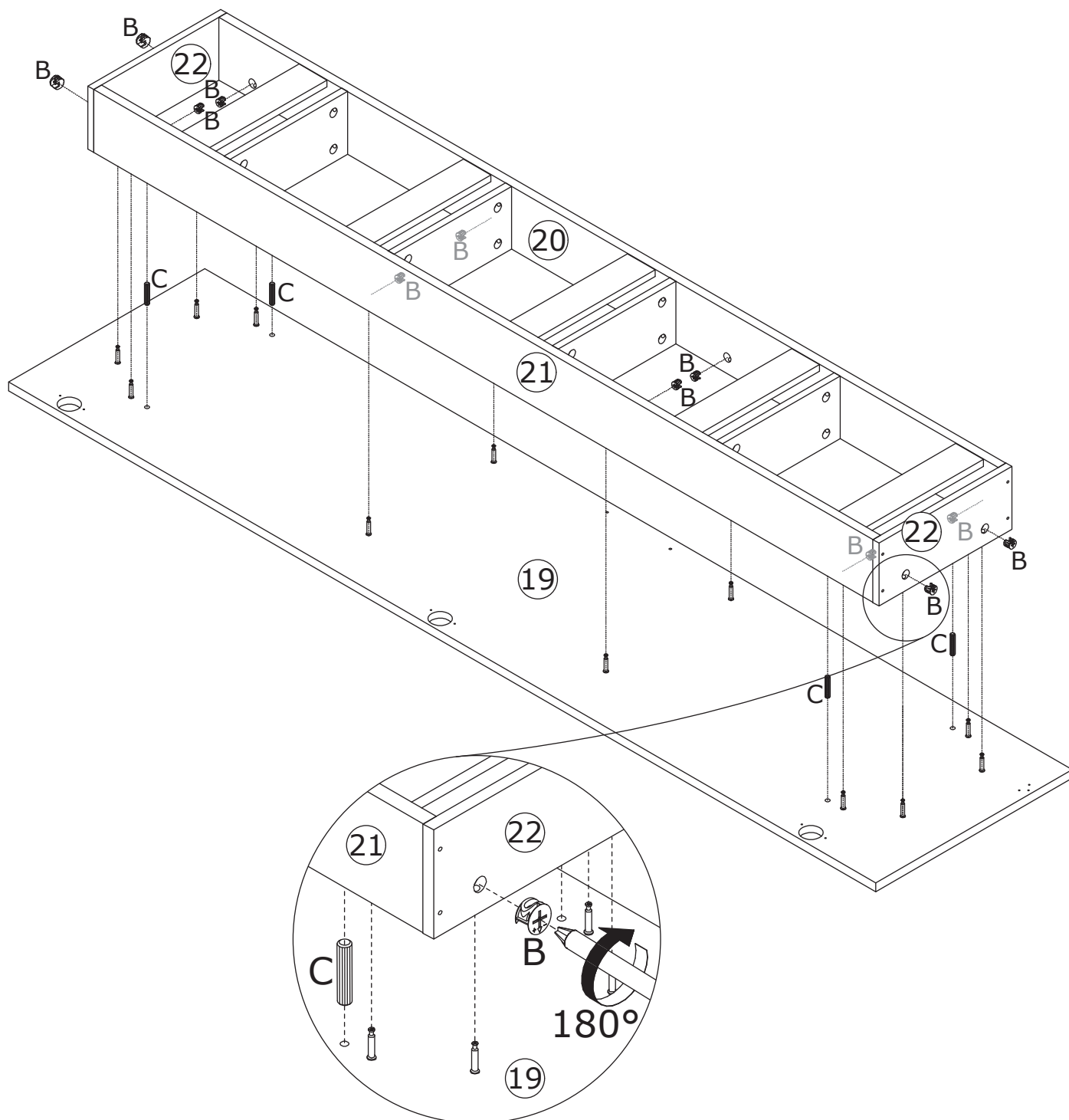
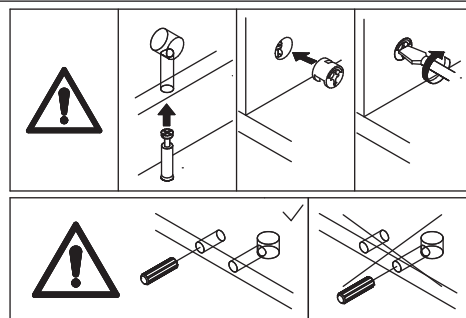

43

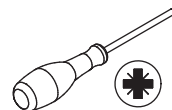

Fix hinge(G) to panel 19 with screw(J) as shown.
Fix wheel(H) with screw(J) as shown.

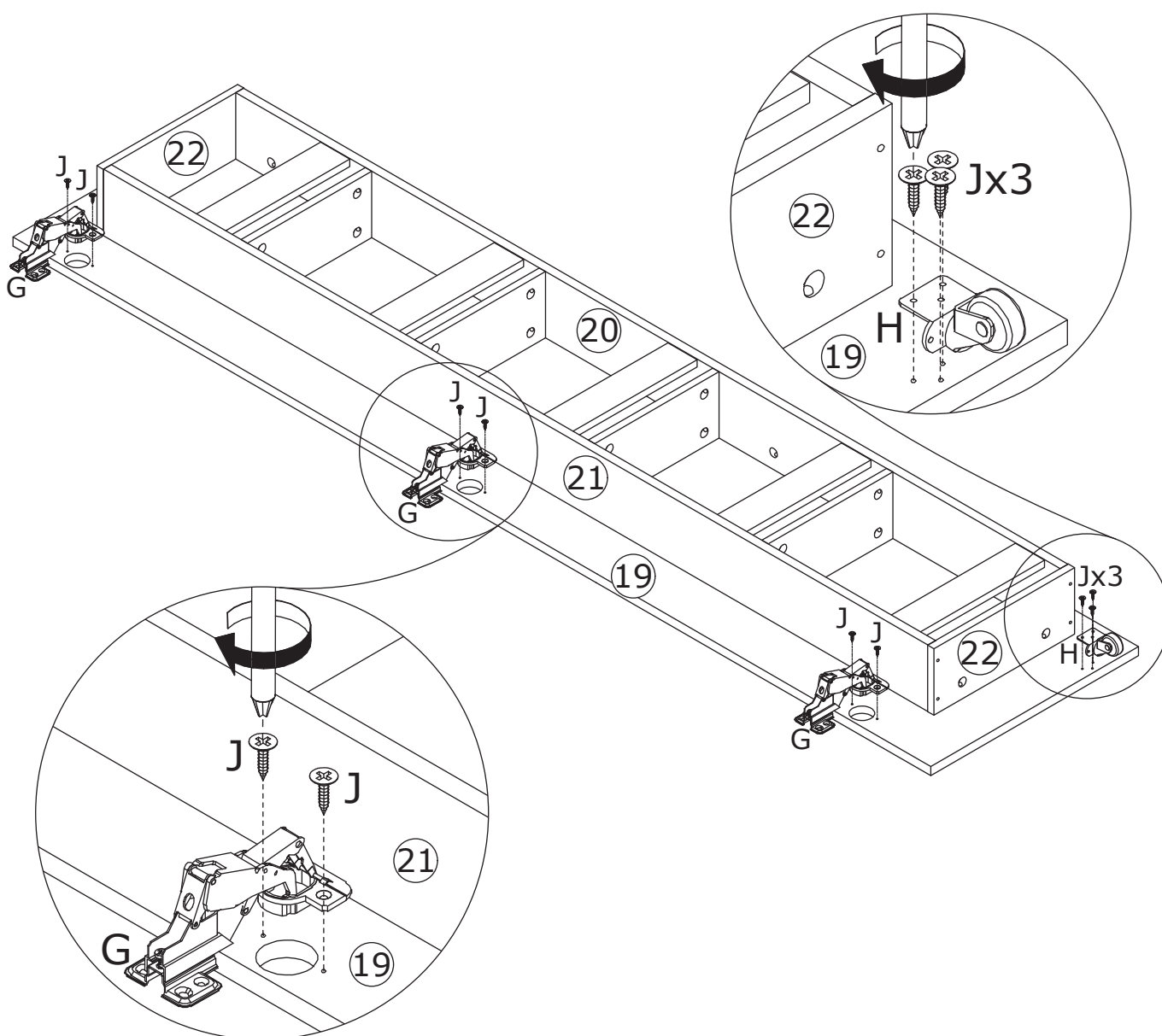

44

J x 12



CRD3514A

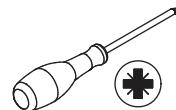

Assemble door 19 to panel 6 by fixing hinge with screw(J) as shown.

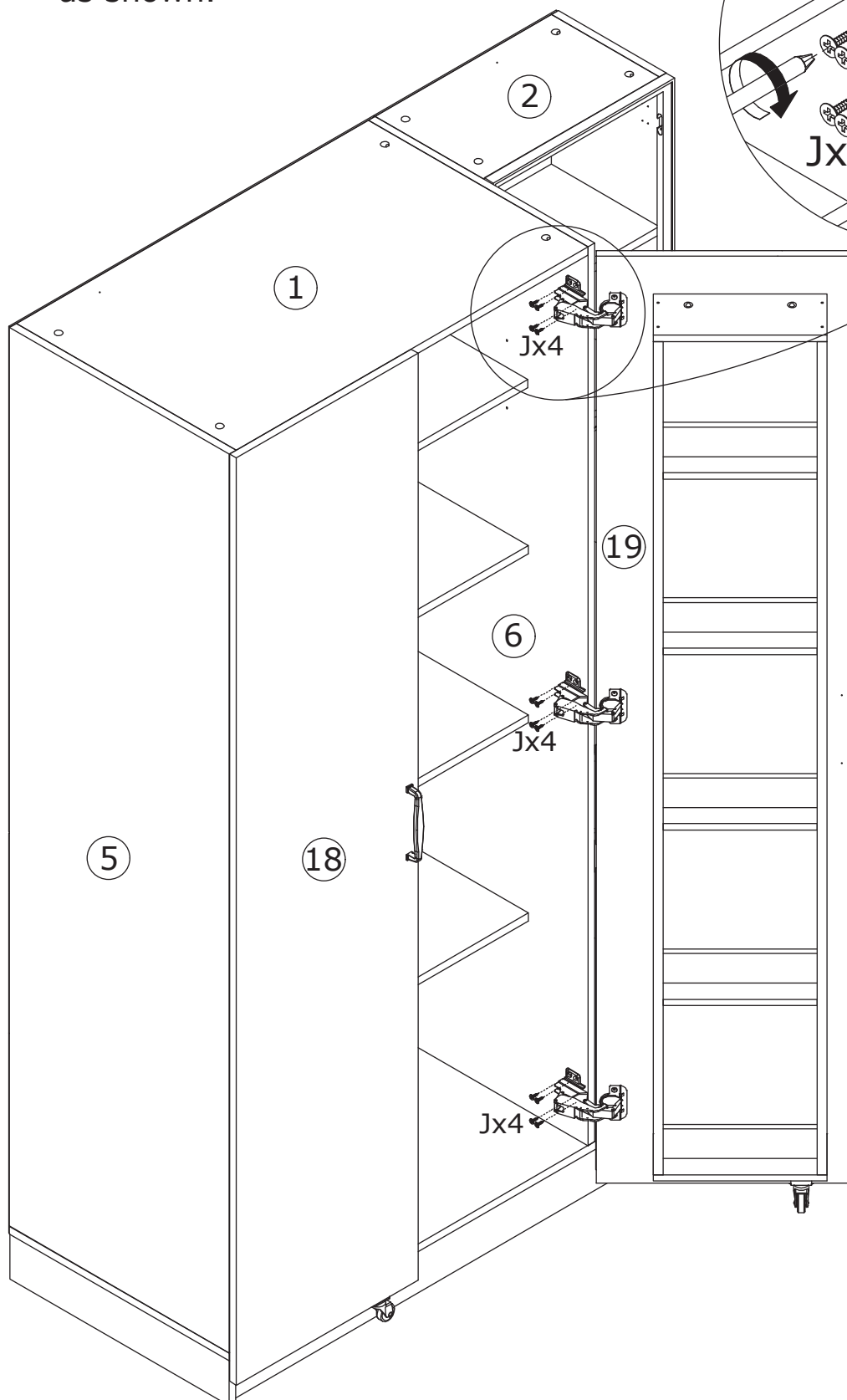

45

M x 1

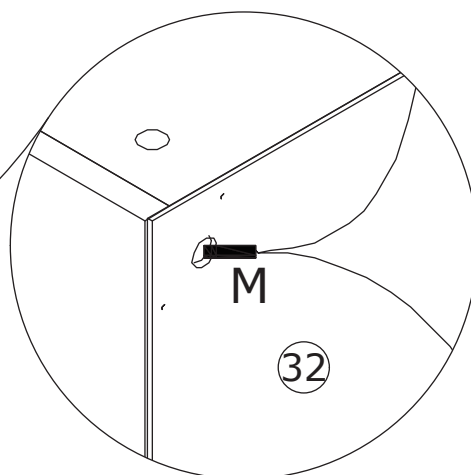
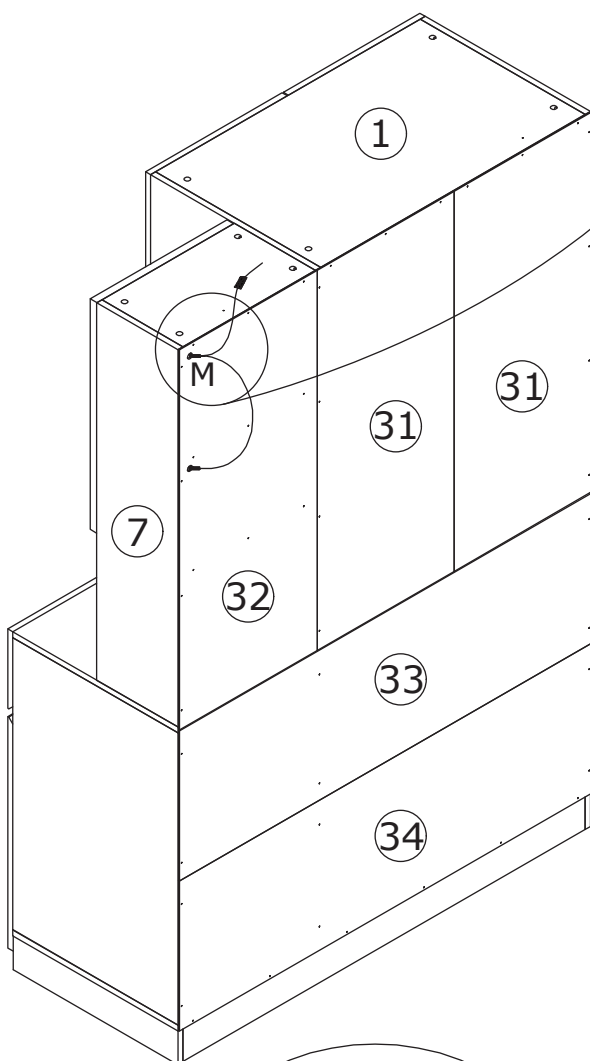
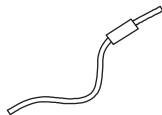

Stick light strip M to panel 2 as shown.

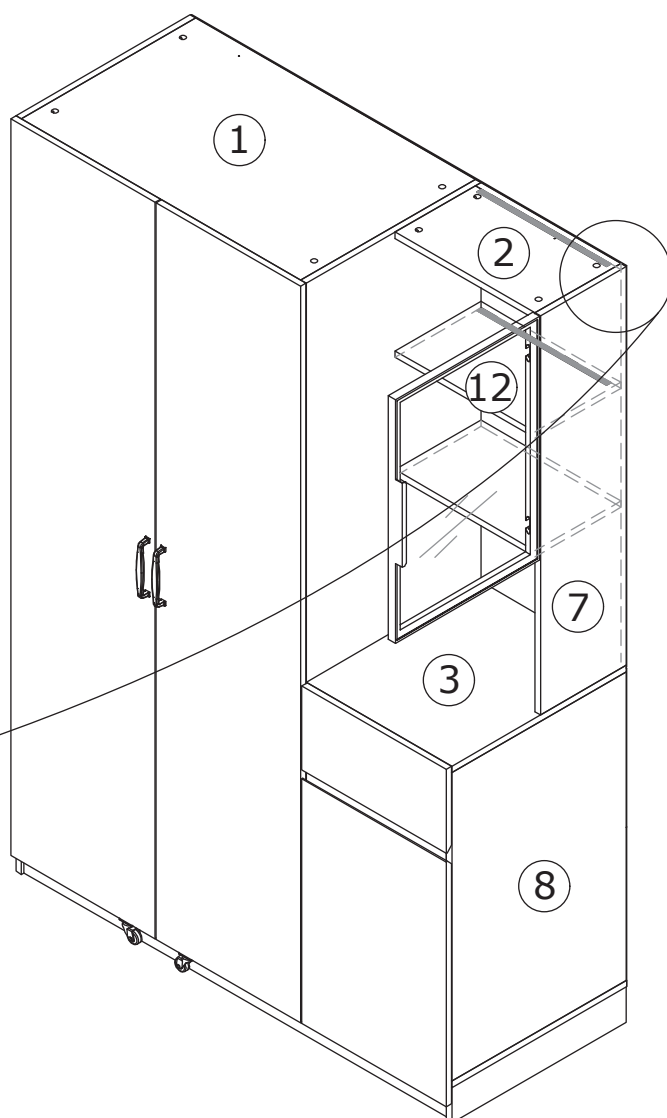
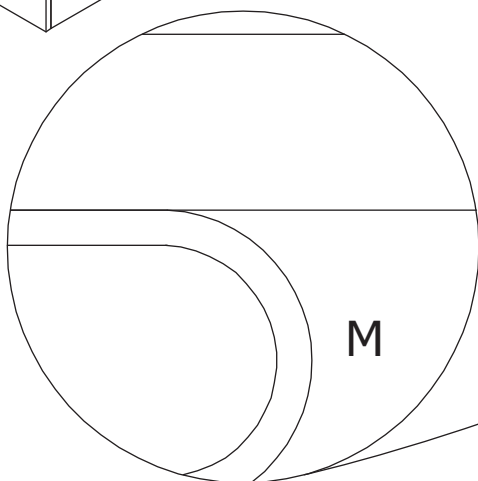

46

T x 2

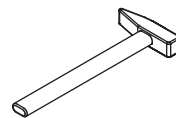
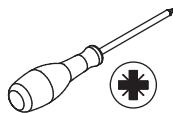
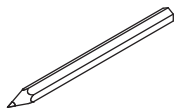
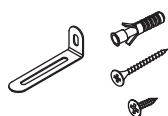

Install anti-tipping device as shown.

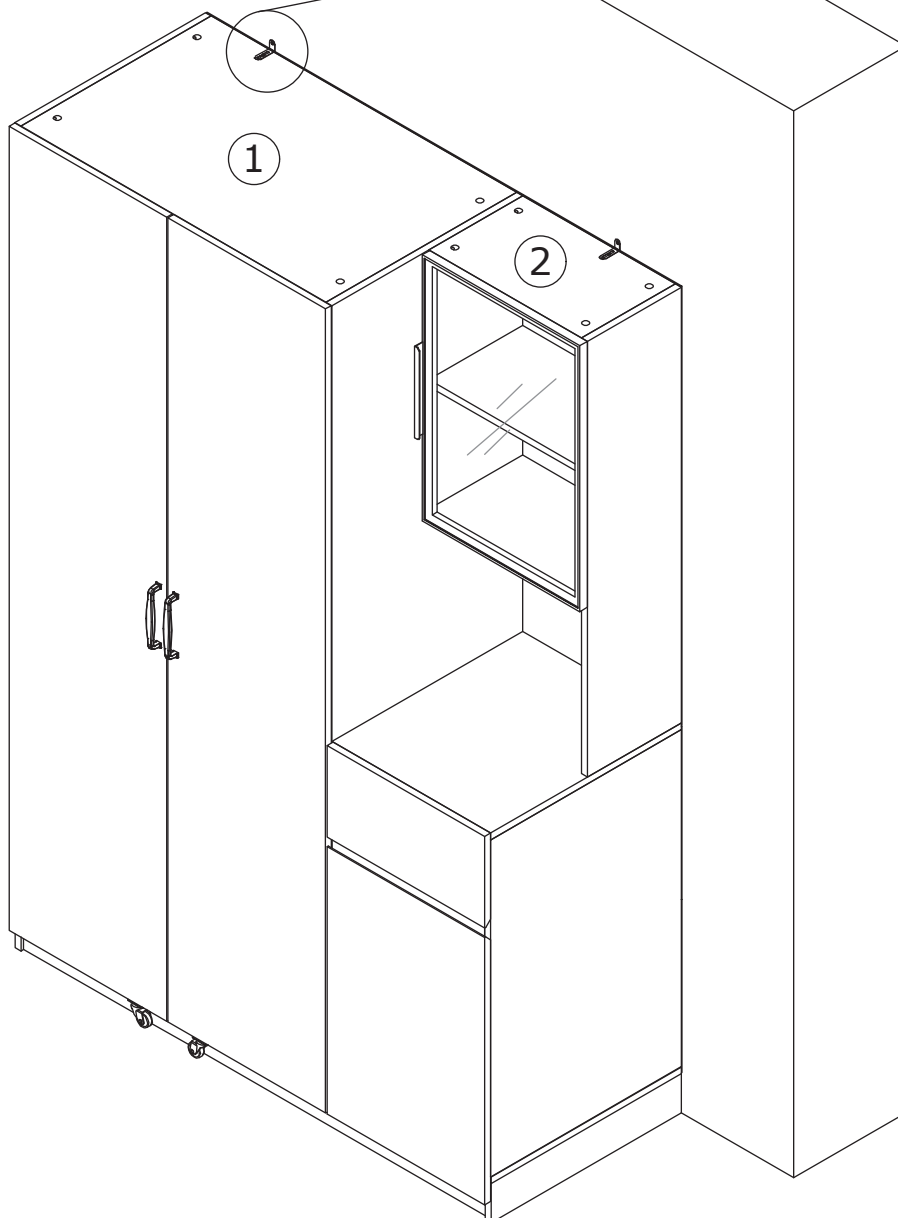
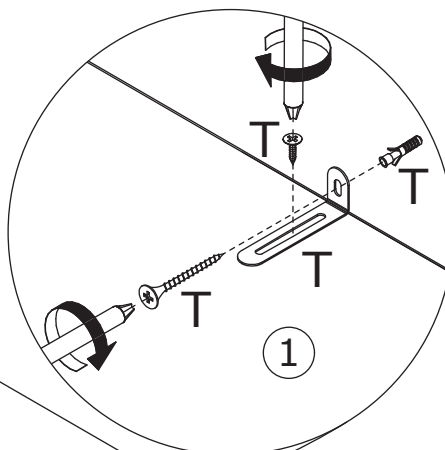

1.

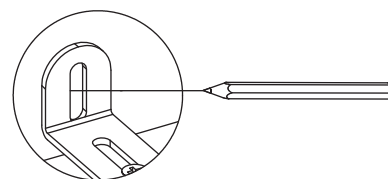

2.

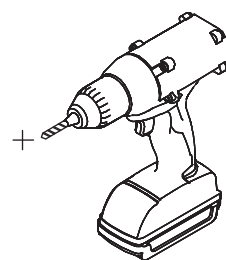

3.

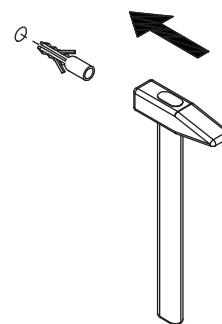

4.

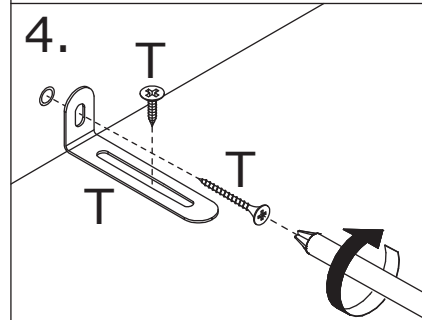

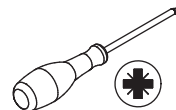

Please review the videos and try to adjust the cabinet doors.

[Hinge adjustment video number 1:, <https://www.youtube.com/watch?v=FKGoPsgsb6M>]

[Hinge adjustment video number 2:, <https://www.youtube.com/watch?v=747vm8CJS3I>]

[Hinge adjustment video number 3:, <https://www.youtube.com/watch?v=X1ImHtTLUoU>]

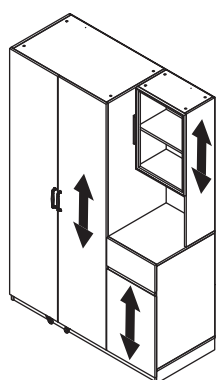
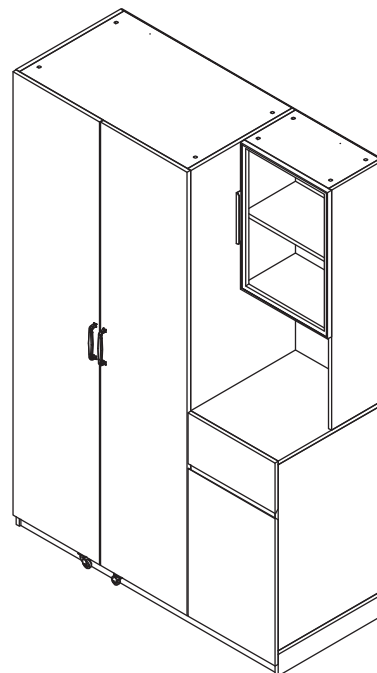

I

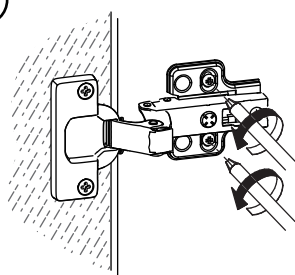

II

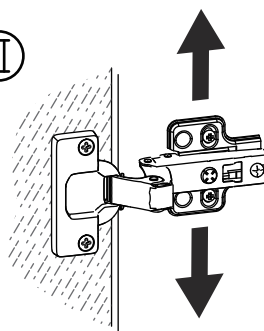

III

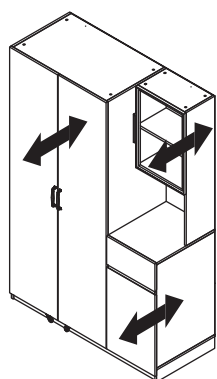
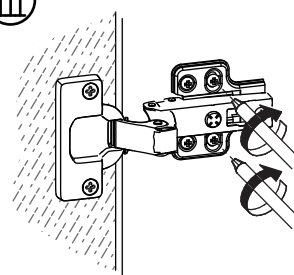

I

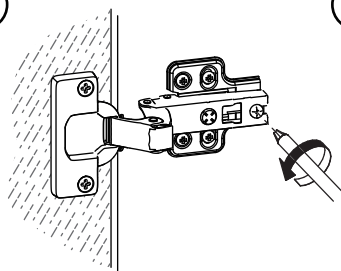

II

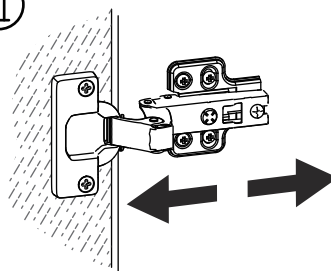

III

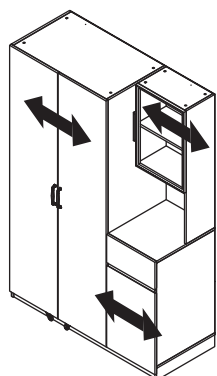
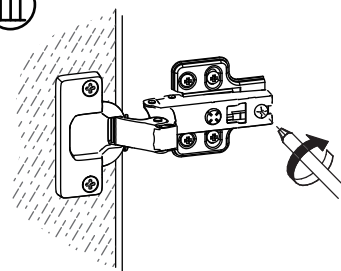

I

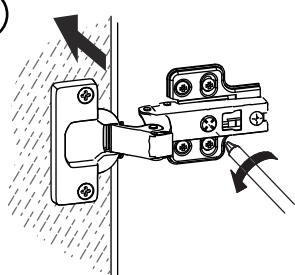

II

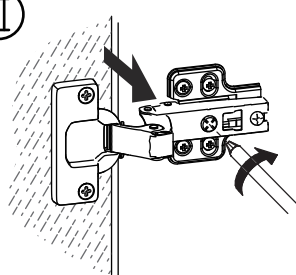

WARRANTY

WARRANTY CLAIMS

- There is a 30-day warranty for broken furniture or any other problems that do not work properly. The warranty will start from the date of purchase which must be verified by proof of purchase.
- Before making a claim, we may be able to answer your query, simply call us. Please leave your purchase order number, along with some details of the problem, if you want a replacement part. We will arrange within 48 hours. If there is out of stock, we will reply with a shipping date.
- The product must be used in accordance with the instructions provided. For health reasons.
- For other reasons, if the furniture needs to be returned, it must be cleaned and dried and operated within 30 days of receipt.

Type of Warranty Claim

- Failure to follow the furniture instructions will invalidate the warranty. Attention please.
- Does not include damage during installation, but includes damage during transportation.

Scope of responsibility

- Shall not bear any responsibility for misuse or user damage and / or loss of parts during the installation of furniture.
- After using, the damage and scratches of the furniture are not covered by the warranty.

The Warranty Relates to All Bought in The Us and Covers The Following Areas

- Sheet parts: 1 month from the date of purchase.
- Electrical parts: 1 month from the date of purchase.

RETURNS

CHANGED YOUR MIND AND NEED TO RETURN YOUR ITEM?

PLEASE FOLLOW THE BELOW INSTRUCTIONS:

- If you have purchased and have simply changed your mind, follow the retailer's instructions for returns.

DEFECTIVE ITEMS

- If your item is defective in any way, i.e. it doesn't work but you can't identify why, in the first instance, please call us.

DAMAGED ITEMS

- If you receive an order with obvious shipping damage from the retailer, then we suggest the delivery is refused. If the delivery has been accepted and then shipping damage is found, please follow the specific instructions advised by the retailer.
In all circumstances please save all packaging material and paperwork for the order. Please be aware that if you dispose of packaging material or attempt to return the merchandise without contacting the fulfiller, you jeopardise your chances of making a claim, and you may not receive a credit for the return.

AFTER-SALES CONTACT



feedbackstation@163.com



(303)800-6387