

# Item No.GR103-1X3

## Installation Guide

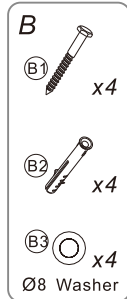

Screw Package  
(2 packs)

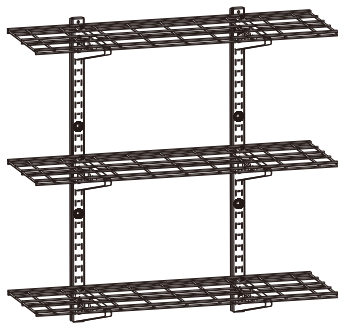

Wall Plate  
(2 pcs)



Shelf Bracket  
(6 pcs)



Wire Grid  
(3 pcs)

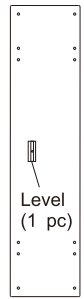

Installation  
Template (1 pc)

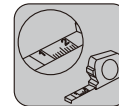
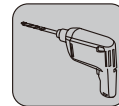
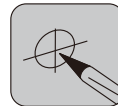

## STEP1-A

### Install Wall Plate into Solid Concrete Wall

Please select the appropriate height according to the actual use.

Solid Concrete Wall

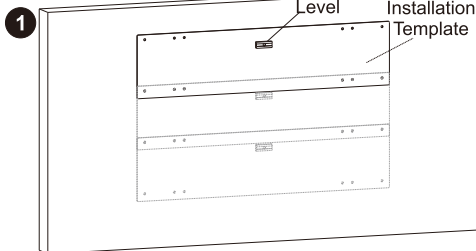

Repeatedly use the installation template for marking holes.

Decide the height and use template and level to mark the hole.

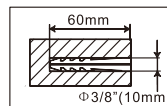
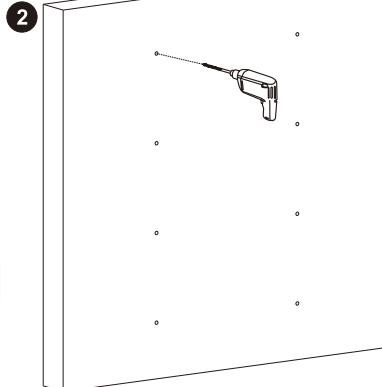

Wall

Wall

**Caution:** Make sure that the wall plates are completely fixed on the wall without gaps to prevent property damage or personal injury.

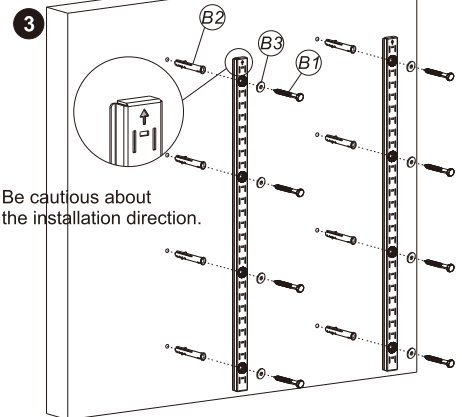

Be cautious about the installation direction.

## STEP1-B

### Install Wall Plate into Wooden Wall

Please select the appropriate height according to the actual use.

Wooden Wall

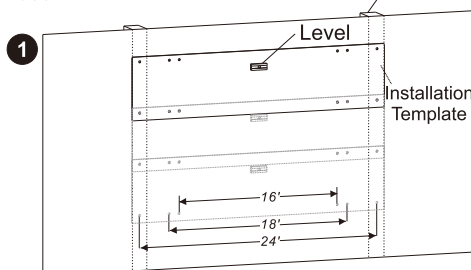

Repeatedly use the installation template for marking holes.

Decide the height and use template and level to mark the hole.

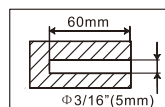
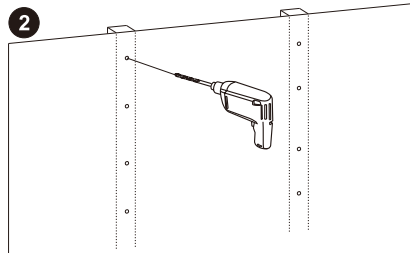

Wall

Wall

**Caution:** Make sure that the shelf brackets are completely fixed on the wall without gaps to prevent property damage or personal injury.

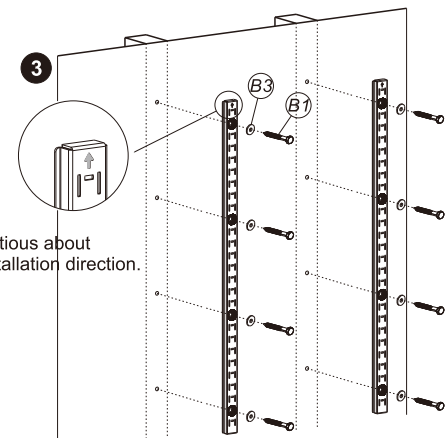

Be cautious about the installation direction.

## STEP 2

### Attach the Shelf Brackets to the Wall Plates

As shown in figure, buckle the shelf brackets to the wall plates.

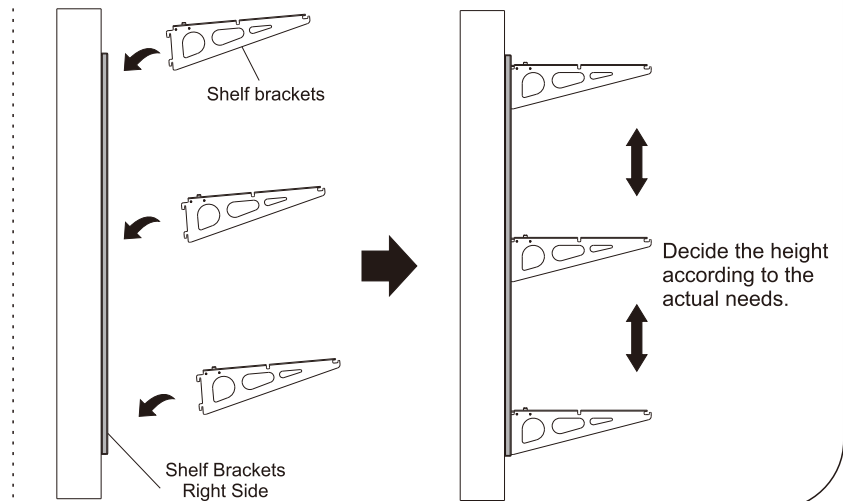
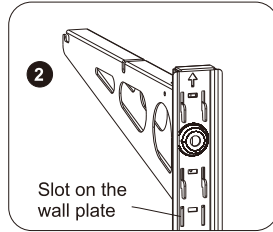
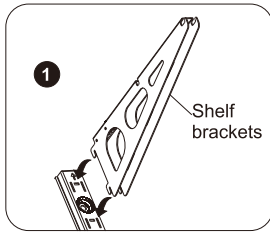

## STEP 3

### Place and Attach Wire Grids

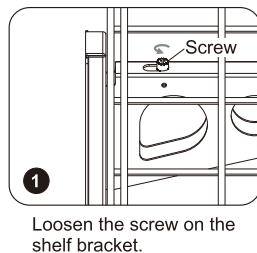
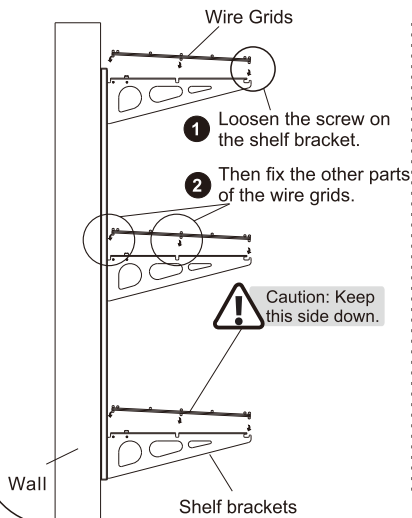

Loosen the screw on the shelf bracket.

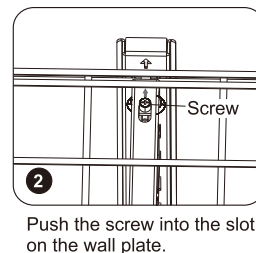

Push the screw into the slot on the wall plate.

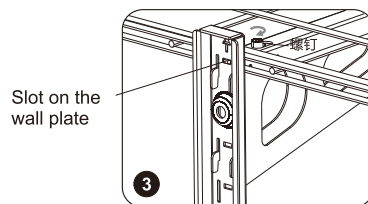

Tighten the screw again to fully fix the shelf bracket onto the wall plate.

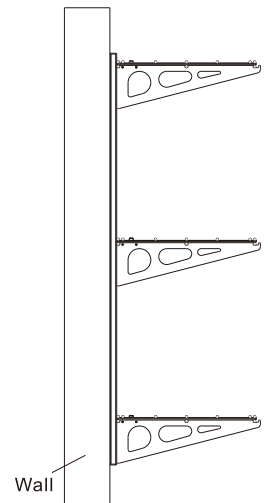

## CAUTION

This product contains small items that could be a choking hazard if swallowed. Keep these items away from young children.

- Make sure these instructions are read and completely understood before attempting installation. If you are unsure of any part of this installation, please contact a professional installer for assistance.
- The wall must be capable of supporting the combined weight of the garage rack and your stuff. Otherwise, the structure and weight capacity of the ceiling must be reinforced.
- Proper tools must be used. A minimum of two people are required for this installation. Failure to install properly can result in property damage or serious injury.
- Check joint parts every two months, making sure the screws have not loosened.
- This product is designed to be installed on a wooden wall or solid concrete ceiling. Before installation, make sure that the weight capacity of the wall will support the combined load of the rack and your stuff. Never exceed the maximum load capacity of the product 99 lbs (45 kg), or else it may result in product damage or physical injury.

Note: This product is intended for indoor use only. Use of this product outdoors could lead to product damage or physical injury.