



## BASE CABINET DIMENSIONS

72" W x 21.5" D x 33.5" H

## FEATURES

- Solid wood frame & plywood panels
- Dovetail drawers and joints
- Soft closing doors & drawers

## HARDWARE FINISHES



Brushed Nickel



Satin Brass



Matte Black



Polished Chrome

## AVAILABLE COLORS



White



Grey

## FRONT VIEW

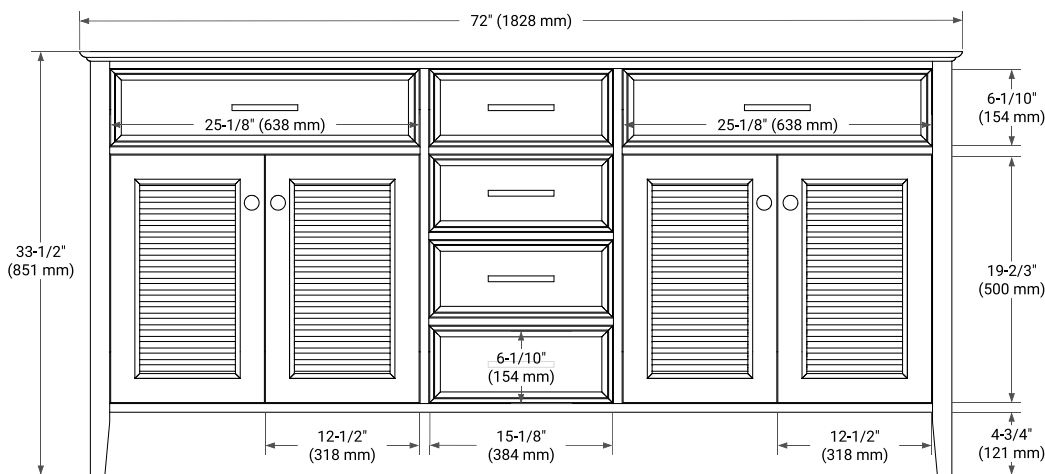

## SIDE VIEW

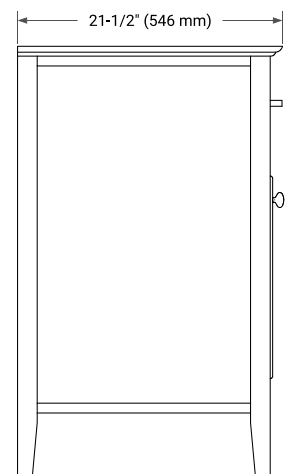

## PLAN VIEW

