

INSTRUCTION

How to Assemble Awning:

- 1. Slide the rear awning rod(11) into the back of the awning cover (12).
- 2. Connect the front awning rod (5) and the other awning rod (4).
- 3. Connect (2)-(3) using C, then insert the awning cover (12) and join the side of the awning mechanism(1).
- 4. Assemble to the awning cover.

INSTRUCTION MANUAL

NO.	PARTS	SIZE	QTY
1			1PC
2			1PC
3			1PC
4			1PC
5			1PC
6			2PCS
7			2PCS
8			2PCS
9			1PC
10			2PCS
11			1PC
12			1PC
A			2PCS
B		M6x20	2PCS
C		ST3x10	8pcs

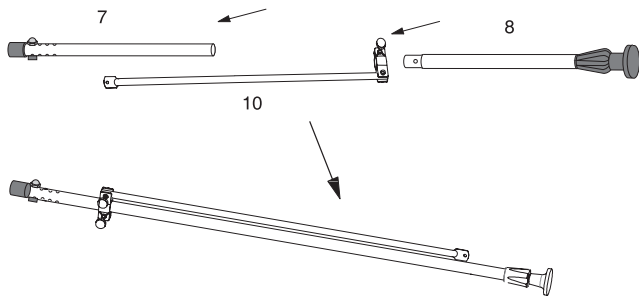

3

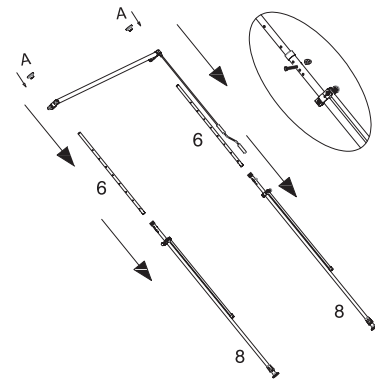

4

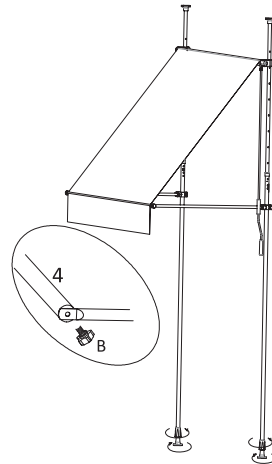
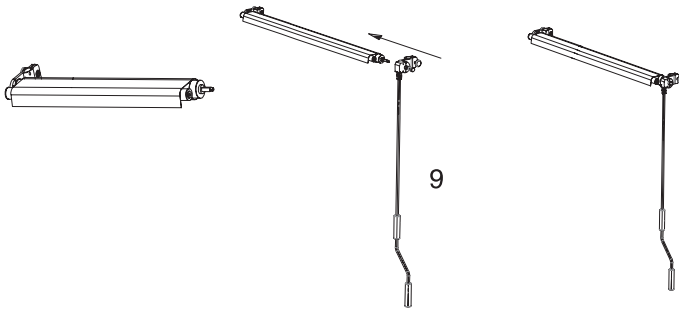

Assemble Mounting Rack :

1. Ensure center rods (7) and adjustment rods(10) are firmly connected and that the adjustment rods can move easily within their sockets.
2. Slide the lower rods (8) into the other end of the center rods (7).
3. Remove the long bolts from the center rods(7) and slide the upper rods (6) to the center rods.
4. Measure the height of the scene. Slide (6) to the correct distance to fit the height of your preferred awning brace, fasten the long bolts. Add pressure feet (A) to the top of each of the upper rods (6).
5. Remove the nut and gasket from tube (1), install the upper gear module(9), and reinstall the gasket and nut to secure.
6. Fit awning into desired space, with pressure feet placed flush with a hard surface on the bottom and the top feet aligned to meet a hard surface above when tightened.
7. Twist bottom feet to tighten and loosen the tension between both ends until the top pressure feet meet the top surface.
8. Both feet should be affixed against the surfaces until the awning is firmly positioned in the desired space.
9. Use short bolts (B) to attach the front of the awning(4)to the adjustment rods(10).