

# Shower Drain

## INSTALLATION GUIDE



Service@Rainlex-store.com  
www.rainlex-store.com

**Rainlex**

Carefully read the following instructions before proceeding with the installation, the warranty will be void if the product is installed with a conspicuous defect.

■ Thoroughly inspect all components before starting the installation. If you find any items be damaged or lacked, please contact us at soonest possible, your questions will be responded within 24 hours.

■ Our stainless steel product does not rust, but external factors such as sealant, adhesive, mortar or any aggressive substance may have “surface” rust on the channel body. After installation, recommend to remove such “rust” using a scour pad, always brushing in the direction of the gain.

■ Our drain and grate can be cleaned and maintained using a non-abrasive stainless steel cleaner or soft scrub. For Polished Stainless, we recommend a mid soap and a soft cloth for cleaning. All cleaning agents must be free of hydrochloric and hydrofluoric acid.

### Components list of metal cover style:

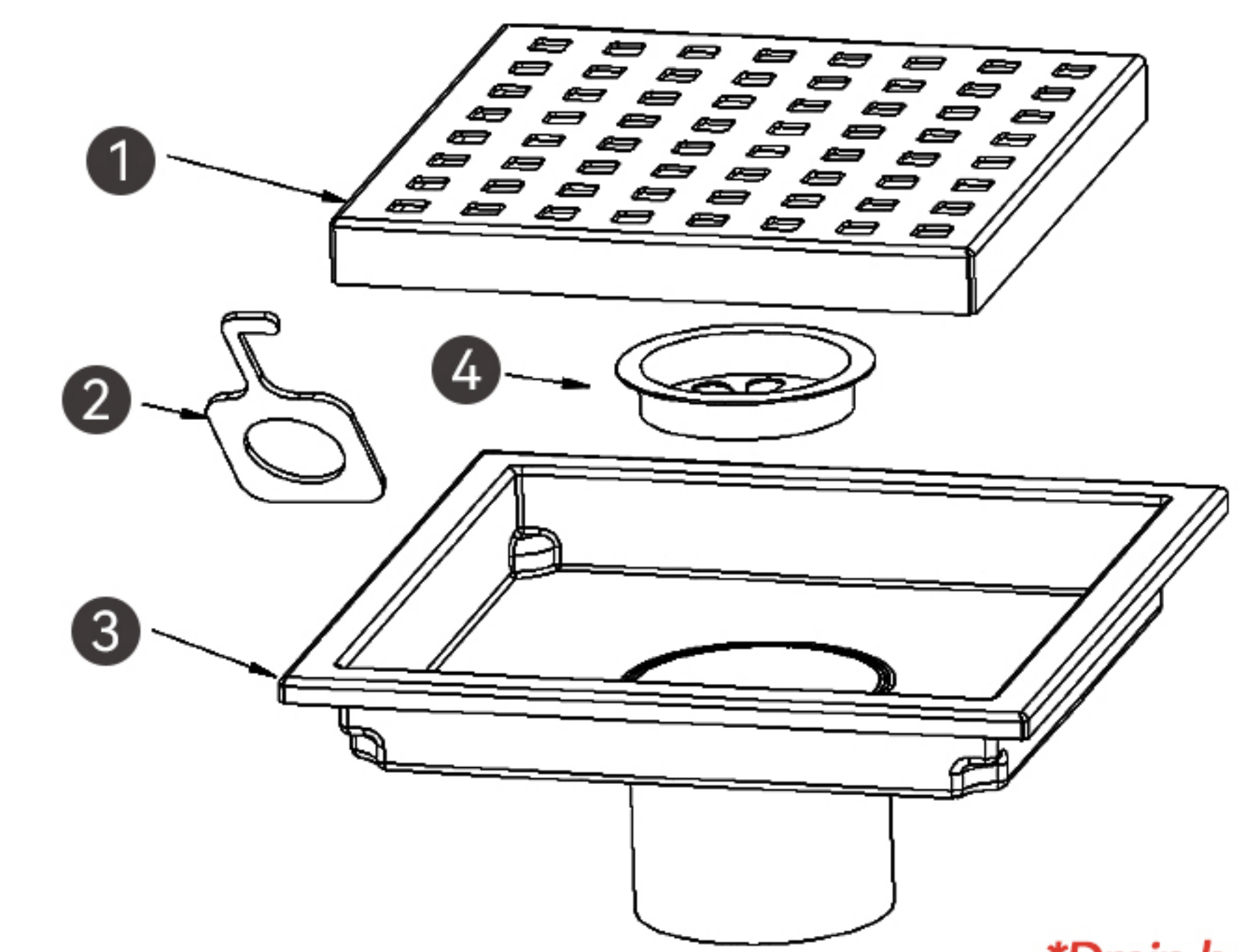

- 1 Drain Cover
- 2 Lifting Hook
- 3 Linear Shower Drain Body
- 4 Hair Strainer

*\*Drain base is not included*



### Components list of tile-in style:

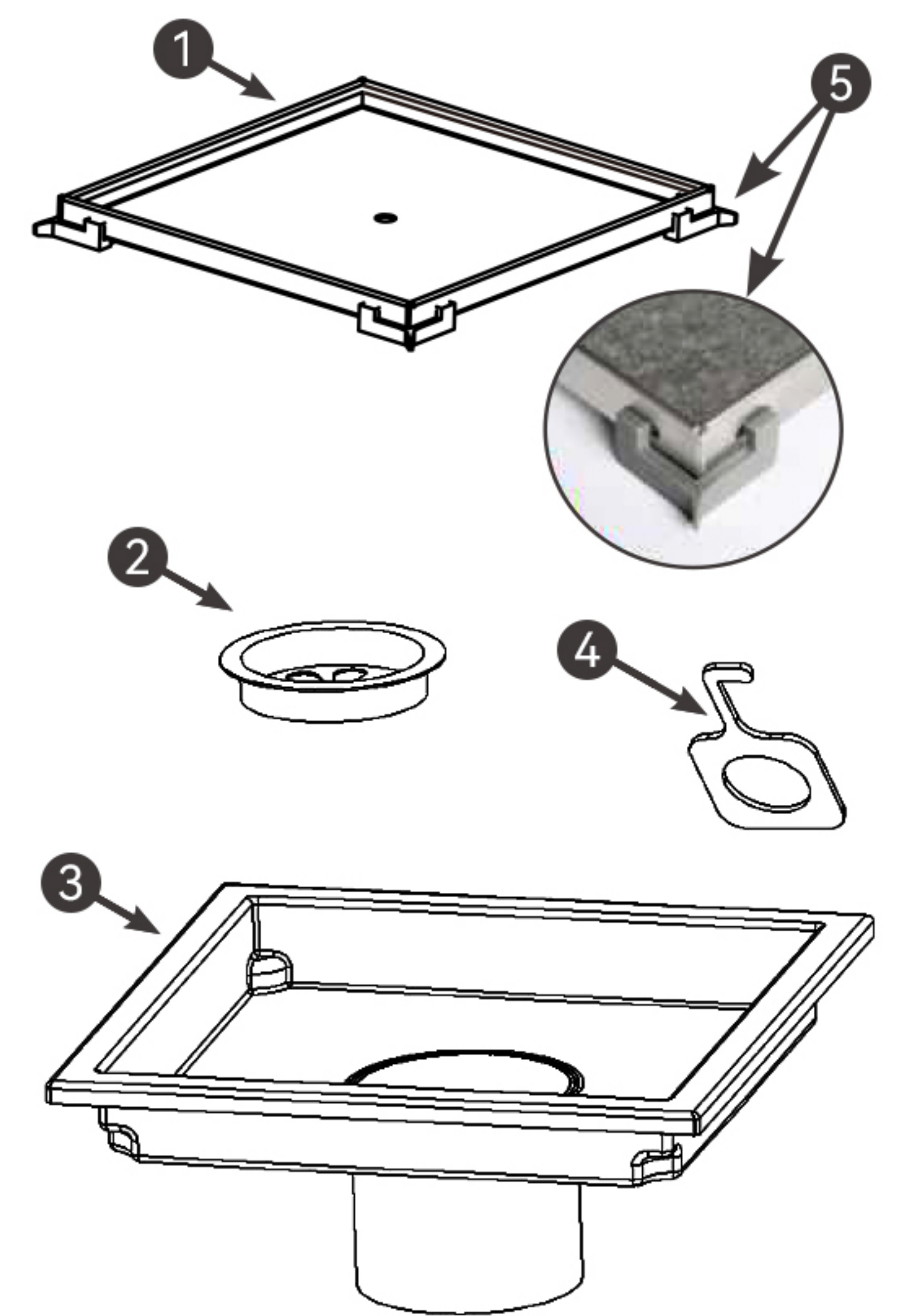

*\*Drain base is not included*



- 1 Tile-insert tray
- 2 Hair Strainer
- 3 Drain Body
- 4 Stainer Hook
- 5 Tray supporter

### Placement in Bath Room:

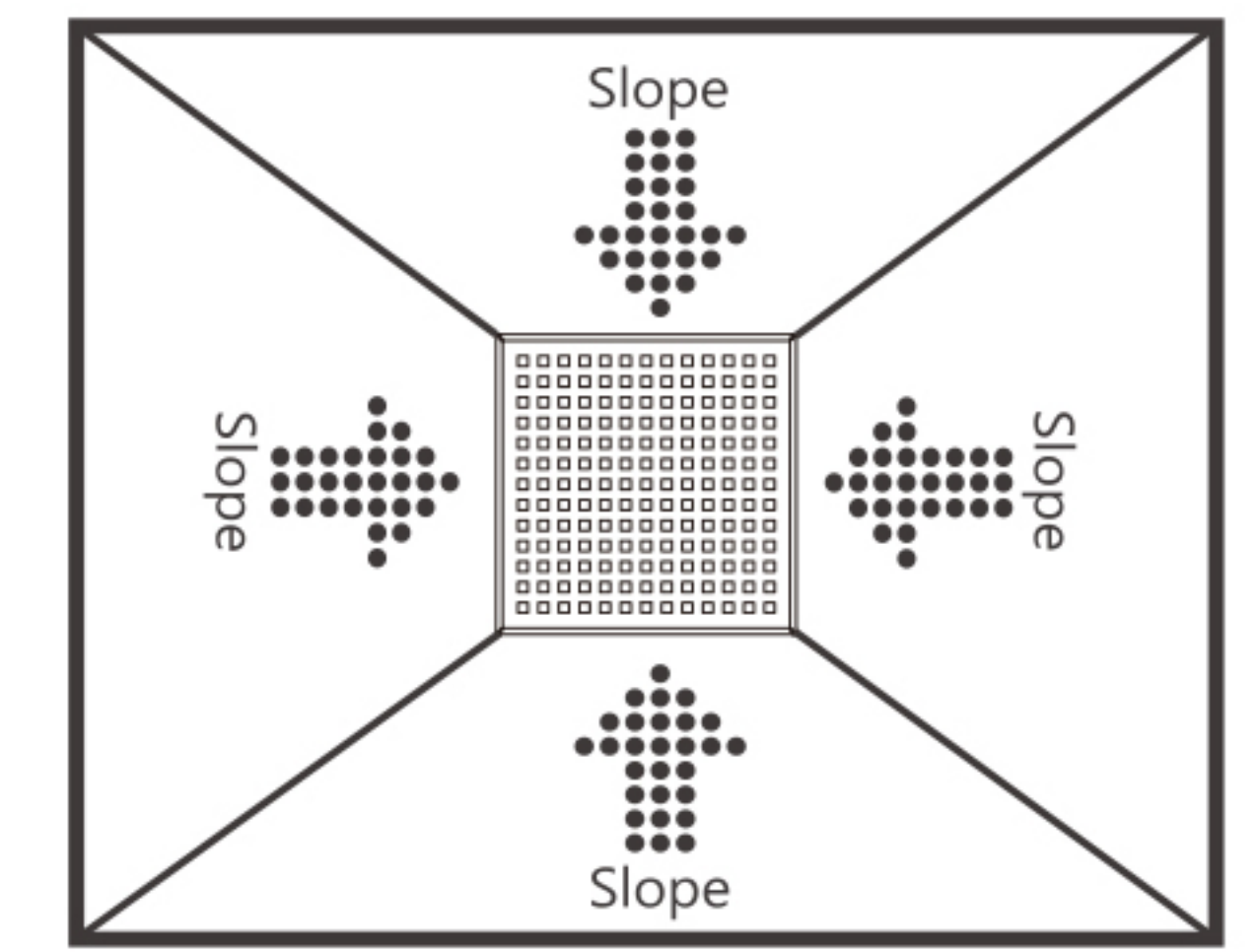

Using a single square drain in the shower area, floors must be graded appropriately or other barriers must be used to prevent flow of water into bathroom area.

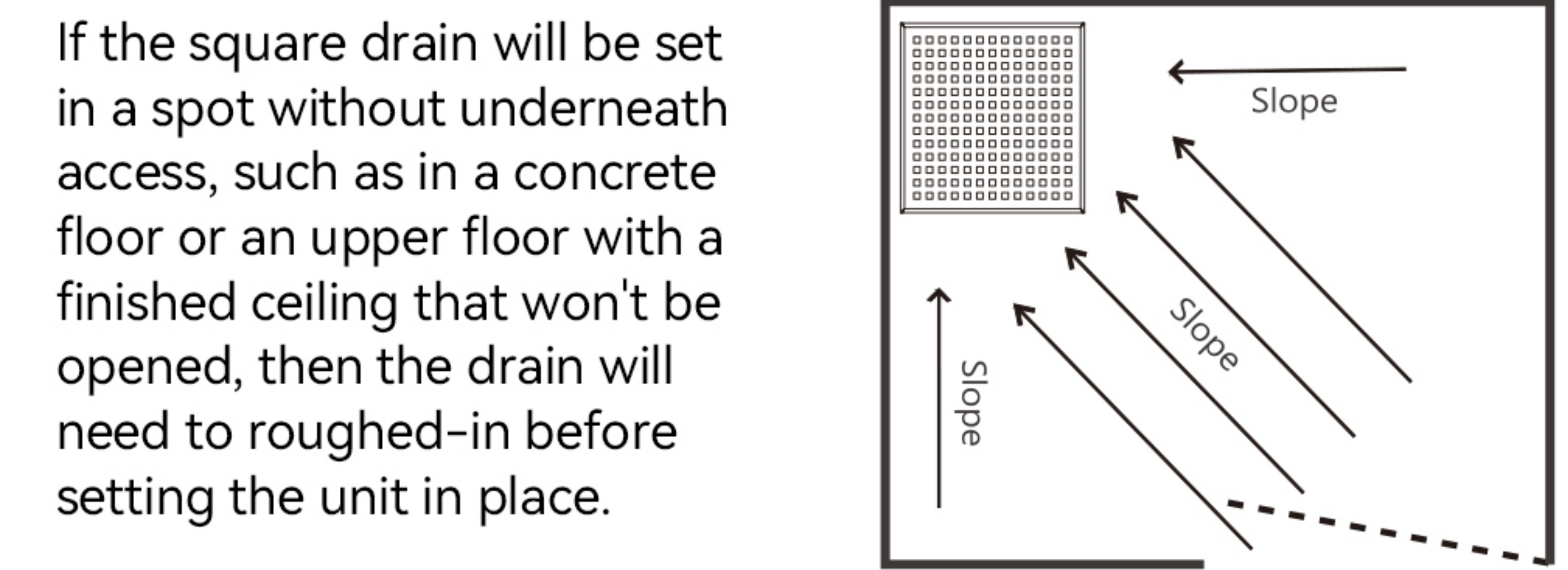

If the square drain will be set in a spot without underneath access, such as in a concrete floor or an upper floor with a finished ceiling that won't be opened, then the drain will need to roughed-in before setting the unit in place.



The following installation steps are applicable for concrete substrate only.



Disassemble the drain coupling,install the base to the waste pipe and secure it in place. If use PVC pipe,glue with PVC cement.If use No-Hub rubber coupling, fasten with screw driver.

Always consult with a licenced professional during installation.

Stuff a rag into the drain opening. Apply floor mortar to build up the shower pan liner, the surface should be slope of 1°,approx 1/4" per foot toward the drain. Allow the mortar to cure 12 hours.

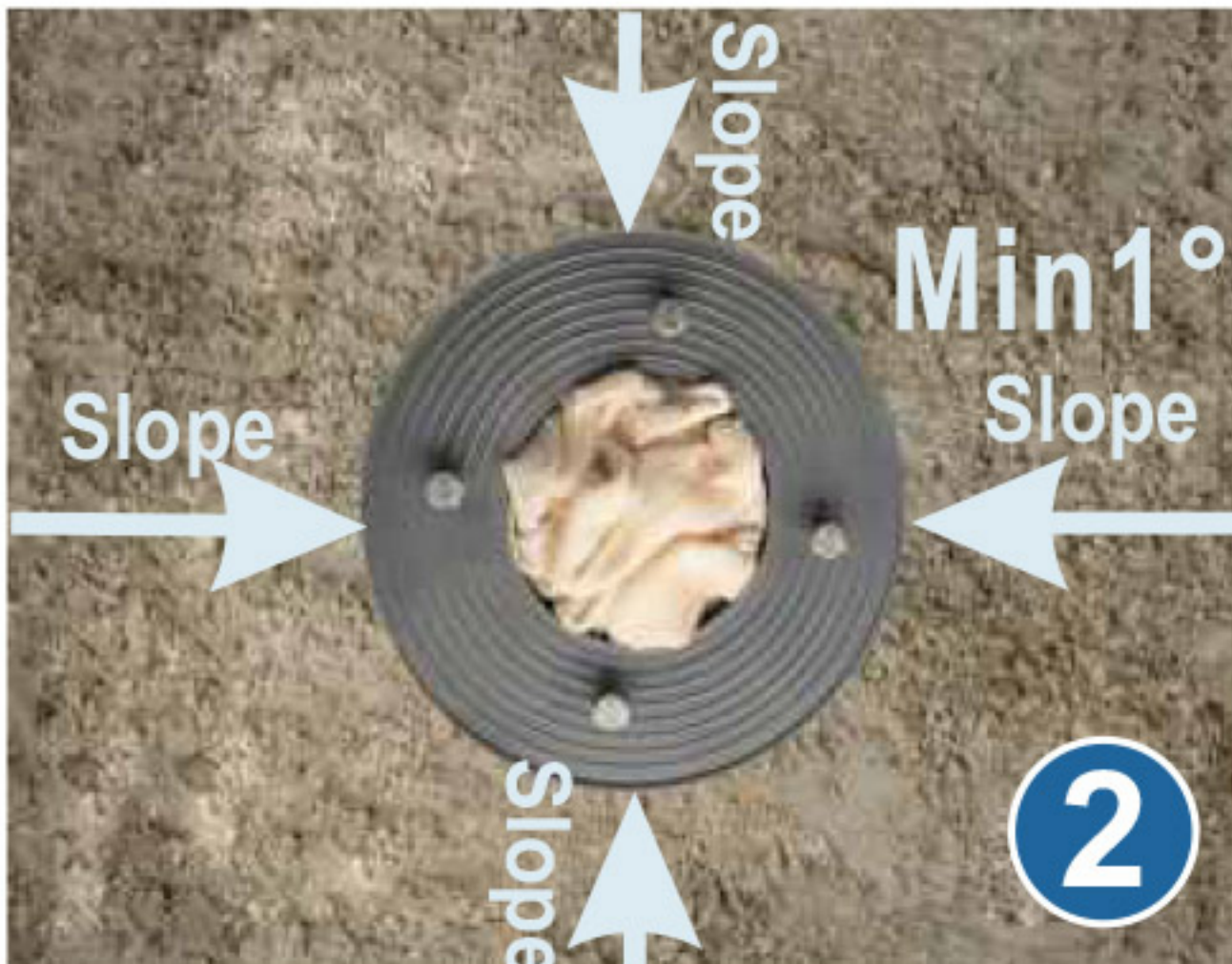

INSTALLATION GUIDE



Press the waterproof membrane down around the bolts,use utility knife to cut a slit for the bolts to poke through, afterwards cut away the waste hole in the center.

Always consult with a licenced professional during installation.

Partially loose the drain bolts, install the coupling plate, tightening them evenly and firmly to creat watertight seal once the membrane installed.



INSTALLATION GUIDE



Insert drain body into waste hole,adjust the height to be compatible with planned floor, make sure the height from the top edge to the coupling plate not less than 1-1/2".

Always consult with a licenced professional during installation.

Apply floor mortar to build up the second mortar bed, the surface most have minimum drainage slope of 1°, approximately 1/4" per foot toward the drain. Leaving space of tile thickness and thinset along the seam.



INSTALLATION GUIDE



After the second mortar bed cured for 12 hours,install the floor tile with thinset or tile adhesive.

Always consult with a licenced professional during installation.

Fill the gap around the drain body with silicone bead or grout.Take away the dustcloth,finalize the installation by laying the strainer and grating.

Note:Wait for 24 hours before using your shower.

24 hours



INSTALLATION DIAGRAM

Standard Clamp Drain

Note1 Building paper should be stapled to the plywood floor before being covered with a galvanized metal mesh.

Note2 Tile and adhesive should be no less than 1-1/2" (40mm)

Note3 PVC drain base and waterproof membrane should be purchased separately.

Typical Installation 2 layers of sloped mortar bed

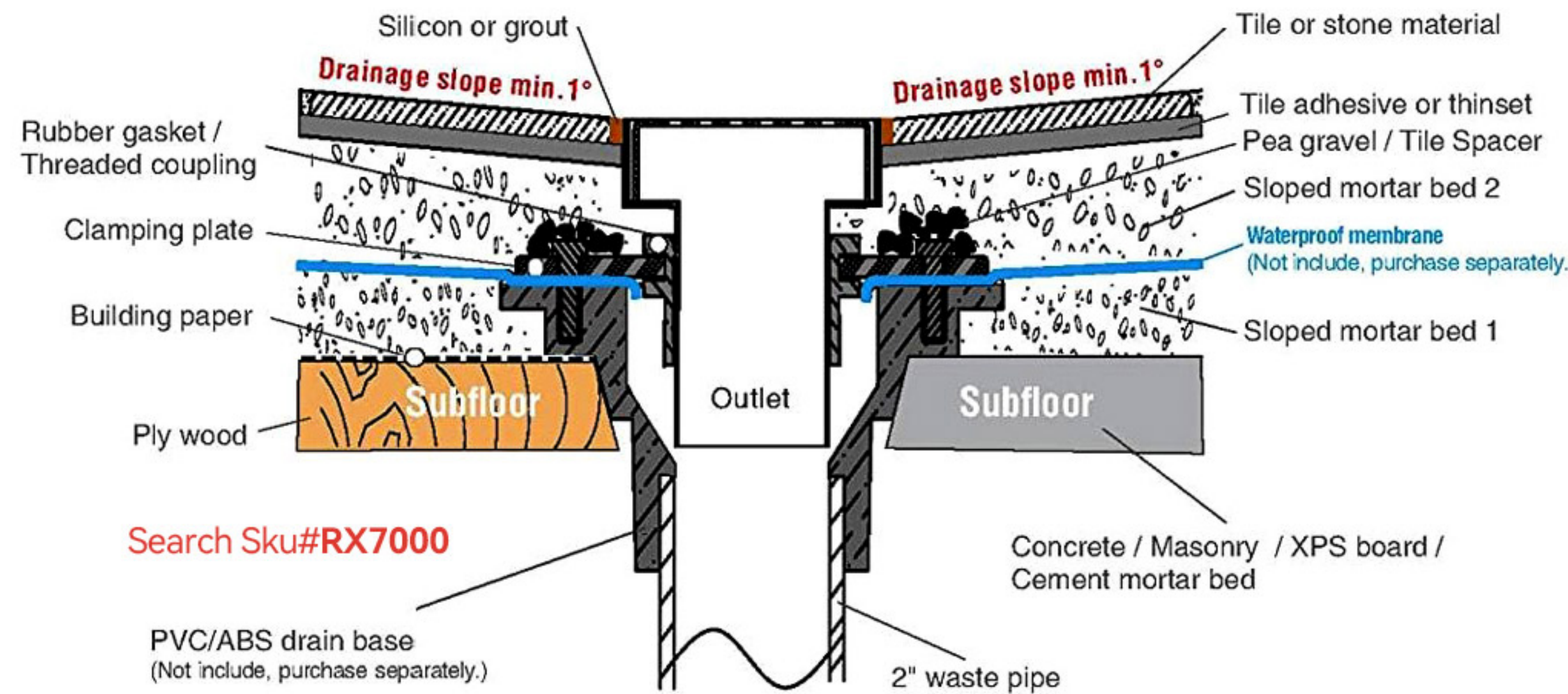

Please take into account the size of drain base when you install shower drain against the wall.