

Installation instructions
Refrigerator water filter

A replacement for the following water filters:

Whirlpool®/EveryDrop®/ Maytag®/Amana®/KitchenAid® filters
UKF8001, Filter 4, EDR4RXD1, EDR4XD1B, EDR4RXD2, 4396395, UKF8001-750, UKF8001AXX,
UKF8001AXX-200, UKF8001AXX-750, UKF8001AXXP, UKF8001AXXT, UKF8001P, UKF8001T, UKF9001,
67002269, 67002671, 67003523, 67003591, 67003640, 67003727, 67006464, 67006467, 67006469,
67006470, 67006474, 67006475, 67006476, 67006477, 67006633, 67006634, 67006637, WF50, OWF50,
WF51, OWF51, OWF50-NI300, WF50-KNI300, WF50-NI500, OWF50-WI500
Kenmore® filters
46-9005, 469005, 9005, 9005P, 46-9006, 469006, 9006, 9006P, 46-9992, 469992, 9992, 9992P, 469005750,
469005-750, 46-9005-750, 469006750, 469006-750, 46-9006-750, 04609005000, 04609006000
Puriclean II® filters
67003526, 67003527, 67003528



Tested and Certified by NSF International against NSF/ANSI Standard 42 in model EFF-6007S for the reduction of the claims specified on the Performance Data Sheet, and to NSF/ANSI 372 (≤0.25% lead).

Installation instructions

- Before installation:
• Shut off the cold-water supply to the refrigerator before installation. Turn on the refrigerator water dispenser to release water pressure, letting water drain from the pipe completely.
• It is normal for black carbon fines (particles) to appear on the outside of your filter. This happens when the filter is jarred in shipping. It is safe to simply wipe it off.
• The filter connectors are larger to prevent leaks. You might have to twist the filter hard to make sure the connection is secure.
- 1. Locate the filter cartridge holder in the back upper right hand corner of the refrigerator. To open the cartridge cover, push in where indicated and the cover will drop down.
2. Remove old filter by slowly rotating it to the left. A small amount of water may drip down.

6007S | V040

- 3. Position the cartridge inside the cartridge holder and slowly rotate the cartridge to the right until it stops. When the cartridge is properly installed, you will feel it “click” as it locks into place. Do not over tighten.
4. Close the cartridge cover.
5. Run water from the dispenser for 5 minutes at 0.5 gpm (about 2.5 gallons) to clear the system and prevent sputtering.

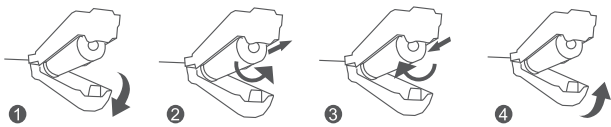

Resetting your filter indicator:

Note: These are the most common filter reset instructions. If the instructions don't work for your refrigerator brand, see the documentation that came with your refrigerator.

Table with 2 columns: Refrigerator brand, Instructions. Rows for Maytag® systems and Kenmore® systems.

Storage and maintenance:

- Replace your filter every 6 months or 300 gallons to prevent bacteria and fungus growth in your filter, supply lines, and storage tank.
- Keep your unused filters in a cool, dark, and dry place until you need them.
- If you do not use your water dispenser for more than four days, run two gallons of water before using it to prevent bad tasting water.

Frequently asked questions:

- Q: Why is it difficult to twist the new filter into the filter housing?
A: The connector may expand because of water pressure. Therefore, it is recommended you push the new filter in with a little bit of force, but not too hard. Then turn it clockwise.
Q: Do I need to flush the filter after installation?
A: After installation, it is highly recommended you run water for a few minutes before using. Water filters are made from advanced coconut carbon block, so there are some carbon fines in the filter. Flushing removes the carbon fines to produce clean water.
Q: Must the filter be changed every 6 months?
A: Yes, you must replace the filter every six months or sooner if water flow is reduced or if there is heavy sediment / rust present. Over-used filters will degrade the filtration performance.

Warning:

To reduce the risk of property damage due to water leakage, this filter MUST be installed in accordance with the manufacturer's specifications and instructions. This filter unit must be replaced every 300 gallons or 6 months. Failure to follow instructions and operating specifications will void your warranty. Further, manufacturer assumes no responsibility or liability for damages arising out of misuse of the product.
Maytag® is a registered trademark of Maytag Corp., Delaware.
Maytag® is used for reference purposes only.
KitchenAid® is a registered trademark of Whirlpool Properties, INC..
KitchenAid® is used for reference purposes only.
Kenmore® is a registered trademark of KCD IP, LLC..
Kenmore® is used for reference purposes only.

*The service life mentioned above is subject to chlorine reduction. Actual result varies according to the local water quality.

Manufacturer Technical Support
Tel: 1-888-352-3558 (U.S.)
E-mail: service@water-filter.com

Performance data sheet

System Model No.: EFF-6007S

Operating specifications:

Operating Temperature: 33 -100°F/0.6 - 38°C
Working Pressure: 20 -100 psi/140 - 689 kPa
Rated Capacity: 300 gallons/1,137 litres
Flow Rate: 0.5 gpm/1.9 lpm

Substance reduction:

The system has been tested and certified by the NSF International according to NSF/ANSI Standard 42 for the reduction of the substances listed below. The concentration of the indicated substances in water entering the system was reduced to a concentration less than or equal to the permissible limit for the water leaving the system, as specified by NSF/ANSI Standard 42. While testing was performed under standard laboratory conditions, actual performance may vary.

Table with 8 columns: Substance, Inf.Average, NSF Specified Challenge Concentration, Ave. % Reduction, Average Product Water Concentration, Max Permissible Product Water Concentration, NSF Reduction Requirements, NSF Test Report.



Do not use with water that is microbiologically unsafe or of unknown water quality without adequate disinfection before or after the system. Systems certified for cyst reduction may be used with disinfected water that may contain filterable cysts.