

INSTRUCTION MANUAL

Instruction Manual for Electric Luminarias IMPORTANT SAFETY INSTRUCTIONS

When using electrical products, basic precautions should always be followed including:

1. **READ AND FOLLOW ALL SAFETY INSTRUCTIONS**
2. This is a seasonal use product and is not intended for permanent installation or use.
3. Save these instructions.
4. Do not mount or place near gas or electric heaters, fireplaces, candles or other similar sources of heat.
5. Do not secure the wiring of the product with staples or nails, or place on sharp hooks or nails.
6. Do not let bulbs rest on the supply cord or on any wire.
7. Unplug the product when leaving the house or the location where being used, when retiring for the night, or if left unattended.
8. This is an electric product--not a toy! To avoid risk of fire, burns, personal injury and electric shock it should not be played with or placed where small children can reach it.
9. Do not use this product for other than the intended use.
10. Do not hang ornaments or other objects from the cord, wire, bulb or any other area of the product.
11. Avoid pinching the electrical cord by items such as doors, windows, cabinets, etc. as this may damage the wire insulation and product.
12. Do not cover the product with cloth, paper or any material not part of the product when in use.
13. This product has a polarized plug (one blade is wider than the other) as a feature to reduce the risk of electric shock. This plug will fit in a polarized outlet only one way. If the plug does not fit fully in the outlet, reverse the plug. If it still does not fit, contact a qualified electrician. Do not use with an extension cord unless plug can be fully inserted and safe for outdoor use. Do not alter or replace the plug.
14. When products are used in outdoor and indoor applications, connect the product to a Ground Fault Circuit Interrupting (GFCI) outlet. If one is not provided or you are unsure, contact a qualified electrician for proper installation.
15. This product employs overload protection (fuse). A blown fuse indicates an overload or short-circuit situation. If the fuse blows, unplug the product from the outlet. Also, unplug any additional strands or products that may be attached to the product. Replace the fuse as per the user servicing instructions (follow product marking for proper fuse rating) and check the product. If the replacement fuse blows, a short-circuit may be present and the product should be discarded for safety purposes.
16. Read and follow all the instructions that are on the product or provided with the product.

Use and Care Instructions

Before using or reusing, inspect product carefully. Discard any product that has a cut, is damaged, or has frayed wire insulation or cords, cracks in the bulb holders or enclosures, loose connections, or exposed copper wire. When storing the product, carefully remove the product from wherever it is placed, including trees, branches, or bushes, to avoid any undue strain or stress on the product conductors, connections, and wires. When not in use, store neatly in a cool, dry location protected from sunlight.

Assembly Instructions

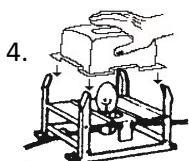
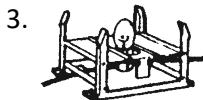
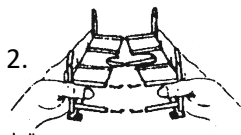

NOTE: Do not plug ELECTRIC LUMINARIAS into power until installation is complete!

1. String out wire with sockets at each position where ELECTRIC LUMINARIAS is to be installed.
2. Press stand sections together.
3. Screw bulb into socket. Bring each bulb and socket up from the bottom of the frame, then bring up snap-tight socket holder. (Bulb should **not** rest on the frame.)
4. Place clear bulb guard on base before installing luminaria sleeve. If not already removed, remove Small Circle on top of Bulb Guard before installing (Small Circle says "REMOVE BEFORE USE" on it).
5. (optional) For a traditional look or in high wind areas cut open the top of the sleeve.
6. Slid Sleeves over stand uprights
7. (optional) Purchase our Electric Luminarias Bag Clips(L21008) to prevent the Sleeve from coming off. After step 6, slide Bag Clip over bag and base. For best results, use two Bag Clips per frame.
8. (optional) Purchase our Heavy Duty Galvanized Hold-Downs(L10085). Push Hold-Downs through hole in frame and into ground. For best results, use two Hold-Downs per frame. For temporary use only.
9. (optional) Purchase our Parrot Clips and Luminaria Snaps to apply the ELECTRIC LUMINARIAS to walls and on top of Santa Fe style houses. Refer to Parrot Clips and Luminaria Snaps directions for assembly.
10. Plug only into 110 to 120 volt outlet equipped with Ground Fault Circuit Interrupter (GFI).

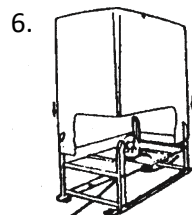

User Servicing Instructions

1. Grasp plug and remove from the receptacle or other outlet device. Do not unplug by pulling on cord.
2. Open fuse cover (illustration A). Slide open fuse access cover on top of the attachment plug towards plug blades.
3. Remove fuse carefully (illustration B), replace with new fuse. Replace fuse only with 5 Amp , 120-125 Volt new fuse.(provided with product) Caution risk of fire if improper fuse is used.
4. Close fuse cover (illustration C). To close, slide fuse access cover on top of the attachment plug away from the plug blades and back into place.
5. Plug contains a fused safety device that should not be removed. Discard product if the attachment plug is damaged.
6. To remove bulb, grasp plastic socket and carefully unscrew bulb counter-clockwise.
7. Caution: Replace bulb with only same type 7 watt max C-9 1/4 UL classified or C9 LED bulbs.



(illustration A)



(illustration B)



(illustration C)

For more information contact:

RC Company Manufacturing LLC
www.RCCompany.com

428 E Thunderbird Rd #243
Phoenix, AZ 85022
(623) 434-1745
Fax: (623) 434-1746
Email: info@rccompany.com

