

## Item Number: A05029

### **WARNING (To reduce the risk of fire, electric shock, or personal injury):**

1. We suggest installation by a **licensed electrician**.
2. Please read the instruction carefully and save it as you may need it at a later time.
3. Before you start, **NEVER** attempt any work without shutting off the electricity until the work is done.
  - » Go to the main fuse, or circuit breaker, box in your home.  
Place the main power switch in the **"OFF"** position.
  - » Place the wall switch in the **"OFF"** position.
4. Mounting surface should be clean, dry, flat, strong enough and 1/4" larger than the canopy on all sides. Any gaps between the mounting surface and canopy exceeding 3/16" should be corrected as required.
5. Make sure that the ceiling or wall can stand the weight of the lamp before installation.
6. Make sure the voltage you are using is **120V**. The maximum wattage is **LED, Max 30W**.
7. Keep the lamp away from acidic and alkaline substances in case of damaging the surface of the lamp.
8. When replacing bulbs, you should turn off or unplug the lamp and you must wait until it is cool as bulbs get hot quickly.
9. The safety instructions appearing in this manual are not meant to cover all possible conditions that may occur. It must be understood that common sense, caution and care must be used with any electrical products.

### **IMAGE FOR FINISHED PRODUCT:**

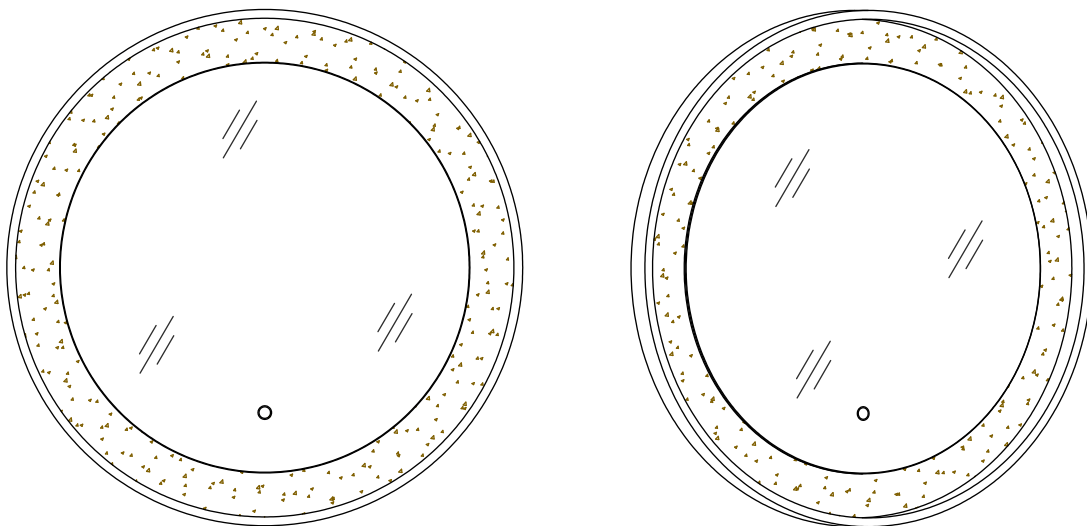

### **TOOLS REQUIRED (NOT INCLUDED):**

Before starting assembly and installation please prepare the needed tools as below picture

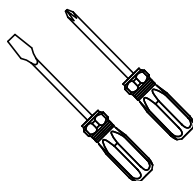
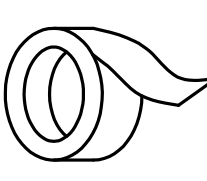
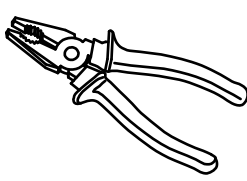
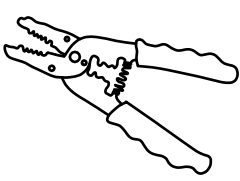
				
Ladder	Philips Head or Flat Blade Screwdriver	Electrical Tape	Pliers	Wire Cutter/Stripper

### **ORDERING PARTS**

Keep this sheet for future reference in case you need to order replacement parts. All parts for this fixture can be ordered from the place of purchase. Be sure to use exact wording from illustration when ordering parts.

### **CLEANING**

To clean, wipe the fixture with a soft cloth. Clean glass with a mild cleaner (such as mild and non-abrasive soap). Do not use abrasive materials such as scouring pads or powders, steel wool or abrasive paper.

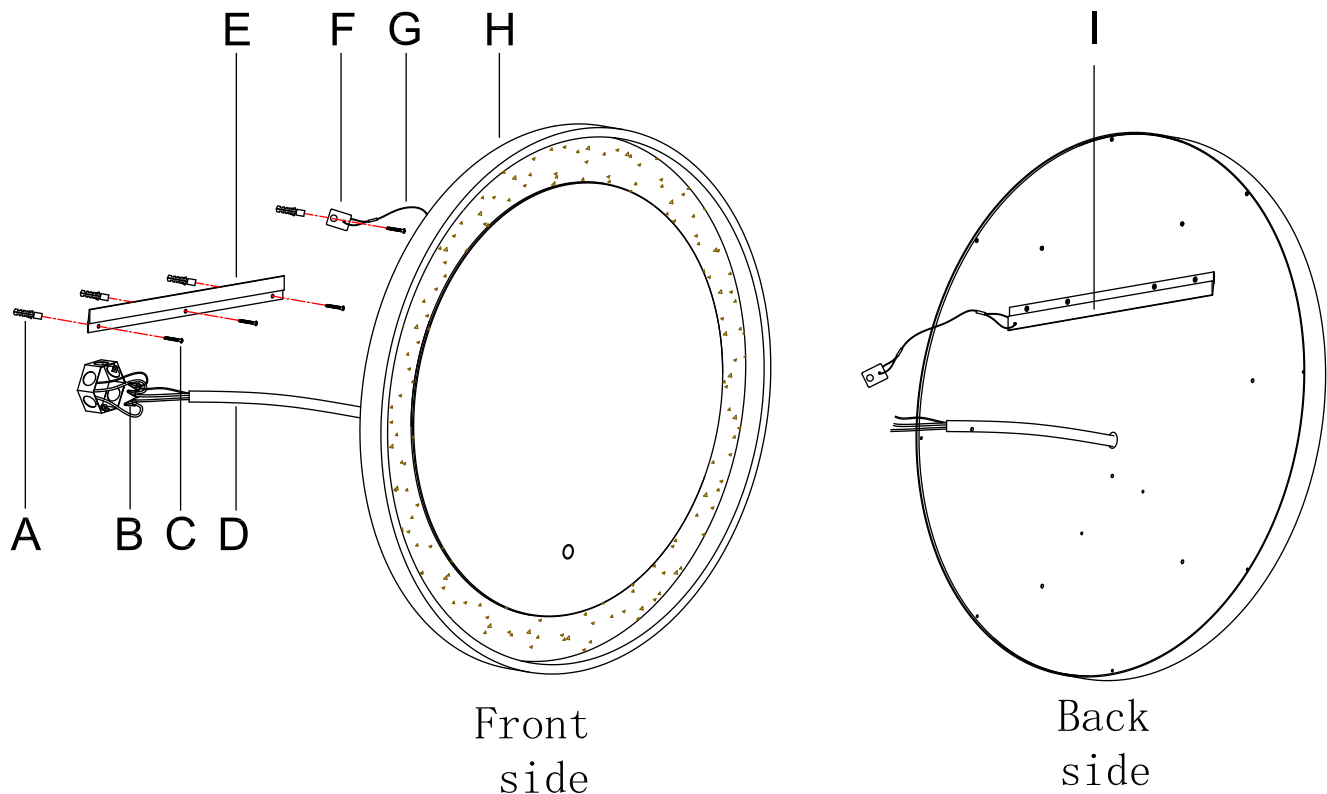

**PARTS TYPE & QTY INCLUDING:**

- (D) Wire (1)
- (E) Hanging plate (1)
- (F) Washer (1)
- (G) Steel wire (1)
- (H) Lamp body (1)
- (E) Back plate (1)

**ACCESSORIES & QTY ENCLOSED:**

- (A) Wall anchor (5) (1 of them is the spare part)
- (B) Plastic wire connector (3)
- (C) Wood screw (5) (1 of them is the spare part)

**ASSEMBLY & INSTALLATION INSTRUCTIONS:**

1. Carefully remove the fixture from the carton and check that all parts and accessories are included as shown in the above illustration.

2. Turn off power

Before you start the installation, NEVER attempt any work without shutting off the electricity until the work is done.

**1) Go to the main fuse, or circuit breaker, box in your home.**

**Place the main power switch in the “OFF” position.**

**2) Place the wall switch in the “OFF” position.**

3. Make installation

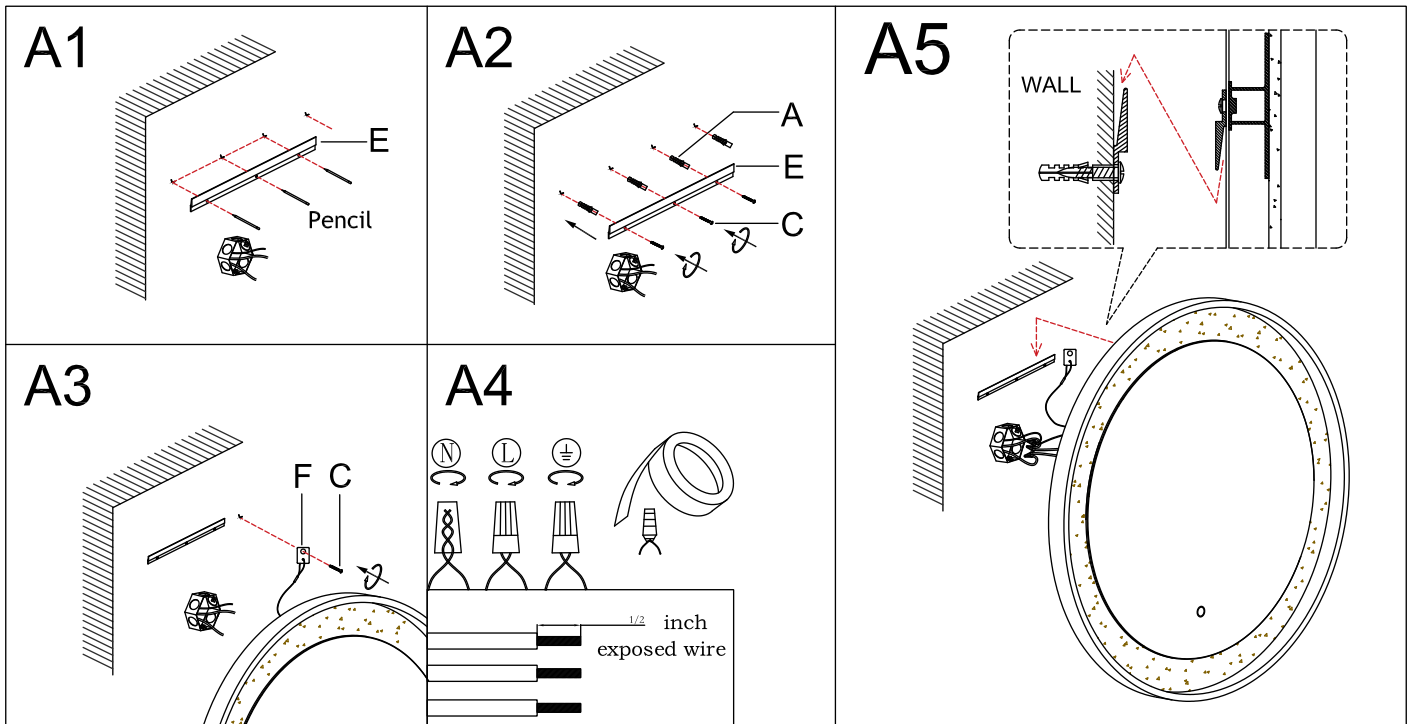

**Step A1»** 1) By measuring, mark spots on the wall and above the outlet box with a pencil, and draw a total of 4 spots.

2) Use an electric drill to punch four  $\varnothing 6\text{mm}$  holes at the marked spots.

• ( $\varnothing 6\text{mm}$  drill bit, drilling depth in 2 inches)

**Step A2 »** 1) Gently put wall anchors (A) into the holes with hammer until wall anchors are level with the wall as shown in the illustration.

2) Secure hanging plate (E) to the wall with wood screws (C) as shown in the illustration.

**Step A3 »** Screw the last wood screw (C) into the last hole to fix washer (F).

**Step A4 »** Make wire connections

Connect wires as below wires connection shown. **REFER TO THE FOLLOWING CHARTS, NEVER CONNECT OTHER WIRES TO GROUND WIRES.**

Connect ground wires according to the below chart

Connect wires according to the below chart

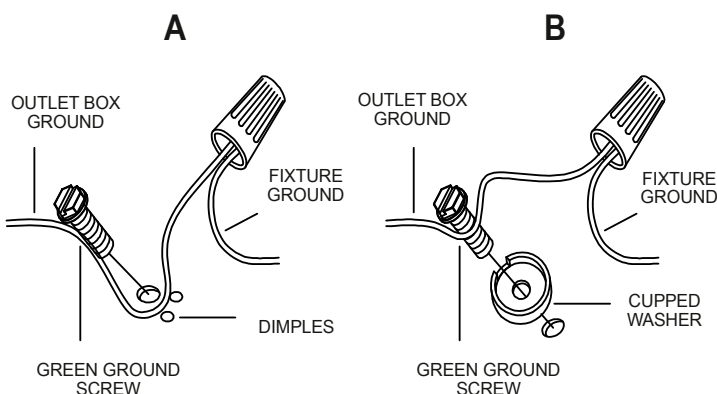

Connect Black or Red Supply Wire to:	Connect White Supply Wire to:
Black	White
*Parallel cord (round & smooth)	*Parallel cord (square & ridged)
Clear, Brown, Gold or Black without tracer	Clear, Brown, Gold or Black with tracer
Insulated wire (other than green) with copper conductor	Insulated wire (other than green) with silver conductor

\* Note: When parallel wires (SPT I & SPT II) are used. The neutral wire is square shaped or ridged and the other wire will be round in shape or smooth (see illus.)

- Twist wires together with plastic wire connectors (B) until tightly joined.
- Wrap each connector with approved electrical tape.
- Be sure that no wire strands are exposed and then carefully tuck all wires into the outlet box.

**Step A5 »** Insert one of back plates (I) into the slot of hanging plate (E) as shown in the illustration.

4. Check everything is already installed properly, then you could turn on the light. Enjoy!

## Operating instructions:

(1)After the power is turned on, the touch button will remain white.

Short press (hold for less than 1s)

Long press (hold for more than 1s).

### (2)Operation of light control.

1.Change the color of LED strip:

- 1) Short press touch button for the first time → to turn on the light and LED strip in white.
- 2) Short press for the second time → LED strip in yellow.
- 3) Short press for the third time → LED strip in warm white.
- 4) Short press for the fourth time → to turn off the light and the button remains white.

2.LED strip is on: long press the touch button to circularly adjust the brightness of the LED strip.

3.LED strip is off: long press the touch button to turn off the touch button light.