

### Important note:

1. Place all wooden parts on a clean and smooth surface such as a rug or carpet to avoid scratching the parts.
2. Kindly follow the assembly instructions step by step.
3. Do not tighten all screws and bolts until the table is fully assembled.
4. Unscrew the protective plastique supports from the metal insert of the table legs before assembly.

### PARTS IDENTIFICATION

#### A Table Top

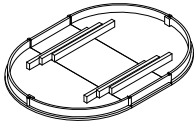

1pc

#### B Mounting Plate

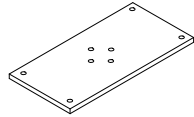

1pc

#### C Pedestal

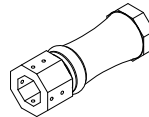

1pc

#### D Table Leg

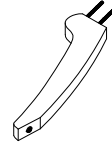

4pcs

### HARDWARE IDENTIFICATION

**1** Long Bolt  
Ø5/16"x50mm  
8pcs

**2** Hex Nut  
Ø5/16"x12mm  
8pcs

**3** Spring Washer  
Ø5/16"x11mm  
16pcs

**4** Flat Washer  
Ø5/16"x19mm  
16pcs

**5** Allen Key  
M4  
1pc

**6** Spanner  
12mm  
1pc

### STEP 1

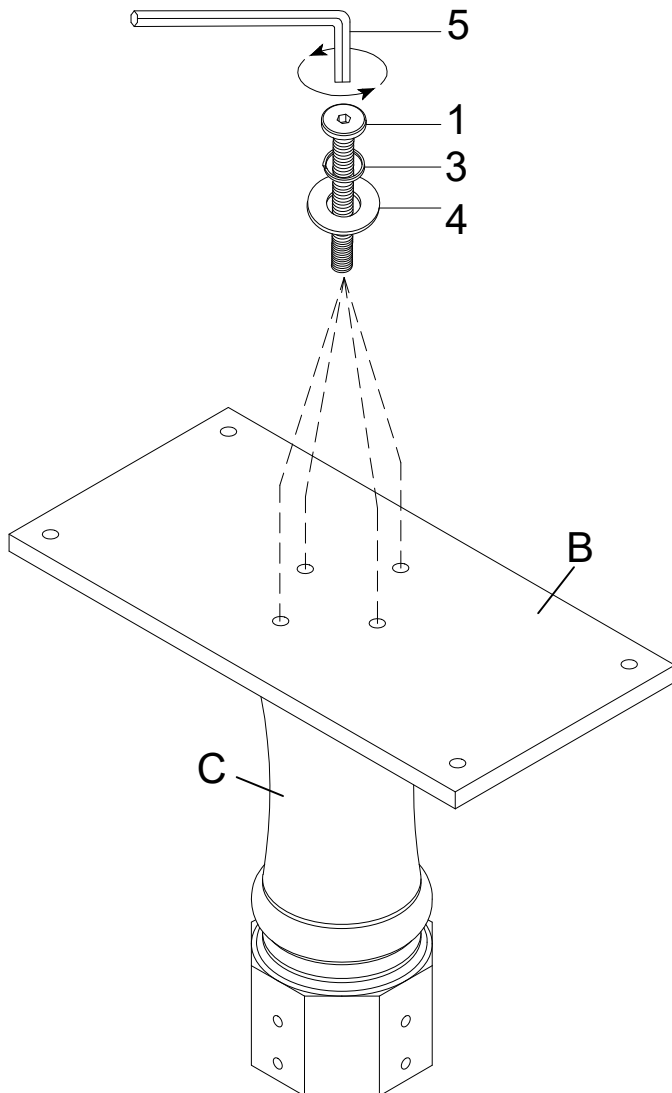

### STEP 2

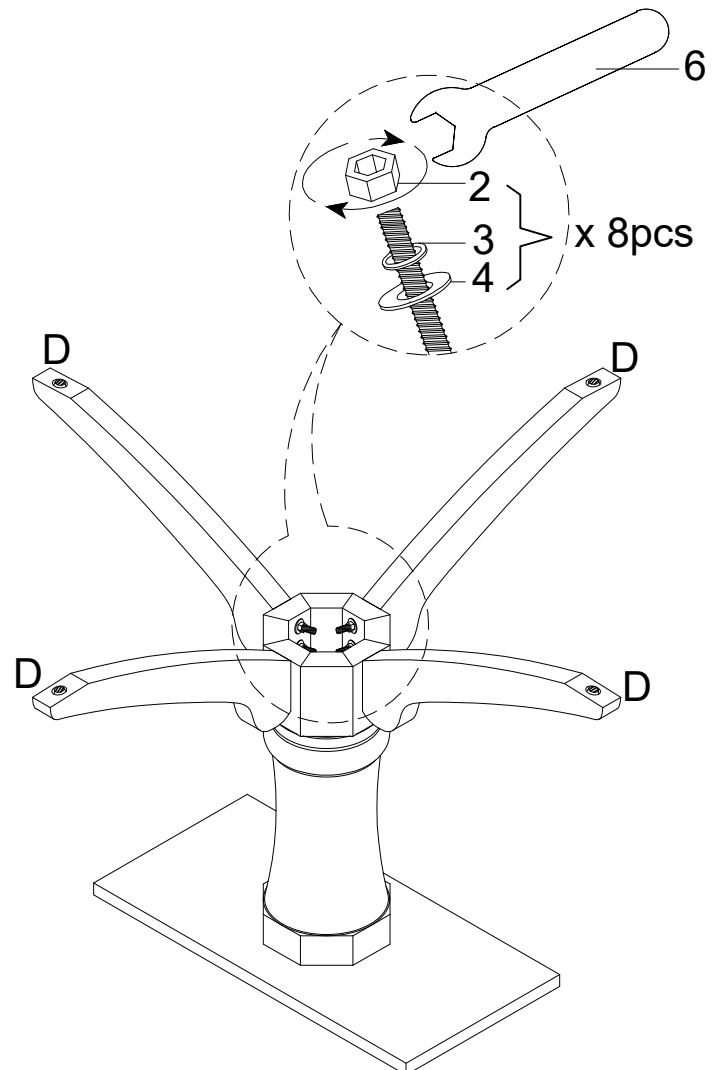

# ASSEMBLY INSTRUCTION

## ITEM: WF305986/WF305987

### STEP 3

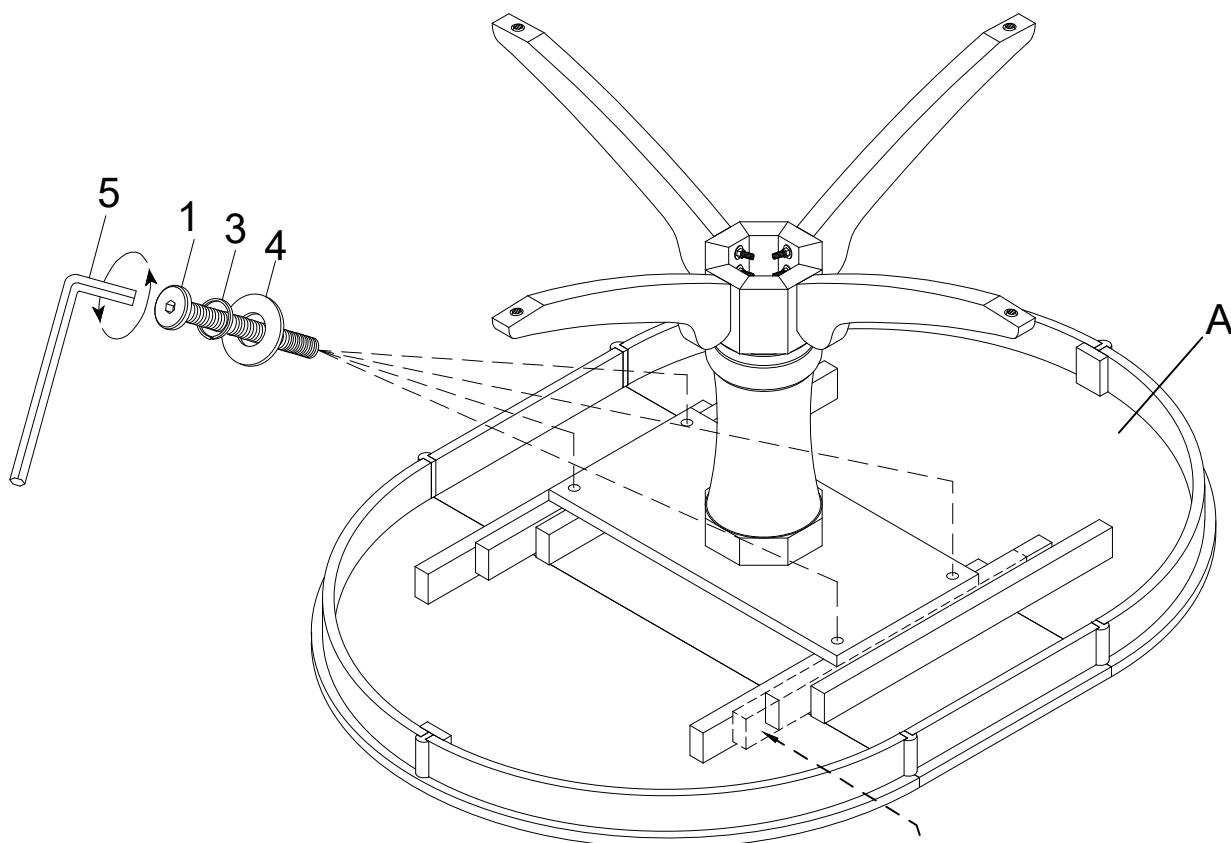

### STEP 4

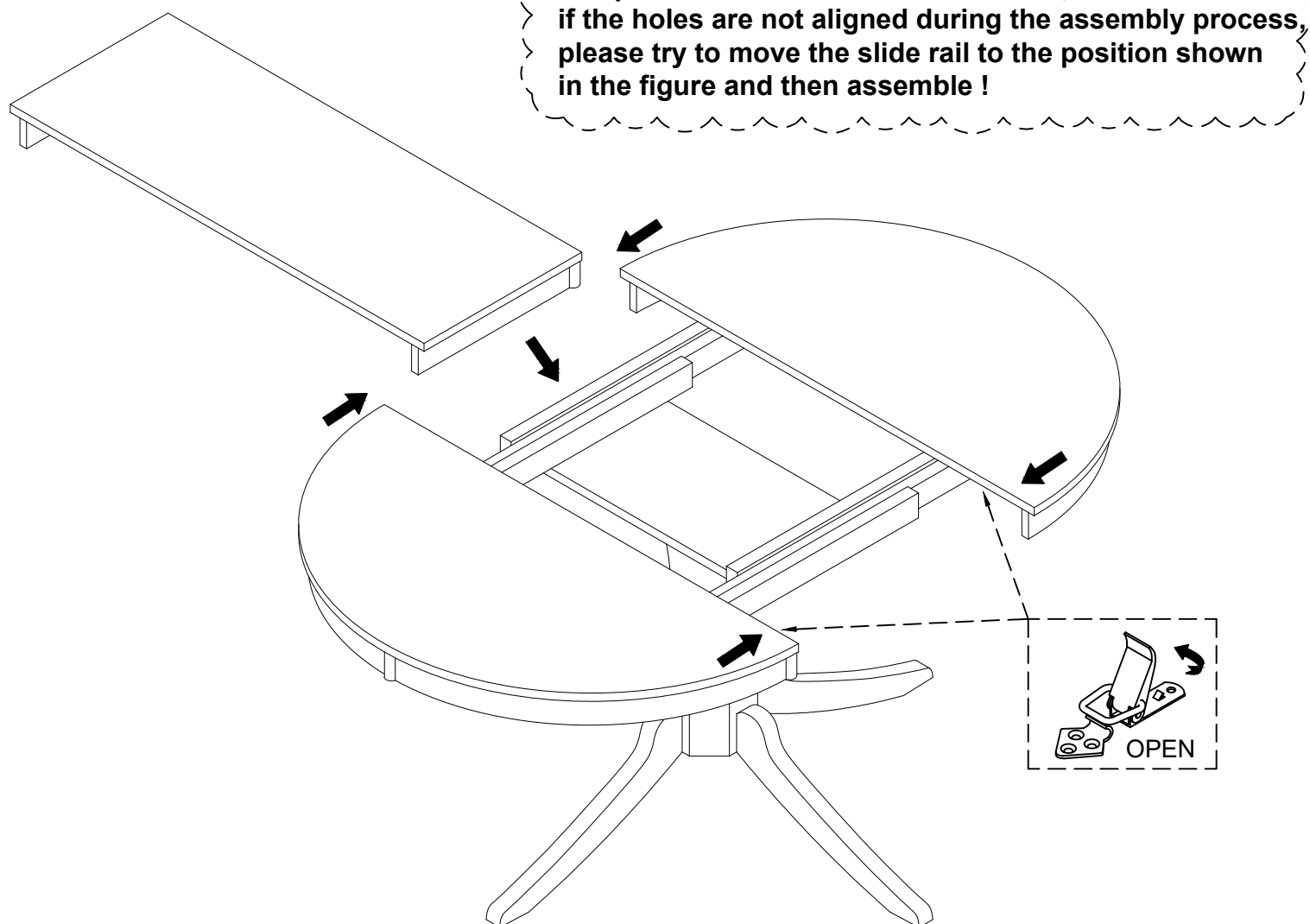

ASSEMBLY INSTRUCTION  
ITEM: WF305986/WF305987

COMPLETE

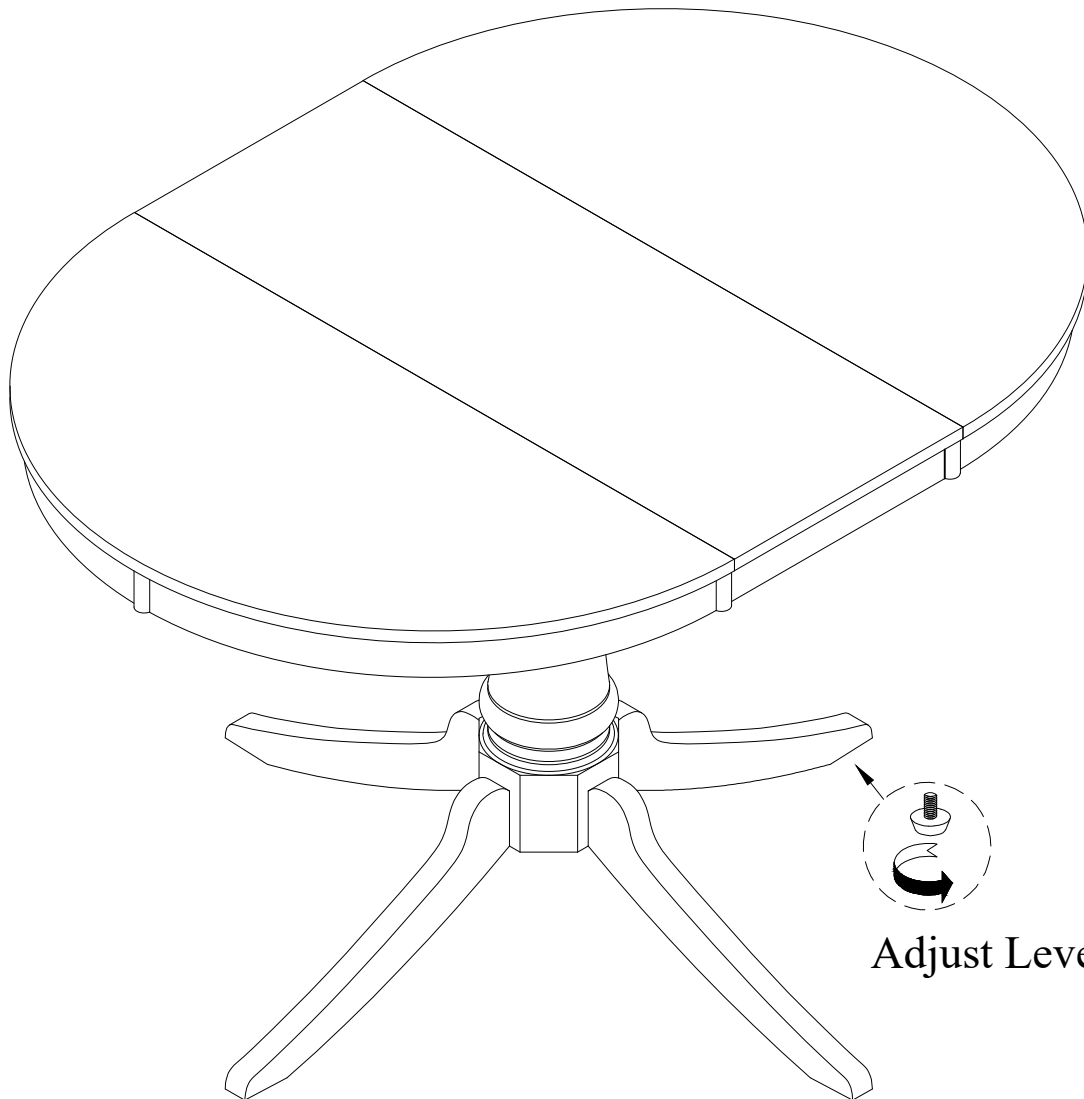

Adjust Leveler=4pcs.

# ASSEMBLY INSTRUCTION

## ITEM: WF305988

### Important note:

1. Place all wooden parts on a clean and smooth surface such as a rug or carpet to avoid scratching the parts.
2. Kindly follow the assembly instructions step by step.
3. Do not tighten all screws and bolts until the table is fully assembled.
4. Unscrew the protective plastique supports from the metal insert of the legs before assembly.

### PARTS IDENTIFICATION

**A** Chair Back

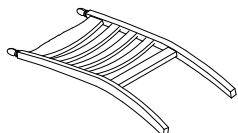

1pc

**B** Seat cushion

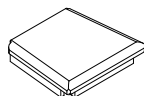

1pc

**C** Left Leg

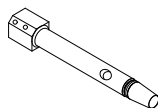

1pc

**D** Right Leg

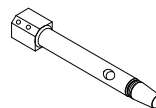

1pc

**E** Stretcher

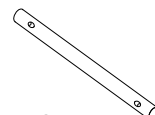

2pcs

### HARDWARE IDENTIFICATION

**1** Bolt

Ø5/16"x38mm



2pcs

**2** Bolt

Ø5/16"x60mm



4pcs

**3** Long Bolt

Ø5/16"x80mm



4pcs

**4** Spring Washer

Ø5/16"x11mm



10pcs

**5** Flat Washer

Ø5/16"x19mm



10pcs

**6** Wood screw

#8x38mm



4pcs

**7** Allen Key

M4

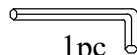

1pc

### STEP 1

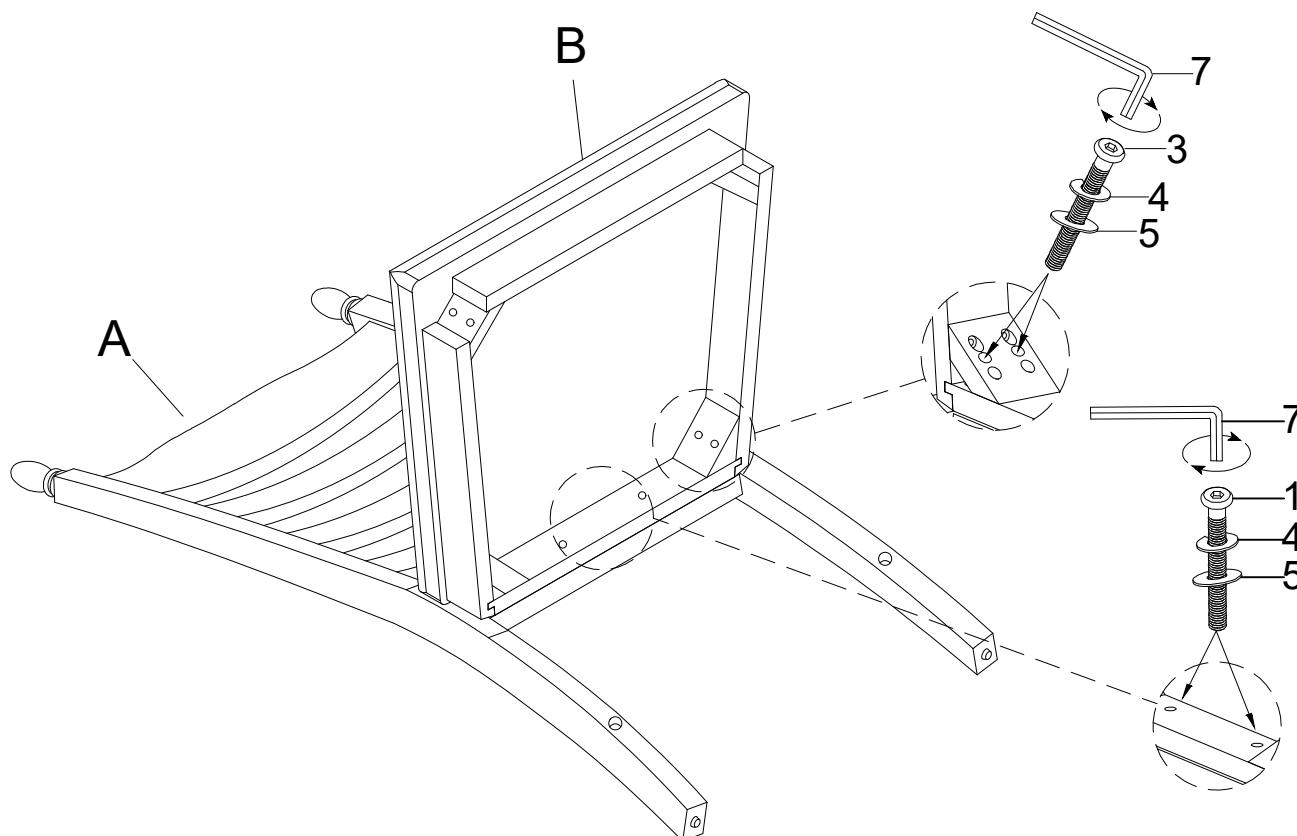

# ASSEMBLY INSTRUCTION

## ITEM: WF305988

### STEP 2

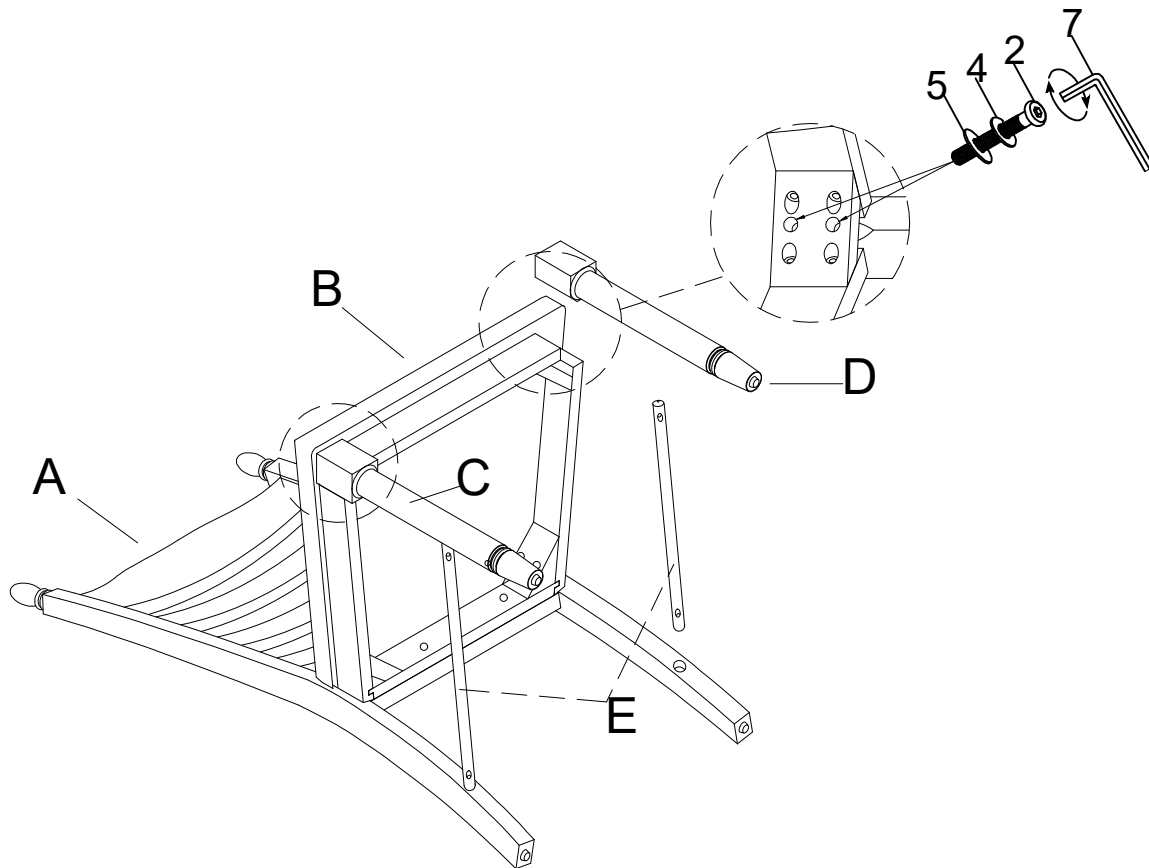

### STEP 3

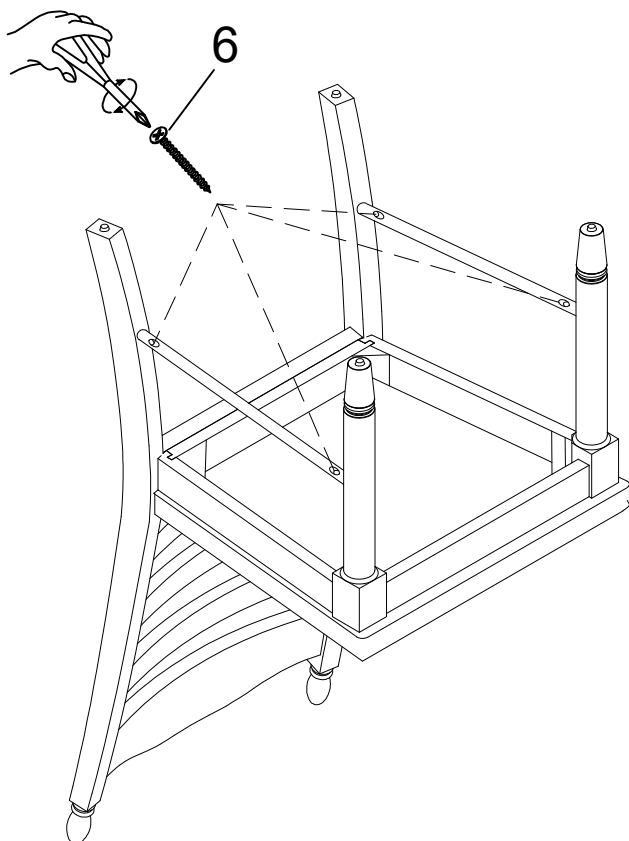

### COMPLETE

