



FINISHING PRODUCTS

CertainTeed Finishing Products



CertainTeed is a complete system of finishing products, specially developed to meet the demands of drywall professionals. The result is a professional-grade performance that minimizes callbacks improves profitability.

CertainTeed packages are color-coded to make it easy to pick the right CertainTeed product for your application.

READY-MIXED JOINT COMPOUNDS

CertainTeed Joint Compounds are pre-mixed high performance products designed for professional applicators. These products meet ASTM C475 Standard.

Lightweight



CertainTeed Lite Taping

Code: 640008

3.5 gal / 13.2 L

- Ready-Mixed
- For embedding wallboard tape and trims
- Excellent adhesion



CertainTeed Lite All-Purpose

Code: 640011

3.5 gal / 13.2 L

- Ready-Mixed Joint Compound
- Tape / Fill / Finish - Designed for all phases of drywall finishing
- Low shrinkage



CertainTeed Lite Topping

Code: 640009

3.5 gal / 13.2 L

- Ready-Mixed Joint Compound
- Designed for finish coats
- Low shrinkage



CertainTeed EXTRA All-Purpose

Code: 640031

3.5 gal / 13.2 L

- Ready-Mixed
- Designed for all phases of drywall finishing
- Low shrinkage
- Not available in all regions



CertainTeed Lite All-Purpose

Code: 640012

1 gal / 3.8 L

Code: 640007

4.5 gal / 17 L

- Ready-Mixed Joint Compound
- Tape / Fill / Finish - Designed for all phases of drywall finishing
- Low shrinkage

Heavyweight



CertainTeed Taping

Code: 640001

45 lb / 20.4 kg

- Ready-Mixed Joint Compound
- For embedding wallboard tape and trims
- Superior adhesion



CertainTeed All-Purpose

Code: 640002

48 lb / 21.8 kg

- Ready-Mixed Joint Compound
- Tape / Fill / Finish - Designed for all phases of drywall finishing



CertainTeed Topping

Code: 640000

48 lb / 21.8 kg

- Ready-Mixed Joint Compound
- Designed for finish coats
- Excellent for skim coating



CertainTeed All-Purpose

Code: 640004

62 lb / 21.8 kg

- Ready-Mixed Joint Compound
- Tape / Fill / Finish - Designed for all phases of drywall finishing



CertainTeed EXTREME All-Purpose

Code: 640892

3.5 US Gal. / 13.2 L

- High Performance Ready-Mixed
- Designed for tape, fill and finish coats
- Extreme Moisture and Mold Resistance
- Formulated to work with M2Tech® and GlasRoc® Interior drywall

Midweight



CertainTeed ONE Multi-Purpose

Code: 640010

3.5 gal / 13.2 L

- Ready-Mixed Joint Compound
- Tape / Fill / Finish - Designed for all phases of drywall finishing
- Can be used for skim coating and simple texturing

EASI-FIL® RETAIL COMPOUNDS

Easi-Fil® All-Purpose Joint Compounds are pre-mixed, air drying, easy-to-use products for any drywall job. Use them to embed paper tape, conceal and finish joints, fasteners and trim accessories. Easi-Fil® compounds come in varying sizes for any job.



Easi-Fil Dust Away

Code: 640520

1 US Gal / 3.8 L

- When sanded, dust clumps and falls directly to the floor
- General purpose formula for filling, repairing and finishing
- Ideal for areas where cleanliness is required

Easi-Fil® Setting Powders are chemically setting compounds that set in a prescribed time for fast fills and repairs. They have a higher bond strength than air drying compound.



Easi-Fil Light Repair 20

Code: 640032

2.76 lb / 1.25 kg

- Setting Compound
- Filling and finishing drywall joints, trims and fasteners
- Easy to sand when dry
- Sets in 20 minutes



Easi-Fil Heavy Repair 90

Code: 640033

4.4 lb / 2 kg

- Setting Compound
- Heavy fills and repairs
- Hard surface, difficult to sand
- Sets in 90 minutes

THE CERTAINTEED M2TECH® SYSTEM

M2Tech systems protect against moisture and mold in a lower cost system solution versus paperless products. These systems promote healthy indoor air quality when used in new construction and renovations over wood or steel framing in dry areas or areas with limited water exposure.



CertainTeed M2Tech Gypsum Board

CertainTeed M2Tech 90 Setting Compound
Code: 640034

FibraFuse™ Mold Resistant Mesh Tape
Code: 406479

SANDABLE SETTING POWDERS

CertainTeed LITE Sand PLUS Setting Compounds are lightweight sandable chemically setting powders used to prefill joints, embed joint tape and conceal joints, fasteners and trim accessories on gypsum wallboard. They can also be used for interior patching and repair. They are ideal for heavy fills because they are specially formulated to harden with very little shrinkage in a prescribed time frame. Setting times are available from 5 minutes to 210 minutes.



CertainTeed LITE Sand PLUS Setting Compounds

18 lb / 8.1 kg

- Lightweight
- Chemical hardening
- Low shrinkage
- Sandable when dry



LITE Sand PLUS 5
Code: 640602

LITE Sand PLUS 20
Code: 640574

LITE Sand PLUS 45
Code: 640576

LITE Sand PLUS 90
Code: 640594



CertainTeed M2Tech 90 Setting Compound

Code: 640034

18 lb / 8.1 kg

- Moisture and mold resistant
- Lightweight
- Chemical hardening
- Low shrinkage
- Sandable when dry

HEAVYWEIGHT SETTING POWDER

CertainTeed Super Set 45 Setting Compound is a heavyweight, sandable, chemically setting powder that is used to prefill joints, embed joint tape and conceal joints, fasteners and trim accessories on gypsum wallboard. It can also be used for interior patching and repair. It is ideal for heavy fills because it is specially formulated to harden with very little shrinkage in the prescribed time frame of 45-55 minutes.



CertainTeed Super Set 45 Setting Compound

Code: 642644

25 lb / 11.3 kg

- Heavyweight Setting Compound
- Smooth mixing
- Low shrinkage
- Sandable
- Good mileage

WALL AND CEILING SPRAY TEXTURES

CertainTeed Wall and Ceiling Spray Textures provide a decorative appearance over gypsum panels and most other interior wall and ceiling surfaces. They are formulated to provide for a variety of decorative options including splatter, knockdown and orange peel designs.



CertainTeed Wall and Ceiling Texture (Red)

Code: 640519

50 lb / 22.6 kg

- Suitable for orange peel to knock down texture patterns
- Tough, durable finish
- Excellent mileage
- Unaggregated



CertainTeed Wall and Ceiling Texture (Blue)

Code: 640526

50 lb / 22.6 kg

- Easy mixing
- Good mileage
- Light to medium texture patterns
- Unaggregated



CertainTeed Easi-Tex Spray Texture

Code: 640005

48 lb / 21.8 kg

- Dust free and pre-mixed
- Harder and more durable finish
- Suitable for all spray patterns and equipment
- Unaggregated

JOINT REINFORCEMENT TAPE

CertainTeed Marco® Spark-Perf® Joint Reinforcement Tape is a spark perforated paper tape designed for use with ready-mix joint compound to reinforce gypsum board joints and corners.



CertainTeed Marco Spark-Perf Paper Tape

500' x 10 rolls Code: 639341

250' x 20 rolls Code: 639337

75' x 20 rolls Code: 639338

- Spark-perforated for elimination of air bubbles
- Manufactured from fibered-paper with added tensile strength to help prevent tearing, wrinkling or stretching
- Machine roughed for superior bonding



FibaFuse™ Paperless Drywall Tape

2-1/16" x 250' Code: 406479

- Compatible with mold resistant wallboard
- Stronger than paper tape
- Perfect "10" rating on ASTM D3273 mold test
- For use with setting compounds



CertainTeed Marco Spark-Perf 94# Heavy Weight Paper Tape

Code: 639535

500' x 10 rolls

- Heavy weight drywall tape
- Spark-perforated for elimination of air bubbles
- Manufactured from fibered-paper with added tensile strength to help prevent tearing, wrinkling or stretching
- Machine roughed for superior bonding

COATINGS

CertainTeed coatings are high performance surfacers that efficiently bring high levels of finishing.



CertainTeed Level V Roll-On Wall and Ceiling Primer/Surfacer

Code: 405374

18.9 L / 5 US Gal.

- Takes a level 4 finish to level 5
- Designed for easy roller or spray application
- Eliminates putty or skim coating by hand
- Can be sanded but not necessary



CertainTeed Quick Prep Interior Prep Coat/Primer

Code: 405507

5 gal / 18.9 L

- Uniforms porosities between gypsum paper and joints
- Designed for easy roller or spray application
- Sandable



CertainTeed Quick Prep +PLUS Interior Prep Coat/Primer

Code: 405774

5 gal / 18.9 L

- For use in lieu of skim coat
- Uniforms porosities between gypsum paper and joints
- Meets specification for GA 214 and ASTM C840



CertainTeed Vapor Prime

Code: 408186

5 gal / 18.9 L

- Semi-permeable vapor retarder
- Apply with airless sprayer
- No thinning necessary
- Low VOC product



CertainTeed Extreme Texture Coat

Code: 405593

5 gal / 18.9 L

- Highly durable and scrubbable
- Not abrasive to skin
- Mold resistant
- Highest possible score for mold resistance under ASTM 3273

Gypsum

Every day, walls come under attack — from bumps to mould, formaldehyde to sound transmission. CertainTeed drywall and corner solutions can fend off whatever life throws at it, creating superior durability, acoustic and indoor air quality solutions. See Why Walls Matter, in any project, with CertainTeed Gypsum. certainteed.com/wallsmatter

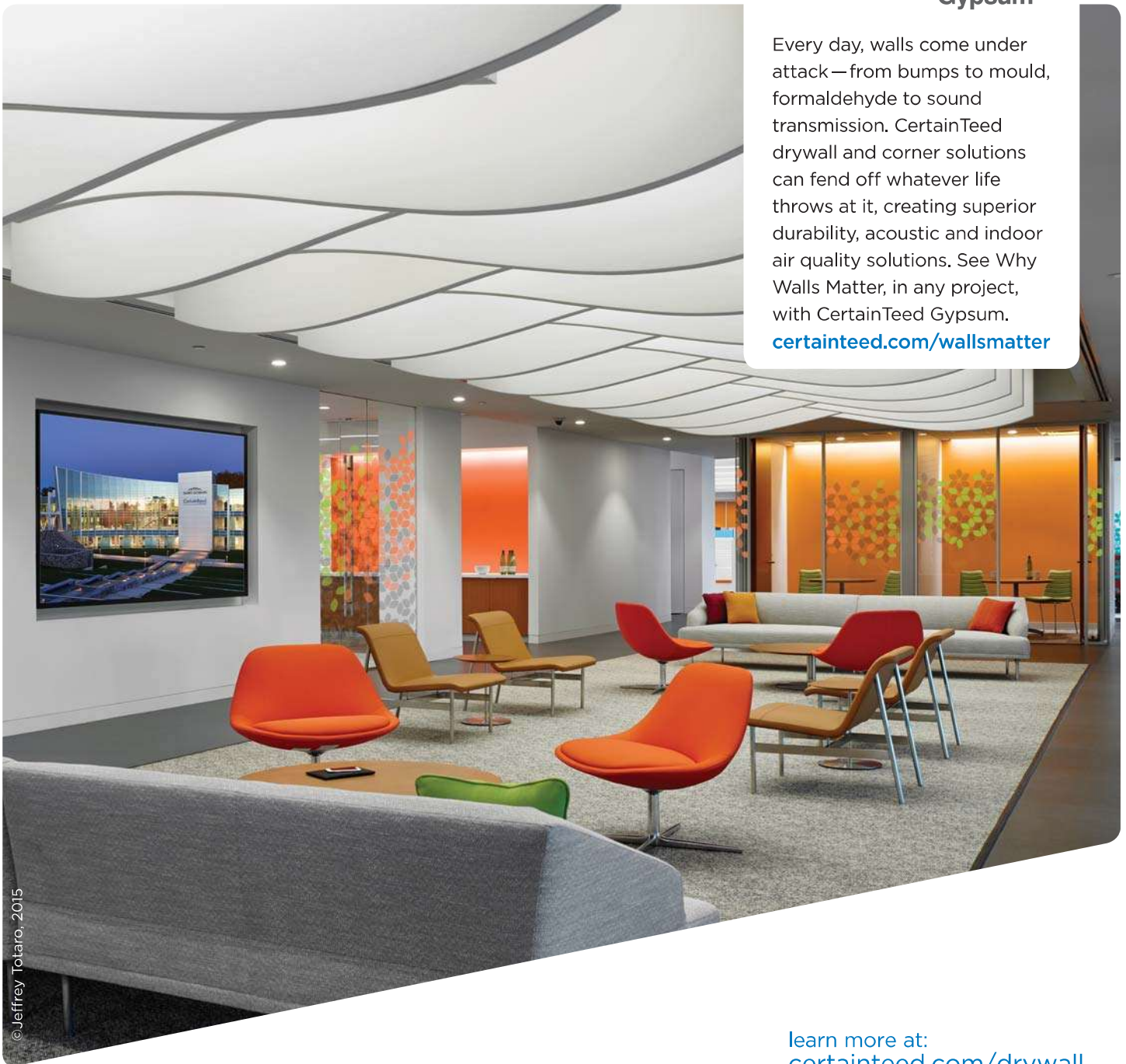

©Jeffrey Totaro, 2015

learn more at:
certainteed.com/drywall



CertainTeed Corporation

CEILINGS • DECKING • FENCE • GYPSUM • INSULATION • RAILING • ROOFING • SIDING • TRIM

20 Moores Road Malvern, PA 19355 Professional: 800-233-8990 Consumer: 800-782-8777 certainteed.com