

American Planking Installation Instructions

Read Carefully Before Installation

Step 1) Open boxes of planking in the room it will be installed. Wood **MUST** acclimate to the conditions of the room for a minimum of **72 hours**.

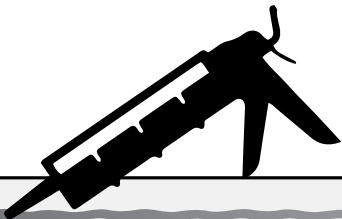
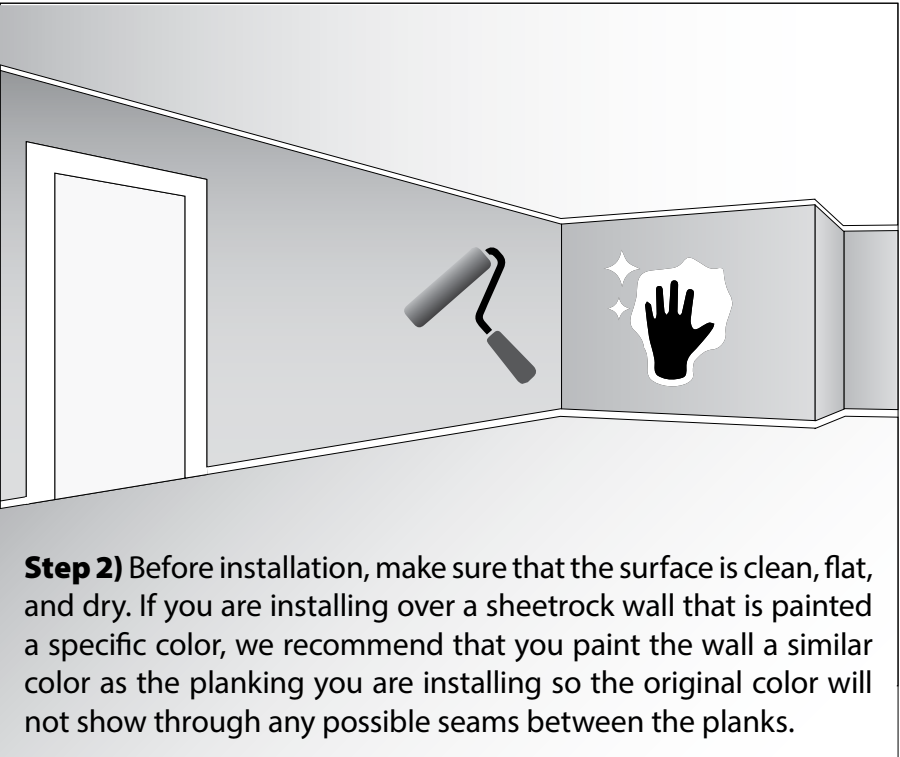
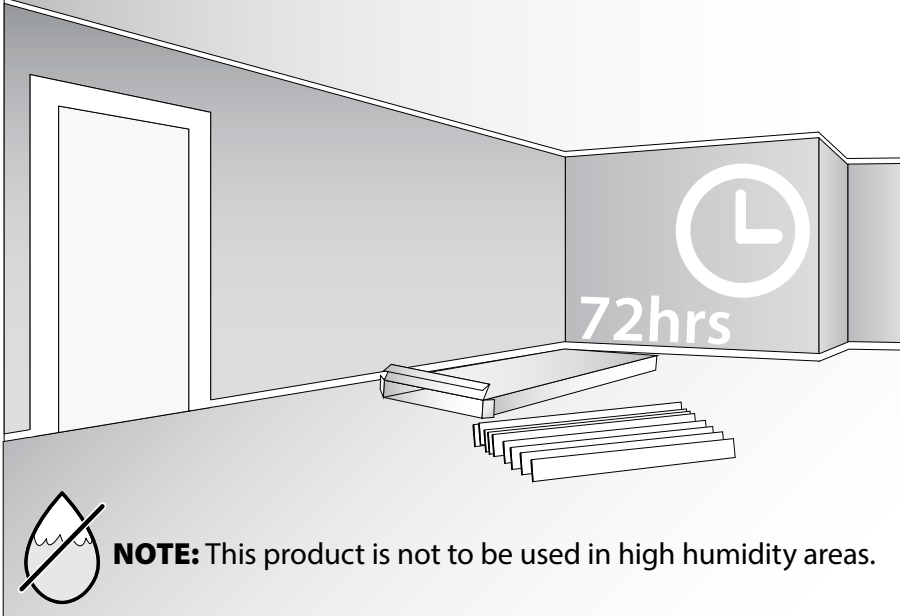

Proper Construction Adhesive Application

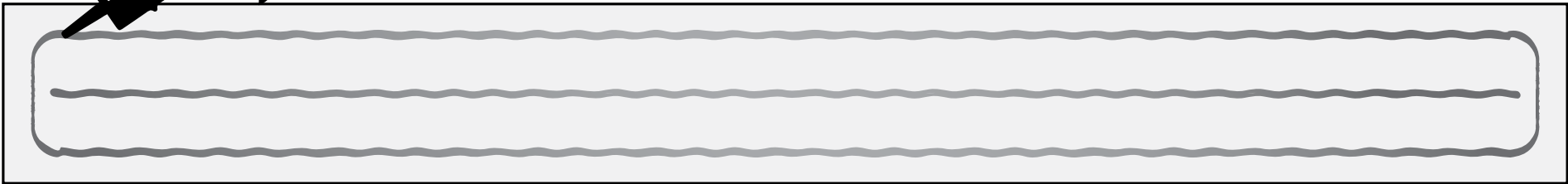

Proper Brad / Nail Placement



Step 3) Recommended installation is with Heavy Duty *Liquid Nails® (construction adhesive) and to be nailed with a brad nail gun or a hammer and finishing nails. Each plank should have a bead of adhesive 1" from all outside edges and a single bead applied down the center of the plank (see above diagram). Recommended brad/nail lengths is 1-1/4". Apply brads/nails approximately 1/2" from outside edges of planks and into studs when possible (see above diagram). If a brad gun is not available, use 3d x 1-1/4" finish nails along with a nail set to set the nail head slightly before the surface of the plank. It is not recommended to apply wood putty to the nail holes since the putty will collect in the weathered wood grain.

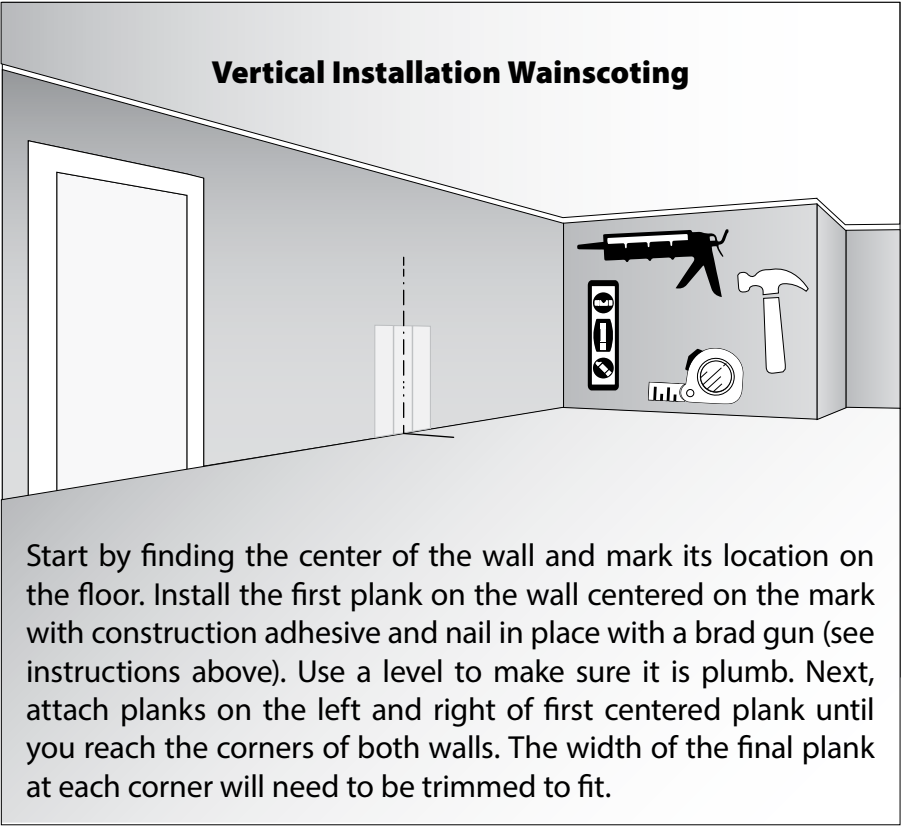
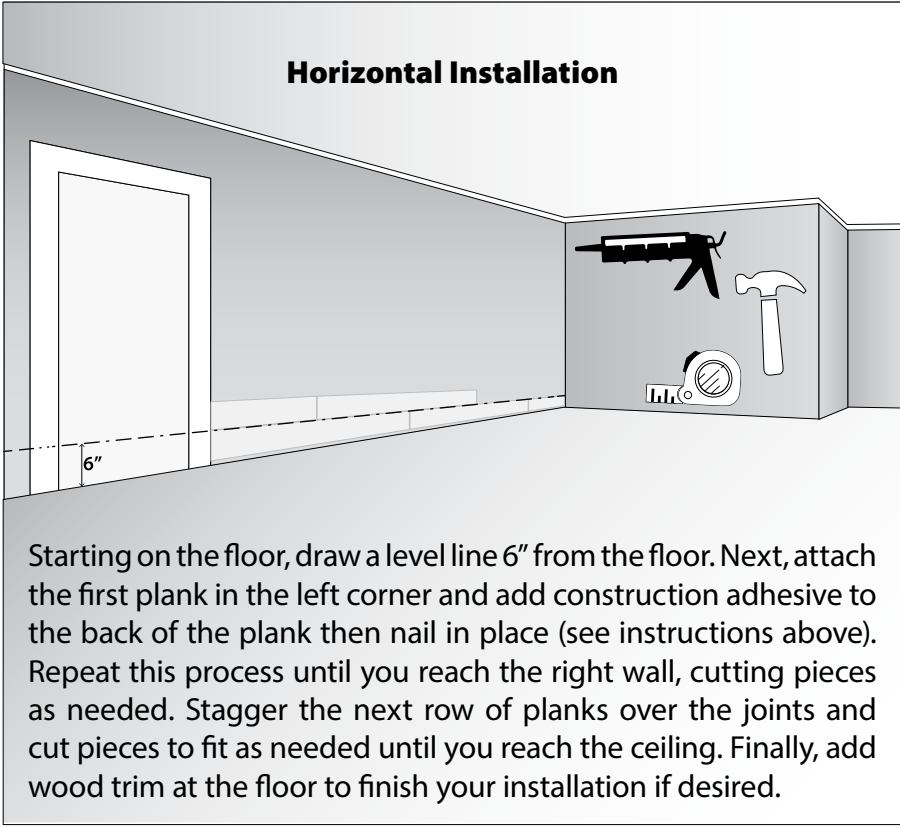

Coastal White Touch Up Instructions

What you will need:

- **Minwax® - Tinsmith Gray MW1091 Penetrating Stain
- Cotton swabs or a small art brush
- Disposable container

Directions: In a disposable container, dilute the amount of stain you need with 50% water. Apply a small amount of **Minwax® Tinsmith Gray MW1091 stain to a cotton swab or small art brush. Lightly brush the stain over the area needing to be repaired and wipe away the excess. Let the spot dry. Reapply additional light coats if needed.

AmericanPac.com



*Liquid Nails® is a registered trademark of PPG Architectural Finishes Inc. © 2024 PPG Industries, Inc.

** Minwax® is a registered trademark of The Sherwin - Williams Company © 2024 Minwax® Company