

## ASSEMBLY INSTRUCTIONS

# MOD-7202

V0.07.29.24

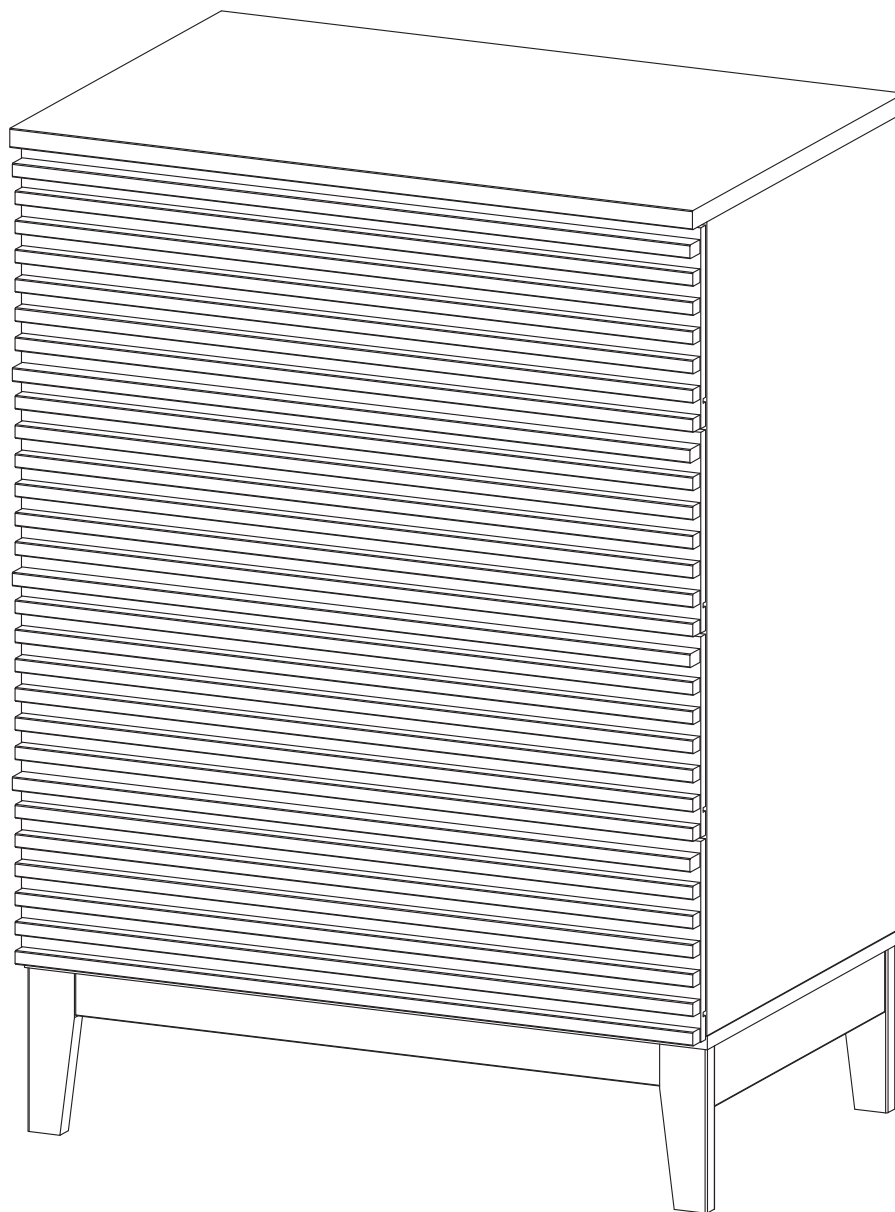

### Questions? Contact us!

609.256.9000 • [cs@modway.com](mailto:cs@modway.com)  
[www.modway.com](http://www.modway.com)

\*modway

# Let's get started!

\*modway



Read through all of the instructions before starting



Care instructions are listed in the last step of this manual



Approx. 60 minutes assembly time



Make sure you have all parts and components before discarding any packing materials



2 people recommended for assembly

**Only use hand tools to assemble this item.** Do not use power tools. Do not tighten bolts or screws completely until all hardware is lined up and inserted into the holes.

Do not over-tighten screws and bolts to avoid stripping the hardware or cracking the item.

Assemble your item on a flat, carpeted area, with plenty of space to work. This will prevent damage and scratches to your floors or the item while you're assembling the product.

Keep all components and packaging out of reach of children or animals to avoid risk of choking or suffocation.

## Furniture components:

1	Top Board	x1	11	Bottom Drawer	x4
2	Bottom Board	x1	12	Support Drawer	x4
3	Side Board Left	x1	13	Handle	x4
4	Side Board Right	x1	14	Support Board	x1
5	Assembly Leg	x2	15	Counter Weight Board	x2
6	Bottom Skirt	x2	16	Back Board	x4
7	Front Drawer	x4			
8	Side Drawer Left	x4			
9	Side Drawer Right	x4			
10	Back Drawer	x4			

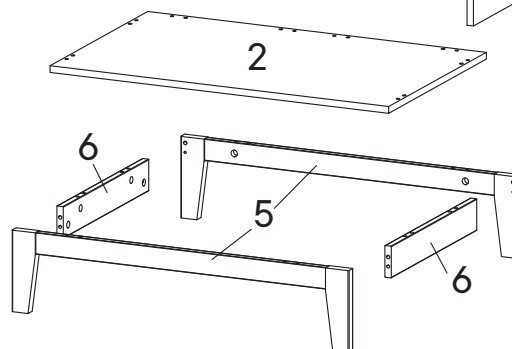
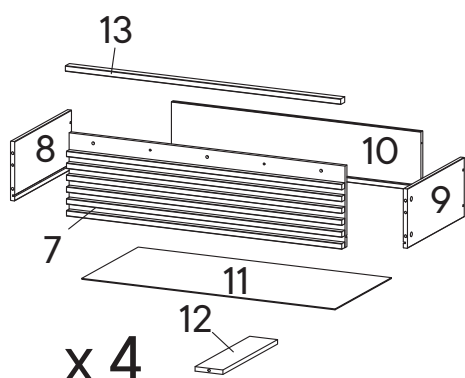
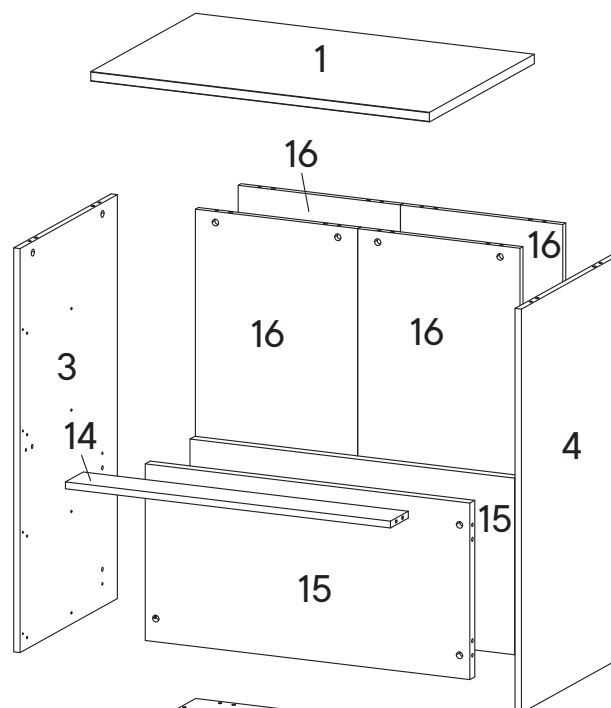

Wait!

Missing parts or hardware? Need assistance?  
Contact us before returning your item. We're here to help!  
609.256.9000 • cs@modway.com

## Provided hardware:

A		Cam Bolt Ø6 x 35 mm	x26	J		Screw M 3.5 x 13 mm	x24
B		Cam Lock Ø15 mm	x26	K		Screw M 8 x 39 mm	x24
C		Cam Lock Ø12 mm	x20	L		Screw M 3.5 x 15.5 mm	x16
D		Wood Dowel Ø8 x 30 mm	x36	M		Wedge	x16
E		Wood Dowel Ø6 x 30 mm	x8	N		Floor Protector	x4
F		Wood Dowel Ø5 x 20 mm	x8	O		Screw M 6.4 x 25 mm	x12
G		Cam Bolt Ø6 x 32 mm	x20	P		Screw M 6 x 10.5 mm	x24
H		Screw M 7 x 50 mm	x8	Q		Wood Dowel Ø8 x 20 mm	x6
I		Allen Key	x2	RM35A		Drawer Runner	x4

## What you need:



## Components Carton Placement

### Carton 1 of 2

Label	Description	Qty
1	Top Board	x1
2	Bottom Board	x1
5	Assembly Leg	x2
7	Front Drawer	x4
13	Handle	x4
14	Support Board	x1
15	Counter Weight Board	x2
	Hardware Pack	x1

### Carton 2 of 2

Label	Description	Qty
3	Side Board Left	x1
4	Side Board Right	x1
6	Bottom Skirt	x2
8	Side Drawer Left	x4
9	Side Drawer Right	x4
10	Back Drawer	x4
11	Bottom Drawer	x4
12	Support Drawer	x4
16	Back Board	x4
	Hardware Pack	x1

# Step 1

## HARDWARE

- E** Wood Dowel Ø6 x 30 mm x8
- F** Wood Dowel Ø5 x 20 mm x8
- G** Cam Bolt Ø6 x 32 mm x20

## COMPONENTS

- 7** Front Drawer x4
- 8** Side Drawer Left x4
- 9** Side Drawer Right x4
- 13** Handle x4

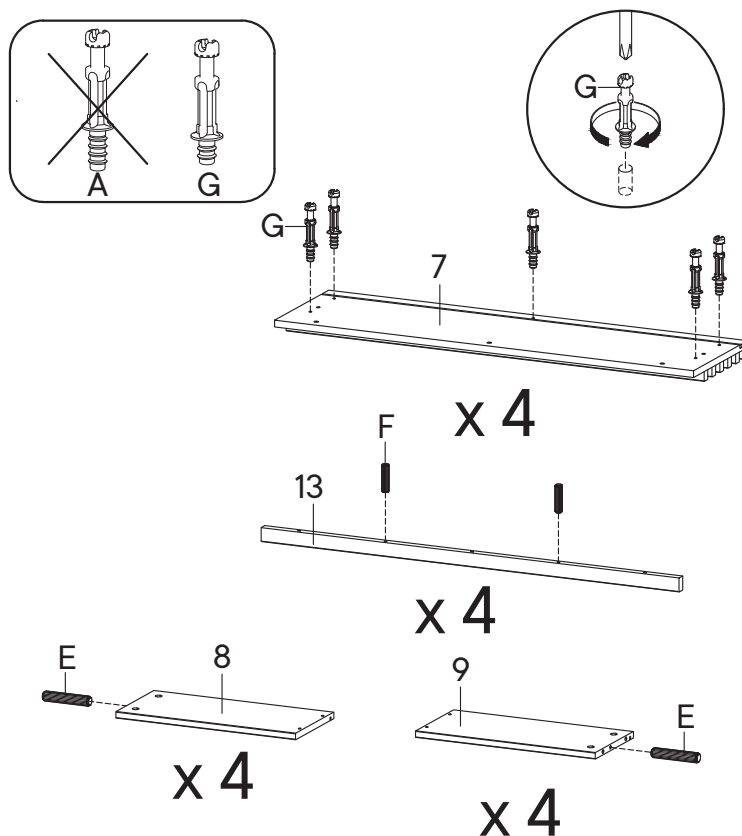

# Step 2

## HARDWARE

- C** Cam Lock Ø12 mm x20
- K** Screw M 8 x 39 mm x24

## COMPONENTS

- 7** Front Drawer x4
- 8** Side Drawer Left x4
- 9** Side Drawer Right x4
- 10** Back Drawer x4
- 11** Bottom Drawer x4
- 12** Support Drawer x4

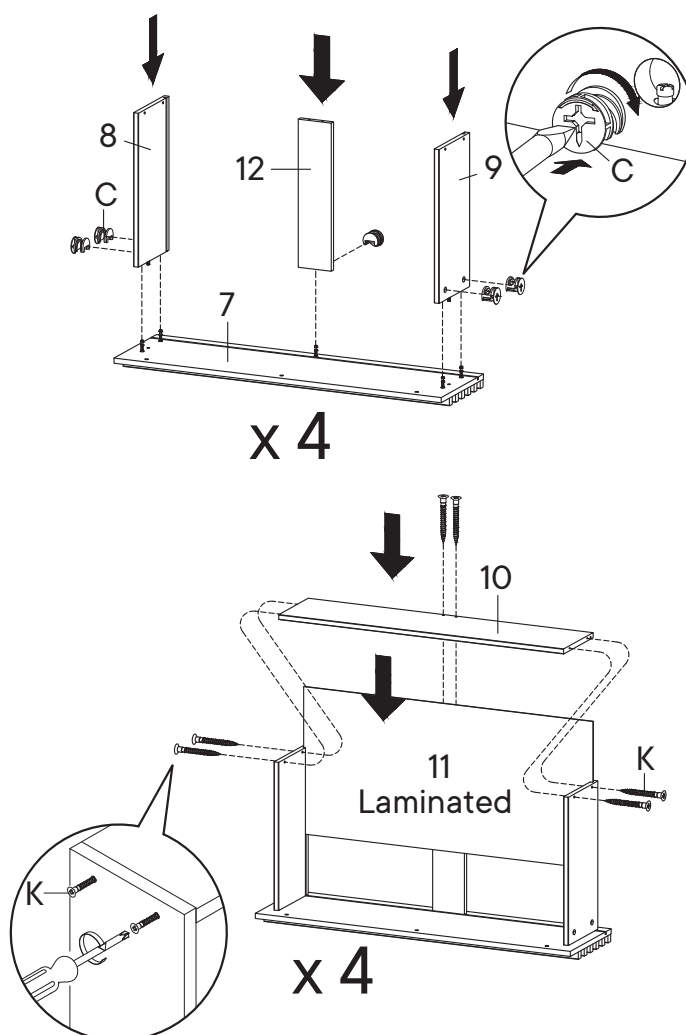

# Step 3

## HARDWARE

<b>J</b>	Screw M 3.5 x 13 mm	x24
<b>L</b>	Screw M 3.5 x 15.5 mm	x16
<b>M</b>	Wedge	x16
<b>RM35A</b>	Drawer Runner	x4

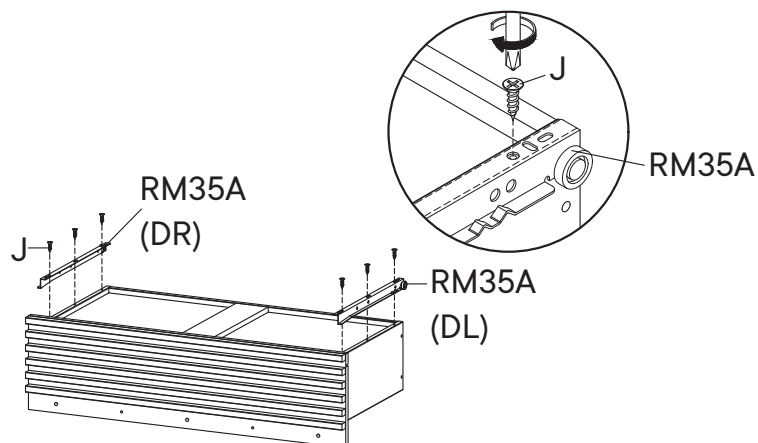

x 4

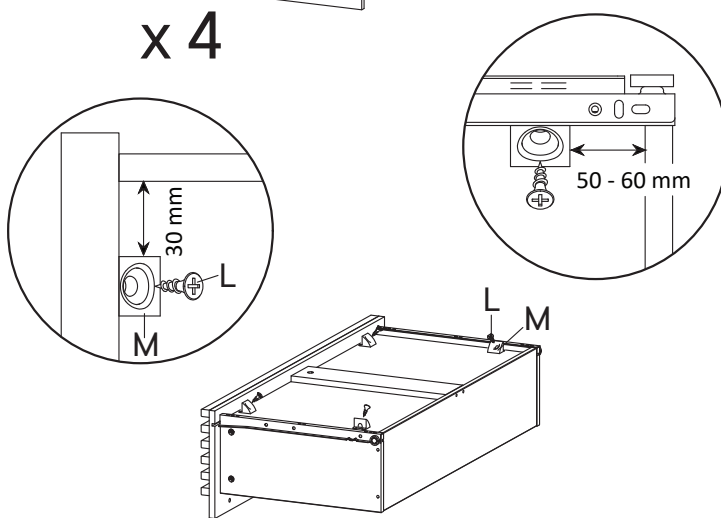
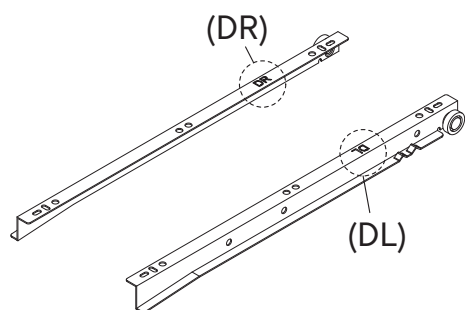

x 4

# Step 4

## HARDWARE

<b>I</b>	Allen Key	x1
<b>O</b>	Screw M 6.4 x 25 mm	x12

## COMPONENTS

<b>13</b>	Handle	x4
-----------	--------	----

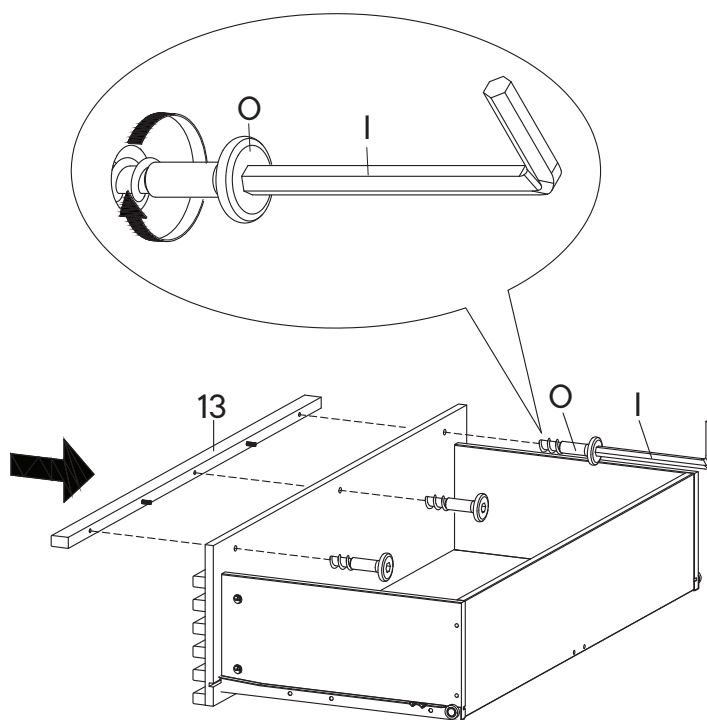

x 4

# Step 5

## HARDWARE

- A** Cam Bolt  $\varnothing 6 \times 35$  mm x14
- D** Wood Dowel  $\varnothing 8 \times 30$  mm x10

## COMPONENTS

- 1** Top Board x1
- 3** Side Board Left x1
- 4** Side Board Right x1
- 14** Support Board x1

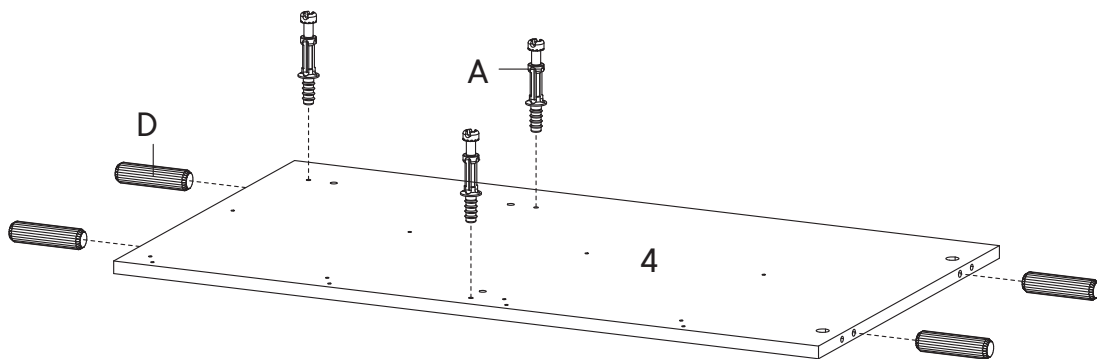
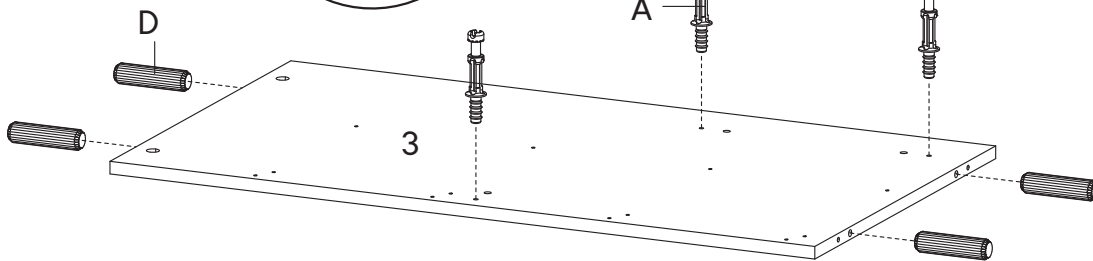
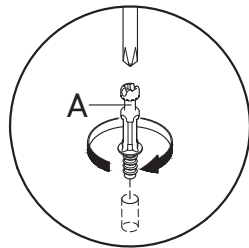
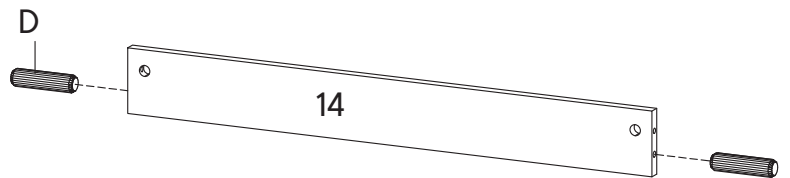
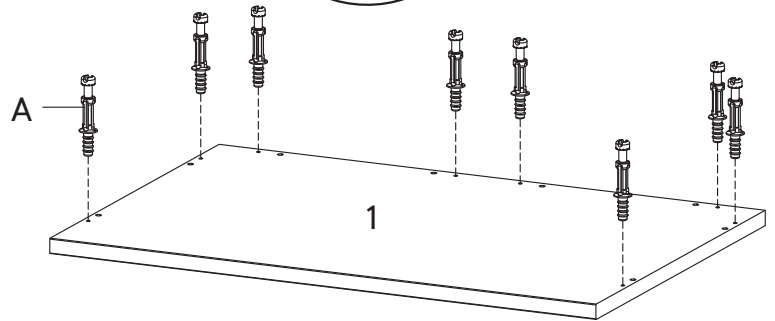
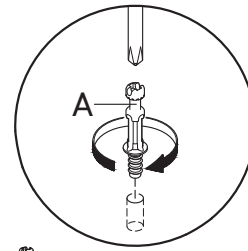

# Step 6

## HARDWARE

**P** Screw M 6 x 10.5 mm x24

**RM35A** Drawer Runner x4

## COMPONENTS

**3** Side Board Left x1

**4** Side Board Right x1

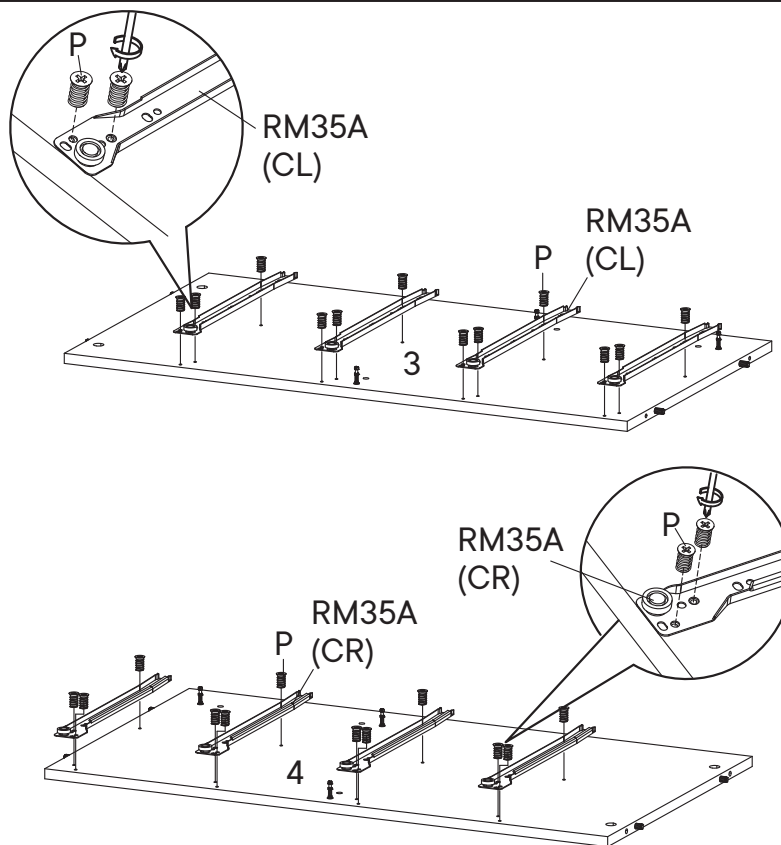
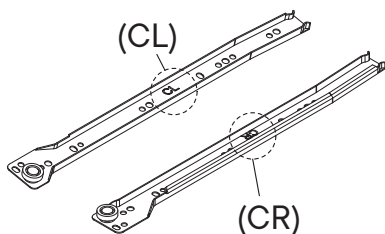

# Step 7

## HARDWARE

**D** Wood Dowel Ø8 x 30 mm x6

## COMPONENTS

**15** Counter Weight Board x2

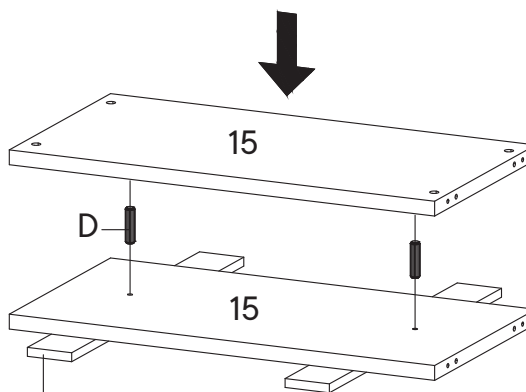

STYROFOAM  
Elevate from floor  
by min 4 cm

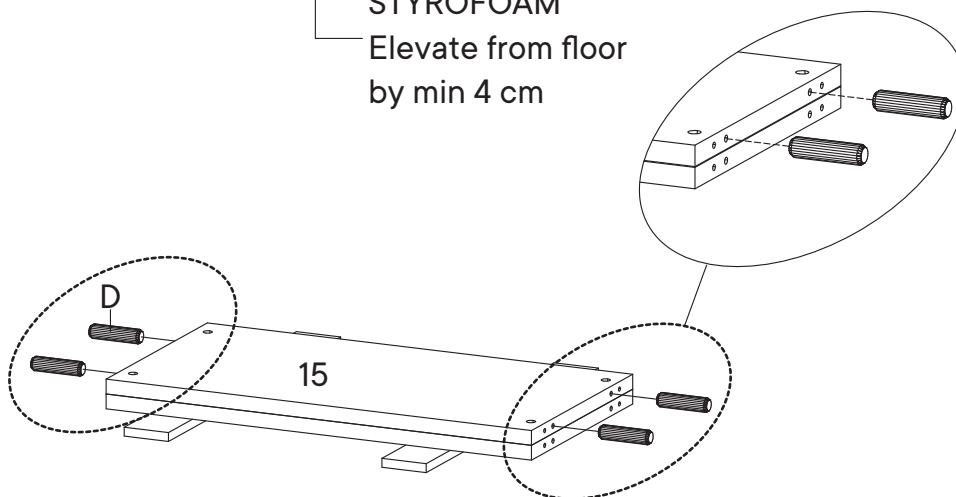
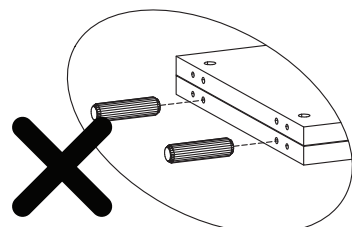
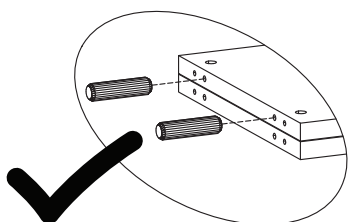

# Step 8

## HARDWARE

- D** Wood Dowel Ø8 x 30 mm x8
- Q** Wood Dowel Ø8 x 20 mm x6

## COMPONENTS

- 16** Back Board x4

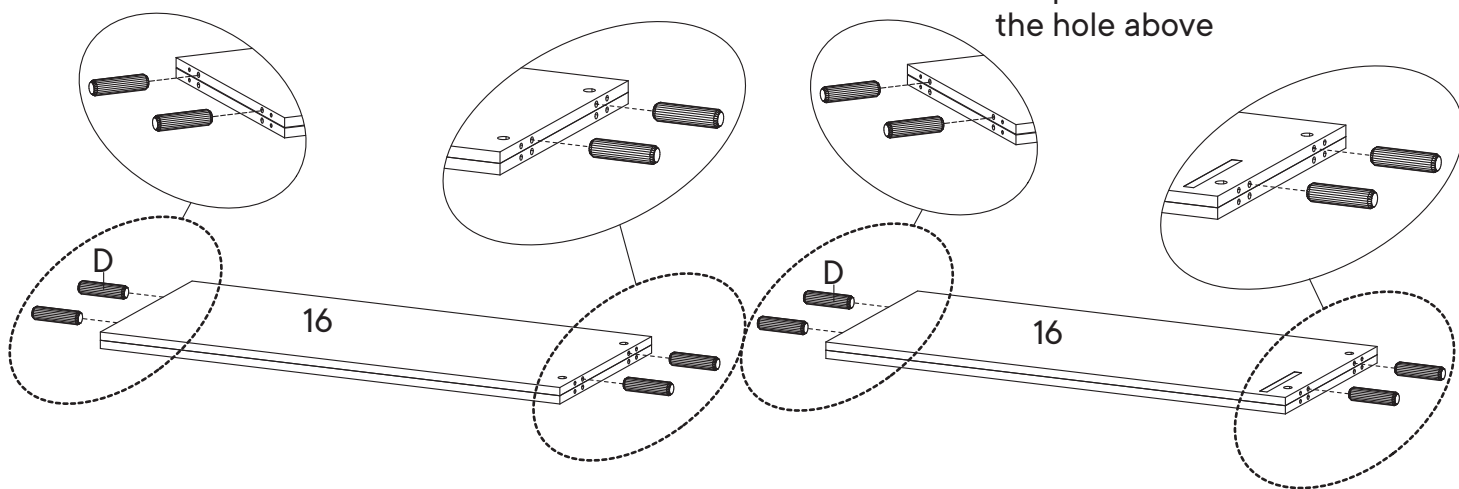
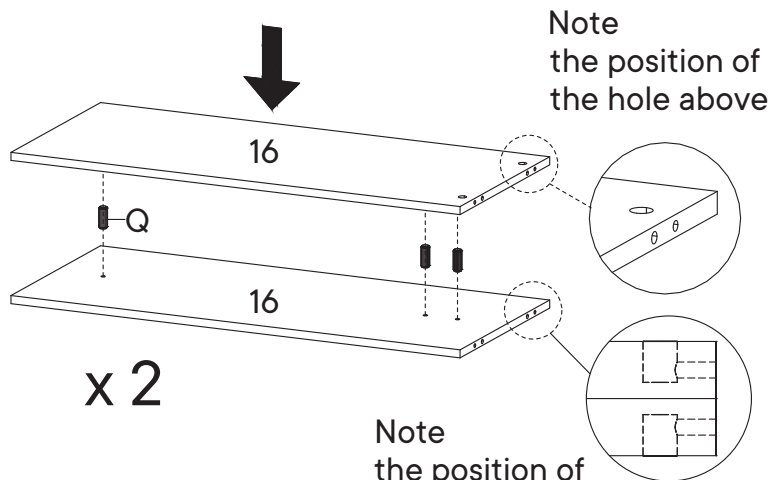

# Step 9

## HARDWARE

- B** Cam Lock Ø15 mm x3

## COMPONENTS

- 3** Side Board Left x1
- 14** Support Board x1
- 15** Counter Weight Board x2

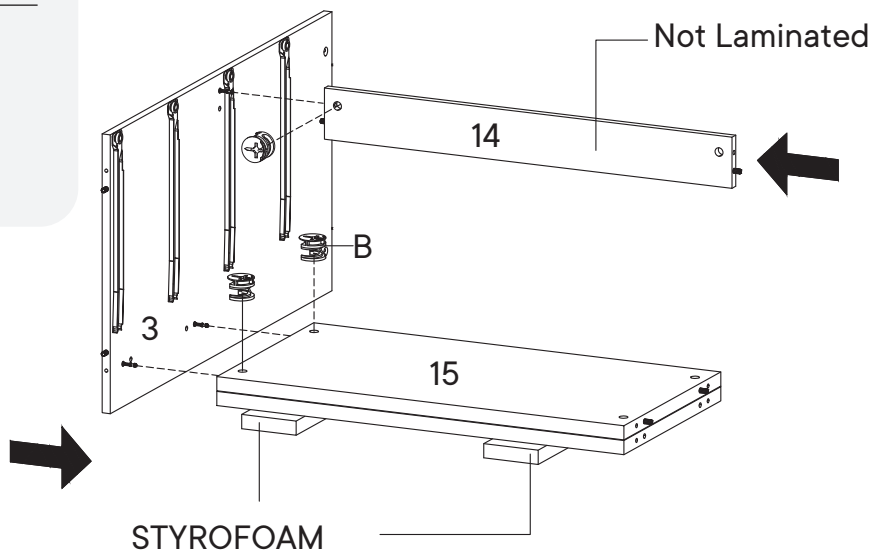
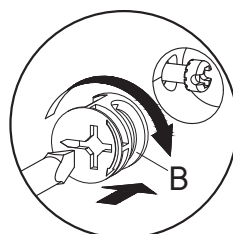

# Step 10

## HARDWARE

**B** Cam Lock Ø15 mm x3

## COMPONENTS

**4** Side Board Right x1

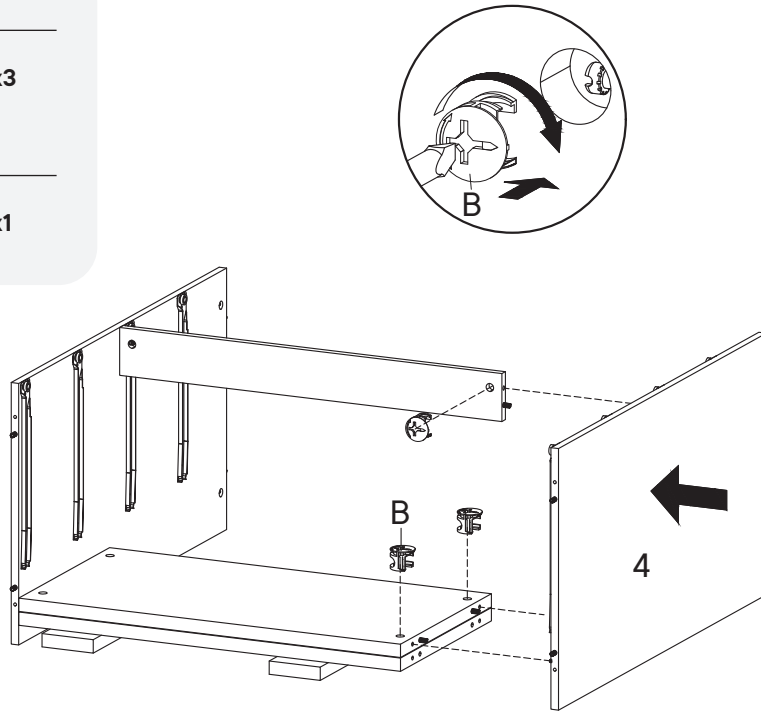

# Step 11

## HARDWARE

**B** Cam Lock Ø15 mm x4

## COMPONENTS

**1** Top Board x1

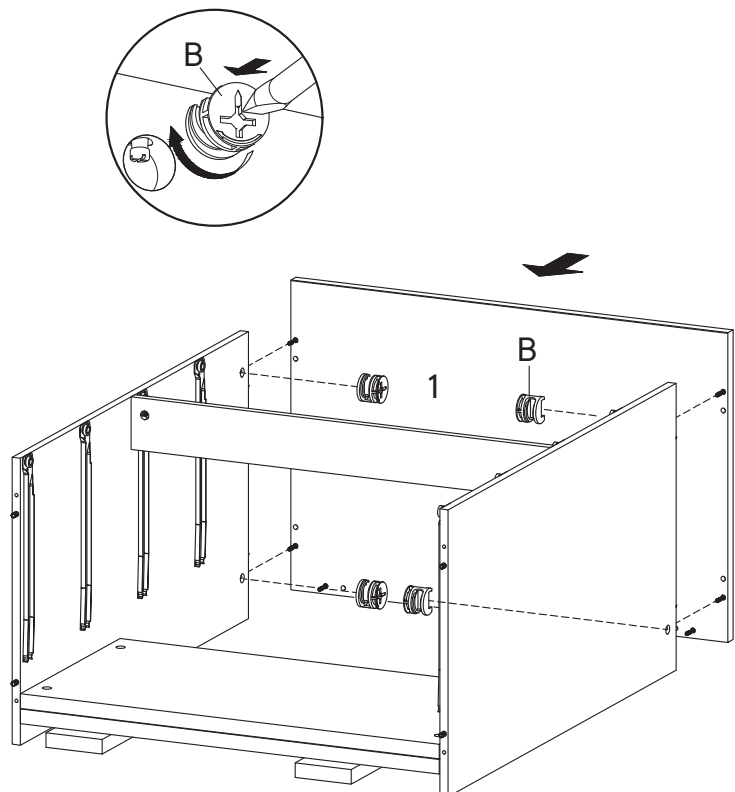

# Step 12

## HARDWARE

**B** Cam Lock Ø15 mm x4

## COMPONENTS

**16** Back Board x4

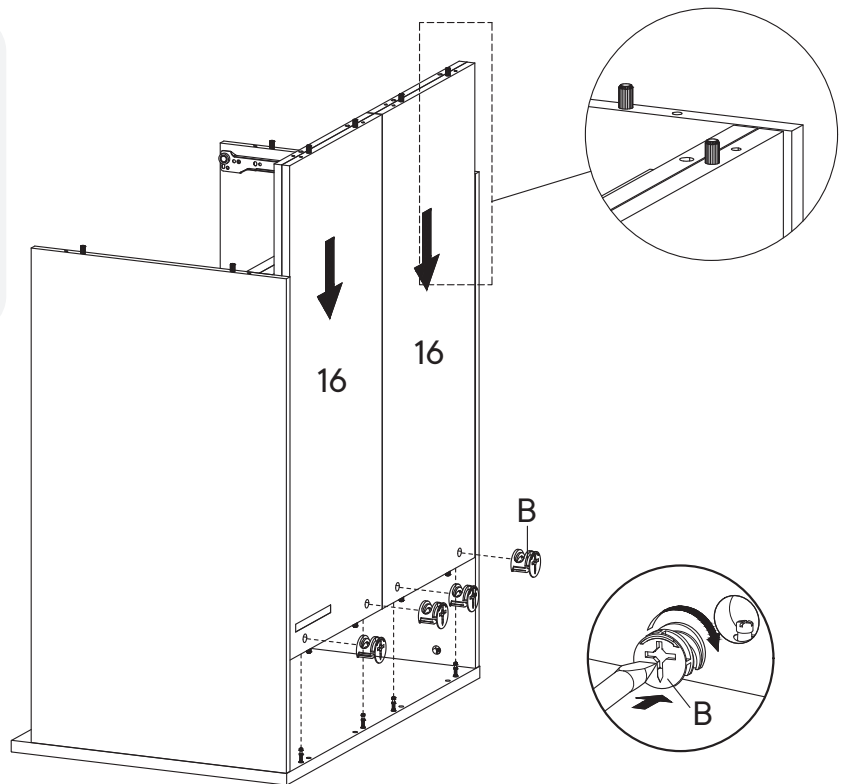

# Step 13

## HARDWARE

**H** Screw M 7 x 50 mm x8

**I** Allen Key x1

## COMPONENTS

**2** Bottom Board x1

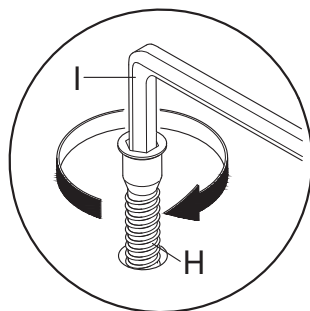
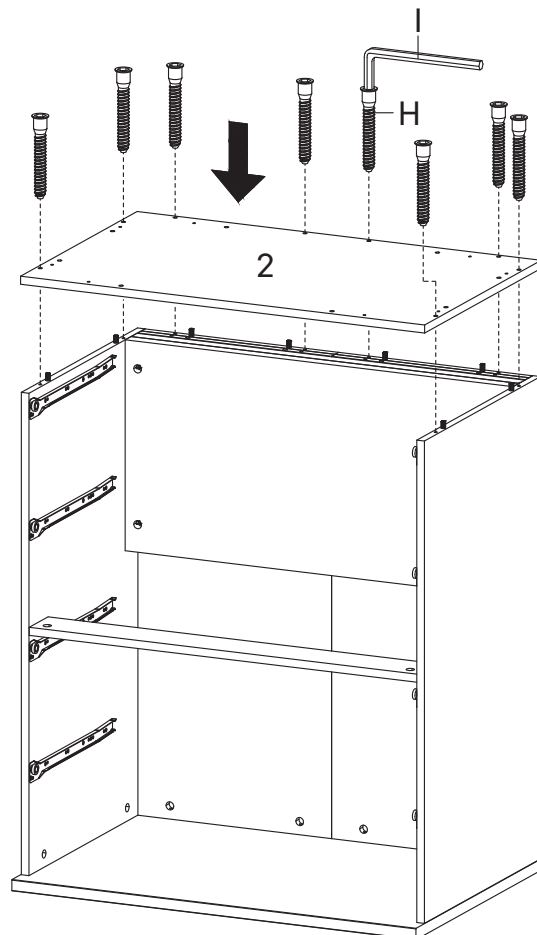

# Step 14

## HARDWARE

- A** Cam Bolt  $\varnothing 6 \times 35$  mm x8

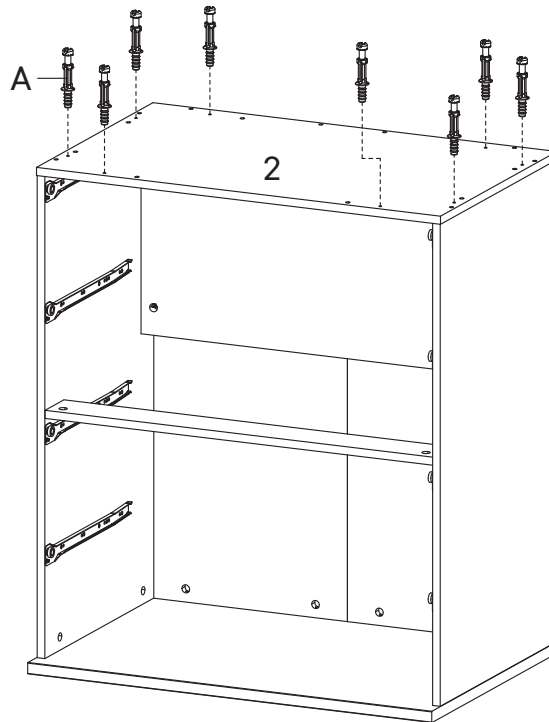
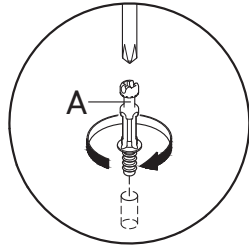

# Step 15

## HARDWARE

- A** Cam Bolt  $\varnothing 6 \times 35$  mm x4
- D** Wood Dowel  $\varnothing 8 \times 30$  mm x4

## COMPONENTS

- 5** Assembly Leg x2
- 6** Bottom Skirt x2

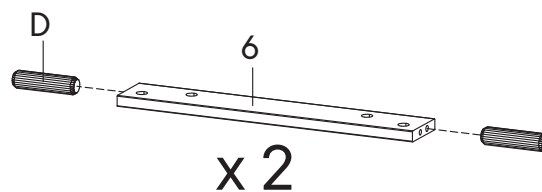
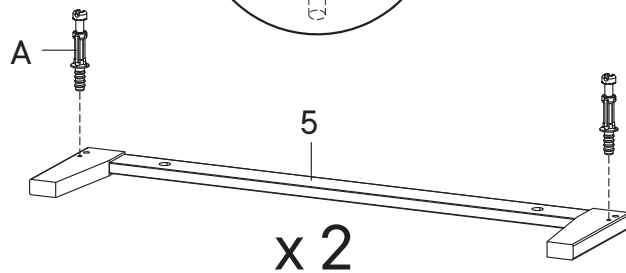
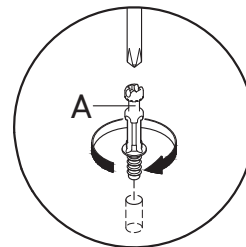

## Step 16

### HARDWARE

**B** Cam Lock  $\varnothing 15$  mm x4

### COMPONENTS

**5** Assembly Leg x2

**6** Bottom Skirt x2

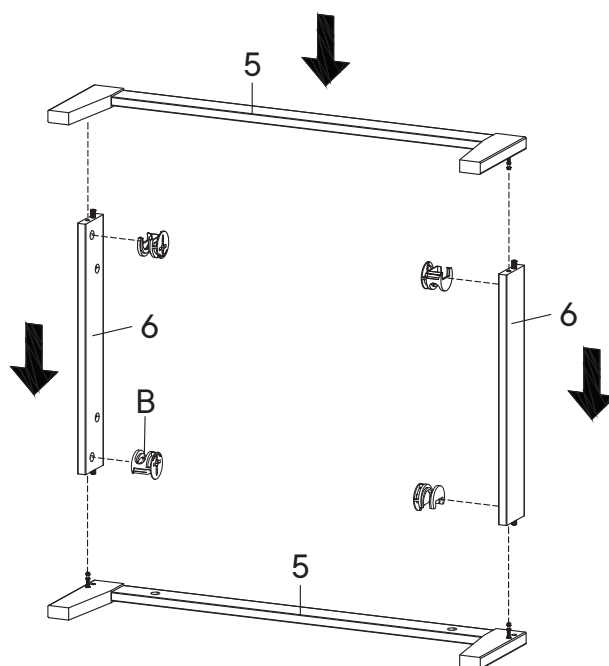
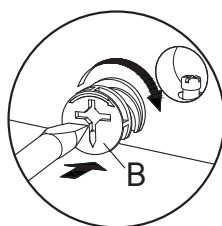

## Step 17

### HARDWARE

**D** Wood Dowel  $\varnothing 8$  x 30 mm x8

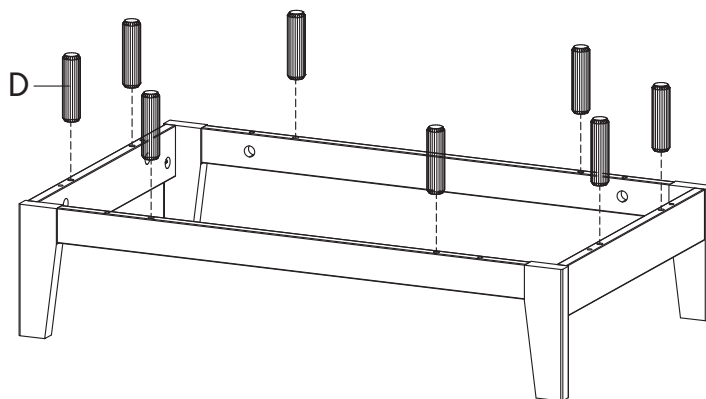

# Step 18

## HARDWARE

- B** Cam Lock Ø15 mm x8
- N** Floor Protector x4

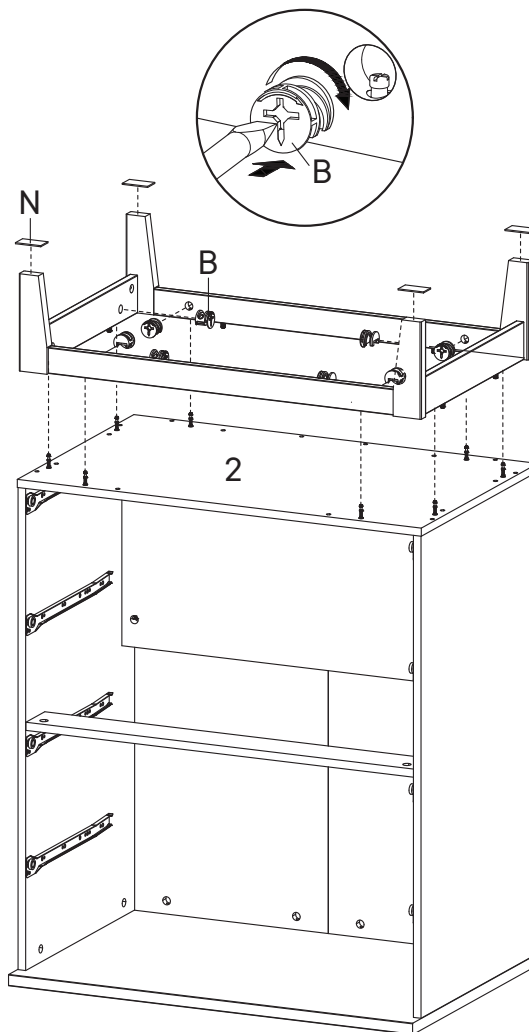
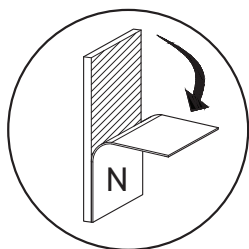

# Step 19

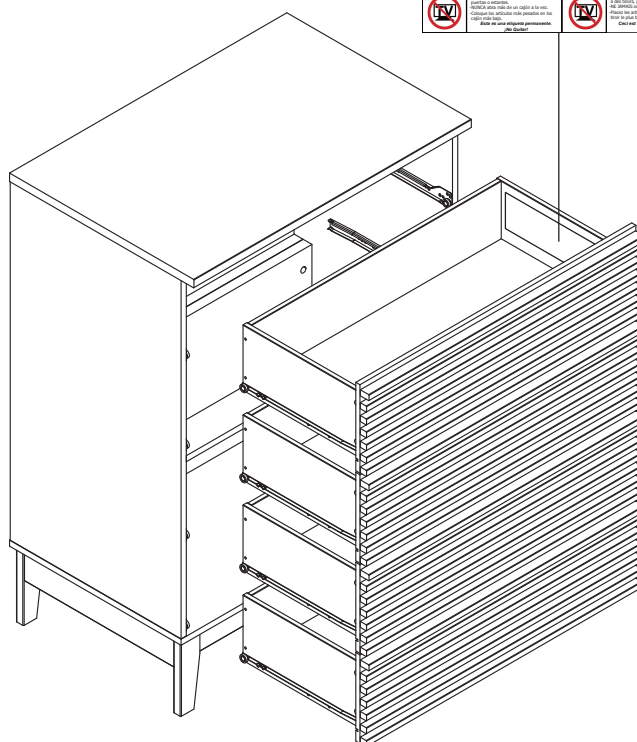
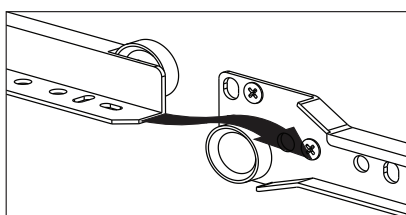

ADVERTENCIA	ATTENTION	WARNING
<p>Las piezas deben ensamblarse correctamente de acuerdo a las instrucciones. Para reducir el riesgo de lesiones de los usuarios:</p> <ul style="list-style-type: none"> <li>● No utilizar el producto como estante para objetos pesados o volátiles.</li> <li>● No utilizar el producto como estante para objetos pesados o volátiles.</li> <li>● No utilizar el producto como estante para objetos pesados o volátiles.</li> <li>● No utilizar el producto como estante para objetos pesados o volátiles.</li> <li>● No utilizar el producto como estante para objetos pesados o volátiles.</li> <li>● No utilizar el producto como estante para objetos pesados o volátiles.</li> </ul>	<p>Les instructions doivent être lues attentivement avant de commencer l'assemblage. Pour réduire le risque de blessures des utilisateurs :</p> <ul style="list-style-type: none"> <li>● Ne pas utiliser le produit comme étagère pour des objets lourds ou instables.</li> <li>● Ne pas utiliser le produit comme étagère pour des objets lourds ou instables.</li> <li>● Ne pas utiliser le produit comme étagère pour des objets lourds ou instables.</li> <li>● Ne pas utiliser le produit comme étagère pour des objets lourds ou instables.</li> <li>● Ne pas utiliser le produit comme étagère pour des objets lourds ou instables.</li> <li>● Ne pas utiliser le produit comme étagère pour des objets lourds ou instables.</li> </ul>	<p>Check the user manual before assembly. To reduce the risk of harmful injuries:</p> <ul style="list-style-type: none"> <li>● Do not use the product as a shelf for heavy or unstable objects.</li> <li>● Do not use the product as a shelf for heavy or unstable objects.</li> <li>● Do not use the product as a shelf for heavy or unstable objects.</li> <li>● Do not use the product as a shelf for heavy or unstable objects.</li> <li>● Do not use the product as a shelf for heavy or unstable objects.</li> <li>● Do not use the product as a shelf for heavy or unstable objects.</li> </ul>

# Great job!

Chest Of Drawers assembly is complete.

## ♥ CARING FOR YOUR ITEM

Indoor use only.

Not contract grade.

Clean using a non-abrasive cloth and a mild cleaner.

Never use harsh chemicals, as they could damage the finish or integrity of the item.

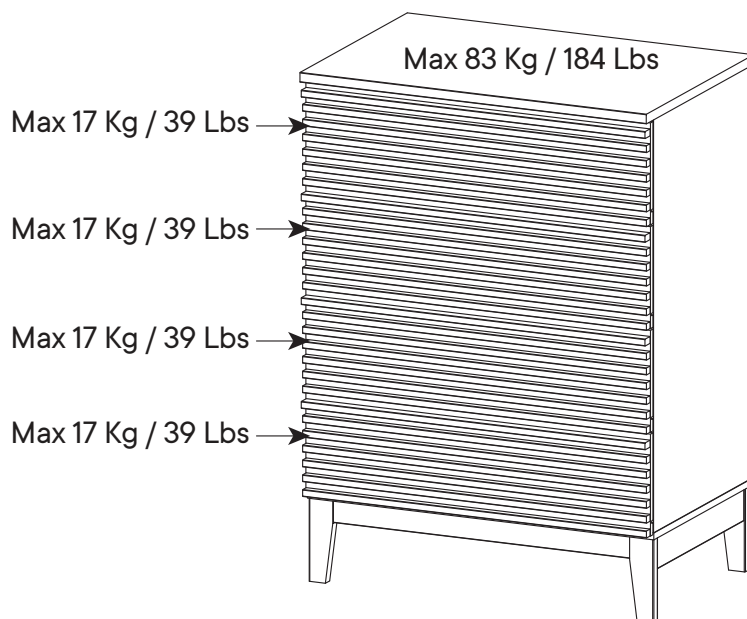

## CONNECT WITH US!

Tag us @modway\_furniture and #modway for a chance to be featured.

## TIPPING RESTRAINTS KIT INSTALLATION GUIDANCE

Different wall materials require unique wall fasteners.

The wall plugs (AA2) and screws (AA3) are designed for fixing to concrete walls only.

Please consult your local hardware store to ensure you are using the correct hardware for you wall type.

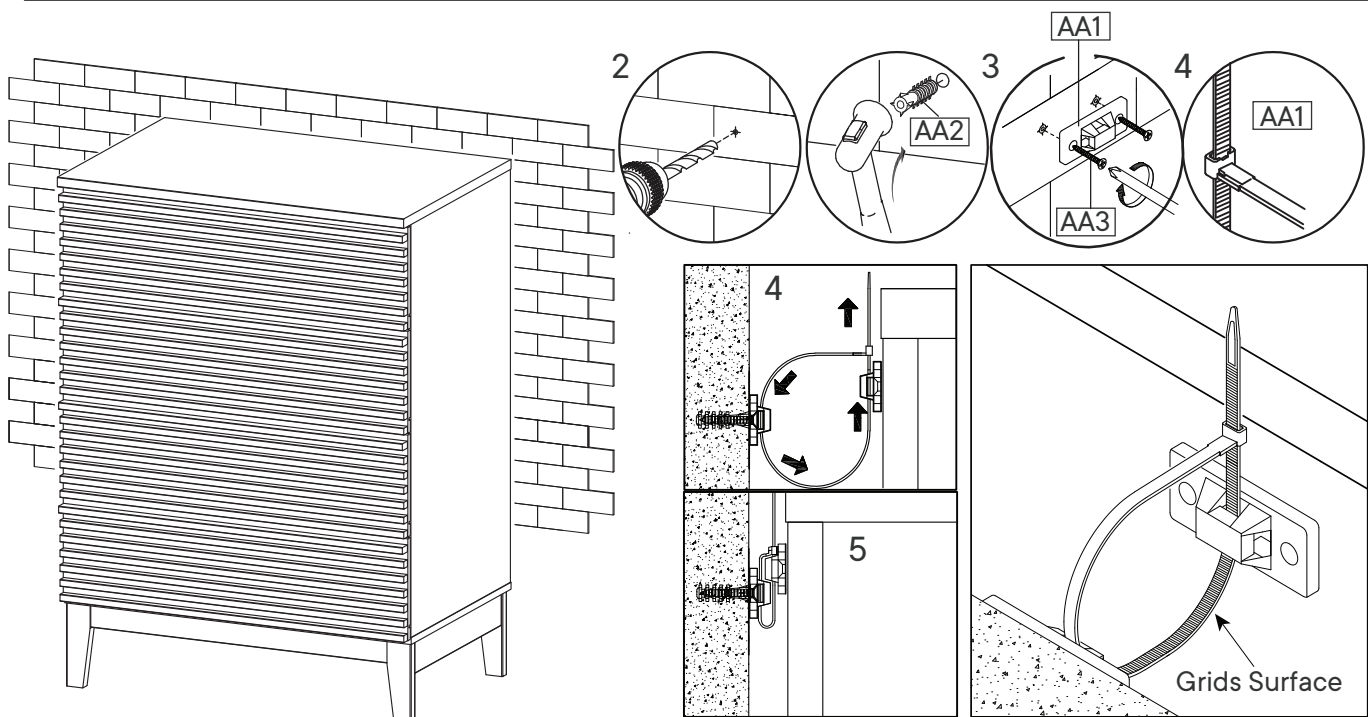
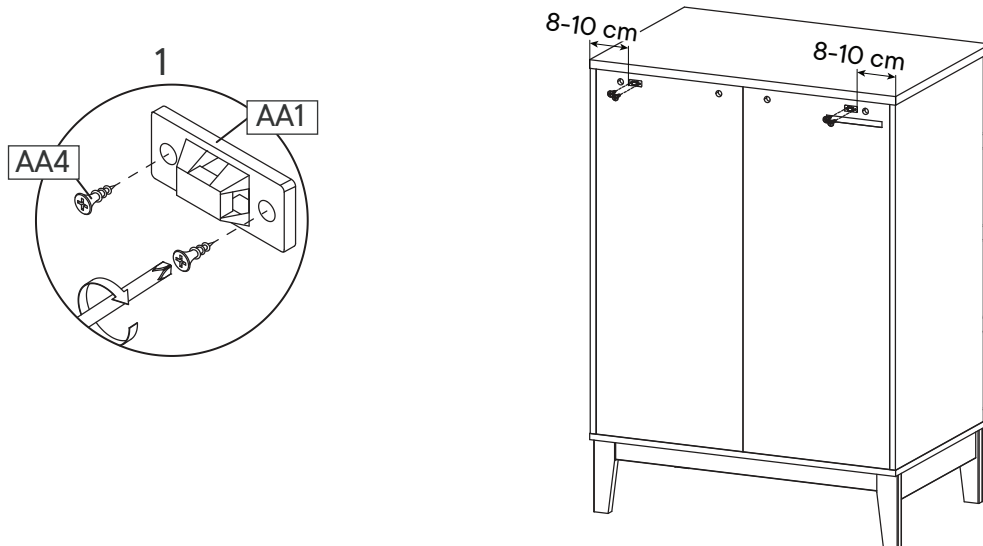
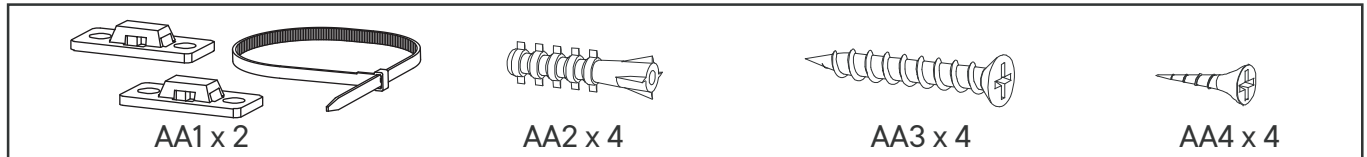

### Installation Instructions :

1. Attach bracket (AA1) securely to the back top of the furniture using screw (AA4) provided. Allow 8 - 10 cm from each side.
2. Please make a hole for wall plugs position on the wall and minimum 15 mm below bracket secured to the back of unit. Attach the wall plugs (AA2).
3. Install the other bracket (AA1) on the wall over wall plugs (AA2), secure with screw (AA3). Place furniture into position so both brackets (AA1) are aligned.
4. Lace the end of the restraints strap through the larger hole in each bracket. Ensure the restraints strap with grids surface facing the inner loops. Bring both ends together and slide the flat end through the locking end and draw it through until all slack is removed.
5. Make sure that the strap is securely laced & locked.