

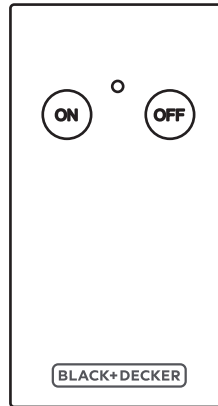

## Indoor Wireless Remote Control Outlet

### INSTRUCTION MANUAL

CATALOG NUMBERS  
BDXPA0001



**Thank you for choosing BLACK+DECKER!**

**PLEASE READ BEFORE RETURNING THIS PRODUCT FOR ANY REASON.**

If you have a question or experience a problem with your BLACK+DECKER purchase, go to <http://www.blackanddeckerelectrical.com>. If you can't find the answer or do not have access to the Internet, call 1-844-746-6688 from 9 a.m. to 5 p.m. EST Mon.-Fri. to speak with an agent. Please have the catalog number available when you call.

**SAVE THIS MANUAL FOR FUTURE REFERENCE.**

ENGLISH

English (*original instructions*)

3

---

Español (*traducido de las instrucciones originales*)

8





---

# Important Safety Guidelines

SAVE THESE INSTRUCTIONS FOR FUTURE REFERENCE.

## Definitions: Safety Alert Symbols and Words

This instruction manual uses the following safety alert symbols and words to alert you to hazardous situations and your risk of personal injury or property damage.

-  **DANGER:** Indicates an imminently hazardous situation which, if not avoided, **will** result in **death or serious injury**.
-  **WARNING:** Indicates a potentially hazardous situation which, if not avoided, **could** result in **death or serious injury**.
-  **CAUTION:** Indicates a potentially hazardous situation which, if not avoided, **may** result in **minor or moderate injury**.
-  (Used without word) Indicates a safety related message.
- NOTICE:** Indicates a practice not related to personal injury which, if not avoided, **may** result in **property damage**.
-  **WARNING:** PLEASE READ THIS INSTRUCTION MANUAL THOROUGHLY AND COMPLETELY BEFORE INSTALLATION & USE. FAILURE TO DO SO COULD CAUSE DAMAGE TO PROPERTY, SERIOUS INJURY OR DEATH, AND VOID YOUR WARRANTY.

 WARNING: Cancer and Reproductive Harm - <a href="http://www.P65Warnings.ca.gov">www.P65Warnings.ca.gov</a> .
 AVERTISSEMENT: Cancer et Troubles de l'appareil reproducteur - <a href="http://www.P65Warnings.ca.gov">www.P65Warnings.ca.gov</a> .
 ADVERTENCIA: Cáncer y Daño Reproductivo - <a href="http://www.P65Warnings.ca.gov">www.P65Warnings.ca.gov</a> .

For California residents / Pour les résidents de la Californie / Para residentes en California

# Indoor Wireless Remote Control Outlet

**⚠ WARNING:** Danger of explosion if battery is incorrectly replaced. When replacing battery, replace it with the same or equivalent type CR2032. Observe correct polarity (+ and -) when replacing batteries. Do not store or carry batteries so that metal objects can contact exposed battery terminals.

**⚠ DANGER:** DO NOT INGEST BATTERY; CHEMICAL BURN HAZARD. This product contains a coin/button cell battery. If the coin/button cell battery is swallowed, it can cause severe internal burns in just 2 hours and can lead to death. Keep new and used batteries away from children. If the battery compartment does not close securely, stop using the product and keep it away from children. If you think batteries might have been swallowed or placed inside any part of the body, seek immediate medical attention.

1. Step A: Locate the battery compartment on the back of the remote.

Push down and away to slide the compartment cover off.

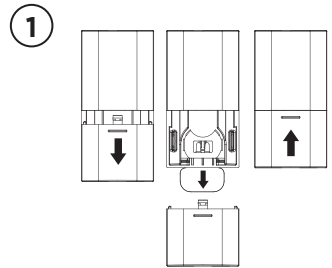

Step B: Remove the plastic battery tab from the battery compartment in the back of the remote control to activate the pre-installed battery.

Step C: Slide the compartment cover on the remote and click securely into place. Your remote is now ready to use.

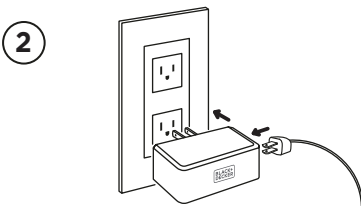

2. Plug the receiver into a standard AC electrical wall socket.  
Plug the appliance into the receiver outlet.

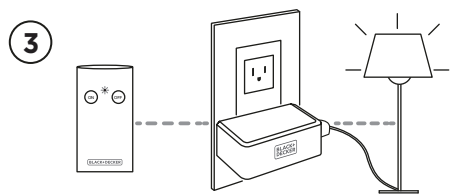

3. To manually control the outlet, press the ON or OFF button on the remote control. Once completed, you can then use the remote control to turn the connected outlet ON/OFF.

## Specifications:

Power input: 125V/60Hz

Power output: 1250W/10A (Max.)

Transmitter frequency: 433.92MHz

Remote transmitter battery: DC CR2032, 3V battery 1pc

Transmission range: up to 100ft

## Indoor Wireless Remote Control Outlet

---

### Remote Battery Replacement:

If operation of the receiver unit becomes erratic, it may be necessary to replace the battery in the hand-held remote unit. To do this, first remove the battery compartment cover. Press the tray release button on the back of the remote. Next, remove the depleted battery and discard according to local ordinances. Be sure to correctly install the new battery. Replace battery compartment cover and test by using it to control the indoor remote control outlet.

### **▲ CAUTION:**

1. Appliances to be connected to the remote control socket **MUST NOT** exceed the voltage and current ratings as in "Specifications".
2. Operation is subject to the following two conditions:
  - (1) this appliance may not cause harmful interference, (2) this appliance must accept any interference received, including interference that may cause undesired operation.
3. Only for indoor use and storage.
4. Low transmitter battery may lower the distance between the transmitter and the receiver.

# Indoor Wireless Remote Control Outlet

---

## Double Insulation

Double insulated appliances are constructed throughout with two separate layers of electrical insulation or one single layer of reinforced insulation between the user and the appliance's electrical system. Products built with this insulation system are not intended to be grounded. As a result, this appliance is equipped with a two-prong plug which permits it to be used without concern for maintaining a ground connection.

**NOTE:** Double insulation does not take the place of normal safety precautions when operating this appliance. The secondary insulation system is for protection against injury resulting from a possible failure of the primary insulation within the product.

**⚠ CAUTION:** WHEN SERVICING USE ONLY IDENTICAL REPLACEMENT PARTS.  
Repair or replace damaged cords.

## Polarized Plugs

Polarized plugs (one blade is wider than the other) are used on equipment to reduce the risk of electric shock. When provided, this plug will fit in the polarized outlet only one way.

**⚠ WARNING:** Do not alter the plug in any way. If the plug does not fit fully in the outlet, reverse the plug. If it still does not fit, contact a qualified electrician to install the proper outlet.

**⚠ WARNING:** A grounded appliance with an adaptor is not recommended.

# Indoor Wireless Remote Control Outlet

---

## 1 YEAR LIMITED WARRANTY

**IMPORTANT: Proof of Purchase is required to obtain warranty service.**

Paragon Group USA Inc. warrants to the original owner that our products will be free from defect in workmanship and material for a period of ONE YEAR from the date of purchase. Should any unit(s) prove to be defective during this period, Paragon Group USA Inc. will be responsible for replacement of the defective unit(s) only. Paragon Group USA Inc. is not responsible for labor charges or any incidental or consequential expenses.

Not Covered – Batteries are not covered by this warranty. Repair service, adjustment and calibration due to misuse, abuse or negligence are not covered by this warranty. Unauthorized service or modification to this product or of any furnished components will void this warranty in its entirety.

This warranty does not include reimbursement for inconvenience, installation, set-up time, loss of use, postage, unauthorized service, or other products used in conjunction with **BLACK+DECKER** products.

**Copyright©2021 Black&Decker  
BLACK+DECKER and the BLACK+DECKER Logo are  
trademarks of Stanley Black Decker, Inc. or  
an affiliate thereof and are used under license.**

Ph: 1-844-746-6688  
www.blackanddeckerelectrical.com  
E-mail: info@blackanddeckerelectrical.com

Imported by:  
Paragon Group USA,  
Englewood, NJ, 07631  
USA



## Indoor Wireless Remote Control Outlet

### INSTRUCTION MANUAL

CATALOG NUMBERS  
BDXPA0001

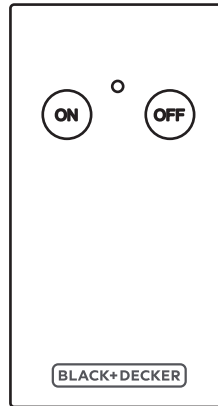

**Thank you for choosing BLACK+DECKER!**

**PLEASE READ BEFORE RETURNING THIS PRODUCT FOR ANY REASON.**

If you have a question or experience a problem with your BLACK+DECKER purchase, go to <http://www.blackanddeckerelectrical.com>. If you can't find the answer or do not have access to the Internet, call 1-844-746-6688 from 9 a.m. to 5 p.m. EST Mon.-Fri. to speak with an agent. Please have the catalog number available when you call.

**SAVE THIS MANUAL FOR FUTURE REFERENCE.**



ENGLISH

English (*original instructions*)

3

---

Español (*traducido de las instrucciones originales*)

8





---

# Important Safety Guidelines

SAVE THESE INSTRUCTIONS FOR FUTURE REFERENCE.

## Definitions: Safety Alert Symbols and Words

This instruction manual uses the following safety alert symbols and words to alert you to hazardous situations and your risk of personal injury or property damage.

-  **DANGER:** Indicates an imminently hazardous situation which, if not avoided, **will** result in **death or serious injury**.
-  **WARNING:** Indicates a potentially hazardous situation which, if not avoided, **could** result in **death or serious injury**.
-  **CAUTION:** Indicates a potentially hazardous situation which, if not avoided, **may** result in **minor or moderate injury**.
-  (Used without word) Indicates a safety related message.
- NOTICE:** Indicates a practice not related to personal injury which, if not avoided, **may** result in **property damage**.
-  **WARNING:** PLEASE READ THIS INSTRUCTION MANUAL THOROUGHLY AND COMPLETELY BEFORE INSTALLATION & USE. FAILURE TO DO SO COULD CAUSE DAMAGE TO PROPERTY, SERIOUS INJURY OR DEATH, AND VOID YOUR WARRANTY.

 WARNING: Cancer and Reproductive Harm - <a href="http://www.P65Warnings.ca.gov">www.P65Warnings.ca.gov</a> .
 AVERTISSEMENT: Cancer et Troubles de l'appareil reproducteur - <a href="http://www.P65Warnings.ca.gov">www.P65Warnings.ca.gov</a> .
 ADVERTENCIA: Cáncer y Daño Reproductivo - <a href="http://www.P65Warnings.ca.gov">www.P65Warnings.ca.gov</a> .

For California residents / Pour les résidents de la Californie / Para residentes en California

# Indoor Wireless Remote Control Outlet

**⚠ WARNING:** Danger of explosion if battery is incorrectly replaced. When replacing battery, replace it with the same or equivalent type CR2032. Observe correct polarity (+ and -) when replacing batteries. Do not store or carry batteries so that metal objects can contact exposed battery terminals.

**⚠ DANGER:** DO NOT INGEST BATTERY; CHEMICAL BURN HAZARD. This product contains a coin/button cell battery. If the coin/button cell battery is swallowed, it can cause severe internal burns in just 2 hours and can lead to death. Keep new and used batteries away from children. If the battery compartment does not close securely, stop using the product and keep it away from children. If you think batteries might have been swallowed or placed inside any part of the body, seek immediate medical attention.

1. Step A: Locate the battery compartment on the back of the remote.

Push down and away to slide the compartment cover off.

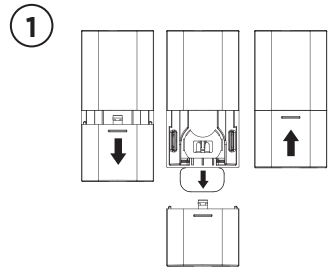

Step B: Remove the plastic battery tab from the battery compartment in the back of the remote control to activate the pre-installed battery.

Step C: Slide the compartment cover on the remote and click securely into place. Your remote is now ready to use.

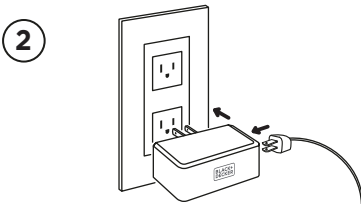

2. Plug the receiver into a standard AC electrical wall socket.  
Plug the appliance into the receiver outlet.

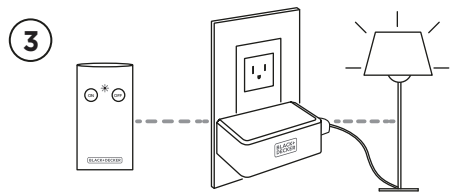

3. To manually control the outlet, press the ON or OFF button on the remote control. Once completed, you can then use the remote control to turn the connected outlet ON/OFF.

## Specifications:

Power input: 125V/60Hz

Power output: 1250W/10A (Max.)

Transmitter frequency: 433.92MHz

Remote transmitter battery: DC CR2032, 3V battery 1pc

Transmission range: up to 100ft

## Indoor Wireless Remote Control Outlet

---

### Remote Battery Replacement:

If operation of the receiver unit becomes erratic, it may be necessary to replace the battery in the hand-held remote unit. To do this, first remove the battery compartment cover. Press the tray release button on the back of the remote. Next, remove the depleted battery and discard according to local ordinances. Be sure to correctly install the new battery. Replace battery compartment cover and test by using it to control the indoor remote control outlet.

### **▲ CAUTION:**

1. Appliances to be connected to the remote control socket **MUST NOT** exceed the voltage and current ratings as in "Specifications".
2. Operation is subject to the following two conditions:
  - (1) this appliance may not cause harmful interference, (2) this appliance must accept any interference received, including interference that may cause undesired operation.
3. Only for indoor use and storage.
4. Low transmitter battery may lower the distance between the transmitter and the receiver.

# Indoor Wireless Remote Control Outlet

---

## Double Insulation

Double insulated appliances are constructed throughout with two separate layers of electrical insulation or one single layer of reinforced insulation between the user and the appliance's electrical system. Products built with this insulation system are not intended to be grounded. As a result, this appliance is equipped with a two-prong plug which permits it to be used without concern for maintaining a ground connection.

**NOTE:** Double insulation does not take the place of normal safety precautions when operating this appliance. The secondary insulation system is for protection against injury resulting from a possible failure of the primary insulation within the product.

**⚠ CAUTION:** WHEN SERVICING USE ONLY IDENTICAL REPLACEMENT PARTS.  
Repair or replace damaged cords.

## Polarized Plugs

Polarized plugs (one blade is wider than the other) are used on equipment to reduce the risk of electric shock. When provided, this plug will fit in the polarized outlet only one way.

**⚠ WARNING:** Do not alter the plug in any way. If the plug does not fit fully in the outlet, reverse the plug. If it still does not fit, contact a qualified electrician to install the proper outlet.

**⚠ WARNING:** A grounded appliance with an adaptor is not recommended.

# Indoor Wireless Remote Control Outlet

---

## 1 YEAR LIMITED WARRANTY

**IMPORTANT: Proof of Purchase is required to obtain warranty service.**

Paragon Group USA Inc. warrants to the original owner that our products will be free from defect in workmanship and material for a period of ONE YEAR from the date of purchase. Should any unit(s) prove to be defective during this period, Paragon Group USA Inc. will be responsible for replacement of the defective unit(s) only. Paragon Group USA Inc. is not responsible for labor charges or any incidental or consequential expenses.

Not Covered – Batteries are not covered by this warranty. Repair service, adjustment and calibration due to misuse, abuse or negligence are not covered by this warranty. Unauthorized service or modification to this product or of any furnished components will void this warranty in its entirety.

This warranty does not include reimbursement for inconvenience, installation, set-up time, loss of use, postage, unauthorized service, or other products used in conjunction with **BLACK+DECKER** products.

**Copyright©2021 Black&Decker  
BLACK+DECKER and the BLACK+DECKER Logo are  
trademarks of Stanley Black Decker, Inc. or  
an affiliate thereof and are used under license.**

Ph: 1-844-746-6688  
www.blackanddeckerelectrical.com  
E-mail: info@blackanddeckerelectrical.com

Imported by:  
Paragon Group USA,  
Englewood, NJ, 07631  
USA

# BLACK+ DECKER®

## Tomacorriente con control remoto inalámbrico para interiores MANUAL DE INSTRUCCIONES

NÚMEROS DE CATÁLOGO  
BDXPA0001

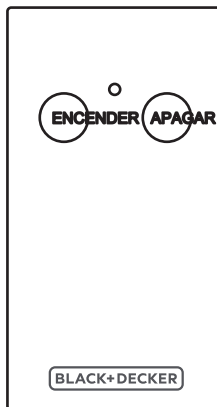

**¡Gracias por elegir BLACK+ DECKER!**

**LEA ANTES DE DEVOLVER ESTE PRODUCTO POR CUALQUIER RAZÓN.**

Si tiene alguna pregunta o problema con su compra de BLACK+DECKER, diríjase a <http://www.blackanddeckerelectrical.com>.

Si no puede encontrar la respuesta o no tiene acceso a internet, llame al 1-844-746-6688 de 9 a. m. a 5 p. m. (EST), de lunes a viernes para hablar con un agente. Tenga a mano el número de catálogo cuando llame.

**CONSERVE ESTE MANUAL PARA REFERENCIA FUTURA.**

ESPAÑOL

English (*original instructions*)

3

---

Español (traducido de las instrucciones originales)

8

---











# Guía de seguridad importante

CONSERVE ESTAS INSTRUCCIONES PARA REFERENCIA FUTURA.

## Definiciones: Símbolos y palabras de alerta de seguridad

Este manual de instrucciones utiliza los siguientes símbolos y palabras de alerta de seguridad para alertarlo de situaciones peligrosas y del riesgo de lesiones personales o daño a la propiedad.

-  **PELIGRO:** Indica una situación peligrosa inminente que, si no se evita, resultará en la muerte o en una lesión grave.
-  **ADVERTENCIA:** Indica una situación peligrosa potencial que, si no se evita, podría resultar en la muerte o en una lesión grave.
-  **PRECAUCIÓN:** Indica una situación peligrosa potencial que, si no se evita, es posible que resulte una lesión menor o moderada.
-  (Utilizado sin palabra) Indica un mensaje relacionado con la seguridad.
-  **AVISO:** Indica una práctica no relacionada con una lesión personal que, si no se evita, es posible que resulte en **daño a la propiedad**.
  
-  **ADVERTENCIA:** LEA ESTE MANUAL DE INSTRUCCIONES MINUCIOSA Y COMPLETAMENTE ANTES DE LA INSTALACIÓN Y EL USO. EN CASO DE QUE NO LO HAGA PODRÍA CAUSAR DAÑO A LA PROPIEDAD, LESIONES GRAVES O LA MUERTE, Y DEJAR SIN EFECTO LA GARANTÍA.

 WARNING: Cancer and Reproductive Harm <a href="http://www.P65Warnings.ca.gov">www.P65Warnings.ca.gov</a>
 AVERTISSEMENT: Cancer et Troubles de l'appareil reproducteur - <a href="http://www.P65Warnings.ca.gov">www.P65Warnings.ca.gov</a>
 ADVERTENCIA: Cáncer y Daño Reproductivo <a href="http://www.P65Warnings.ca.gov">www.P65Warnings.ca.gov</a>

For California residents/Pour les résidents de la Californie/Para residentes en California

# Tomacorriente con control remoto inalámbrico para interiores

**⚠️ ADVERTENCIA:** Peligro de explosión si se pone mal la batería. Cuando cambie la batería, reemplácela con el mismo tipo o un tipo equivalente a CR2032. Observe que la polaridad (+ y -) sea la correcta cuando la cambie. No guarde o traslade las baterías de manera que los objetos metálicos puedan entrar en contacto con las terminales expuestas de dicha batería.

**⚠️ PELIGRO:** NO INGIERA LA BATERÍA; PELIGRO DE QUEMADURA QUÍMICA. Este producto contiene una batería tipo botón. Si se traga la batería tipo botón, puede causar quemaduras internas graves en solo dos horas y esto puede llevar a la muerte. Mantenga las baterías nuevas y las usadas fuera del alcance de los niños. Si el compartimiento de la batería no cierra de forma segura, deje de usar el producto y manténgalo fuera del alcance de los niños.

Si cree que alguien podría haberse tragado las baterías o que podría haberlas puesto dentro de alguna parte del cuerpo, busque atención médica de inmediato.

- Paso A:** Ubique el compartimiento de la batería en la parte posterior del control remoto. Presione hacia abajo y hacia afuera para sacar la tapa del compartimiento deslizándola.  
**Paso B:** Quite la pestaña de plástico del compartimiento de la batería en la parte posterior del control remoto para activar la batería que viene instalada.  
**Paso C:** Deslice la tapa del compartimiento del control remoto hasta que haga "clic" en el lugar correcto. Su control remoto está listo para ser usado.

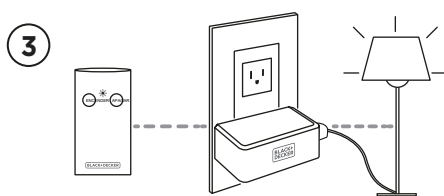
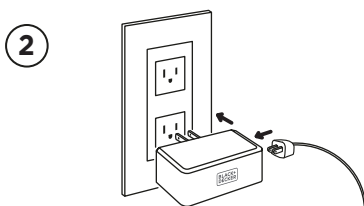
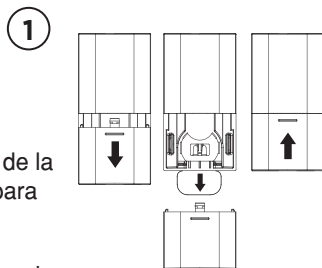

- 2.** Enchufe el receptor en una toma eléctrica de pared estándar de CA. Enchufe el aparato en el tomacorriente del receptor.

- 3.** Para controlar de forma manual el tomacorriente, presione el botón ON (encendido) u OFF (apagado) del control remoto. Una vez que haya finalizado, puede usar el control remoto para ENCENDER/APAGAR el tomacorriente conectado.

## Especificaciones:

Alimentación de corriente eléctrica: 125 V/60 Hz

Salida de corriente eléctrica: 1250 W/10 A (Máx.)

Frecuencia del transmisor: 433.92 MHz

Batería del transmisor con control remoto: Una batería DC CR2032, 3 V

Rango de transmisión: hasta 100 ft (30 m)

# **Tomacorriente con control remoto inalámbrico para interiores**

---

## **Reemplazo De La Batería Del Control Remoto:**

Si falla el funcionamiento de la unidad receptora, es posible que tenga que reemplazar la batería de la unidad portátil del control remoto. Para hacer esto, primero quite la tapa del compartimiento de la batería. Presione el botón para liberar la bandeja de la parte posterior del control remoto. Luego, quite la batería agotada y deséchela conforme a las normas locales. Asegúrese de instalar la batería nueva de forma correcta. Vuelva a poner la tapa del compartimiento de la batería y pruebe el control usándolo para controlar el tomacorriente con control remoto para interiores.

### **▲ PRECAUCIÓN:**

1. Los aparatos que se vayan a conectar a la toma del control remoto **NO DEBEN** exceder las clasificaciones de voltaje y corriente mencionados en "Especificaciones".
2. Su funcionamiento está sujeto a las siguientes dos condiciones:
  - (1) Este aparato no puede causar interferencia dañina; y (2) este aparato debe aceptar cualquier interferencia recibida, lo que incluye interferencia que puede causar un funcionamiento indeseado.
3. Únicamente para uso y almacenamiento en interiores.
4. Si el transmisor tiene poca batería, puede disminuir la distancia entre el transmisor y el receptor.

# **Tomacorriente con control remoto inalámbrico para interiores**

---

## **Doble aislamiento**

Los aparatos con doble aislamiento se construyen con dos capas separadas de aislamiento eléctrico o una única capa de aislamiento reforzado entre el usuario y el sistema eléctrico del aparato. Los productos construidos con este sistema de aislamiento no están creados para tener conexión a tierra. En consecuencia, este aparato está equipado con un enchufe de dos clavijas que permite usarlo sin tener la preocupación de la conexión a tierra.

**NOTA:** El doble aislamiento no reemplaza las precauciones de seguridad normales cuando se lo utiliza. El sistema de aislamiento secundario es para la protección contra lesiones causadas por una posible falla del aislamiento principal dentro del producto.

**⚠ PRECAUCIÓN:** UTILICE SOLO PARTES DE REPUESTO IDÉNTICAS EN LA REPARACIÓN. Repare o reemplace los cables dañados.

## **Enchufes polarizados**

Los enchufes polarizados (una clavija es más ancha que la otra) se utilizan en el equipo para reducir el riesgo de descarga eléctrica. Cuando se brinde este tipo de enchufe, entrará en el tomacorriente polarizado únicamente de una manera.

**⚠ ADVERTENCIA:** No modifique el enchufe de ninguna forma. Si el enchufe no entra completamente en el tomacorriente, delo vuelta. Si aun así no entra, comuníquese con un electricista calificado para que instale el tomacorriente adecuado.

**⚠ ADVERTENCIA:** No se recomienda el uso de un aparato con un adaptador con conexión a tierra.

## **Tomacorriente con control remoto inalámbrico para interiores**

---

### **GARANTÍA LIMITADA DE UN AÑO**

**IMPORTANTE:** Se requiere el comprobante de venta para obtener el servicio de garantía.

Paragon Group USA Inc. garantiza al dueño original que nuestros productos no tendrán defectos de mano de obra ni en los materiales durante un período de UN AÑO desde la fecha de compra.

Si cualquier unidad resulta defectuosa durante este período, Paragon Group USA Inc. será responsable únicamente del reemplazo de la unidad defectuosa. Paragon Group USA Inc. no se hace responsable por los costos de los beneficios laborales o gastos incidentales o consecuentes.

Sin cobertura: Esta garantía no cubre las baterías. Esta garantía no cubre los servicios de reparación, ajuste y calibración debido al mal uso, al abuso o a la negligencia. La reparación o modificación no autorizada de este producto o de cualquier componente suministrado dejará completamente sin efecto esta garantía.

Esta garantía no incluye reembolso por inconvenientes, instalación, tiempo de armado, pérdida de uso, envío, reparación no autorizada u otros productos utilizados junto con los productos **BLACK+DECKER**.

**Todos los derechos reservados a Black & Decker, 2021©  
BLACK+DECKER y el logotipo de BLACK+DECKER son  
marcas registradas de Stanley Black Decker, Inc. o  
una filial de dicha empresa, y se utilizan con licencia.**

Tel.: 1-844-746-6688

[www.blackanddeckerelectrical.com](http://www.blackanddeckerelectrical.com)

Correo electrónico: [info@blackanddeckerelectrical.com](mailto:info@blackanddeckerelectrical.com)

Importado por:

Paragon Group USA,  
Englewood, NJ, 07631  
EE. UU.