

Dog Cage

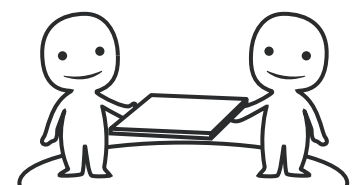

ASSEMBLED BY 2 ADULTS

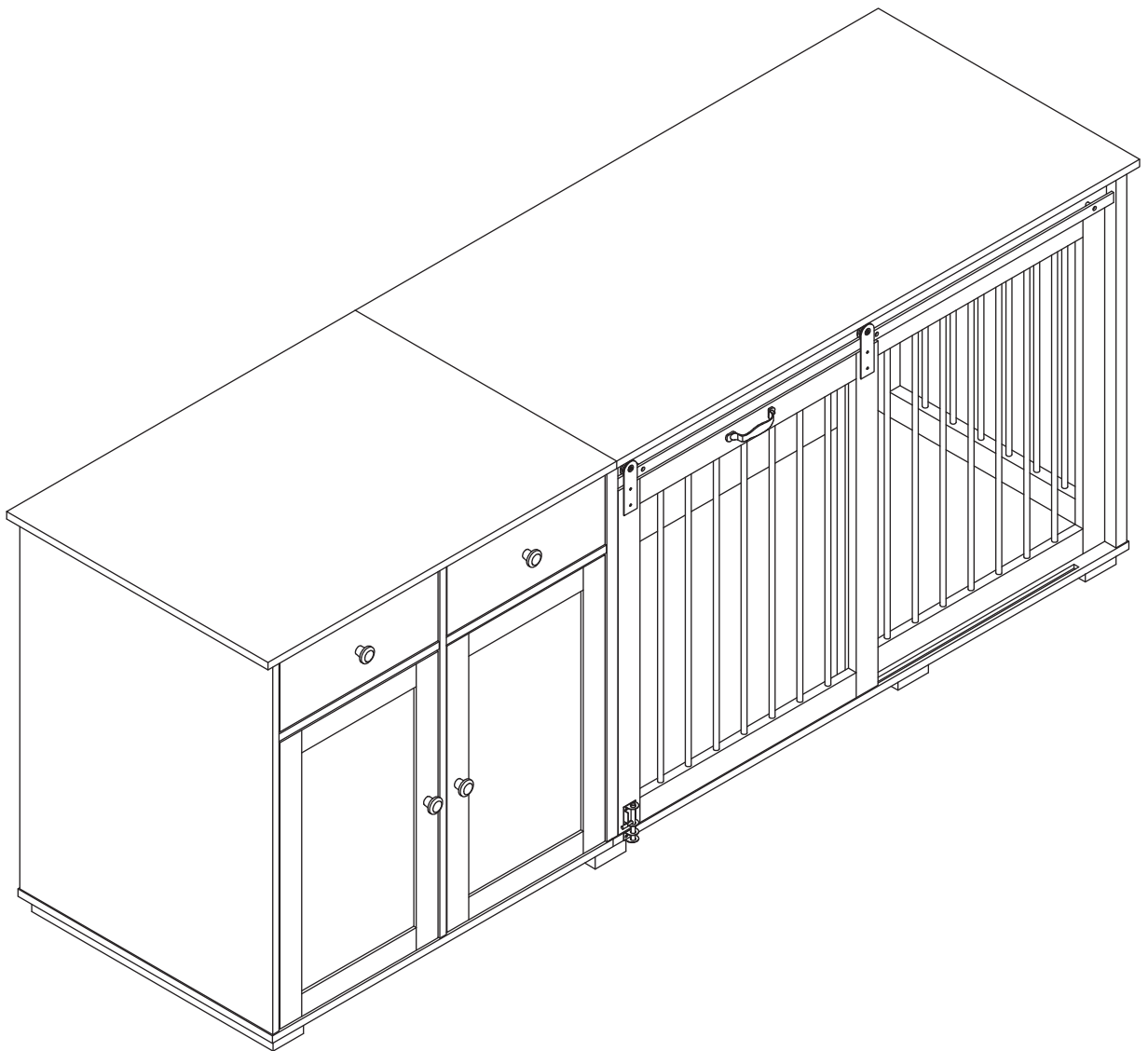

IMPORTANT INFORMATION!

please read the entire manual before starting to assemble and/or using this product. follow the manual thoroughly and keep it for further reference.



AVOID SCRATCHES!

In order to avoid scratching this furniture should be assembled on a soft layer-could be a rug.



IMPROVE EFFICIENCY !

Try to find a partner to install with you, which can speed up the installation efficiency and shorten the time.

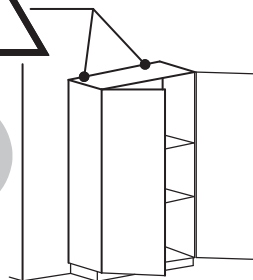
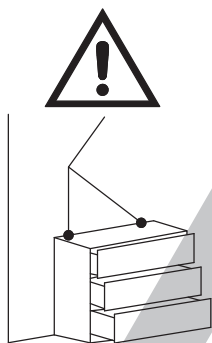

ANTI-TOPPLE WARNING !

Overturned furniture can cause serious or fatal crush injuries. To prevent tipping over, be sure to use the wall attachment, if not included with this product. Please purchase the wall attachment that fit your wall. If unsure, seek professional advice. Please read and follow each step of the instructions carefully.

IMPORTANT !

It is important that any product which is assembled using any kind of screw is re-tightened 2 weeks after assembly, and once every 3 months - in order to assure stability through-out the lifespan of the product.

For regular maintenance and cleaning of the product, for the frame, please use a rag dipped in neutral detergent to fully wipe it, and then dry it with a clean rag. For glass materials, wipe with a rag dampened with water glass cleaner, and then dry with a dry rag.

Do not use an electric screwdriver, and do not use too much force when installing, because the board is easy to break.



Please prepare the following tools

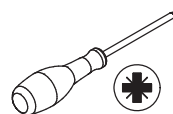
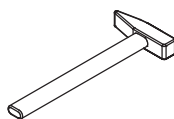

When installing, please carefully confirm whether each screw corresponds to the manual, accessories with similar shapes can be distinguished by size

<p>A x 46+4</p> <p>Ø 6 x 35 mm</p>	<p>B x 38+3</p> <p>Ø 15 x 12 mm</p>	<p>C x 8+1</p> <p>Ø 15 x 9.5 mm</p>	<p>D x 41+4</p> <p>Ø 6 x 30 mm</p>	<p>E x 24+4</p> <p>Ø 3 x 14 mm</p>
<p>F x 16+2</p> <p>Ø 3.5 x 14 mm</p>	<p>G x 8</p> <p>Ø 4 x 40 mm</p>	<p>H x 21</p> <p>Ø 6 x 35 mm</p>	<p>J x 3</p> <p>Ø 6 x 25 mm</p>	<p>K x 4</p> <p>Ø 4 x 22 mm</p>
<p>L x 2</p> <p>350 mm</p>	<p>M x 2</p> <p>350 mm</p>	<p>N x 4</p> <p>Ø 6 x 50 mm</p>	<p>P x 4</p> <p>Ø 6 x 10 mm</p>	<p>Q x 12</p> <p>Ø 3 x 16 mm</p>
<p>R x 8</p> <p>Ø 7 x 14 mm</p>	<p>S x 1</p> <p>Ø 3.5 x 14 mm</p>	<p>T x 1</p> <p>Ø 3.5 x 14 mm</p>	<p>U x 8</p> <p>Ø 25 mm</p>	<p>V x 4</p> <p>Ø 4 x 22 mm</p>
<p>W x 2</p> <p>Ø 8 x 25 mm</p>	<p>X x 2</p> <p>Ø 4 x 22 mm</p>	<p>Y x 46</p> <p>Ø 20 mm</p>	<p>K2 x 1</p> <p>Ø 4 x 22 mm</p>	

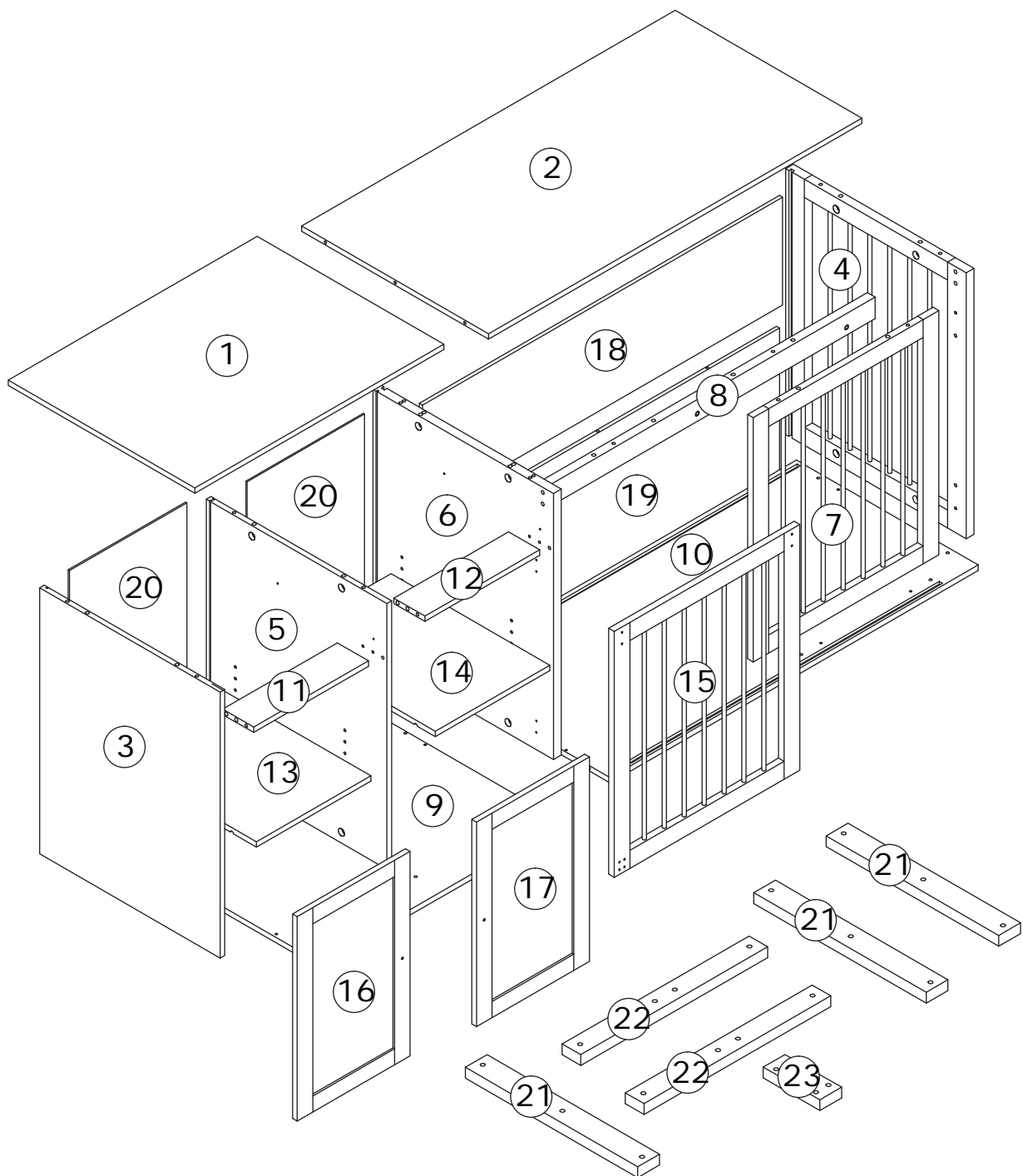

⚠ WARNING



Children have died from furniture tipover. To reduce the risk of furniture tipover:

- ALWAYS install tipover restraint provided.
- NEVER put a TV on this product.
- NEVER allow children to stand, climb or hang on drawers, doors, or shelves.
- NEVER open more than one drawer at a time.
- Place heaviest items in the lowest drawers.

*This is a permanent label.
Do not remove!*

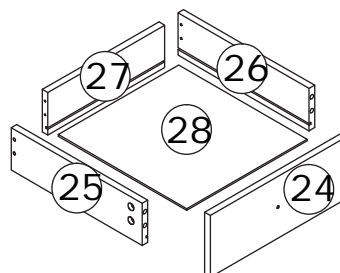

x2

1

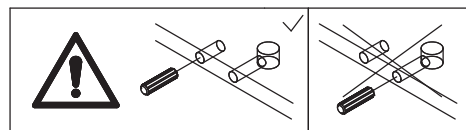
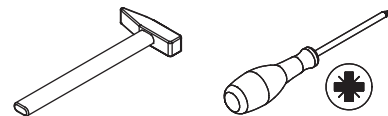
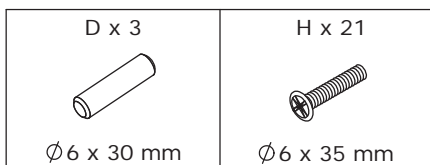

Connect board 9 to board 10
using wooden dowel(D) at first.
Fix board 21, 22 and 23 to board
9 and 10 with screw(H) as shown.

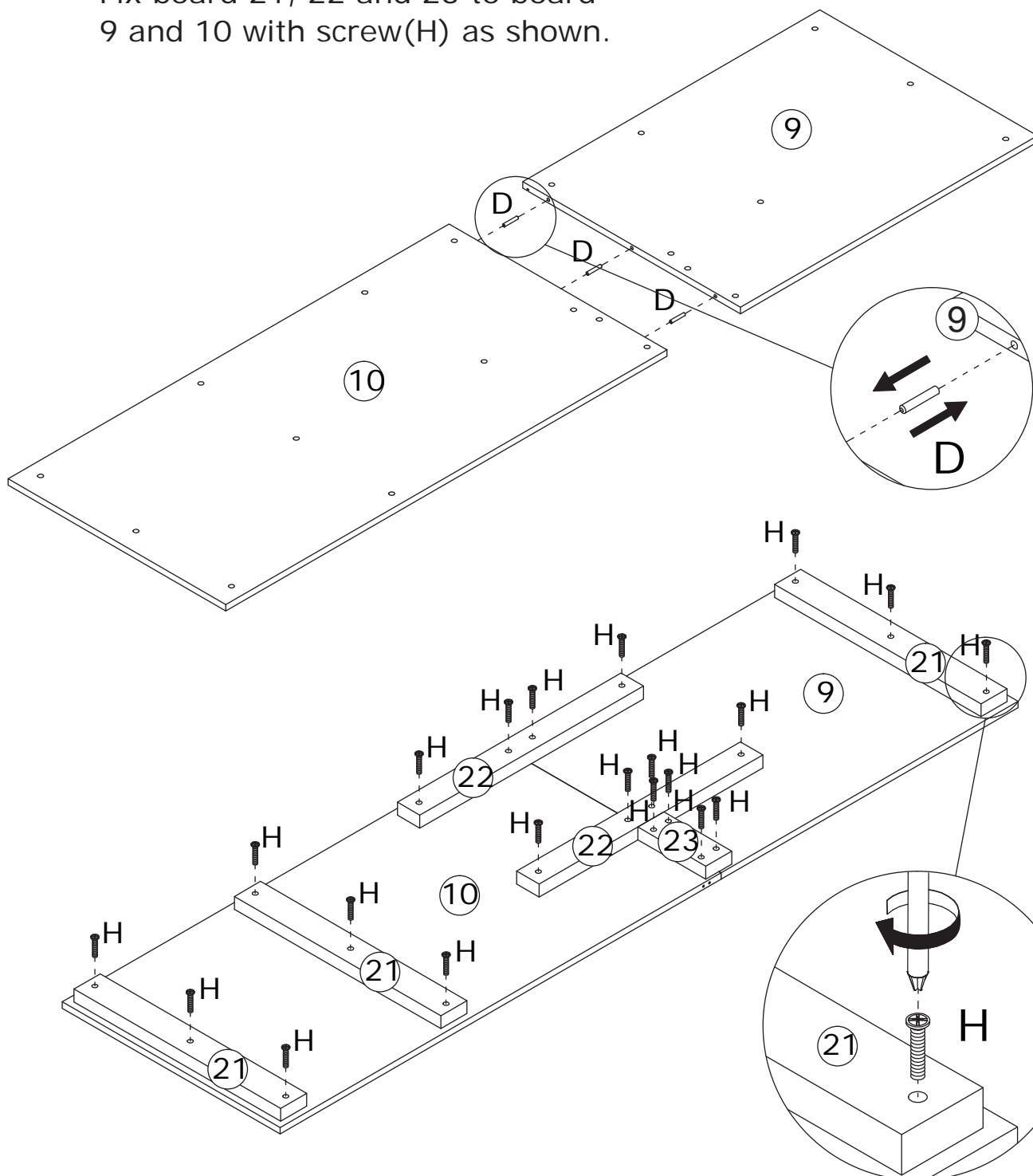

2

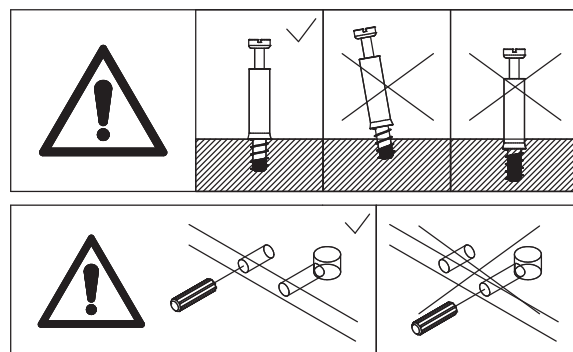

Screw eccentric rod(A) and insert wooden dowel(D) into board 9 and 10 as shown.

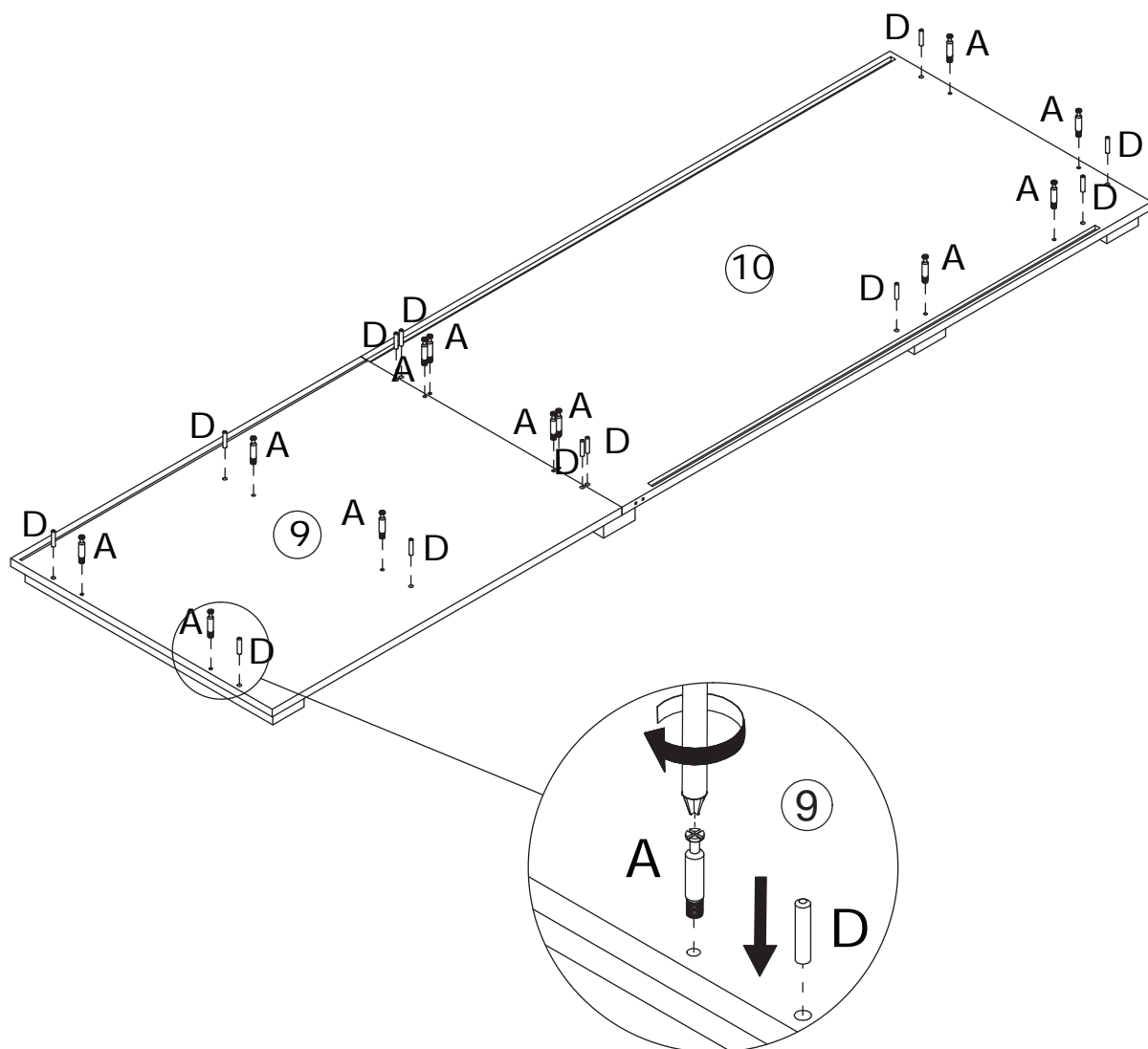

3

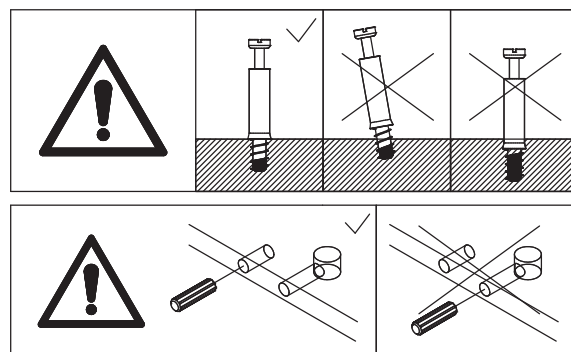
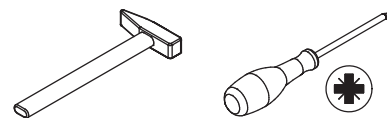
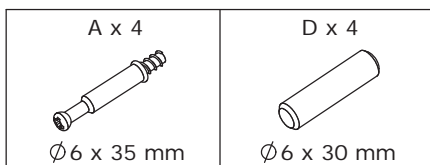

Screw eccentric rod(A) and insert wooden dowel(D) into board 4 and 8 as shown.

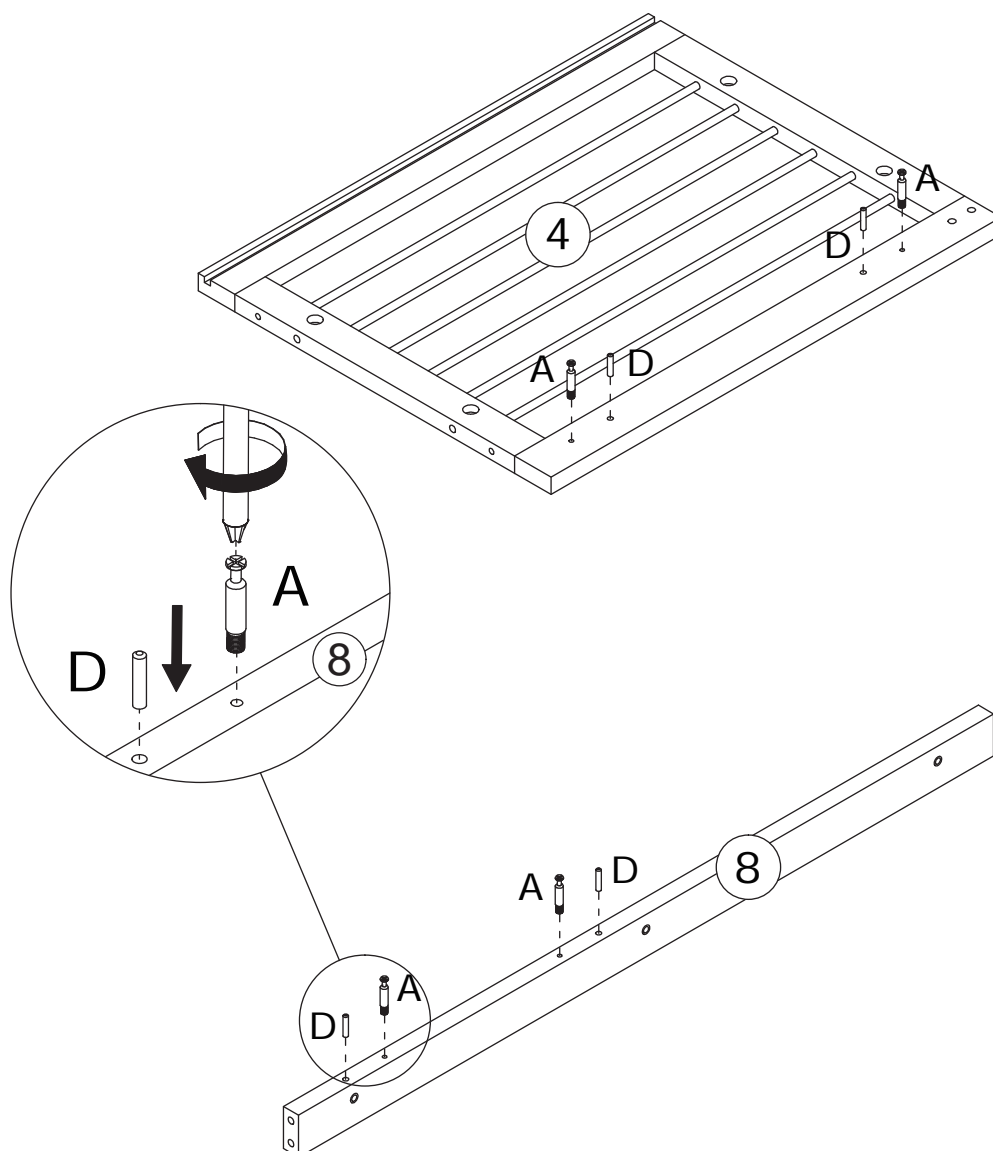

4

B x 2



Ø 15 x 12 mm

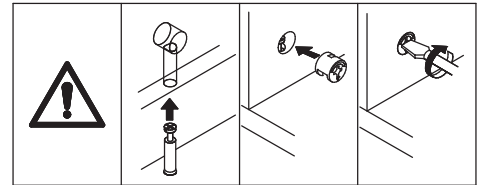
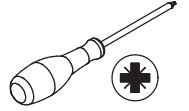

Attach board 4 to board 7, add cam lock(B) into board 7 and turn clockwise to tighten as shown.

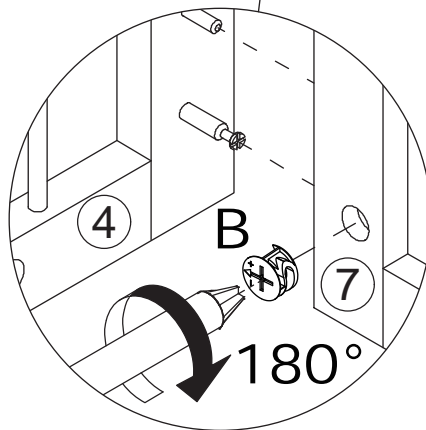
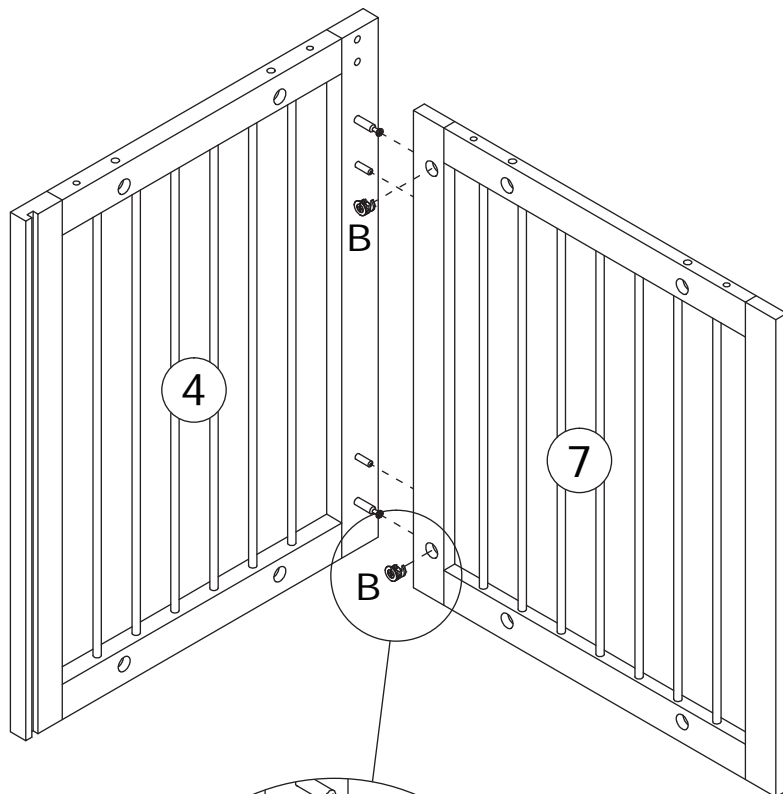

5

B x 2



Ø 15 x 12 mm

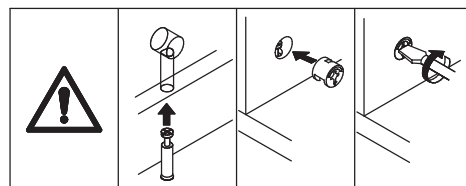

Attach board 8 to board 7, add cam lock(B) into board 7 and turn clockwise to tighten as shown.

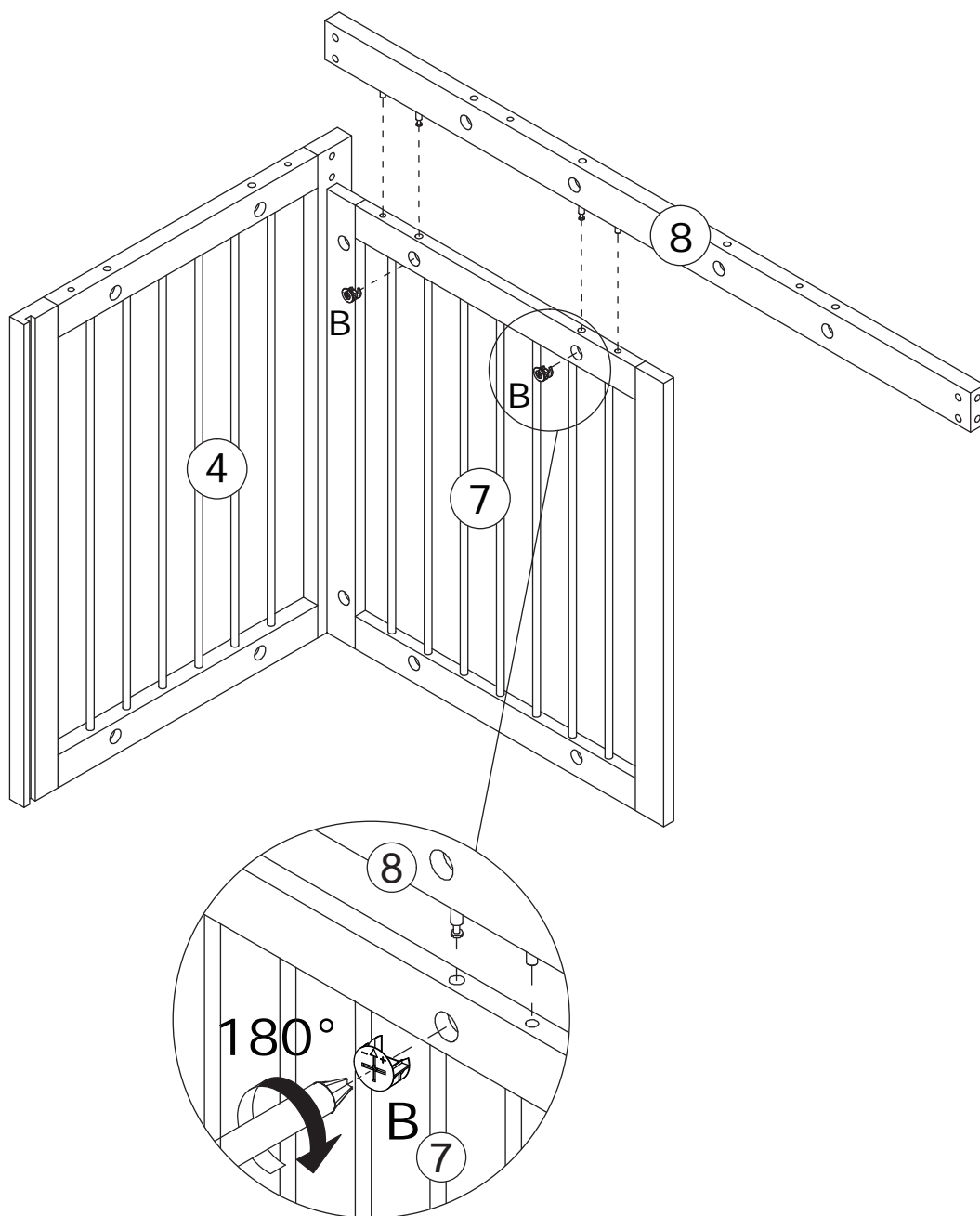

6

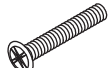
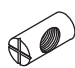
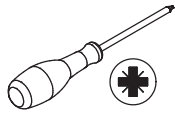

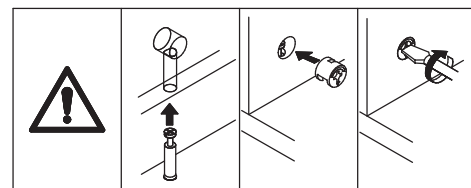
<p>B x 4</p>  <p>Ø 15 x 12 mm</p>	<p>N x 2</p>  <p>Ø 6 x 50 mm</p>	<p>P x 2</p>  <p>Ø 6 x 10 mm</p>	
--------------------------------------------------------------------------------------------------------------------	-------------------------------------------------------------------------------------------------------------------	-------------------------------------------------------------------------------------------------------------------	-------------------------------------------------------------------------------------

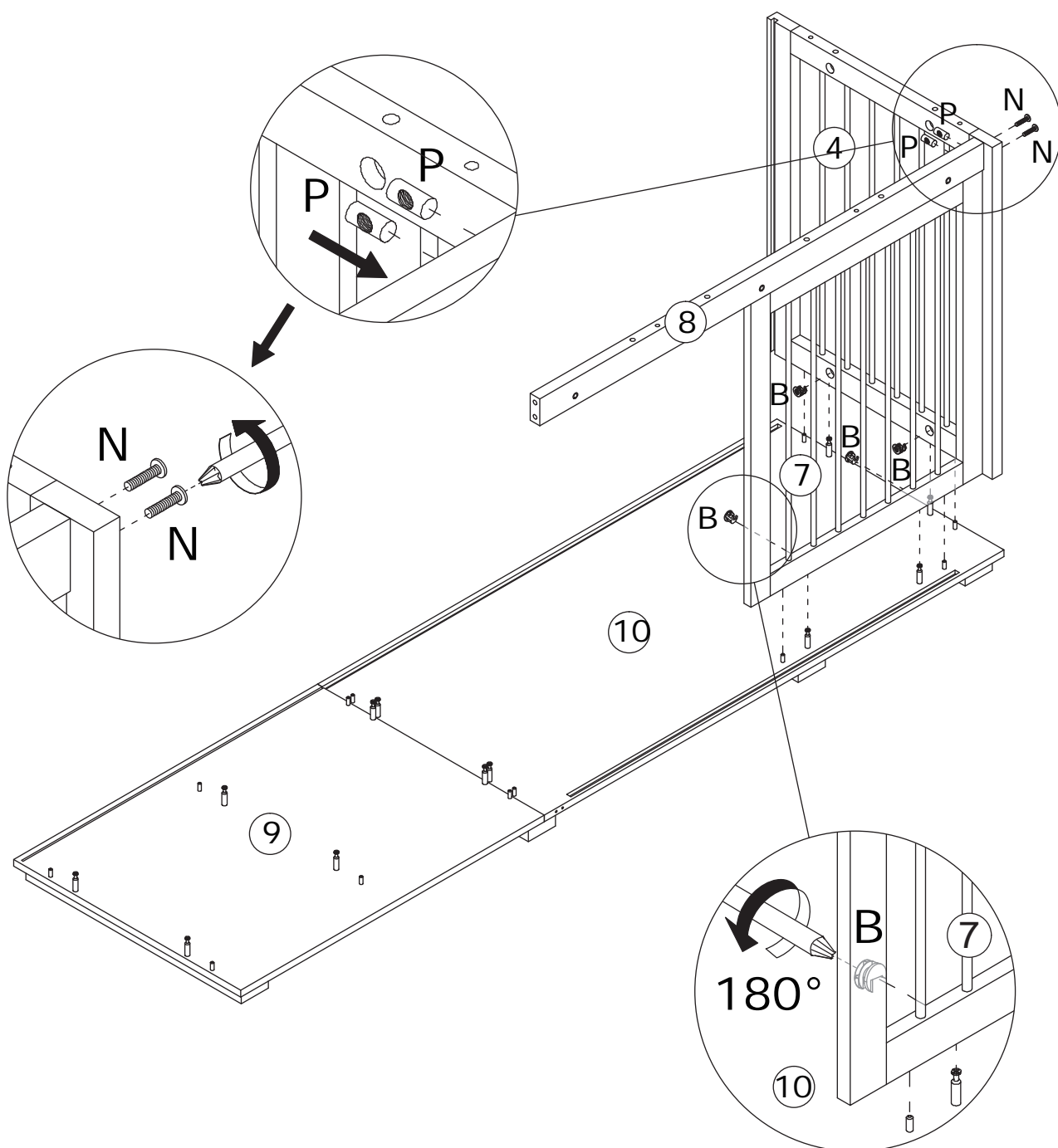

Add nut(P) into board 8 at first, then fix board 4 to board 8 using screw(N) as shown.
Attach board 4 and 7 to board 10, add cam lock(B) into board 4,7 and turn clockwise to tighten as shown.

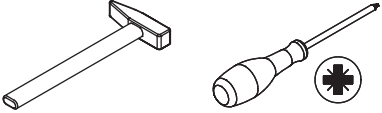
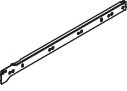
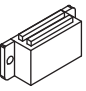

7

<p>A x 2</p>  <p>Ø6 x 35 mm</p>	<p>D x 1</p>  <p>Ø6 x 30 mm</p>	<p>E x 6</p>  <p>Ø3 x 14 mm</p>	
<p>M x 1</p>  <p>350 mm</p>	<p>X x 2</p> 		

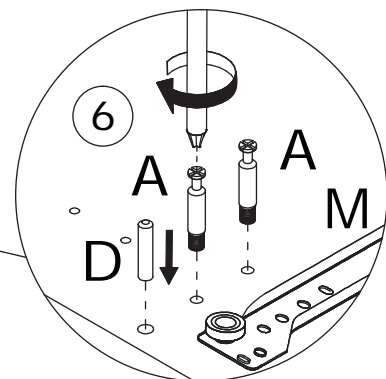
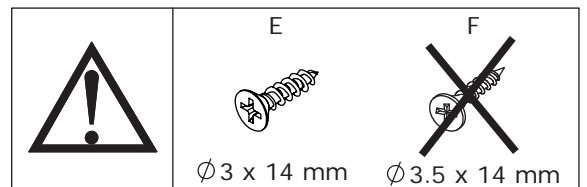
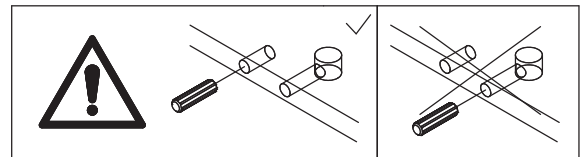
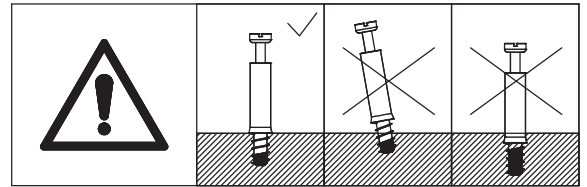
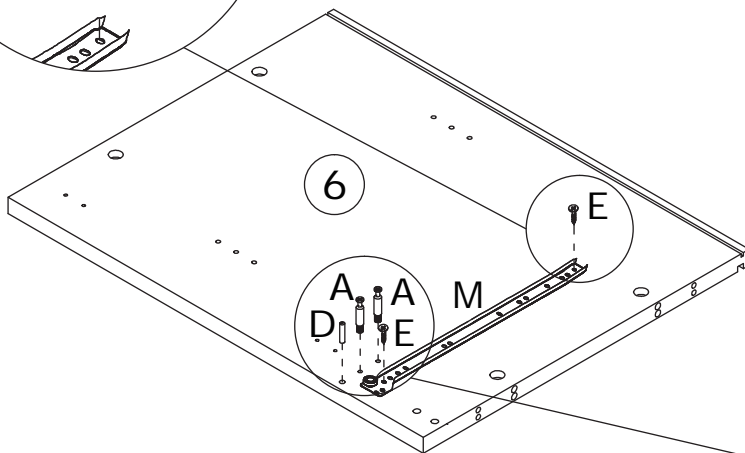
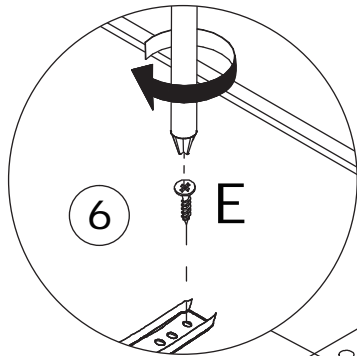
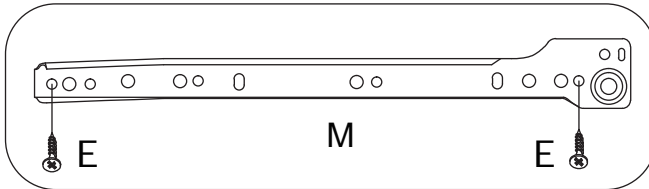

Fix rail(M) to board 6 with screw(E), screw eccentric rod(A) and insert wooden dowel(D) into as shown. Fix part(X) to board 11 and 12 with screw(E) as shown.

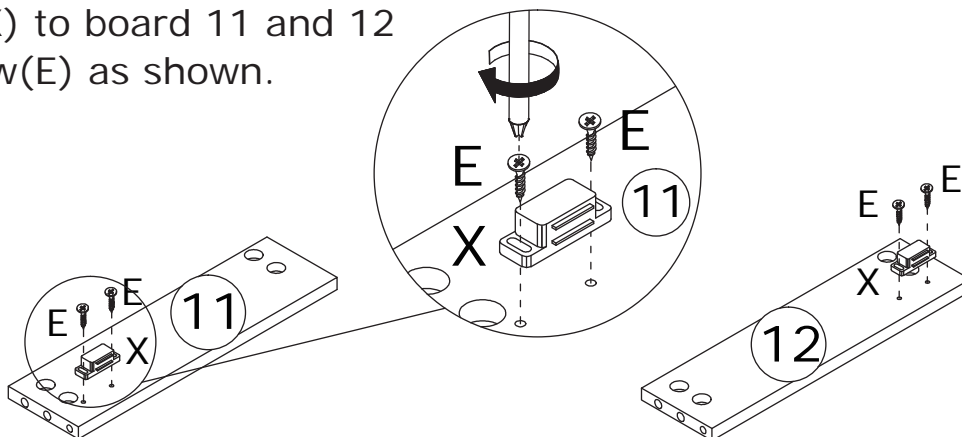

8

C x 4



Ø 15 x 9.5 mm

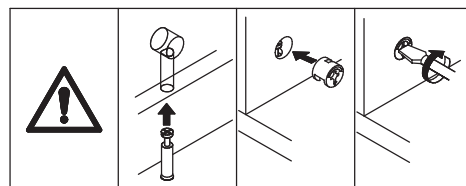
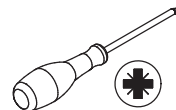

Attach board 6 to board 9 and 10, add cam lock(C) into board 6 and turn clockwise to tighten as shown.

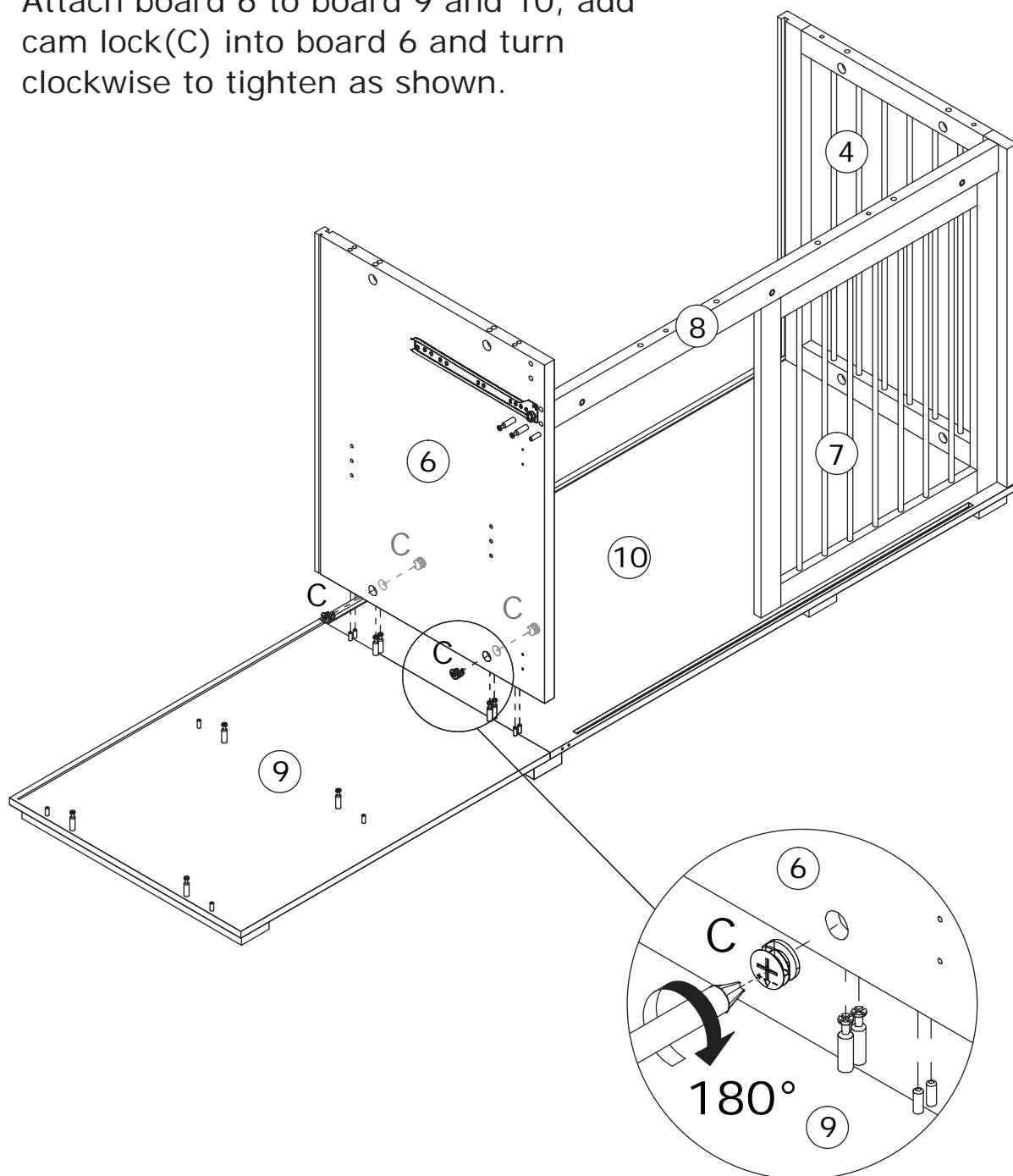



9

<p>B x 2</p> <p>Ø 15 x 12 mm</p>	<p>N x 2</p> <p>Ø 6 x 50 mm</p>	<p>P x 2</p> <p>Ø 6 x 10 mm</p>	
----------------------------------	---------------------------------	---------------------------------	--

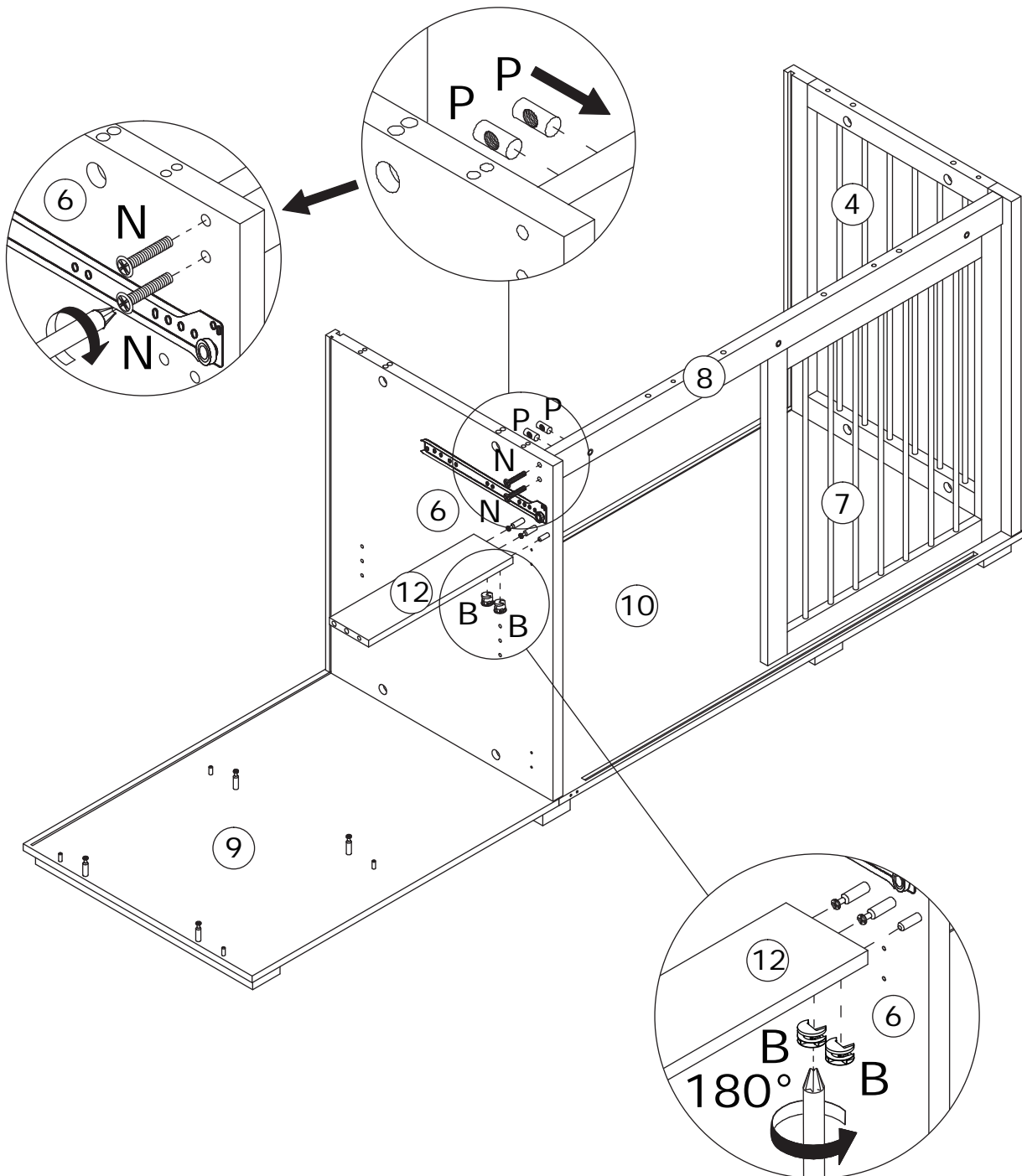
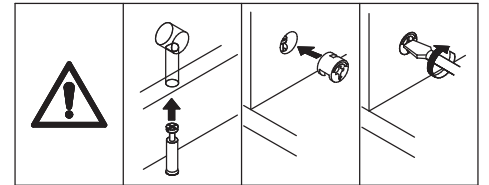
Add nut(P) into board 8 at first, then fix board 6 to board 8 using screw(N) as shown. Attach board 12 to board 6, add cam lock(B) into board 12 and turn clockwise to tighten as shown.

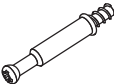

10

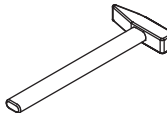
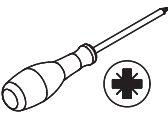
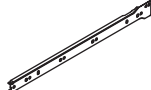
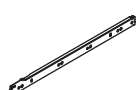
<p>A x 6</p>  <p>Ø 6 x 35 mm</p>	<p>D x 3</p>  <p>Ø 6 x 30 mm</p>	<p>E x 6</p>  <p>Ø 3 x 14 mm</p>	 
<p>L x 2</p>  <p>350 mm</p>	<p>M x 1</p>  <p>350 mm</p>		

Fix rail(L) to board 3 with screw(E), screw eccentric rod(A) and insert wooden dowel(D) into as shown. Fix rail(L) to board 5 with screw(E), screw eccentric rod(A) and insert wooden dowel(D) into at first. Flip the board to back, fix rail(M), screw eccentric rod(A) and insert wooden dowel(D) into as well.

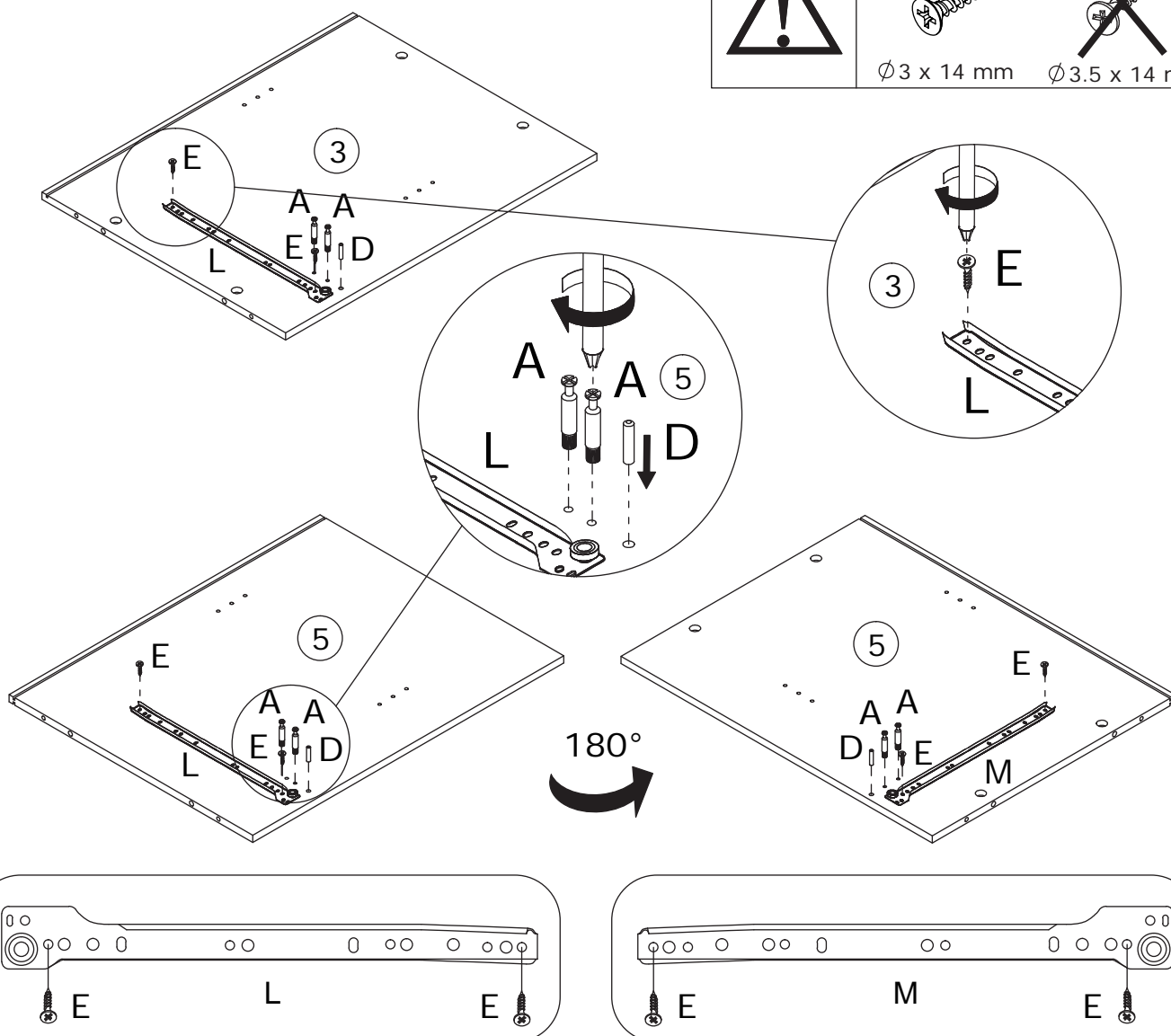
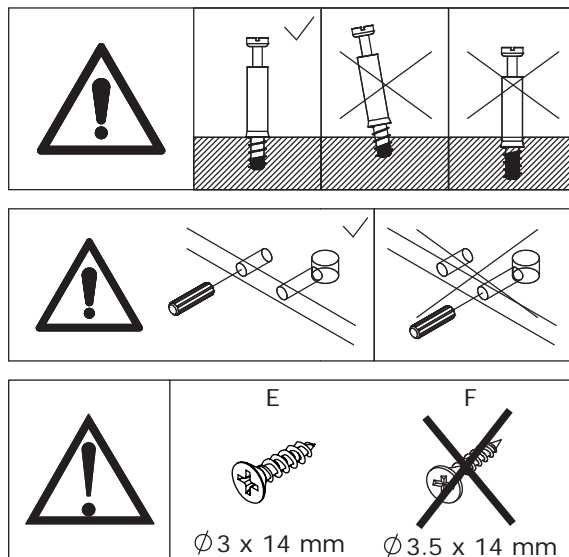

11

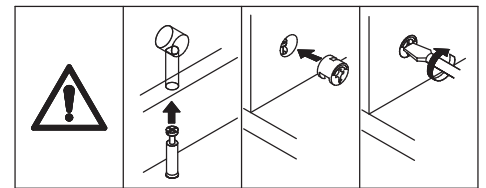
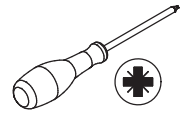
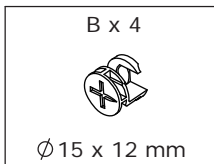

Connect board 5 to board 9 and 12,
and add cam lock(B) into board 5, 12,
then turn clockwise to tighten.

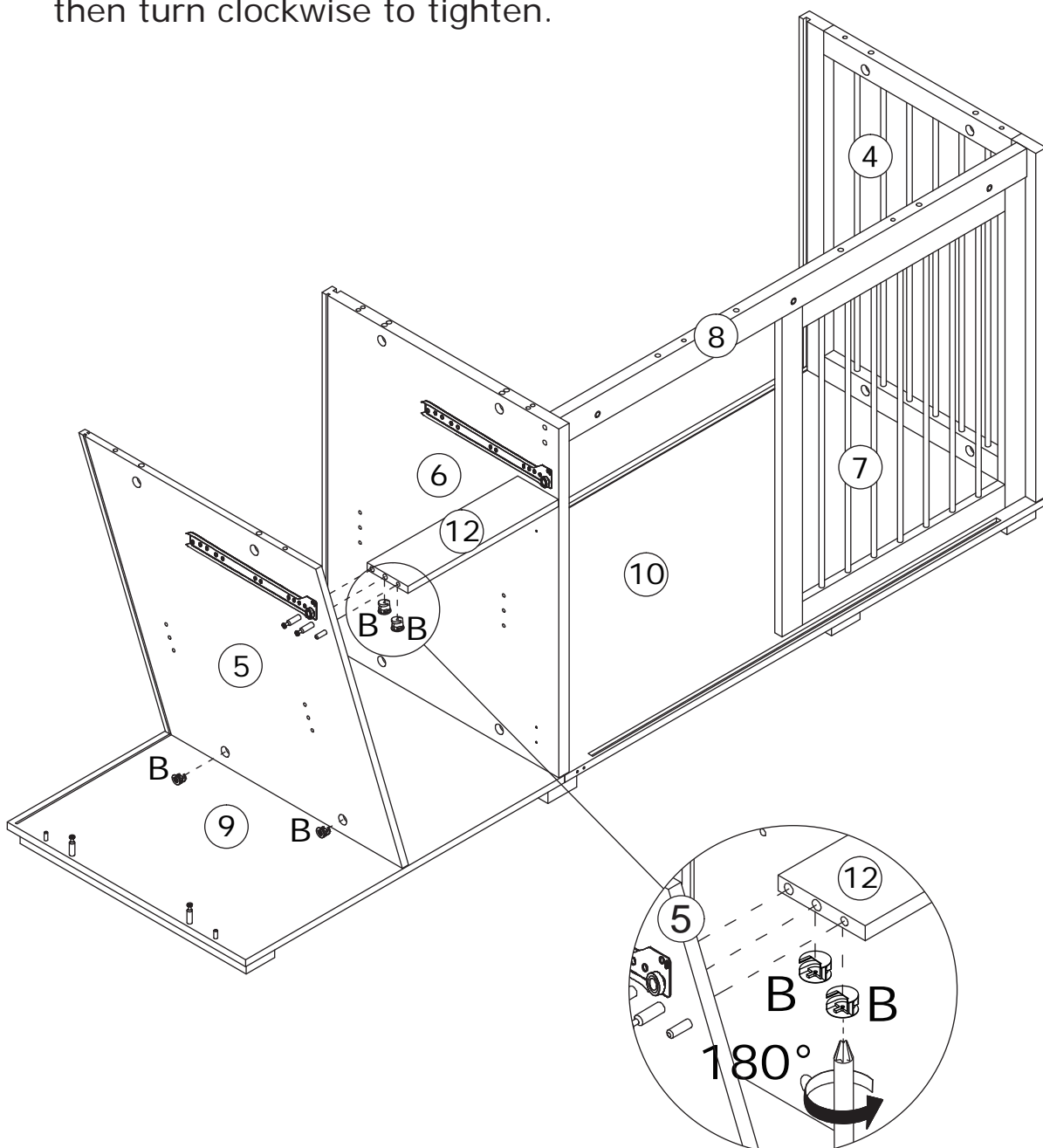

12

B x 2



Ø 15 x 12 mm

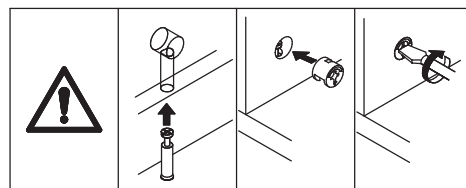
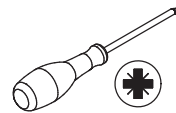

Attach board 11 to board 5, add cam lock(B) into board 11 and turn clockwise to tighten as shown.

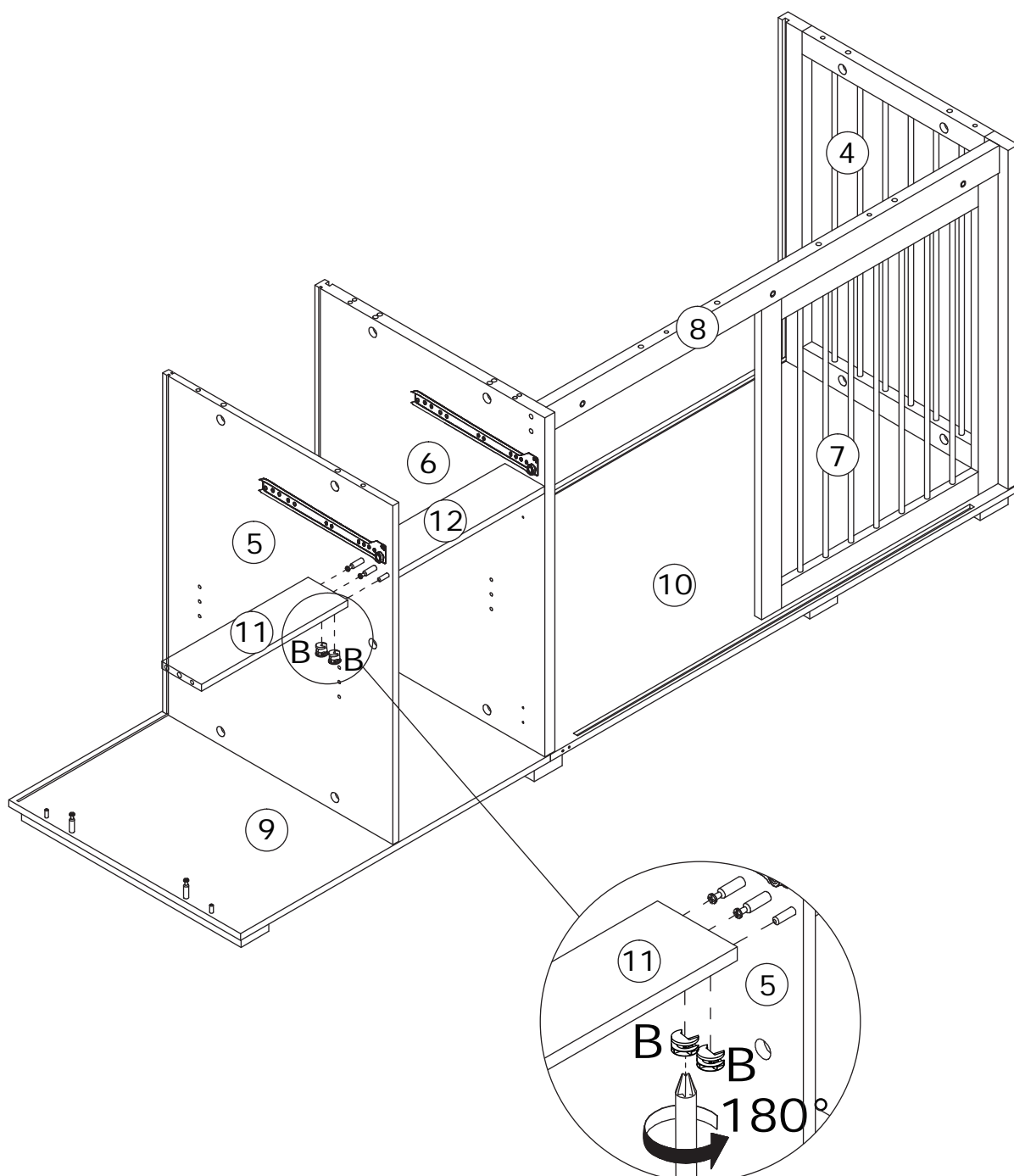

13

B x 4



Ø 15 x 12 mm

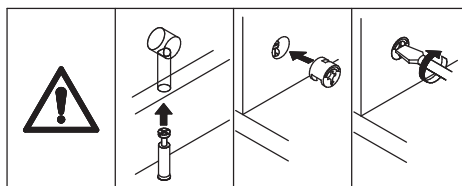

Connect board 3 to board 9 and 11, and add cam lock(B) into board 3, 11, then turn clockwise to tighten.

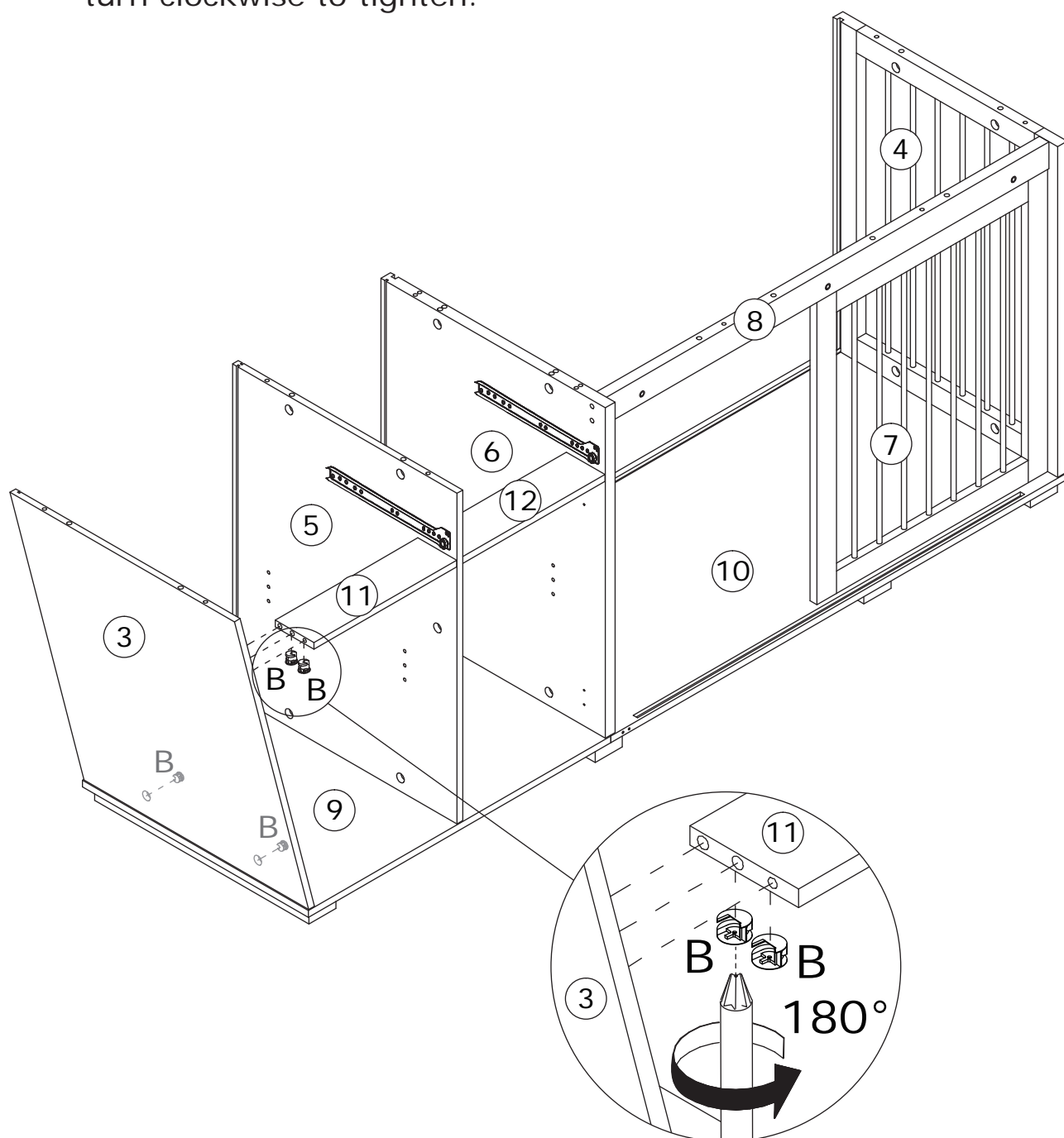

14

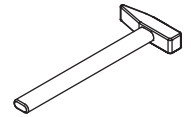
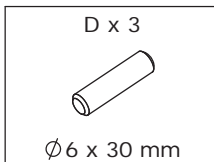

Connect board 18 to board 19 with wooden dowel(D) at first.
Insert the back board 18, 19 and 20 along available grooves as shown.

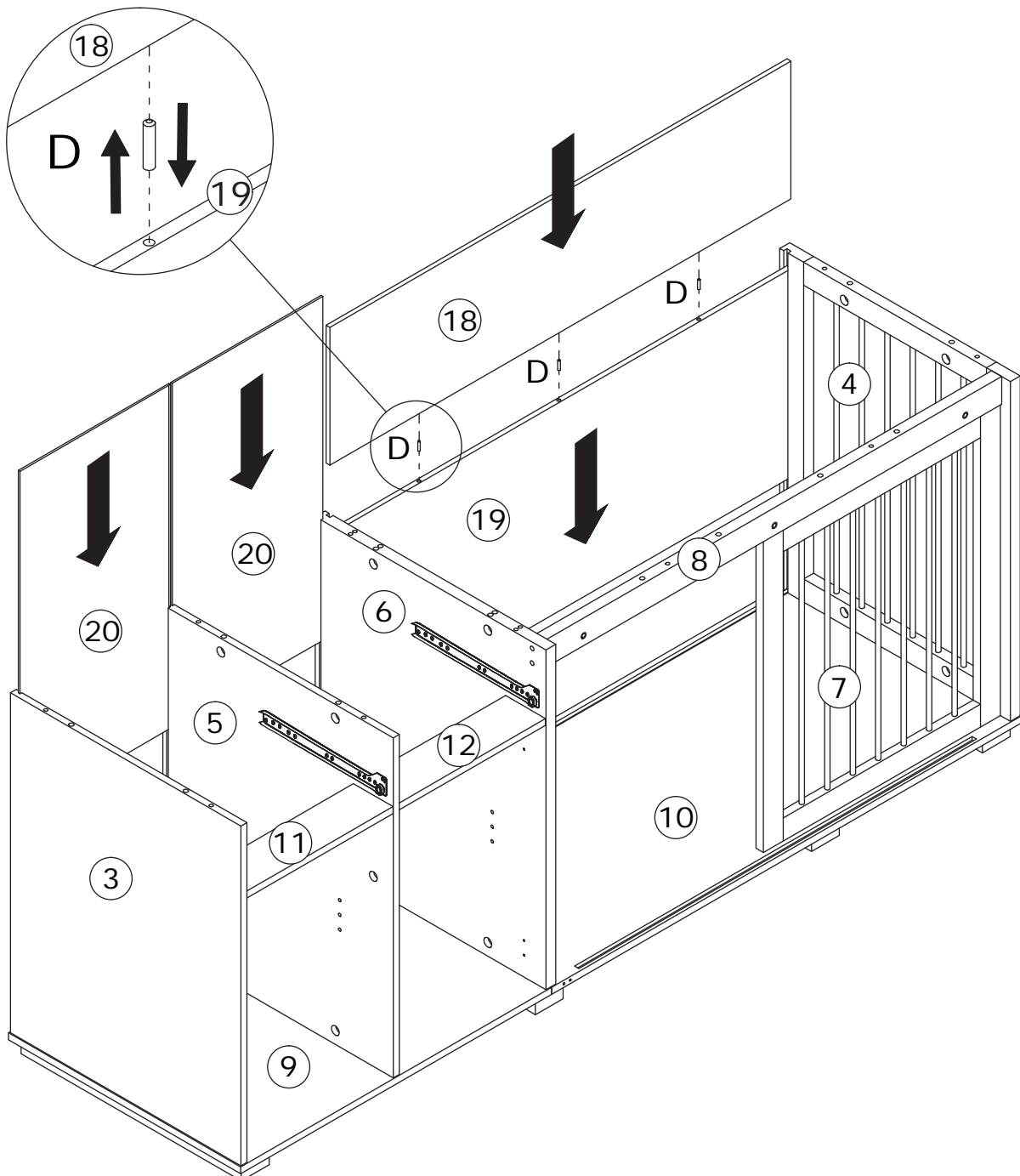
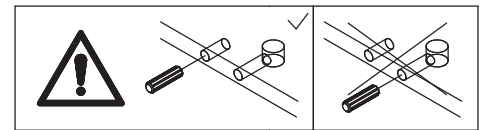

15

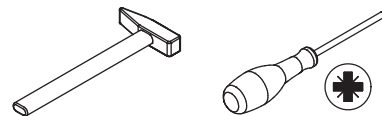
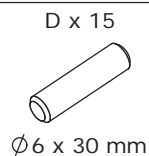
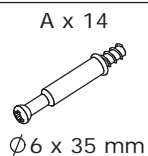

Connect board 1 to board 2 using wooden dowel(D) at first. Screw eccentric rod(A) and insert wooden dowel(D) into board 1 and 2 as shown.

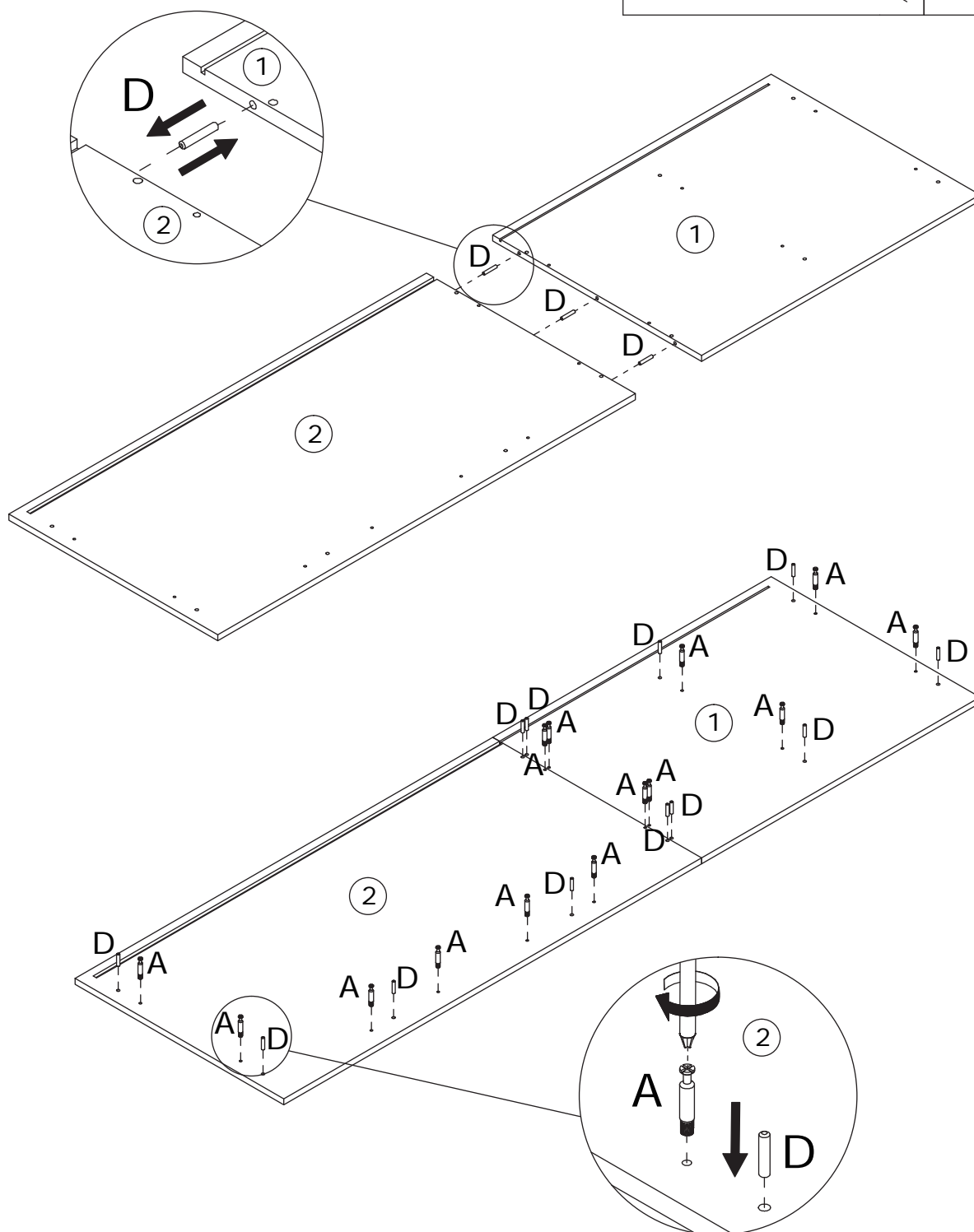
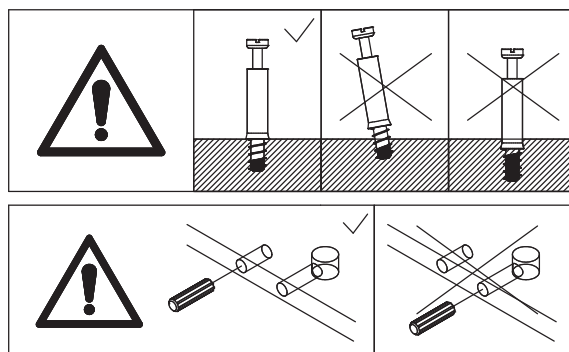

16

B x 10



Ø 15 x 12 mm

C x 4



Ø 15 x 9.5 mm

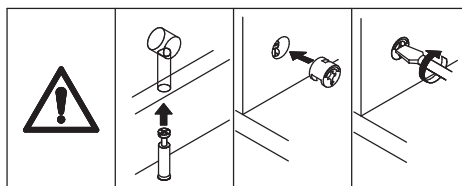
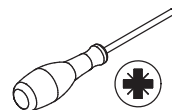

Cover board 1 and 2 to the top, add cam lock(B) into board 3,5,8,4 and add cam lock(C) into board 6, turn clockwise to tighten as shown.

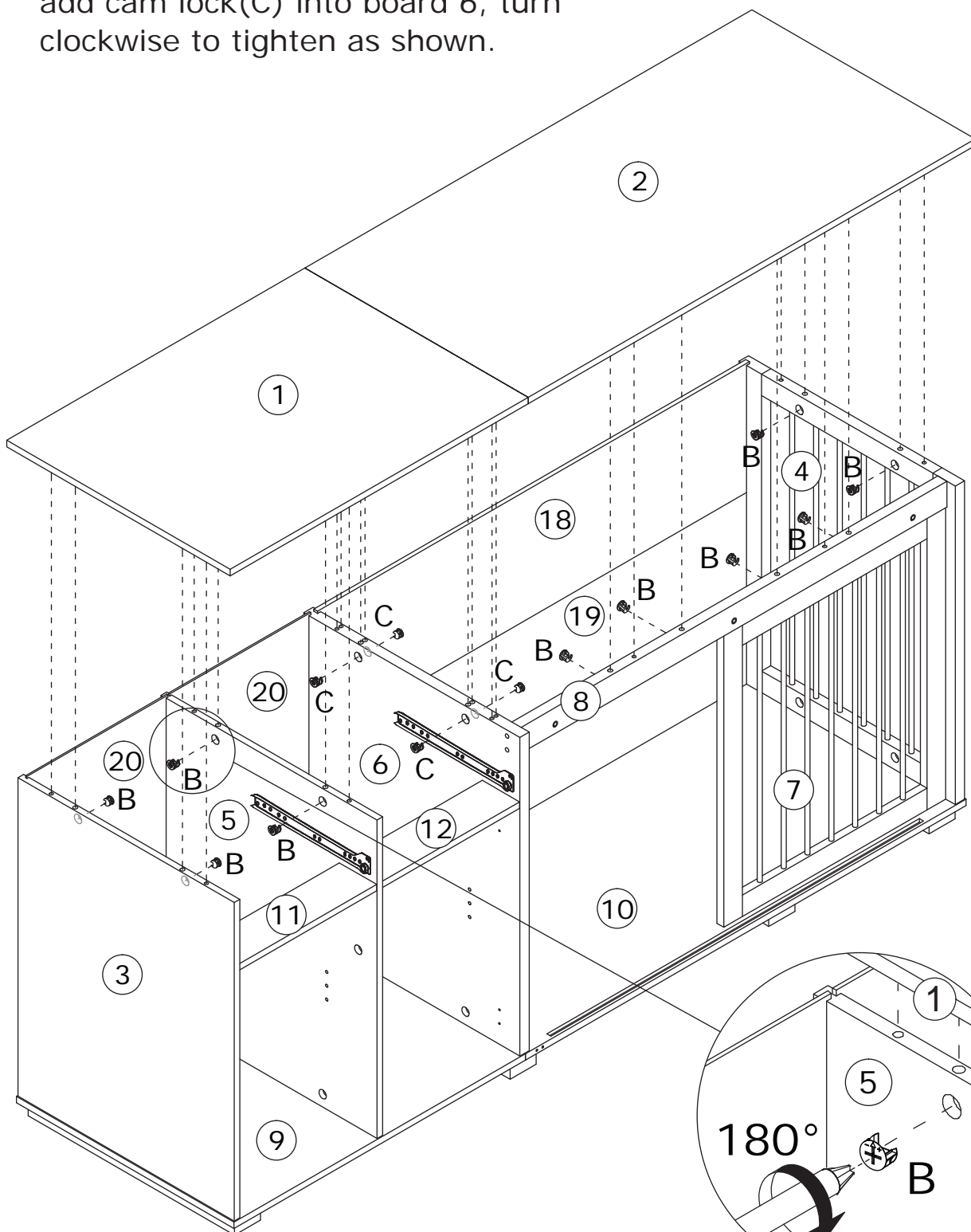



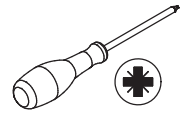
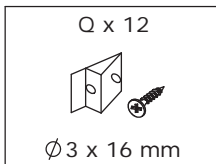

17

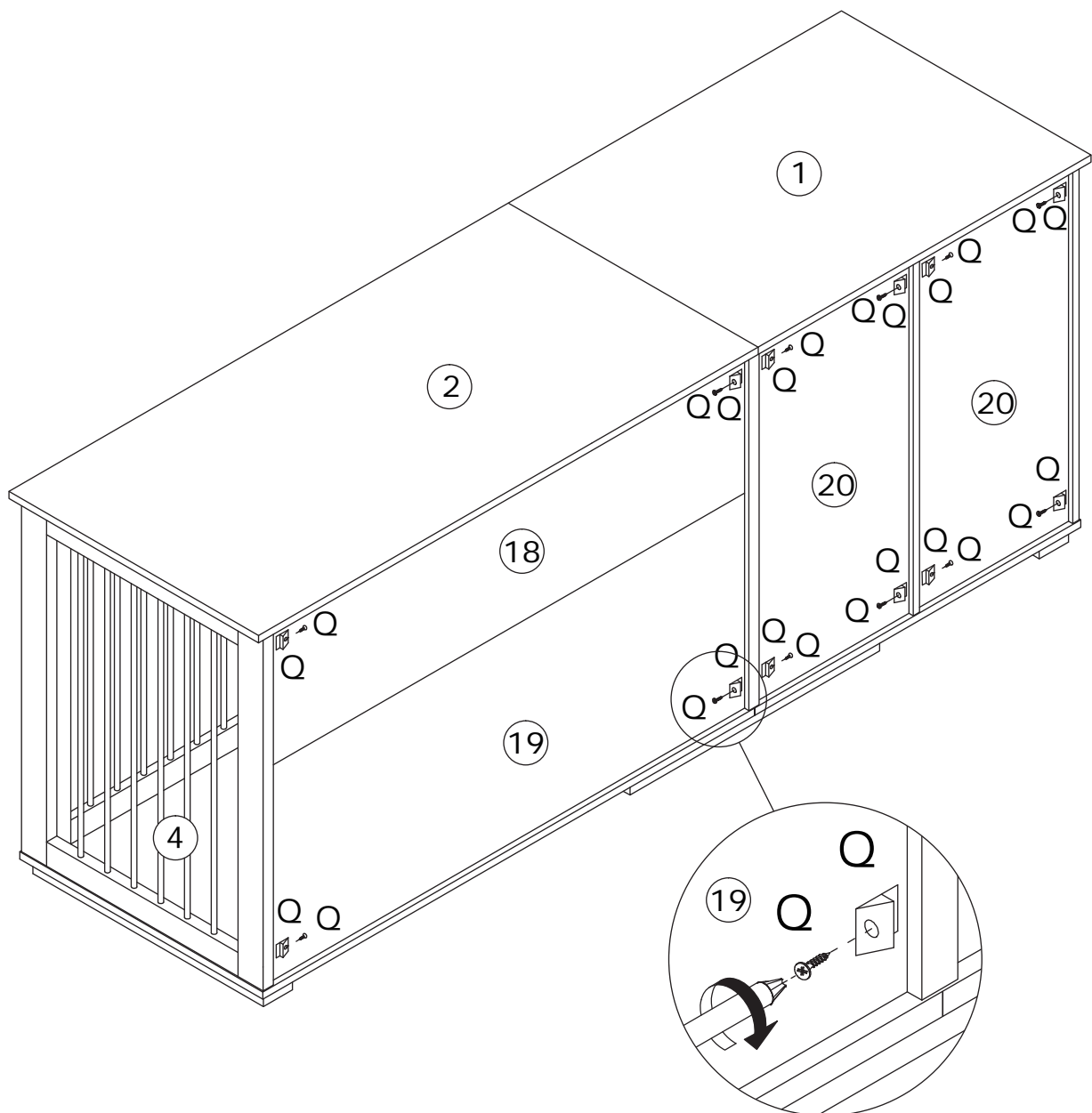

Insert buckle(Q) into back slots
and fix to tighten as shown.

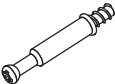

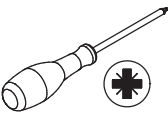
18

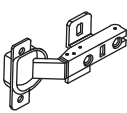
<p>A x 8</p>  <p>Ø 6 x 35 mm</p>	<p>E x 4</p>  <p>Ø 3 x 14 mm</p>	<p>F x 8</p>  <p>Ø 3.5 x 14 mm</p>	
<p>K x 4</p>  <p>Ø 4 x 22 mm</p>	<p>X x 2</p> 	<p>V x 4</p> 	

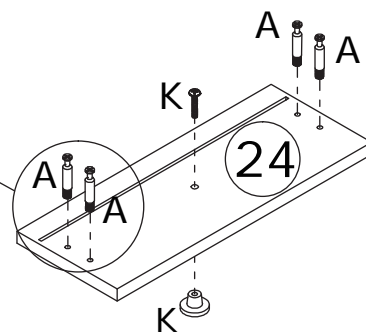
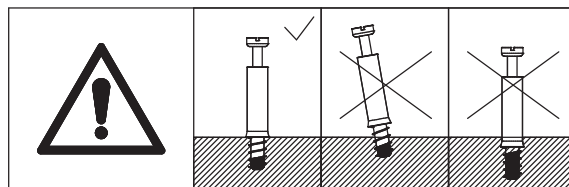
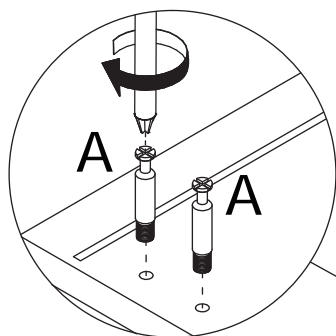

x2

Screw eccentric rod(A)
into board 24 as shown.

Fix hinge(V) to board 16
and 17 with screw(F) as shown.

Fix part(X) to board 16 and 17 with screw(E) as shown.

Fix knob(K) to board 24, 16 and 17 as shown.

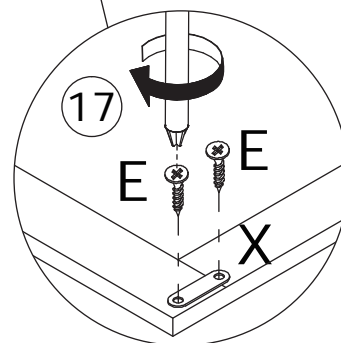
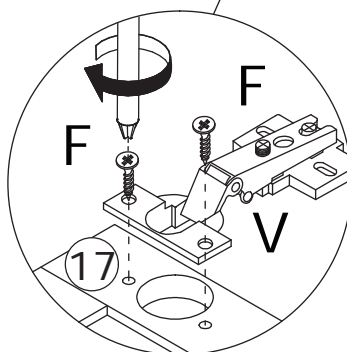
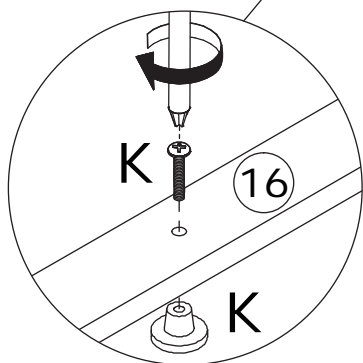
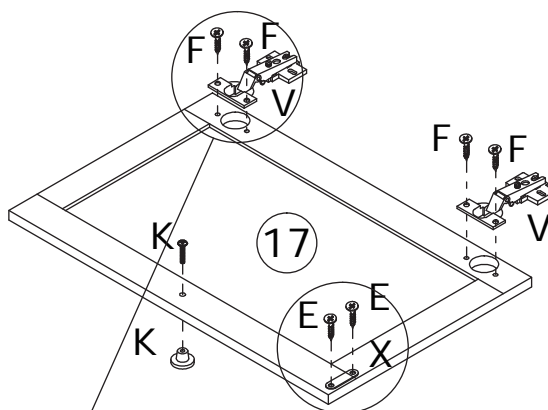
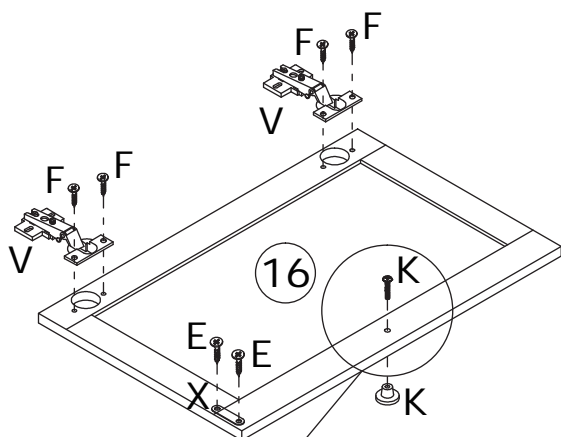



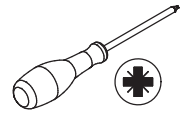
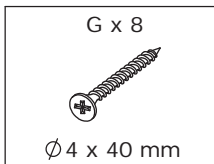

19

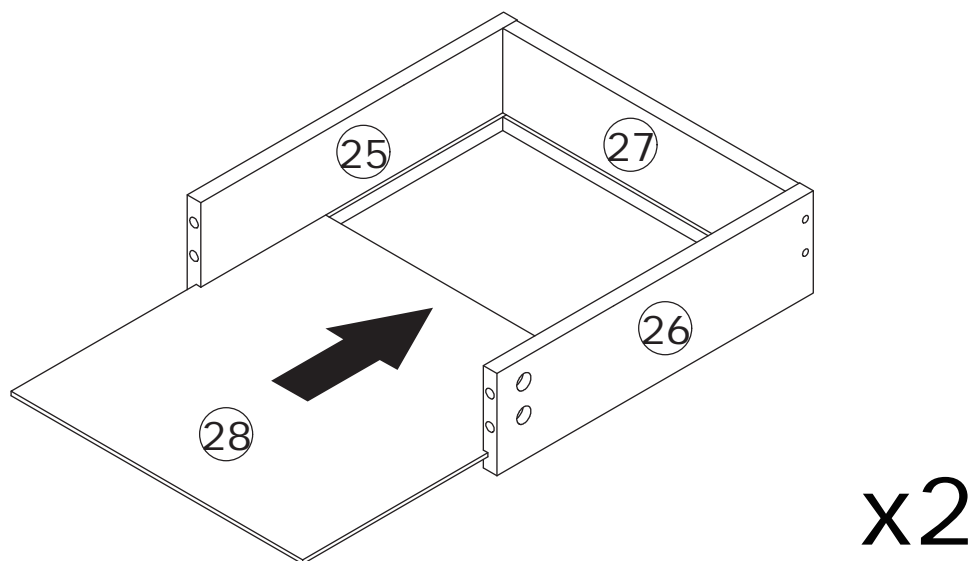
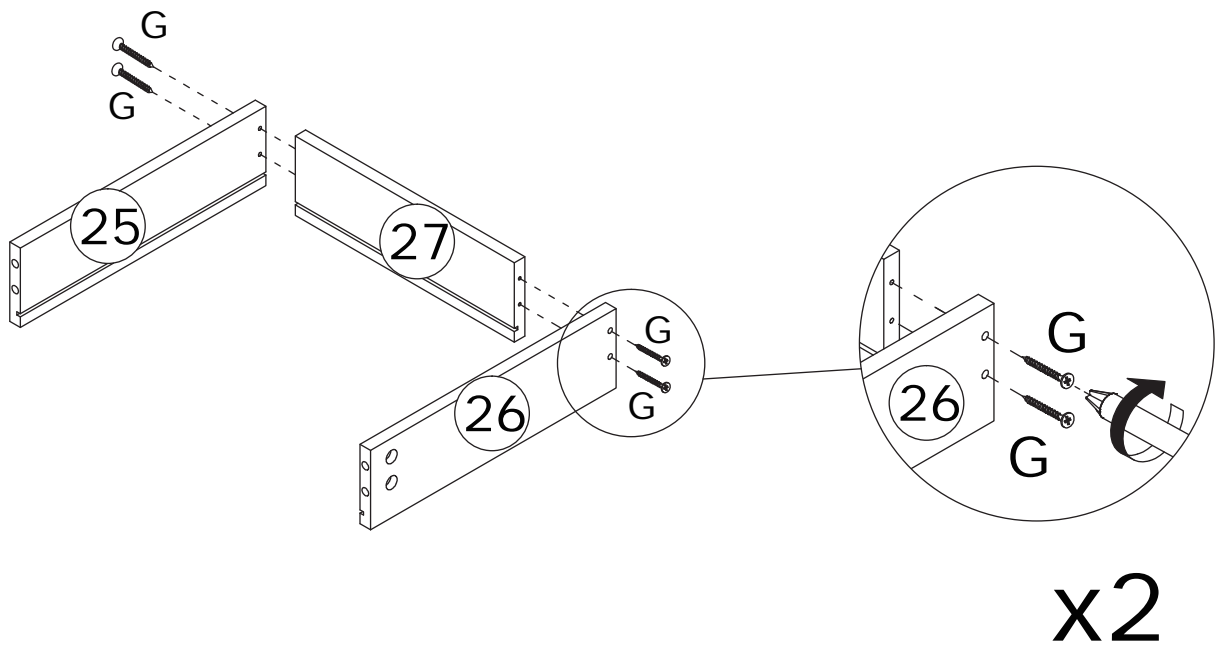

Fix board 25 and 26 to board 27 with screw(G) as shown.
Insert bottom board 28 along available grooves as shown.

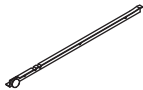

20

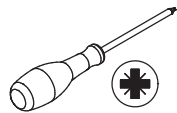
<p>B x 8</p>  <p>Ø 15 x 12 mm</p>	<p>E x 8</p>  <p>Ø 3 x 14 mm</p>	<p>L x 2</p>  <p>350 mm</p>	<p>M x 2</p>  <p>350 mm</p>	
--------------------------------------------------------------------------------------------------------------------	-------------------------------------------------------------------------------------------------------------------	--------------------------------------------------------------------------------------------------------------	---------------------------------------------------------------------------------------------------------------	-------------------------------------------------------------------------------------

Attach board 24 to board 25 and 26, add cam lock(B) into board and turn clockwise to tighten as shown. Fix runner(L) and (M) to board 25 and 26 with screw(E) as shown.

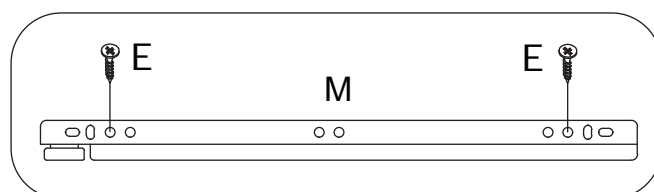
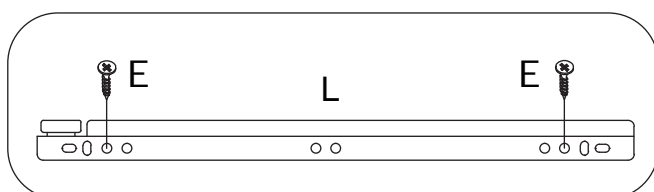
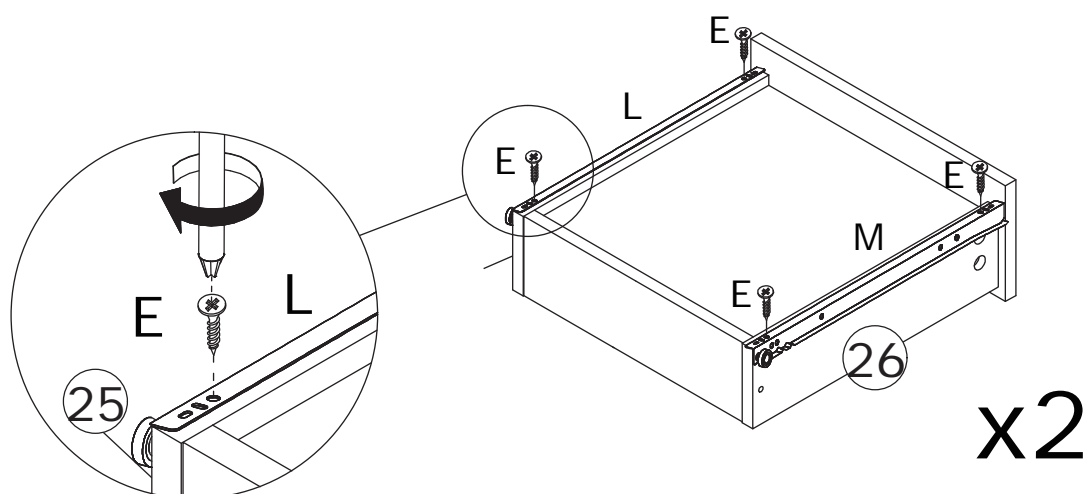
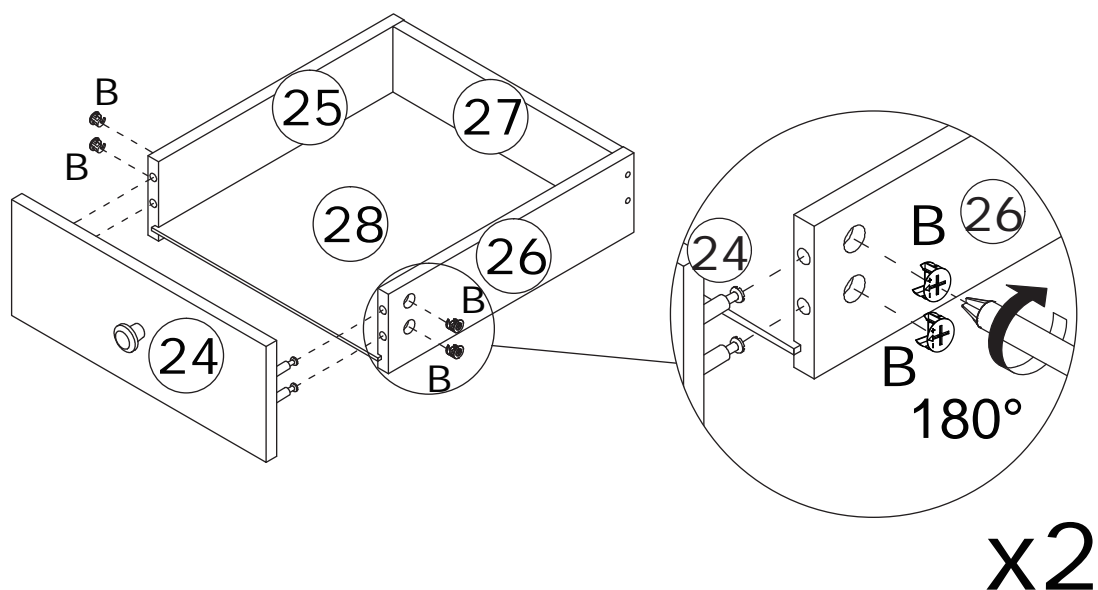
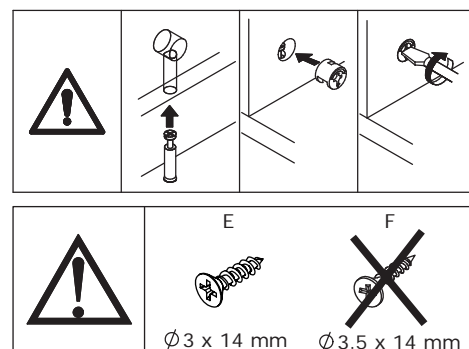

21

Align rails, insert drawers in.

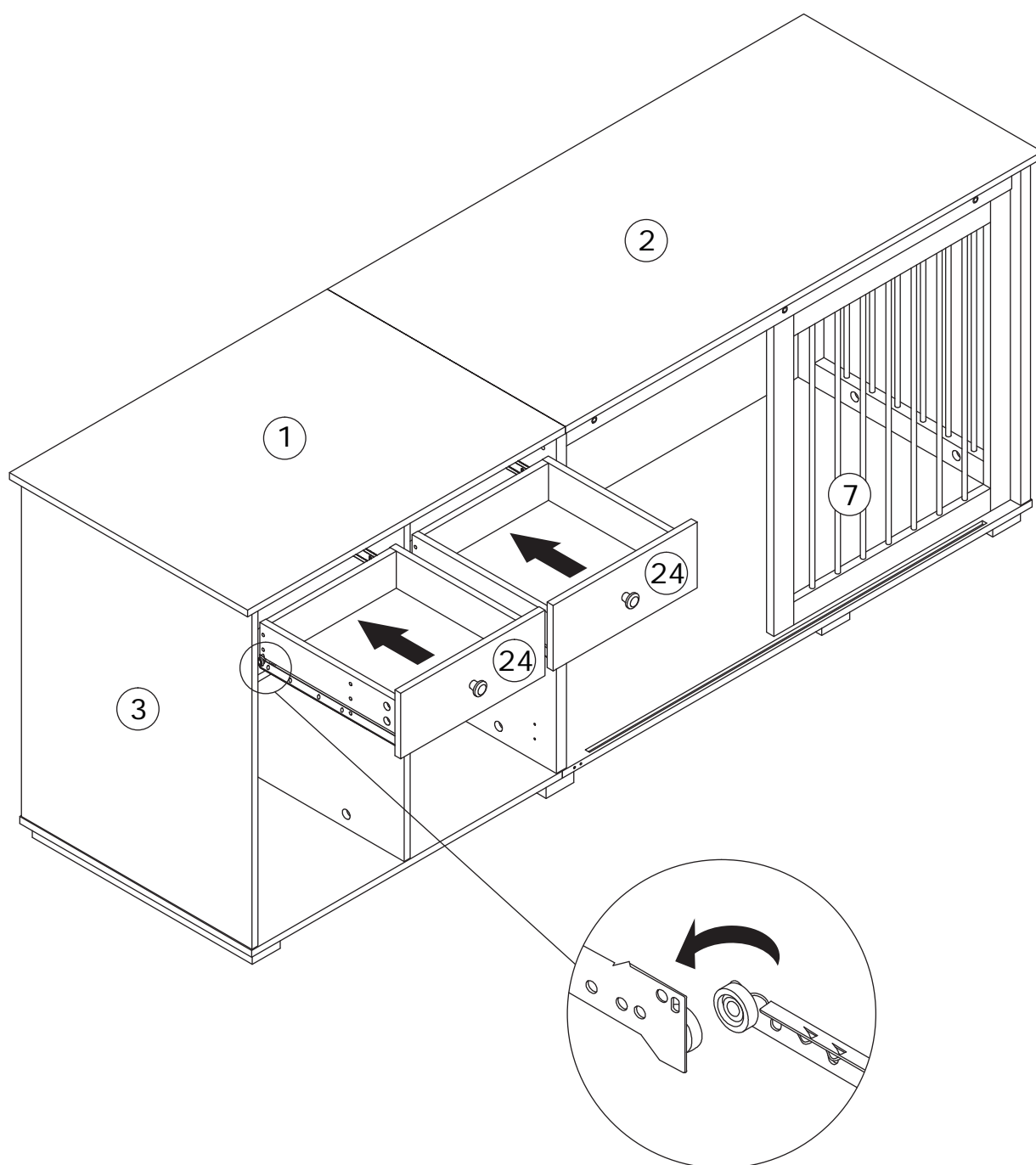

22

R x 8



Ø7 x 14 mm

Insert layer pin(R) into board 3, 5 and 6,
then place shelf board 13 and 14 in as shown.

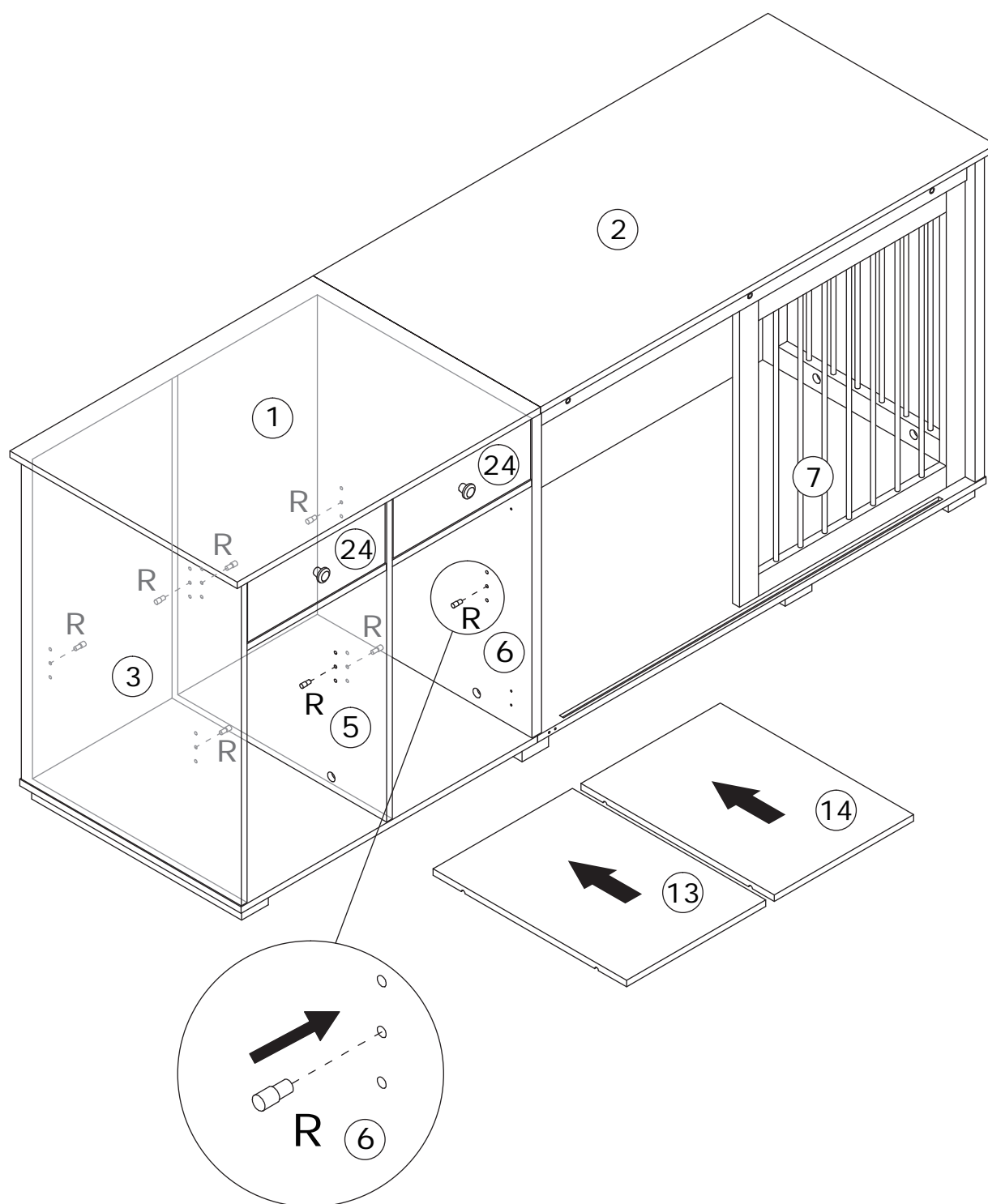

23

F x 8



Ø3.5 x 14 mm

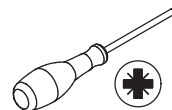

Ø3 x 14 mm

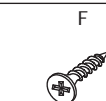

Ø3.5 x 14 mm

Assemble door 16 and 17 to board 3 and 6 by fixing hinge with screw(F) as shown.

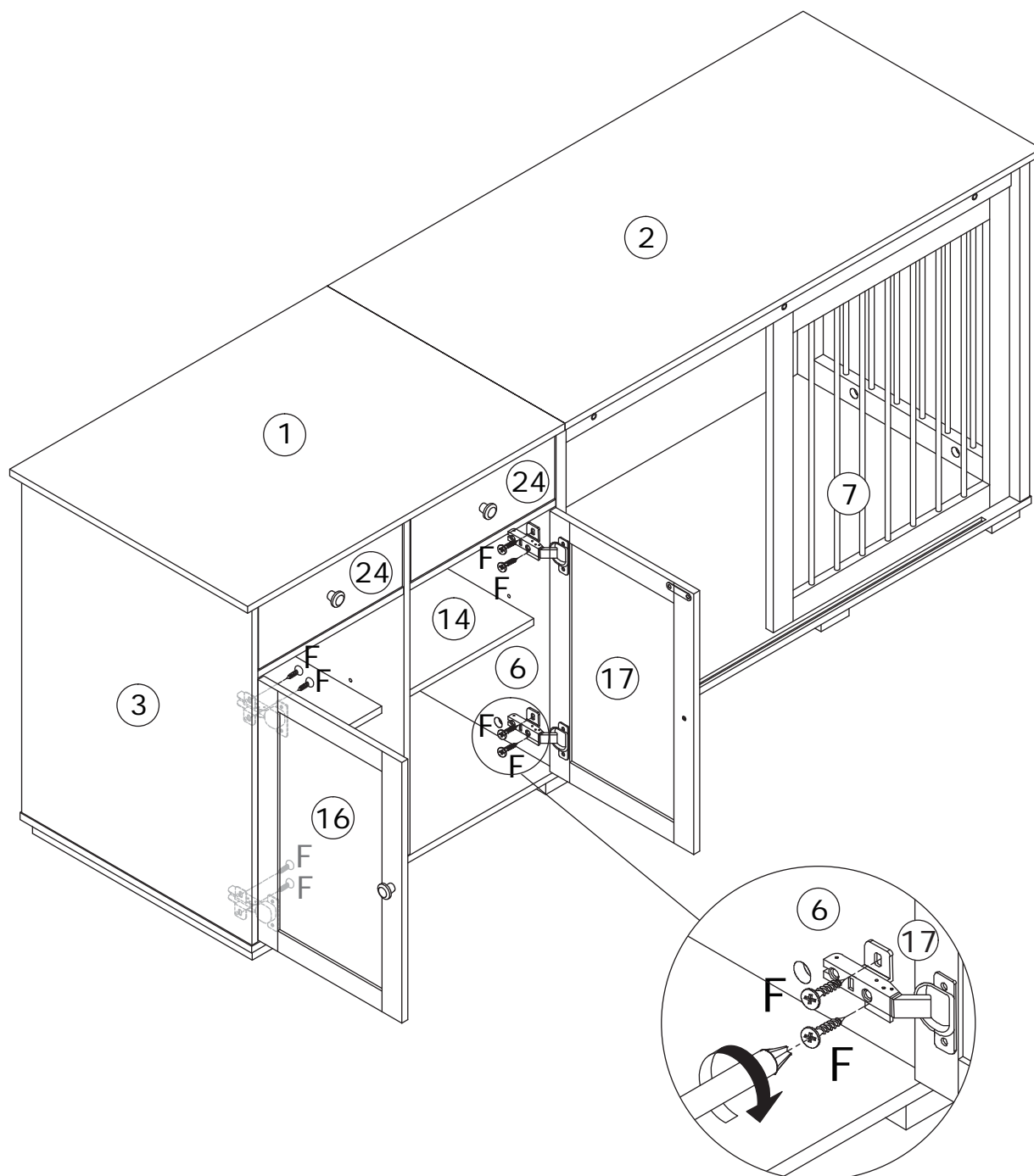

24

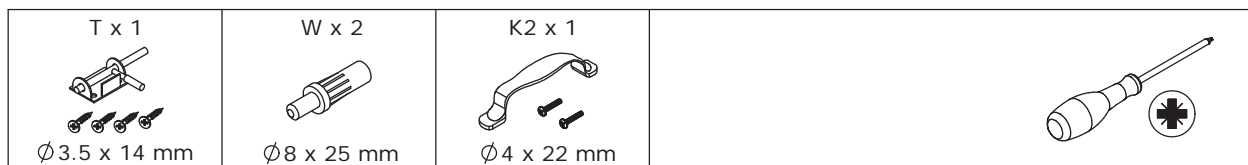

Fix handle(K) and bolt(T) to board 15.
Insert part(W) into board 15 as shown.

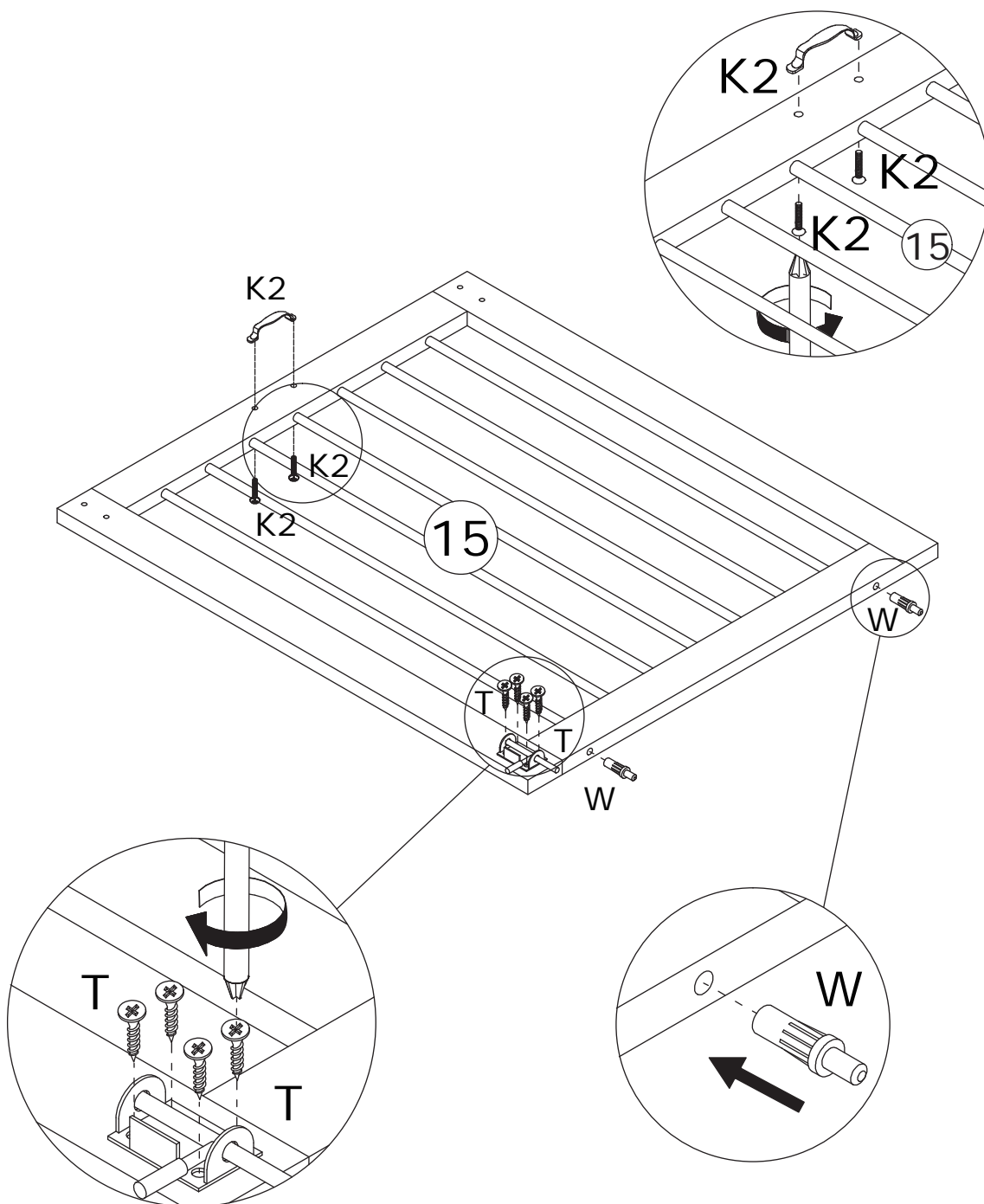

25

J x 3



Ø6 x 25 mm

T x 1



Ø3.5 x 14 mm

S x 1

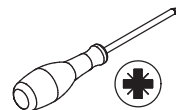
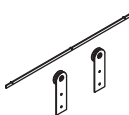

Fix part(S) to board 8 with screw(J) as shown.
Fix bolt(T) to board 10 as shown.

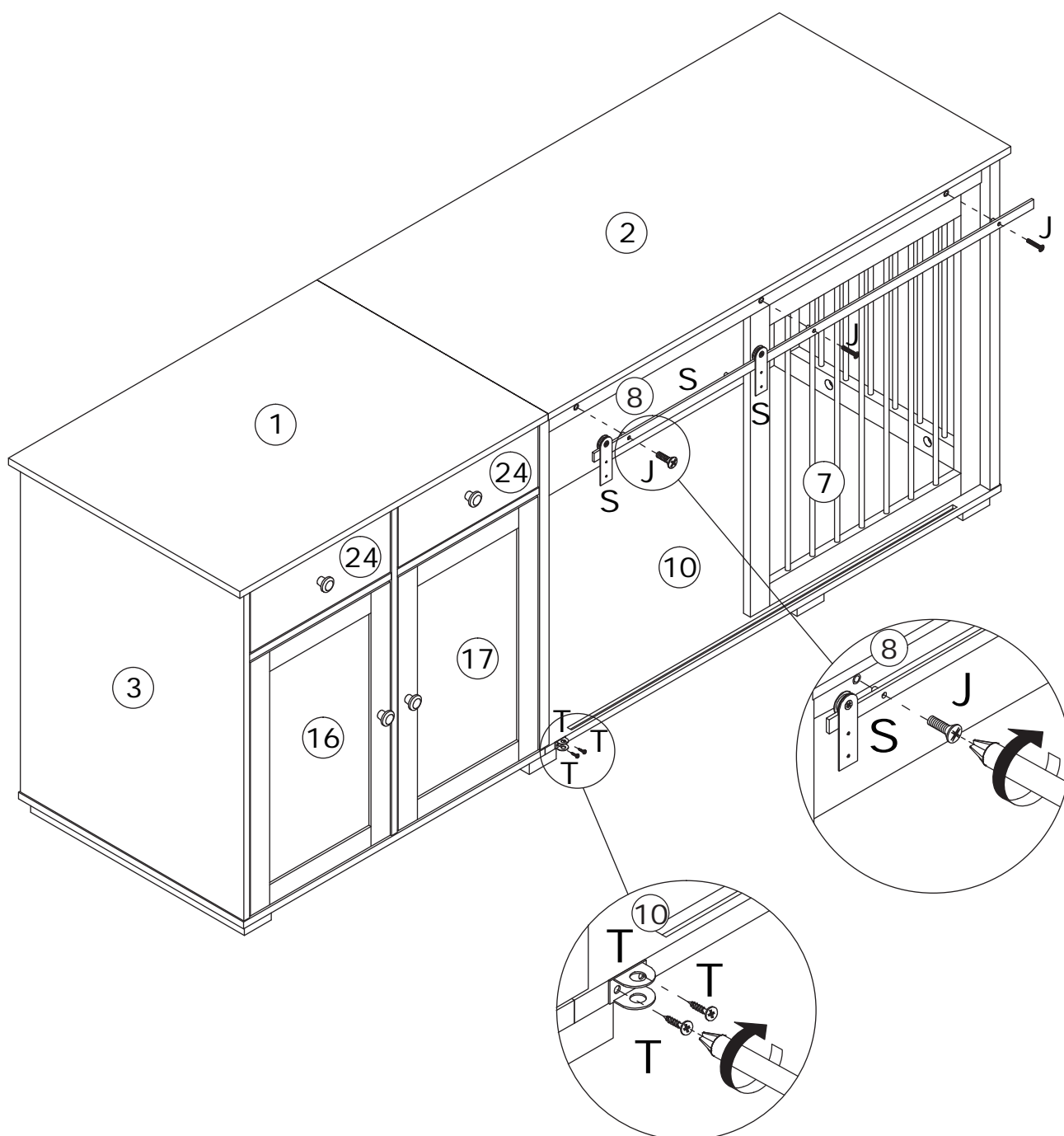

26

S x 4



Ø3.5 x 14 mm

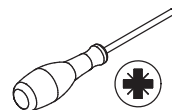

Assemble door 15 to the cabinet.
Fix board 15 to part(J) with screw(S) as shown.

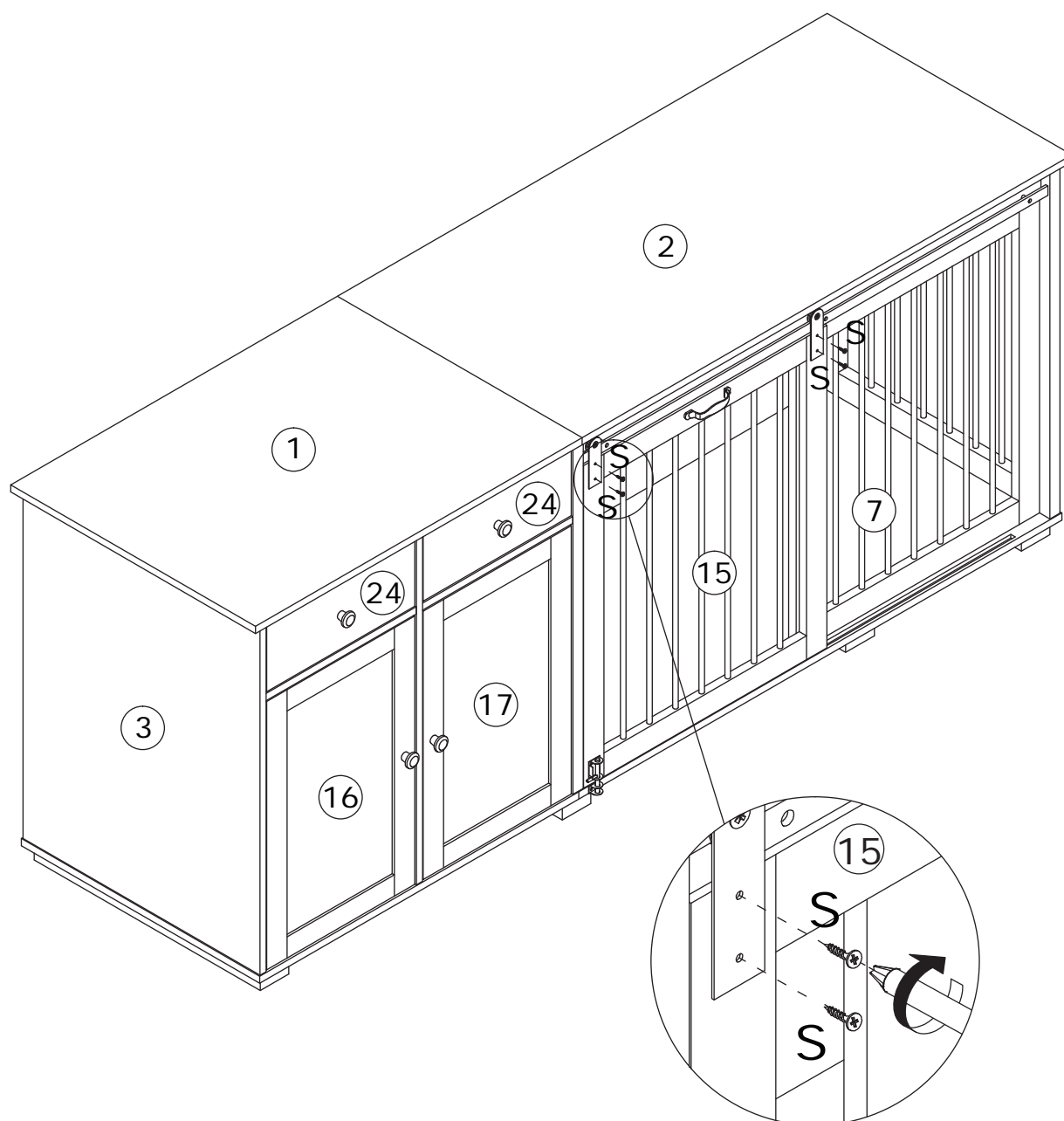

27

U x 8



Ø 25 mm

Y x 46



Ø 20 mm

Stick non-slip mat(U) to the bottom as shown.

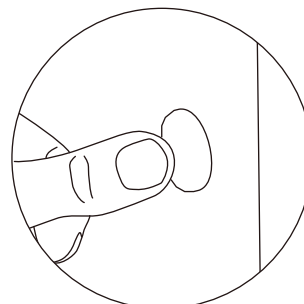
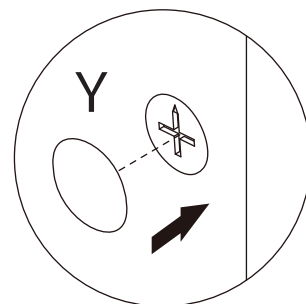
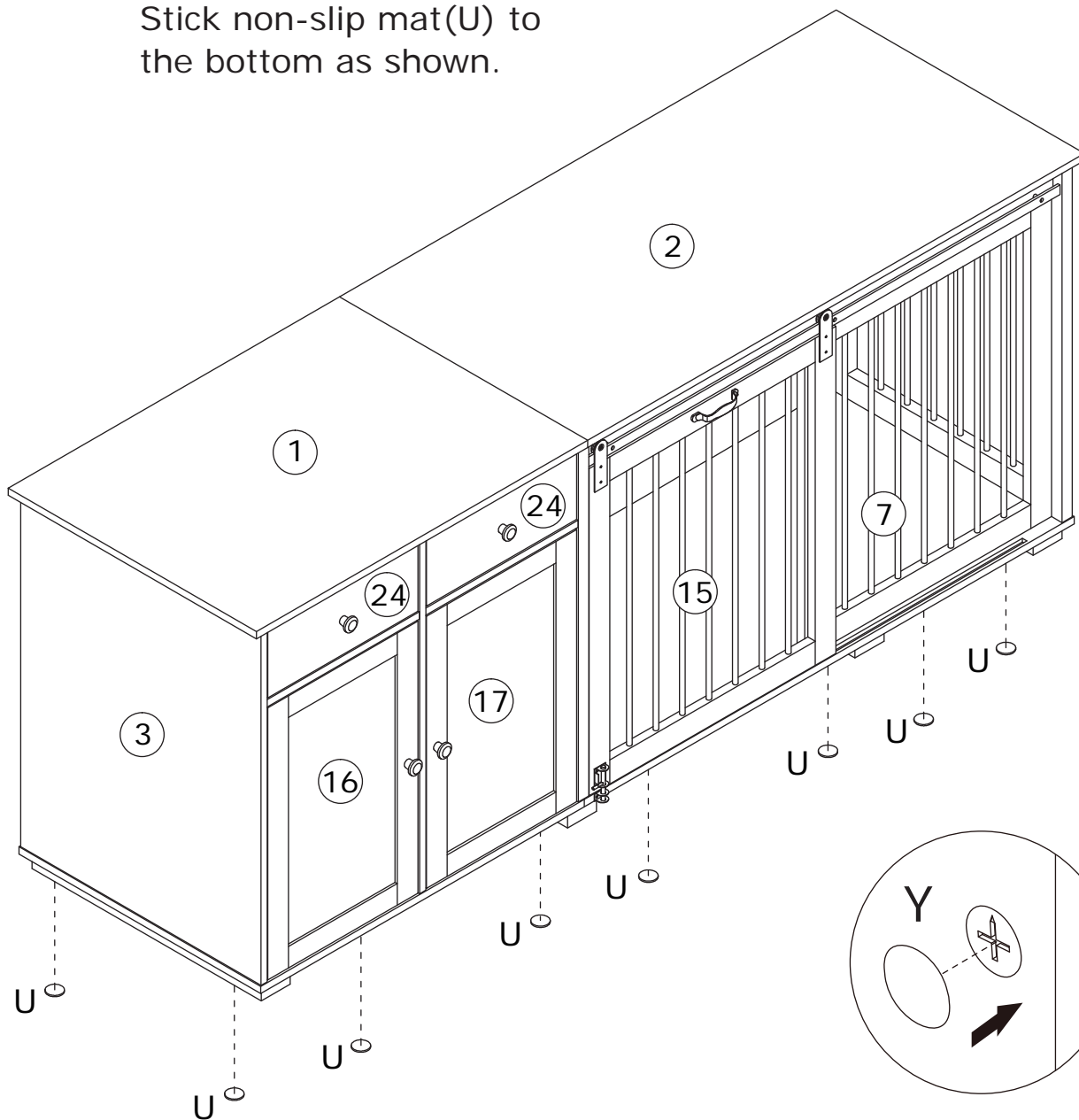

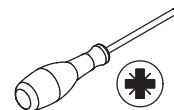

If doors are still not aligned if the hinges are properly correctly, please watch the video.

<https://youtu.be/n0Lb36SoODM>

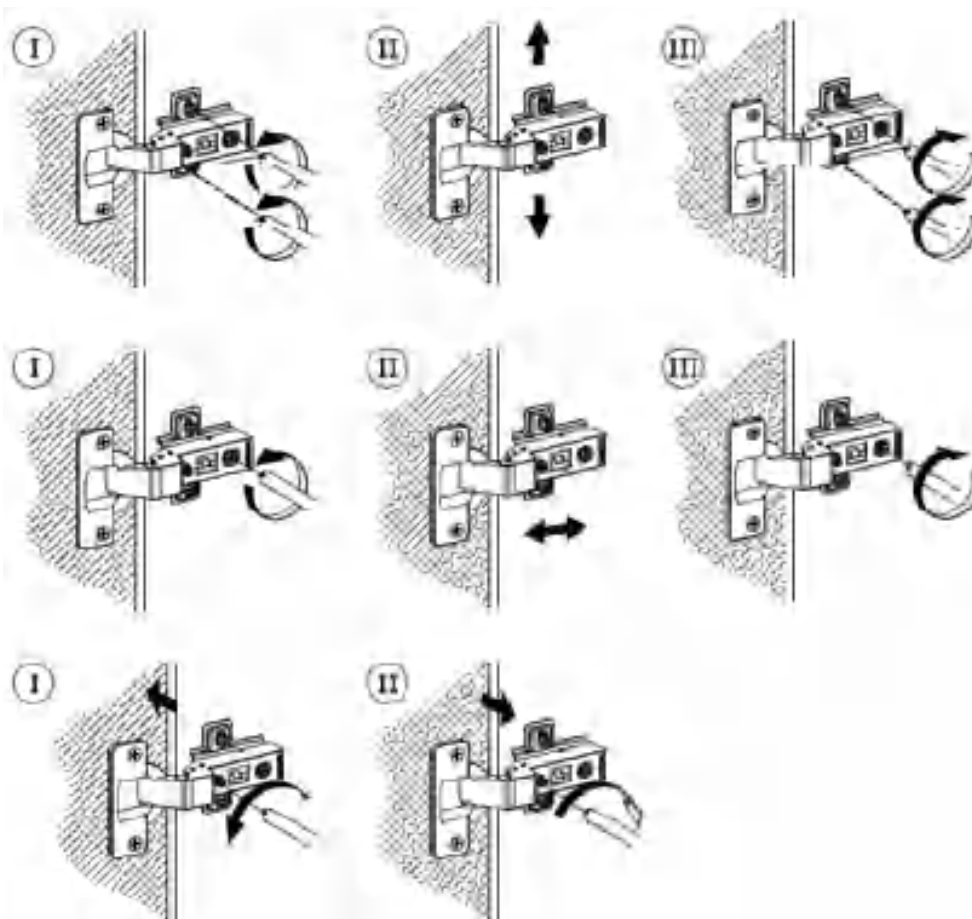
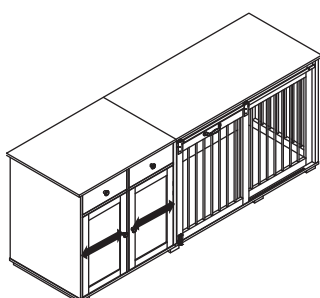
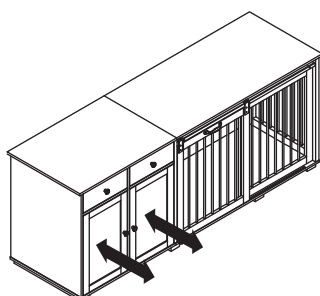
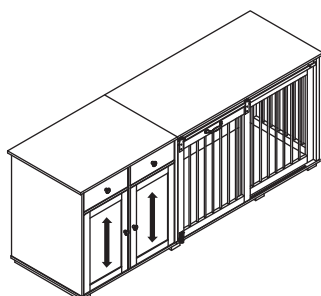
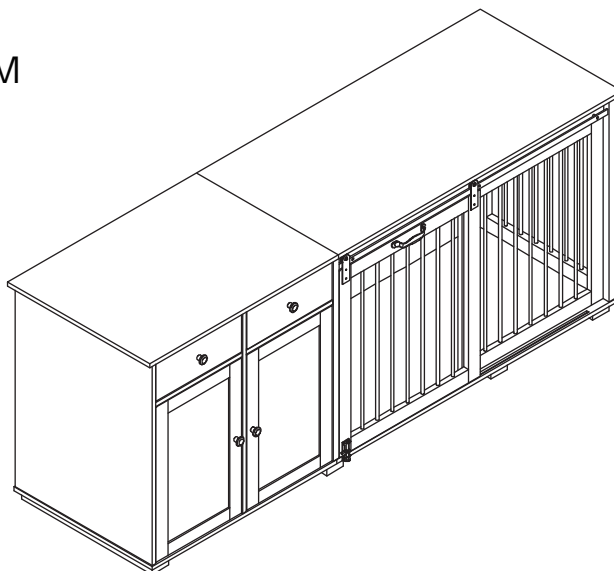

WARRANTY

WARRANTY CLAIMS

- There is a 30-day warranty for broken furniture or any other problems that do not work properly. The warranty will start from the date of purchase which must be verified by proof of purchase.
- Before making a claim, we may be able to answer your query, simply call us. Please leave your purchase order number, along with some details of the problem, if you want a replacement part. We will arrange within 48 hours. If there is out of stock, we will reply with a shipping date.
- The product must be used in accordance with the instructions provided. For health reasons.
- For other reasons, if the furniture needs to be returned, it must be cleaned and dried and operated within 30 days of receipt.

Type of Warranty Claim

- Failure to follow the furniture instructions will invalidate the warranty. Attention please.
- Does not include damage during installation, but includes damage during transportation.

Scope of responsibility

- Shall not bear any responsibility for misuse or user damage and / or loss of parts during the installation of furniture.
- After using, the damage and scratches of the furniture are not covered by the warranty.

The Warranty Relates to All Bought in The Us and Covers The Following Areas

- Sheet parts: 1 month from the date of purchase.
- Electrical parts: 1 month from the date of purchase.

RETURNS

CHANGED YOUR MIND AND NEED TO RETURN YOUR ITEM?

PLEASE FOLLOW THE BELOW INSTRUCTIONS:

- If you have purchased and have simply changed your mind, follow the retailer's instructions for returns.

DEFECTIVE ITEMS

- If your item is defective in any way, i.e. it doesn't work but you can't identify why, in the first instance, please call us.

DAMAGED ITEMS

- If you receive an order with obvious shipping damage from the retailer, then we suggest the delivery is refused. If the delivery has been accepted and then shipping damage is found, please follow the specific instructions advised by the retailer.
In all circumstances please save all packaging material and paperwork for the order. Please be aware that if you dispose of packaging material or attempt to return the merchandise without contacting the fulfiller, you jeopardise your chances of making a claim, and you may not receive a credit for the return.

AFTER-SALES CONTACT

