

INSTALLATION OVERVIEW/VUE D'ENSEMBLE DE L'INSTALLATION

1

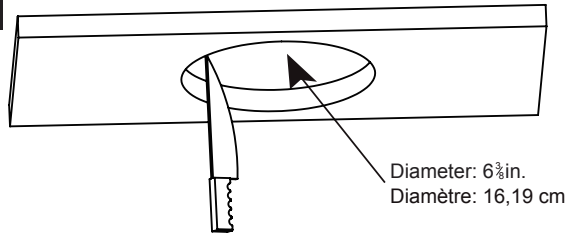

Locate a suitable location for the fixture and cut a 6 1/8 in round hole where the LED Ultra- Thin Downlight(A) will be installed. Ensure this location has access to electrical wire from the switch (power supply).

2

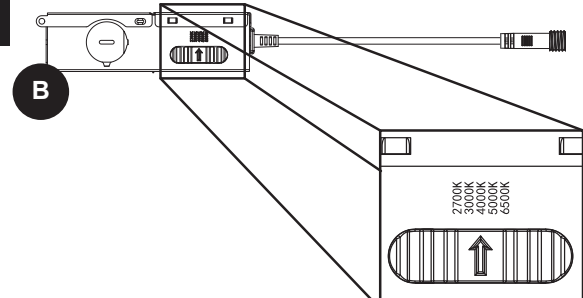

Select desired color temperature.

3

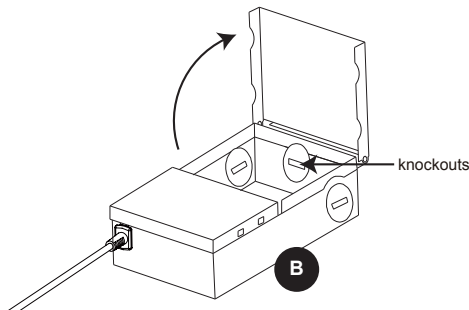

Carefully open the hardwire junction box (B) and remove the appropriate knockout(s).

4

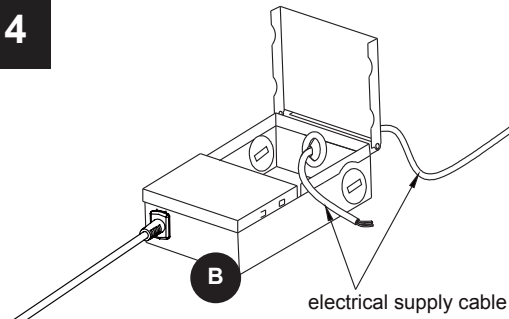

Insert the electrical supply cable through the knockout and secure with a cable connector(sold separately).

5

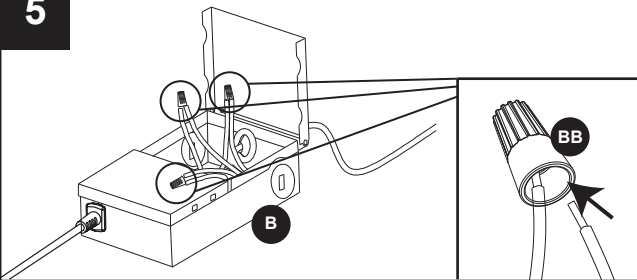

Using wire nuts(BB), connect supply cable to hardwire junction box(B) in the following manner: green to ground, white to white, black to black. Place all wiring connections back into the hardwire junction box (B) and close the cover.

6

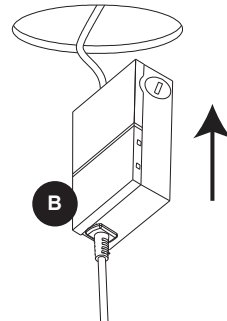

Insert the hardwire junction box (B) through the mounting hole established in Step 1.

7

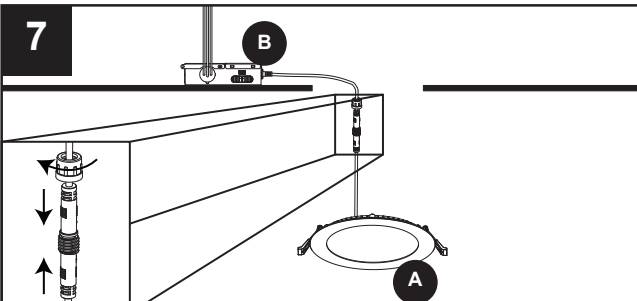

Connect the LED Ultra-Thin Downlight (A) to the hardwire junction box(B) by inserting and twisting the male/female connections of the attached connector cables together.

8

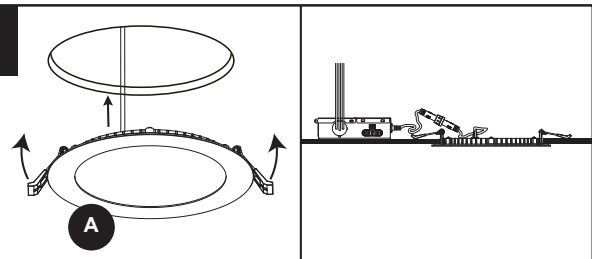

Push the spring loaded clips on the LED Ultra-Thin Downlight(A) upwards and insert the base of the LED Ultra-Thin Downlight(A) into the mounting hole established in Step 1. Release the clips and the fixture will grip flush with the ceiling/drywall.