

KCHS0024-MB

PART LIST

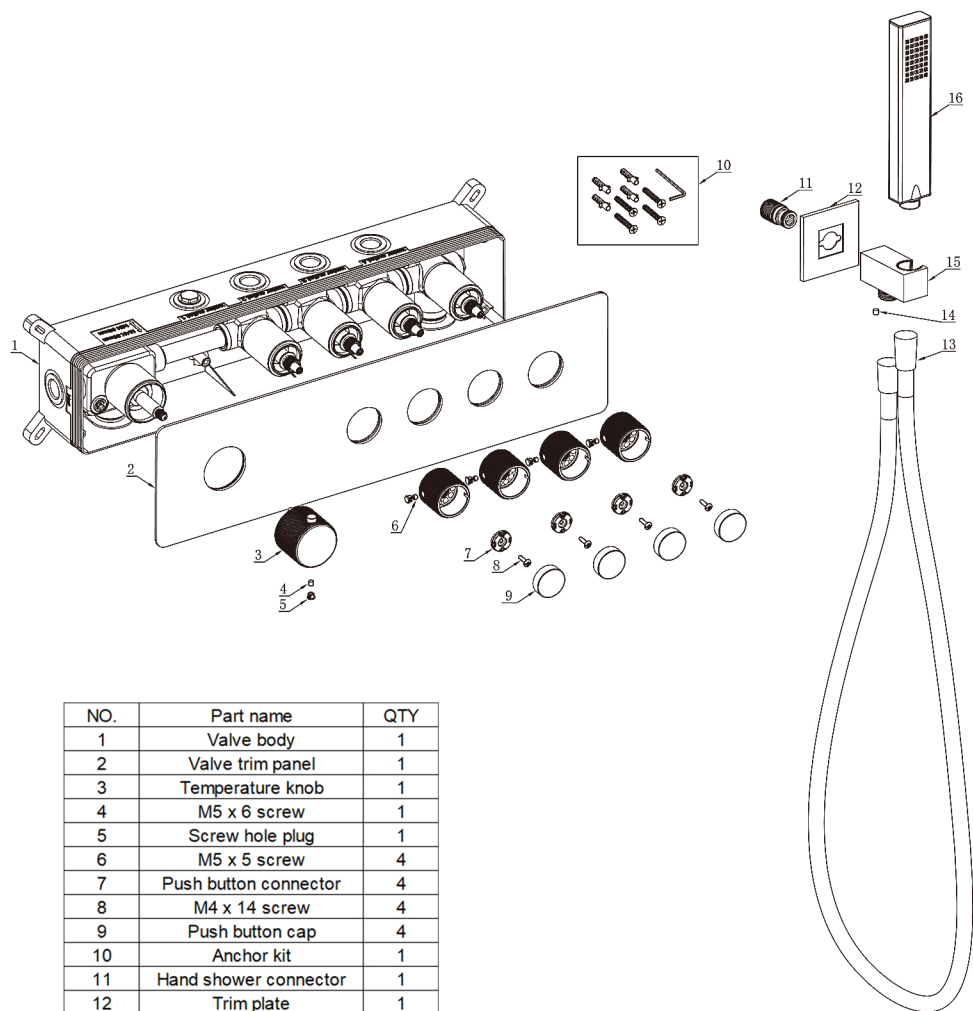

NO.	Part name	QTY
1	Valve body	1
2	Valve trim panel	1
3	Temperature knob	1
4	M5 x 6 screw	1
5	Screw hole plug	1
6	M5 x 5 screw	4
7	Push button connector	4
8	M4 x 14 screw	4
9	Push button cap	4
10	Anchor kit	1
11	Hand shower connector	1
12	Trim plate	1
13	Shower hose	1
14	Set screw	1
15	Hand shower arm	1
16	Hand shower	1

Piping diagram

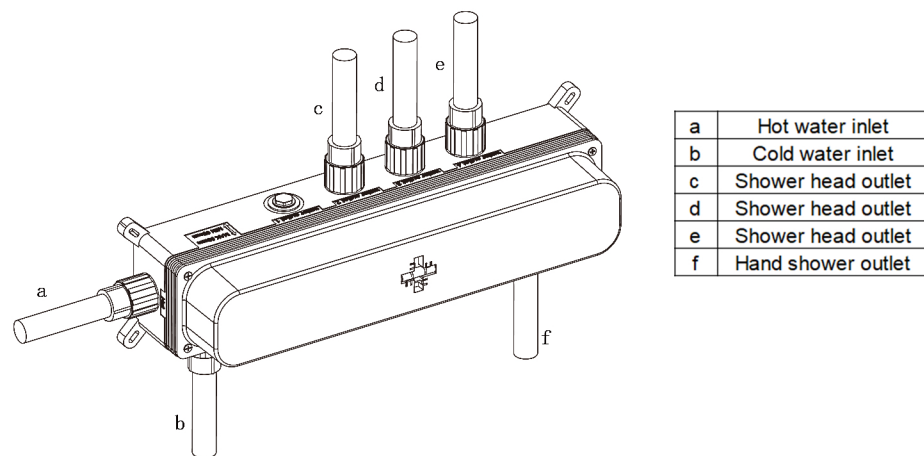

Installation depth of valve body

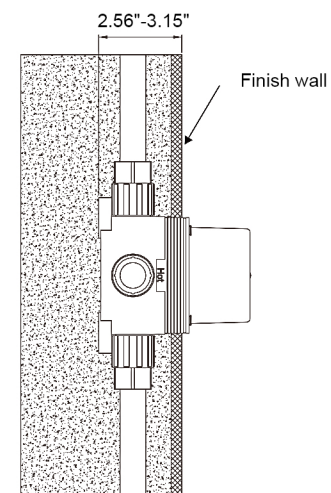

1. Secure the valve body to the mounting surface ensuring the valve body is level.

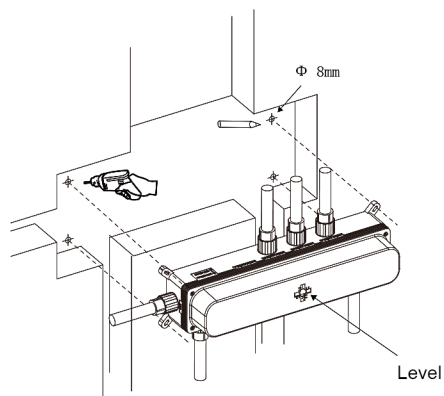

2. Wrap telon tape around the threads of the male adapters and connect the hot, cold, shower head, and hand shower water lines to the valve body.

NOTE: See Step 12 Hand shower installation.

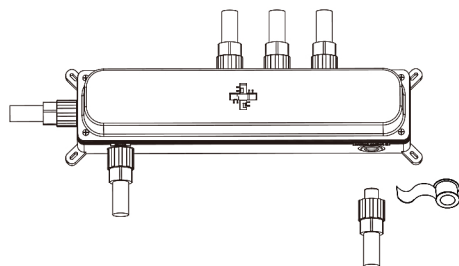

3. After the wall is finished, remove the plasterboard from the valve body and cut the valve body casing flush with the wall if necessary. Discard the plasterboard.

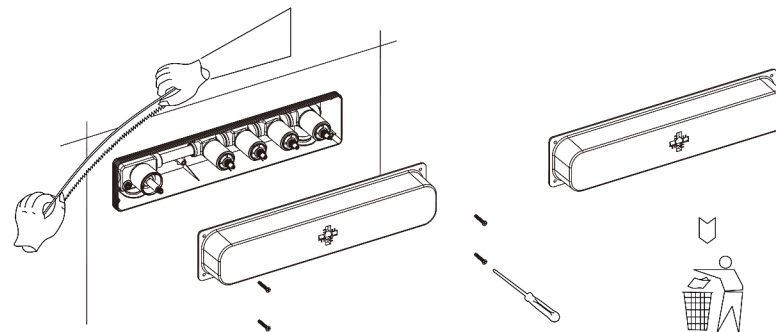

4. Rotate all the valve stems clockwise to their stopping point.

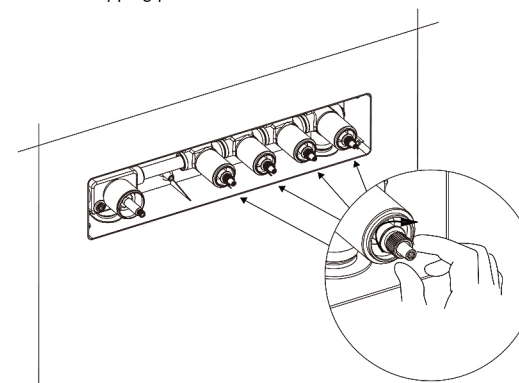

5. On the back side of the valve trim panel, run a bead of silicone around the edge and place it onto the valve body securing it to the finish wall.

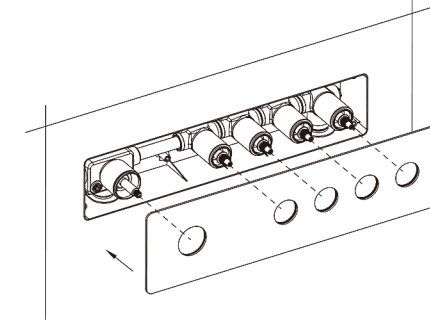

6. Install the valve trim panel and the diverter knobs as shown in the image below. Secure the knobs by using an Allen wrench to tighten the set screws.

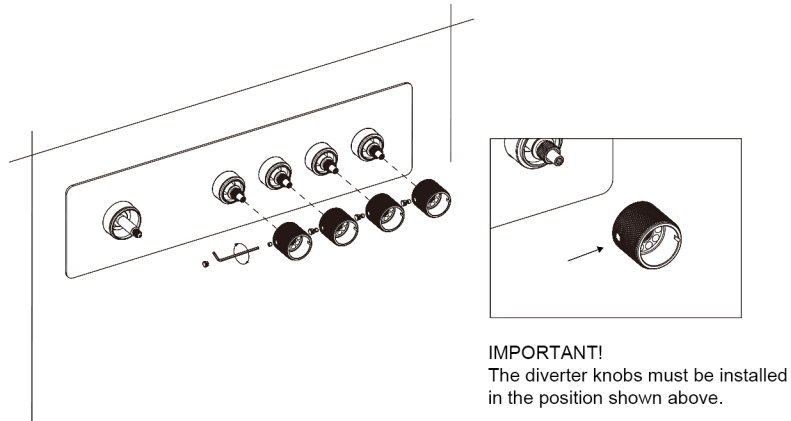

7. Insert the push button connectors into the knobs and secure.

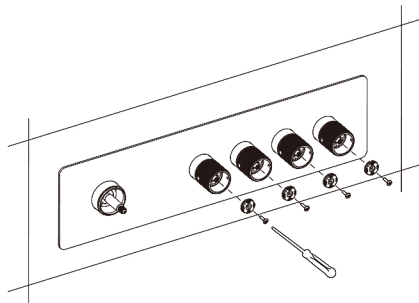

8. Insert the push buttons caps onto the diverter knob connectors making sure that they are even with the end of the knobs.

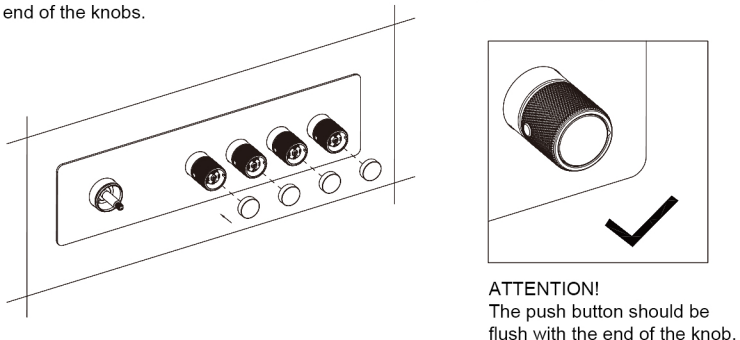

9. Install the temperature control knob exactly how it is shown in the image below. Secure the knob by using an Allen wrench to tighten the set screw.

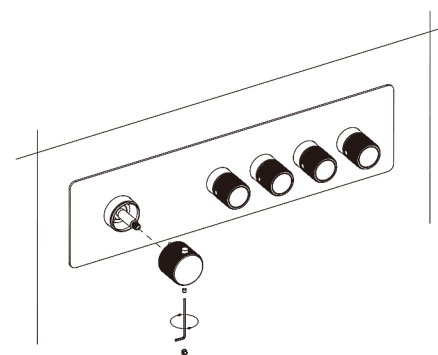

10. Valve trim panel and knob installation finished.

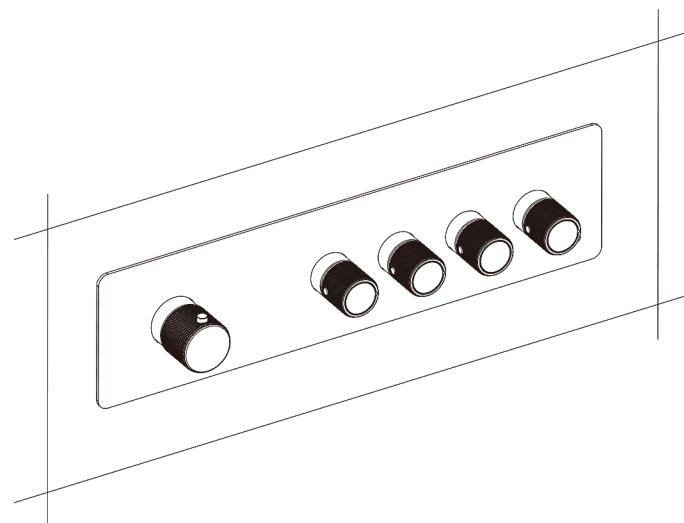

11. Install hand shower arm

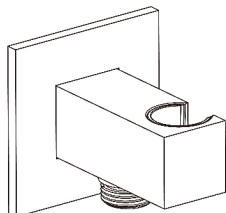

12. When piping the valve body, ensure that the connection for the hand shower is installed correctly, as shown in the images.

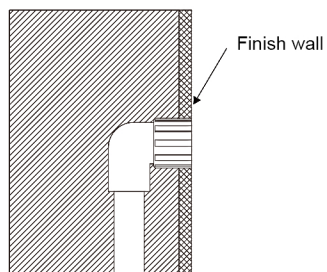
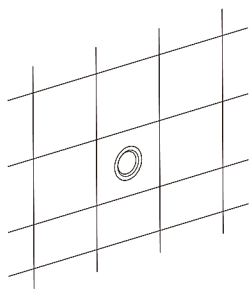

13. Wrap the threads of the hand shower arm connector and screw it into the wall connection, as shown in the images.

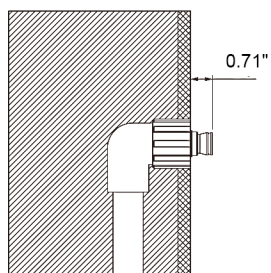
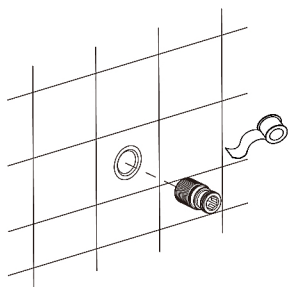

14. Place the trim plate onto the hand shower arm and secure the hand shower arm to the connector.

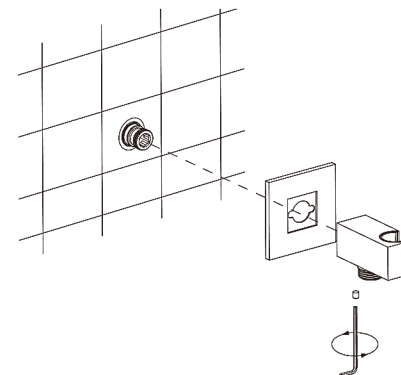

15. Connect the hand shower hose.

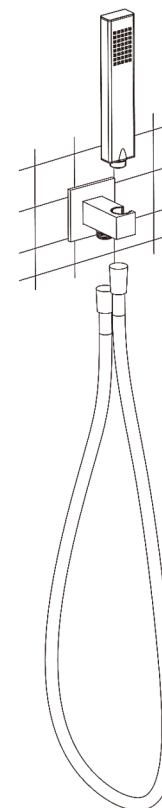

16. Hand shower installation finished.

