

# INSTALLATION INSTRUCTION



**CONCEALED SHOWER**

<b>IAPMO RESEARCH AND TESTING, INC.</b>	
<b>CERTIFICATE OF LISTING</b>	
Issued To: QIANG YONG HOSE FACTORY	Effective Date: April 2021
File Number: N-12008	
Product: Drinking Water System Components - Health Effects	Valid After: April 2025
This certificate is not evidence of current listing. To verify listing status, visit the IAPMO R&T Product Listing Directory at <a href="http://ipm-apprmgw.com">ipm-apprmgw.com</a>	
<b>Identification:</b> Each product shall be permanently and legibly marked with the manufacturer's name or trademark. The product may also be marked with the standard designation "NSF/IANS/ICAN 61".	
<b>Characteristics:</b> Materials or products that come into contact with drinking water and/or drinking water treatment chemicals. Products and materials may include process media, protective materials, joining and sealing materials, pipes and related products, mechanical devices used with treatment/transmission/distribution systems, and mechanical plumbing devices. To be installed in accordance with the manufacturer's instruction. Lead free requirements are addressed under a separate certificate of listing.	
Products listed on this certificate have been tested by an IAPMO R&T recognized laboratory. This recognition has been granted based upon the laboratory's compliance to the applicable requirements of ISO/IEC 17025.	

Page 2 of 4

## IAPMO RESEARCH AND TESTING, INC.

5001 E. Philadelphia Street, Ontario, CA 91761 • 9516 • Fax (909) 472-4200 • Fax (909) 472-4244 • www.iapmurt.org

The ANSI logo consists of the word "ANSI" in bold letters above the words "American National Standards Institute".

The IAPMO R&T logo features the words "IAPMO" in large letters with "R&T" below it, all enclosed within an oval border.

The UL logo shows a stylized letter "U" inside a circle, with the letters "ELECTRICITY" and "LABORATORY" written vertically on either side.

### IAPMO R&T Product Listing

This IAPMO R&T listing is current as of 8/22/2008

The UPC logo depicts a shield shape containing the letters "UPC". Below the shield is a small registered trademark symbol (®).

C

#### Product

Flooring Fixture Fittings

File No. 9338

#### Manufacturer

BREIDENBACH,  
111 HUNTERWOOD HEIGHTS  
WATKINSVILLE, GA 30670

#### Identification:

Each flooring component shall have permanent labeling markings to identify the manufacturer. This marking shall be the same size, typeface, or other mark known to identify the manufacturers. The product shall be free from all other markings required by the standards. The marking shall be placed where it can be readily seen after installation to complete the product or packaging shall also bear the UPDM certification mark.

#### Description:

(Characteristics/Flooring fixture fittings component to be installed in accordance with the Manufacturer's instructions and the requirements of the latest edition of the Uniform Plumbing Code.  
Products listed on this certificate have been tested by an IAPMO R&T recognized laboratory. This recognition has been based solely upon the laboratory's compliance to the applicable requirements of ASME A112.19.1.

Products are in compliance with the following code(s)

- Uniform Plumbing Code (UPC)
- National Fire Protection Association (NFPA)
- International Plumbing Code (IPC)

Products are in compliance with the following standard(s)

ASME A112.19.1—STEEL PIPE, SIZES 1/8"

#### MATERIALS:

Cast Iron, Cast Steel, Carbon Steel, BRASS/BRONZE, COPPER, Stainless Steel, Spring Steel, Tin Snodish, Nickel, Chromium Nippon

Auxiliary Part Number Shown In Schedule L-41g

#### (A) Assembly Type

- 1 Assembled
- 2 Welded Joints Assembled
- 3 Flange

#### (B) Product Type

- 1 Iselator
- 2 Iselator JV
- 3 Elbow
- 4 Tee
- 5 Y-Piece
- 6 Spring Pin Jo
- 7 Vent Pipe Short
- 8 Iselator JV (Insulated)
- 9 Insulator From Thread
- 10 Coupling
- 11 Capthread
- 12 Flow Rate

# IAPMO RESEARCH AND TESTING, INC.

5001 E. Philadelphia Street, Ontario, CA 91761 • Phone (909) 472-4100 • Fax (909) 472-4244 • [www.iapmo.org](http://www.iapmo.org)



## CERTIFICATE OF LISTING

USFMO Research and Testing, Inc. is a product certification body which tests and inspects samples taken from the supplier's stock or from the market or a combination of both to verify compliance to the requirements of applicable codes and standards. This activity is coupled with periodic surveillance of the supplier's factory and warehouses as well as the assessment of the supplier's Quality Assurance System. This listing is subject to the conditions set forth in the Characteristics below and is not to be construed as any recommendation, endorsement or guarantee by USFMO Research and Testing, Inc. of the product certificate authority Authorizing Having Jurisdiction.

*Issued To:*

### QIANG YING HOSE FACTORY

BLOCK 1, NO. 225 JIAOXING NORTH ROAD, SHURUO TOWN, KAPING, GUANGDONG, CHINA

*Product:*

### Drinking Water System Components - Health Effects

*Products are in compliance with the following standard(s)*  
NSF/ANSI/CAN 61-2018

File Number: N-12908  
Effective Date: April 2021  
Valid After: April 2026\*



*Susan O'Connell*  
Customer Product Certification Specialist

*Chief Technical Service Officer*

\*This listing period is of indefinite or current listing. To verify listing status, visit the USFMO R&T Product Listing Directory at [pds.iapmo.org](http://pds.iapmo.org)

This listing period is based on the date of the month indicated on this listing and may differ from other dates. Any change or material manufacturing process, material or design without being approved or approval of the Product Certificate Commission, or any violation of non-compliance with applicable rules and standards or of inferior performance may be deemed sufficient cause for revocation of this listing. Publication of an addition to this form for affecting purposes may be made only by specific permission of USFMO Research and Testing, Inc. Any alteration of this certificate should be grounds for revocation of the listing. This document shall be reproduced in its entirety.

Page 1 of 4

# IAPMO RESEARCH AND TESTING, INC.

## CERTIFICATE OF LISTING

Issued To: QINANG YING HOSE FACTORY

Effective Date: April 2021

NSF/ANSI/CAN 6.1

File Number: N-12908

Product: Drinking Water System Components - Health Effects

Valid After: April 2026

This certificate is not evidence of current listing. To verify listing status, visit the IAPMO R&T Product Listing Directory at [prod.usp.org](http://prod.usp.org).

### Models

**Note:** The following models are in compliance with NSF/ANSI/CAN 6.1, Section 9.

#### Flexible Braided Hose

Legend Format	Description
PEX-QY-BuB-C-***	
<b>B</b>	Type of Nut/Connection Fitting
-F3/8	
-F1/2	
-F3/4	
-F1S*1	
-M3/8	
-M1/2	
-M3/4	
-M1"	
-M1 1/2"	
-M1 1/4"	
-M1 3/4"	
-1/2"OD BM	
-SPRUE/MPF	
-CH10 Quick Connect	
-push fit	
-push fit-three way	
<b>C</b>	Type of outer tube
-stainless steel braided	
-nylon braided	
***	Length (in cm)
20cm - 200cm	

Page 1 of 4

[illegible]

# BEFORE INSTALLATION

This product has been inspected and debugged by the factory to the best condition. Please do not disassemble and assemble it yourself.

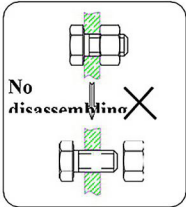

Before installing the faucet, please be sure to remove sundries and sludge from the water pipe to prevent sundries from blocking the faucet.



## Freestanding Bathtub Faucet Manual

1.Please check everything component by the list below after you open the package, make sure nothing missing, any questions please contact us feel free, we will reply within 24 hours. and solve the issue together with you.

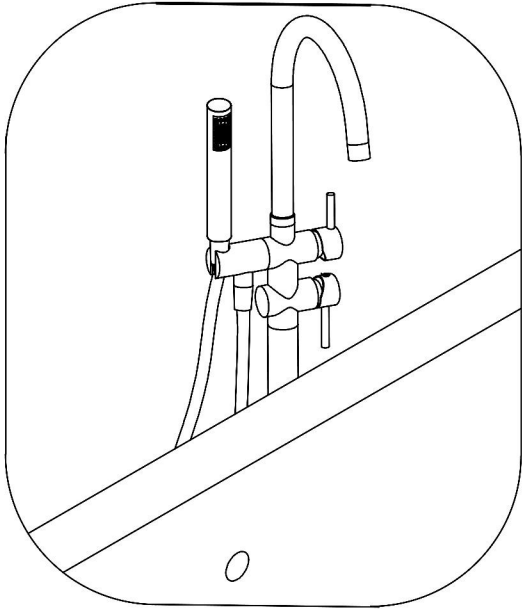

NO.	Part	PCS
1	Main Body	1
2	Straight Tube	1
3	Decorative Cover	1
4	Inlet Tube	2
5	Bolts Holder	1
6	Expansion Bolts	3
7	Shower Head	1
8	Shower Tube	1
9	Manual	1

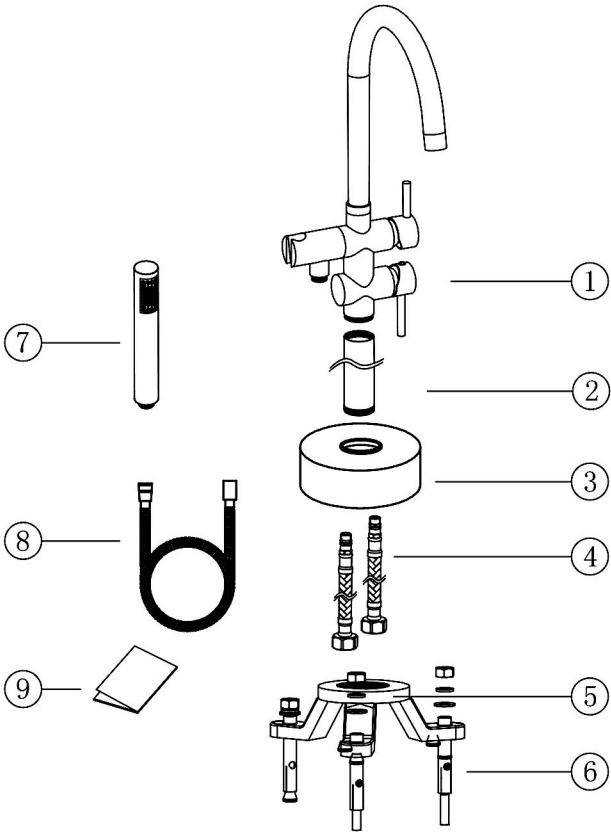

2.Using the faucet for a matching height bathtub.



# INSTALLATION STEPS

1. Connect the straight tube, decorative cover and bolts holder to inlet tube then screw the inlet tube to main body.

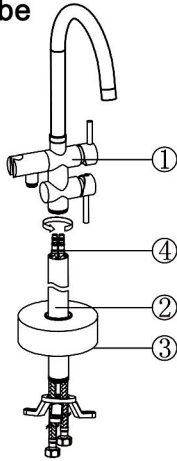

2. Connect the main body with straight tube by twisting it.

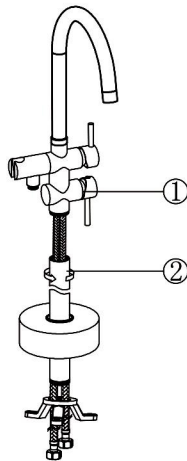

3. Prepare water inlet like the drawing below.

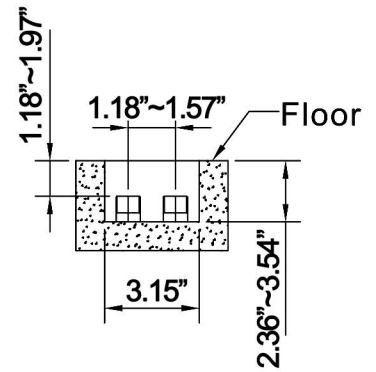

4. Connect the inlet tube like the drawing.

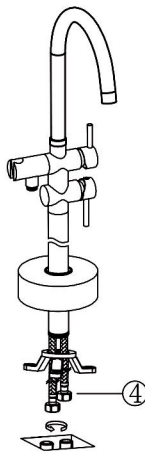

5. Twist the bolts holder to the faucet.

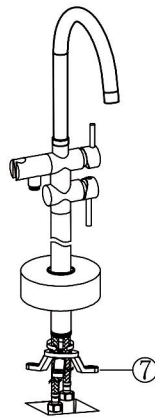

6. Drill holes on floor based on the drawing.

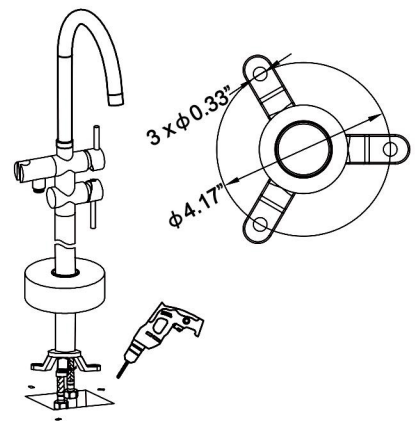

7. Tighten the expansion bolts.

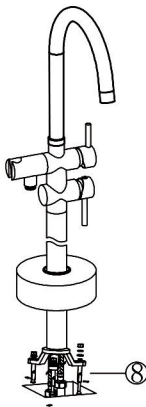

8. Twist the shower tube to both faucet and shower head.

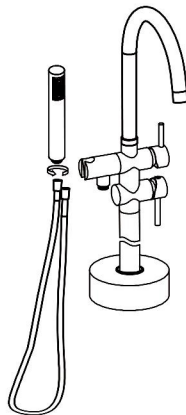

9. Finished assembly.

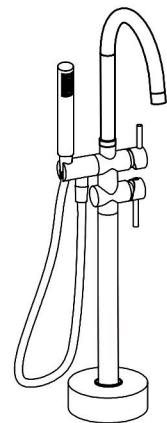

## CLEANING CARE

In order to keep the appearance of faucet clean, bright and good performance, please take care of the faucet as follows;

1. Rinse with water only and dry with soft cotton cloth;
2. Use mild liquid and colorless glass cleaner to remove surface dirt and scale film, or use polish without abrasive effect;
3. Do not use abrasive detergent, polish, emery cloth, paper towel or scraper, etc.;
4. Do not use acid cleaner, or cleaner and soap with insoluble gran etc.;
5. In the process of use, mud may accumulate in the bubbler and make the water flow slow. The bubbler can be unscrewed, rinsed with water, and then installed back in place.





