

USE AND CARE GUIDE

25 IN- 72 IN BACKSPLASH AND 21.25 IN SIDESPLASH

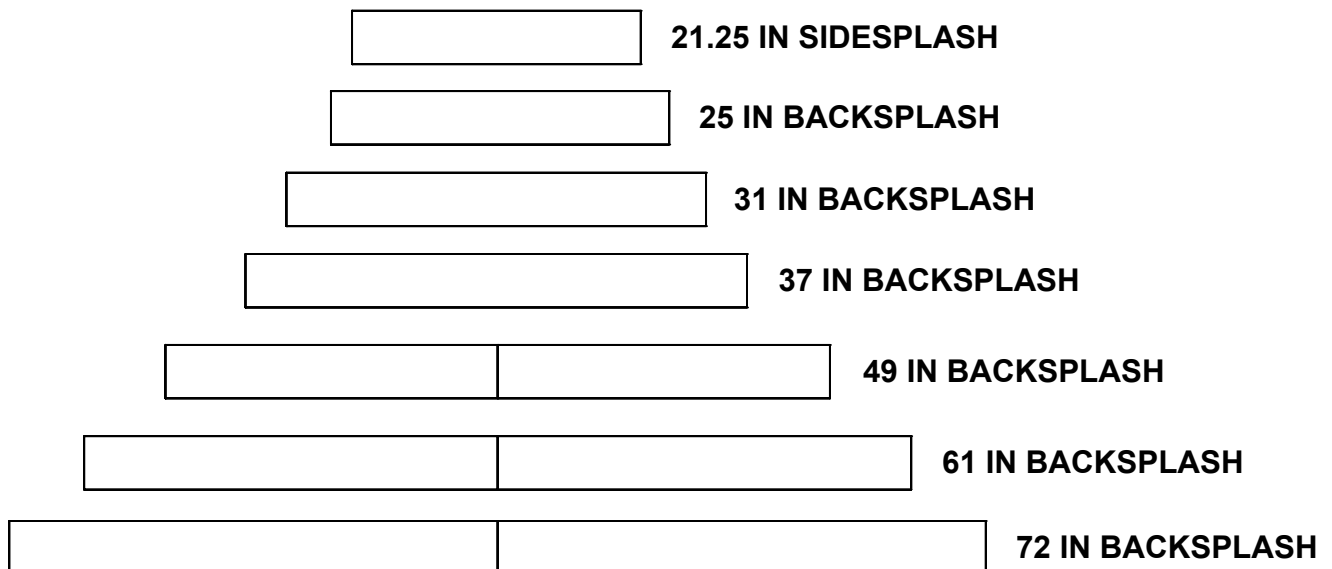

Questions, problems, missing parts?
Before returning, contact us on:
info@tjamerican.com
TJAMERICAN.COM

THANK YOU

We appreciate the trust and confidence you have placed in TJAmerican LLC through the purchase of this Vanity.

Visit us online to see our full line of products available for your home improvement needs.

SPECIFICATION

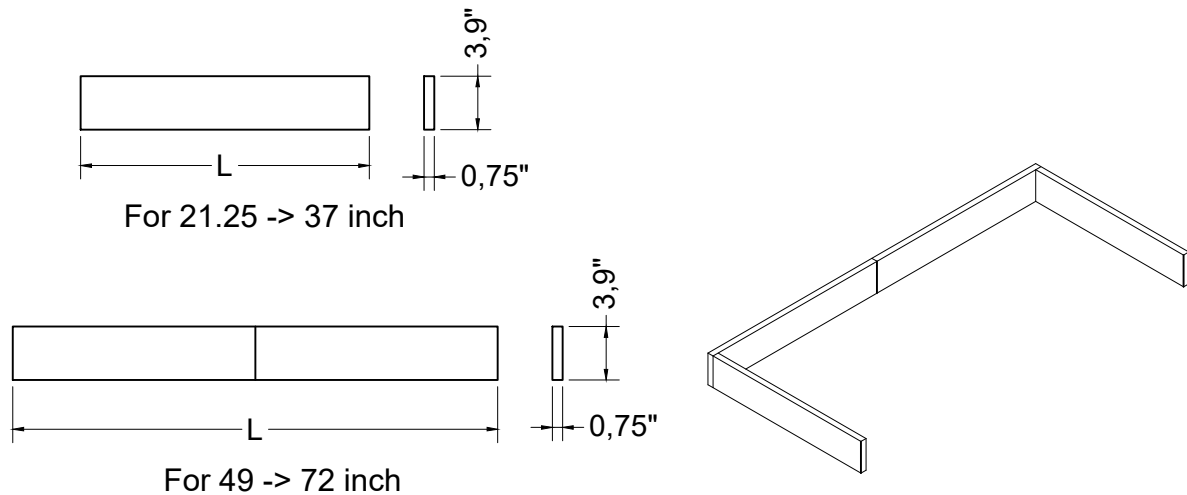

PART	ITEM CODE	DESCRIPTION	LENGTH (L)
A	TJ25-40BS300	25" Natural Carrara Backsplash	25"
	TJ25-40BS100	25" Engineered Carrara Backsplash	25"
	TJ25-40BS101	25" Engineered White Backsplash	25"
	TJ25-40BS305	25" Granite Backsplash	25"
	TJ31-40BS300	31" Natural Carrara Backsplash	31"
	TJ31-40BS100	31" Engineered Carrara Backsplash	31"
	TJ31-40BS101	31" Engineered White Backsplash	31"
	TJ31-40BS305	31" Granite Backsplash	31"
	TJ37-40BS300	37" Natural Carrara Backsplash	37"
	TJ37-40BS100	37" Engineered Carrara Backsplash	37"
	TJ37-40BS101	37" Engineered White Backsplash	37"
	TJ37-40BS305	37" Granite Backsplash	37"
	TJ49-40BS300	49" Natural Carrara Backsplash	49"
	TJ49-40BS100	49" Engineered Carrara Backsplash	49"
	TJ49-40BS101	49" Engineered White Backsplash	49"
	TJ49-40BS305	49" Granite Backsplash	49"
	TJ61-40BS300	61" Natural Carrara Backsplash	61"
	TJ61-40BS100	61" Engineered Carrara Backsplash	61"
	TJ61-40BS101	61" Engineered White Backsplash	61"
	TJ61-40BS305	61" Granite Backsplash	61"
B	TJ72-40BS300	72" Natural Carrara Backsplash	72"
	TJ72-40BS100	72" Engineered Carrara Backsplash	72"
	TJ72-40BS101	72" Engineered White Backsplash	72"
	TJ72-40BS305	72" Granite Backsplash	72"
	TJ22-40SS300	21.25" Natural Carrara Sidesplash	21.25"
	TJ22-40SS100	21.25" Engineered Carrara Sidesplash	21.25"
	TJ22-40SS101	21.25" Engineered White Sidesplash	21.25"
	TJ22-40SS305	21.25" Granite Sidesplash	21.25"



Note: Parts sold separately upon purchase, not included in a combo.

IMPORTANT

- ☐ Shade variations and patterns are an inherent characteristic of stone (e.g. granite, marble, engineered stone). Stone tops will vary from product to product. Use caution placing items such as soap or any fragranced material on the stone surface. Use a soap dish, coaster or similar item to protect the surface if placing any soap or fragranced products on the stone.
- ☐ If soap or fragranced products come in contact with the stone top, rinse the surface with water and dry using a soft non-abrasive cloth.
- ☐ **WARNING:** Must use cleaning agents safe for stone. Check your cleaning agents use restrictions before using on any stone. Damage to the stone may result. The manufacturer not responsible for damage caused by improper cleaning agents or soaps used. Warranty will not cover damage caused by the use of improper soaps or cleaning agents.
- ☐ **DO NOT** use products to clean the stone top that contain acetone, lemon, vinegar or other acids as these may cause damage to the stone surface.
- ☐ Periodically reseal the stone top using an appropriate stone sealer available from your local home store. Follow the manufacturer's directions on how to apply.

ASSEMBLY

1. Applying silicon to the Backsplashes

- Apply silicone to the unpolished back side, bottom, and one side of the backsplashes (A) for 49-72" backsplash.
- Place the backsplashes (A) on the vanity.
- Be sure to align the backsplash (A) with the top of the vanity.



Note: Make sure the veining is matched between two backsplashes when the backsplashes come in two pieces and have veining on them.

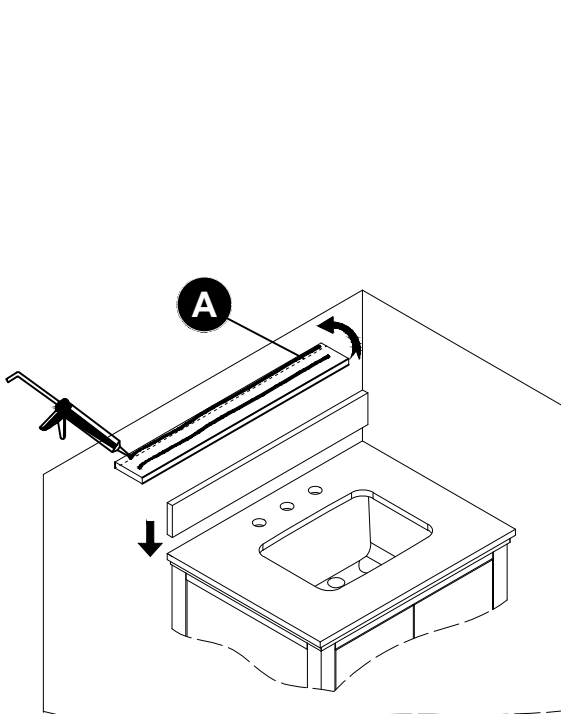

For 25 -> 37 inch backsplash

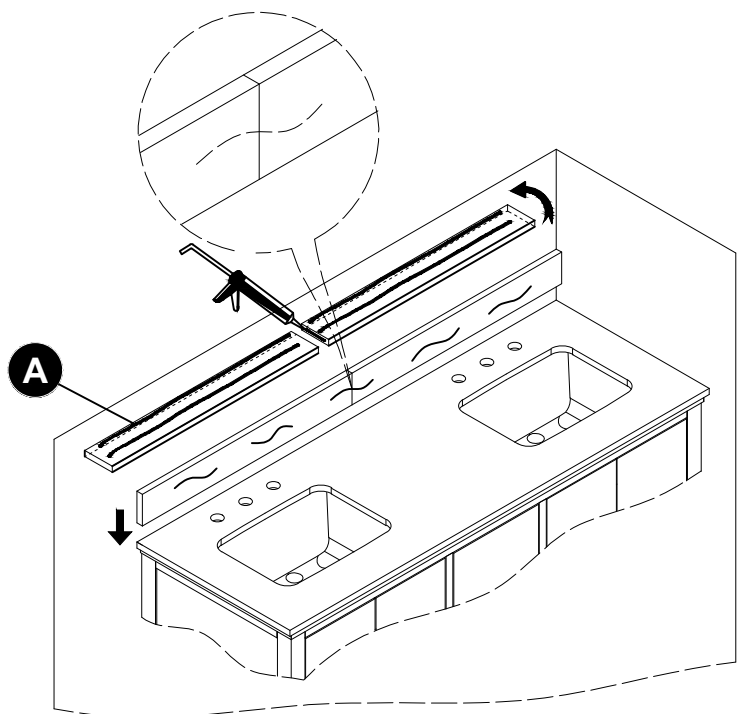

For 49 -> 72 inch backsplash

ASSEMBLY

2. Applying silicon to the Sidesplash (if purchased)

- Apply silicone to the unpolished back side, bottom, and the side touches backsplash (A) of the sidesplash (B).
- Place the sidesplash (B) on the vanity.
- Be sure to align the sidesplash (B) with the top of the vanity.

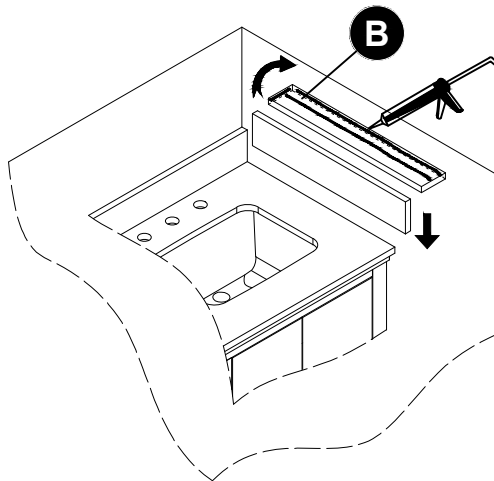

3. Removing silicon to the backsplashes and sidesplash

Gently remove excess glue from the connecting area.

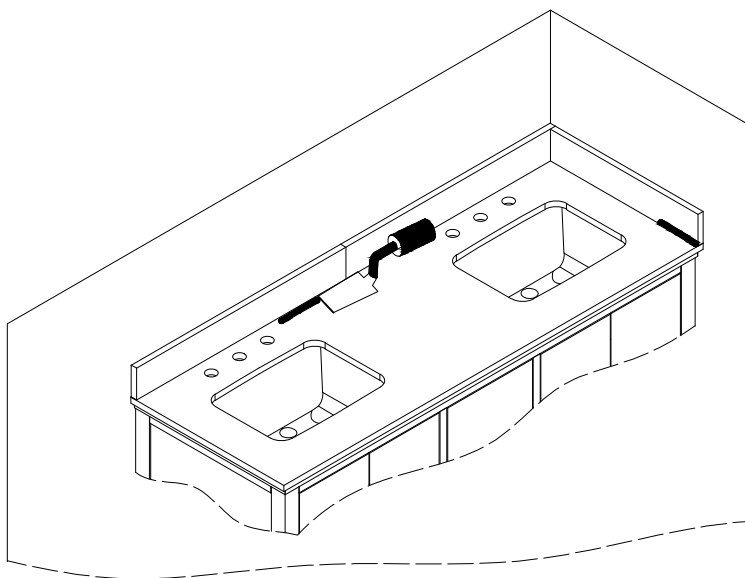

ASSEMBLY

4. Needing time for silicon to be dried

Let the vanity and backsplashes, sidesplash sit for 24 hour before use.

