



SMART HOME ADAPTER

User manual

HD2018GH

- These safety precautions are for owner's safety and prevention of property damage. Therefore, please read this manual thoroughly before using your product.

SAMSUNG





Contents

What is the SMART HOME ADAPTER?	3	Specification	9
Application of the SMART HOME ADAPTER	3	Open Source Announcement	9
SmartThings app	4	Safety information	10
Connecting network	4	Troubleshooting	13
Connecting the wireless IP router with an SMART HOME ADAPTER	6		
Downloading the SmartThings app	6		
Registering Samsung account	7		
Connecting the product to SmartThings app	8		



What is the SMART HOME ADAPTER?

The SMART HOME ADAPTER is an optional accessory that is used to enable Wi-Fi and/or run the SmartThings app on compatible appliances (not included) of Samsung Electronics Co., Ltd.

Application of the SMART HOME ADAPTER

- Use the SMART HOME ADAPTER for compatible Samsung appliances. Visit Samsung.com for a list of compatible devices.

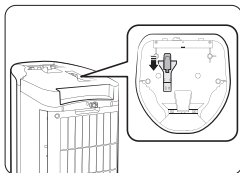

Floor standing Air conditioner

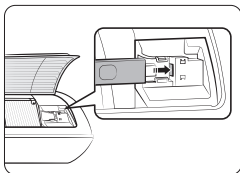

Wall-mounted Air conditioner

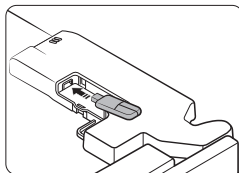

Refrigerator



SmartThings app

Connecting network



NOTE

- This SMART HOME ADAPTER support only below three encryption.
 - Open (No encryption), WPA/TKIP, WPA2/AES
 - You may not be able to establish Wi-Fi connection if other type of encryption is used.
- For SMART HOME ADAPTER installation, select SMART READY appliance location near to wireless router. In case Wi-Fi signal strength is weakened, SmartThings app may be disconnected depending on the Wi-Fi signal strength.

- Smart-Phone should be in the Wi-Fi signal zone to use SmartThings app.
- For Mobile broadband internet access, SmartThings app can be used when Mobile Broadband Adapter is activated to use Wi-Fi.
- This product supports only DHCP(Dynamic Host Configuration Protocol). If users use an existing wireless router, the DHCP server option function should be activated.
- Select a channel for the wireless router that is not currently being used.
- If a wireless router is connected by other than the above modes, the router may not be connected with the SMART HOME ADAPTER or may not work. To use 802.11n, using WPA2/AES is recommended.



-
- The quality of wireless network connection can be affected by the surrounding wireless environment.
 - If an internet service provider has permanently registered the users PC or MAC address (a unique identifying number), the SMART HOME ADAPTER might not be connected to internet. When appliances other than a PC are to be connected to Internet, ask your ISP (Internet service provider) about the procedures required to connect to the internet.
 - If your internet service provider requires an ID or a password to connect to the internet, your SMART HOME ADAPTER may not be able to connect to the internet. If this is the case, you must enter your ID or password when connecting to the internet.
 - The internet connection may fail because of a firewall problem. If this is the case, contact your internet service provider.
 - If you cannot connect to the internet even after you have followed the procedures of your internet service provider, please contact a samsung service center.



SmartThings app

Connecting the wireless IP router with an SMART HOME ADAPTER

- For wireless router installation, refer to the user manual of the corresponding router.
- Samsung SMART HOME ADAPTER supports the communication protocols of IEEE802.11 b/g/n(2.4GHz).
- For wireless router installation, refer to the user manual of each manufacturing company. Samsung does not provide customers with the wireless router manual.
- Uncertified router may not be able to connect with an SMART HOME ADAPTER.
- Certified router has the logo of below on the package or user manual.

Downloading the SmartThings app

- You can download the SmartThings app on your smart phone by searching "SmartThings(Samsung Connect)" on Play Store, Galaxy Apps or iPhone app Store.



NOTE

- The SmartThings app is not compatible with tablets and some devices.
 - Android OS 6.0 or later (with at least 2 GB RAM) is recommended.
 - Supported screen resolutions: 1280 x 720 (HD), 1920 x 1080 (FHD), 2560 x 1440 (WQHD)



- The SmartThings app is not compatible with some Apple devices including iPad and some smartphones.
 - iPhone 6 or later with iOS 10.0 or later is supported.
 - Supported screen resolutions: 1334 x 750, 1920 x 1080
- The SmartThings app may change without prior notice to improve product usability and performance.

Registering Samsung account

Log in with a Samsung account

- To use the SmartThings app, Samsung account is required. Log in the system following the instructions from the SmartThings app. You do not need to install an app.

NOTE

- If you have a Samsung smart phone account, log in with the account. If you are Samsung smart phone user, automatically log in followed.



SmartThings app

Connecting the product to SmartThings app

- To control the product remotely, first connect the product to SmartThings app. Download and install the app, and then configure the settings by following the instructions on the screen.

Registering your product to the SmartThings app

- 1 Make sure your smart phone is connected to the wireless network. If not connected, launch the **Settings app**, select the **wireless network (Wi-Fi)** to **On**. And then select an AP to connect.
- 2 Launch the SmartThings app on your smart phone.

3 When a pop-up window appears to indicate that a new device is found, touch **Add**.

- When you run the SmartThings app, products other than the ones you want to connect to may be found if other SmartThings-compatible products exist in the surroundings. (Temporarily disconnect the power cables from products other than the ones you want to connect to.)
 - When pop-up window does not appear, touch "Add device" and then select a product to connect from the list.
- 4 Connect your product to the SmartThings app by following the instructions on your smart phone.



Specification

Dimensions	79.5 x 28.1 x 10.7 mm
Weight	13 g
Power consumption	Maximum 2.0 W
Wireless LAN protocol	IEEE 802.11b/g/n (2.4 GHz)

Open Source Announcement

The software included in this product contains open source software. You may obtain the complete corresponding source code for a period of three years after the last shipment of this product by sending an email to mailto:oss.request@samsung.com.

It is also possible to obtain the complete corresponding source code in a physical medium such as a CD-ROM; a minimal charge will be required.

The following URL http://opensource.samsung.com/opensource/SMART_AT_051/seq/0 leads to the download page of the source code made available and open source license information as related to this product. This offer is valid to anyone in receipt of this information.





Safety information

These safety precautions are for the owner's safety and prevention of property damage. Therefore, please read this manual thoroughly before using your product.

The manufacturer is not responsible for any injury or property damage occurred by not following the safety information.

This product is for compatible Samsung appliances, and it will not work on other devices. Visit Samsung.com for compatible appliances.

- **If the product is getting hot, stop using it.**
 - Burning of skin may occur if skin is in contact with a hot device.
- **Do not put the product near or in a heater(stove, microwave, etc.), a cooking utensil or a high pressure vessel.**
 - Doing so may supply heat to the product or may cause fire.
- **Do not drop the product or give external shock to the product.**
 - Do not put or store the product on a slant. This action may drop the product.
 - If the product is dropped, it may get damaged and malfunction.



-
- To avoid bodily injury and harm to the product, please ensure that children, toddlers or pets do not suck, bite or swallow the product.
 - Do not use the product for purposes other than what is described in this manual and/or the manuals of the compatible appliance.

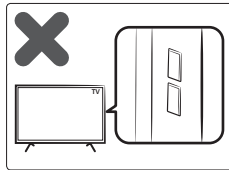
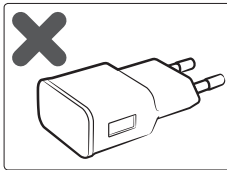
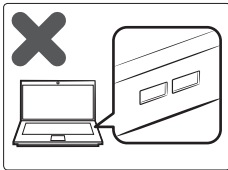



Safety information

- **Leave the product in a dry place without moisture or humidity.**
 - Humidity or liquid may cause damage to the parts and circuits of the product.
 - If the product gets wet, remove moisture and allow it to dry before connecting it to a compatible Samsung appliance and then bring it to a Samsung service center.
- **Do not attempt to repair, disassemble or modify the product yourself.**
 - If a user attempts to repair, disassemble or modify the product, regular service cannot be guaranteed.
- **Be careful when cleaning the product.**
 - Clean the product with a soft cloth.
 - Do not use harsh chemicals or detergent for cleaning the product. Doing so may cause product discoloration or corrosion.
- **This equipment is a EMC device for home use (B grade), and it is intended primarily for use in all areas of the home.**



Troubleshooting

Before you make a call to Service center, be sure to check chart below because you will be charged for visits and consultations.

Download

The SmartThings app is not searched on app market.

- The SmartThings app is not compatible with tablets and some devices.
 - Android OS 6.0 or later (with at least 2 GB RAM) is recommended.
 - Supported screen resolutions: 1280 x 720 (HD), 1920 x 1080 (FHD), 2560 x 1440 (WQHD)
- The SmartThings app is not compatible with some Apple devices including iPad and some smartphones.
 - iPhone 6 or later with iOS 10.0 or later is supported.
 - Supported screen resolutions: 1334 x 750, 1920 x 1080



Troubleshooting

Connection

After installing the SmartThings app, Samsung SMART READY appliance is not connected to the app.

Connect the Samsung SMART READY appliance to a wireless router before using the app.

The SSID connection to the product is not made immediately.

If the connection is lost when the product is in AP mode, disable the "Smart network switch" function on your smart phone and try again.

The product is not connected to a wireless router.

Make sure that the SSID (name) of the wireless router is a combination of English and numeric characters. When the SSID contains any special characters, change its name.



Connection

The product is not connected at the server registration step.

After accessing the router settings page, disable the firewall of the router and try it again.

The country error occurred in the Samsung account during connection.

After being logged out, log in your previous Samsung account and the delete existing devices. Log in the system again with a new Samsung account and configure the settings.

A failure message appears while adding devices.

It may have failed temporarily due to obstacle or the distance from the place where the router is installed. Please try again later.

Turn off the Samsung SMART READY appliance and then reconnect the power after 30 seconds. Then try again



SAMSUNG

Declaration of Conformity

Manufacturer

Samsung Electronics Co., Ltd.

Product details

Product : Smart Home Adapter

Model(s) : HD2018GH

Variant Model(s):

Declaration & Applicable standards

We hereby declare, that the product above is in compliance with the essential requirements of Radio Equipment Directive (2014/53/EU) by application of:

EMC	EN 301 489-1 V2.1.1 EN 301 489-17-V3.1.1
SAFETY	EN 60950-1 : 2006+A11 : 2009+A1 : 2010+A12 : 2011+A2 : 2013 EN 62311 : 2008
RADIO	EN 300 328 V2.1.1

and the Directive (2011/65/EU) on the restriction of the use of certain hazardous substances in electrical and electronic equipment by application of EN 50581:2012.

Representative in the EU

Samsung Electronics Euro QA Lab.
Blackbushe Business Park, Saxony Way,
Yateley, Hampshire, GU46 6GG, UK
2018-03-16

(Place and date of issue)

Stephen Colclough / Director Regulatory Affairs

(Name and signature of authorised person)

* This is not the address of Samsung Service Centre. For the address or the phone number of Samsung Service Centre, see the warranty card or contact the retailer where you purchased your product.





This device complies with part 15 of the FCC Rules.
Operation is subject to the following two conditions:
(1) This device may not cause harmful interference, and
(2) This device must accept any interference received,
including interference that may cause undesired
operation.



Any changes or modifications to the equipment not expressly approved by the party responsible for compliance could void user's authority to operate the equipment.

This equipment has been tested and found to comply with the limits for a Class B digital device, pursuant to part 15 of the FCC Rules. These limits are designed to provide reasonable protection against harmful interference in a residential installation.

This equipment generates, uses and can radiate radio frequency energy and, if not installed and used in accordance with the instructions, may cause harmful interference to radio communications. However, there is no guarantee that interference will not occur in a particular installation. If this equipment does cause harmful interference to radio or television reception, which can be determined by turning the equipment off and on, the user is encouraged to try to correct the interference by one or more of the following measures:



- Reorient or relocate the receiving antenna.
- Increase the separation between the equipment and receiver.
- Connect the equipment into an outlet on a circuit different from that to which the receiver is connected.
- Consult the dealer or an experienced radio/TV technician for help.

 **NOTE**

This unit was tested with shielded cables on the peripheral devices. Shielded cables must be used with the unit to insure compliance.

This SAMSUNG brand product, as supplied and distributed by SAMSUNG and delivered new, in the original carton to the original consumer purchaser, is warranted by SAMSUNG against manufacturing defects in materials and workmanship for a limited warranty period of: (12 months Parts and Labor)



SAMSUNG

CE

