



Laurel Mountain

PARKER 3

66" x 32" Drop-In Acrylic Tub

Model Number

6632PT064

Drop-In Soaker in White

Features

- Constructed of high-gloss durable acrylic
- Textured slip resistant bottom
- Deep bathing well
- Pre-leveled base for easy installation
- Can be installed as an undermount
- Minimalist design
- Tub can be under mounted
- Limited lifetime warranty
- Made in the USA



All dimensions are +/- 1/2" and subject to change without notice

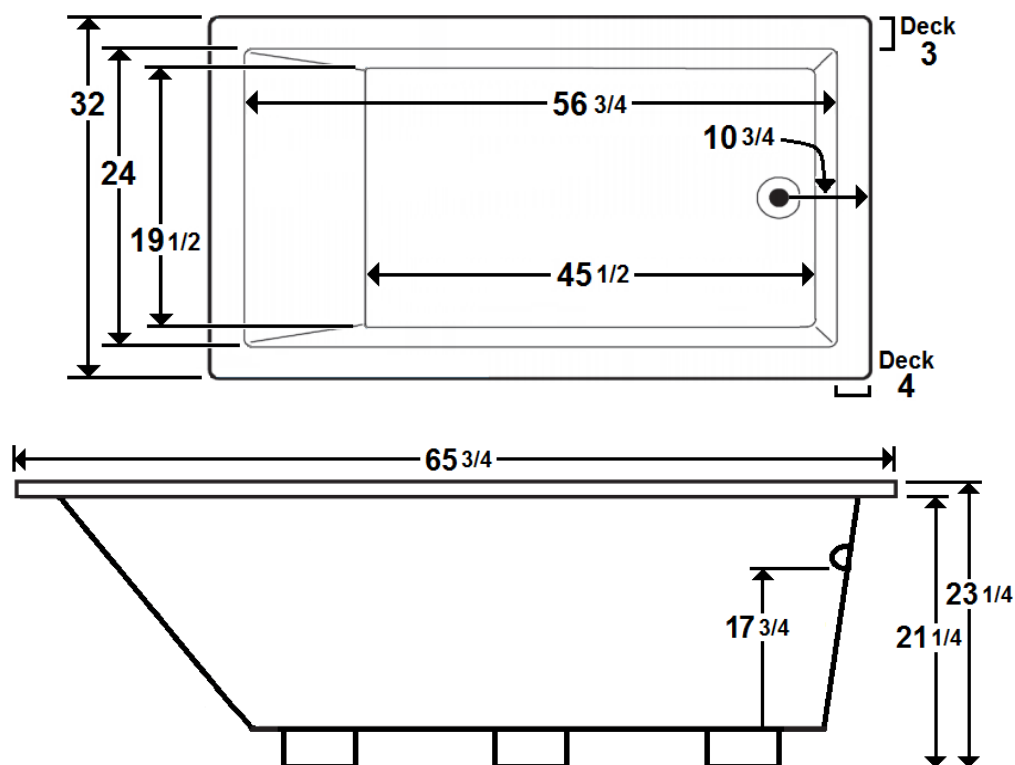

Technical Information

- Weight: 148 lbs.
- Water Depth to Overflow: 17 3/4"
- Water Capacity: 79 gal.
- Sump Dimension: 45 1/2" x 19 1/2"

Installation Notes

Install these acrylic fixtures according to the Owner's Manual. Confirm Specifications before starting installation.



PARKER 3

6632PT064
Drop-In Drain Soaker in White

AVAILABLE OPTIONS & UPGRADES

For current pricing, pictures, and descriptions of the Laurel Mountain options listed below, go to www.lowes.com. Enter the model number of the option into the search bar at the top right of the page next to the magnifying glass. For additional information, visit www.laurelmountainbath.com or call Laurel Mountain customer service at 800-930-0050.

Therapeutic

LM301 Radiant Heat

LM525 Music. Lights. Vibe

Accessories

CABLE OPERATED DRAINS

LM200 Chrome

LM210 White

LM231 Biscuit

LM201 Brushed Nickel

LM211 Biscuit

LM202 Bronze

INSTALLATION

Install this unit according to the Owner's Manual. The Owner's manual can be found at www.laurelmountainbath.com. Select "Resources" at the top of the homepage, then click on "Literature and Manuals". Scroll down the page to the Owner's Manual section then click on the "Whirlpool, Air Bath, Combo Bath" document.