



# User Manual

## Open Air Merchandiser Refrigerator



**CDAU-13C**



**WWW.KOOLMORE.COM**



**Please read the manual thoroughly prior to equipment  
Set-up, operation and maintenance!**

## **Contents**

<b>1. Structure and Parts.....</b>	<b>3</b>
<b>2. Location and Set Up.....</b>	<b>4</b>
<b>3. Safety and Power Supply.....</b>	<b>5</b>
<b>4. Operation.....</b>	<b>6-7</b>
<b>5. Digital Controller.....</b>	<b>6-7</b>
<b>6. Maintenance.....</b>	<b>7</b>
<b>7. Troubleshooting.....</b>	<b>8</b>
<b>8. Technical Specifications.....</b>	<b>9</b>
<b>9. Warranty.....</b>	<b>10-11</b>



## Structure and Parts





## Refrigerator Location and Set Up

- **Handle With Care**  
Unplug the wall socket, never tilt over 45 degrees while handling
- **Wait!**  
Wait at least two hours after handling the unit before plugging in to the wall socket
- **Dry Surface**  
Always place the refrigerator on completely dry surface
- **Level Surface**  
Place the refrigerator on a solid and level surface, the unit may be noisy or even malfunction if placed on an uneven surface.
- **Sufficient Space**  
Place the refrigerator no less than 4” away from the wall or other surface to avoid blocked airflow
- **Location Temperature**  
Select an indoor location away from heat and moisture-generating equipment. High ambient temperatures may cause the compressor to malfunction and will void the warranty. Never place the refrigerator in direct sunlight.
- **No Heavy Load**  
Never store a heavy load on top of the refrigerator, never install anything on to the refrigerator. Do not puncture any holes in to the refrigerator.



## **Safety and Power Supply**

- The unit should have its own 110/60Hz dedicated outlet, do not share the outlet.
- Do not use extension cords.
- Ensure the unit is not resting on or against the electrical cord. Make sure there is no damage to the cable
- After unplugging the unit, wait at least 10 minutes before plugging it back in. Failure to do so could cause damage to the compressor, please make sure there is no damage to the cable.
- To avoid shock and fire hazards, do not plug in or unplug the unit with wet hands.
- Please ensure that the required voltage is being supplied at all times.
- Do not store flammable and explosive gas or liquids inside the unit.
- Never give the refrigerator surface a flush otherwise, this will cause damage to the refrigerator.



## Operation

1. Plug the refrigerator in to a 115V exclusive socket. After the refrigerator is running, place your hand on the air suction to confirm that it is sufficiently cool
2. Set the digital controller to the desired temperature (see below)
3. Adjust the shelves to the desired location
  - Remove the shelves.
  - Move the shelf support to a suitable height.
  - Place the shelves on the support.
  - To get an even temperature between the top and bottom, please space the shelves equally.

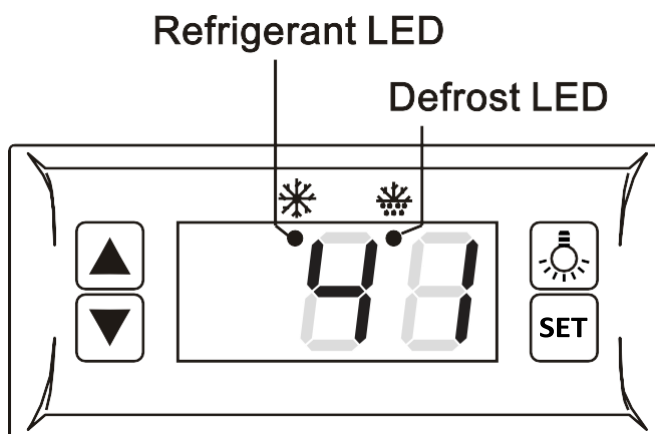

### Front Panel Operation

1. Set temperature:

Press **SET** button, the set temperature is displayed.

Press  or  to adjust the temperature

Press **SET** button to exit the adjustment and display the unit's current temperature.

2. If no more buttons are pressed within 10 seconds, the unit's current temperature will be displayed.

3. Lights: Press  button to turn lights 'on' or 'off'.

Manual start/stop defrost: Press  button and hold for 6 seconds to defrost or stop defrost.

4. Refrigerant LED: When the compressor is running, the LED is on; when the refrigerator temperature is constant, the LED is off; During the delay start, the LED flashes.

5. Defrost LED: during the defrost cycle, the LED is on; when it stops defrosting, the LED is off. During the delayed display of defrost, the LED flashes.

## Maintenance

**1. Cabinet cleaning. The product should be cleaned once a week with the power supply disconnected. When cleaning please use mild rinsing with mild soap and water**

1. Remove 4 screws from the top of the front grill.
2. Pull out the front grill.
3. Take out the filter.

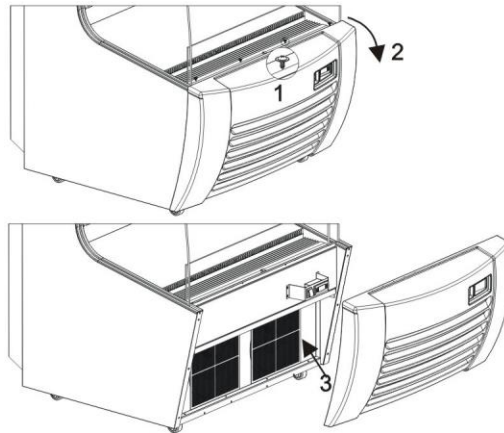

### 2. Cleaning the filter

**• If Message "EE4" appears on the display, please clean the filter immediately. After cleaning, if message "EE4" appears again, please contact your after service.**

Instructions for cleaning the filter

**3.** Frequently observe the operation of the product. in case of any abnormal noise, smell or smog, cut off the power supply immediately and call for professionals for help. Do not restart the product before the issue is cleared.



## Troubleshooting

Issues	Cause	Solution
Strange noise under the bottom shelf	Fan blade broken.	Power off and fix the blade.
Non-cooling in spite of normal operation	1 Power is off 3.Refrigerant leak 4.Unit failure.	1. Power it on. 3.Patch the leak and refill refrigerant 4.Call for professionals.
Weak air from air curtain, and higher cabinet temperature	1. Evaporator blocked by ice 2.Inside fan damaged. 3. Temperature is to low. 4. Vent is blocked by product	1. Increase defrost frequency. 2.Replace the fan. 3 Adjust the set temperature 4 Remove the product
Normal air curtain, but higher cabinet temperature	1 .Insufficient refrigerant. 2.Temperture set to high 3.The wind curtain disturbed by strong air flow. 4.Ambient temperature or humidity beyond standards.	1. Refill the refrigerant. 2.Adjust the temperature temperature controller. 3.Removing the disturbing factors. 4.Improve the conditions.
Melting water overflown	1.Heating pipe melting water damaged 2.Water-levelcontroller failure. 3.Ambient temperature or humidity higher than normal	1 .Replace the heating pipe. 2. Replace the water-level controller. 3.Improve the environment
Normal air curtain, but Periodical fluctuation of cabinet temperature	1. Condenser is dirty 2.Poor venting of the unit. 3.Heat protection of compressor failure 4.Capillary is blocked by ice 5.Temperature controller failure.	1. Clean the condenser. 2.Improve the venting conditions. 3.Replace the heat protection. 4.Replace the drying filter. 5.Replacethe temperature controller





## Technical Specifications

Coolant and injection quantity(g)	R290&(146)
General Rated input power(W)	1200
Power running of electrical heating element(W)	450
Max.ambienttemp./RH	80.6 °F /7 0%
Refrigeration temperature	(35.6-50)
Rated voltage(V)	110-120-
Rated Frequency(Hz)	60
Rated Current(A)	12.2
Type of Climate	6
Foaming agent	<i>CsH10</i>
Net weight(Lbs.)	271
Lamp power(W)	2 5*2(LED)
Total effective volume(L)	11.3
Overall dimension (mm) (LxWxH)	36.*33.3*59.4

WWW.KOOLMORE.COM



## **Warranty**

### **The one year1 Year warranty -is Valid only in the United States**

Unless otherwise stated, KOOLMORE Supply Inc. warrants to the original purchaser of new, qualified Koolmore units (and all parts thereof), that such equipment will be free from defects in material and workmanship for a period of 1 year from the date of delivery.

If a qualified product is found to be defective during this period, KOOLMORE Supply Inc. will repair the defective unit, replace any defective parts, or replace the defective unit.

### **What This Warranty Does Not Cover:**

KOOLMORE Supply Inc. will not warrant coverage for component failure or other damages that arise under the following conditions:

- Failure to install and/or use the unit within proper operating conditions specified by KOOLMORE Supply Inc.
- Failure to properly maintain the unit. This includes, but is not limited to, basic preventative maintenance like cleaning the condenser coil.
- Installation in non-commercial or residential applications.
- Products sold or used outside of the United States.
- Any damage that occurs as a result of negligence or improper handling.
- Overloading or improper loading of the unit in a manner that prevents proper airflow.

Additionally, no claims can be made against this warranty for spoilage of products, loss of sales or profits, or any other consequential damages.

Normal wear type parts, such as light bulbs and gaskets, are not included in warranty coverage.

Warranty is not transferable. This warranty is not assignable and applies only in favor of the original purchaser/user to whom delivered. ANY SUCH ASSIGNMENT OR TRANSFER SHALL VOID THE WARRANTIES HEREIN MADE AND SHALL VOID ALL WARRANTIES, EXPRESS OR IMPLIED, INCLUDING ANY WARRANTY OF MERCHANTABILITY OR FITNESS FOR A PARTICULAR PURPOSE.

**WARRANTY CLAIMS.** All claims should include: model number of the cooler, the serial number of the cabinet, proof of purchase, date of installation, and all pertinent information supporting the existence of the alleged defect. Any action or breach of these warranty provisions must be commenced within one (1) year after that cause of action has accrued.

**For Warranty Inquiries or Service:**

To obtain warranty service contact [warranty@koolmore.com](mailto:warranty@koolmore.com)

**Failure to contact KOOLMORE Supply Inc. prior to obtaining equipment service may void your warranty.**

