

## Features

- Two Lever handles offer separate control of hot and cold water
- 7-1/8" (181 mm) spout reach
- 1.2 gpm (4.5 lpm) maximum flow rate at 60 psi (4.14 bar)
- Coordinates with other products in the Riff collection
- This product can help a building earn Water Efficiency points in LEED® Green Building Rating System

## Material

- Premium metal construction for durability and reliability
- KOHLER® finishes resist corrosion and tarnishing

## Installation

- Wall-mount
- Requires rough-in kit (sold separately)

## Required Products/Accessories

For wall-mount installation  
K-410-K Wall-mount Valve

## Adapters, Rough-in and Extension Kits

1349542                      Range: 2-1/2" (64 mm) -  
   3-1/2" (89 mm)

## Recommended Products/Accessories

K-23726 Drain treatment  
K-23723 Faucet cleaner  
K-27409 18" towel bar  
K-27410 24" towel bar  
K-27411 Double robe hook  
K-27412 Towel ring  
K-27413 Pivoting toilet paper holder

## Optional Products/Accessories

K-7107 Decorative Drain  
K-7108 Decorative Drain  
K-7129 Drain  
K-7129-A Bathroom sink grid drain with overflow  
K-8801 Sink drain and strainer with tailpiece  
K-33151 Clicker drain without overflow  
K-25322 Clicker drain with overflow



<b>ADA</b>	<b>CSA B651</b>	<b>OBC</b>
------------	-----------------	------------

## Codes/Standards

ASME A112.18.1/CSA B125.1  
NSF/ANSI/CAN 61  
NSF/ANSI/CAN 372  
All applicable US Federal and State material regulations  
DOE - Energy Policy Act 1992  
EPA WaterSense®  
California Energy Commission (CEC)  
ADA  
ICC/ANSI A117.1  
CSA B651  
OBC  
IAPMO Certification

## KOHLER® Faucet Lifetime Limited Warranty

See website for detailed warranty information.

## Available Colors/Finishes

*Color tiles intended for reference only.*

Color	Code	Description
	CP	Polished Chrome
	SN	Vibrant® Polished Nickel
	BN	Vibrant® Brushed Nickel
	BL	Matte Black
	2MB	Vibrant® Brushed Moderne Brass

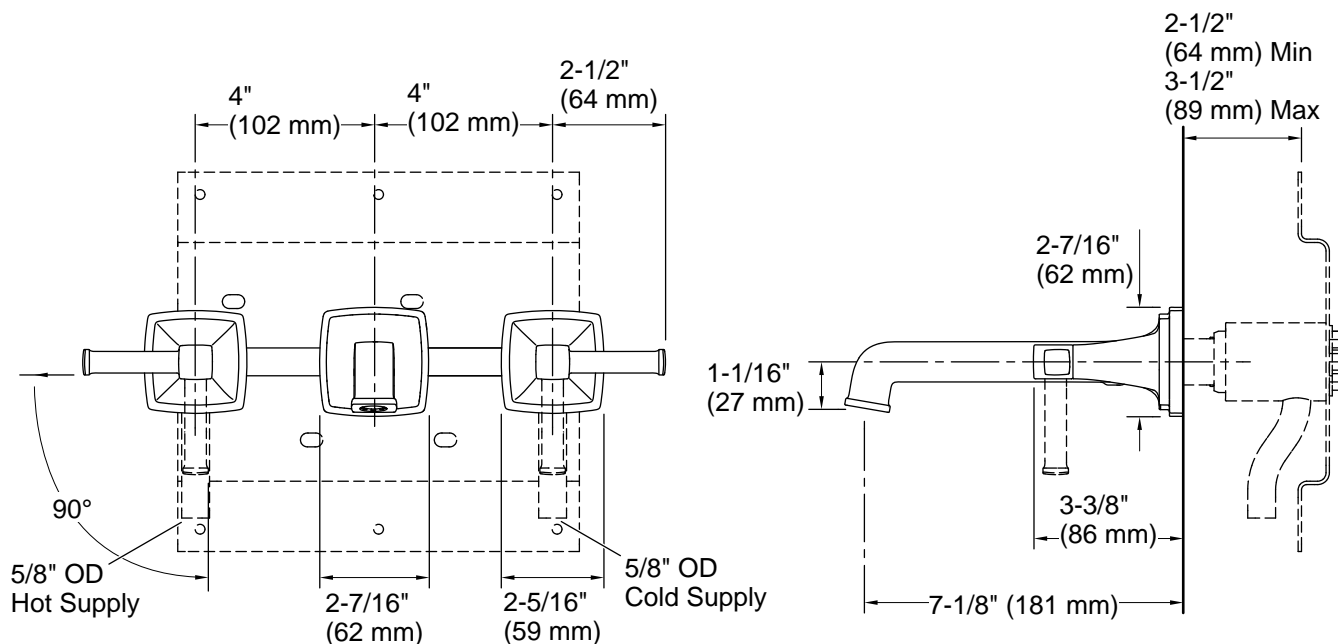

## Technical Information

All product dimensions are nominal.

### Faucet:

Flow rate: 1.2 gal/min (4.5 l/min)

Drain included: No

Drain with overflow: No

### Spout:

Spout reach: 7-1/8" (180 mm)

### Handshower:

Rated maximum flow: 0 gal/min (0 l/min)

## Notes

Install this product according to the installation instructions.

ADA, OBC, CSA B651 compliant when installed to the specific requirements of these regulations.