

Manual Wheelchair  
**FS-SERIES WHEELCHAIR**



# CATALOG

Warning	1
Intended use	1
Containications	1
Structure and omposition	1
Technical Parameters	1
<b>Chapter 1 Overview</b>	<b>2</b>
1.1 Necessary preparation before use	2
1.2 Precautions	2
<b>Chapter 2 Instructions for use</b>	<b>3</b>
2.1 Unfold and fold the wheelchair	3
2.2 Bending and Reclining operations	3
<b>Chapter 3 About Function Description</b>	<b>4</b>
3.1 How to adjust the armrest upside down	4
3.2 How to adjust the armrest length	4
3.3 How to adjust the armrest height	5
3.4 How to adjust the rear handle folding	5
3.5 How to use the front brake for parking	6
3.6 How to use the rear brake for parking	6
3.7 How to adjust the foot pead height	7
3.8 Anti-Rollover Wheel installation method	7
3.9 Car Tools	7
<b>Chapter 4 Maintenance and Warranty</b>	<b>8</b>
4.1 Maintenance Method	8
4.2 Warranty Regulations	9
<b>Chapter 5 About Special Storage Conditions and Transportationn Conditions</b>	<b>10</b>
5.1 Special storage Conditions Methods and Transportation Conditions	10
5.2 Transportation Conditions	10
<b>Chapter 6 Date of Production and Service Life</b>	<b>10</b>



## Warning

Read and fully understand the instructions carefully before operating the equipment. If you can't understand the tips, warnings and other information in the manual, please contact a professional, otherwise you are prone to accidents!

**Intended use:** This product is used as a mobility tool for disabled people, patients and the elderly and infirm.

**Contraindications:** None.

**Structure and composition:** By the frame, Front wheel, Rear wheel, Armrest, Foot and Foot support.

## Technical Parameters

Product Parameters						
<b>Model Number</b>	FS907LABH					
<b>Frame Materials</b>	Aluminium alloy					
<b>Overall Dimensions</b>	Total length	31	Seat depth	16	Height of foot pedals off the ground	-
	Total width	23	Height of seat from ground	20	Wheelchair weight	27
	Total height	35	Armrest height	7-11	Maximum load	275
<b>Fold Width (inches)</b>	33*12.6*29		Distance between handrails	-	Front wheel specifications	7
<b>Seat Width (inches)</b>	18		Height of backrest	14	Rear wheel gauge	15

**NOTES:** There is an error in the manual measurement. Please refer to the physical object.

### 1.1 Necessary Preparations before use:

- 1.Ensure the stability of the wheelchair: For maximum stability, the rear wheel axle must be fixed in the last position. Any displacement of the axle will affect the stability of the moving wheelchair. If the rear wheel of the wheelchair has been moved forward, check that it is stable before you use the wheelchair.
- 2.Ensure that the wheelchair parking brake is working properly: You must ensure that the brake is working properly and that the rear wheel is locked. Make sure that the rear wheels are securely locked before you push the wheelchair.
- 3.Wear your seat belt before use.

### 1.2 Precautions

- 1.Unless otherwise specified, all wheelchair adjustment operations should be carried out when no one is on board.
- 2.When you are sitting in a wheelchair and want to take items other than the wheelchair such as in front of, on both sides or behind the wheelchair, please pay attention to the tilt of the body not too large, so as to avoid the wheelchair weightlessness and cause tipping.
- 3.Before using the wheelchair, please check whether the handrails, handles, etc. have become loose. If so, please contact the sales staff.
- 4.Please use your wheelchair safely, especially on sloping roads.
- 5.Do not move your body forward to try to pick up items while in the wheelchair.
- 6.Do not bend below your knees to pick up objects on the floor when riding in the wheelchair.
- 7.Do not change your sitting position when you lean back in a wheelchair, otherwise the wheelchair will tip over.
- 8.The wheel lock device is not a brake device, so please do not use the wheel lock device to stop the moving wheelchair.
- 9.Do not go up or down stairs in a wheelchair without assistance.
- 10.Wheelchairs should not walk on escalators, otherwise it will cause serious personal injury.
- 11.When the passenger wants to transfer from the wheelchair to another place, first park the car in the nearest and best position, the direction of the front wheel of the wheelchair towards the place that needs to be transferred, and check whether the wheel of the wheelchair has been locked when getting on the wheelchair.
- 12.When moving the wheelchair, please grasp the fixed connection part of the wheelchair, and do not grasp the moving parts, such as handrails, foot support devices, etc.
- 13.Do not stand on the frame of the wheelchair.
- n Please do not use the pedal to get on and off the bus, be sure to fold the pedal or rotate it to one side first.

## 2 Instructions for Use

### 2.1 Unfold and fold the wheelchair

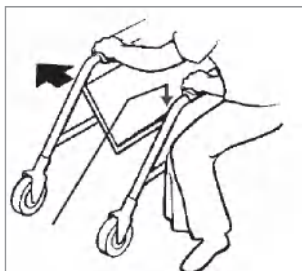

Unfold the wheelchair

#### 2.1.1 Ways to deploy your wheelchair

Press the sides of the wheelchair seat down vertically with your hands to completely open the wheelchair to the normal use state, and then lower the left and right foot pedals to the use position.

#### 2.1.2 How to fold the wheelchair

Turn the foot pedal to the vertical position, and then pull the wheelchair seat vertically up from the middle by hand, so that the wheelchair is completely folded to the non-use state.



Folding wheelchair

### 2.2 Bend and back

**Note:** Do not attempt to reach for the item by moving your body forward or bending lower than your knee lid to pick it up.

**Bend over:** Before performing the movement, please adjust the position of the front wheel, (two front The wheels must be parallel to each other) Lock the back wheel!

**Lean back:** First park the car in the closest and best position, adjust the front wheel to match the wheelbase of the rear wheel shaft to the maximum. Reach back but do not change the sitting posture. Do not lean back over the highest point of the back, or else a change in center of gravity will cause the wheelchair to flip back.



### 3 About Function Description

#### 1 How to adjust the armrest upside down?

Step ① Press and hold the dowel pin button located at the front of the armrest to detach it, and then pull it up to complete the flip.

Step ② Press down the armrest until it engages with the positioning pin buckle to complete the reset.

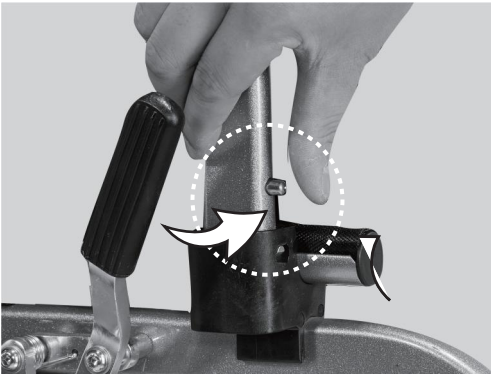

#### 2 How to adjust the armrest length?

Step ① Press and hold the length adjustment button with your finger and push forward to adjust the armrest to the desired length.

Step ② Press and hold the length adjustment button with your finger and push the armrest back to return to its original state push the armrest back to return to its original state securely.

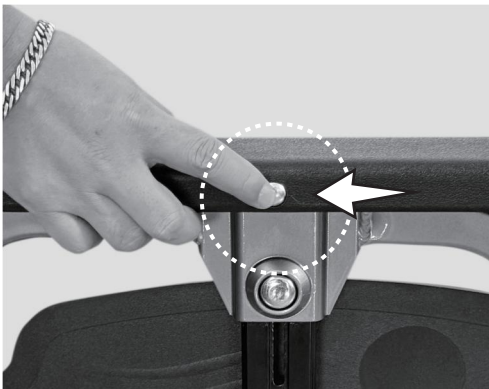

### 3 How to adjust the armrest height?

Step ① Press and hold the adjustment button with one hand, pull the armrest up with the other hand, adjust the armrest to the ideal height and let go.

Step ② Press and hold the adjustment button with one hand and press down on the armrest with the other hand to restore the original state.

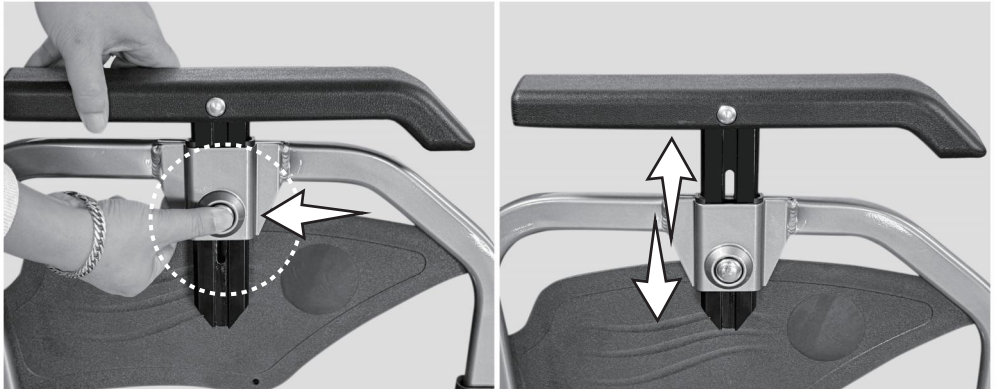

### 4 How to adjust the rear handle folding ?

Step ① Pull the lever back with both hands simultaneously to complete the folding.

Step ② Hold the handle with both hands and lift it up to ensure the buckle is locked, completing the rese.

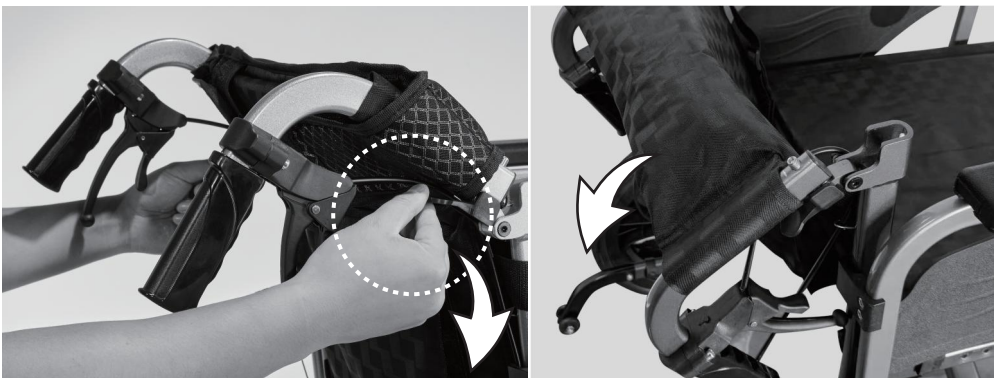

## 5 How to use the front brake for parking?

Step ① Push the front brake lever forward to its maximum displacement to engage the self-locking parking mechanism.

Step ② Pull the brake lever backward to release the parking mode.

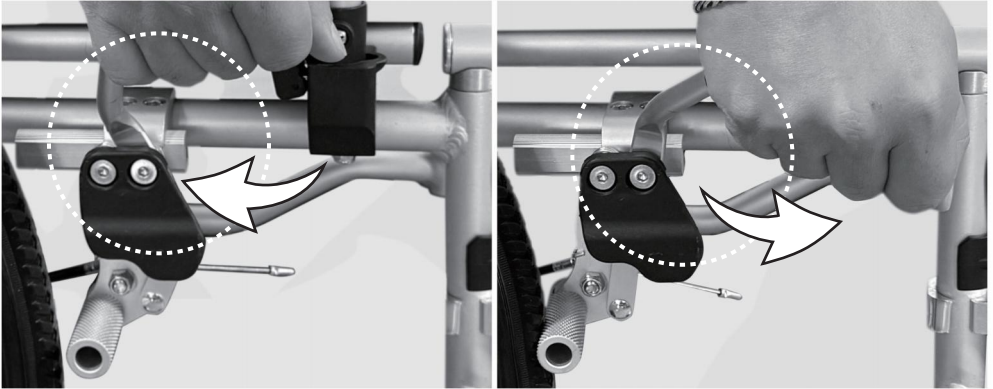

## 6 How to use the rear brake for parking?

Step ① Grasp the brake handle with both hands, ensuring the brake device is in the stop-and-hold position.

Step ② Hold the brake hand to complete the parking state.

Step ③ In the self-locking parking state, lift the self-locking plate with the index fingers of both hands simultaneously to release the parking state.



## 7 How to adjust the foot pedal height ?

Step ① Use the L-shaped hexagons in the vehicle tool kit to remove the two screws in order to adjust to the desired height.

Step ② Align the screw with the adjustment holes and tighten them securely.

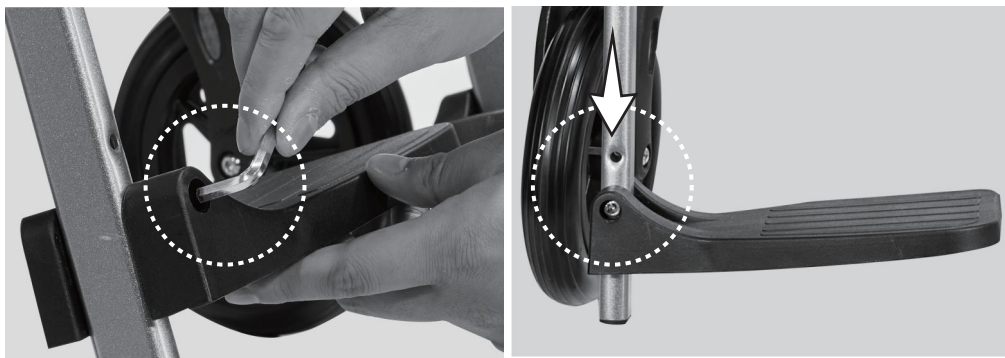

## 8 Anti-Rollover Wheel installation method

Step ① Insert the anti-rollover bracket into the frame mounting tube, ensuring that two adjustment holes are reserved for position adjustment as needed.

Step ② Plug it in and ensure that the installation is secure.



## 9 Car Tools(Notes: In the storage bag.)

① Large L-shaped hexagons; ② Small L-hexagon; ③ Multi-function wrench

## 4 Maintenance and Warranty

### 4.1 Maintenance Methods

1. Please place the wheelchair in a dry and ventilated place to avoid corrosive chemicals such as oil, acid and alkali.
2. Keep the body clean, you can use ordinary neutral detergent to wipe the body, please dry the body in time after wiping, and add lubricating oil at the bearing.
3. The vehicle should avoid exposure to the sun and rain, and it is strictly forbidden to take the wheelchair shower. After soaking in water, the vehicle should be dried in time and lubricating oil should be added at the bearing position.
4. This wheelchair is a light life wheelchair, and it is strictly prohibited to be used in sports activities such as playing ball and racing.
5. Always check the air pressure of pneumatic tires, pay attention to check the wear of the tire pattern, and replace it if necessary.
6. Drive spokes need to be adjusted once a year.
7. Two to three drops of high-quality oil should be added to the bearings of the driving wheel and the front guide wheel every month.
8. Always clean the debris (such as hair and thread head) at the wheel bearing.
9. Always check the sensitivity of the brake and pay attention to whether the seat cushion is damaged to ensure safety.
10. Make sure all the screws and nuts are securely installed before operating the wheelchair.

### 4.2 Warranty Regulations

1. The sales agent shall guarantee the wheelchair for one year under the condition of normal use according to the instruction manual.
2. The warranty period starts from the date of purchase of the wheelchair.
3. Documents you need to provide for the warranty: Warranty manual, product picture, purchase order.
4. During the warranty period, when the customer finds that the wheelchair is defective, he must immediately notify the seller. Please show this manual when repairing it. In compliance with paragraph 1 of this Treaty, our company will repair or replace the damaged parts free of charge.

5. The damaged parts that are replaced free of charge within the warranty scope belong to our company's property.

6. The warranty period will be cancelled if the wheelchair is changed in structure by the technical personnel who is not our company or does not use the original parts of our company for maintenance. The company shall not be responsible for any loss caused by this.

7. The following conditions are not covered by warranty:

a. No warranty manual.

b. The wheelchair model recorded in the warranty manual does not match.. or has been altered with the model number of the wheelchair being repaired.

c. The inner and outer tires of the wheelchair and the inner and outer tires of the front guide wheel are not covered by the warranty.

d. Loss and damage caused by not operating in accordance with the instructions.

e. Suffering from force majeure or accidents (including but not limited to fire, flood, earthquake, traffic accident, etc.)

f. Failure caused by natural wear, external force damage or poor maintenance:

① The cushion is deformed due to riding.

② The bearings are rusted because of water or without lubricating oil maintenance.

③ The armrest fabric is cracked and damaged (the warranty period of this part is three months).

④ The drive spokes are loose and broken.

⑤ Discoloration of metal parts.

⑥ Scratches and color changes on the spray surface where the movable parts rub against each other.

⑦ Paint damage caused by collision.

⑧ Deformation, fracture and other parts damage of the frame caused by falling and collision.

⑨ In the process of use, sudden start, sudden stop, sharp turn or in situ violent spoiling and noise.

## 5 About storage Conditions and Transportation Conditions

### 5.1 Special storage Conditions:

After packing, it should be stored at room temperature with relative humidity not exceeding 80%RH. No corrosive gases and well ventilated, clean and indoor.

### 5.2 Transportation Conditions:

Handling and transportation should be handled lightly, noise-proof, avoid light, away from heat sources.

## 6 Date of Production

Date of Manufacture: See product label.

Service Life: The product is used for 5 years under normal condition.

Manual Wheelchair

# FS-SERIES WHEELCHAIR

Made in China

**Classification Name:**WHEELCHAIR,MECHANICAL

**Manufacturer:**FOSHAN DONGFANG MEDICAL EQUIPMENT MANUFACTORY (LTD)

**Address:**No.5 XINGFU RD.NANHAI SHISAN INDUSTRIAL PARK FOSHAN Guangdong,CN 528225

**ESTABLISHMENT REGISTRATION NUMBER:**3004194020

**Owner/Operator Number:**9059383

**Manufacturer Email:** hancheukbaobao@hotmail.com

**510K Number:**K041814