

5. INSTALLING THE SCREEN IN THE GROUND

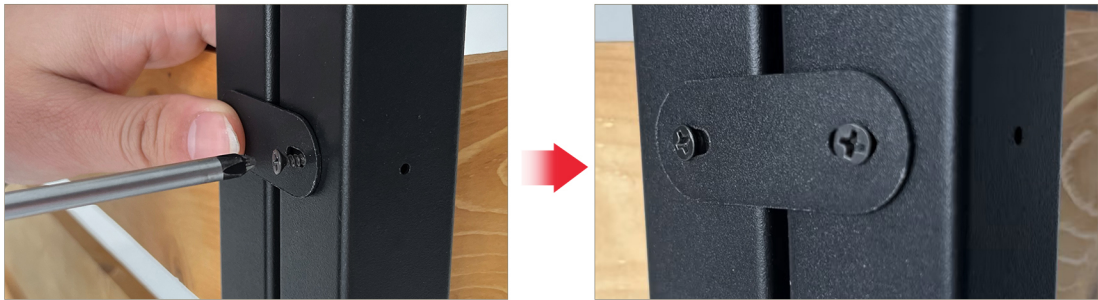

6. INSTALL POST CAPS

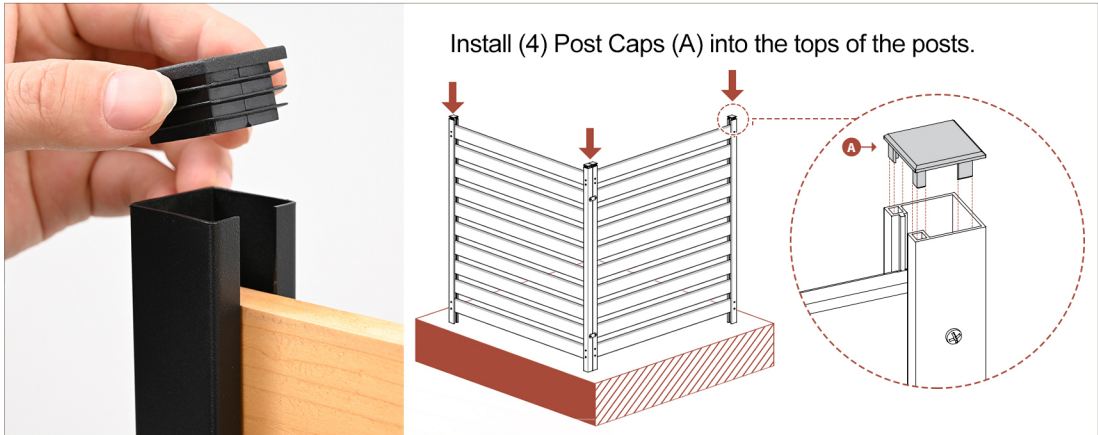

NOTE:

Check the inside of the larger pieces in your box for other materials packed inside.  
When assembling components, place on a non-abrasive surface to avoid scratching.  
We recommend an area approximately 5'x 8' for unobstructed assembling.  
You should not need to use excessive force when assembling components.  
If you are having problems with the assembly or installation of this product,  
we are happy to assist you with the process.

 [yeye5207788@gmail.com](mailto:yeye5207788@gmail.com)

If you have any questions about our products,  
feelfreetoemailusanytime,anywhere.



INSTRUCTION OF OPERATION &  
USER MANUAL  
OUTDOOR FENCE

## LAY OUT MATERIALS



A: Post Cap\*4



D: Screw B



E: Wood Assembly Spacer



G: Post Anchor \*4



B: Joiner Clip\*2



C: Screw A



F: Post\*4



H: Board with holes\*4



I: Board without holes

## 1. FASTEN POST ANCHORS



1. Insert (2) Post Anchors (G), into the posts until the pre-drilled holes in the anchors and posts align.
2. Drive (4) Stainless Steel Screws (C) into the pre-drilled holes in the posts to secure the board and post anchors.

## 2. INSERT BOARD



1. Insert the first Board with Holes (H)
2. Fix with screw (C)
3. Preliminary formation.



4. Put in Wood Assembly Spacer (E)
5. Insert other BOARD Without Holes (I)
6. Insert the last Board with HOLES (H)
7. Preliminary formation.

## 3. INSERT BOARD

Repeat Steps in order to assemble the second screen.

## 4. INSTALLING THE SCREEN IN THE GROUND

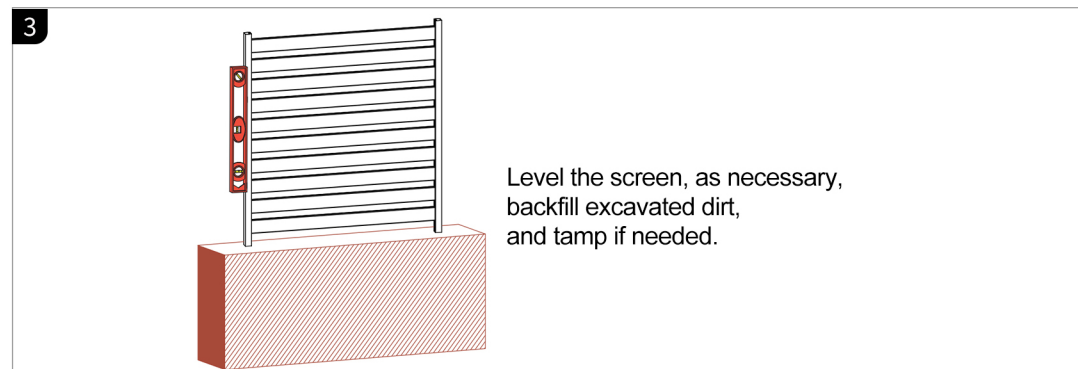
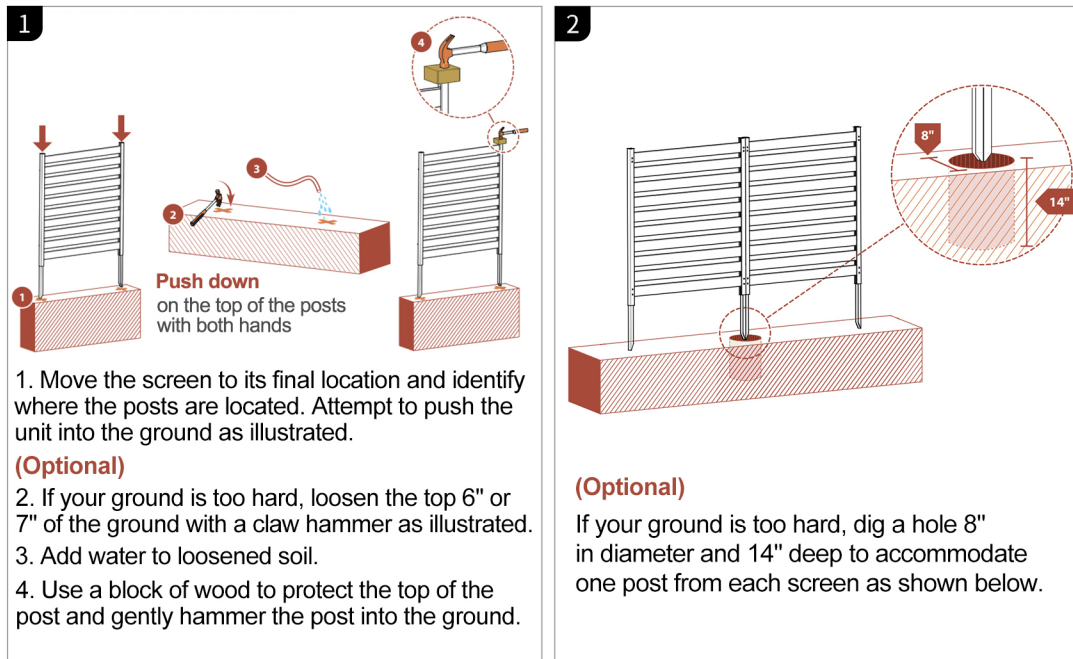

Level the screen, as necessary, backfill excavated dirt, and tamp if needed.