

Gibraltar Wooden Soffit Vents for surface mounting on wood soffits.

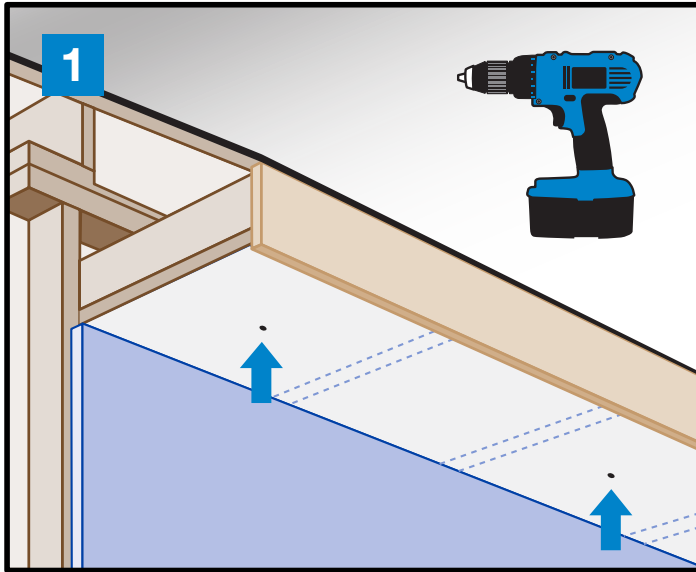

1. From inside the attic locate the area between the soffit joists where you will be installing the soffit vents. Find the center and then drill a hole to mark it.

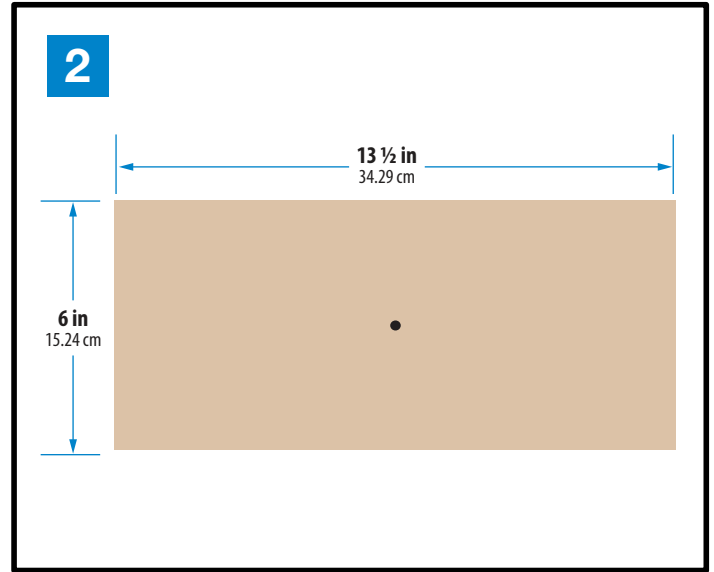

2. Make a 15 in. x 7 in. cardboard template of the **rough opening**. Punch an alignment hole in the center.

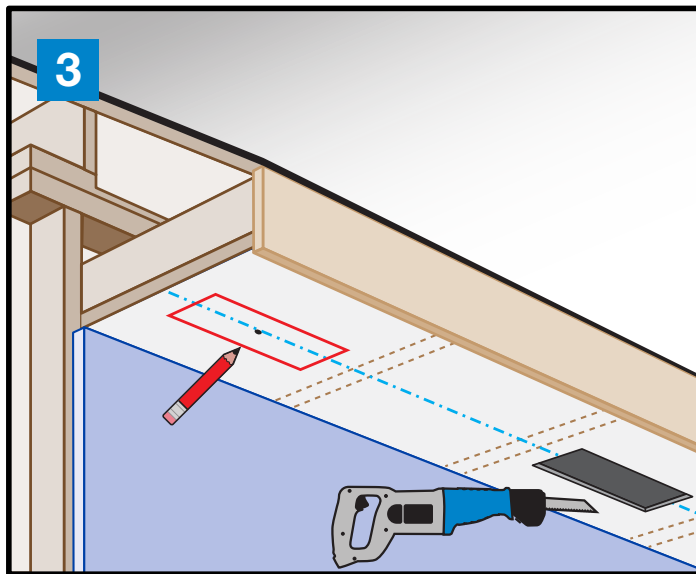

3. On the outside of your home, center the template over each hole that you made in Step 1. Trace around the template. Cut out the template outline with a jigsaw or reciprocating saw.

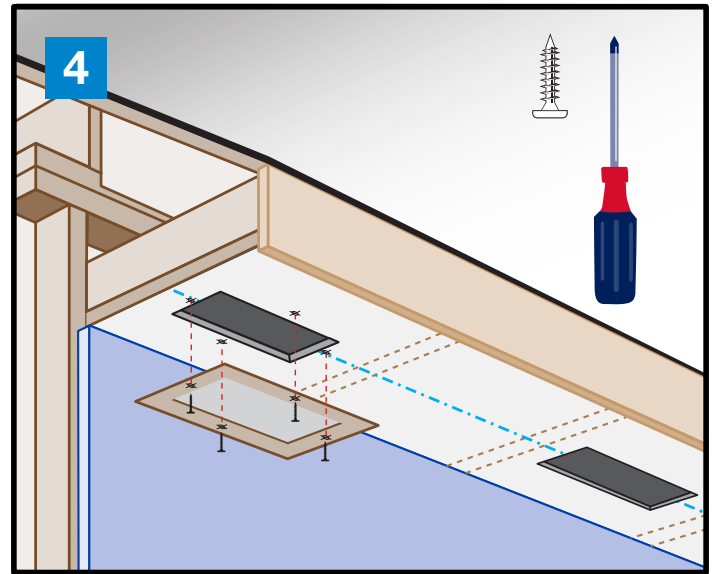

4. Install the vent by centering it over the opening and attaching it with four #8 x 1 inch pan-head screws.



CAUTION! Working above grade is inherently dangerous, be sure that proper fall protection measures are in place. When working with power tools, gloves and eye protection are absolutely required.

These installation guidelines are for use with typical or standard applications. It is always recommended to seek advice from a licensed professional, and to check with your local building inspector or building permit office for approvals and possible variations that may apply.