



## CAST-IRON FREESTANDING BATHTUB SERIES

# OWNER'S MANUAL & INSTALLATION GUIDE



### **READ ENTIRE INSTALLATION GUIDE PRIOR TO INSTALLING THE BATHTUB**

This bathtub should only be installed by a certified plumber  
two people are required to lift the bathtub

For installation and assembly videos, please visit our website  
**[www.streamlinebath.com](http://www.streamlinebath.com)**

OR

our YouTube page by searching for  
**"Streamline Bath"**

OR

following the below link to our channel:

**<https://www.youtube.com/channel/UCII7TGMBkwoGSqzo-pGfaJw>**



**External Drain  
Assembly Video**

# PRIOR TO INSTALLATION

These products must be installed by a fully insured and licensed plumber only.

Installation of any product by anyone other than fully insured and licensed plumber shall void limited warranty.

We are not responsible for any local code compliance for this product.

Building and plumbing codes may vary state-to-state.

Streamline shall not be held liable for any and all incidental damages or flood caused due to use of this product.

Streamline shall not be held liable for any and all fees stemming from cost of installation, re-installation, removal, subsequent damage, or transportation in a case of a product defect.

## TOOLS REQUIRED



SILICONE



MEASURING  
TAPE



PENCIL



LEVER BAR



ADJUSTABLE  
KEY



SAFETY  
GLASSES

## WHAT'S IN THE BOX

\*\* REPRESENTS DIFFERENT COLORS OF THE ITEM

Please note:

Different bathtub models have different drain models. Please see the next page to determine which drain model applies to the bathtub model that you have purchased.

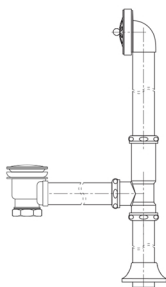

Model: N-DWF-XX\*\*

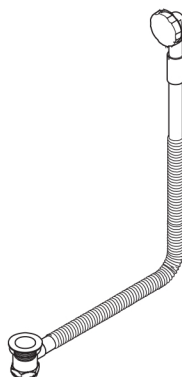

(Pre-installed)  
Model A1866

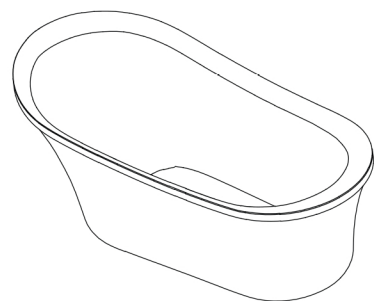

Bathtub



# DRAIN MODEL COMPATIBILITY

## ACRYLIC FREESTANDING BATHTUB

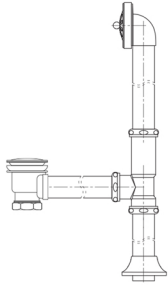

**MODEL: N-DWF-XX\*\***



R-5040-67CIFSBBCH-FM



R-5041-67CIFSBBCH-FM



R-5042-67CIFSBBCH-FM



R-5043-67CIFSBBCH-FM



R-5080-66CIFSBBCH-FM



R-5081-60CIFSBBCH-FM



R-5140-66CIFSBBCH-FM



R-5180-72CIFSBBCH-FM



R-5200-72CIFSBBCH-FM



R-5201-61CIFSBBCH-FM



R-5300-71CIFSBBCH-FM



R-5320-67CIFSBBCH-FM



R-5340-66CIFSBBCH-FM



R-5360-72CIFSBBCH-FM



R-5380-67CIFSBBCH-FM



R-5381-67CIFSBBCH-FM



R-5480-60CIFSBBCH-FM



R-5400-67CIFSBBCH-FM

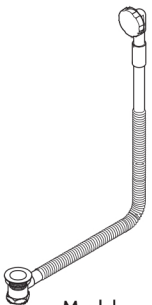

Model  
Model A1866



R-5260-67CIFSBBCH-FM

# DRAIN DIAGRAMS

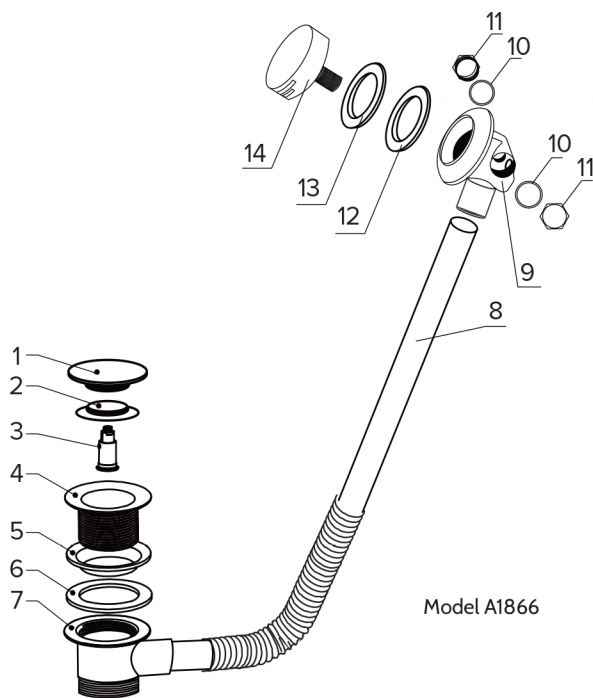

Model A1866

No.	ITEM	Qty
1	Pop-Up Cover	1
2	O-Ring	1
3	Cartridge	1
4	Strainer	1
5	Upper Rubber Gasket	1
6	Lower Rubber Gasket	1
7	Tee	1
8	Drain Ell	1
9	Overflow Body	1
10	Gasket	2
11	Corner Plug	2
12	Lower Overflow Gasket	1
13	Upper Overflow Gasket	1
14	Overflow Cover	1

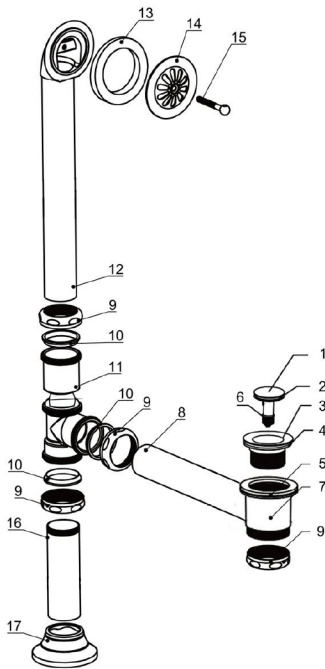
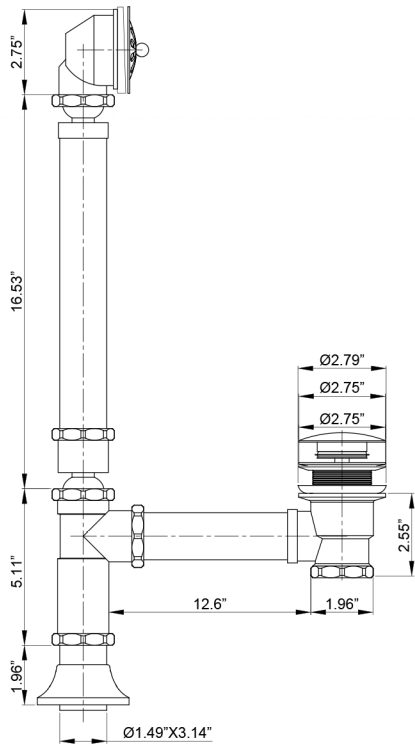

Model: N-DWF-XX\*\*

No.	ITEM	Qty
1	Pop-Up Cover	1
2	O Ring	1
3	Strainer	1
4	Upper Rubber Gasket	1
5	Lower Rubber Gasket	1
6	Cartridge	1
7	Drain Tee	1
8	Drain Ell	1
9	Drain Cap	1
10	Washer	1
11	Tee	1
12	Overflow Ell	1
13	Tapered Rubber Gasket	1
14	Overflow Plate	1
15	Pin Bolt	1
16	Tail Piece	1
17	Flange	1

\*\*XX REPRESENTS DIFFERENT COLORS OF THE ITEM

# BATHTUB INSTALLATION

1. Ensure that the floor at the installation site has sufficient floor support and level.

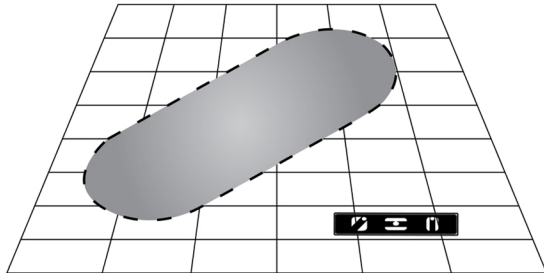

2. Waterproofing the floor is highly recommended

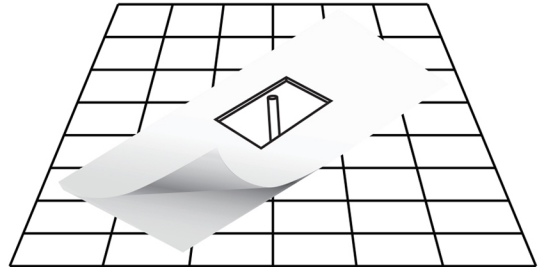

3. Determine the location of the drainpipe on the floor by taking measurement of the drain and waste location underneath the unit. Clean the drain hole area in preparation of setting the drain. The area should be dry & free from any debris.

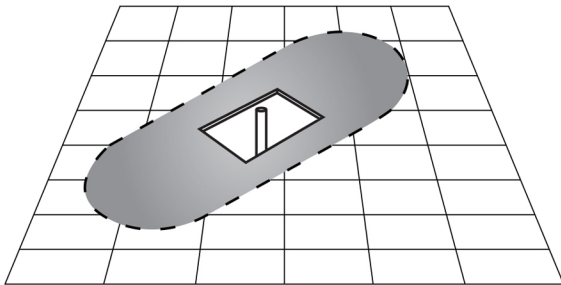

4. Remove the bathtub from its box. It is recommended that the bathtub is carried by a minimum of two people.

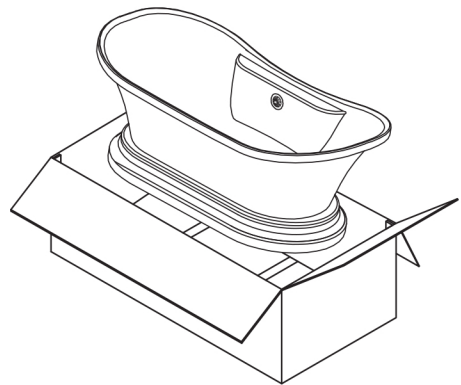

5. Move the bathtub into the desired location near the drainpipe.

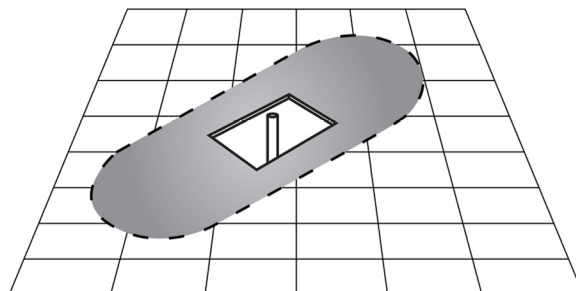

**Below is the installation for drain A1866; For drain N-DWF-XX, please skip to page 08**

# BATHTUB INSTALLATION

6. Before proceeding with installation, push the pop up into a close position and fill the bathtub above the overflow [Note: some models may not have an overflow] to test for overflow and drain leakage.

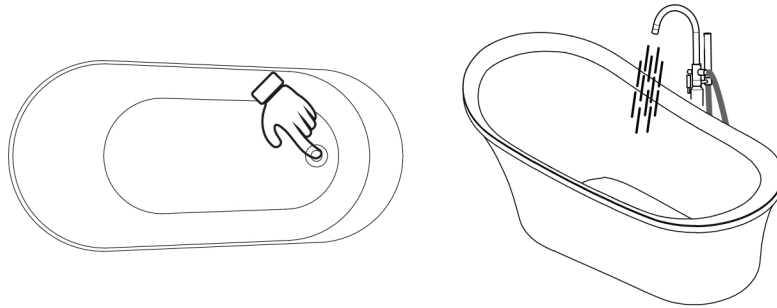

7. Proceed to place the provided flexible drain hose into the floor drain.

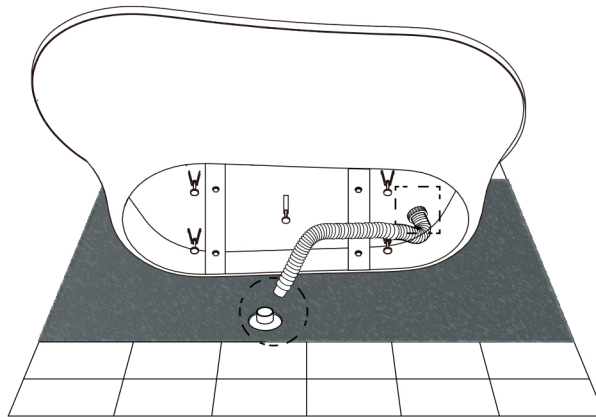

8. Please note, the flexible hose is a basic way that we provide to connect to the end plumbing in a home. The plumbing installation in every home differs, so please consult with a certified plumber to see if the plumbing in your home is compatible with using a basic flexible hose.

9. Seal the connection by using a PVC pipe sealant to join the parts together.

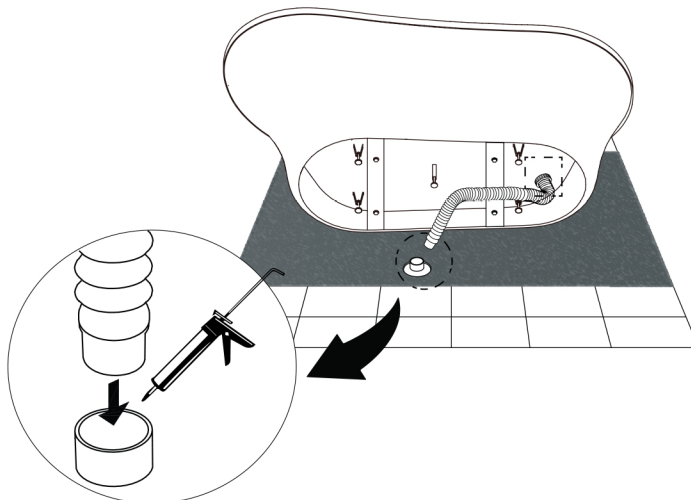

# BATHTUB INSTALLATION

- 10.** Apply silicone along the bottom of the bathtub in order to create an airtight seal. Then apply a bead of tub & tile caulk around the edges of the base.

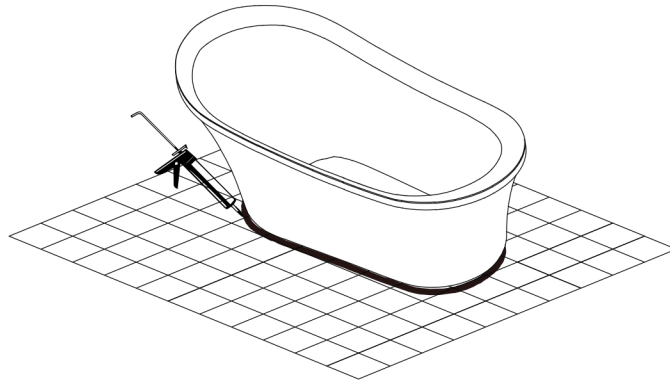

- 11.** With the bathtub now in place, wipe off any excess silicone, tub & tile caulk where the bathtub meets the floor.

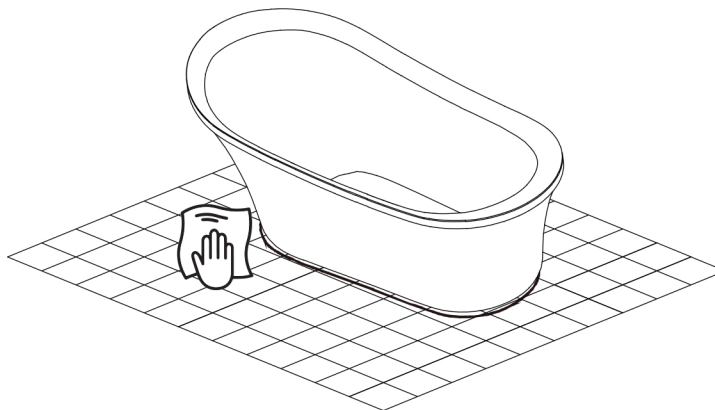

- 12.** Allow for up to 24 hours for the adhesive material to set.

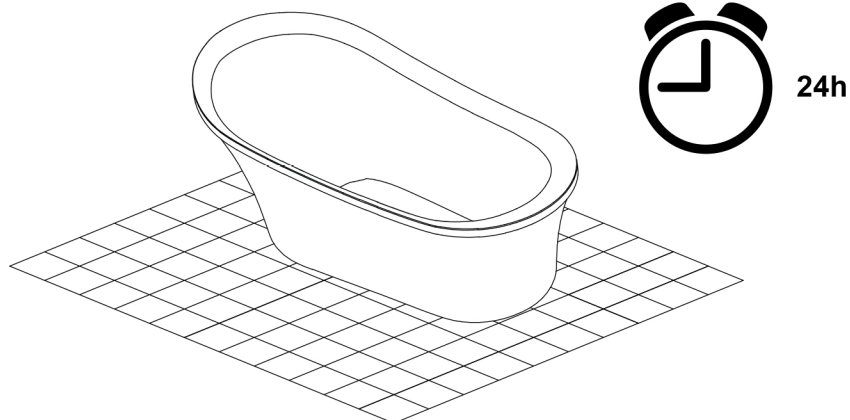

# THE BELOW INSTRUCTIONS ARE FOR INSTALLING DRAIN ASSEMBLY N-DWF-XX

1. Take the overflow ell and unscrew the pin bolt, removing the overflow cover as well.

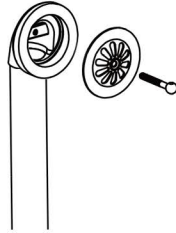

2. Take the tapered rubber gasket and the overflow ell and place it on the overflow hole on the back of the bathtub. Run the pin bolt with the overflow cover through the overflow hole and tighten firmly.

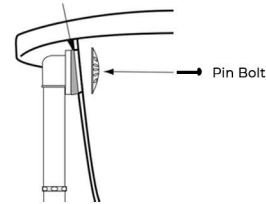

3. Remove the strainer from the drain tee. Take off the larger, lower rubber gasket. Set it aside. **DO NOT TAKE OFF THE SMALLER, UPPER GASKET.** Place the strainer through the drain hole in the bathtub. Use silicone sealant to seal and ensure a tight connection. **DO NOT** use plumber's putty.

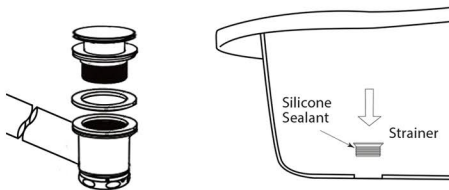

4. Take the lower gasket that was previously removed and re-attach it to the strainer from underneath the bathtub.

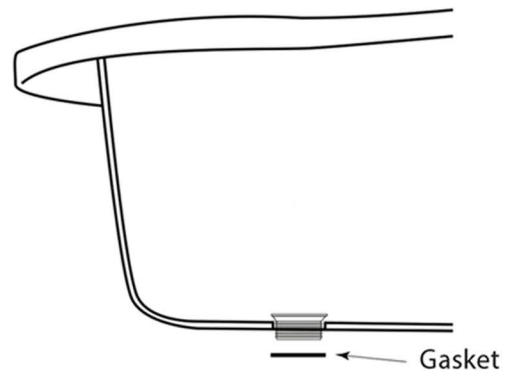

5. Screw on the drain tee to the bottom of the drain, making sure the opening of the drain tee is facing outwards to align with the overflow hole.

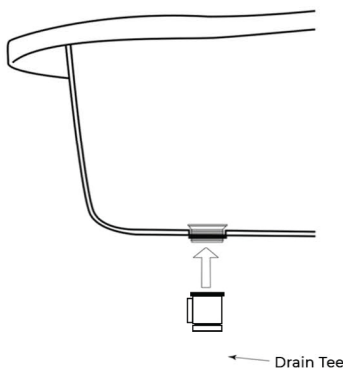

6. Insert the drain ell into the drain tee and screw in tightly. The use of threaded plumbing tape may be necessary at the joint to prevent leakage. This can be done at your discretion.

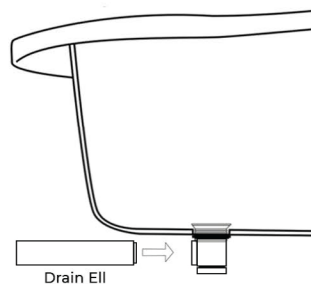



# THE BELOW INSTRUCTIONS ARE FOR INSTALLING DRAIN ASSEMBLY N-DWF-XX

---

- 7.** Remove the coupling nut and washer from the top of the tee where the ball joint is located.

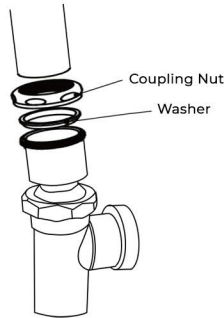

- 8.** Connect the top of the ball joint tee with the overflow ell using the washer and coupling nut. Tighten firmly to have a leakless connection.

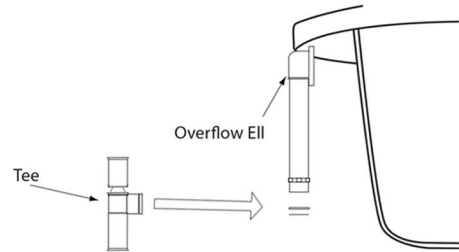

- 9.** Use the ball and joint to angle the drain properly to allow for proper installation in the bathroom.

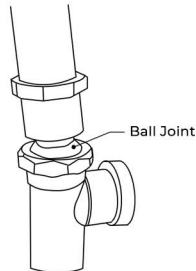

- 10.** Remove the coupling nut and washer from the left-hand side of the drain tee.

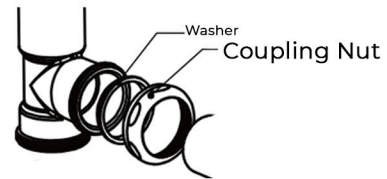

- 11.** Connect the drain ell with the left-hand side of the drain tee using the coupling nut and washer. Tighten firmly to have a leakless connection.

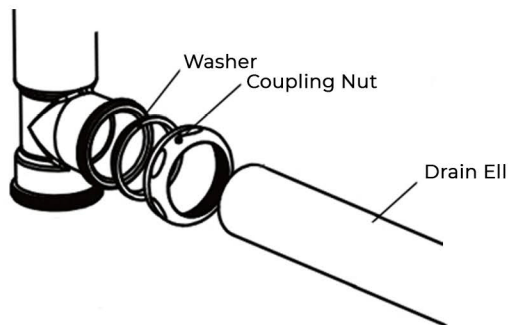

- 12.** Attach the flange to the base of the external drain and proceed to connect the drain to the end home plumbing.

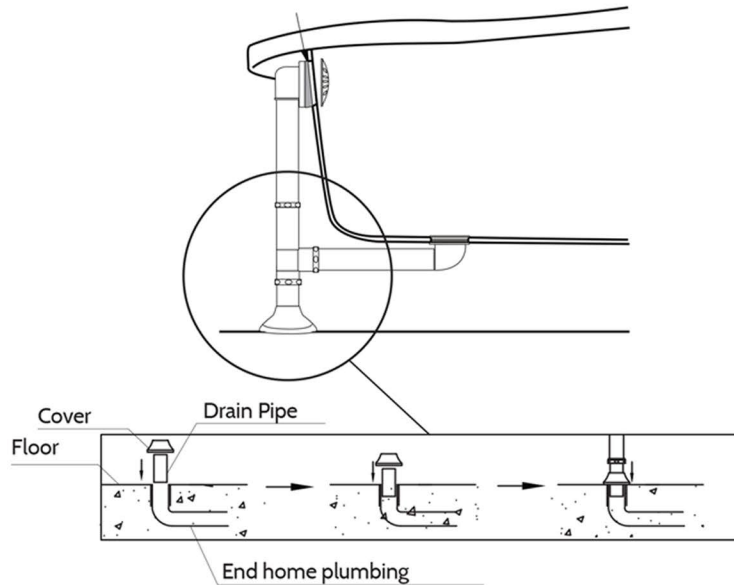

- 13.** Prior to finalizing installation, check all drain connections and fill the bathtub with a minimal level of water to test and ensure that no connections are leaking.