

# ASSEMBLY INSTRUCTIONS

---

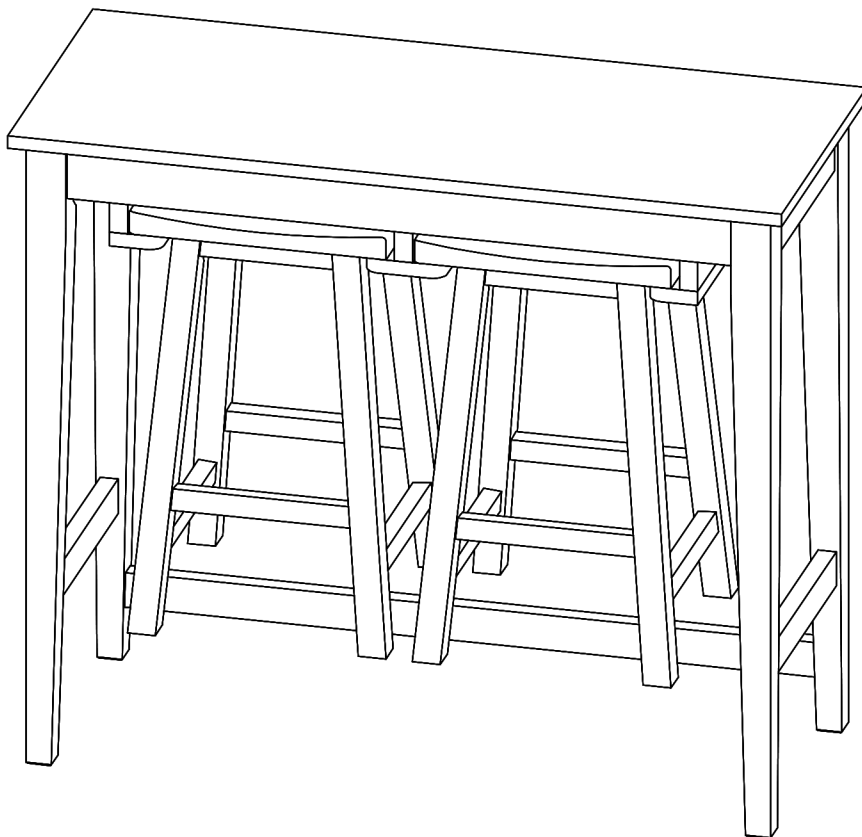

## TOOLS REQUIRED



Allen Wrench

(Included)



Phillips  
Screwdriver

(Not Included)



2 - People  
Recommended

## ASSEMBLY RATING



EASY —————> DIFFICULT

The Assembly Rating is a 5-point system showing the level of effort needed to assemble a specific product.



## **CHECK BEFORE STARTING**

☐

### **Are you missing anything?**

Double-check all parts, hardware and accessories listed on Page 6 are accounted for.

☐

### **Check out our Quick Tips!**

We recommend reviewing the pre-assembly handouts. Even experts need a refresher now and then!

☐

### **Should we send any replacements?**

Are there any irregularities or flaws in the parts? We can send replacements!

☐

### **Prep Time!**

Please review the assembly instructions and all diagrams prior to assembling. Arrange parts as recommended on Page 7 and group identical hardware together to make assembling easier.

# PRE ASSEMBLY INTRODUCTION

We understand building ready-to-assemble furniture can be a challenging experience for some. To help avoid confusion, we have provided some helpful tips that may speed up the process.



## Teamwork

ALWAYS have at least two people to help with transporting and assembling the product to avoid potential injury and/or damage.

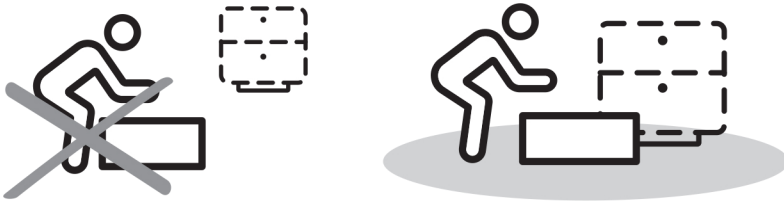

## Suitable Location

Assembling near the area of the intended location is highly recommended.



## Sufficient Space

Make sure you have enough space to move around during the assembly.

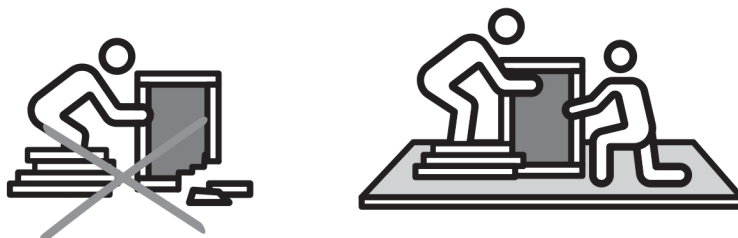

## Avoid Scratches

Use cardboard, blankets or a carpeted area while assembling furniture to prevent scratches.

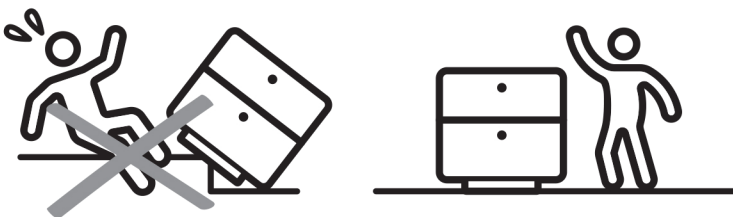

## Flat Surface

Make sure the furniture rests on a flat and level surface with each leg evenly touching the floor.

# ASSEMBLY AND CARE ADVICE



**FAILURE TO FOLLOW THE GUIDELINES BELOW MAY  
RESULT IN INJURY AND/OR PROPERTY DAMAGE.**



Position each part correctly  
and insert screws or bolts into  
their respective holes.

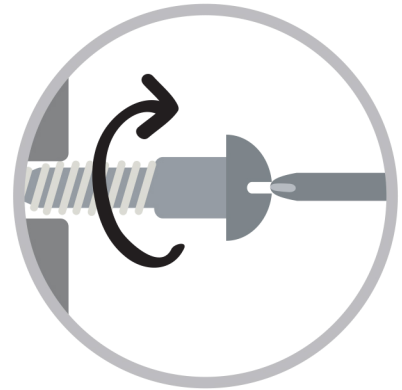

Turn clockwise to tighten and  
only tighten when step is  
completed or when instructed  
to do so.



Use the appropriate hand tools  
or power tools for assembly.  
Select steps, such as tightening  
screws and/or bolts, may require  
hand tools to avoid causing  
damage during assembly.



Save the instructions and store  
any supplied tools for later  
maintenance.

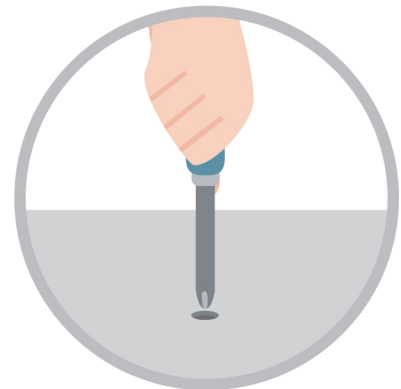

After two weeks, check and  
tighten any loose hardware and  
repeat again every six months  
thereafter.

**IT IS THE USER'S RESPONSIBILITY TO MAINTAIN THE FURNITURE. THE HARDWARE MAY LOOSEN OVER TIME AND MAY CAUSE THE FURNITURE TO BE WOBBLY AND UNABLE TO SUPPORT ITS INTENDED WEIGHT CAPACITY. THIS MAY LEAD TO COLLAPSE AND MAY CAUSE SERIOUS INJURY.**

# HEIGHT TABLE SET

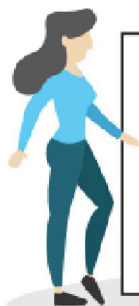

- Please keep instructions for future reference.
- Check the quantity and irregularity of parts and hardware before you start.

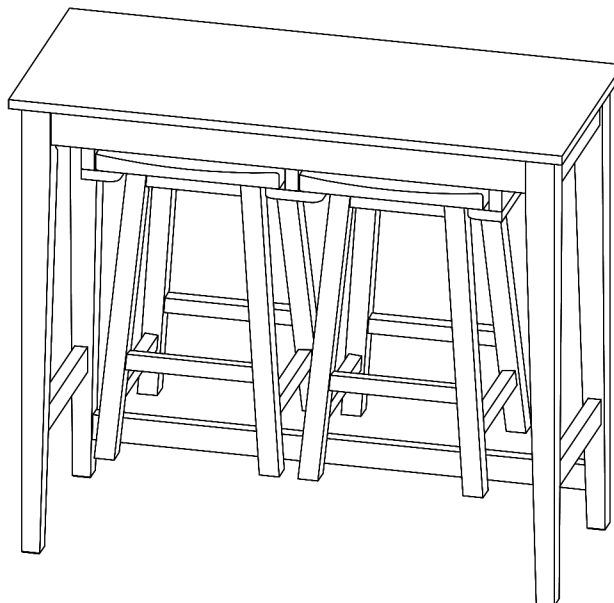

## PARTS

#1 1pc

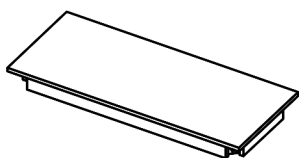
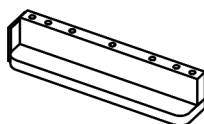

Table Top

#2 1pc



Right Stool Support

#3 1pc

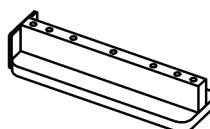

Mid Stool Support

#4 1pc

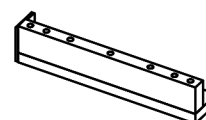

Left Stool Support

#5 1pc

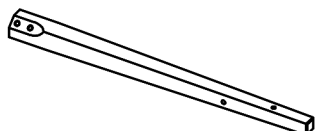

Table Leg #5

#6 1pc

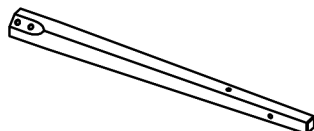

Table Leg #6

#7 1pc

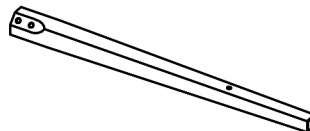

Table Leg #7

#8 1pc

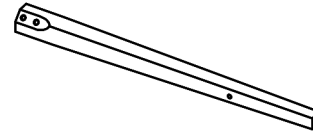

Table Leg #8

#9 1pc

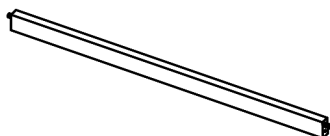

Table Long Stretcher

#10 2pcs

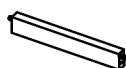
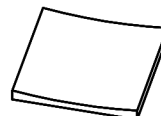

Table Short Stretcher

#11 2pcs



Stool Seat

#12 4pcs



Stool Leg #12

#13 4pcs



Stool Leg #13

#14 4pcs

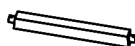

Stool Stretcher #14

#15 4pcs

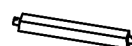

Stool Stretcher #15

# HARDWARE

#A 8pcs



Bolt Ø5/16"x 2-1/8"

#B 8pcs



Lock washer  
Ø5/16"x 12mm

#C 8pcs

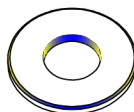

Flat washer  
Ø5/16"x 19mm

#D 6pcs



Bolt Ø1/4"x 3"

#E 6pcs



Hex nut Ø10x 30mm

#F 22pcs



Screw #4 x 38mm

#G 1pc



Allen key 4mm

#H 8pcs



Bolt Ø1/4"x 2"

#J 8pcs



Lock washer Ø1/4"x 11mm

#K 8pcs

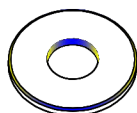

Flat washer Ø1/4"x 19mm

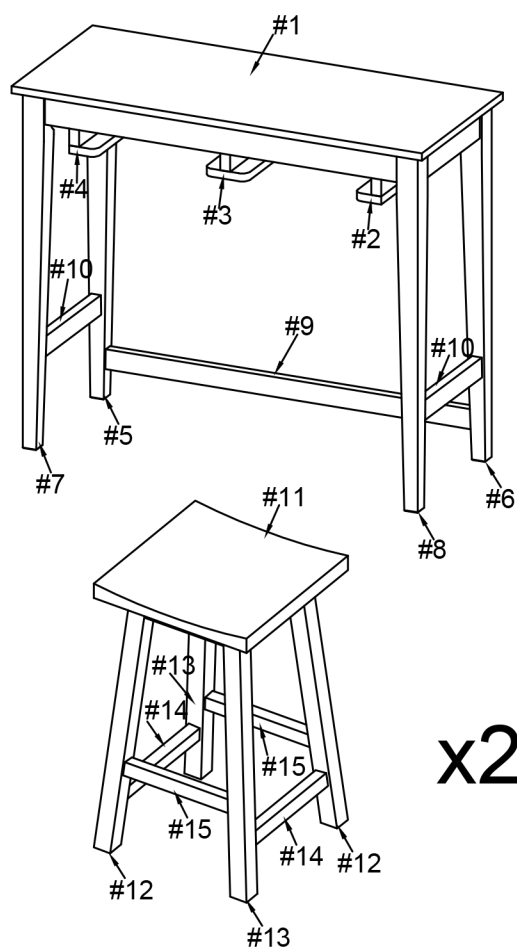

x2

# ASSEMBLY INSTRUCTIONS

## 1

- Part #1 x 1pc
- Part #5 x 1pc
- Part #6 x 1pc
- Part #9 x 1pc
- Hardware #A x 4pcs
- Hardware #B x 4pcs
- Hardware #C x 4pcs

Align table legs (#5,6) with stretcher (#9) to the top (#1), then secure by using bolts (#A) with washers (#B,C).

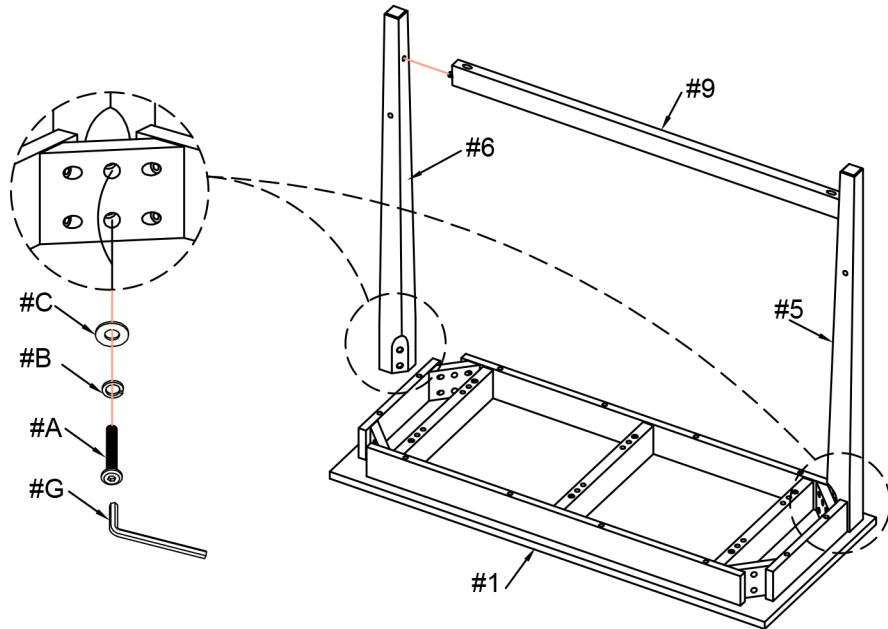

## 2

- Part #7 x 1pc
- Part #8 x 1pc
- Part #10 x 2pcs
- Hardware #A x 4pcs
- Hardware #B x 4pcs
- Hardware #C x 4pcs

Align legs (#7,8) with stretchers (#10) to the top (#1), then secure by using bolts (#A) with washers (#B,C).

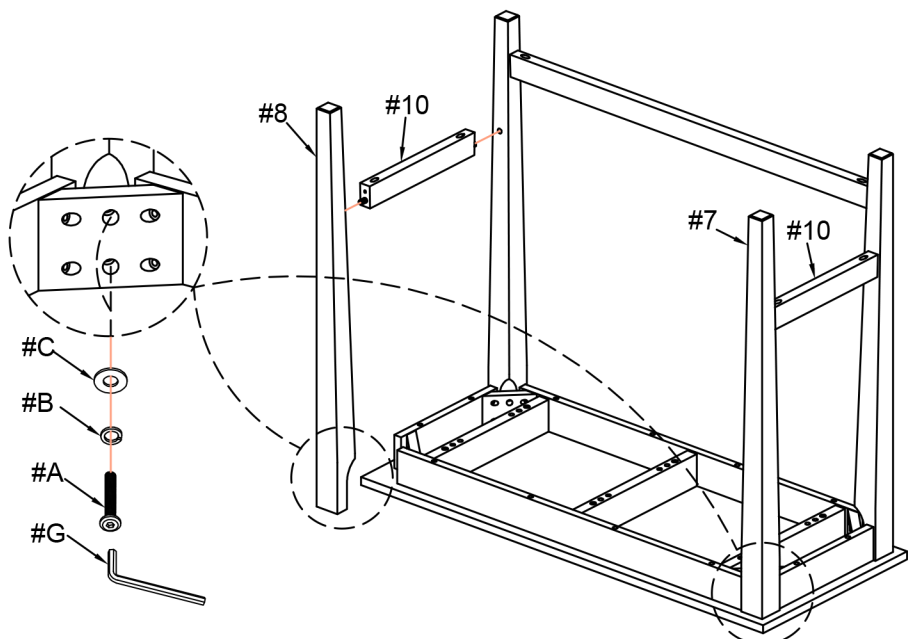

# ASSEMBLY INSTRUCTIONS

## 3

Hardware **#F** x 6pcs

Secure stretchers to legs by using screws (**#F**).

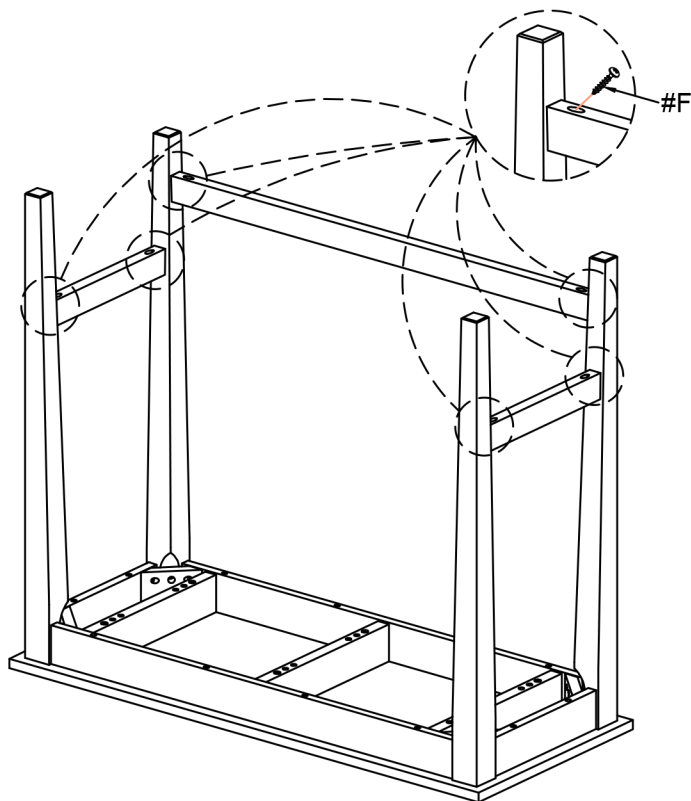

## 4

Part **#2** x 1pc

Part **#3** x 1pc

Part **#4** x 1pc

Hardware **#D** x 6pcs

Hardware **#E** x 6pcs

Insert dowels (**#E**) to stool supports (**#2,3,4**). Align stool supports (**#2,3,4**) to the top, then secure by using bolts (**#D**).

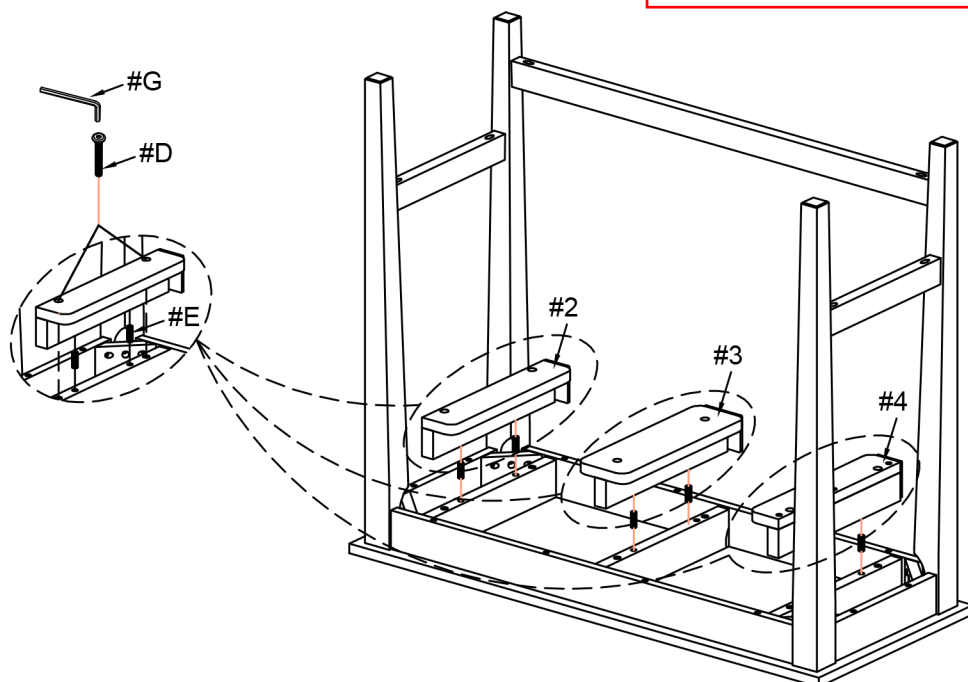

# ASSEMBLY INSTRUCTIONS

## 5

- Part #11 x 2pcs
- Part #12 x 4pcs
- Part #13 x 4pcs
- Hardware #H x 8pcs
- Hardware #J x 8pcs
- Hardware #K x 8pcs

Align stool legs (#12,13) to the seat (#11) as shown in the diagram, then secure by using bolts (#H) with washers (#J,K).

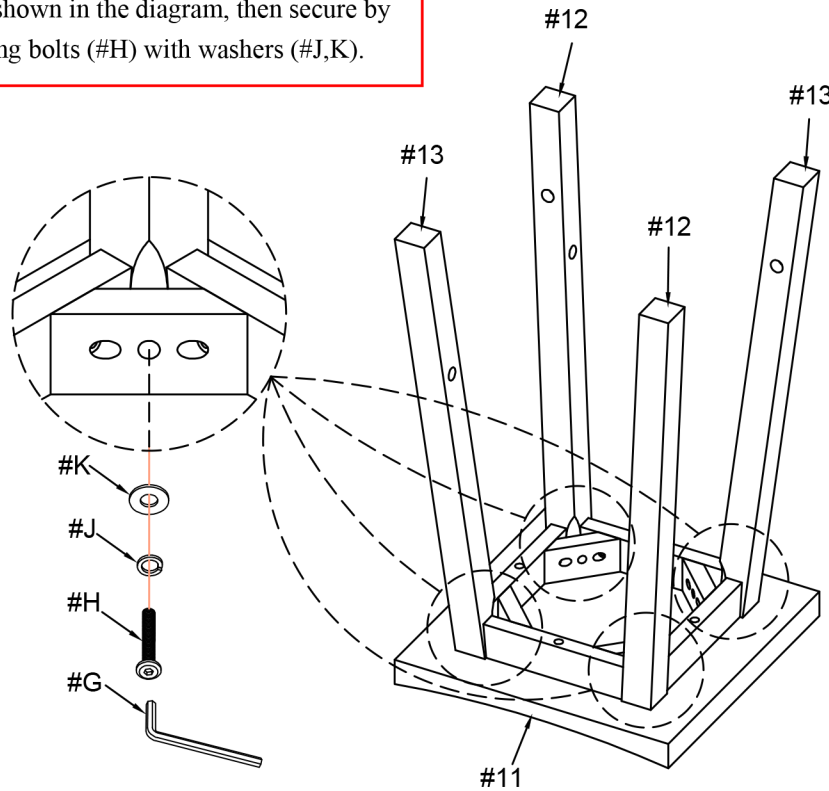

## 6

- Part #14 x 4pcs
- Part #15 x 4pcs
- Hardware #F x 16pcs

Secure stretchers by using screws (#F).

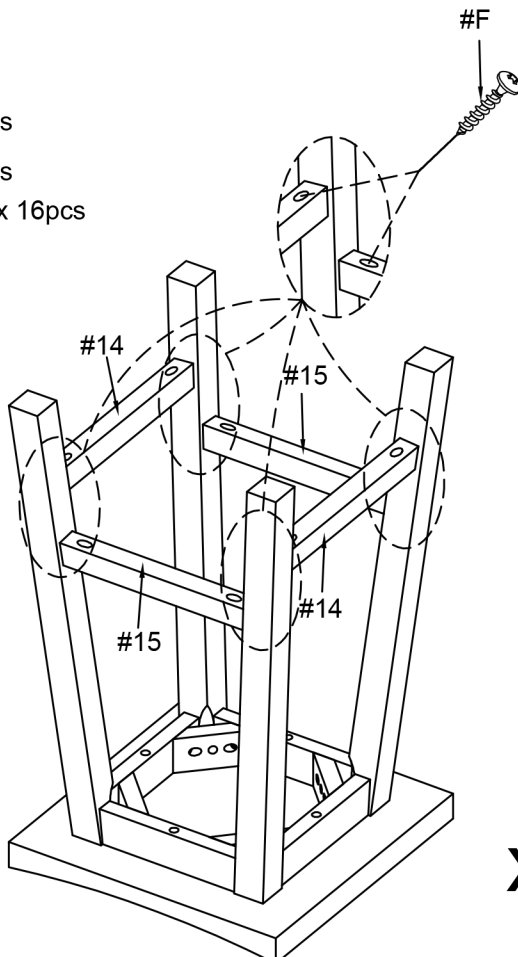

## ASSEMBLY COMPLETED



Please ensure the furniture rests on an even and flat surface. If the product wobbles or feels loose, double-check all bolts and/or screws are properly tightened and secured.



### Keep this handy!

Please retain this instruction manual and any order-related information for future reference.



### Lift, don't drag!

To avoid damage to product please always LIFT the product when transporting or adjusting the placement.