

ITEM #1055724

ISLAND LIGHT

MODEL #IL19-6BZB

Français p. 11

Español p. 21

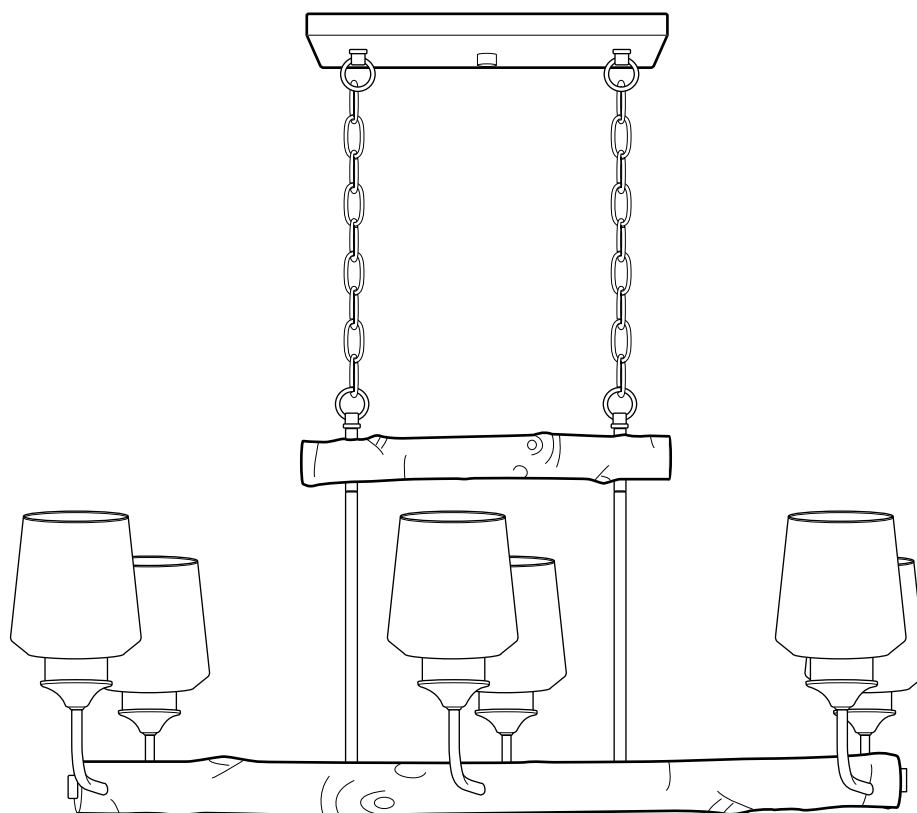

ATTACH YOUR RECEIPT HERE

Purchase Date _____



Questions, problems, missing parts? Before returning to your retailer, call our customer service department at **1-800-527-1292**, 8:30 a.m. - 5 p.m., Monday - Friday, CST

PACKAGE CONTENTS

PART	DESCRIPTION	QUANTITY
A	Fixture	1
B	Rod	4
C	Mounting Strap	1
D	Decorative Nut (preassembled to mounting strap (C))	1
E	Canopy	1
F	Chain	2
G	Fixture Loop (preassembled to threaded rod (H))	2
H	Threaded Rod	2
I	Rod Support	1
J	Socket Ring (preassembled to fixture (A))	6
K	Glass Shade	6

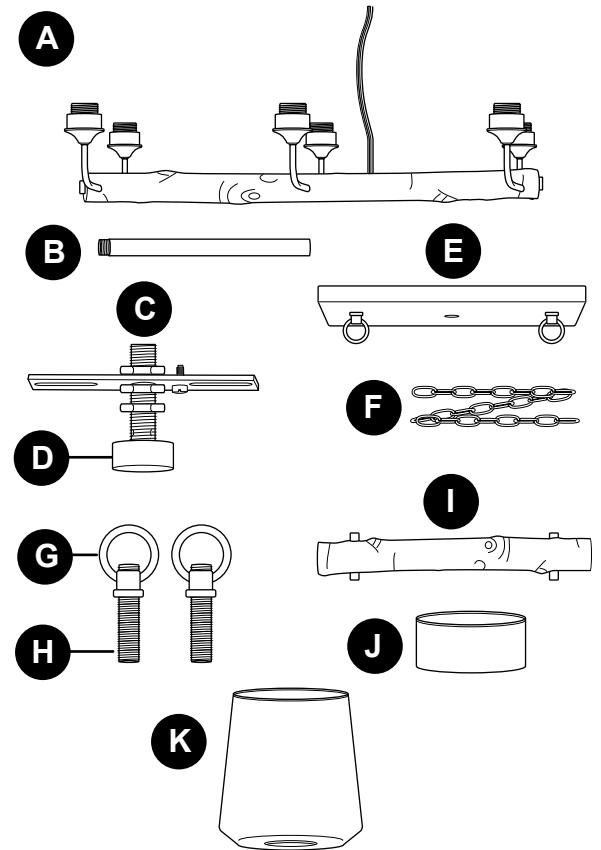

HARDWARE CONTENTS (shown actual size)

AA

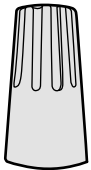

Wire
Connector

Qty. 3

BB

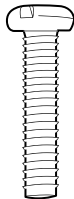

Machine
Screw

Qty. 2

CC

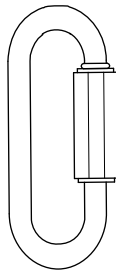

Connecting
Chain
Link

Qty. 4

DD

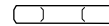

Hex Nut

Qty. 1



SAFETY INFORMATION

READ AND SAVE THESE INSTRUCTIONS.



DANGER

- For your protection and safety, carefully read and understand the information provided in this manual completely before attempting to assemble, install or operate this product. Failure to do so could lead to fire, electrical shock or other injuries that could be hazardous or even fatal.

SAFETY INFORMATION

- DO NOT connect this fixture to an electrical system that does not provide a means for equipment grounding. Never use a fixture in a two-wire system that is not grounded. Installing a fixture into an electrical system not having a proper grounding means could cause metal parts of the fixture to carry electrical currents if any of the fixture wires, wire connections or splices were to become broken, cut or loose during the mounting or normal operation of the fixture. Under this condition, anyone coming in contact with the fixture would be subject to electrical shock, which could cause serious injury or death.
- DO NOT connect the bare or green insulation fixture ground wire to the black (HOT) current-carrying wire or the white (NEUTRAL) house wire. Connection of the bare or green fixture ground wire to the black or white house wires may cause metal parts of the fixture to carry electrical currents. Under this condition anyone coming in contact with the fixture will receive electrical shock, which could cause serious injury or death.
- DO NOT damage or cut the wire insulation (covering) during installation of fixture. DO NOT permit wires to contact any surface having a sharp edge. To do so may damage or cut the wire insulation, which could cause serious injury or death from electrical shock.

WARNING

- All electrical connections must be in agreement with local codes and ordinances, the National Electric Code (NEC) and ANSI/NFPA 70-1999. Contact your municipal building department to learn about your local codes, permits and/or inspections. Risk of fire - most dwellings built before 1985 have supply wire rated for 140°F. Consult a qualified electrician before installation.
- To avoid personal injury, the use of gloves may be necessary while handling fixture parts with sharp edges.
- DO NOT suspend any fixture by the house wires. A fixture must always be mounted directly to an outlet box or to a mounting plate which is first attached to the outlet box. Wire connectors will not support the weight of a fixture. Suspending a fixture by the house wires and wire connectors will result in the fixture falling, with the possibility of personal injury and the danger of electrical shock or fire.
- To reduce the risk of fire, electrical shock or personal injury, wire connectors provided with this light fixture are designed to accept only one 12-gauge house wire and two lead wires from the light fixture. If your house wire is larger than 12-gauge or there is more than one house wire to connect to the corresponding fixture lead wires, consult an electrician for the proper size wire connectors to use.
- To avoid personal injury, the use of gloves may be necessary while handling fixture parts with sharp edges.

CAUTION

- TURN OFF ELECTRICITY at main fuse box (or circuit breaker box) before beginning installation by removing the fuse (or switching the circuit breaker off).
- If you are not sure the lighting system has a grounding means, DO NOT attempt to install this fixture. Contact a qualified, licensed electrician for information regarding the proper grounding methods as required by the local electrical code in your area.
- All fixtures must be mounted to an outlet box that is supported by the building structure.
- DO NOT use bulbs having a wattage greater than the maximum value stated on the fixture. The use of bulbs with higher wattage than specified will increase temperatures and risk of fire.
- If a dimmer control switch is used with this fixture, obtain professional advice to determine the correct type to use as well as the electrical rating required.
- Due to the weight of this fixture, it is advisable to seek the help of another person to hold the stepladder in place and to then help lift the fixture up to you once you are set on the ladder.

PREPARATION

Before beginning assembly of product, make sure all parts are present. Compare parts with package contents list and hardware contents list. If any part is missing or damaged, do not attempt to assemble the product.

Estimated Assembly Time: 45 minutes

Tools Required for Assembly (not included): Flathead Screwdriver, Phillips Screwdriver, Wire Strippers, Pliers, Wire Cutters, Safety Glasses, Stepladder, Electrical Tape

Helpful Tools (not included): A/C Tester Light, Do-It-Yourself Guide, Soft Cloth

ASSEMBLY INSTRUCTIONS

1. Turn off circuit breakers and wall switch to the fixture supply line leads.

⚠ DANGER: Failure to disconnect power supply prior to installation may result in serious injury or death.

2. Remove existing fixture and disconnect all electrical wiring.

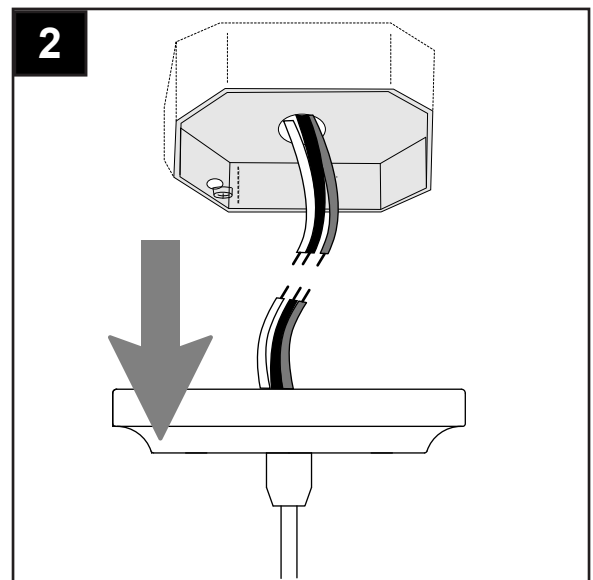
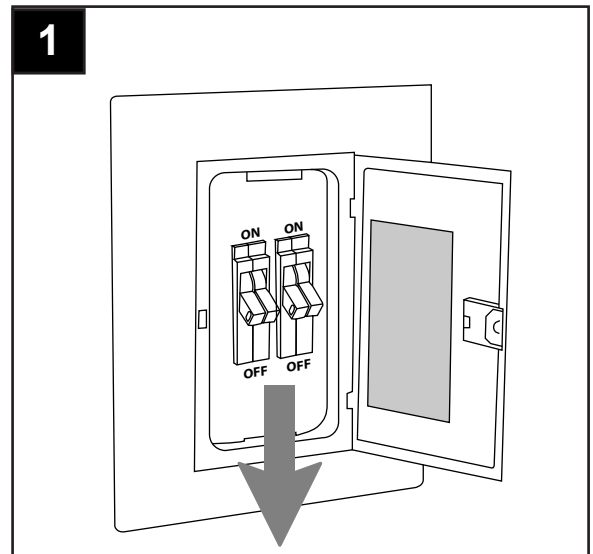

ASSEMBLY INSTRUCTIONS

3. Remove decorative nut (D) from threaded rod on mounting strap (C). -- *Save for later use.*

Attach mounting strap (C) to outlet box (not included) using existing washers and outlet box screws or the machine screws (BB).

NOTE: If the outlet box screws required for your outlet box are of a different size than the machine screws (BB), consult a licensed electrician before proceeding.

Tighten machine screws (BB) to secure mounting strap (C).

⚠ CAUTION: Make sure the outlet box can support 35 lbs. hanging weight. Use *metal* outlet box; plastic outlet boxes are not recommended.

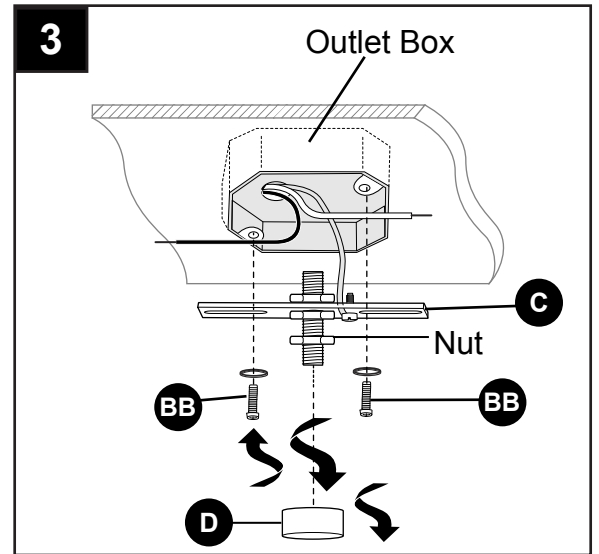

Hardware Used

BB Machine Screw  x 2

4. Attach rods (B) by screwing the ends of the rods (B) together. Be sure rods (B) are completely connected. Feed wires from fixture (A) through the rods (B). Screw lowermost rod (B) onto top of fixture (A).

Screw the other two rods (B) together, then screw lowermost rod (B) onto top of fixture (A). Be sure rods (B) are secure.

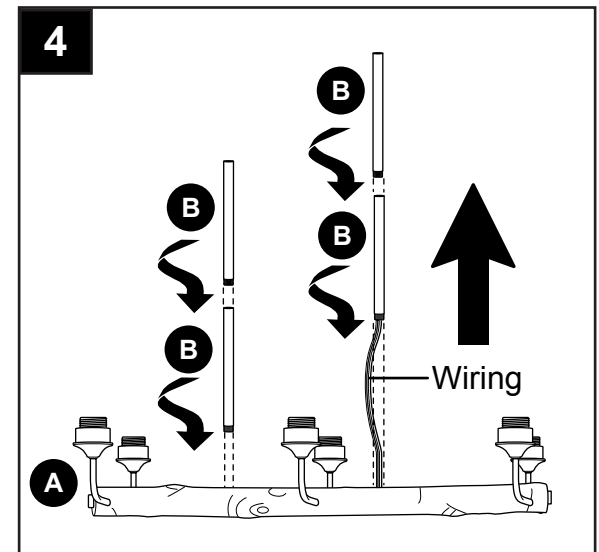

ASSEMBLY INSTRUCTIONS

5. Align holes in rod support (I) over uppermost rods (B) --threaded rods (H) should come through holes in rod support (I) just enough so that fixture loops (G) will fit flush against rod support (I). Once in the correct position, feed remaining wires through corresponding hole in rod support (I) - *Make sure wires do not get twisted*. Screw uppermost rods (B) onto threaded rod (H).

NOTE: Adjust wire length by pulling wires from fixture (A) until taut.

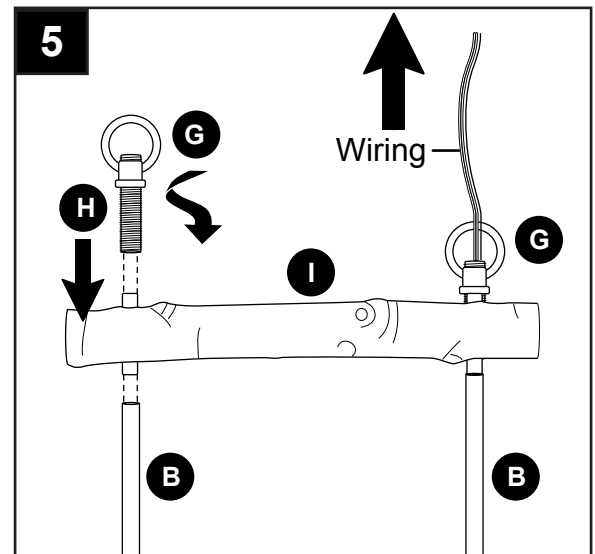

6. Attach one connecting chain link (CC) and chain (F) to both fixture loops (G) at the top of the rod support (I).

Determine the hanging length that is best for the fixture (A). **NOTE:** Use pliers, a flathead screwdriver and a soft cloth (all not included) to open the chain link at length chosen above. Remove any extra chain at this time.

Feed wiring through corresponding chain (F) to pre-determined length.

Attach remaining connecting chain links (CC) to the other end of the chains (F).

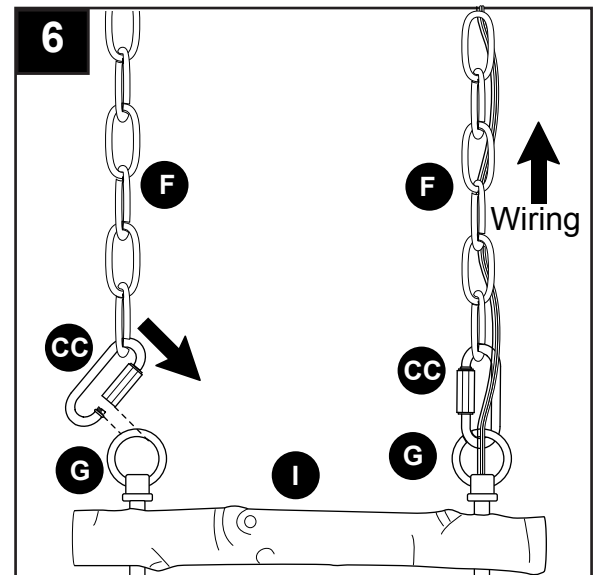

Hardware Used

CC Connecting Chain Link x 4

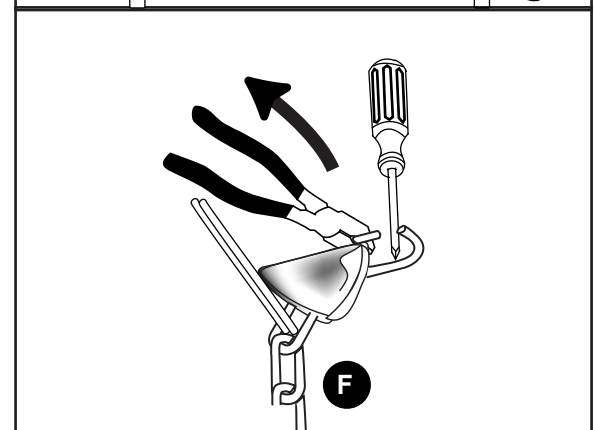
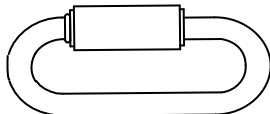

ASSEMBLY INSTRUCTIONS

7. Feed wiring and bare ground wire through corresponding loop on canopy (E). Pull all wiring until there is no extra slack left in the wires running through the chain (F). Hang chains (F) on loops using the connecting chain links (CC).

NOTE: If ceiling is above 10 ft., it is advisable to seek the help of another person to hold the stepladder in place and to then help lift the fixture up to you once you are set on the ladder.

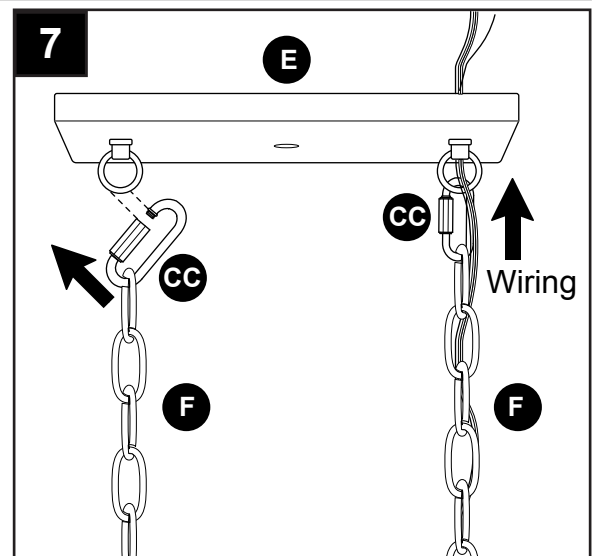

- 8a. Cut wire to desired length. Prepare wire by stripping 3/4 in. of insulation from wire ends using wire strippers (not included). Tie wire into a knot.

- 8b. Connect RIBBED wire from the fixture (A) to WHITE wire from outlet box using existing wire connector or wire connector (AA). Connect the SMOOTH wire from the fixture (A) to BLACK wire from outlet box using existing wire connector or wire connector (AA). Connect BARE/GREEN ground wire from outlet box to BARE ground wire from fixture (A) using wire connector (AA).

NOTE: Screw wire connectors (AA) on in a clockwise direction.

! WARNING: Never connect ground wire to WHITE or BLACK power supply wires.

! WARNING: To reduce the risk of fire, electrical shock or personal injury, wire connectors (AA) provided with this light fixture are designed to accept only one 12-gauge house wire and two lead wires from the light fixture. If your house wire is larger than 12-gauge or there is more than one house wire to connect to the corresponding fixture lead wires, consult an electrician for the proper size wire connectors to use.

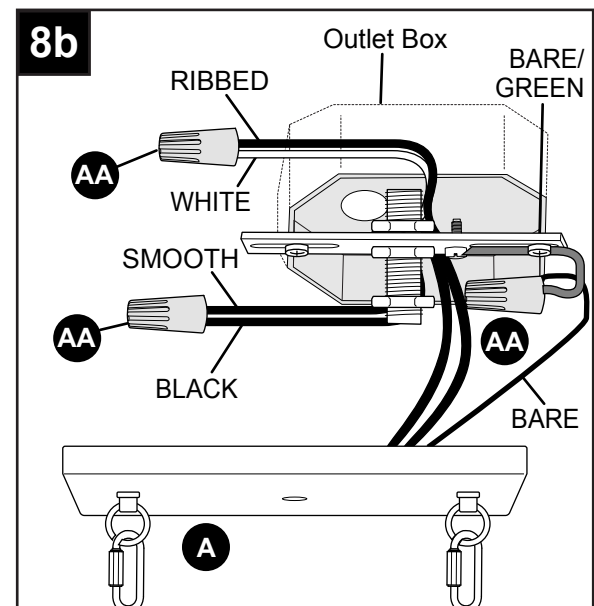
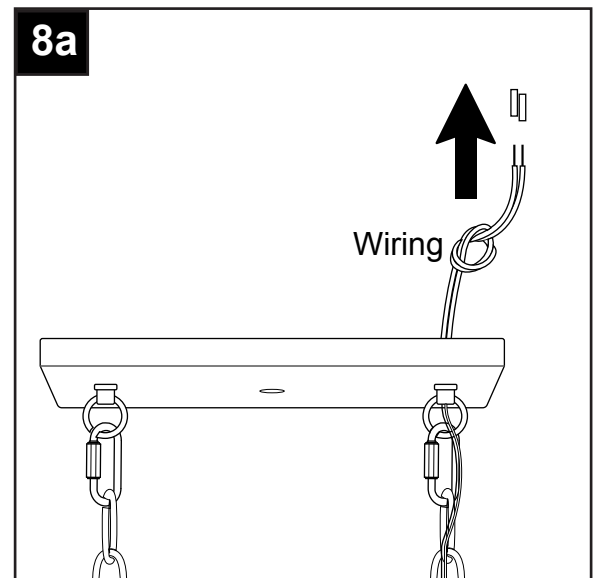

Hardware Used

AA	Wire Connector		x 3
-----------	----------------	--	-----

ASSEMBLY INSTRUCTIONS

9. Wrap electrical tape (not included) around each individual wire connector (AA) down to the wire.

⚠ WARNING: Make sure no bare wire or wire strands are visible after making connections.

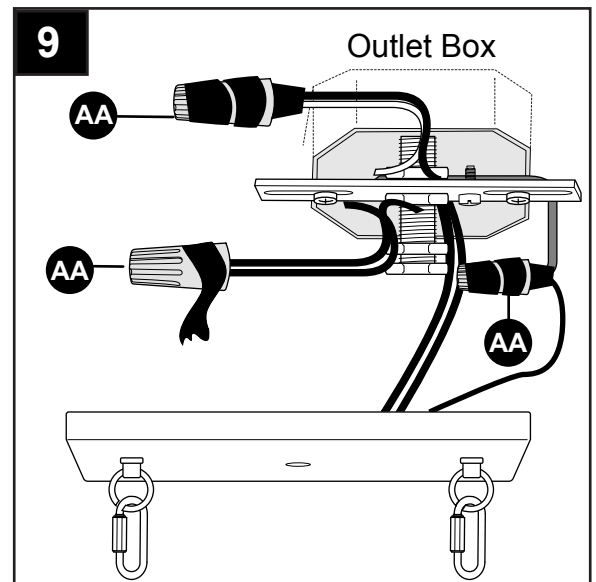

10. Carefully arrange excess wiring and wire connectors (AA) within outlet box. Adjust nut on threaded rod to proper height on mounting strap (C).

Raise canopy (E) toward ceiling and align threaded rod on mounting strap (C) with hole in middle of canopy (E)--threaded rod should come through hole in canopy (E) just enough so that the hex nut (DD) and decorative nut (D) will fit flush against canopy (E) when mounted.

Secure fixture (A) to mounting strap (C) with hex nut (DD) and decorative nut (D) previously removed (Step 3, page 5) on the underside of canopy (E).

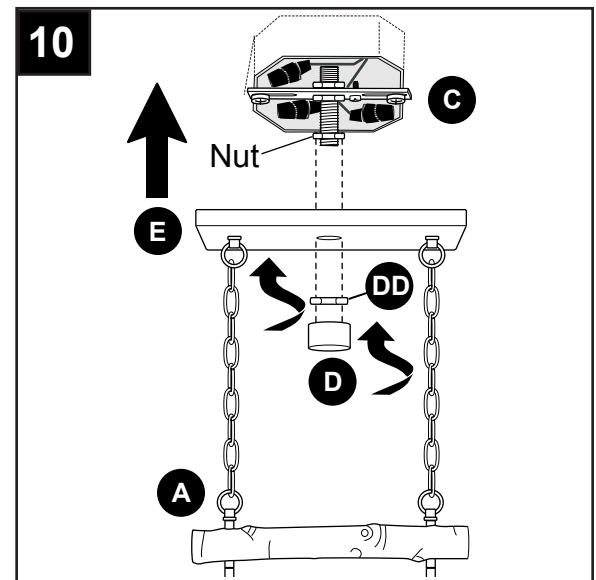

Hardware Used



Hex Nut

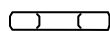

x 1

ASSEMBLY INSTRUCTIONS

11. Remove socket ring (J) from one of the sockets on fixture (A). Attach glass shade (K) to the socket using socket ring (J).

Repeat for remaining sockets.

⚠ CAUTION: Do not overtighten socket rings (J) as glass may crack or break.

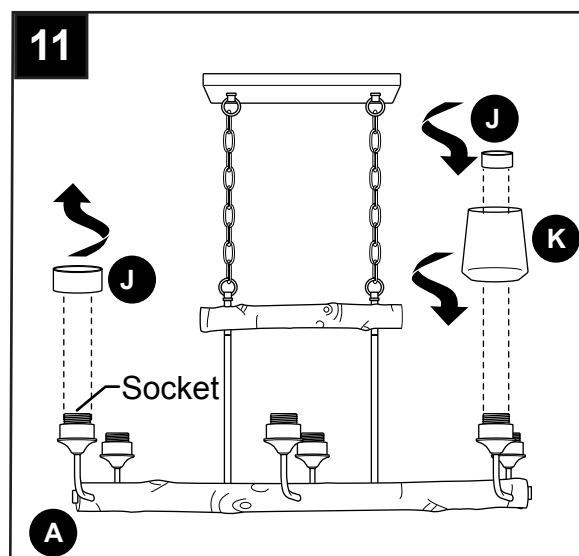

12. Install six standard-base bulbs (not included). Use 60-watt max. incandescent bulbs or CFL/LED equivalent.

⚠ CAUTION: When replacing bulbs, please allow bulbs and glass shades to cool before touching.

Restore power and test fixture (A).

If lights do not function, please refer to TROUBLESHOOTING below.

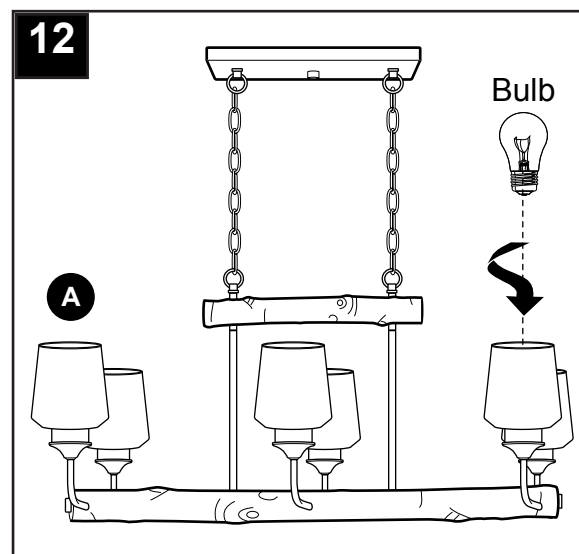

CARE AND MAINTENANCE

- Shut off main power supply. Wipe fixture with soft, damp cloth. Use window cleaner to clean glass. Do not use an abrasive cleaner on glass or fixture.

TROUBLESHOOTING

⚠ WARNING: Before beginning work, shut off the power supply to avoid electrical shock.

PROBLEM	POSSIBLE CAUSE	CORRECTIVE ACTION
Bulb(s) will not light.	1. Bulb(s) is/are burned out. 2. Power is OFF. 3. Faulty connection.	1. Replace light bulb(s). 2. Make sure power supply is ON. 3. Check wiring and all connections.
Fuse blows out or circuit breaker trips.	1. Crossed wires. 2. Power wire is grounding out.	1. Check wiring. 2. Check all connections.

WARRANTY

The distributor warrants all of its lighting fixtures against defects in materials and workmanship for one (1) year from the date of purchase. If within this period the product is found to be defective, take a copy of the bill of sale as a proof of purchase and the product in its original carton to the place of purchase. The distributor will, at its option, repair, replace or refund the purchase price to the consumer. All costs of installation and removal of the fixture is the responsibility of the consumer. This warranty does not cover fixtures becoming defective due to misuse, accidental damage or improper handling and/or installation and specifically excludes liability for direct, incidental or consequential damages. As some states do not allow exclusions of limitations on an implied warranty, the above exclusion and limitation may not apply. This warranty gives you specific rights and you may also have other rights which may vary from state to state.