

# Windsor 47.24

## Console Accent Table

4LC

Read to access Assembly Video

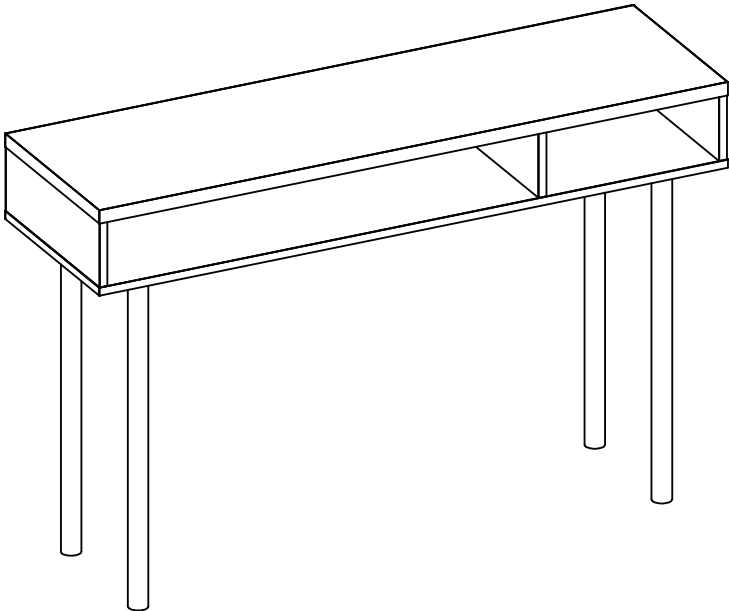

# Assembly Instructions

### Dimensions

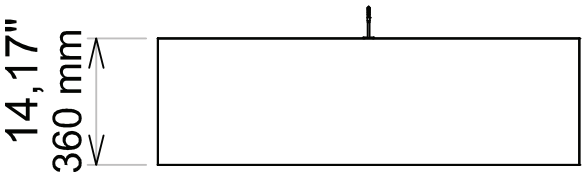
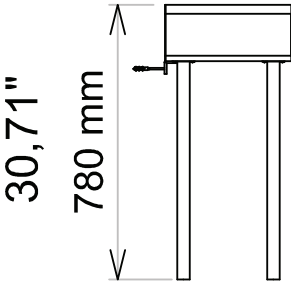
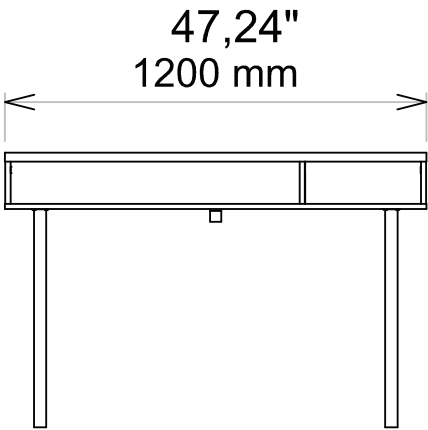

# Introduction

- \*Read the manual and follow the steps for the perfect assembly.
- \*Prepare the environment before you start. Leave the room completely clean to start the assembly. Use the carton of the box as a protection layer to separate and protect the parts in order to avoid damages. Image 01.
- \*Don't install it in areas that may be damp, with infiltrations.
- \*Observe cuidadosamente el manual y siga estrictamente los pasos de montaje.

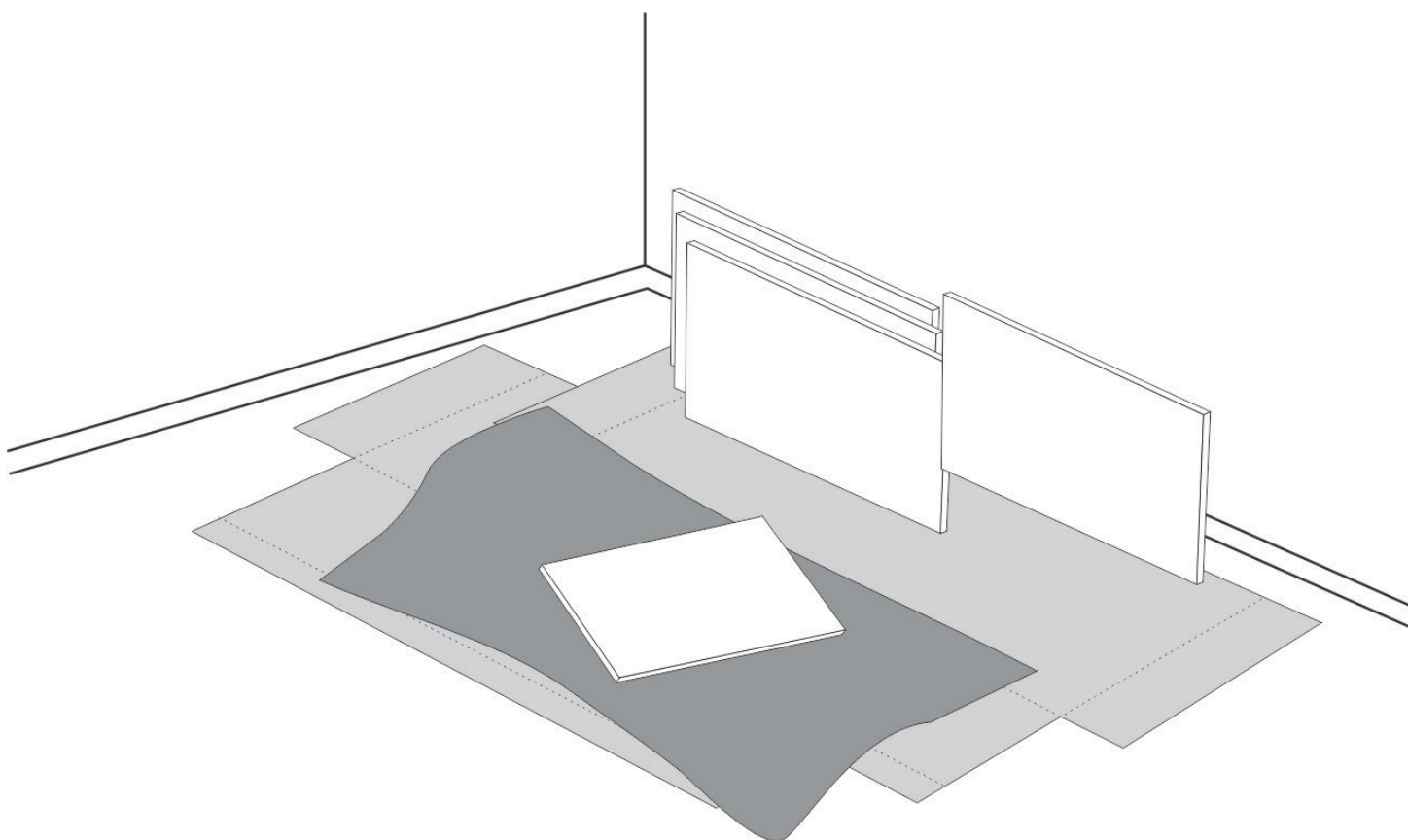

\*Image 01 Separate the parts

\* Before starting assembly, check all components.  
parts list, separate accessories by type and  
assemble the furniture lying down.

\* The parts come with their code stamped on.

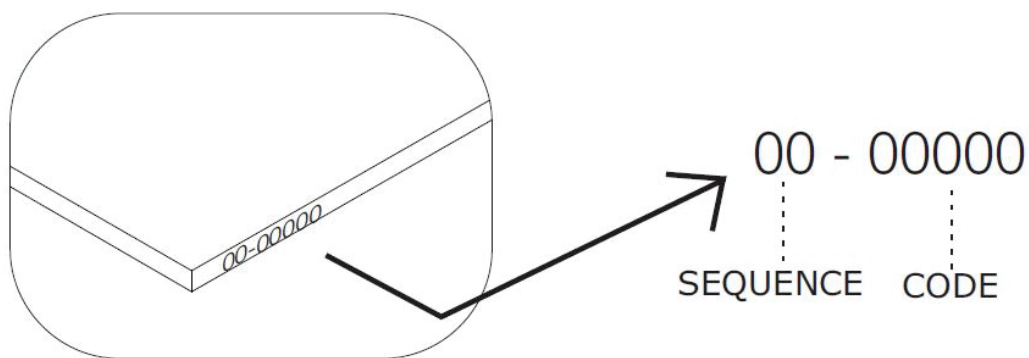

## Tools

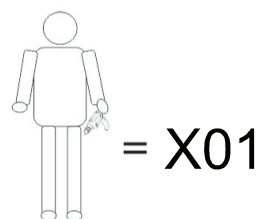
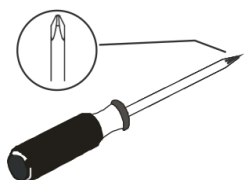

## Hardwares



(A) = X16  
+2 Extra



(B) = X3



(C) = X3  
+2 Extra

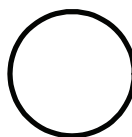

(D) = X3



(E) = X3



(F) = X16

SEQUENCE	CODE	DESCRIPTION	QTY
01	50964	LOWER BASE	1
02	50966	LEFT SIDE	1
03	50968	BOTTOM	1
04	50967	SIDE AND PARTITION	2
05	50965	TOP	1
06	MET0121	FOOT SUPPORT	4
07	PES0371	CYLINDRICAL FOOT	4

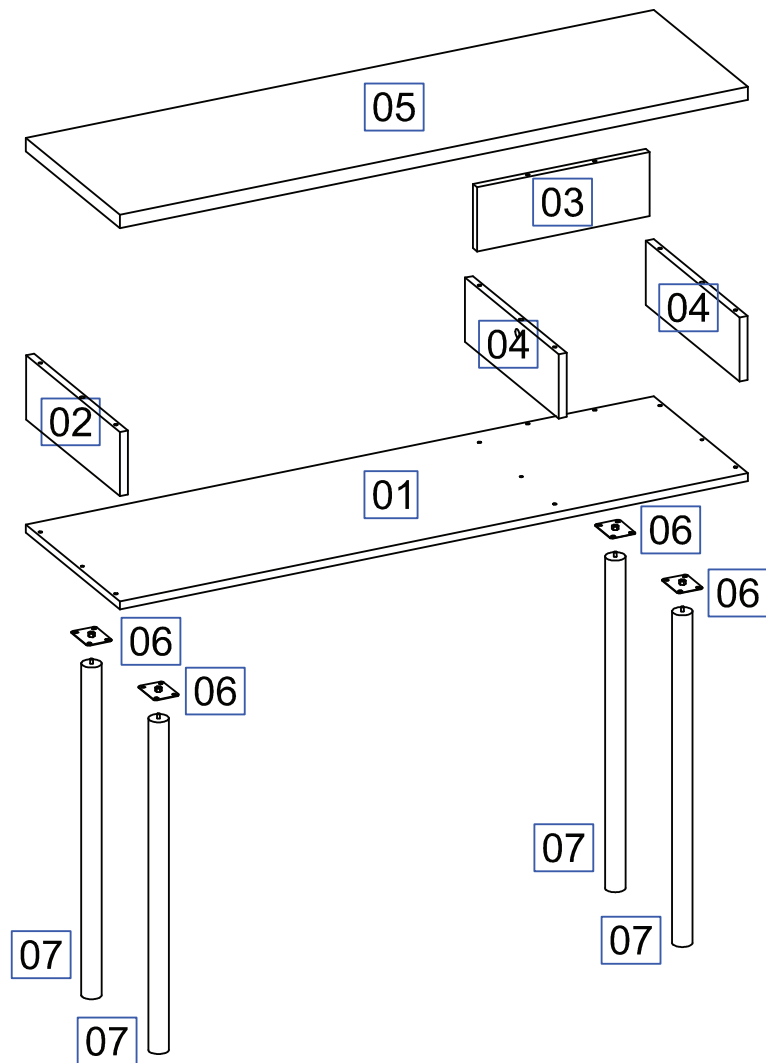

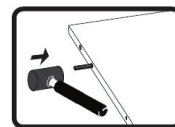

\* Before starting, you have to know:

(  ) You should always fix the dowel until the end using a rubber hammer.

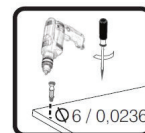

(  ) You must screw thi hardware using an eletric drilling machine or phillips screwdriver only in the 0,236 inches hole (the smaller hole).



(  ) Always fix this hardware with the arrow faced to the hole.

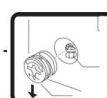
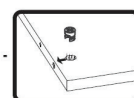

## STEP 01

\* Insert hardware "A" on the extremities of the part 04 and hardware "C" on the face of it.

X2

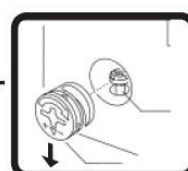
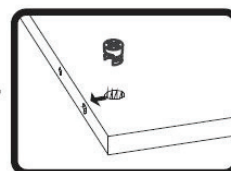
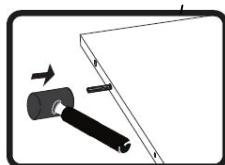
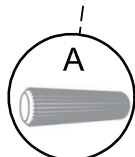
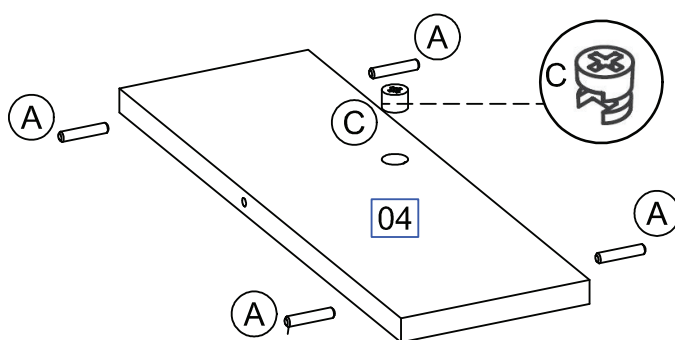

\* Be aware the arrow of the nuts must be faced according to the image.

## STEP 02

\* Insert accessorie "A" into the extremity of part 03.

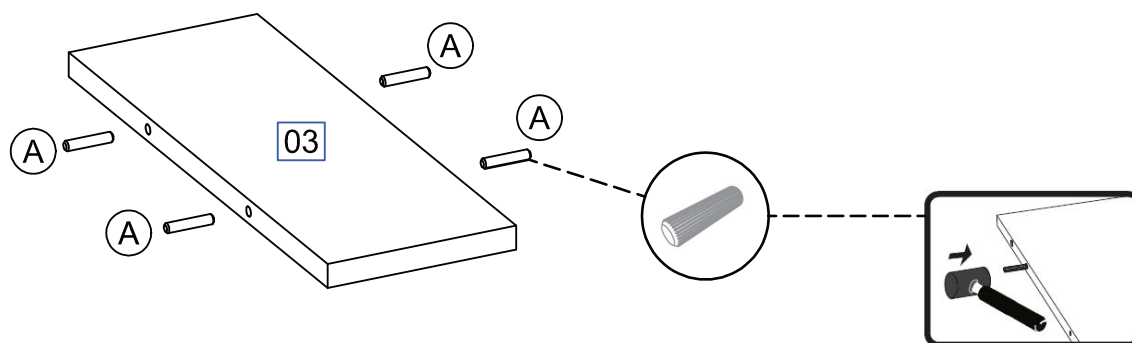

## STEP 03

\* Insert hardware "A" on the extremities of the part 02 and hardware "C" on the face of it.

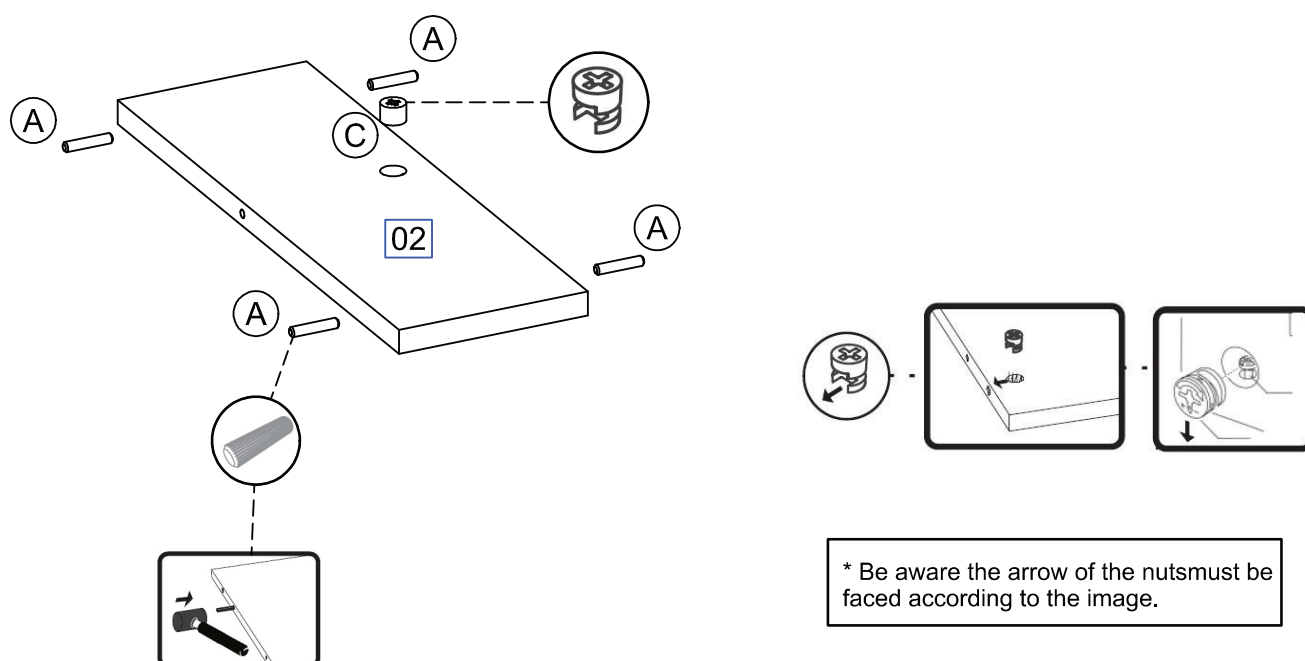

\* Be aware the arrow of the nuts must be faced according to the image.

## STEP 04

\* Insert hardware "B" on the surface of part 05.

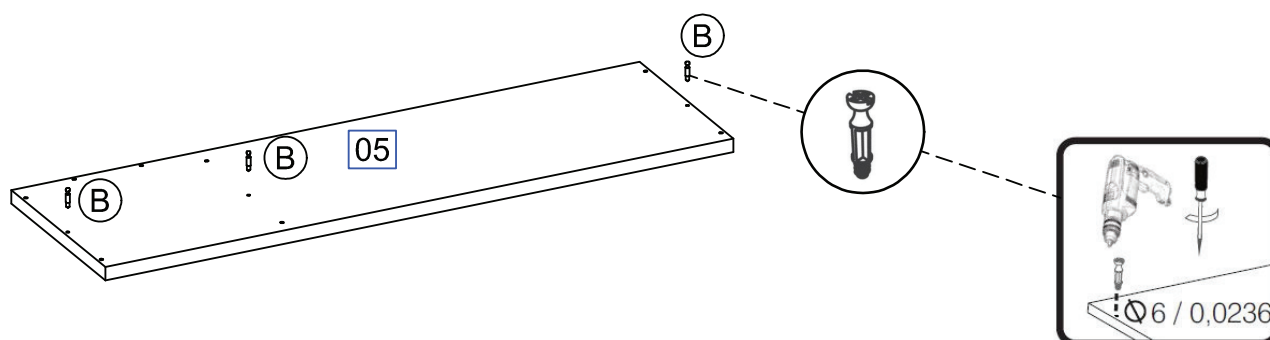

STEP 05

\* Attach part 02 to the part 01 according to the image, then screw it using hardware "E".

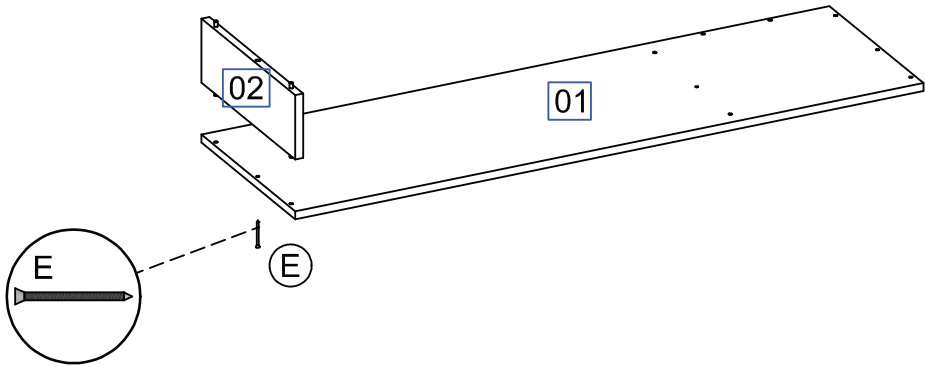

STEP 06

\* Attach part 03 according to the existing pre holes of part 01.

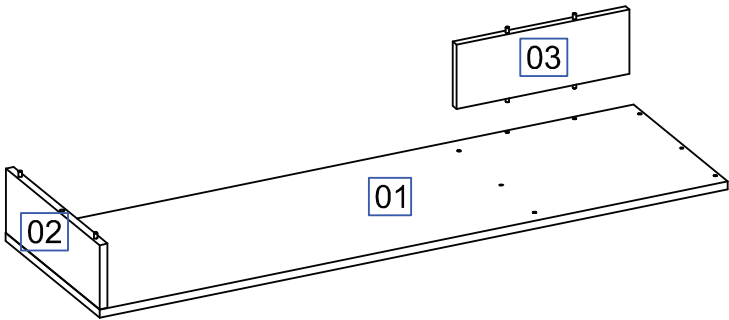

STEP 07

\* Attach part 04 to the part 01 according to the image, then screw it using hardware "E"

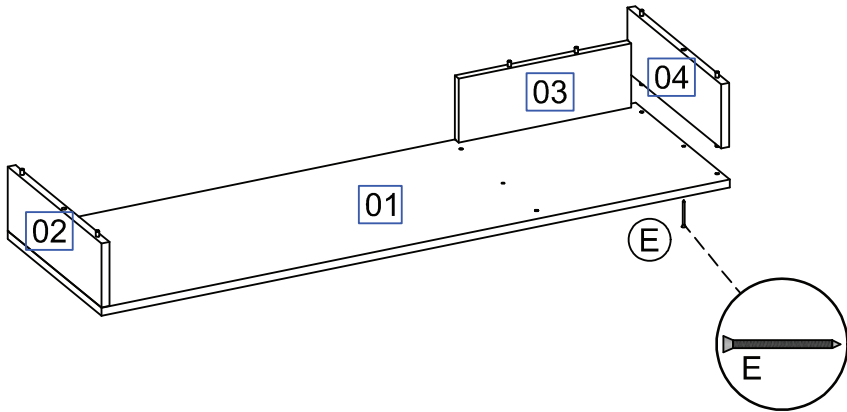

## STEP 08

\* Attach part 04 to the part 01 according to the image, then screw it using hardware "E".

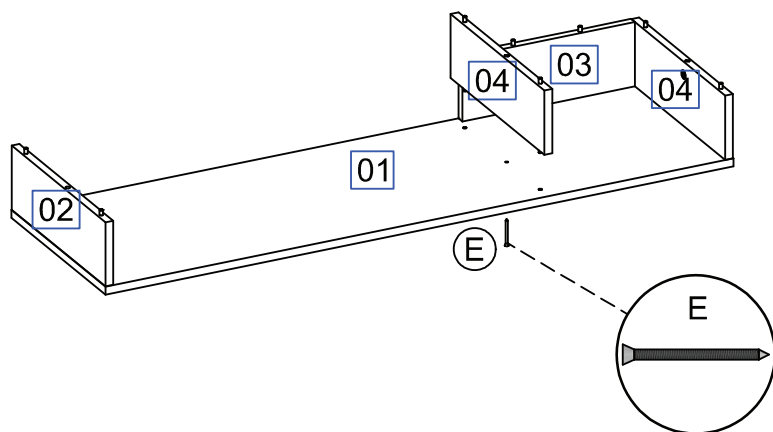

## STEP 09

\* Attach part 05 to the parts 02 and 04 according to the image. Then screw them using the nuts "C".

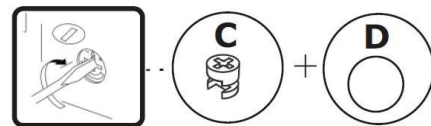
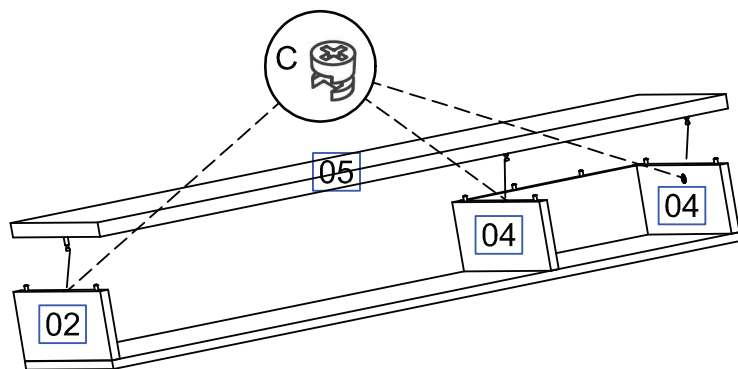

## STEP 10

\* Screw the part 06, using the hardware "F" according to the existing pre holes of part 01.

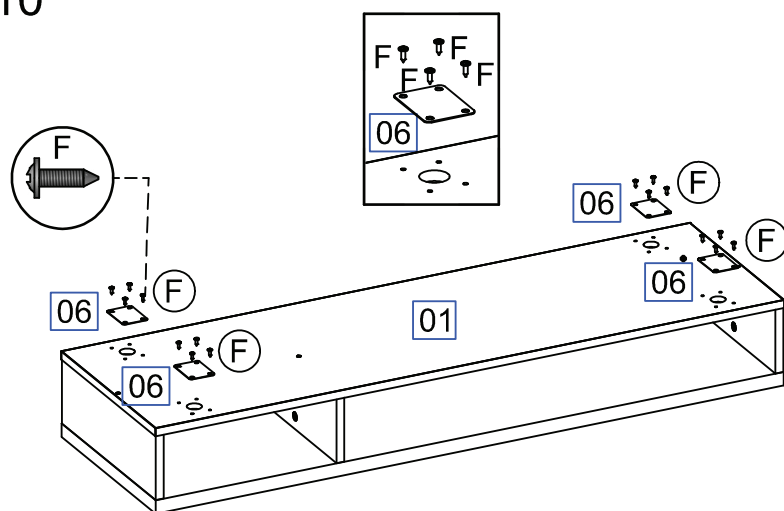



## STEP 11

\* Attach part 07 to the part 06 according to the image.

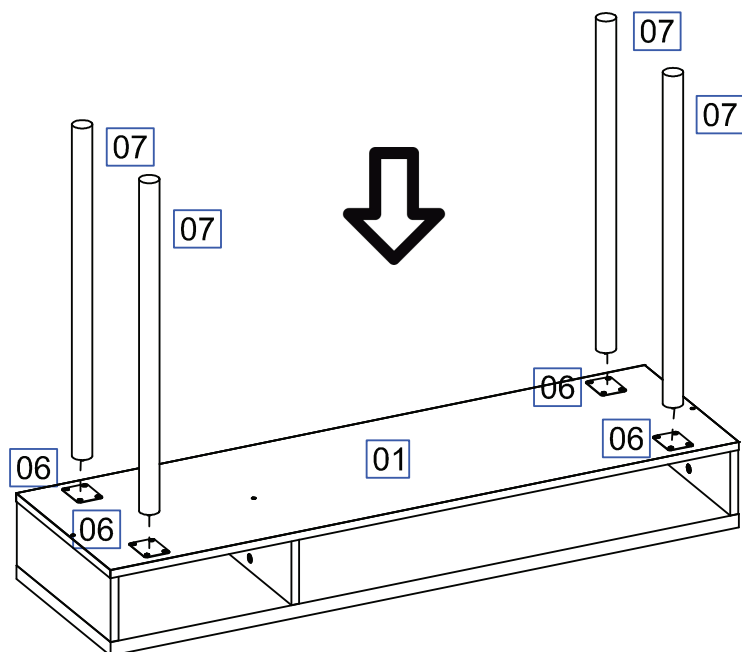

## FINAL VIEW

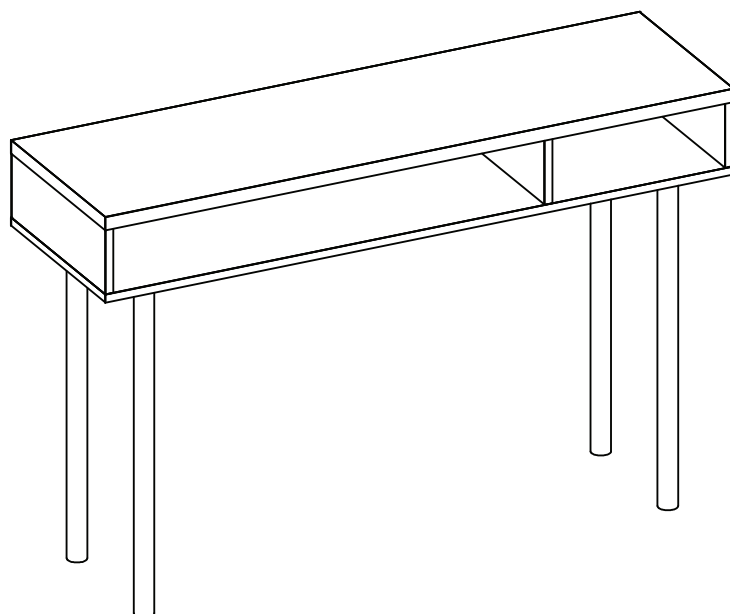

# WARNING

## TIPOVER SYSTEM

Please attach the hardware (Z1) using screw (Z2) in the part 01, according to the image. Then, drill the wall to press the wings (Z3) into the hole.

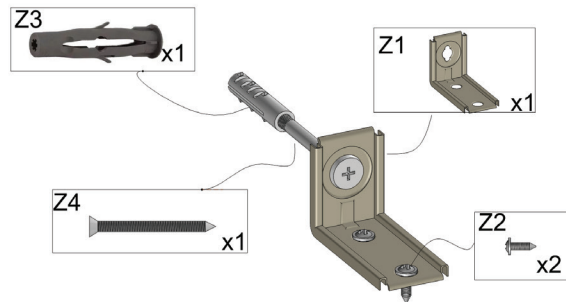
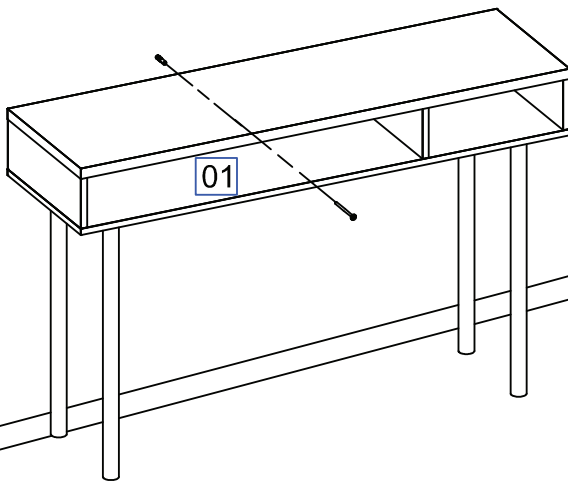
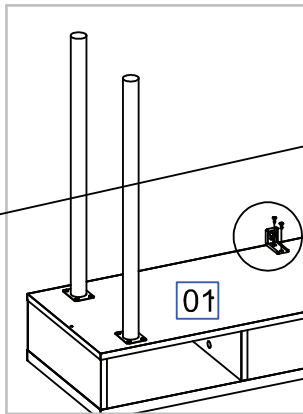

**Hardware (Z3) plugged in the wall**

**Now fix entertainment unit into the wall with hardware (Z1) and Screw (Z4)**

## WEIGHT

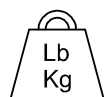

\* Be aware about maximum weights shown in the assembly instruction.

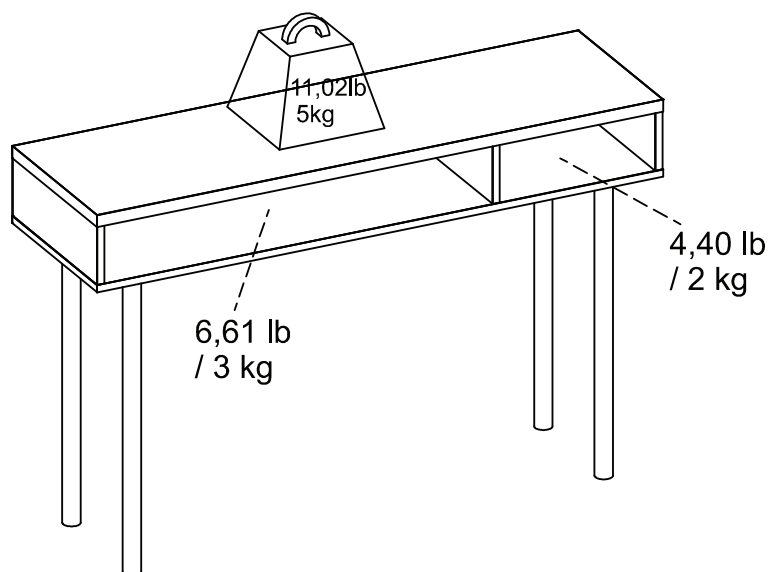

## AVOID ACCIDENTS

\* Don't climb or lean on the furniture.

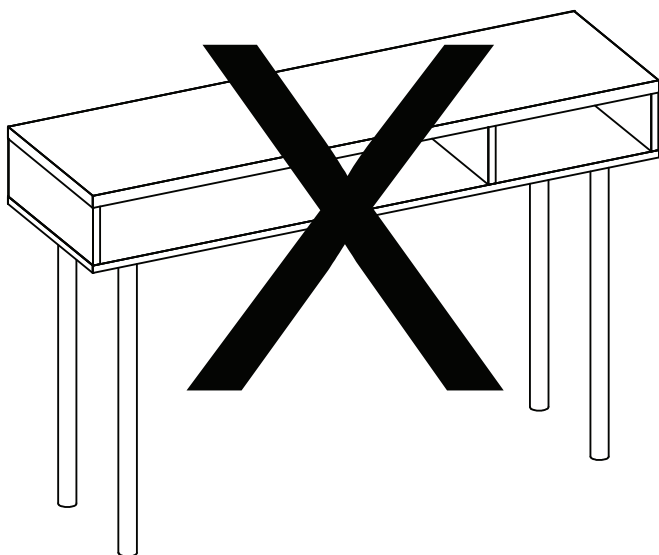

## MAINTENANCE AND CLEANING

\* For cleaning use only cloth slightly dampened in water.