

system damage. Water should now be flowing through the system to the point of use. Allow the water to run until the stream falls to a thin gentle flow. Initial discharge may be accompanied by a harmless discoloration due to loose carbon. Discard the first few gallons of product water until the water runs clear and both the TDS and pH stabilize.

For more information please visit www.ThePerfectWater.com or contact customer service at 1-877-693-PURE. We will be happy to assist you with your filter change.

Insert tube Push up to tube stop

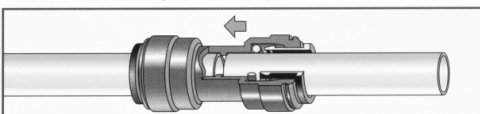

Push the tube into the fitting, to the tube stop. The collet (gripper) has stainless steel teeth which hold the tube firmly in position while the 'O' ring provides a permanent leak proof seal.

Push in collet and remove tube

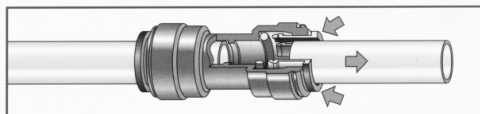

To disconnect, ensure the system is depressurized before removing the tube. Push in collet squarely against face of fitting. With the collet held in this position, the tube can be removed.

Pull to check secure

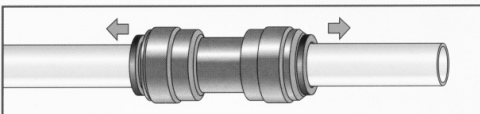

Pull on the tube to check that it is secure. It is a good practice to test the system prior to leaving site and/or before use.

Perfect Water Technologies, Inc.
Copyright © 2010



HydroGardener® Series Reverse Osmosis System Filter Change Instructions

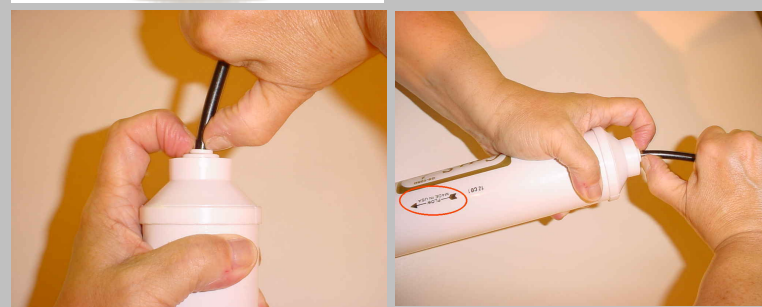

HydroGardener® Series Reverse Osmosis System Filter Change Instructions

Tools Required

Scissors

Towel

1. Clear away a workspace near the location of the HydroGardener® Reverse Osmosis System.
2. Turn off the water feeding the HydroGardener, by closing the inline ball valve located on the feed water line. See Figure 1.
3. Depressurize the system. Locate the 3/8" blue tubing at the output of the system. Depending on how you have terminated this line and connected it to your point of use (float valve, ball valve, open to reservoir) make sure this is open and water no longer flows. The system is now depressurized; continue to leave it in the open position.
4. Slowly and gently pull the HydroGardener® off of its mounting clips from the bottom up. Lay it on a towel. Pull off the first filter to be changed. **IMPORTANT:** Make note of flow direction arrows on the filter body and line then up with the replacement filter which you should position nearby.

- a. To determine which replacement filter you should use, compare the labels on the filters and make sure the flow direction arrows face the same direction. Make note of your system configuration.
 - b. To remove the tubing from the filter – push down the seal ring to the filter body with the thumb and forefinger while simultaneously pulling on the tubing as shown in Figure 6. Some mild resistance to pulling out the tubing is normal. Removing the tubing will be impossible without first fully depressurized the HydroGardener as described in step 4. See diagram on page 4. Immediately trim off a ¼" from the end of the tubing with the scissors. Make sure tubing end is smooth and round before inserting it into the replacement filter. **NOTE:** A rough or oblong tube end will leak.
 - c. Insert the tube end about a ¼" into the replacement filter fitting then pull back gently to ensure a snug fit. Repeat step 4 for the other end of the filter. Immediately discard used filter. Repeat step 4 for each of the next replacement filters.
5. Remount the HydroGardener®, and **SLOWLY** open the feed water line to the HydroGardener®. **Failure to repressurize slowly may result in**