



## 1x6 Thermally Modified Cladding



Big Sky

Wood Smoke

Back Country



Glacier

Natural

Timber Ridge

Lost Trail

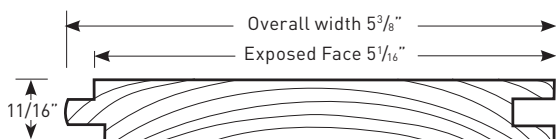

### Horizontal Installation

Drywall over studs

Framing studs

15- or 16-gauge trim nails

Thermally Modified boards

Apply adhesive 1" from bottom of shiplap board

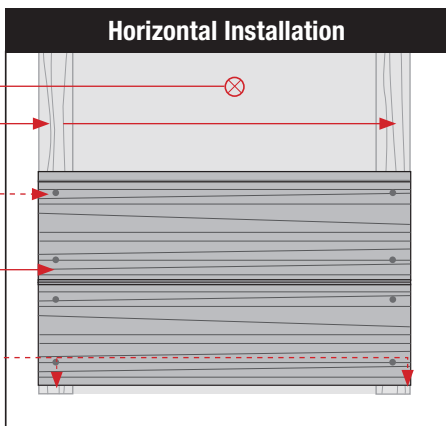

### Vertical Installation

Trim (install with 15- or 16-gauge trim nails prior to or following boards)

Thermally Modified boards

Apply adhesive 1" from side of shiplap board

Furring strips

Drywall over studs

Framing stud

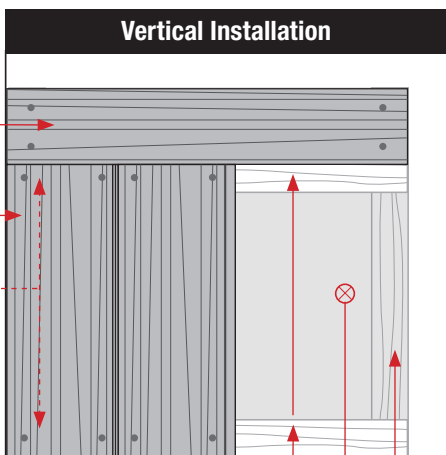

If using for furniture or in high traffic areas a high quality polyurethane sealer is recommended.